

1 Ground Floor Plan - GIA 48.7 m2
1 : 50



3 Roof Plan
1 : 50

3 Bed 5 Person House Type Plan GIA 97.4 m²



2 First Floor - GIA 48.7 m2
1 : 50

RESPONSIBILITY IS NOT ACCEPTED FOR OTHERS SCALING DIRECTLY FROM THIS DRAWING. DO NOT SCALE FROM THIS DRAWING. USE WRITTEN DIMENSIONS ONLY.



THIS DRAWING IS PRODUCED FOR USE IN THIS PROJECT ONLY AND MAY NOT BE USED FOR ANY OTHER PURPOSE. THE ORIGINATOR ACCEPTS NO LIABILITY FOR THE USE OF THIS DRAWING OTHER THAN THE PURPOSE FOR WHICH IT WAS INTENDED IN CONNECTION WITH THIS PROJECT AS RECORDED IN THE 'PURPOSE FOR ISSUE' AND 'FILE STATUS CODE'.

THIS DRAWING MAY NOT BE REPRODUCED IN ANY FORM WITHOUT PRIOR WRITTEN AGREEMENT.

© CROWN COPYRIGHT AND DATABASE RIGHTS - ORDNANCE SURVEY LICENCE NUMBER 100019340.

KEY PLAN

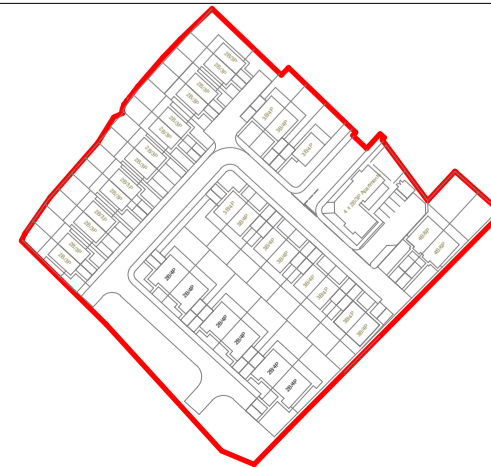

NOTES

Rev	Description	Date
P01	First issue	02.11.18
P02	Bed to amended to twin bedroom	08.11.18
P03	Amended to incorporate long car amends	01.03.19
P04	For information only	21.10.19
P05	Updated to reflect client comments. Aire source heat pump cylinder indicated.	07.11.19
P06	Kitchen/Stair flipped and first floor reconfigured to suit.	15.11.19
P07	Updated to reflect client comments	06.12.19
P08	Updated to reflect client comments	13.12.2019

CLIENT

BMC Housing Growth

PROJECT

St. Michael's Avenue

TITLE

Proposed 3 Bed House Type Plan

SCALE

1 : 50

DRAWING NUMBER

NPS_XX_ZZ_DR_A_040

STATUS CODE

S2

PURPOSE OF ISSUE

Planning

PROJECT NUMBER

1811301

REV CODE

P08

Drawn by

EA

Checked by

BT

Approved by

-



Barnsley - Gateway Plaza

Sackville Street
Barnsley
South Yorkshire
S70 2RD
barnsley@nps.co.uk