

Key

- Proposed Lead Roof
- Existing Roof Level
- Discrepancy from Existing Roof Level

Any dimensions and detail sections shown are indicative of the existing roof and are for guidance only. Exact dimensions to be taken on site prior to commencement of works. Rooflight is indicative of The Standard Patent Glazing Company Heritage LC No 7 DG skylight system incorporating double glazed units. For all details, refer to SPG Co Ltd drawings.

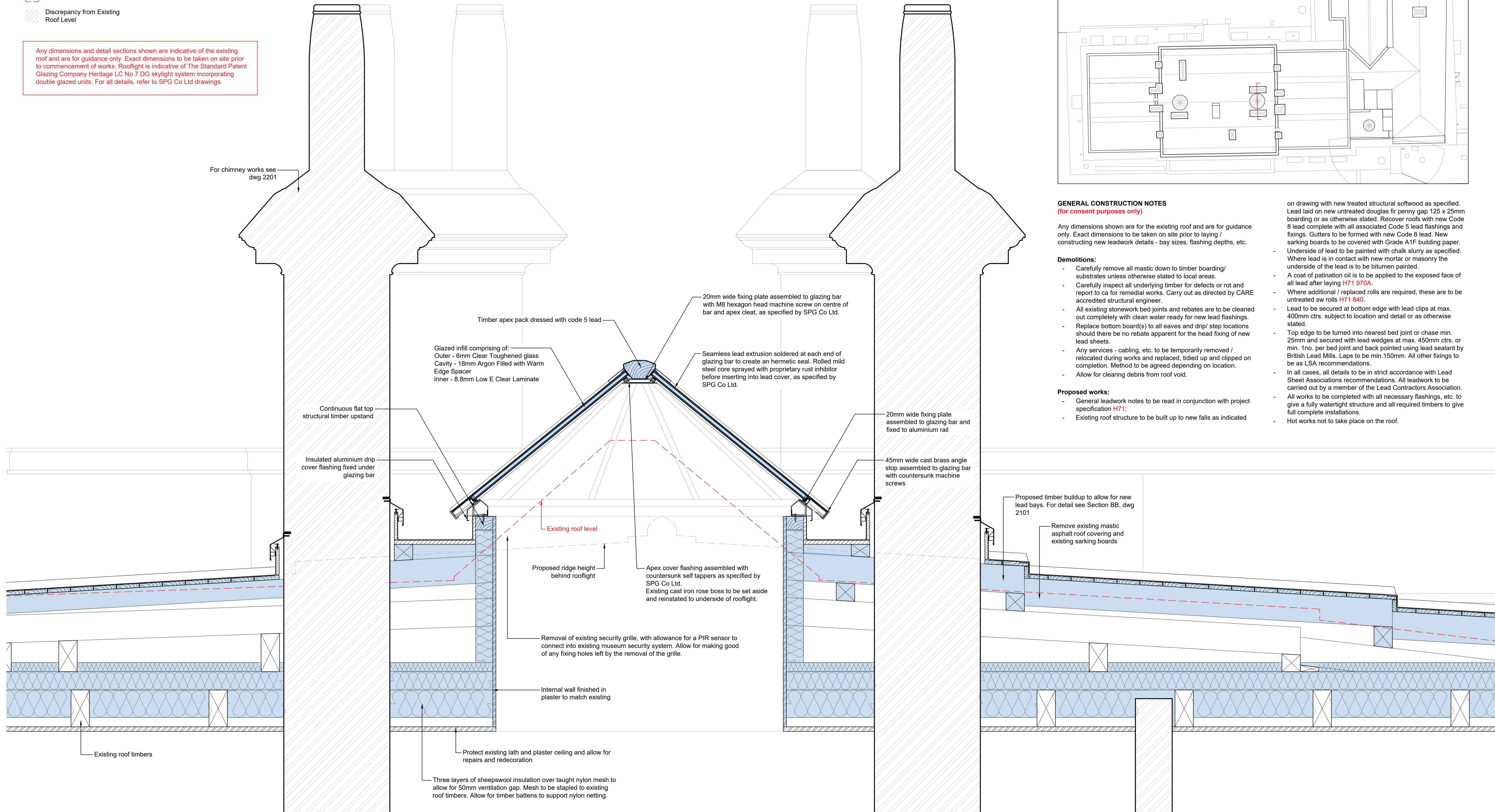

GENERAL CONSTRUCTION NOTES
(for consent purposes only)

Any dimensions shown are for the existing roof and are for guidance only. Exact dimensions to be taken on site prior to laying / constructing new leadwork details - bay sizes, flashing depths, etc.

Demolitions:

- Carefully remove all mastic down to timber boarding/ substrates unless otherwise stated to local areas.
- Carefully inspect all underlying timber for defects or rot and report to ca for remedial works. Carry out as directed by CARE accredited structural engineer.
- All existing stonework bed joints and rebates are to be cleaned out completely with clean water ready for new lead flashings.
- Replace bottom board(s) to all eaves and drip/ step locations should there be no rebate apparent for the head fixing of new lead sheets.
- Any services - cabling, etc. to be temporarily removed / relocated during works and replaced, tidied up and clipped on completion. Method to be agreed depending on location.
- Allow for clearing debris from roof void.

Proposed works:

- General leadwork notes to be read in conjunction with project specification **H71:**
- Existing roof structure to be built up to new falls as indicated

- on drawing with new treated structural softwood as specified. Lead laid on new untreated douglas fir penny gap 125 x 25mm boarding or as otherwise stated. Recover roofs with new Code 8 lead complete with all associated Code 5 lead flashings and fixings. Gutters to be formed with new Code 8 lead. New sarking boards to be covered with Grade A1F building paper.
- Underside of lead to be painted with chalk slurry as specified. Where lead is in contact with new mortar or masonry the underside of the lead is to be bitumen painted.
- A coat of palmation oil is to be applied to the exposed face of all lead after laying **H71 970A.**
- Where additional / replaced rolls are required, these are to be untreated sw rolls **H71 840.**
- Lead to be secured at bottom edge with lead clips at max. 400mm ctrs. subject to location and detail or as otherwise stated.
- Top edge to be turned into nearest bed joint or chase min. 25mm and secured with lead wedges at max. 450mm ctrs. or min. 1no. per bed joint and back pointed using lead sealant by British Lead Mills. Laps to be min.150mm. All other fixings to be as LSA recommendations.
- In all cases, all details to be in strict accordance with Lead Sheet Associations recommendations. All leadwork to be carried out by a member of the Lead Contractors Association.
- All works to be completed with all necessary flashings, etc. to give a fully watertight structure and all required timbers to give full complete installations.
- Hot works not to take place on the roof.

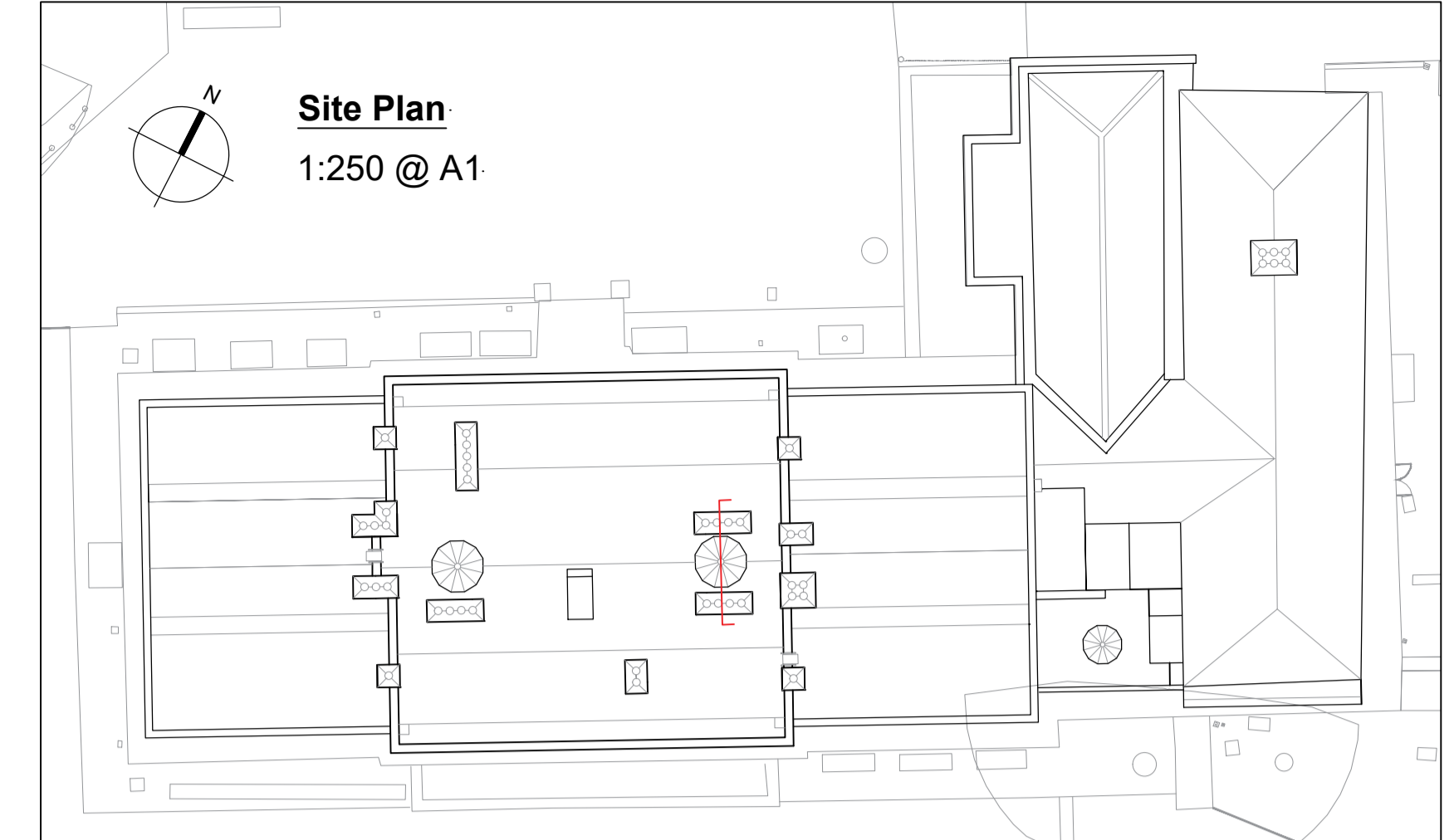

Stair Housing: Proposed Section
1:10 @ A1

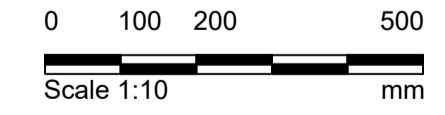

Notes

1. Any dwg format drawing is to be read in conjunction with and at the scale of the accompanying pdf.
2. Where colours other than black or grey are used, the drawing must be plotted in colour.
3. For status 'C' (Construction) drawings all dimensions are to be checked on site by the contractor, scaling is for Local Authority purposes only.
4. Unless otherwise indicated, all dimensions are in millimeters.
5. All information on this drawing is to be read in conjunction with the relevant Donald Insall Associates specification and trade contractors' drawings and information by specialists.
6. In the event of any discrepancy, please contact us immediately.
7. This drawing may contain survey information by others and is to be used solely for the purposes for which it was issued.
8. These are uncontrolled documents issued for information purposes only. If you have any queries regarding the drawings, please contact DIA immediately.
9. Please note DIA cannot be held responsible for any errors arising from changes made to an uncontrolled dwg file.

© 2019 DONALD INSALL ASSOCIATES LTD

Drawing Status

- F Feasibility
- S Sketch Design
- P Planning
- B Building Control
- D Developed Design
- M Measurement
- T Tender
- C Construction
- R Record

BARNSELEY
Metropolitan Borough Council

Supported using public funding by

Rev	Date	Dwn	Auth	Revision
2	27-10-23	JZG	DXE	Revised Issue
1	22-09-23	JZG	DXE	Planning Issue
0	26-08-22	DXE	DZP	Initial Issue

Donald Insall Associates
Chartered Architects and Historic Building Consultants

15 High Petergate
York YO1 7FJ
(+44) 01904 230 069
york@insall-architects.co.uk

Cannon Hall, Barnsley

Rooflights Proposed Section	Project YCH.02	No 2202	
	Scale (A1) 1:10	Status P	Revision 2