

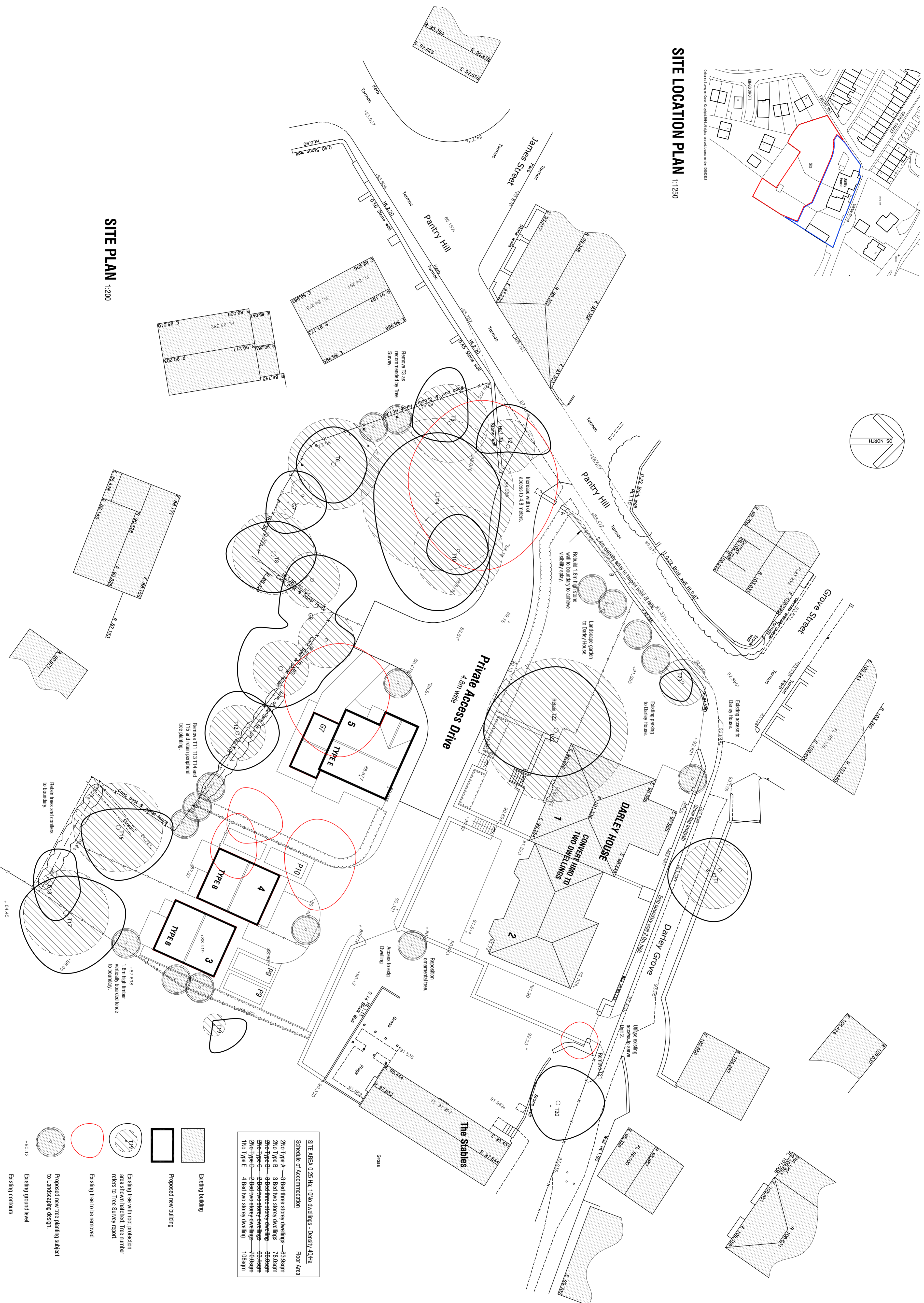

SITE LOCATION PLAN 1:1250

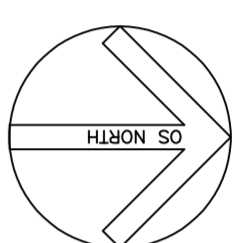

SITE PLAN 1:200

SITE AREA 0.25 Ha - 1000 dwellings - Density 40/Ha Schedule of Accommodation	Floor Area
2No-Type A - 3 Bed three-storey dwellings - 65-69sqm	1300sqm
2No-Type B - 3 Bed two-storey dwellings - 72.0sqm	1440sqm
2No-Type C1 - 3 Bed three-storey dwellings - 65-69sqm	1300sqm
2No-Type C2 - 2 Bed two-storey dwellings - 65-69sqm	1300sqm
4No-Type E - 4 Bed two-storey dwelling - 108sqm	432sqm
110 Type E	432sqm

- Existing building
- Proposed new building
- Existing tree with not protection area shown hatched. Tree number refers to Tree Survey report.
- Existing tree to be removed
- Proposed new tree planting subject to Landscaping design.
- Existing ground level
- Existing contours

RESIDENTIAL DEVELOPMENT
DARLEY HOUSE
PANTRY HILL
WORSBROUGH DALE
BARNSLEY

OUTLINE PROPOSALS
SITE PLAN

architectural design and building consultants

mbcoohdesign
 Fairfield House
 Barnsley S70 2ET
 T: 01228 286246
 M: 07881893000
 E: mcoohdesign@mbcoohdesign.com

Scale: AS SHOWN @ A1 Drawn: MJB
 Date: OCT 2017 Ref: 1620
 Dwg No: **P10** Rev: **J**

J19.09.2016 - Show position of T3 to be removed.
 H 31.07.2016 - Amend Planning Application red line site boundary.
 G 06.07.2016 - Further minor alterations for planning submission.
 F 04.07.2016 - Further minor alterations for planning submission.
 E 05.06.2016 - Redesign layout.
 Reduce numbers, retain protected trees, retain existing buildings at Darley House, amend access to re-define highways comments.
 D 26.04.16 - Redesign layout.
 C 1.8.07.2016 - Amend Location Plan to exclude Darley House buildings at Darley House, amend Schedule of accommodation.
 B 20.12.2017 - Amend survey, amend Schedule of accommodation.
 A 02.10.17 - Amend access, add trackings, amend design of Units 1 and 2.

Copyright © 2017 mbcoohdesign. All rights reserved. This document is confidential. Distribution for marketing and/or other purposes without the consent and in writing on the part of mbcoohdesign is prohibited.