

Notes
 Do not scale off drawing - refer to the tree data schedule for accurate crown spread measurements.
 Depictions of tree canopies are based on measurements taken to four cardinal compass points.
 No liability of any kind is accepted for any omissions or inaccuracies in respect of this plan.
 All rights reserved.

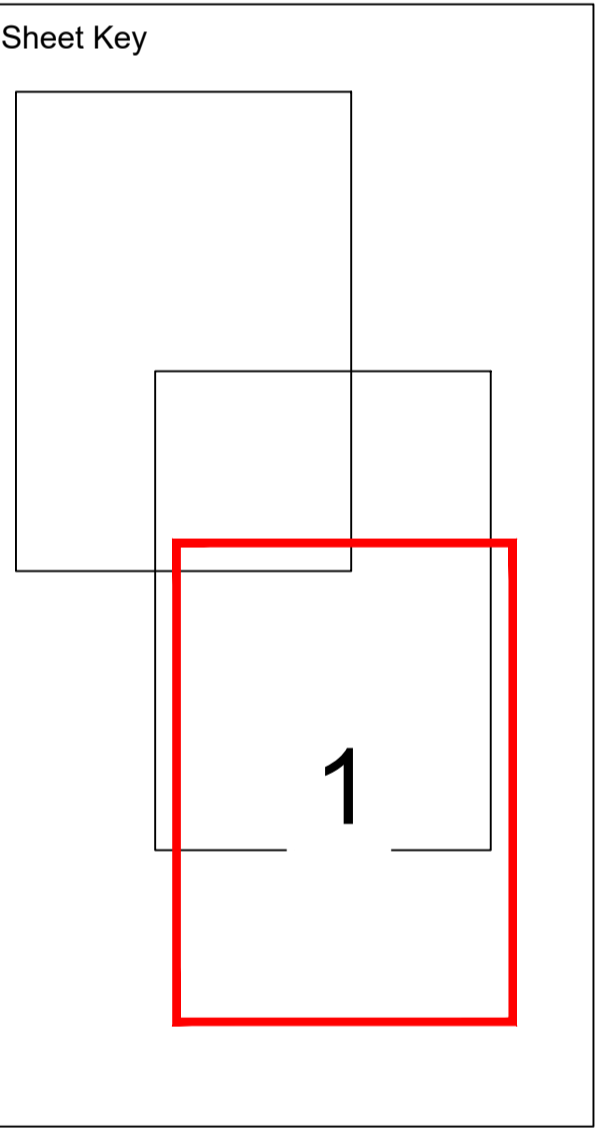
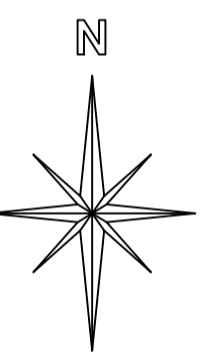
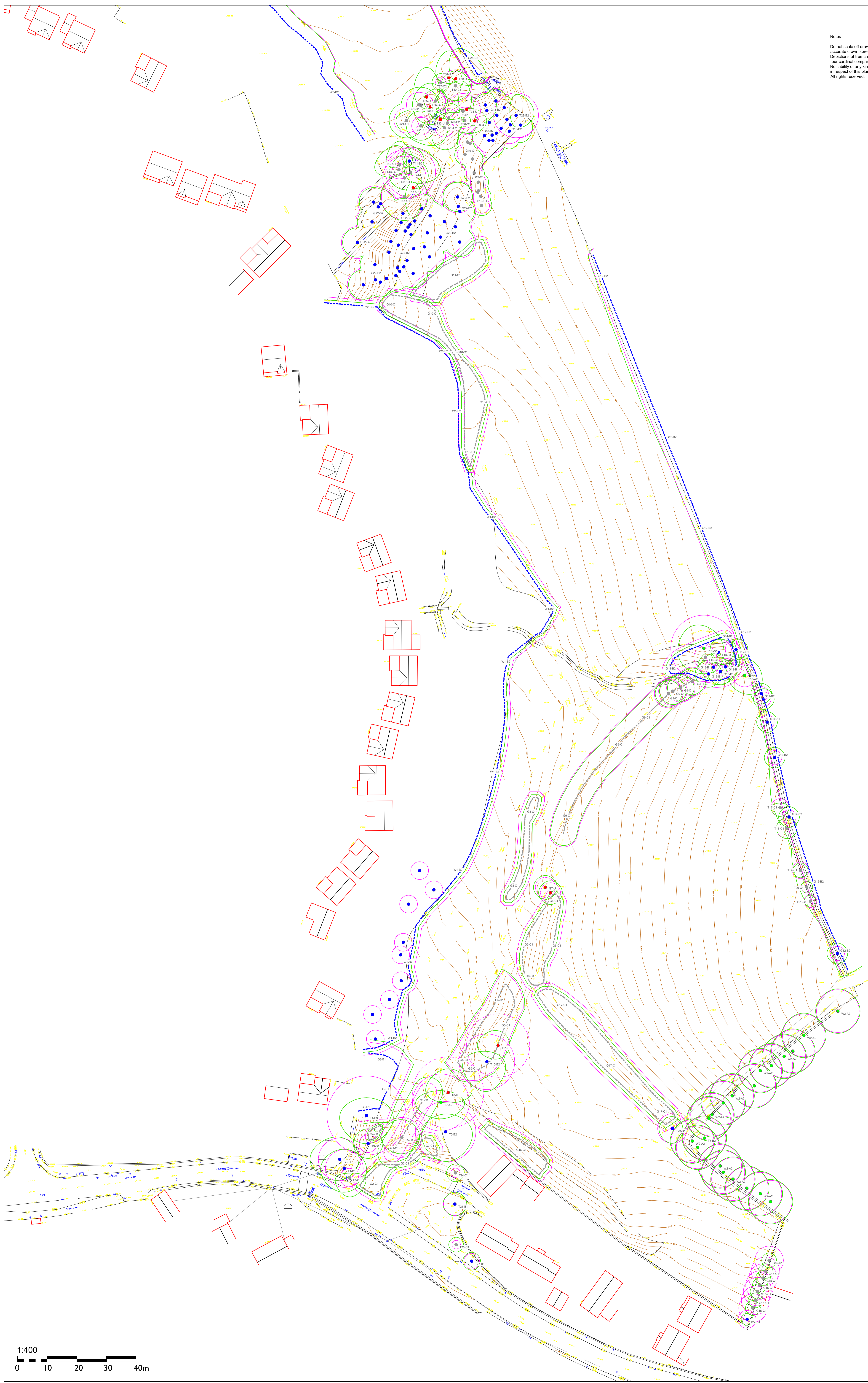
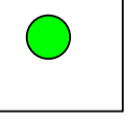
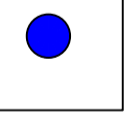
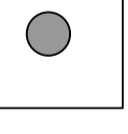
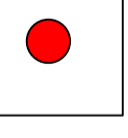
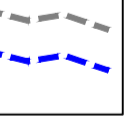
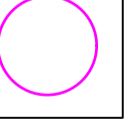
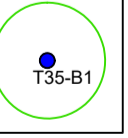

Tree Constraints Plan showing tree categories and root protection zones.

BS5837:2012 Tree Categories

- 
Category A
 Trees of high quality with an estimated remaining life expectancy of at least 40 years. Groups shown as hatched shapes.
- 
Category B
 Trees of moderate quality with an estimated remaining life expectancy of at least 20 years. Groups shown as hatched shapes.
- 
Category C
 Trees of low quality with an estimated remaining life expectancy of at least 10 years, or young trees with a stem diameter below 150 mm. Groups shown as hatched shapes.
- 
Category D
 Trees in such a condition that they cannot realistically be retained as being trees in the context of the current land use for longer than 10 years. Groups shown as hatched shapes.
- 
Tree groups
 Shown as dashed centre line. Colour represents category (see above).
- 
BS 5837:2012 Root Protection Area
- 
Tree
 Showing canopy extent, category colour and tag number (with category).

TreeGroup/Hedge numbering: G1-G3, W1-W2

QUANTS
 environmental

Quants Environmental Limited
 65 Kinkoy Road, Ripon, North Yorkshire HG4 2HR.
 Office: 01765 600799
 Email: info@quantsenvironmental.com
 Web: www.quantsenvironmental.com

Client: **Keepmoat**

Project: **Land off Keresforth Road, Dodworth**

Drawing Title: **Tree Constraints Plan -Sheet 1**

Scale: 1:400 A0	Date: Dec 2021	DS	JS	CB
Drawing Number: 153.01b	Rev: 1			