

- Key
- 1 Standard scaffold poles
 - 2 Heavy gauge 2 m tall galvanized tube and welded mesh infill panels
 - 3 Panels secured to uprights and cross-members with wire ties
 - 4 Ground level
 - 5 Uprights driven into the ground until secure (minimum depth 0.6 m)
 - 6 Standard scaffold clamps

BS5837:2012 Figure 2

NO	TPO ref	TREE SPECIES Common Name	TREE SPECIES Scientific Name	HEIGHT m	SPREAD m	Clear stem (m)	DIA mm	N	CAT.	Life Stage	Life exp yrs	NOTES	RECOMMENDATIONS
T1	5/T1	Copper Beech	Fagus sylvatica f. purpurea	15	20	1.5	800		A2	Mature	40+	Wire through canopy, ivy at base, inos culation at 3m	
T2		Ash	Fraxinus excelsior	10	5	5	150		C2	Young	40+	Suppressed, lean south west	Fell
T3		Ash	Fraxinus excelsior	8	6	3	250		C2	Young	40+	Suppressed, severe lean south west	Fell
T4		Hawthorn	Crataegus monogyna	9	5	1	150		C2	Young	40+	Suppressed	
T5		Ash	Fraxinus excelsior	8	5	4	120		C2	Young	40+	Suppressed	
T6		Ash	Fraxinus excelsior	8	4	3	400		C2	Young	40+	Suppressed	Fell
T7		Ash	Fraxinus excelsior	10	5	250		N	C2	Young	40+	Suppressed, multistem, wire in canopy	Fell
T8		Hawthorn	Crataegus monogyna	7	4	120		N	C2	Young	40+	Suppressed, multistem	
T9		Hawthorn	Crataegus monogyna	8	5	275		N	C2	Early-Mature	40+	Suppressed, multistem	
T10		Holly	Ilex aquifolium	7	5	75			C2	Young	40+	Suppressed, approx 5 no. Lean	Fell
T11				7	5	250			U	Early-Mature	0	Dead	Fell
G12		Leyland cypress	Cupressus x leylandii	9	5	300			C2	Semi-Mature	40+	20 no. Approx, at 1m spacing	Fell
T13		Cherry	Prunus sp.	12	5	300			C2	Semi-Mature	40+	Suppressed	Clear to 1.5m
T14		Apple	Malus domestica	3.5	4	1	120		C2	Early-Mature	20+	Suppressed	
T15		Ash	Fraxinus excelsior	8	4	2	150		C2	Young	40+		Fell
T16		Laurel	Laurus nobilis	6	5	220		N	C2	Semi-Mature	20+	Multistem	Fell
T17		Cherry	Prunus sp.	4	3	75			C2	Young	40+		Fell
T18		Yellow Cypress	Cupressus nootkatensis	7	4	200			C2	Early-Mature	40+		Fell
T19		Ornamental		6	4	150			C2	Semi-Mature	20+	Multistem, lean south west	Fell

OFF-SITE TREES	TPO ref	TREE SPECIES Common Name	TREE SPECIES Scientific Name	HEIGHT m	SPREAD m	Clear stem (m)	DIA mm	N	CAT.	Life Stage	Life exp yrs	NOTES	RECOMMENDATIONS
OSA		Fir	Abies procera	9	4	1	220		C2	Semi-Mature	20+		
OSB		Apple	Malus domestica	2.5	1	200		N	C2	Semi-Mature		Multistem, cut back	
OSC		Hawthorn	Crataegus monogyna	8	5	2	200		C2	Semi-Mature			
GOSD		Ash	Fraxinus excelsior	8	4	120			C2	Young		Approx 10 no.	
OSE		Hawthorn	Crataegus monogyna	7	3	150			C2	Young		Multistem	
OSF		English Elm	Ulmus minor var. vulgaris	13	9	400		N	U	Semi-Mature	0	DEAD, Twin stem at base, Dutch Elm Disease (peeling bark, coral spot)	Recommend Fell by landowner
OSG		Golden Chain Tree	Laburnum	7	4	150		N	C2	Young	20+	Multistem	
OSH		Ginkgo	Ginkgo biloba 'Fastigiata'	14	4	2	300		B2	Semi-Mature	40+	Ivy	
OSI		Ash	Fraxinus excelsior	4	4	100			C2	Young		Supressed	

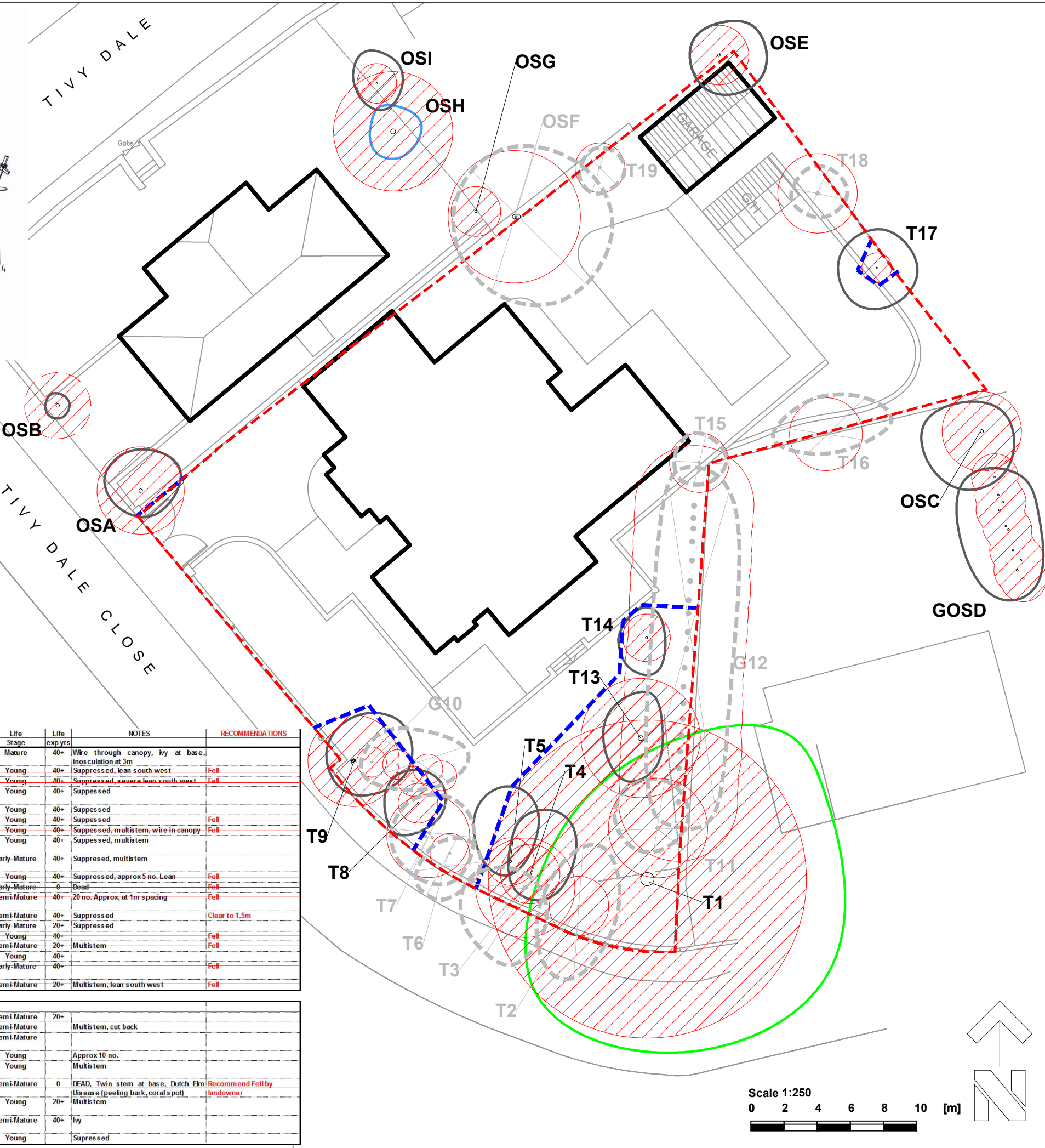

TREE SURVEY TO BS5837:2012

KEY COLOUR	QUALITY	DESCRIPTION
GREEN	A: HIGH retention most desirable	Vigorous healthy good form, visually important, historic or rare
BLUE	B: MODERATE retention desirable	Slightly impaired condition, numerous immature, 'A' potential
GREY	C: LOW could be retained	Adequate condition requiring minimal surgery
RED	U: FELL Unsuitable for retention	Dead dying, dangerous insecure rooting, significant fungal disease
GREEN	SHRUBS	

SUB-CATEGORY:

- 1 ARBORICULTURAL
- 2 LANDSCAPE
- 3 CULTURAL/CONSERVATION

--- Site Boundary

In accordance with BS5837:2012 'Trees in relation to design, demolition and construction', offsite trees within a distance equal to 12x stem diameter from boundary should be surveyed. In accordance with good working practice, all trees within 12m of the site boundary have been surveyed.

The original of this drawing is produced in colour - a monochrome copy should not be relied upon.

LIMITATION OF THIS SURVEY
This survey records amenity quality and desirability of tree retention in relation to proposed construction by visual inspection from ground level where accessible.

It does not constitute a Tree Inspection or detailed report on condition.

Tree heights and spread approximate. The diameter of single stem trees is taken at 1.5m above ground level. For the diameter of multistemmed trees, each multistem is measured at 1.5m above ground level and calculated to give a notional diameter as if all multistems were fused into one stem.

The branch spread is an accurate representation of the crown as clause 4.4.2.5 (e)

Tree inspections should take place annually in September/October when trees are in leaf.

Tree positions are based on topographic survey drawing number CODA/309/SP, by HH Surveys Ltd, dated SEPT 2017

TREE CONSTRAINTS

- ROOT PROTECTION AREA (RPA)**
Root Protection Areas have been calculated on the following basis:
Single stems: Area equivalent to circle of radius 12 x (& Notional) stem diameter at 1.5m
Multistems: Area equivalent to circle of radius 10 x diameter at ground level.
- Root Protection Areas shaped due to obstruction to root spread e.g. retaining wall, water course.
- RPA of pollarded or topped trees has been reduced to an area appropriate to actual canopy spread.

TREE PROTECTION

- TREES TO BE REMOVED** (with root protection area)
- Scaffold Protective Fence as BS5837:2012 Figure 2

Weddle Landscape Design
LANDSCAPE ARCHITECTURE
ENVIRONMENTAL PLANNING
Mews Studio, Charnwood House, Tel (0114) 250 1181
8 Kenwood Bank, Sheffield S7 1NU Fax (0114) 250 1188
www.weddles.co.uk mail@weddles.co.uk

Job TIVY DALE CLOSE, BARNSELY

Title **TREE PROTECTION PLAN**

scale@A3	drawn	date	job number	number	revision
1:250	CB	DEC 18	887	TDC 03	-

