

**SCOPE OF WORKS**

- Existing external ATM (01) to be replaced with new ATM, through the same centre line as existing. Existing aperture to be altered to suit new clearance requirements. Collar added to ATM neck to project ATM face past cill, to improve wheel chair accessibility.
- External ATM (02) to be removed and exposed aperture in-filled to match the current wall build up and made good. External stone cill re-instated to match.
- Glazing to be replaced to full extent following removal / replacement with black film applied to match existing.
- New illuminated ATM marketing installed.
- New external CCTV dome camera installed to right hand side of ATM. Refer to elevation for location.

**LEGEND**

SELF SERVICE MACHINE/ EQUIPMENT/FURNITURE BEING INSTALLED

AREA OF REQUIRED ADJUSTMENT (EXISTING / PROPOSED)

EXISTING STRUCTURE

**MARKETING ITEMS (EXTERNAL)**

ILLUMINATED EXTERNAL BUTTON  
CASH - ATM

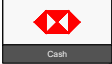
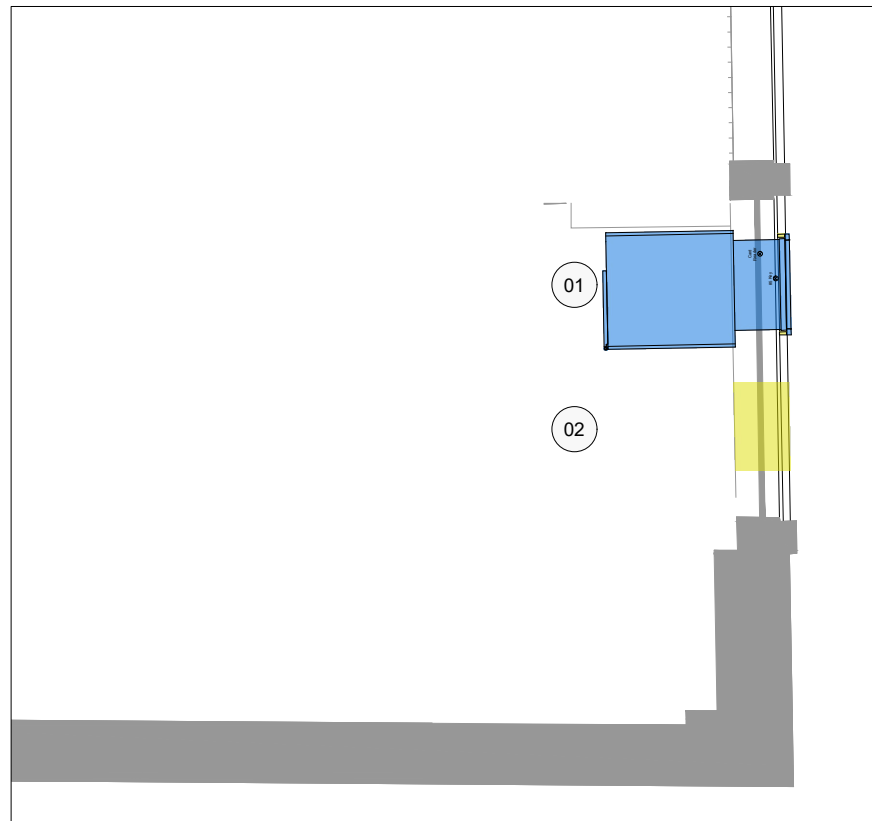
**PROPOSED PLAN DETAIL**  
SCALE 1:20 @A1

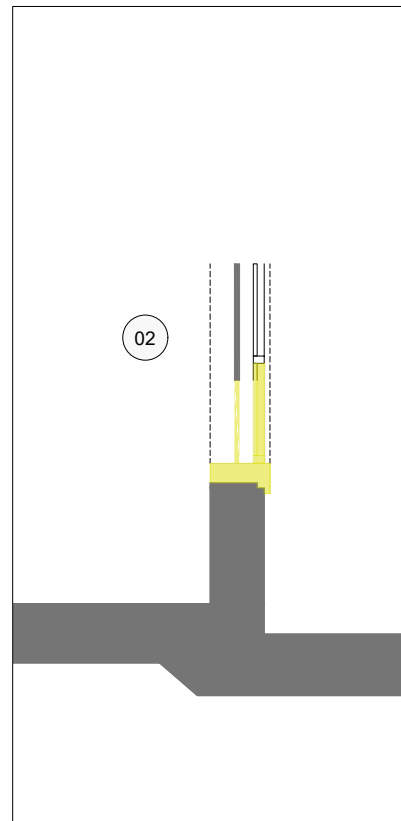

**PROPOSED ATM SECTION**  
SCALE 1:20 @A1

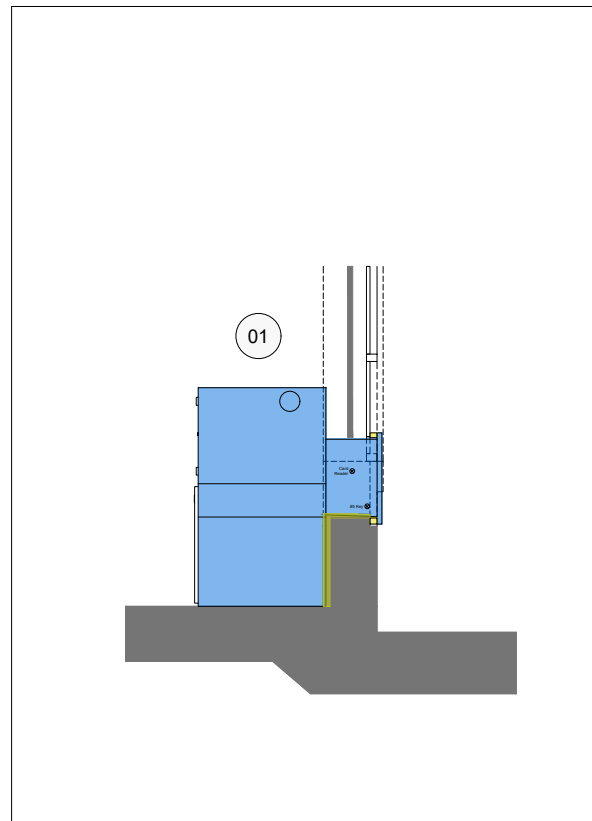

**PROPOSED ATM SECTION**  
SCALE 1:20 @A1



**PROPOSED ATM ELEVATION**  
SCALE 1:20 @A1

Notes:	Rev	Date	Notes	Rev	Date	Notes
Copyright of this drawing is reserved by AXIS Architecture and issued on the condition that it is not copied, reproduced or disclosed to any third party either wholly or in part without the consent in writing of AXIS Architecture.						
			<p><b>RESIDUAL RISK</b></p> <p>Wherever possible unnecessary risk is designed out of these proposals. Where residual risk remains this is assessed and identified on the relevant drawings with this symbol. Refer to the note and the relevant measures in the Health + Safety documentation</p>			

Client Corporate Real Estate	Project Barnsley	Title Proposed Plans, Elevations & Sections			
Status <b>PLANNING DRAWING</b>	Scale A1 1:25 A3 1:50	Date 26/10/22	Drawn JCC	Checked RAS	Job No. 27637-004-PR03-PL1
AXIS Architecture and Design Ltd, Talbot Chambers, 2-6 North Church Street, Sheffield, S1 2DH.		tel: +44(0)114 2490944 fax: +44(0)114 2490966 www.axis-architecture.com designed@axis-architecture.com		