

TYPICAL SECTION THROUGH ACCESS ROADS - TYPE 4

CBR%	CAPPING (mm)		+	SUB-BASE (mm)	
	Type 4 road	Type 5b road		Type 4 road	Type 5b road
Less than 2	310	410	+	440	340
2	-	-	+	440	340
3	-	-	+	440	340
4	-	-	+	440	340
5-15	-	-	+	440	340
More than 15	-	-	+	440	340

* Material within 450mm of the finished road surface must not be frost susceptible.
CBR to be retested on top of any capping layer. Minimum value to be >10% before sub base is placed.

PAVEMENT FOUNDATION DESIGN

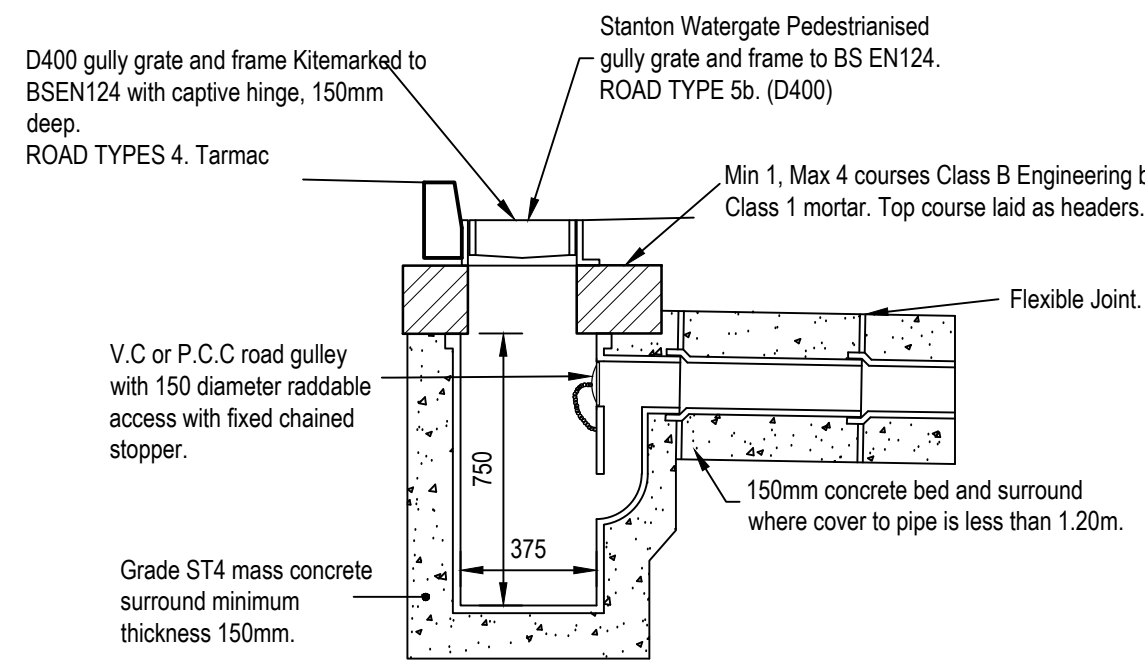

TYPICAL GULLY DETAIL
SCALE 1:25

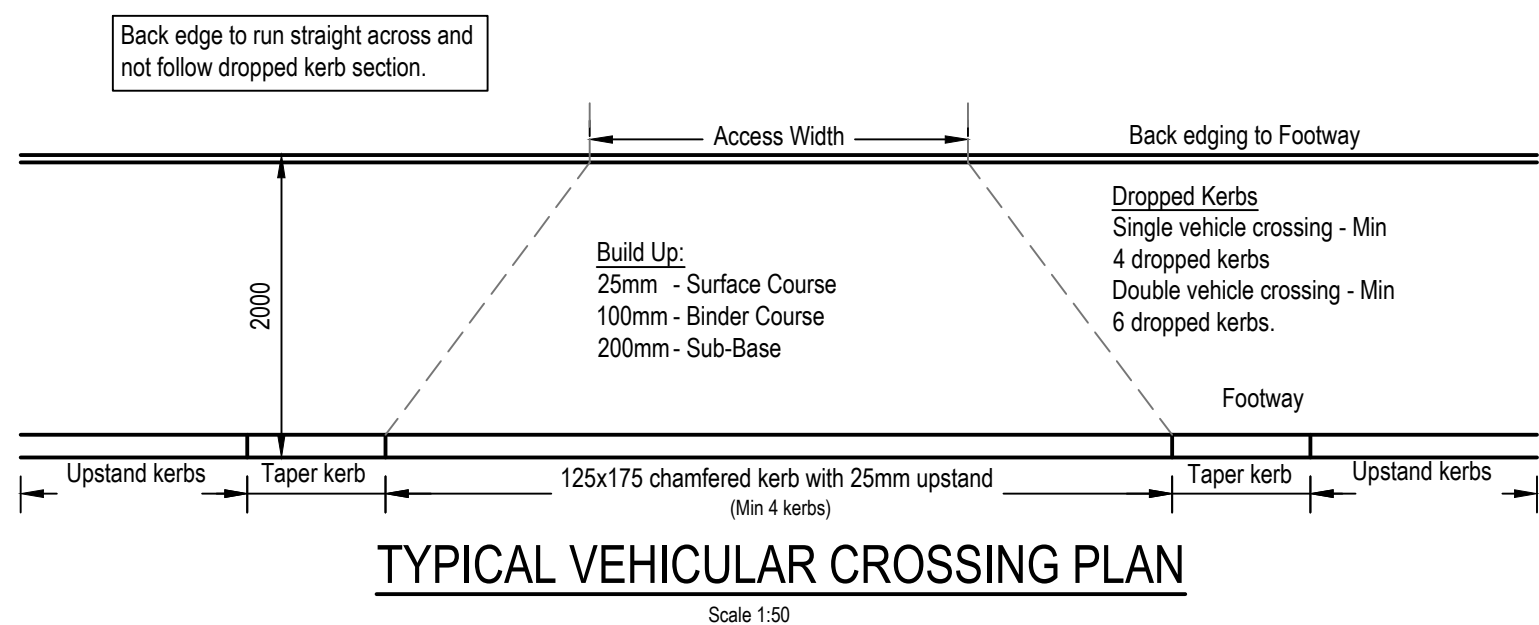

TYPICAL VEHICULAR CROSSING PLAN
Scale 1:50

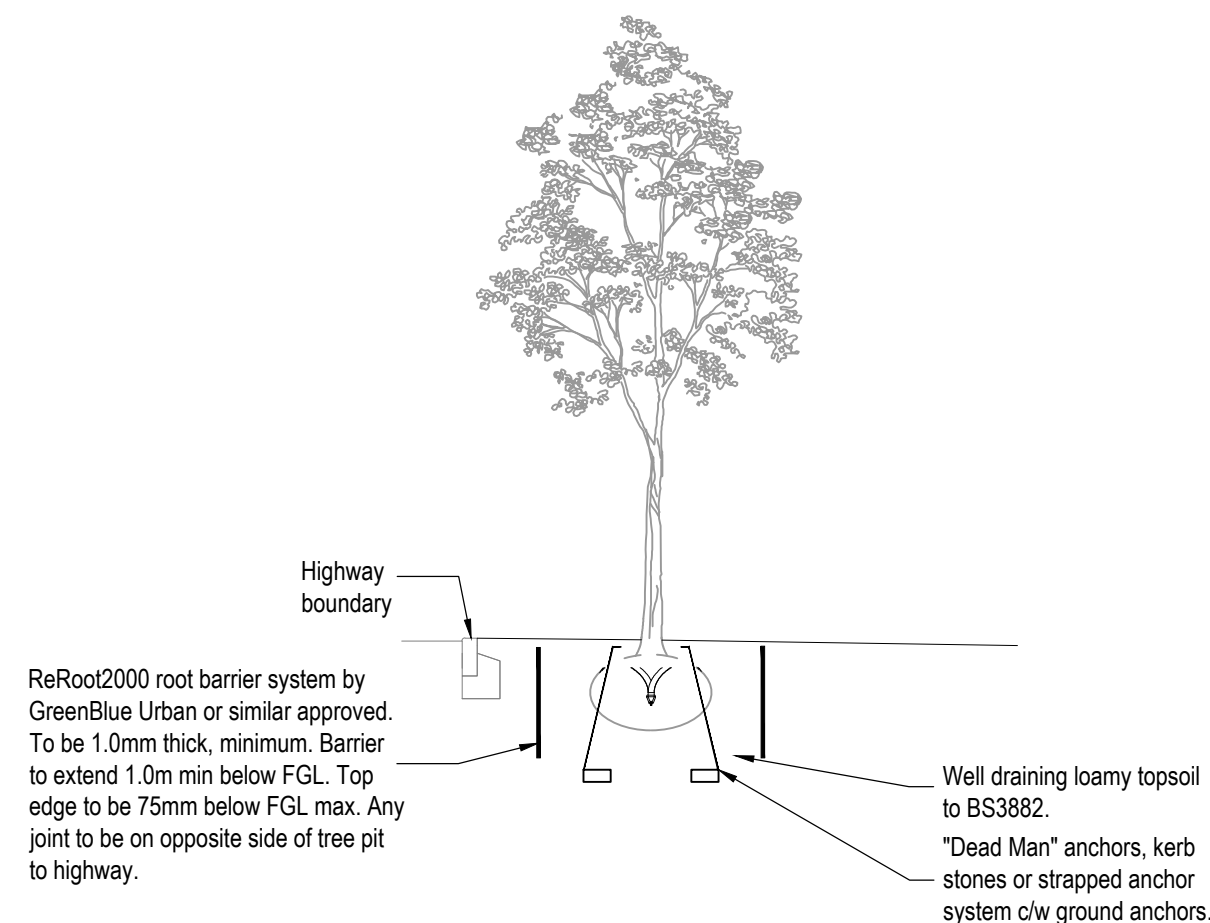

TREE ROOT BARRIER DETAIL
(REQUIRED WHERE TREE IS LOCATED WITHIN 3.0m OF ADOPTABLE HIGHWAY)
Scale 1:50.

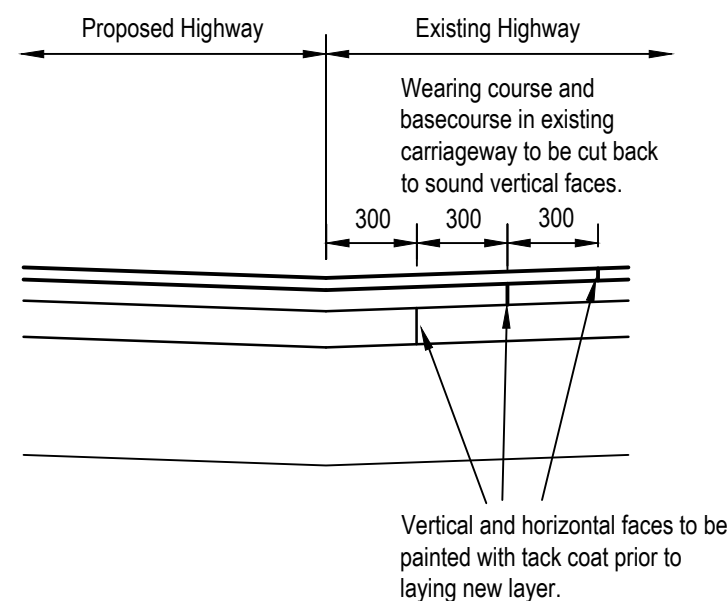

INTERFACE WITH EXISTING HIGHWAY

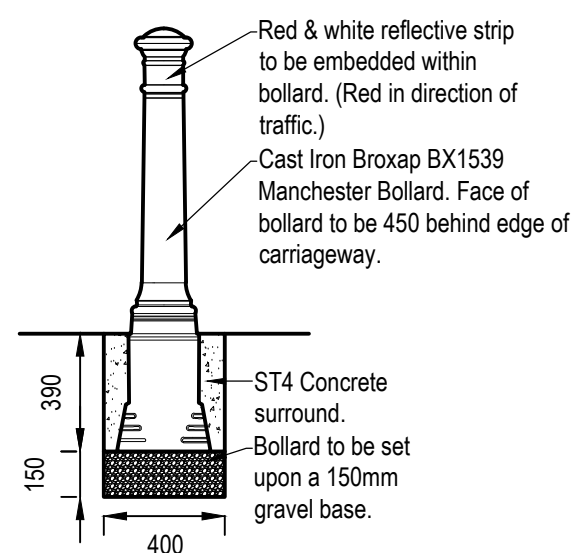

TYPICAL DETAIL THROUGH BOLLARD
SCALE 1:25

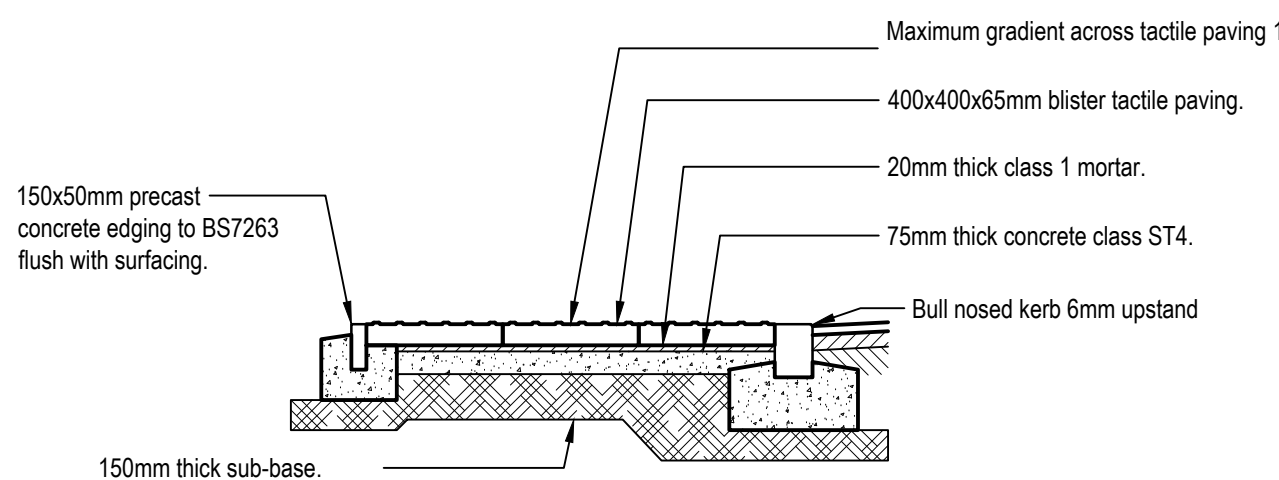

TYPICAL DETAIL THROUGH TACTILE PAVING
Scale 1:20

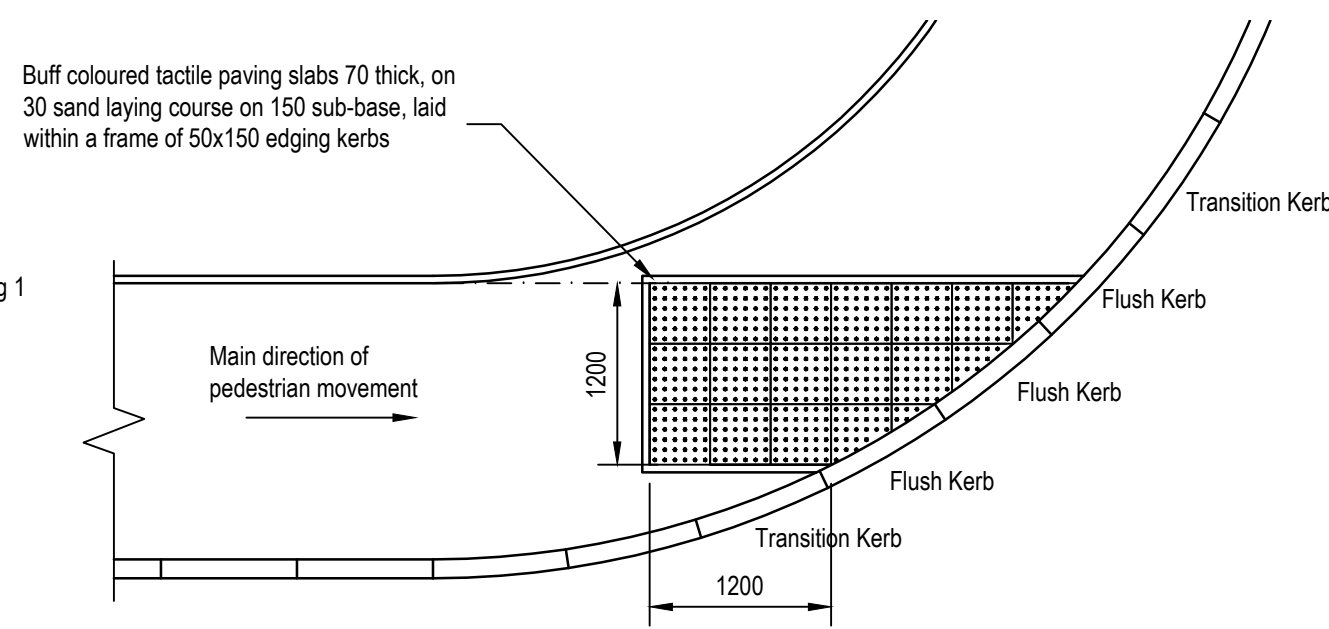

TYPICAL PEDESTRIAN CROSSING DETAILS.
Scale 1:50.

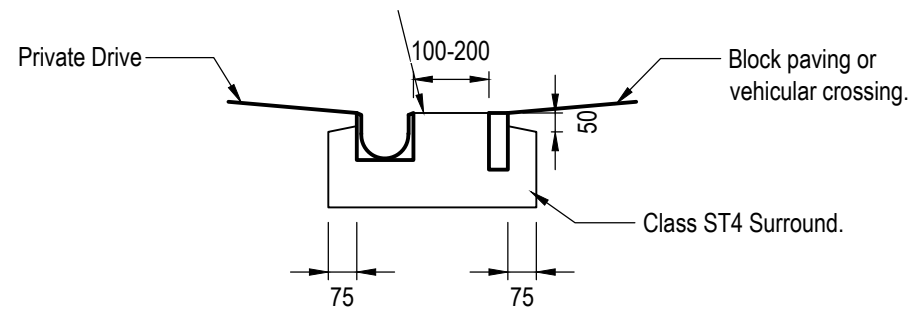

ACO CHANNEL BACKING
Scale 1:20

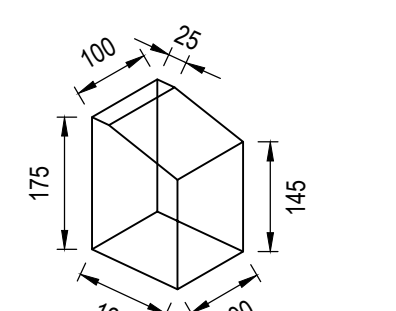

DETAILS OF PLASMOBILITY KERB
Scale 1:10

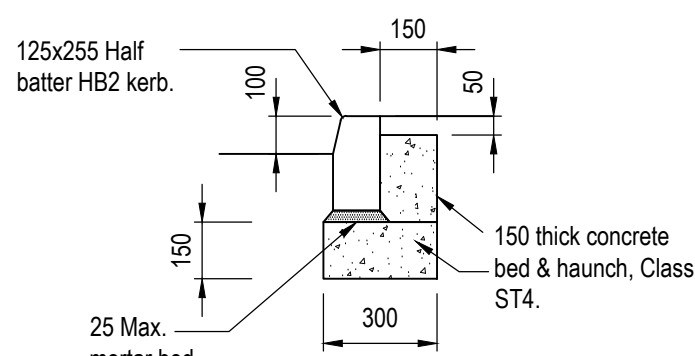

TYPICAL HB2 KERB DETAIL
Scale 1:20

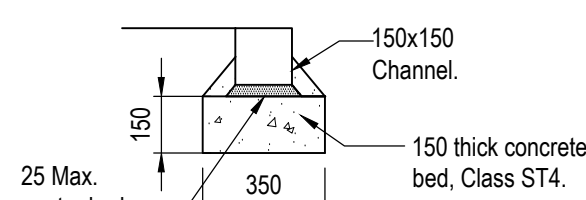

TYPICAL CHANNEL BLOCK DETAIL
Scale 1:20

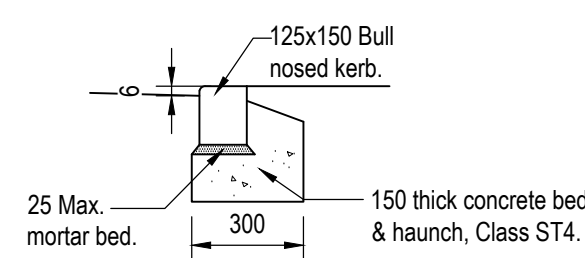

TYPICAL BULL NOSED KERB DETAIL
Scale 1:20

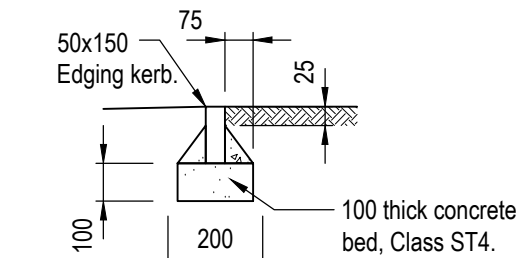

TYPICAL FOOTPATH EDGING KERB DETAIL
Scale 1:20

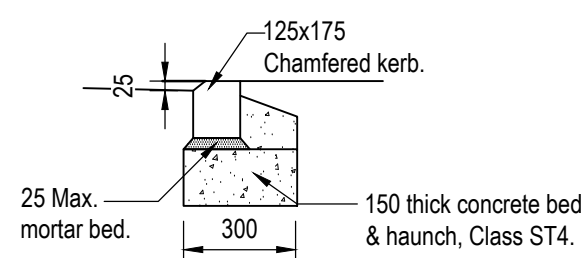

TYPICAL CHAMFERED KERB DETAIL
Scale 1:20

1. ROAD SPECIFICATION - TYPE 4

SURFACE COURSE
30mm of 0/10mm CG Surface Course 125 Pen H/Stone to BS 4987-1:Clause 7.4.

BINDER COURSE
50mm of 0/20mm DBM 125 Pen Binder Course H/Stone to BS 4987-1:Clause 6.5.

BASE (ROADBASE)
90mm of 0/32mm DBM 125 Pen Base L/Stone to BS 4987-1:Clause 5.2.

SUB-BASE
440mm of Type 1 stone Sub-Base. Highway Works Clause 803. Must be free from extraneous matter. Weeds must be removed and the sub-grade sprayed with total weedkiller.

2. FOOTPATH SPECIFICATION

SURFACE COURSE
25mm thick - 6mm size dbm surface course complying with South Yorkshire Lab. Spec. No 34 and BS 4987.

BINDER COURSE
100mm thick - 20mm size DBM binder course complying with South Yorkshire Lab. Spec. No 31 and BS 4987.

SUB-BASE
200mm thick - type 1 granular sub-base to South Yorkshire Lab. Spec. No 19. Must be free from extraneous matter. Weeds must be removed and the sub-grade sprayed with total weedkiller.

3. GENERAL NOTES

The formation, whether in cut or fill, shall be prepared, profiled and THOROUGHLY COMPACTED as required by clauses 612 and 616 of the DOT Specification for Highway Works.

Over excavation below road formation is to be backfilled with Type 1 granular sub-base material, well compacted in layers not exceeding 225mm.

Blast furnace slag and limestone aggregate are not allowed in the carriageway binder course unless it is to be covered within 6 weeks.

P01	First Issue.	RJ	CH	09.03.23
REV	DESCRIPTION	SIG	CHK	DATE

DUCHY HOMES

DARTON LANE

HIGHWAY CONSTRUCTION DETAILS

Eastwood
CONSULTING ENGINEERS

St Andrew's House
23 Kingfield Road
Sheffield, S11 9AS

T: 0114 255 4554
E: mail@eastwoodce.com
eastwoodce.com

ECE PROJECT No	SCALE AT A1	STATUS	SUITABLE FOR
47509	1:250	S0	Initial
DRAWING NUMBER			
47509 - ECE - XX - XX - DR - C - 0013	P01		
Project	Originator	Zone	Level
	Type	Role	Number