

Williams Saunders is the trading name of Wm Saunders Partnership LLP. Wm Saunders Partnership Limited Liability Partnership is registered in England and Wales with the Registration number OC 30822. The Registered Office is Sheppard Lockton House, Cafferata Way, Newark on Trent, Notts, NG24 2JN.

This drawing & any design thereon is the copyright of Wm Saunders Partnership LLP and must not be reproduced without their written consent.

Contractors must verify all dimensions, levels and co-ordinates of the site before commencing any work or making any shop drawings: no dimensions to be taken from drawing.

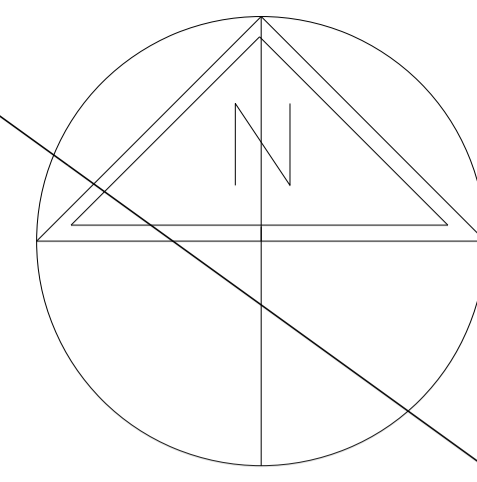

This drawing is subject to Building Regulations Approval.

Car parking bays to be generally 5.0m long x 2.5m wide.  
Disabled bays to incl. 1.2m aisle as shown and pictogram/signage.

DK indicates dropped kerbing. Exact extent of all kerbing to be agreed with the Employer.

indicates below ground water point, with flip top lid.

indicates lighting column, with light direction.

2.4m high green paladin fencing, and gates where indicated.

2.4m high galv. steel palisade fencing.

Note. Fencing and gates are not to be fixed directly to the new buildings. Post to be installed adj. the building.

Note. Contours and associated features taken from topographical survey by Ramouski Clarke Ltd, dwg. no. 2701-01-a.

Unit	Gross Internal Area.		Office Area.	
	Area Sq.m	Area Sq.Ft	Area Sq.m	Area Sq.Ft
1A	326	3,500	-	-
1B	326	3,500	-	-
2A	279	3,000	-	-
2B	279	3,000	-	-
2C	279	3,000	-	-
2D	279	3,000	-	-
2E	279	3,000	-	-
2F	279	3,000	-	-
3A	583	6,275	124.43	1339.36
3B	372	4,000	-	-
4	792	8,500	96.96	1043.68
5	976	10,500	121.06	1303.10
6	931	10,000	115.76	1246.05
7	558	6,000	109.60	1179.74
8	372	4,000	-	-
<b>Total</b>	<b>6,910</b>	<b>74,275</b>	<b>567.81</b>	<b>6,111.93</b>

**Total Floor Area - 6,910 + 567.81 = 7,477.81sq.m (80,491.15 sq.ft)**

119 Parking bays incl. 8 disabled.

Rev	Description	Drm	Vf'd	Date
K	Pond added to northern plot.	SW	SW	12/17
J	Minor amendment & status updated.	SW	SW	11/17
H	Access into north site removed. New access between plots added. Unit 3 reduced & unit 8 added. Entrance to top plot and fencing amended.	IR	SW	10/17
G	Floor Plans. Fencing and paving updated. signage added.	IR	SW	07/17
F	Bin Store 3D View added.	IR	SW	06/17
E	Top plot entrance amended.	IR	SW	06/17
D	Lighting columns and waterpoints added.	SW	NAC	05/17
C	Floor plans updated, parking, bin stores and cycles amended.	IR	SW	05/17
B	Floor plans added.	IR	SW	04/17
A	Issued for information	IR	NAC	04/17

As outlined in section 2.3 of the CIB Industry Guidance to Designers, insignificant risks can usually be ignored, as can risks arising from routine construction activities, unless the design compounds or significantly alters these risks. In accordance with CDM Regulations 8, 9 and 11, any significant risks relating to the design features shown on this drawing have been identified and are annotated thus:

- No significant risks have been identified.
- Significant risks have been identified - refer to notes on drawing for information on residual risks and any control measures to be employed.

Refer to the current Designer's Risk Assessment sheets for further details.  
Designer's Signature: SW Date: 04/17

Drawing Status: **PLANNING**

**williamsaunders**  
architecture: engineering: building consultancy  
Sheppard Lockton House Tel: 01636 704361  
Cafferata Way Fax: 01636 702809  
Newark-on-Trent W: wms-saunders.co.uk  
Nottinghamshire, NG24 2JN  
Also at Leeds, Cardiff, Wlirsworth

Project  
**Proposed Development, Capitol Park, Barnsley.**

Client  
**Carnell Management Services Ltd.**

Title  
**Proposed Site Plan.**

Drawn	Date	Scale	@ A1
IR	April 2017	1:500	
Discipline	Project Number	Drawing Number	Revision
Arch	11548	(D)01	K

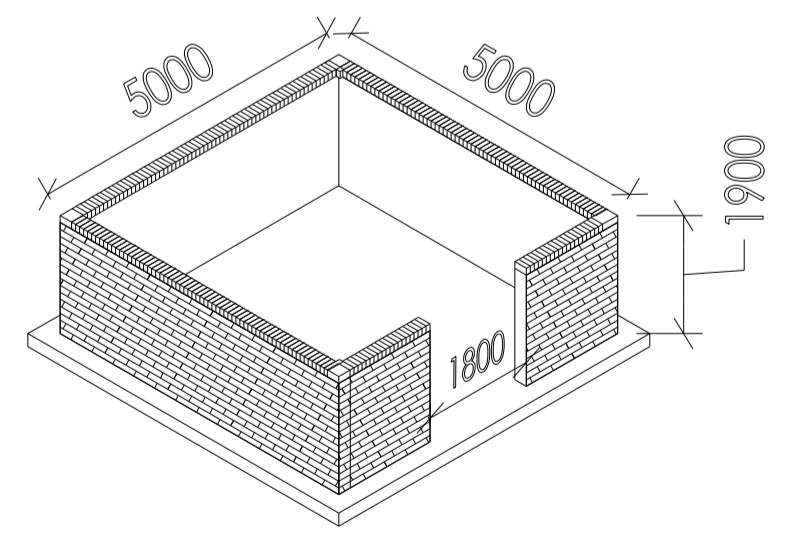
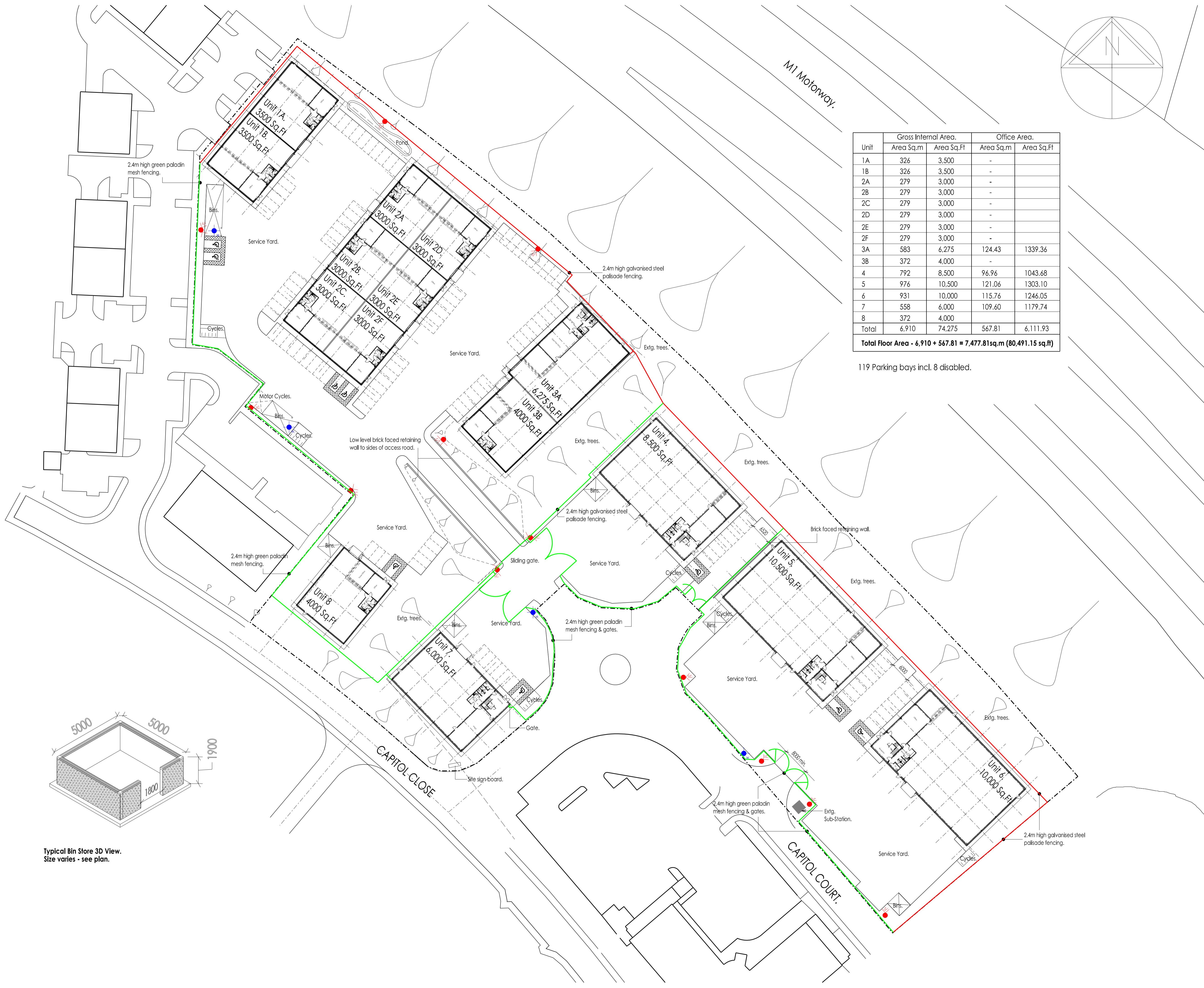

Typical Bin Store 3D View.  
Size varies - see plan.