

SITE LOCATION

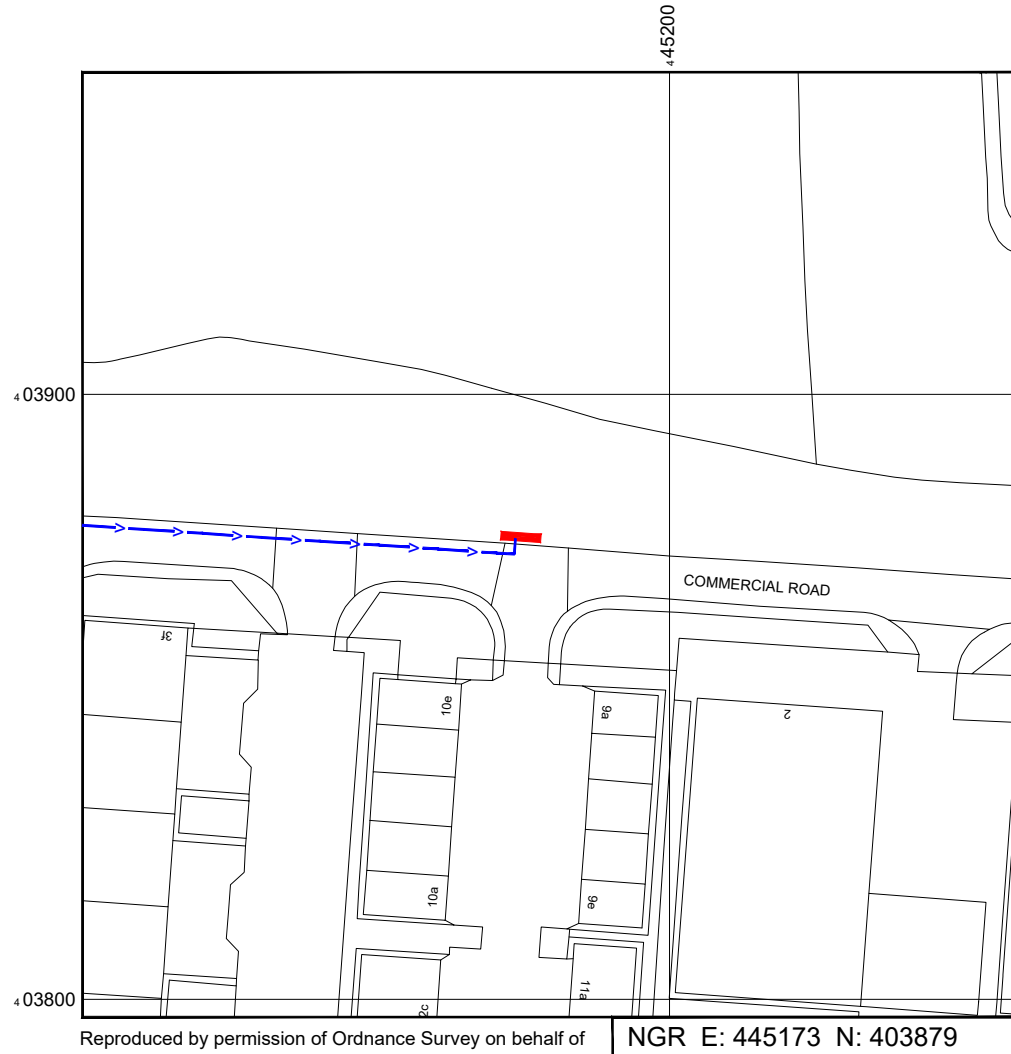

Reproduced by permission of Ordnance Survey on behalf of the Controller of Her Majesty's Stationary Office
All rights reserved. © Crown Copyright licence no. 100062043



Reproduced by permission of Ordnance Survey on behalf of the Controller of Her Majesty's Stationary Office
All rights reserved. © Crown Copyright licence no. 100062043

NGR E: 445173 N: 403879

SITE AREA PLAN

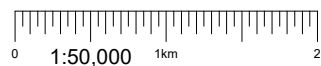

SITE LOCATION PLAN

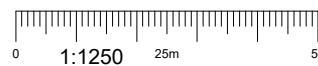

SITE PHOTOGRAPH



GOOGLE MAPS QR CODE

GOOGLE MAPS - <https://goo.gl/maps/fTweiUFyxSLahkzw7>

GOOGLE STREETVIEW - <https://goo.gl/maps/AF9TELTFSq9VovzeA>

NOTES:

1. ALL DIMENSIONS IN MM UNLESS OTHERWISE NOTED.

DIRECTIONS TO SITE:

Head north-west on A1(M). At junction 37, take the A635 exit. At the roundabout, take the 1st exit onto Barnsley Rd/A635. At Fields End Roundabout, take the 2nd exit and stay on A635. At the roundabout, take the 2nd exit onto Dudley Dr. Turn left to stay on Dudley Dr. Continue onto Commercial Rd. Follow Commercial Road and site location is on the left hand side.

Site Provider's Property Boundary:



Access Route To Site:



Access Route:



Master: M003	MBNL / EE: MBNL	Project: 3UK DNSW	Purpose of Issue: Planning	Issue: C
Date: 26/06/2023	Revision / Upgrade Description: Pole location amended			
Drawn: CDN				
Checked: DH				
Approved: SD				
Master: M002	MBNL / EE: MBNL	Project: 3UK DNSW	Purpose of Issue: Planning	Issue: B
Date: 24/04/2023	Revision / Upgrade Description: Pole location amended			
Drawn: CDN				
Checked: DH				
Approved: SD				
Master: M001	MBNL / EE: MBNL	Project: 3UK DNSW	Purpose of Issue: Planning	Issue: A
Date: 03/04/2023	Revision / Upgrade Description: First Issue - Site nomination dated: TBC			
Drawn: CDN				
Checked: DH				
Approved: SD				

CK Hutchison Networks (UK) Limited

Green Park
450 Longwater Avenue
Reading
RG30 3UR

Design Consultant & Principal Contractor:



WHP Telecoms
Unit 1 Maple Park,
Low Fields Avenue, Leeds
LS12 6HH

Tel: 01133023550
e-mail: info@whptelecoms.com

Site Name: **COMMERCIAL ROAD STREETWORKS**

Site ID: **BAR22826**

Address: **COMMERCIAL ROAD,
BOLTON UPON DEARNE, BARNLSLEY,
SOUTH YORKSHIRE MAYORAL
COMBINED AUTHORITY, ENGLAND,
S63 9AZ**

Title: **002 SITE LOCATION PLAN**

Project: **3UK DNSW**

Purpose of Issue: **PLANNING**

EE Cell ID: 89929	MBNL Cell ID: BAR154	Cell ID: S1392
-----------------------------	--------------------------------	--------------------------

Master Drawing No: **BAR22826_M003** Issue: **C**