

Planting Schedule

Proposed Trees

Nr	Code	Tree Name	Specification	Girth	Height
9-	Ac	Acer campestre	RB-Standard	8-10cm	1.8-2.0m
9-	Al	Amelanchier lamarckii	RB-Standard	8-10cm	1.8-2.0m
14-	Ap	Acer platanoides	RB-Standard	8-10cm	1.8-2.0m
21-	Bpe	Betula pendula	RB-Light Standard	8-10cm	1.8-2.0m
5-	MJD	Malus 'John Downie'	RB-Standard	8-10cm	1.8-2.0m
24-	Pa	Prunus avium	RB-Standard	8-10cm	1.8-2.0m
6-	Pp	Prunus padus	RB-Standard	8-10cm	1.8-2.0m
8-	SaJR	Sorbus aucuparia 'Joseph Rock'	RB-Standard	8-10cm	1.8-2.0m
30-	Sar	Sorbus aria	RB-Standard	8-10cm	1.8-2.0m
7-	Sau	Sorbus aucuparia	RB-Standard	8-10cm	1.8-2.0m
Total :133 -					

Proposed Hedges (4m)

Nr	Code	Tree Name	Specification	Height
950-	Cb	Carpinus betulus	C	60-80cm
1153-	Fs	Fagus sylvatica	C	60-80cm
512-	Gli	Griselinia littoralis	C	
120-	LOA	Ligustrum ovalifolium 'Aureum'	C	60-80cm
Total :2735 -				

Proposed Shrubs

Nr	Code	Plant Name	Height	Cntr (l)	Nr/m2
181-	Bg	Brachyglottis greyi	30-40cm	5L	3/m ²
96-	BVA	Berberis thunbergii 'Atropurpurea'	30-40cm	5L	3/m ²
152-	BIAN	Berberis thunbergii 'Atropurpurea Nana'	40-60cm	5L	3/m ²
56-	Ct	Choisya ternata	30-40cm	5L	3/m ²
123-	EEG	Euonymus fortunei 'Emerald Gaiety'	30-40cm	5L	4/m ²
126-	EIEG	Euonymus fortunei 'Emerald 'n' Gold'	30-40cm	5L	4/m ²
29-	Hca	Hypericum calycinum	30-40cm	5L	4/m ²
90-	HRE	Hebe 'Red Edge'	20-30cm	2L	4/m ²
178-	Hs	Hebe 'Sutherlandii'	30-40cm	5L	4/m ²
117-	LAH	Lavandula angustifolia 'Hidcote'	30-40cm	5L	4/m ²
293-	LNBG	Lonicera nidula 'Baggesen's Gold'	30-40cm	5L	4/m ²
82-	LNMG	Lonicera nidula 'May Green'	30-40cm	5L	3/m ²
107-	Vd	Viburnum davidii	30-40cm	5L	4/m ²
94-	Vmi	Vinca minor	30-40cm	5L	4/m ²
129-	Vt	Viburnum tinus	30-40cm	5L	3/m ²
Total :1853 -					

Proposed Grasses

Nr	Code	Plant Name	Cntr (l)	Nr/m2
51-	FgEB	Festuca glauca 'Elijah Blue'		4/m ²
Total :51 -				

Proposed Native Hedge Mix (5m)

Nr	Code	Plant Name	Height	Root %
29-	Ac	Acer campestre	80-100cm	BR 5%
115-	Cav	Corylus avellana	80-100cm	BR 20%
173-	Cm	Crataegus monogyna	80-100cm	BR 30%
58-	la	Ilex aquifolium	80-100cm	BR 10%
115-	Ps	Prunus spinosa	80-100cm	BR 20%
58-	Sc	Salix caprea	80-100cm	BR 10%
29-	Vo	Viburnum opulus	80-100cm	BR 5%
Total :577 -				

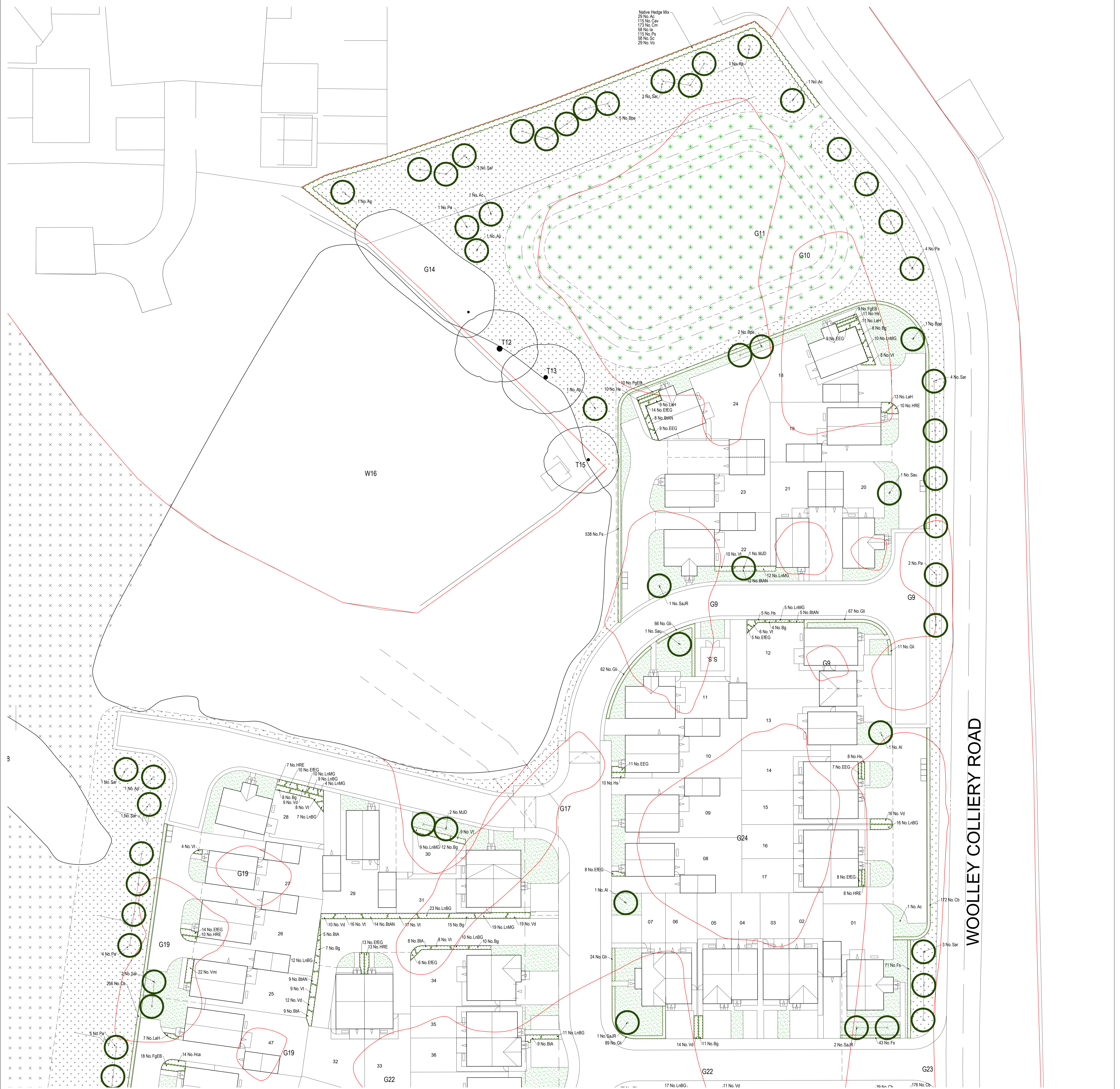

Planting Notes
 Topsoil shall be a minimum of 400mm depth over planting beds and graded to fall. Imported topsoil must be BS3882:2015 compliant and existing topsoil must be cultivated in accordance with BS3882:2015. No cultivation should take place in well waterlogged conditions.
Herbicide and cultivation: Topsoil to be treated with two applications of herbicide prior to planting, where necessary, strictly in accordance with the Control of Pesticides Regulations 1986 (as amended 1997, or otherwise, updated/superseded legislation) and following manufacturer's instructions by qualified staff. The topsoil shall then be cultivated to 150mm depth.
Planting: All planting must be in accordance with BS306:1992 Nursery Stock and BS 8545:2014 Trees from Nursery to Independence.
Trees: All tree planting should conform to BS5845:2014. Standard trees to be planted in pits 800x600x450mm or dimensions of rootball, whichever is greater. Heavy and Extra Heavy Standard trees to be planted in pits 1000x1000x600mm or dimensions of rootball, whichever is greater. Align soil improver and 150g Emerag (or equivalent) to be incorporated into the soil of all new tree pits. Trees to be planted centrally within a tree pit. Tree stakes shall be of hazel, chestnut or other approved timber. They shall be round, rough sawn, straight, free from projections, laps or edge knots and other defects and be pointed at the lower end. They shall be strong enough not to split when driven into the ground and when tied are nailed to them (both initially and when adjusted). For Feathered Trees use 2hr stakes (1.4m by 10mm) to be driven into ground 800mm, leaving 600mm above ground. For Selected Standard Trees 2hr stakes (1.7m by 10mm) and cross bars are required, stakes to be driven 500mm below ground leaving 300mm above ground. For Heavy/Extra Heavy trees use 2hr stakes (2.2m x 100mm) with a 400x100x15mm cross bar. Stakes to be driven into ground 1m heavily 1.2m above ground.
Tree ties: All tree ties to be Green-Tech Fibrillated Natural Tree Ties. Natural tree tie is made entirely of natural fibres and is fully bio-degradable. A spacer by formed using the Natural tree tie itself. It will not strangle the tree and will bio-degrade as the tree establishes itself.
Native Woodland / Shrub areas: Soil depth shall consist of 300mm topsoil and 600mm subsoil (in accordance with BS3882:2015).
Container grown shrubs, transplants and whips: Shrubs and transplants shall be planted in pits 300x300x400mm (depth), and the backfill shall include 3 lines of peat-free tree and shrub compost. Where two or more shrub species are indicated within a single bed each species shall be randomly mixed throughout the bed in groups of 3/5.
Herbicide: Spot treat with herbicide throughout the maintenance period in accordance with the manufacturer's instructions.
Mulch: Planting beds to receive 75mm depth pulverized ornamental bark mulch. Native woodland / shrub / hedgerow plants to be planted with Green-Tech Mulch Mat - Type 11. Mulch Mats are 100% biodegradable with an approximate three year lifespan. Mulch Spats are ready-cut for individual plant production with a centre hole for plant protection. Mats pinned to soil.
Plant position: Final position of trees and shrubs subject to confirmation of service location and approval of statutory undertakers.
Protection to planting: Native hedgerow plants, trees and shrubs within mires to be protected by Green-Tech Bio-Earth Tree Shelter. The Bio-Earth Tree Shelter is made from a special water-proof FSC-approved cardboard which is 100% biodegradable, recyclable, and compostable. Lifespan is typically 3 years. Once the tree / shrub has established enough to no longer need it, the Bio-Earth Tree Shelter can be left to safely biodegrade.
Ornamental hedging: Hedges to comprise a single row of plants. 400mm wide trench excavated to take plants and topsoil cultivated to 400mm depth prior to application of fertiliser.
Grass: All turf/seeded areas to be cultivated and levelled as required removing any stones, rubble, subsoil, general construction waste.
Planting Season: Bare-root shrubs to be planted between mid-November and mid-March dependent upon the planting season.

LEGEND

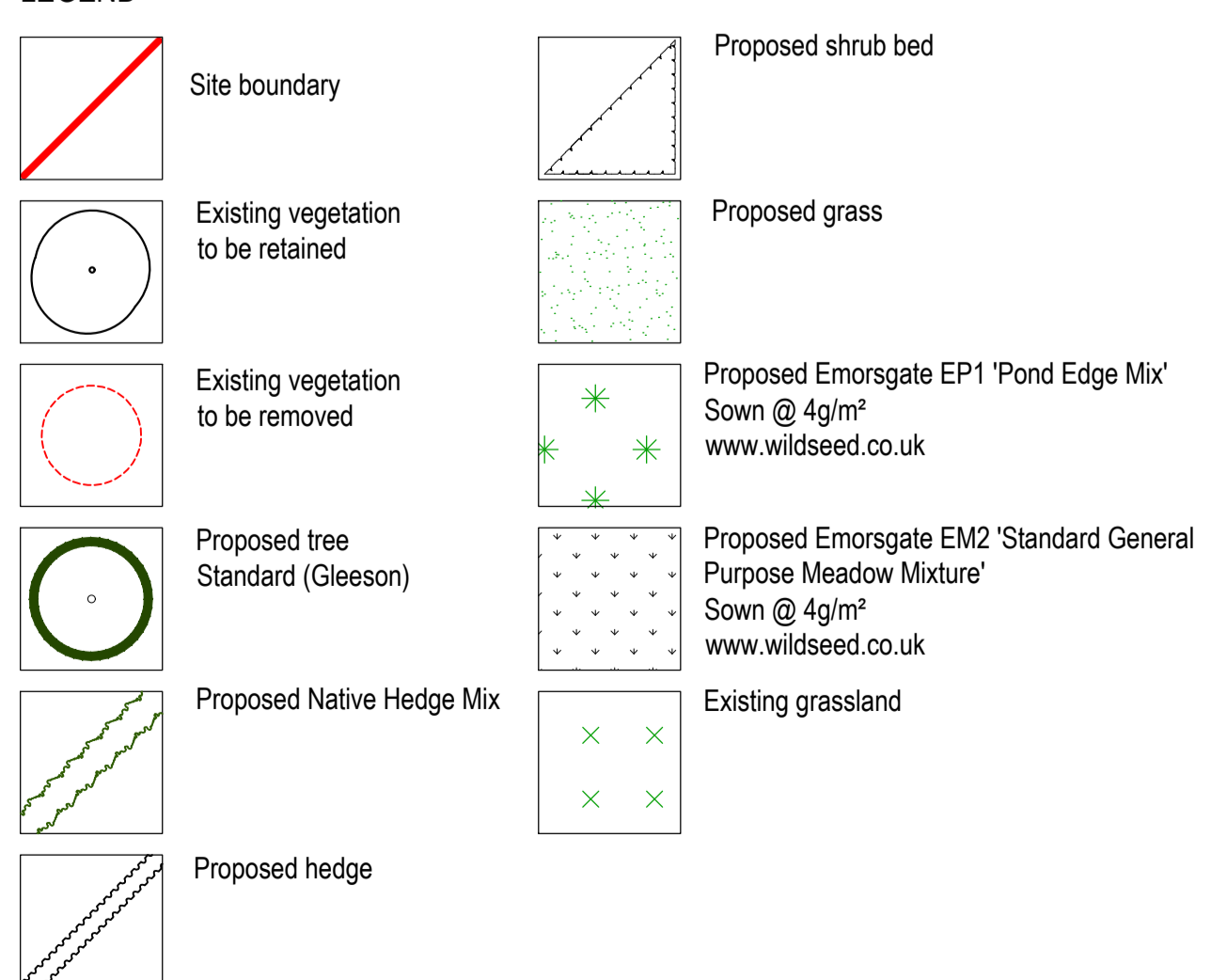

This drawing is the copyright of Rosetta Landscape Design and cannot be reproduced in any form without the express consent of the company. Written and scaled dimensions to be checked on site, any discrepancies reported prior to work commencing. **If in doubt please ask.**

This drawing has been prepared for the purpose of planning approval.

Base: PRA 'Proposed Sketch Layout' 1329-05-B received 17Sep24

PROJECT	Woolley Colliery, Darton
TITLE	Detailed Landscape Proposals (1 of 3)
CLIENT	Gleeson Homes & Regeneration
DATE	20 Sep 24
SCALE	1 : 250
SHEET	AO
DRAWN	BP
DRAWING NO	4101/1
CHECKED	BP
REVISION	-

ROSETTA
 LANDSCAPE DESIGN
 Landscape Architects
 Swallow's Nest, Main Street
 Ashham Richard, York, YO23 3PT
 Telephone +44 (0)1904 500410
 Email: design@rosettalandscape.co.uk
 Web: www.rosettalandscape.co.uk