

A,B&C southern boundary to have min. 2m high masonry wall or vertically boarded double thickness timber fence with cover strips to prevent gaps, & fully sealed at ground level

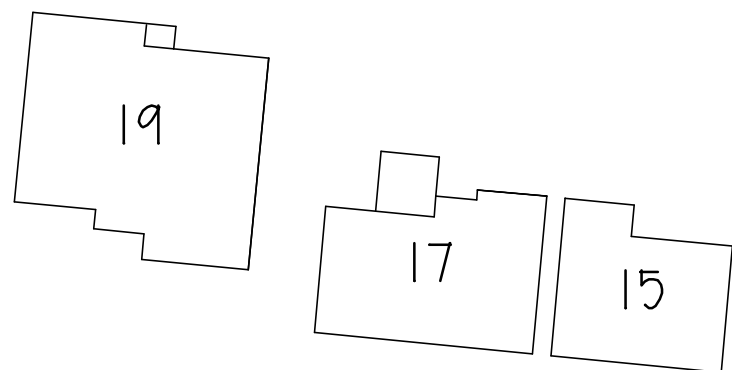

C SOAR & SONS (UK) LTD

PROPOSED UNIT C
ALBION WORKS
OFF HUNNINGLEY LANE
STAIRFOOT S70 3DY

SITE PLAN

1:500@A3 AUG23 Rev M

Peter Thompson

"Linwood"
Barnsley Road
Dodworth



M.C.I.A.T.

†f. 01226 201391
Barnsley S75 3JR m. 07973251730
e-mail peter-thompson@hotmail.co.uk