

NOTE:  
REFER TO HJCE DRAWING 4100  
FOR ROAD LONG SECTION

This drawing should not be scaled. Dimensions to be verified on site.  
Any discrepancies should be referred to the Engineer prior to work commencing.

**NOTES**

**GENERAL NOTES**  
ARCHITECTURAL SITE PLAN  
THE HARRIS PARTNERSHIP  
12006-S-THP-XX-XX-DR-A-0001B  
EXISTING TOPOGRAPHICAL SURVEY  
ELLAM LAND SURVEYS  
8848\_ZD11

1. ALL COORDINATES RELATE TO TOPOGRAPHICAL SURVEY COORDINATION
2. ALL DIMENSION IN METRES UNLESS NOTIFIED OTHERWISE
3. ALL LEVELS IN METRES AOD IN RELATION TO TOPOGRAPHICAL SURVEY COORDINATION UNLESS NOTIFIED OTHERWISE

**KEY:**

- ▲ 0.000 PROPOSED FINISHED LEVEL
- 1.000 PROPOSED GRADIENT (FALL)
- PROPOSED MAJOR CONTOUR (0.5m)
- PROPOSED MINOR CONTOURS (0.1m)
- PROPOSED RETAINING (WITH INDICATIVE HEIGHT)
- SITE BOUNDARY

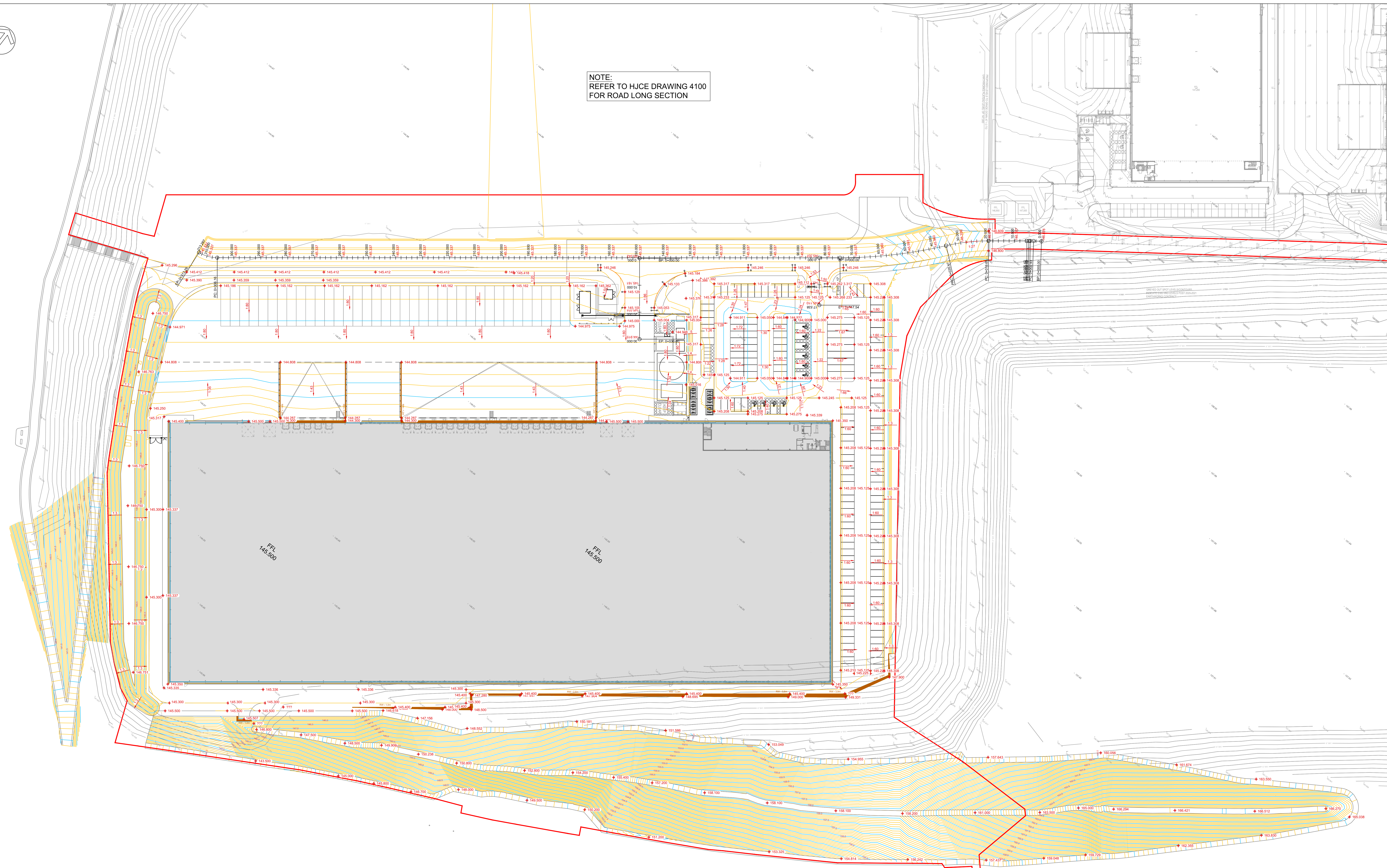

REV	DATE	DESCRIPTION	BY
P02	20.02.25	RED LINE BOUNDARY UPDATED	AF
P01	06.11.24	FIRST ISSUE	AF

REVISIONS

**UNIT 7 - GATEWAY 36,  
ROCKINGHAM,  
BARNSELY**

TITLE

**EXTERNAL LEVELS  
OVERALL SITE PLAN**

CLIENT

**EOS Inc Limited**

**HOLLOWAY  
JENNINGS**  
Consulting Civil & Structural Engineers

CORNAUGHT HOUSE, PARK VIEW, LOFTHOUSE  
WAKEFIELD WF5 3HA  
T 01924 624 433  
admin@hjcpe.co.uk www.hjcpe.co.uk

STATUS

**PRELIMINARY**

DESIGNED BY	CHECKED BY	HJCE REF
DM	AMF	7241
DRAWN BY	DATE	SCALE(S) @
DM	06.11.2024	1:500

PROJECT	OPERATION	VOLUME	SHEET	TOTAL SHEETS	REVISION
7241-HJCE-00-XX-DR-C-0002					P02

