

KEY

- FFL 0.00 Finished floor level
 - + 0.00 Proposed ground level
 - FOE --- Flag on edge
 - CB --- Fence with concrete gravel board
 - RW --- Retaining wall
 - HWRW --- Highway Retaining Wall
 - GAB --- Gabion Retaining Wall
 - UB --- Extra facing brickwork - underbuild
 - 00.00 --- Approx existing level
 - 1:3 --- Max 1 in 3 batter (unless noted otherwise)
 - G --- Gully
 - CD --- Channel Drain (min B125 grade cover)
 - YG --- Yard gully
- Levels/Gradients/Heights may vary to suit working conditions.
For typical road construction details see drawing No. 1048/88/04.

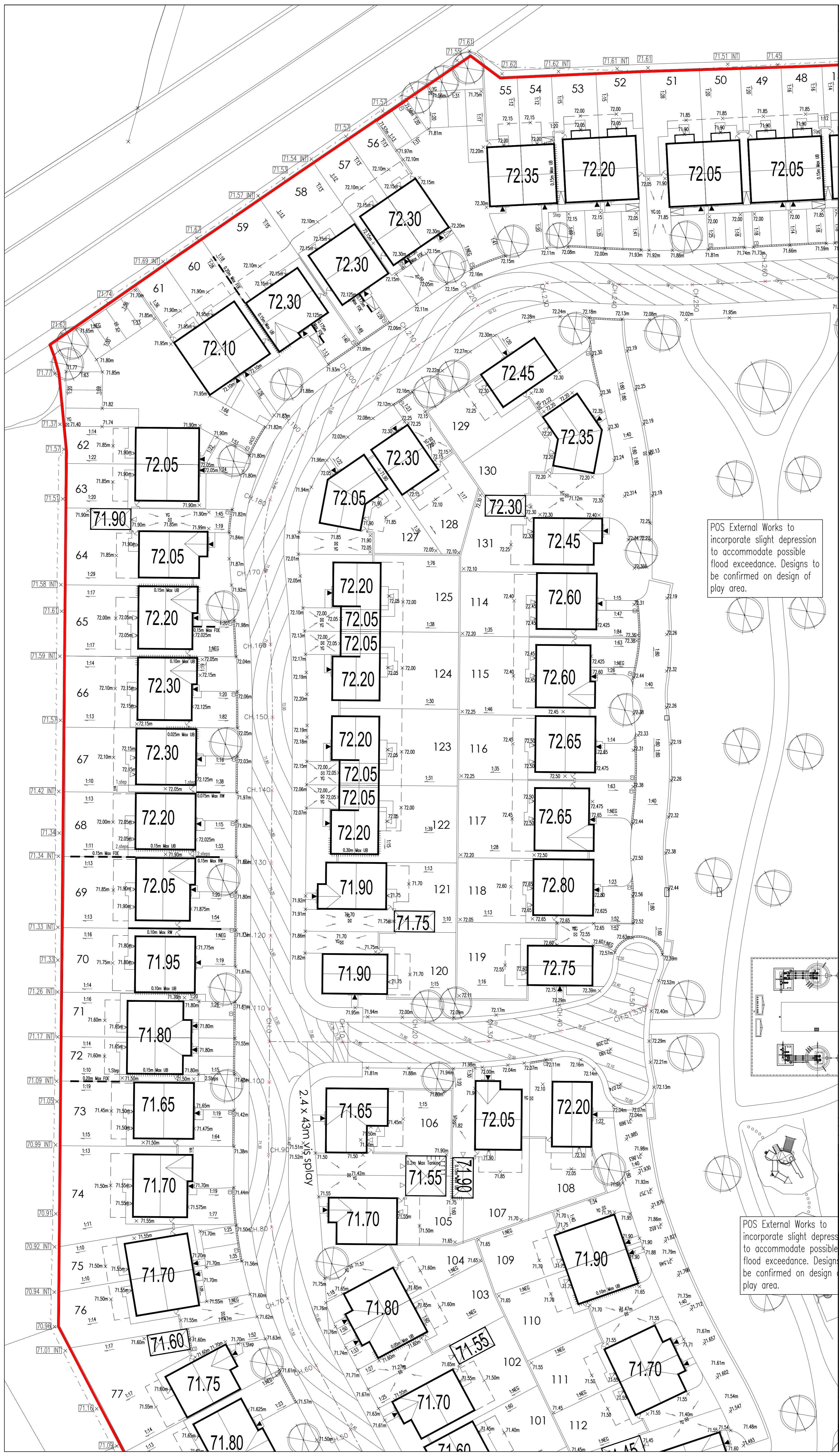

POS External Works to incorporate slight depression to accommodate possible flood exceedance. Designs to be confirmed on design of play area.

POS External Works to incorporate slight depression to accommodate possible flood exceedance. Designs to be confirmed on design of play area.

Rev	By	Date	Revision	Chk
D	JMG	21.11.18	External works updated to suit layout	IC
C	ANB	17.08.17	External works updated to suit layout update Rev D	
B	ANB	16.06.17	External levels amended following review	
A	TF	19.05.17	New layout added and drawing revised to suit.	TF
	JMG	28.03.17	Issued for approval	MI

ARP ASSOCIATES
CHARTERED CONSULTING ENGINEERS

Northwest House • 5/6 Northwest Business Park • Servia Hill • Leeds LS6 2QH
Telephone: 0113 2458498 • Fax: 0113 2443864 • E-Mail: leeds@arpassociates.co.uk
ARP Associates is a trading division of ARP Geotechnical Ltd, a company registered in England and Wales with company number 3375811. whose registered office is at 5/6 Northwest Business Park, Servia Hill, Leeds LS6 2QH

TITLE			
EXTERNAL WORKS LAYOUT SHEET 1 OF 4			
PROJECT			
LEE LANE, ROYSTON			
CLIENT			
BDW YORKSHIRE WEST			
Scale	Date	Drawn	Chk.
1:250 @ A1	MAR 17	JMG	MI
Drg. No.			Rev
1048/88/08.01			D