

Weddle Landscape Design

LANDSCAPE ARCHITECTURE

ENVIRONMENTAL PLANNING

Mews Studio, Charnwood House 8

Kenwood Bank, Sheffield S7 1NU Tel

(0114) 250 1181 Fax (0114) 250 1188

E-mail mail@weddles.co.uk

Web site <http://www.weddles.co.uk>

BANK END ROAD, BARNSELY

Preliminary Ecological Appraisal (PEA)

September 2019 (Rev A – February 2020)

TABLE OF CONTENTS

1	INTRODUCTION.....	3
1.1	Background	3
1.1	Site Description	4
1.2	The Proposals	5
1.3	Planning Status	5
2	METHODOLOGY	6
2.1	Desk Study	6
2.2	Field Survey	6
3	BASELINE ECOLOGICAL CONDITION.....	7
3.1	Designations.....	7
3.2	Habitats and Flora.....	7
3.3	Fauna	11
4	ECOLOGICAL CONSTRAINTS AND OPPORTUNITIES.....	14
4.1	Confirmed Constraints and Mitigation Proposals	14
4.2	Potential Constraints and Avoidance Measures	14
4.3	Recommendations for further surveys	15
4.4	Ecological Enhancement Opportunities	15
5	CONCLUSION	16

APPENDICES

Appendix A: Natural England's Magic Map, September 2019

Appendix B: Barnsley Metropolitan Borough Council's 2019 Adopted Local Plan

Appendix C: Barnsley's Biological Records Centre data records, September 2019

Appendix D: South Yorkshire Bat Group data records, September 2019

DRAWING

1001-WLD-LA-PA-001 PHASE 1 HABITAT SURVEY

1001-WLD-LA-PA-003 TREE SURVEY PLAN

1 INTRODUCTION

1.1 Background

An outline planning application for the development of the site at Bank End Road, Barnsley, is being prepared.

Urbana Town Planning have asked Weddle Landscape Design to carry out a Preliminary Ecological Appraisal (PEA) of the site.

This Preliminary Ecological Appraisal aims to:

- Identify any likely ecological constraints
- Propose any necessary design changes
- Identify any further ecological surveys required to enable an Ecological Impact Assessment (EclA) to be carried out
- Propose any ecological enhancements

Pre-application advice has been sought from Barnsley Metropolitan Borough Council. This included comments received on 26th September 2018 from Matthew Joy relating Biodiversity Issues which states:

“The enquiry site is a completely vegetated site, which clearly has significant biodiversity value, so any subsequent planning application should be accompanied by an ecology report complying with the relevant parts of our attached standard ecological requirements.

The enquiry site consists of a sloping site which is dominated by mature native broadleaf woodland. Including many large oak trees and an understorey which suggests this may be an ancient woodland relict habitat even though the site does not have the benefit of an ancient woodland designation.

Any subsequent planning application should fully evaluate the importance of the woodland habitat including spring wildflower surveys, an ancient/ veteran trees survey and assessment of bat roost quality.

The sites boundary with Bank End Road is formed by a stone wall and what appears to be the remnants of a relict hedge. The applicants ecology report should determine whether it is a relict hedge and if it is any proposals to remove a section should be supported by an assessment against the Hedgerow Regulations 1997 criteria.

In this case external data will also have to be gained from South Yorkshire Bat Group but not from SY Badger Group. The site is wholly within the Dearne Valley Nature Improvement Area, so biodiversity enhancements should be offered over and above the usual mitigation/ compensation measures.”

This PEA includes a desk study and extended Phase 1 Habitat Survey undertaken in September 2019.

This report has been prepared by Neil Northrop BA DipLD MCIHort MArborA CMLI with over 11 years ecological field surveying, scoping, protected species surveys and report writing experience. This report has been prepared in line with BS 42020:2013 Biodiversity: Code of

practice for planning and development and the CIEEM Guidance for Preliminary Ecological Appraisal, Ecological Report Writing and Ecological Impact Assessment.

1.1 Site Description

The Planning Application site is approximately 0.3 hectares located approximately 3km south-east of Barnsley centre at Ordnance Survey grid reference SE 359 043.

The north, east and west boundaries adjoin residential properties. The southern boundary is Bank End Road with residential properties beyond.

The site slopes steeply towards Bank End Road. The top of the site the site begins to level out towards the northern residential gardens.

The site is predominantly woodland. There are no buildings or hardstanding onsite. The site does not have public access; however, the site is not securely fenced from Bank End Road and it is evident the site is regularly trespassed, as seen by the significant fly-tipping, litter, arson and vandalism.



Figure 1 OS Map showing site location





Figure 2 Aerial photograph with site boundary

1.2 The Proposals

An outline planning application for a residential development on the site is being prepared. Part of the woodland will need to be removed to facilitate the development.

1.3 Planning Status

The site is in South Yorkshire under the development control of Barnsley Metropolitan Borough Council (BMBC).

The proposed site is within “Bank End Road Escarpment” Greenspace in the 2019 Adopted Local Plan. The site is also within Dearne Valley Green Heart ‘Nature Improvement Area’.

The site is covered entirely by woodland group W1 in TPO no 13, a woodland area of mature oak with other occasional species which includes all trees and undergrowth

2 METHODOLOGY

2.1 Desk Study

A desk study was undertaken for a 1km radius from the approximate centre of the site (OS grid reference SE 359 043 in order to collate any existing ecological data for the site and its immediate surroundings.

As part of the desk study process, other sources of record information (including both statutory and non-statutory organisations) have been considered, as follows:

- Natural England Magic website for geographic information on key environmental schemes and designations. www.magic.gov.uk, September 2019 (see Appendix A).
- Barnsley Metropolitan Borough Council's Adopted Local Plan 2019 (see Appendix B).
- Barnsley Biological Records Centre (BBRC) 1km data search at OS grid reference SE 359 043, operated by Sheffield City Council Ecology Unit. Received 24th September 2019 (see Appendix C – full data set available on request).
- South Yorkshire Bat Group (SYBG) 2km data search at at OS grid reference SE 359 043. Received 20th September 2019 (see Appendix D)

2.2 Field Survey

Field surveys were carried out in accordance with the Joint Nature Conservation Committee's 'Handbook for Phase 1 Habitat Survey'. The Phase 1 Habitat survey was undertaken on 24th September 2019 (an overcast day). This is considered to be within the optimum period for Habitat Field Surveys, between March and October.

This survey was 'extended' to include the following:

- Description of each habitat including list of species and assessment of general management and condition.
- Consideration of Priority Habitats under S41 of NERC Act and Habitats Directive Annex I habitat types.
- Identification of evidence, or potential for the presence of species.

A follow up Preliminary Ground Level Roost Assessment of trees was in accordance with Bat Conservation Trust Bat Survey Guidelines 2016 on the 21st January 2020. This is within the optimum survey period.

The results of the Phase 1 Habitat Survey are presented below, and a Phase 1 Habitat Plan has been prepared and habitat locations are detailed on drawing number 1001-WLD-LA-PA-001.

3 BASELINE ECOLOGICAL CONDITION

3.1 Designations

There is one site with statutory protection within the 1km search area. This is Worsborough Country Park Local Nature Reserve (LNR) ~800m south of site. There are no European level designated sites within 5km of the site.

There is one Local Wildlife Site (LWS) with the 1km search area. This is Barrow Colliery LWS, ~900m south of site on the far side of River Dove.

Natural England Magic website indicates that within a 1km radius there are two types of Priority Habitat Inventory (PHI) allocations. This includes several areas allocated as Deciduous Woodland PHI, including a strip of woodland which includes the site and extends east and west along Bank End Road Escarpment; and a strip of woodland on the edge of Worsborough Country Park. Most of this woodland, including the site is also allocated 'Broadleaved' under the Forestry Commission's National Forest Inventory.

There is an area designated as 'Good Quality Semi-improved grassland' PHI ~800m south of site.

There is an area of Ancient & Semi-Natural Woodland within Worsborough Country Park ~850m south of site.

3.2 Habitats and Flora

Flora Records

Rotherham Biological Records Centre (BBRC) have provided no flora records for any notable plant species for the site or within the 1km search area.

Invasive Species

There are no invasive species records for the site or within the 1km search area.

Japanese Knotweed was identified on the northern boundary of the site, identified on drawing 1001-WLD-LA-PA-001 as Botanical Target Notes (BTN) 1. It appears to have previously been treated; however, a few living stands remain. No other invasive species were noted during the site walk over.



Photograph 1 Japanese Knotweed, BTN1.

Trees

The majority of the site is broadleaved semi-natural woodland. The woodland was likely planted on the embankment above Bank End Road, possibly to stabilise the slope, for timber or for amenity value.

The majority of the tree stock is mature, and the dominant species is Oak (*Quercus robur*) (particularly in the southern, steeper half of the site). The largest tree onsite has a diameter of ~800mm. Other occasional mature tree species present include Sycamore (*Acer pseudoplatanus*), Sweet Chestnut (*Castanea sativa*) and Ash (*Fraxinus excelsior*).

There are a number of younger trees/saplings in the understory and at the woodland edge. These include Oak (*Quercus robur*), Hawthorn (*Crataegus monogyna*), Cherry (*Prunus sp.*), Holly (*Ilex aquifolium*), Sycamore (*Acer pseudoplatanus*) and Beech (*Fagus sylvatica*).

At the time of survey, the understory across the southern half of the site was predominantly bare ground with few scattered plants, including Bracken (*Pteridium aquilinum*), Fescues (*Festuca Sp*) and Bramble (*Rubus fruticosus agg.*). The understory of the northern part of the site and western boundary is almost exclusively dense Ivy (*Hedera helix*). Most of the trees within this northern part of the site were also have Ivy clad stems.

The Tree Constraints Report by Anderson Tree Care dated March 2018, notes that during the time of survey the understory included additional species of Daffodil (*Narcissus sp.*) and a small area of Spanish Bluebells (*Hyacinthoides sp.*).

The woodland does not exhibit characteristics of a Semi Natural Ancient Woodland (SNAW) and there are no veteran trees onsite. The entire woodland is covered by Barnsley TPO no.13.



Photograph 2 ivy covered understory and tree trunks in the north of the site.

Hedge

A young Hawthorn (*Crataegus monogyna*) hedge has been planted above the wall which runs along the boundary with Bank End Road. This is unpruned and approximately 3m high, 1m wide planted at 0.5m centres. This is not a relic hedge with no evidence of laying from larger stems and was likely planted in the last 20 years.



Photograph 3 young hawthorn hedge along southern boundary.

Wall

The southern boundary to Bank End Road is defined by a ~1m high stone wall which is partially covered with Ivy.



Photograph 4 Stone wall seen from Bank End Road

Tall Ruderal

Two areas of tall ruderal are located on the northern edge of the woodland, adjacent to the residential gardens north of the site. Dominant species is Nettle (*Urtica dioica*) with occasional Bramble (*Rubus fruticosus* agg.).



Photograph 5 tall ruderal on the northern edge of the site.

Introduced Shrub

A line of early mature Cherry Laurel (*Prunus laurocerasus*) has planted along the eastern boundary adjacent to the garden of 17 Bank End Road.



Photograph 6 Cherry Laurel on the eastern boundary

3.3 Fauna

Water Vole

BBRC have provided 7 historic records (1978-1994) of Water Vole (*Arvicola amphibius*) located mostly around Rive Dove, ~1km to the south of the site.

The site has no features which would support Water Vole.

Badger

No records of Badger (*Meles meles*) or were provided by the BBRC data search.

During the walkover the site was searched for evidence of terrestrial mammals. This included searching for signs of Badgers including sett, badger paths or spoor. No field signs were found.

Badgers and their setts are protected under the Protection of Badgers Act 1992.

Bats

Neither BBRC nor SYBG provided records of bats for the site.

SYBG provided 536 individual bat records for 7 identified species within the 2km area of search. Species includes Whiskered bat (*Myotis mystacinus*), Common Pipistrelle (*Pipistrellus pipistrellus*), Soprano pipistrelle (*Pipistrellus pygmaeus*), Nathusius's pipistrelle (*Pipistrellus nathusii*), Daubenton's bat (*Myotis daubentonii*), Common noctule (*Nyctalus noctule*) and Lesser noctule (*Nyctalus leisleri*). The majority of the records are from the western side of the

site; including a wide distribution in Barnsley town, 2km north-west of the site; and Worsbrough Country Park 1.5km south-west of the site. Of these records, only four are within 500m of the site. This includes a 2003 record of emerging bats 160m south-east of site; a 2003 record of 91 count of Pipistrelle sp. at a residential home 340m south-west of site; and two 2012 records of maternity roosts 500m east of site.

BBRC provided a further 10 records of bats made up of the same species, all over 700m from the site.

There are no buildings onsite. The trees were initially checked in September 2019 for features the potential to support roosting bats such as: deep cavities, flaky or deeply fissured bark, hollow stems; location in relation to potential foraging or commuting habitat; the orientation of the tree and level of shade or nearby obstruction to free flight. It was not possible to fully rule out presence of Potential Roost Features (PRFs), therefore a follow up preliminary ground level roost assessment of site trees was carried out on 21st January 2020.

This roost assessment survey included a systematic inspection of all trees for PRFs. Tree numbers are based on tree numbers from drawing 1001-003 Tree Survey by Weddle Landscape Design. No actual presence of bats was identified. Three trees have moderate suitability PRFs, including tree T53 Oak (Vertical crack in principle leader at 4-8m height), T58 Oak (split / decay around dead secondary leader at 4-6m height), and Tree T78 Oak (cavity at 7m height). Semi-mature and mature trees in the north of the site with icy covered stems are considered to have low suitability PRFs. All remaining trees have no PRFs.

The site and surroundings are not considered to form part of an area of high-quality bat foraging habitat.

Some UK bat species are listed under S41 of the NERC Act 2006. All British bat species and their roost are protected under the Wildlife and Countryside Act 1981 (as amended by the CROW Act 2000), and by the Conservation of Habitats and Species Regulations 2010 (as amended).

Birds

BBRC provided no records of birds for the site. Within the 1km search area there were 623 records for ~75 different species.

The site clearly provides suitable nesting habitats for birds, with the mature trees providing the greatest opportunities for nesting. No nests were noted during the site walkover, but they are considered likely to be on site.

Breeding birds are protected under The Wildlife and Countryside Act 1981 (as amended), which includes protection against the damage or destruction of any nests whilst they are in use or being built.

Amphibians

The BBRC data search returned 12 amphibian records of 3 species within the 1km search area, including Smooth Newt (*Lissotriton vulgaris*), Common Toad (*Bufo bufo*) and Common Frog (*Rana temporaria*).

BBRC provided no records of Great Crested Newt (GCN) (*Triturus cristatus*), nor were any EPS licences relating to GCN identified within 1 km of the site using the Magic website.

The site has no waterbodies and low suitability for amphibians. A pond scoping exercise found no ponds and ditches within 500m of the site, and consequently the presence of amphibians is considered unlikely.

Great crested newt is a S41 species and are afforded protection under the Wildlife and Countryside Act 1981 and the Conservation of Habitats and Species Regulations 2010.

Reptiles

The BBRC data search returned 10 records of 2 species of reptile within 1 km of the site. Species were Grass Snake (*Natrix natrix*) and Common Lizard (*Zootoca vivipara*), all located ~1km south of site near The River Dove.

The site inspection revealed no evidence of the presence of reptiles and a lack of mosaic habitats both on and around the site which are preferred by reptiles. It is considered very unlikely that reptiles are present on site.

Invertebrates

The BBRC data search returned 10 records of invertebrate, comprising of 4 species of butterfly and moth. All records are over 500m from the site. The woodland habitat is likely to support a wide range of common invertebrate species.

4 ECOLOGICAL CONSTRAINTS AND OPPORTUNITIES

4.1 Confirmed Constraints and Mitigation Proposals

Avoidance, mitigation and/or compensation measures are required for the following constraints:

Trees

The woodland has a TPO designation and is a Deciduous Woodland PHI. Development should aim to retain as many of the mature woodland trees as possible as part of the proposals.

Retained trees should be protected in line with BS5837:2012 '*Trees in relation to Design, Construction and Demolition -recommendations*.

Birds

Trees provide bird nesting habitat. In compliance with Wildlife and Countryside Act 1981, no construction work which will disturb nesting birds should take place during the breeding season (March – August). A pre-commencement breeding bird check should be undertaken if this is not possible.

Invasive Species

Japanese Knotweed identified as BTN1 on drawing 1001-WLD-LA-PA-001 should be treated in accordance with Environment Agency guidelines.

4.2 Potential Constraints and Avoidance Measures

Avoidance, mitigation and/or compensation measures are required for the following potential constraints:

Bats

BBRC data records for bats suggest there is site is surrounded by populations of a range of bat species.

While no direct evidence of bats was identified, the semi-mature and mature Ivy clad trees in the north of the site have low suitability PRFs and three trees within the southern part of the site have moderate suitability PRFs. A precautionary method of tree work/tree felling should be used for trees with Low suitability PRFs. An aerial tree climbing PRF inspection should be carrier out for trees with Moderate suitability PRF which require tree work/tree felling.

All bat species and their roost are protected under the Wildlife and Countryside Act 1981 (as amended) and by The Conservation of Habitats and Species Regulations 2010 (as amended)

4.3 Recommendations for further surveys

Based on the potential constraints above further survey work is necessary to determine any further avoidance, mitigation and/or compensation measures.

Survey / Inspection	Timescales
Aerial tree climbing PRF inspection survey of trees T53, T58, T78 (as per drawing 1001-003) should they require tree work/tree felling.	Year Round

Table 1 Recommended Surveys

4.4 Ecological Enhancement Opportunities

The site should support aims of the Dearne Valley Green Heart Nature Improvement Area. The following ecological enhancements should be incorporated into the proposed development:

- Adopt sustainable woodland management to enhance the retained woodland habitat in accordance with best practice. A management plan for the site should be produced.
- Shrub and tree planting which includes a diverse mix of native and non-native species in accordance with recognised good practice. Planting should offer foraging and nesting opportunities for birds.
- Any proposed new external lighting for the development should be designed to ensure that lights are angled downward and that night-time light levels remain relatively low.
- Bird Nesting Opportunities including 4No 1B Schwegler Nest Box, or similar.
- Bat Nesting Opportunities including 2No. 2FSchwegler Bat Box (General Purpose), 1No 1FF Schwegler Bat Box to woodland and 2No. 1F Schwegler Bat tubes to buildings, or similar.
- Increase deadwood habitats within woodland
- Boundaries between plots should include holes suitable for hedgehogs
- Continue to monitor and treat any invasive species.

5 CONCLUSION

The site is within an area designated as Deciduous Woodland Priority Habitat Inventory (PHI) and within the Local Plan policy areas "Bank End Road Escarpment" Greenspace and Dearne Valley Green Heart 'Nature Improvement Area'.

The site is predominantly a mature oak established secondary woodland with low biodiversity value due to the poor understory, narrow age range and presence of invasive species, fly tipping and arson.

No protected species were identified however some of the trees have low to moderate suitability potential bat roost features and will require aerial inspection or precautionary working method should they require tree work/felling.

The woodland is does not exhibit features of Ancient Woodland. The roadside hedgerow is not a relic hedge.

APPENDIX A

**Natural England Magic environmental schemes and designations. www.magic.gov.uk
September 2019**

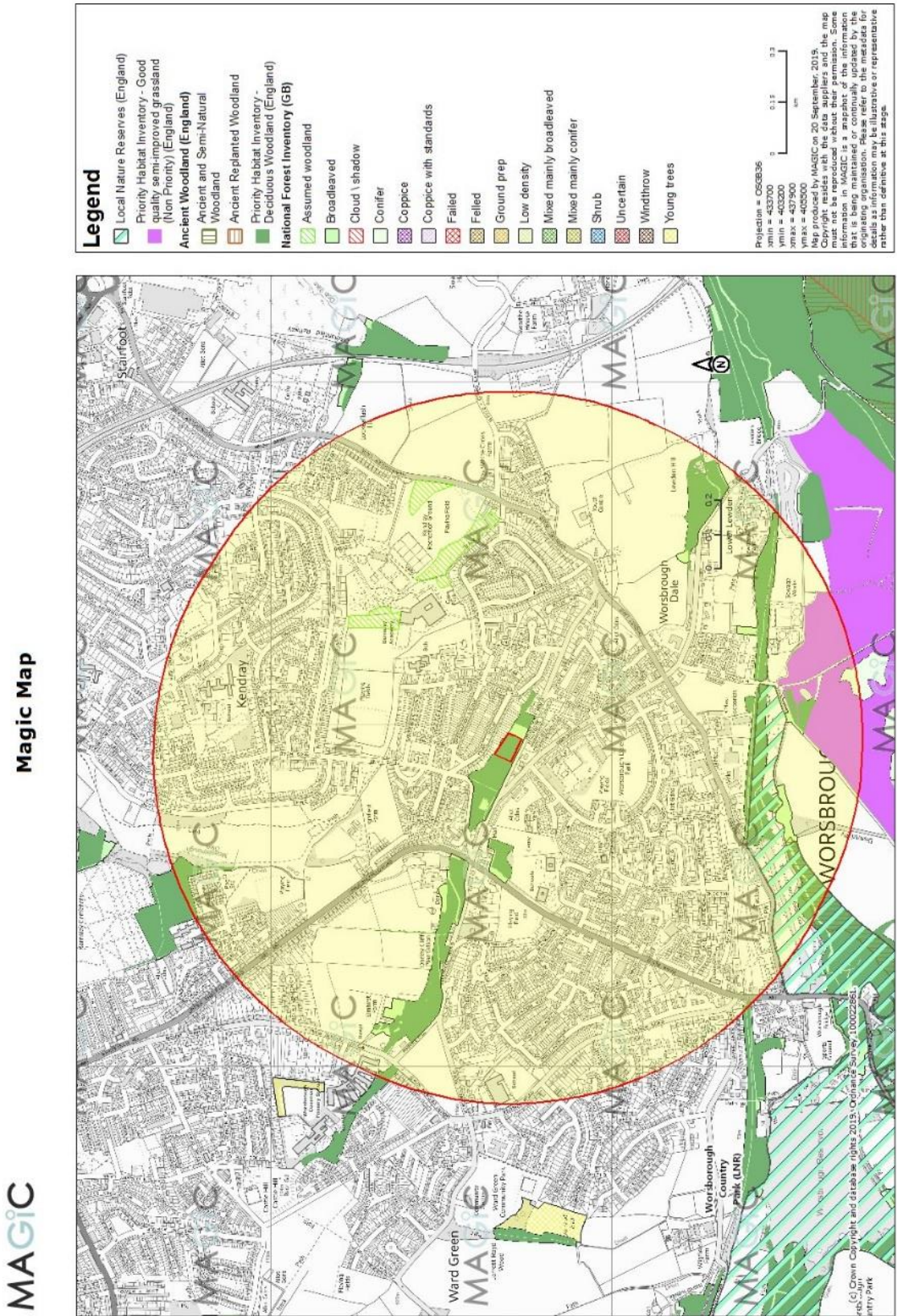

APPENDIX B
Extract from Barnsley Metropolitan Borough Councils Local Plan
Adopted January 2019

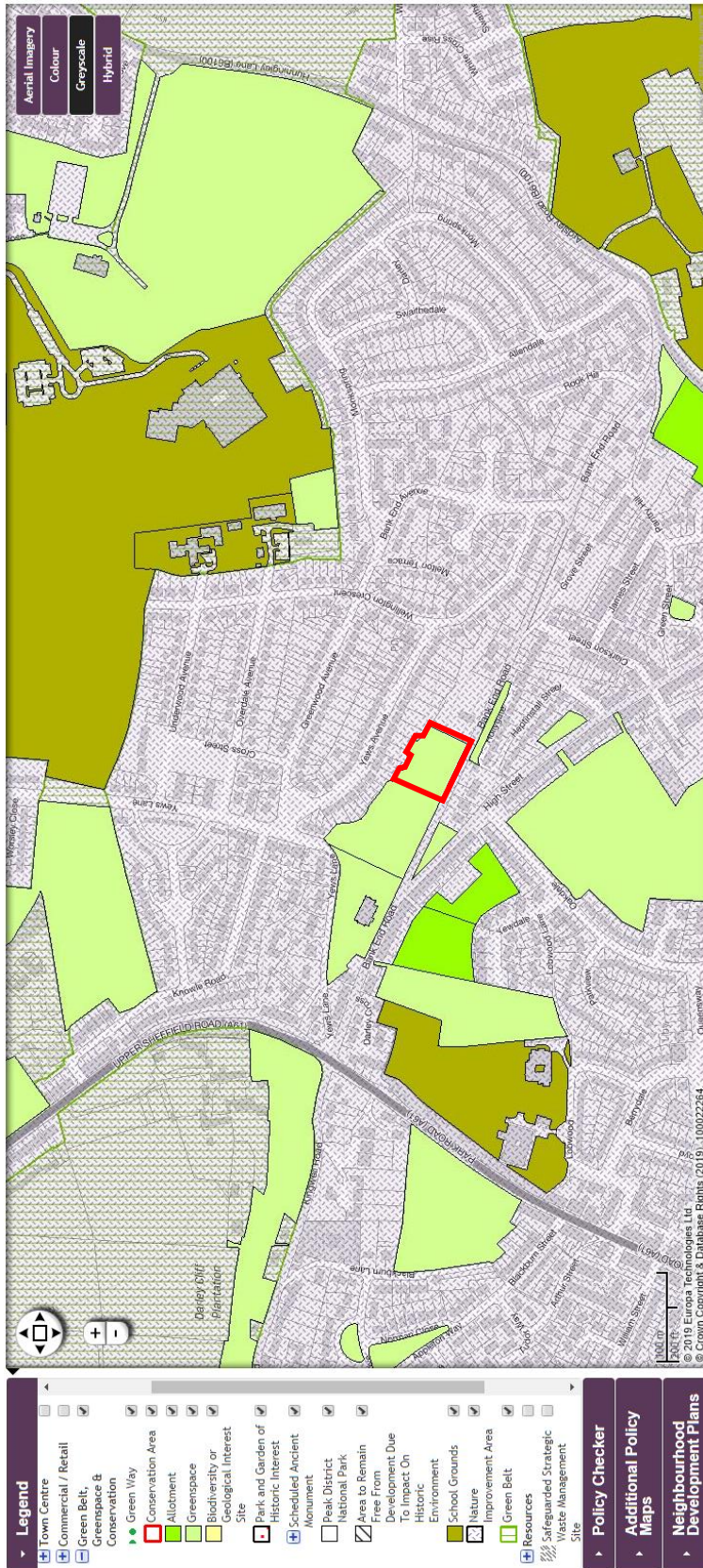

APPENDIX C
BBRC's Biological Data Records - 1km radius, received 24/9/19

Statutory and Non Statutory Local Wildlife Sites Within the Search Area

Bank End Road

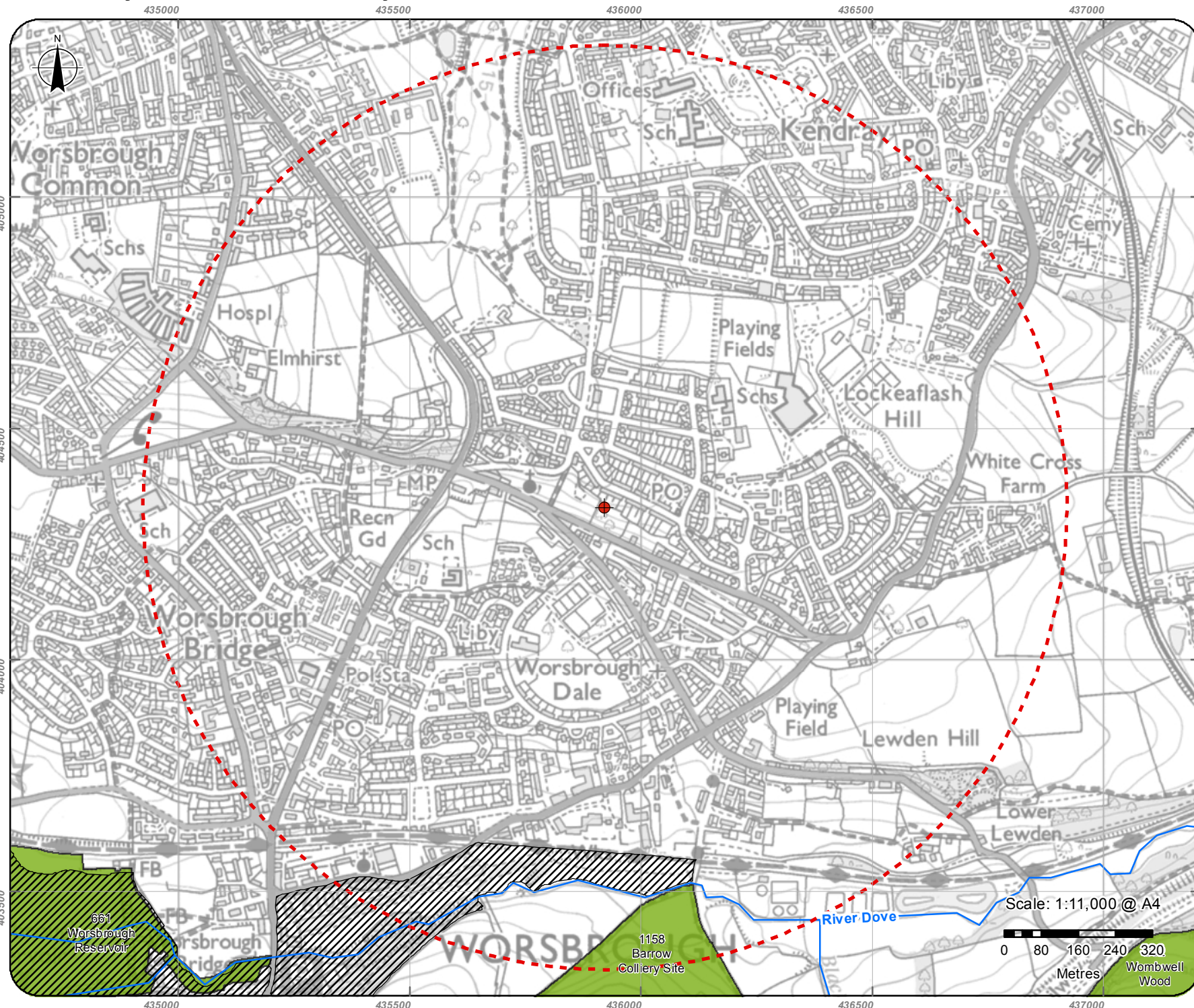

Key

- Centre of Search Area
- 1km Radius
- Watercourse
- Local Wildlife Sites
- LNR Natural England
- Barnsley District Boundary

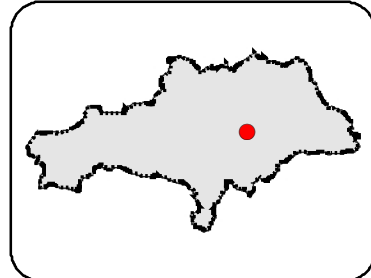

Map Created - 23 Sep 2019



© Natural England 2019, reproduced with the permission of Natural England

© Crown copyright and database rights 2019 OS licence number 100018816. Use of this data is subject to terms and conditions.

Scale: 1:11,000 @ A4

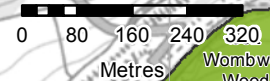

SE180034	Barrow Colliery Barnsley	Worsbrough Dale Sewage Works Pond	01/01/2000/00.00	01/01/2000	amphibian	Rana temporaria	Common Frog	0.00	1.00	0.00	A35000.00 A35000.00	Frog spawn
SE180034	Barrow Colliery Barnsley	Dark Lane Pond	08/01/2014/00.00	08/01/2014	amphibian	Rana temporaria	Common Frog	0.00	1.00	0.00	A35000.00 A35000.00	1st Frog of the year
SE180034	Barrow Colliery Barnsley	Dark Lane Pond	15/03/2014/00.00	15/03/2014	amphibian	Rana temporaria	Common Frog	0.00	1.00	0.00	A35000.00 A35000.00	20 + more Frogs
SE180034	Barrow Colliery Barnsley	Dark Lane Pond	15/03/2014/00.00	15/03/2014	amphibian	Rana temporaria	Common Frog	0.00	1.00	0.00	A35000.00 A35000.00	10 clumps of spawn in pond
SE180034	Barrow Colliery Barnsley	Dark Lane Pond	16/03/2014/00.00	16/03/2014	amphibian	Rana temporaria	Common Frog	0.00	1.00	0.00	A35000.00 A35000.00	15 clumps of spawn in pond
SE180034	Worsbrough Reservoir WVS	Canal	25/07/1991/00.00	25/07/1991	amphibian	Rana temporaria	Common Frog	0.00	1.00	0.00	A34500.00 A30300.00	Young Frogs
SE180034	"BARNLEY MBC"	NE Sector, Dark Lane Pond	04/03/2017/00.00	04/03/2017	amphibian	Rana temporaria	Common Frog	0.00	1.00	0.00	A35000.00 A35000.00	1st frog laid on 5 side of pond
SE180040	Worsbrough	Worsbrough, Tatters Lane	21/02/2017/00.00	21/02/2017	amphibian	Rana temporaria	Common Frog	0.00	1.00	0.00	A35000.00 A35000.00	1st frog of the year seen in a garden
SE180040	"BARNLEY MBC"	Tatters Green	12/04/2011/00.00	12/04/2011	terrestrial mammal	Pipistrellus pipistrellus	Pipistrelle	0.00	1.00	0.00	A35000.00 A35000.00	1 flying near street lamp at dusk
SE180040	"BARNLEY MBC"	Worsbrough, Tatters Green	17/08/2014/00.00	17/08/2014	terrestrial mammal	Pipistrellus pipistrellus	Pipistrelle	0.00	1.00	0.00	A35000.00 A35000.00	1 flying near street lamp at dusk
SE180040	"BARNLEY MBC"	3 Dentons Place	01/01/1985/00.00	01/01/1985	terrestrial mammal	Pipistrellus pipistrellus	Pipistrelle	0.00	1.00	0.00	A35000.00 A35000.00	nocturnal house
SE180040	"BARNLEY MBC"	7 Beconroyd Worsbrough Bridge	01/06/1990/00.00	01/06/1990	terrestrial mammal	Pipistrellus pipistrellus	Pipistrelle	0.00	1.00	0.00	A35000.00 A35000.00	1
SE180040	"BARNLEY MBC"	Woolley Bank Wood, Dove Valley	01/01/1999/00.00	01/01/1999	bird	Pyrrhula pyrrhula	Bullfinch	0.00	1.00	0.00	A35000.00 A35000.00	1
SE180040	Barrow Colliery Barnsley	Worsbrough, Tatters Lane	19/10/1999/00.00	19/10/1999	bird	Pyrrhula pyrrhula	Bullfinch	0.00	1.00	0.00	A35000.00 A35000.00	Dark Lane
SE180040	Barrow Colliery Barnsley	Worsbrough, Tatters Lane	28/08/2003/00.00	28/08/2003	bird	Pyrrhula pyrrhula	Bullfinch	0.00	1.00	0.00	A35000.00 A35000.00	1
SE180040	Worsbrough	Worsbrough, Tatters Lane	06/09/2003/00.00	06/09/2003	bird	Stomus vulgaris	Starling	0.00	1.00	0.00	A35000.00 A35000.00	1
SE180040	Worsbrough	Worsbrough, Tatters Lane	12/02/1987/00.00	12/02/1987	bird	Picus viridis	Green Woodpecker	0.00	1.00	0.00	A35000.00 A35000.00	1
SE180040	Worsbrough	Worsbrough, Tatters Lane	09/07/1988/00.00	09/07/1988	bird	Picus viridis	Green Woodpecker	0.00	1.00	0.00	A35000.00 A35000.00	between Lewdes & Sealthe
SE180040	Worsbrough	Worsbrough, Tatters Lane	21/03/1989/00.00	21/03/1989	bird	Motacilla cinerea	Grey Wagtail	0.00	1.00	0.00	A35000.00 A35000.00	1
SE180040	Worsbrough	Worsbrough, Tatters Lane	26/02/1989/00.00	26/02/1989	bird	Stomus vulgaris	Starling	0.00	1.00	0.00	A35000.00 A35000.00	1
SE180040	Worsbrough	Worsbrough, Tatters Lane	10/12/1990/00.00	10/12/1990	bird	Anas crecca	Teal	0.00	1.00	0.00	A35000.00 A35000.00	1
SE180040	Worsbrough	Worsbrough, Tatters Lane	26/02/1991/00.00	26/02/1991	bird	Anas platyrhynchos	Goldeneye	0.00	1.00	0.00	A35000.00 A35000.00	1
SE180040	Worsbrough	Worsbrough, Tatters Lane	26/02/1991/00.00	26/02/1991	bird	Anas platyrhynchos	Goldeneye	0.00	1.00	0.00	A35000.00 A35000.00	1
SE180040	Worsbrough	Worsbrough, Tatters Lane	26/02/1991/00.00	26/02/1991	bird	Falco aquilina	Common Buzzard	0.00	1.00	0.00	A35000.00 A35000.00	1
SE180040	Worsbrough	Worsbrough, Tatters Lane	21/02/1991/00.00	21/02/1991	bird	Falco tinnunculus	Kestrel	0.00	1.00	0.00	A35000.00 A35000.00	1
SE180040	Worsbrough	Worsbrough, Tatters Lane	18/06/1991/00.00	18/06/1991	bird	Delichon urbica	House Martin	0.00	1.00	0.00	A35000.00 A35000.00	1
SE180040	Worsbrough	Worsbrough, Tatters Lane	25/02/1991/00.00	25/02/1991	bird	Motacilla cinerea	Grey Wagtail	0.00	1.00	0.00	A35000.00 A35000.00	1
SE180040	Worsbrough	Worsbrough, Tatters Lane	06/11/1991/00.00	06/11/1991	bird	Scelopax uroica	Woodcock	0.00	1.00	0.00	A35000.00 A35000.00	1
SE180040	Worsbrough	Worsbrough, Tatters Lane	01/02/1992/00.00	01/02/1992	bird	Motacilla cinerea	Grey Wagtail	0.00	1.00	0.00	A35000.00 A35000.00	1
SE180040	Worsbrough	Worsbrough, Tatters Lane	13/09/1992/00.00	13/09/1992	bird	Motacilla cinerea	Grey Wagtail	0.00	1.00	0.00	A35000.00 A35000.00	1
SE180040	Worsbrough	Worsbrough, Tatters Lane	28/03/1993/00.00	28/03/1993	bird	Carduelis carduelis	Goldfinch	0.00	1.00	0.00	A35000.00 A35000.00	1
SE180040	Worsbrough	Worsbrough, Tatters Lane	01/02/1993/00.00	01/02/1993	bird	Falco aquilina	Common Buzzard	0.00	1.00	0.00	A35000.00 A35000.00	1
SE180040	Worsbrough	Worsbrough, Tatters Lane	14/11/1994/00.00	14/11/1994	bird	Columba oenas	Pouter Dove	0.00	1.00	0.00	A35000.00 A35000.00	1
SE180040	Worsbrough	Worsbrough, Tatters Lane	09/02/1995/00.00	09/02/1995	bird	Motacilla cinerea	Grey Wagtail	0.00	1.00	0.00	A35000.00 A35000.00	1
SE180040	Worsbrough	Worsbrough, Tatters Lane	22/04/1989/00.00	22/04/1989	bird	Motacilla cinerea	Yellow Wagtail	0.00	1.00	0.00	A35000.00 A35000.00	1
SE180040	Worsbrough	Worsbrough, Tatters Lane	06/06/1990/00.00	06/06/1990	bird	Motacilla cinerea	Yellow Wagtail	0.00	1.00	0.00	A35000.00 A35000.00	1
SE180040	Barrow Colliery Barnsley	Barnsley	01/10/2006/00.00	01/10/2006	bird	Falco tinnunculus	Kestrel	0.00	1.00	0.00	A35000.00 A35000.00	1
SE180040	Barrow Colliery Barnsley	Barnsley	01/10/2006/00.00	01/10/2006	bird	Gallinago gallinago	Green Snipe	0.00	1.00	0.00	A35000.00 A35000.00	1
SE180040	Barrow Colliery Barnsley	Barnsley	01/10/2006/00.00	01/10/2006	bird	Picus viridis	Green Woodpecker	0.00	1.00	0.00	A35000.00 A35000.00	1
SE180040	Barrow Colliery Barnsley	Barnsley	01/10/2006/00.00	01/10/2006	bird	Alauda arvensis	Sky Lark	0.00	1.00	0.00	A35000.00 A35000.00	1
SE180040	Barrow Colliery Barnsley	Barnsley	01/10/2006/00.00	01/10/2006	bird	Motacilla cinerea	Grey Wagtail	0.00	1.00	0.00	A35000.00 A35000.00	1
SE180040	Barrow Colliery Barnsley	Barnsley	01/10/2006/00.00	01/10/2006	bird	Agelaius phoeniceus	Goldeneye	0.00	1.00	0.00	A35000.00 A35000.00	1
SE180040	Barrow Colliery Barnsley	Barnsley	01/10/2006/00.00	01/10/2006	bird	Carduelis carduelis	European Goldfinch	0.00	1.00	0.00	A35000.00 A35000.00	1
SE180040	"BARNLEY MBC"	Barnsley	27/02/2009/00.00	27/02/2009	bird	Stomus vulgaris	Starling	0.00	1.00	0.00	A35000.00 A35000.00	1
SE180040	"BARNLEY MBC"	Barnsley	01/05/2009/00.00	01/05/2009	bird	Columba oenas	Pouter Dove	0.00	1.00	0.00	A35000.00 A35000.00	1
SE180040	"BARNLEY MBC"	Barnsley	01/05/2009/00.00	01/05/2009	bird	Stomus vulgaris	Starling	0.00	1.00	0.00	A35000.00 A35000.00	1
SE180040	"BARNLEY MBC"	Barnsley	01/05/2009/00.00	01/05/2009	bird	Ponella modiolaris	Song Thrush	0.00	1.00	0.00	A35000.00 A35000.00	1
SE180040	"BARNLEY MBC"	Barnsley	01/05/2009/00.00	01/05/2009	bird	Stomus vulgaris	Starling	0.00	1.00	0.00	A35000.00 A35000.00	1
SE180040	"BARNLEY MBC"	Barnsley	01/05/2009/00.00	01/05/2009	bird	Physiculus trochilus	Willow Warbler	0.00	1.00	0.00	A35000.00 A35000.00	1
SE180040	"BARNLEY MBC"	Barnsley	01/05/2009/00.00	01/05/2009	bird	Carduelis carduelis	Goldfinch	0.00	1.00	0.00	A35000.00 A35000.00	1
SE180040	"BARNLEY MBC"	Barnsley	25/02/2009/00.00	25/02/2009	bird	Turdus merula	Blackbird	0.00	1.00	0.00	A35000.00 A35000.00	1
SE180040	"BARNLEY MBC"	Barnsley	25/02/2009/00.00	25/02/2009	bird	Turdus merula	Blackbird	0.00	1.00	0.00	A35000.00 A35000.00	1
SE180040	"BARNLEY MBC"	Barnsley	25/02/2009/00.00	25/02/2009	bird	Stomus vulgaris	Starling	0.00	1.00	0.00	A35000.00 A35000.00	1
SE180040	"BARNLEY MBC"	Barnsley	25/02/2009/00.00	25/02/2009	bird	Stomus vulgaris	Starling	0.00	1.00	0.00	A35000.00 A35000.00	1
SE180040	"BARNLEY MBC"	Barnsley	25/02/2009/00.00	25/02/2009	bird	Turdus merula	Blackbird	0.00	1.00	0.00	A35000.00 A35000.00	1
SE180040	"BARNLEY MBC"	Barnsley	25/02/2009/00.00	25/02/2009	bird	Ponella modiolaris	Song Thrush	0.00	1.00	0.00	A35000.00 A35000.00	1
SE180040	"BARNLEY MBC"	Barnsley	25/02/2009/00.00	25/02/2009	bird	Stomus vulgaris	Starling	0.00	1.00	0.00	A35000.00 A35000.00	1
SE180040	"BARNLEY MBC"	Barnsley	25/02/2009/00.00	25/02/2009	bird	Carduelis carduelis	Goldfinch	0.00	1.00	0.00	A35000.00 A35000.00	1
SE180040	"BARNLEY MBC"	Barnsley	25/02/2009/00.00	25/02/2009	bird	Turdus merula	Blackbird	0.00	1.00	0.00	A35000.00 A35000.00	1
SE180040	"BARNLEY MBC"	Barnsley	25/02/2009/00.00	25/02/2009	bird	Turdus merula	Blackbird	0.00	1.00	0.00	A35000.00 A35000.00	1
SE180040	"BARNLEY MBC"	Barnsley	25/02/2009/00.00	25/02/2009	bird	Turdus merula	Blackbird	0.00	1.00	0.00	A35000.00 A35000.00	1
SE180040	"BARNLEY MBC"	Barnsley	25/02/2009/00.00	25/02/2009	bird	Turdus merula	Blackbird	0.00	1.00	0.00	A35000.00 A35000.00	1
SE180040	"BARNLEY MBC"	Barnsley	25/02/2009/00.00	25/02/2009	bird	Turdus merula	Blackbird	0.00	1.00	0.00	A35000.00 A35000.00	1
SE180040	"BARNLEY MBC"	Barnsley	25/02/2009/00.00	25/02/2009	bird	Turdus merula	Blackbird	0.00	1.00	0.00	A35000.00 A35000.00	1
SE180040	"BARNLEY MBC"	Barnsley	25/02/2009/00.00	25/02/2009	bird	Turdus merula	Blackbird	0.00	1.00	0.00	A35000.00 A35000.00	1
SE180040	"BARNLEY MBC"	Barnsley	25/02/2009/00.00	25/02/2009	bird	Turdus merula	Blackbird	0.00	1.00	0.00	A35000.00 A35000.00	1
SE180040	"BARNLEY MBC"	Barnsley	25/02/2009/00.00	25/02/2009	bird	Turdus merula	Blackbird	0.00	1.00	0.00	A35000.00 A35000.00	1
SE180040	"BARNLEY MBC"	Barnsley	25/02/2009/00.00	25/02/2009	bird	Turdus merula	Blackbird	0.00	1.00	0.00	A35000.00 A35000.00	1
SE180040	"BARNLEY MBC"	Barnsley	25/02/2009/00.00	25/02/2009	bird	Turdus merula	Blackbird	0.00	1.00	0.00	A35000.00 A35000.00	1
SE180040	"BARNLEY MBC"	Barnsley	25/02/2009/00.00	25/02/2009	bird	Turdus merula	Blackbird	0.00	1.00	0.00	A35000.00 A35000.00	1
SE180040	"BARNLEY MBC"	Barnsley	25/02/2009/00.00	25/02/2009	bird	Turdus merula	Blackbird	0.00	1.00	0.00	A35000.00 A35000.00	1
SE180040	"BARNLEY MBC"	Barnsley	25/02/2009/00.00	25/02/2009	bird	Turdus merula	Blackbird	0.00	1.00	0.00	A35000.00 A35000.00	1
SE180040	"BARNLEY MBC"	Barnsley	25/02/2009/00.00	25/02/2009	bird	Turdus merula	Blackbird	0.00	1.00	0.00	A35000.00 A35000.00	1
SE180040	"BARNLEY MBC"	Barnsley	25/02/2009/00.00	25/02/2009	bird	Turdus merula	Blackbird	0.00				

SE3603	Barrow Colliery Barnsley	Powder Mill Lane	20/12/2008 00:00	20/12/2008	bird	Alcedo cabanet	Lesser Redpoll					43500.00	40500.00	8 Barrow N plantations
SE3603	Barrow Colliery Barnsley	North sector	18/12/2009 00:00	18/12/2009	bird	Alcedo cabanet	Lesser Redpoll					43500.00	40500.00	12 feeding in alders
SE3603	Lawdon, Worsbrough		23/04/1995 00:00	23/04/1995	bird	Carduelis cannabina	Linnet					43600.00	40300.00	
SE3603	Barrow Colliery Barnsley	Powder Mill Lane	04/07/1999 00:00	04/07/1999	bird	Carduelis cannabina	Linnet					43620.00	40500.00	
SE3603	Canal, Worsbrough		22/11/1991 00:00	22/11/1991	bird	Carduelis cannabina	Linnet					43600.00	40300.00	
SE3603	Powder Mill Lane, Worsbrough Village		10/12/2004 00:00	10/12/2004	bird	Carduelis cannabina	Linnet					43600.00	40300.00	870 Habitat Code: 04. 12. clubbed field
SE3603	Barrow Colliery Barnsley	Powder Mill Lane	01/08/1999 00:00	01/08/1999	bird	Carduelis cannabina	Linnet					43500.00	40500.00	
SE3603	Barrow Colliery Barnsley	Bennett's Ridge East	04/05/2005 00:00	04/05/2005	bird	Carduelis cannabina	Linnet					43500.00	40500.00	
SE3603	"BARNSELY MIBC"	Barnsley	25/05/2009 00:00	25/05/2009	bird	Anas platyrhynchos	Mallard	0.00	0.00	0.00	0.00	43500.00	40500.00	2 breeding pairs. Recorded for Barnsley Bird Atlas 2006-2011.
SE37304	Worsbrough Country Park	Canal Basin, River Dove	08/05/2017 00:00	08/05/2017	bird	Anas platyrhynchos	Mallard	0.00	0.00	0.00	0.00	43450.00	40300.00	female bird with 7 ducklings on the river
SE3603	"BARNSELY MIBC"	East end of Canal Basin	08/07/2018 00:00	08/07/2018	bird	Anas platyrhynchos	Mallard	0.00	0.00	0.00	0.00	43500.00	40500.00	female bird with 4 young birds on river
SE3603	Worsbrough Country Park	East end of Canal Basin	24/05/2015 00:00	24/05/2015	bird	Anas platyrhynchos	Mallard	0.00	0.00	0.00	0.00	43450.00	40300.00	adult female with 5 recently hatched young
SE3603	Worsbrough	Sewage works	06/04/1993 00:00	06/04/1993	bird	Anas platyrhynchos	Mallard	0.00	0.00	0.00	0.00	43500.00	40500.00	juvenile.
SE3603	Worsbrough Dale	Worsbrough Dale Sewage Works	02/05/1988 00:00	02/05/1988	bird	Anas platyrhynchos	Mallard	0.00	0.00	0.00	0.00	43620.00	40300.00	Bred successfully with one brood of 4 ducklings.
SE3603	Worsbrough	Woolley Bark Wood	01/03/1997 00:00	01/03/1997	bird	Carduelis flammula	Redpoll	0.00	0.00	0.00	0.00	43500.00	40300.00	
SE3603	Worsbrough	Woolley Bark Wood	21/11/1997 00:00	21/11/1997	bird	Carduelis flammula	Redpoll					43600.00	40300.00	
SE3603	Sewage Works, Worsbrough, Dove valley		15/11/2003 00:00	15/11/2003	bird	Carduelis flammula	Redpoll					43600.00	40300.00	
SE3603	Sewage Works, Worsbrough, Dove valley		07/05/1992 00:00	07/05/1992	bird	Carduelis flammula	Redpoll					43600.00	40300.00	
SE3603	Sewage Works, Worsbrough, Dove valley		18/12/1993 00:00	18/12/1993	bird	Carduelis flammula	Redpoll					43600.00	40300.00	
SE3603	Lawdon, Worsbrough		14/02/1995 00:00	14/02/1995	bird	Carduelis flammula	Redpoll					43600.00	40300.00	
SE3603	Sewage Works, Worsbrough, Dove valley		01/04/1995 00:00	01/04/1995	bird	Carduelis flammula	Redpoll					43500.00	40300.00	
SE3603	Sewage Works, Worsbrough, Dove valley		08/06/1991 00:00	08/06/1991	bird	Apus apus	Swift	0.00	0.00	0.00	0.00	43600.00	40300.00	
SE3603	Sewage Works, Worsbrough, Dove valley		30/04/1994 00:00	30/04/1994	bird	Apus apus	Swift	0.00	0.00	0.00	0.00	43600.00	40300.00	
SE3604	"BARNSELY MIBC"	SE305-1	01/05/2009 00:00	01/05/2009	bird	Apus apus	Swift	0.00	0.00	0.00	0.00	43500.00	40500.00	Breeding confirmed
SE3603	Barrow Colliery Barnsley	Worsbrough Dale Sewage Works Pond	01/12/1999 00:00	01/12/1999	bird	Apus apus	Swift	0.00	0.00	0.00	0.00	43500.00	40500.00	Small numbers feeding over pond
SE3603	Worsbrough Dale	Worsbrough Dale Sewage Farm	18/05/1975 00:00	18/05/1975	bird	Apus apus	Swift	0.00	0.00	0.00	0.00	43610.00	40300.00	Ringed during a morning session.
SE3603	Worsbrough	Sewage works	30/04/1994 00:00	30/04/1994	bird	Apus apus	Swift	0.00	0.00	0.00	0.00	43500.00	40500.00	
SE3603	Barrow Colliery Barnsley	NW sector	22/05/2017 00:00	22/05/2017	bird	Apus apus	Swift	0.00	0.00	0.00	0.00	43500.00	40300.00	2 birds
SE3604	"BARNSELY MIBC"	Barnsley	25/05/2009 00:00	25/05/2009	bird	Apus apus	Swift	0.00	0.00	0.00	0.00	43500.00	40500.00	1 breeding pair. Recorded for Barnsley Bird Atlas 2006-2011.
SE3603	"BARNSELY MIBC"	Barnsley	03/06/2009 00:00	03/06/2009	bird	Apus apus	Swift	0.00	0.00	0.00	0.00	43500.00	40500.00	5 breeding pairs. Recorded for Barnsley Bird Atlas 2006-2011.
SE3604	"BARNSELY MIBC"	Barnsley	22/04/2009 00:00	22/04/2009	bird	Apus apus	Swift	0.00	0.00	0.00	0.00	43500.00	40500.00	21 breeding pairs. Recorded for Barnsley Bird Atlas 2006-2011.
SE3603	Woolley Bark Wood, Dove Valley		26/01/1999 00:00	26/01/1999	bird	Sitta alba	Tawny Owl	0.00	0.00	0.00	0.00	43500.00	40300.00	
SE3603	Woolley Bark Wood, Dove Valley		03/03/1991 00:00	03/03/1991	bird	Sitta alba	Tawny Owl	0.00	0.00	0.00	0.00	43500.00	40300.00	
SE3603	Lawdon, Worsbrough		07/05/1995 00:00	07/05/1995	bird	Sitta alba	Tawny Owl	0.00	0.00	0.00	0.00	43600.00	40300.00	
SE3603	Worsbrough Reservoir LWS	Worsbrough Country Park	11/05/1980 00:00	11/05/1980	bird	Sitta alba	Tawny Owl	0.00	0.00	0.00	0.00	43450.00	40300.00	owl with chicks
SE3604	"BARNSELY MIBC"	SE305-1	01/05/2009 00:00	01/05/2009	bird	Sitta alba	Tawny Owl	0.00	0.00	0.00	0.00	43500.00	40500.00	Breeding probable
SE3603	Woolley Bark Wood		01/12/1994 00:00	01/12/1994	bird	Sitta alba	Tawny Owl	0.00	0.00	0.00	0.00	43500.00	40300.00	
SE3603	Barrow Colliery Barnsley	NE sector	03/10/2015 00:00	03/10/2015	bird	Sitta alba	Tawny Owl	0.00	0.00	0.00	0.00	43500.00	40500.00	1 hooting in plantation woodland at 1600 hrs
SE37306	"BARNSELY MIBC"	Trans Pennine Trail, Worsbrough	23/02/2016 00:00	23/02/2016	bird	Sitta alba	Tawny Owl	0.00	0.00	0.00	0.00	43500.00	40500.00	1 on live branch at dusk, hooted by alarm call of an agitated Blackbird
SE3603	"BARNSELY MIBC"	Barnsley	03/06/2009 00:00	03/06/2009	bird	Sitta alba	Tawny Owl	0.00	0.00	0.00	0.00	43500.00	40500.00	1 pair - probably breeding. Recorded for Barnsley Bird Atlas 2006-2011.
SE3603	"BARNSELY MIBC"	Barnsley	25/05/2009 00:00	25/05/2009	bird	Sitta alba	Tawny Owl	0.00	0.00	0.00	0.00	43500.00	40500.00	1 pair - probably breeding. Recorded for Barnsley Bird Atlas 2006-2011.
SE3604	"BARNSELY MIBC"	Barnsley	25/05/2009 00:00	25/05/2009	bird	Sitta alba	Tawny Owl	0.00	0.00	0.00	0.00	43500.00	40500.00	1 pair - probably breeding. Recorded for Barnsley Bird Atlas 2006-2011.
SE3603	Sewage Works, Worsbrough, Dove valley		03/08/1989 00:00	03/08/1989	bird	Saxicola rubetra	Whinchat	0.00	0.00	0.00	0.00	43600.00	40300.00	
SE3603	Worsbrough Dale	Worsbrough Dale Sewage Works	07/08/1998 00:00	07/08/1998	bird	Saxicola rubetra	Whinchat	0.00	0.00	0.00	0.00	43620.00	40300.00	
SE3603	Worsbrough	Sewage works	03/09/1994 00:00	03/09/1994	bird	Saxicola rubetra	Whinchat	0.00	0.00	0.00	0.00	43500.00	40500.00	
SE3603	River Dove Valley Worsbrough (Worsbrough City)		30/01/1991 00:00	30/01/1991	bird	Parus montanus	Willow Tit					43500.00	40500.00	
SE3603	Sewage Works, Worsbrough, Dove valley		28/03/1993 00:00	28/03/1993	bird	Parus montanus	Willow Tit					43600.00	40300.00	
SE3603	Barrow Colliery Barnsley	Dark Lane	09/08/1998 00:00	09/08/1998	bird	Parus montanus	Willow Tit					43500.00	40500.00	
SE3603	Barrow Colliery Barnsley	Dark Lane/Wagon Road area	01/01/1999 00:00	01/01/1999	bird	Parus montanus	Willow Tit					43500.00	40500.00	Pair breeding
SE3603	Barrow Colliery Barnsley	Dark Lane	01/01/1998 00:00	01/01/1998	bird	Parus montanus	Willow Tit					43500.00	40500.00	Pair breeding
SE3603	Worsbrough Dale	Worsbrough Dale Sewage Farm	01/01/1975 00:00	01/01/1975	bird	Psocle montana	Willow Tit					43620.00	40300.00	Breeding.
SE3603	Worsbrough Country Park	Canal Basin	23/01/2013 00:00	23/01/2013	bird	Psocle montana	Willow Tit					43450.00	40300.00	1 male bird singing
SE3603	Barrow Colliery Barnsley	Dark Lane Pond	07/11/2013 00:00	07/11/2013	bird	Psocle montana	Willow Tit					43500.00	40500.00	2 birds
SE3603	Barrow Colliery Barnsley	Dark Lane Pond scrub	15/03/2015 00:00	15/03/2015	bird	Psocle montana	Willow Tit					43500.00	40500.00	1 bird responded to lure
SE3603	Barrow Colliery Barnsley	Dark Lane Pond scrub	21/03/2015 00:00	21/03/2015	bird	Psocle montana	Willow Tit					43500.00	40500.00	1 bird responded to lure
SE3603	Trans Pennine Trail, Barnsley	Kendal Greens	23/03/2015 00:00	23/03/2015	bird	Psocle montana	Willow Tit					43500.00	40500.00	1 male bird singing
SE3603	Worsbrough	Canal Basin area	25/03/2015 00:00	25/03/2015	bird	Parus montanus	Willow Tit					43500.00	40500.00	pair
SE3603	Barrow Colliery Barnsley	Barrow	07/11/2013 00:00	07/11/2013	bird	Parus montanus	Willow Tit					43500.00	40500.00	
SE3603	Worsbrough		23/01/2013 00:00	23/01/2013	bird	Parus montanus	Willow Tit					43500.00	40500.00	1 male bird singing

APPENDIX D
SYBG's Biological Data Records - 2km radius, received 20/9/19

Recorder	Date	GridRef 6Fig	Address line 1	Address line 2	Address line 3	Type	Access points	Notes	Species	Number	Evidence
HSM Type Transect/Ro	02.07.16	SE330030	Wentworth Castle Gardens Transect					Bat activity record	Common pipistrelle		HSM Type Transect/Robert E
HSM Type Transect/Ro	02.07.16	SE330030	Wentworth Castle Gardens Transect					Bat activity record	Common pipistrelle		HSM Type Transect/Robert E
HSM Type Transect/Ro	02.07.16	SE330030	Wentworth Castle Gardens Transect					Bat activity record	Common pipistrelle		HSM Type Transect/Robert E
	13/07/2010									1 dead bat in house.	
Eric Bennett		SE339045	The Long Barn	Worsbrough	Barnsley	House	Eaves	Status unknown problems with bat in house.	Pipistrelle sp.		Dr on wall
Martin Nowacki/Jon Moore	01/07/2012	SE338048	Worsbrough				Maternity Roost	BCT call-out as householder having a few problems	Common pipistrelle	65	
Natural England	17/06/2012	SE338047	Genn Lane	Worsbrough					Common pipistrelle	67	
Eric Bennett	27/07/1988	SE3305	Locke Park	Barnsley					Noctule/Leislars	2	
Eric Bennett	21/09/1990	SE330058	Barnsley CRS, Broadway	Kingstone	Barnsley			Bat trapped in warehouse	Pipistrelle sp.	1	
Eric Bennett	01/10/1990	SE330058	Barnsley CRS, Broadway	Kingstone	Barnsley			Bat trapped in warehouse	Pipistrelle sp.	1	
Eric Bennett	19/04/1993	SE3305	Keresforth Hall Road	Kingstone	Barnsley			Grounded bat	Pipistrelle sp.	1	
Brooks Ecological	09/07/2014	SE330055	Broadway				Aural		Common Pipistrelle	Unknown	
Brooks Ecological	29/07/2014	SE330055	Broadway	Barnsley			Aural		Common Pipistrelle	Unknown	
Jerry Brown	08/04/1981	SE3402		Worsbrough Village	Barnsley				Vespertilionidae	1	
Eric Bennett	22/05/1982	SE347028	Bell Bank Wood Tree 2	Worsbrough	Barnsley	Tree Oak	Split	Lost - snow	Noctule	10	
Eric Bennett	25/05/1982	SE347028	Bell Bank Wood Tree 1	Worsbrough	Barnsley	Tree Oak	Branch split	Felled by vandals	Noctule	14	
Jerry Brown	25/05/1982	SE347028	Bell Bank Wood -Tree 1.	Worsbrough	Barnsley				Noctule	14	
Jerry Brown	25/05/1982	SE347028	Bell Bank Wood Tree 2	Worsbrough	Barnsley				Pipistrelle sp.	6	
Jerry Brown	25/05/1982	SE347028	Bell Bank Wood Tree 2	Worsbrough	Barnsley				Noctule	10	
Jerry Brown	26/05/1982	SE3402	Bell Bank Wood	Worsbrough	Barnsley				Vespertilionidae	1	
Jerry Brown	17/07/1986	SE3402	Worsbrough Country Park	Worsbrough	Barnsley				Noctule/Leislars	1	
Eric Bennett	22/05/1988	SE347028	Bell Bank Wood Tree 2	Worsbrough	Barnsley				Noctule	6	
											No bats were present at all this year; Species ID method = UN: Unspecified
Mr Eric Bennett	2001	SE349033	Barnsley	South Yorkshire					Soprano pipistrelle		
Jerry Brown	18/09/1977	SE345034	Worsbrough Country Park	Worsbrough	Barnsley				Vespertilionidae	2	
Jerry Brown	20/09/1977	SE345034	Worsbrough Country Park	Worsbrough	Barnsley				Vespertilionidae	2	
Edwin Blunt	09/12/1977	SE345034	Worsbrough Country Park	Worsbrough	Barnsley				Vespertilionidae	1	
Jerry Brown	10/12/1977	SE345034	Worsbrough Country Park	Worsbrough	Barnsley				Vespertilionidae	1	
Jerry Brown	06/05/1978	SE345034	Worsbrough Country Park	Worsbrough	Barnsley				Vespertilionidae	2	
Jerry Brown	07/05/1978	SE345034	Worsbrough Country Park	Worsbrough	Barnsley				Vespertilionidae	14	
Jerry Brown	09/05/1978	SE345034	Worsbrough Country Park	Worsbrough	Barnsley				Vespertilionidae	10	
Jerry Brown	18/05/1978	SE345034	Worsbrough Country Park	Worsbrough	Barnsley				Noctule/Leislars	12	
Jerry Brown	21/05/1978	SE345034	Worsbrough Country Park	Worsbrough	Barnsley				Vespertilionidae	6	
Jerry Brown	23/05/1978	SE345034	Worsbrough Country Park	Worsbrough	Barnsley				Vespertilionidae	20	
Jerry Brown	26/05/1978	SE345034	Worsbrough Country Park	Worsbrough	Barnsley				Vespertilionidae	6	
Jerry Brown	09/06/1978	SE345034	Worsbrough Country Park	Worsbrough	Barnsley				Vespertilionidae	20	
Jerry Brown	19/06/1978	SE345034	Worsbrough Country Park	Worsbrough	Barnsley				Vespertilionidae	2	
Jerry Brown	26/06/1978	SE345034	Worsbrough Country Park	Worsbrough	Barnsley				Vespertilionidae	5	
Jerry Brown	23/08/1978	SE345034	Worsbrough Country Park	Worsbrough	Barnsley				Vespertilionidae	1	
Jerry Brown	04/09/1978	SE345034	Worsbrough Country Park	Worsbrough	Barnsley				Vespertilionidae	1	
Jerry Brown	05/09/1978	SE345034	Worsbrough Country Park	Worsbrough	Barnsley				Vespertilionidae	1	
Jerry Brown	07/09/1978	SE345034	Worsbrough Country Park	Worsbrough	Barnsley				Vespertilionidae	4	
Jerry Brown	08/09/1978	SE345034	Worsbrough Country Park	Worsbrough	Barnsley				Vespertilionidae	6	
Jerry Brown	13/09/1978	SE345034	Worsbrough Country Park	Worsbrough	Barnsley				Vespertilionidae	1	
Jerry Brown	14/09/1978	SE345034	Worsbrough Country Park	Worsbrough	Barnsley				Vespertilionidae	3	
Jerry Brown	18/09/1978	SE345034	Worsbrough Country Park	Worsbrough	Barnsley				Vespertilionidae	1	
Jerry Brown	19/09/1978	SE345034	Worsbrough Country Park	Worsbrough	Barnsley				Vespertilionidae	1	
Jerry Brown	22/09/1978	SE345034	Worsbrough Country Park	Worsbrough	Barnsley				Vespertilionidae	2	
Jerry Brown	23/09/1978	SE345034	Worsbrough Country Park	Worsbrough	Barnsley				Vespertilionidae	8	
Jerry Brown	27/09/1978	SE345034	Worsbrough Country Park	Worsbrough	Barnsley				Vespertilionidae	5	
Jerry Brown	28/09/1978	SE345034	Worsbrough Country Park	Worsbrough	Barnsley				Vespertilionidae	1	
Jerry Brown	30/09/1978	SE345034	Worsbrough Country Park	Worsbrough	Barnsley				Vespertilionidae	2	
Jerry Brown	04/10/1978	SE345034	Worsbrough Country Park	Worsbrough	Barnsley				Vespertilionidae	5	
Jerry Brown	05/10/1978	SE345034	Worsbrough Country Park	Worsbrough	Barnsley				Vespertilionidae	1	
Jerry Brown	07/10/1978	SE345034	Worsbrough Country Park	Worsbrough	Barnsley				Vespertilionidae	1	
Jerry Brown	09/10/1978	SE345034	Worsbrough Country Park	Worsbrough	Barnsley				Vespertilionidae	1	
Jerry Brown	10/10/1978	SE345034	Worsbrough Country Park	Worsbrough	Barnsley				Vespertilionidae	1	
Jerry Brown	11/04/1979	SE345034	Worsbrough Country Park	Worsbrough	Barnsley				Vespertilionidae	2	
Jerry Brown	12/04/1979	SE345034	Worsbrough Country Park	Worsbrough	Barnsley				Vespertilionidae	1	
Jerry Brown	18/04/1979	SE345034	Worsbrough Country Park	Worsbrough	Barnsley				Vespertilionidae	2	
Jerry Brown	09/05/1979	SE345034	Worsbrough Country Park	Worsbrough	Barnsley				Daubenton's bat	4	
Jerry Brown	11/05/1979	SE345034	Worsbrough Country Park	Worsbrough	Barnsley				Vespertilionidae	1	
Jerry Brown	24/05/1979	SE345034	Worsbrough Country Park	Worsbrough	Barnsley				Vespertilionidae	3	
Jerry Brown	25/05/1979	SE345034	Worsbrough Country Park	Worsbrough	Barnsley				Vespertilionidae	4	
Jerry Brown	27/05/1979	SE345034	Worsbrough Country Park	Worsbrough	Barnsley				Vespertilionidae	12	
Derek Drew	08/06/1979	SE345034	Worsbrough Country Park	Worsbrough	Barnsley				Vespertilionidae	16	
Derek Drew	08/06/1979	SE345034	Worsbrough Country Park	Worsbrough	Barnsley				Pipistrelle sp.	1	
Derek Drew	29/06/1979	SE345034	Worsbrough Country Park	Worsbrough	Barnsley				Noctule	1	
Derek Drew	29/06/1979	SE345034	Worsbrough Country Park	Worsbrough	Barnsley				Pipistrelle sp.	1	
Jerry Brown	03/07/1979	SE345034	Worsbrough Country Park	Worsbrough	Barnsley				Myotis sp.	2	
Jerry Brown	03/07/1979	SE345034	Worsbrough Country Park	Worsbrough	Barnsley				Pipistrelle sp.	1	
Jerry Brown	03/08/1979	SE345034	Worsbrough Country Park	Worsbrough	Barnsley				Daubenton's bat	1	
Jerry Brown	03/08/1979	SE345034	Worsbrough Country Park	Worsbrough	Barnsley				Pipistrelle sp.	2	
Jerry Brown	09/08/1979	SE345034	Worsbrough Country Park	Worsbrough	Barnsley				Noctule	7	
Jerry Brown	15/08/1979	SE345034	Worsbrough Country Park	Worsbrough	Barnsley				large Bat	1	
Jerry Brown	15/08/1979	SE345034	Worsbrough Country Park	Worsbrough	Barnsley				large Bat	1	
Jerry Brown	15/08/1979	SE345034	Worsbrough Country Park	Worsbrough	Barnsley				Vespertilionidae	2	
Jerry Brown	25/08/1979	SE345034	Worsbrough Country Park	Worsbrough	Barnsley				Noctule	1	
Jerry Brown	29/08/1979	SE345034	Worsbrough Country Park	Worsbrough	Barnsley				Vespertilionidae	2	
Jerry Brown	30/08/1979	SE345034	Worsbrough Country Park	Worsbrough	Barnsley				Vespertilionidae	2	
Jerry Brown	31/08/1979	SE345034	Worsbrough Country Park	Worsbrough	Barnsley				Vespertilionidae	2	
Jerry Brown	01/09/1979	SE345034	Worsbrough Country Park	Worsbrough	Barnsley				Vespertilionidae	2	
Jerry Brown	03/09/1979	SE345034	Worsbrough Country Park	Worsbrough	Barnsley				Vespertilionidae	2	
Jerry Brown	04/09/1979	SE345034	Worsbrough Country Park	Worsbrough	Barnsley				Vespertilionidae	1	
Jerry Brown	07/09/1979	SE345034	Worsbrough Country Park	Worsbrough	Barnsley				Vespertilionidae	1	
Derek Drew	08/09/1979	SE345034	Worsbrough Country Park	Worsbrough	Barnsley				Vespertilionidae	3	
Jerry Brown	12/09/1979	SE345034	Worsbrough Country Park	Worsbrough	Barnsley				Vespertilionidae	2	
Jerry Brown	13/09/1979	SE345034	Worsbrough Country Park	Worsbrough	Barnsley				Vespertilionidae	2	
Jerry Brown	14/09/1979	SE345034	Worsbrough Country Park	Worsbrough	Barnsley				Vespertilionidae	2	
Jerry Brown	17/09/1979	SE345034	Worsbrough Country Park	Worsbrough	Barnsley				Vespertilionidae	1	
Jerry Brown	18/09/1979	SE345034	Worsbrough Country Park	Worsbrough	Barnsley				Vespertilionidae	2	
Jerry Brown	18/09/1979	SE345034	Worsbrough Country Park	Worsbrough	Barnsley				Noctule/Leislars	1	
Jerry Brown	22/09/1979	SE345034	Worsbrough Country Park	Worsbrough	Barnsley				Vespertilionidae	6	
Jerry Brown	23/09/1979	SE345034	Worsbrough Country Park	Worsbrough	Barnsley				Vespertilionidae	3	
Jerry Brown	24/09/1979	SE345034	Worsbrough Country Park	Worsbrough	Barnsley				Vespertilionidae	6	
Jerry Brown	29/09/1979	SE345034	Worsbrough Country Park	Worsbrough	Barnsley				Vespertilionidae	3	
Jerry Brown	30/09/1979	SE345034	Worsbrough Country Park	Worsbrough	Barnsley				Vespertilionidae	2	
Jerry Brown	13/10/1979	SE345034	Worsbrough Country Park	Worsbrough	Barnsley				Vespertilionidae	1	
Jerry Brown	05/04/1980	SE345034	Worsbrough Country Park	Worsbrough	Barnsley				Vespertilionidae	1	
Jerry Brown	05/04/1980	SE345034	Worsbrough Country Park	Worsbrough	Barnsley				Vespertilionidae	1	
Jerry Brown	13/04/1980	SE345034	Worsbrough Country Park	Worsbrough	Barnsley				Vespertilionidae	6	
Jerry Brown	14/04/1980	SE345034	Worsbrough Country Park	Worsbrough	Barnsley				Vespertilionidae	3	
Jerry Brown	21/04/1980	SE345034	Worsbrough Country Park	Worsbrough	Barnsley				Vespertilionidae	5	
Jerry Brown	11/05/1980	SE345034	Worsbrough Country Park	Worsbrough	Barnsley				Vespertilionidae	4	
Jerry Brown	11/05/1980	SE345034	Worsbrough Country Park	Worsbrough	Barnsley				Noctule/Leislars	1	
Jerry Brown	15/05/1980	SE345034	Worsbrough Country Park	Worsbrough	Barnsley				Noctule/Leislars	1	
Jerry Brown	15/05/1980	SE345034	Worsbrough Country Park	Worsbrough	Barnsley				Vespertilionidae	5	
Jerry Brown	16/05/1980	SE345034	Worsbrough Country Park	Worsbrough	Barnsley				Vespertilionidae	6	
Jerry Brown	19/06/1980	SE345034	Worsbrough Country Park	Worsbrough	Barnsley				Vespertilionidae	5	
Jerry Brown	16/08/1980	SE345034	Worsbrough Country Park	Worsbrough	Barnsley						

Eric Bennett	29/04/1995	SE345034	Worsbrough Country Park	Worsbrough	Barnsley				Pipistrelle sp.	Unknown	
Eric Bennett	30/08/1997	SE349034	Worsbrough Mill	Worsbrough	Barnsley	Mill	Fascia		Pipistrelle sp.	75	
Eric Bennett	30/08/1997	SE349034	Worsbrough Mill	Worsbrough	Barnsley				Pipistrelle sp.	75	
Eric Bennett	25/04/1998	SE345034	Worsbrough Country Park	Worsbrough	Barnsley				Pipistrelle sp.	Unknown	
Eric Bennett	25/04/1998	SE345034	Worsbrough Country Park	Worsbrough	Barnsley				Noctule	Unknown	
Eric Bennett	25/04/1998	SE345034	Worsbrough Country Park	Worsbrough	Barnsley				Daubenton's bat	Unknown	
Eric Bennett	07/06/1999	SE345034	Bruce Lodge	Pilley	Barnsley				Whiskered bat	Unknown	
Eric Bennett	21/06/1999	SE345034	Bruce Lodge	Pilley	Barnsley				Whiskered bat	1	
Eric Bennett	01/06/2000	SE345034	Bruce Lodge	Pilley	Barnsley				Whiskered bat	4	
Eric Bennett	09/06/2000	SE349033	Worborough Mill, House	Worsbrough	Barnsley				Pipistrelle sp.	79	
Eric Bennett	09/06/2000	SE345034	Worsbrough Country Park	Worsbrough	Barnsley				Noctule	6	
Eric Bennett	15/06/2000	SE3403	Barnsley						Soprano pipistrelle	79	Species ID method = UN: Unspecified ID method
Mr Eric Bennett	15/06/2000	SE349033	Barnsley	South Yorkshire					Soprano pipistrelle	79	Species ID method = UN: Unspecified ID method
Eric Bennett	16/06/2000	SE349034	Worsbrough Mill	Worsbrough	Barnsley				Pipistrelle sp.	3	
Eric Bennett	16/06/2000	SE345034	Worsbrough Country Park	Worsbrough	Barnsley				Noctule	0	
Eric Bennett	16/06/2000	SE345034	Worsbrough Country Park	Worsbrough	Barnsley				Daubenton's bat	6	
Eric Bennett	27/06/2000	SE347033	Bruce Lodge	Pilley	Barnsley				Whiskered bat	2	
Nicky Rivers	13/06/2009	SE3403	Barnsley						Soprano pipistrelle	56	Species ID method = UN: Unspecified ID method
Nicky Rivers	13/06/2009	SE349033	Barnsley	South Yorkshire					Soprano pipistrelle	56	Species ID method = UN: Unspecified ID method
Nicky Rivers	21/06/2009	SE3403	Barnsley						Soprano pipistrelle	30	Species ID method = UN: Unspecified ID method
Nicky Rivers	21/06/2009	SE349033	Barnsley	South Yorkshire					Soprano pipistrelle	30	Species ID method = UN: Unspecified ID method
Nicky Rivers	06/06/2010	SE3403	Barnsley						Soprano pipistrelle	9	Species ID method = UN: Unspecified ID method
Nicky Rivers	06/06/2010	SE349033	Barnsley	South Yorkshire					Soprano pipistrelle	9	Species ID method = UN: Unspecified ID method
Martin Derbyshire	20/06/2010	SE349033	The old Mill building			Known summer roost		Seen leaving the building	Common pipistrelle	2	
SYBG/NBMP	20/06/2010	SE349033	The Old Mill building	Worsbrough Mill	Barnsley			Seen leaving the building	Common pipistrelle	2	
Nicky Rivers	20/06/2010	SE3403	Barnsley						Soprano pipistrelle	3	Species ID method = UN: Unspecified ID method
Nicky Rivers	20/06/2010	SE349033	Barnsley	South Yorkshire					Soprano pipistrelle	3	Species ID method = UN: Unspecified ID method
P Middleton	17/09/2010	SE3403	Worsbrough reservoir					transect	Noctule	3	
P Middleton	17/09/2010	SE3403	Worsbrough reservoir					transect	Common pipistrelle	10	
P Middleton	17/09/2010	SE3403	Worsbrough reservoir					transect	Soprano pipistrelle	12	
P Middleton	17/09/2010	SE3403	Worsbrough reservoir					transect	Nathusius' pipistrelle	1	
P Middleton	17/09/2010	SE3403	Worsbrough reservoir					transect	Daubenton's bat	10	
P Middleton	20/05/2011	SE3403	Worsbrough reservoir					foraging	Noctule	6	
P Middleton	20/05/2011	SE3403	Worsbrough reservoir					foraging	Daubenton's bat	10	
P Middleton	20/05/2011	SE3403	Worsbrough reservoir					foraging	Common pipistrelle	8	
P Middleton	20/05/2011	SE3403	Worsbrough reservoir					foraging	Soprano pipistrelle	10	
Martin Derbyshire	19/06/2011	SE349033	The old Mill building	Worsbrough Mill		Known summer roost		building	Soprano pipistrelle	1	
Nicky Rivers	19/06/2011	SE3403	Barnsley						Soprano pipistrelle	1	Species ID method = UN: Unspecified ID method
Nicky Rivers	19/06/2011	SE349033	Barnsley	South Yorkshire					Soprano pipistrelle	1	Species ID method = UN: Unspecified ID method
Martin Derbyshire	09/07/2011	SE349033	The old Mill building	Worsbrough Mill		Known summer roost		building but no emergence	Pipistrelle sp.	2	Species ID method = UN: Unspecified ID method
Nicky Rivers	09/07/2011	SE349033	Barnsley	South Yorkshire					Soprano pipistrelle	0	Species ID method = UN: Unspecified ID method
P Middleton	02/09/2011	SE3403	Worsbrough reservoir					foraging (30 minimum)	Daubenton's bat	30	
P Middleton	02/09/2011	SE3403	Worsbrough reservoir					foraging (20 minimum)	Common pipistrelle	20	
P Middleton	02/09/2011	SE3403	Worsbrough reservoir					foraging (25 minimum)	Soprano pipistrelle	25	
P Middleton	02/09/2011	SE3403	Worsbrough reservoir					foraging	Noctule	1	
Nicky Rivers	17/06/2012	SE349033	Barnsley					Roost emergence count	Soprano pipistrelle	26	
Nicky Rivers	17/06/2012	SE349033	Barnsley	South Yorkshire					Soprano pipistrelle	26	Species ID method = UN: Unspecified ID method
Nicky Rivers	09/06/2013	SE349033	Barnsley	South Yorkshire					Soprano pipistrelle	0	Species ID method = UN: Unspecified ID method
Nicky Rivers	16/06/2013	SE349033	Barnsley	South Yorkshire					Soprano pipistrelle	6	Species ID method = UN: Unspecified ID method
Robert Bell	15/06/2014	SE349033	Worsbrough Mill					15 bats emerged	Soprano pipistrelle	15	Species ID method = UN: Unspecified ID method
Undisclosed	15/06/2014	SE349033	Barnsley	South Yorkshire					Soprano pipistrelle	15	Species ID method = UN: Unspecified ID method
Middleton Bell Ecology	04.07.18	SE349033	Worsbrough Corn Mill					Roost location on northeast elevation	Leisler's bat	1	See notes
Middleton Bell Ecology	04.07.18	SE349033	Worsbrough Corn Mill					Flight activity record	Noctule	1	See notes
Middleton Bell Ecology	04.07.18	SE349033	Worsbrough Corn Mill					Flight activity record	Probable Daubenton's bat	1	See notes
Middleton Bell Ecology	04.07.18	SE349033	Worsbrough Corn Mill					Roost location at edge of window	Soprano pipistrelle	1	See notes
Middleton Bell Ecology	09.08.18	SE349033	Worsbrough Corn Mill					Flight activity record	Common pipistrelle	1	See notes
Middleton Bell Ecology	09.08.18	SE349033	Worsbrough Corn Mill					Two northeast elevation roost loc	Soprano pipistrelle	2	See notes
Middleton Bell Ecology	13.03.18	SE349033	Wood clad single storey building at Worsbrough Mill					Single dropping on exterior indica	Common pipistrelle	1	See notes
Middleton Bell Ecology	13.03.18	SE349033	Worsbrough Corn Mill					100 droppings were recorded from	Soprano pipistrelle	1	See notes
Eric Bennett	21/06/1998	SE349047	Ridge Walk Way	Ward Green	Barnsley				Noctule	1	
Eric Bennett	21/06/1998	SE349047	Ridge Walk Way	Ward Green	Barnsley				Pipistrelle sp.	10	
Eric Bennett	21/06/1998	SE349047	Ridge Walk Way	Ward Green	Barnsley	House			Pipistrelle sp.	10	
Eric Bennett	26/08/2010	SE342045	Ouslethwaite Court	Worsbrough	Barnsley	House	Fascia	door property	Common pipistrelle	42	
Karen Larkin/Martin Nowacki	03/08/2012	SE343045	Ouslethwaite Court	Worsbrough	Barnsley			One dead pup male at base of roost entrance. 3x adults inside	Common pipistrelle	4	
Karen Larkin	15/07/2015	SE 347046						Bat Care/Callout - DEHYDRATED - LEISLERS		1	Bat Care/Callout
Jerry Brown	29/02/1984	SE340053	Locke Park	Common	Barnsley				Vespertilionidae	2	
Eric Bennett	28/05/1994	SE3405	Beech Street	Kingstone	Barnsley			Grounded bat.	Pipistrelle sp.	1	
Eric Bennett	31/07/1995	SE342055	Spencer Street	Kingstone	Barnsley			Grounded bat, badly injured.	Pipistrelle sp.	1	
Natural England	22/07/2010	SE343046	Ouslethwaite Court	Worsbrough					Pipistrelle sp.	0	
Natural England	27/07/2012	SE342045	Ouslethwaite Court	Worsbrough					Common pipistrelle	147	
Karen Larkin	14/09/2015	SE 347052						Bat Care/Callout - ADULT - REL	PIP	1	Bat Care/Callout No bats were present at all this year; Species ID method = UN: Unspecified No bats were present at all this year; Species ID method = UN: Unspecified
Mr Eric Bennett	1998	SE3406	Barnsley	South Yorkshire					Daubenton's bat		Species ID method = UN: Unspecified
Mr Eric Bennett	2001	SE3406	Barnsley	South Yorkshire					Daubenton's bat	261	Species ID method = UN: Unspecified
Jerry Brown	12/09/1978	SE3406	Barnsley Technical College	Barnsley					Vespertilionidae	1	
Jerry Brown	23/07/1987	SE3406	Hopwood Street		Barnsley				Vespertilionidae	2	
Eric Bennett	27/08/1987	SE3406	Central Offices/ Market		Barnsley				Vespertilionidae	1	
Eric Bennett	07/08/1989	SE340068	Western Street		Barnsley				Pipistrelle sp.	59	
Eric Bennett	04/09/1989	SE344065	Regent Street		Barnsley				Pipistrelle sp.	1	
Eric Bennett	11/06/1991	SE340068	Western Street		Barnsley				Noctule	1	
Eric Bennett	12/06/1991	SE342066	Victoria Avenue		Barnsley				Pipistrelle sp.	1	
Eric Bennett	12/06/1991	SE340068	Western Street		Barnsley	House	Fascia		Pipistrelle sp.	213	
Eric Bennett	22/06/1991	SE340068	Western Street		Barnsley				Pipistrelle sp.	188	
Eric Bennett	01/06/1992	SE340067	Sackville Street		Barnsley				Pipistrelle sp.	1	
Eric Bennett	10/08/1992	SE346063	Market Hill		Barnsley				Pipistrelle sp.	1	
Eric Bennett	11/08/1992	SE345065	Regent Street South Gardens		Barnsley				Pipistrelle sp.	1	
Eric Bennett	07/09/1992	SE346068	County Way		Barnsley				Pipistrelle sp.	1	
Eric Bennett	13/09/1994	SE3406	County Way		Barnsley				Pipistrelle sp.	1	
Eric Bennett	11/10/1994	SE3406	Victoria Road		Barnsley				Pipistrelle sp.	1	
Eric Bennett	13/06/1997	SE3406	Victoria Road		Barnsley				Pipistrelle sp.	1	
Eric Bennett	15/06/1997	SE3406	Barnsley						Daubenton's bat	261	Species ID method = UN: Unspecified ID method
Mr Eric Bennett	15/06/1997	SE3406	Barnsley	South Yorkshire					Daubenton's bat	261	Species ID method = UN: Unspecified ID method
Householder Unknown	17/01/1998	SE342068	Western Street		Barnsley				Vespertilionidae	2	
Eric Bennett	09/09/1998	SE345067	County Way		Barnsley				Pipistrelle sp.	2	
Eric Bennett	15/06/1999	SE3406	Barnsley						Daubenton's bat	258	
Mr Eric Bennett	15/06/1999	SE3406	Barnsley	South Yorkshire					Daubenton's bat	258	Species ID method = UN: Unspecified ID method
Eric Bennett	15/06/2000	SE3406	Barnsley						Daubenton's bat	304	Species ID method = UN: Unspecified ID method
Mr Eric Bennett	15/06/2000	SE3406	Barnsley	South Yorkshire					Daubenton's bat	304	Species ID method = UN: Unspecified ID method
Eric Bennett	01/09/2000	SE344068	County Way		Barnsley	Hole in wall			Common pipistrelle	2 + Dr	
Eric Bennett	01/09/2000	SE344068	County Way		Barnsley				Common pipistrelle	2	
Eric Bennett	15/06/2002	SE3406	Barnsley						Daubenton's bat	257	Species ID method = UN: Unspecified ID method
Mr Eric Bennett	15/06/2002	SE3406	Barnsley	South Yorkshire					Daubenton's bat	257	Species ID method = UN: Unspecified ID method
Eric Bennett	26/07/2002	SE342066	Churchfields		Barnsley			2 P pip feeding	Common pipistrelle	2	
Eric Bennett	29/07/2002	SE342066	Churchfields		Barnsley			S-E P pip feeding	Common pipistrelle	6	
English Nature	30/06/2003	SE340065	Sackville Street		Barnsley			Grounded bat, small wound, given antibiotics. Attempt	Vespertilionidae	1	
English Nature	08/12/2003	SE342068	Hopwood Street		Barnsley			Bat found on outside wall 2ft above ground. Possibly been southwards along railway	Vespertilionidae	1	
Eric Bennett	08/06/2006	SE347063	Kendray Street						Common pipistrelle	1	









P Middleton	15-Aug-14	SE340068	80 Sackville street, Barnsley				roost (known for years)	Common pipistrelle	3	Field
Jerry Brown	22/07/1977	SE350029	Hall Close	Worsborough	Barnsley			Vespertilionidae	1	
Jerry Brown	08/08/1977	SE350029	Hall Close	Worsborough	Barnsley			Vespertilionidae	3	
Jerry Brown	06/05/1978	SE350029	Hall Close	Worsborough	Barnsley			Vespertilionidae	1	
Jerry Brown	30/06/1978	SE345034	Hall Close	Worsborough	Barnsley			Vespertilionidae	30	
Jerry Brown	27/08/1978	SE350029	Hall Close	Worsborough	Barnsley			Vespertilionidae	1	
Jerry Brown	07/07/1979	SE350029	Hall Close	Worsborough	Barnsley			Noctule/Leislars	1	
Jerry Brown	22/07/1979	SE350029	Hall Close	Worsborough	Barnsley			Vespertilionidae	1	
Jerry Brown	28/07/1979	SE350029	Hall Close	Worsborough	Barnsley			Vespertilionidae	2	
Jerry Brown	06/09/1979	SE350029	Hall Close	Worsborough	Barnsley			Vespertilionidae	2	
Jerry Brown	19/06/1980	SE350029	Hall Close	Worsborough	Barnsley			Vespertilionidae	1	
Jerry Brown	30/07/1980	SE350029	Hall Close	Worsborough	Barnsley			Vespertilionidae	1	
Jerry Brown	04/08/1980	SE350029	Hall Close	Worsborough	Barnsley			Vespertilionidae	1	
Jerry Brown	05/08/1980	SE350029	Hall Close	Worsborough	Barnsley			Vespertilionidae	1	
Jerry Brown	10/08/1980	SE350029	Hall Close	Worsborough	Barnsley			Pipistrelle sp.	2	
Jerry Brown	11/08/1980	SE350029	Hall Close	Worsborough	Barnsley			Vespertilionidae	3	
Jerry Brown	13/08/1980	SE350029	Hall Close	Worsborough	Barnsley			Vespertilionidae	1	
Jerry Brown	20/08/1980	SE350029	Hall Close	Worsborough	Barnsley			Vespertilionidae	4	
Jerry Brown	01/09/1980	SE350029	Hall Close	Worsborough	Barnsley			Vespertilionidae	Unknown	
Jerry Brown	09/04/1981	SE350029	Hall Close	Worsborough	Barnsley			Vespertilionidae	1	
Jerry Brown	26/05/1981	SE350029	Hall Close	Worsborough	Barnsley			Noctule/Leislars	1	
Jerry Brown	27/07/1981	SE350029	Hall Close	Worsborough	Barnsley			Vespertilionidae	Unknown	
Jerry Brown	30/07/1981	SE350029	Hall Close	Worsborough	Barnsley			Vespertilionidae	6	
Jerry Brown	09/08/1981	SE350029	Hall Close	Worsborough	Barnsley			Vespertilionidae	1	
Jerry Brown	11/08/1981	SE350029	Hall Close	Worsborough	Barnsley			Noctule	1	
Jerry Brown	11/08/1981	SE350029	Hall Close	Worsborough	Barnsley			Vespertilionidae	10	
Jerry Brown	13/08/1981	SE350029	Hall Close	Worsborough	Barnsley			Vespertilionidae	1	
Jerry Brown	16/08/1981	SE350029	Hall Close	Worsborough	Barnsley			Pipistrelle sp.	4	
Jerry Brown	19/08/1981	SE350029	Hall Close	Worsborough	Barnsley			Pipistrelle sp.	38	
Jerry Brown	20/08/1981	SE350029	Hall Close	Worsborough	Barnsley			Pipistrelle sp.	34	
Eric Bennett	22/08/1981	SE350029	Hall Close	Worsborough	Barnsley	Mansion	Eaves open joint	Pipistrelle sp.	50	
Jerry Brown	22/08/1981	SE350029	Hall Close	Worsborough	Barnsley			Pipistrelle sp.	50	
Jerry Brown	22/04/1982	SE350029	Hall Close	Worsborough	Barnsley			Vespertilionidae	2	
Jerry Brown	16/05/1982	SE350029	Hall Close	Worsborough	Barnsley			Vespertilionidae	2	
Jerry Brown	28/06/1982	SE350029	Hall Close	Worsborough	Barnsley			Vespertilionidae	2	
Jerry Brown	30/06/1982	SE350029	Hall Close	Worsborough	Barnsley			Pipistrelle sp.	2	
Jerry Brown	08/08/1982	SE350029	Hall Close	Worsborough	Barnsley			Vespertilionidae	1	
Jerry Brown	28/08/1982	SE3502	Hall Close	Worsbrough Village	Barnsley			Vespertilionidae	1	
Jerry Brown	21/04/1983	SE3502	Hall Close	Worsbrough Village	Barnsley			Vespertilionidae	1	
Jerry Brown	07/06/1983	SE350029	Hall Close	Worsborough	Barnsley			Vespertilionidae	3	
Jerry Brown	16/07/1983	SE3502		Worsbrough Village	Barnsley			Vespertilionidae	1	
Jerry Brown	28/07/1983	SE3502		Worsbrough Village	Barnsley			Vespertilionidae	1	
Jerry Brown	15/08/1983	SE350029	Hall Close	Worsborough	Barnsley			Vespertilionidae	1	
Jerry Brown	03/10/1983	SE350029	Hall Close	Worsborough	Barnsley			Vespertilionidae	1	
Jerry Brown	11/08/1984	SE350029	Hall Close	Worsborough	Barnsley			Vespertilionidae	1	
Jerry Brown	13/09/1984	SE350029	Hall Close	Worsborough	Barnsley			Vespertilionidae	1	
Jerry Brown	21/08/1986	SE350029	Hall Close	Worsborough	Barnsley			Leisler's bat	32	
Jerry Brown	27/08/1986	SE350029	Hall Close	Worsborough	Barnsley			Leisler's bat	17	
Jerry Brown	13/09/1986	SE350029	Hall Close	Worsborough	Barnsley			Vespertilionidae	1	
Jerry Brown	15/10/1986	SE350029	Hall Close	Worsborough	Barnsley			Noctule/Leislars	4	
Jerry Brown	19/04/1987	SE350029	Hall Close	Worsborough	Barnsley			Pipistrelle sp.	2	
Jerry Brown	18/08/1989	SE350029	Hall Close	Worsborough	Barnsley			Leisler's bat	1	
Householder							Large dead bat found in bedroom			
Unknown	01/01/1990	SE350029	Hall Close	Worsborough	Barnsley			large Bat	1	
Eric Bennett	23/04/1990	SE350025		Worsbrough	Barnsley	Offices	Gable apex	Pipistrelle sp.	2	
Eric Bennett	23/04/1990	SE351028		Worsbrough Village	Barnsley			Noctule	1	
Eric Bennett	23/04/1990	SE351028		Worsbrough Village	Barnsley		bat found under ridge tile during repair work	Pipistrelle sp.	2	
Eric Bennett	01/08/1990	SE350029	Hall Close	Worsborough	Barnsley			Noctule	1	
Eric Bennett	01/08/1990	SE350029	Hall Close	Worsborough	Barnsley			Pipistrelle sp.	Unknown	
Jerry Brown	01/08/1990	SE350029	Hall Close	Worsborough	Barnsley			Pipistrelle sp.	1	
Jerry Brown	01/08/1990	SE350029	Hall Close	Worsborough	Barnsley			Noctule	1	
Eric Bennett	01/02/1993	SE350029	Hall Close	Worsborough	Barnsley	Tree		Vespertilionidae	6	
Eric Bennett	01/02/1993	SE350029	Hall Close	Worsborough	Barnsley			Noctule/Leislars	Unknown	
Eric Bennett	01/08/2000	SE350029		Pilley	Barnsley			Whiskered bat	4	
Eric Bennett	24/08/2001	SE350028	Hall Close	Worsborough	Barnsley			Vespertilionidae	Unknown	
Eric Bennett	05/09/2001	SE350028	Hall Close	Worsborough	Barnsley	Converted Mansion	Eaves	Soprano pipistrelle	61	
Eric Bennett	05/09/2001	SE350028	Hall Close	Worsborough	Barnsley	Converted mansion	Unknown	Brown long-eared bat	+Dr	
Eric Bennett	05/09/2001	SE350028	Hall Close	Worsborough	Barnsley			Soprano pipistrelle	28	
Eric Bennett	05/09/2001	SE350028	Hall Close	Worsborough	Barnsley			Brown long-eared bat	Unknown	
Eric Bennett	11/09/2001	SE350029	Hall Close	Worsborough	Barnsley			Soprano pipistrelle	61	
Mr Eric Bennett	1998	SE351034	Barnsley		South Yorkshire			Soprano pipistrelle		No bats were present at all this year; Species ID method = UN: Unspecified
Mr Eric Bennett	2001	SE351034	Barnsley		South Yorkshire			Soprano pipistrelle		No bats were present at all this year; Species ID method = UN: Unspecified
Mr Eric Bennett	2002	SE352032	Barnsley		South Yorkshire			Soprano pipistrelle		No bats were present during the survey dates but were present at other times; Species ID method = UN: Unspecified
Mr Eric Bennett	2002	SE351034	Barnsley		South Yorkshire			Soprano pipistrelle		No bats were present at all this year; Species ID method = UN: Unspecified
Nicky Rivers	2012	SE351034				Roost emergence count		Common pipistrelle	2	
Nicky Rivers	2012	SE351034				Roost emergence count		Noctule / leisler's bat	1	
Bob Boreham	16/05/1978	SE3503		Worsbrough	Barnsley			Vespertilionidae	1	
Jerry Brown	21/08/1981	SE352032		Worsbrough	Barnsley			Myotis sp.	3	
Jerry Brown	21/08/1981	SE352032		Worsbrough	Barnsley			Noctule	4	
Eric Bennett	01/06/1990	SE355037		Worsbrough Bridge	Barnsley		Cat damaged bat, died.	Pipistrelle sp.	1	
Eric Bennett	06/07/1991	SE352032		Worsbrough	Barnsley			Pipistrelle sp.	1	
Eric Bennett	06/07/1991	SE352032		Worsbrough	Barnsley			Noctule	1	
Eric Bennett	06/07/1991	SE352032		Worsbrough	Barnsley	Public House	Eaves Fascia	Pipistrelle sp.	238	
Eric Bennett	06/07/1991	SE352032		Worsbrough	Barnsley			Pipistrelle sp.	467	
Eric Bennett	17/07/1991	SE3503		Worsbrough	Barnsley			Noctule	1	
Eric Bennett	17/07/1991	SE352032		Worsbrough	Barnsley			Pipistrelle sp.	201	
Eric Bennett	02/08/1991	SE352032		Worsbrough	Barnsley			Pipistrelle sp.	311	
Eric Bennett	01/06/1992	SE352032		Worsbrough	Barnsley			Pipistrelle sp.	237	
Eric Bennett	15/06/1992	SE352032		Worsbrough	Barnsley			Pipistrelle sp.	310	
Eric Bennett	16/07/1992	SE352032		Worsbrough	Barnsley			Pipistrelle sp.	525	
Eric Bennett	21/08/1992	SE352032		Worsbrough	Barnsley			Pipistrelle sp.	160	
Eric Bennett	03/06/1993	SE352032		Worsbrough	Barnsley			Pipistrelle sp.	369	
Eric Bennett	10/06/1993	SE352032		Worsbrough	Barnsley			Pipistrelle sp.	283	
Eric Bennett	16/06/1993	SE352032		Worsbrough	Barnsley			Pipistrelle sp.	366	
Eric Bennett	02/06/1994	SE352032		Worsbrough	Barnsley			Pipistrelle sp.	444	
Eric Bennett	23/06/1994	SE352032		Worsbrough	Barnsley			Pipistrelle sp.	374	
Eric Bennett	03/06/1996	SE352032		Worsbrough	Barnsley			Pipistrelle sp.	412	
Eric Bennett	19/06/1996	SE352032		Worsbrough	Barnsley			Pipistrelle sp.	451	
Eric Bennett	03/06/1997	SE352032		Worsbrough	Barnsley			Soprano pipistrelle	467	
Eric Bennett	03/06/1997	SE352032		Worsbrough	Barnsley			Pipistrelle sp.	467	
Mr Eric Bennett	03/06/1997	SE352032	Barnsley		South Yorkshire			Soprano pipistrelle	467	Species ID method = UN: Unspecified ID method
Eric Bennett	11/06/1997	SE352032		Worsbrough	Barnsley			Soprano pipistrelle	450	
Eric Bennett	11/06/1997	SE352032		Worsbrough	Barnsley			Pipistrelle sp.	450	
Mr Eric Bennett	11/06/1997	SE352032	Barnsley		South Yorkshire			Soprano pipistrelle	450	Species ID method = UN: Unspecified ID method
Eric Bennett	15/06/1997	SE3503						Soprano pipistrelle	467	
Eric Bennett	15/06/1997	SE0335						Vespertilionidae	Unknown	
Mr Eric Bennett	15/06/1997	SE351034	Barnsley		South Yorkshire			Soprano pipistrelle	467	Species ID method = UN: Unspecified ID method
Mr Eric Bennett	08/06/1999	SE352032	Barnsley		South Yorkshire			Soprano pipistrelle	0	Species ID method = UN: Unspecified ID method

Eric Bennett	15/06/1999	SE3503						Soprano pipistrelle	112	
Eric Bennett	15/06/1999	SE0335						Vespertillionidae	Unknown	
Mr Eric Bennett	15/06/1999	SE351034	Barnsley	South Yorkshire				Soprano pipistrelle	112	Species ID method = UN: Unspecified ID method
Eric Bennett	24/06/1999	SE352032						Soprano pipistrelle	112	
Eric Bennett	24/06/1999	SE352032		Worsbrough	Barnsley			Noctule	1	
Eric Bennett	24/06/1999	SE352032		Worsbrough	Barnsley			Pipistrelle sp.	112	
Mr Eric Bennett	24/06/1999	SE352032	Barnsley	South Yorkshire				Soprano pipistrelle	112	Species ID method = UN: Unspecified ID method
Eric Bennett	07/06/2000	SE352032						Soprano pipistrelle	100	
Eric Bennett	07/06/2000	SE352032		Worsbrough	Barnsley			Pipistrelle sp.	100	
Mr Eric Bennett	07/06/2000	SE352032	Barnsley	South Yorkshire				Soprano pipistrelle	100	Species ID method = UN: Unspecified ID method
Eric Bennett	15/06/2000	SE3503						Soprano pipistrelle	366	Species ID method = UN: Unspecified ID method
Mr Eric Bennett	15/06/2000	SE351034	Barnsley	South Yorkshire				Soprano pipistrelle	366	Species ID method = UN: Unspecified ID method
Eric Bennett	19/06/2000	SE352032						Soprano pipistrelle	122	
Eric Bennett	19/06/2000	SE352032		Worsbrough	Barnsley			Pipistrelle sp.	122	
Mr Eric Bennett	19/06/2000	SE352032	Barnsley	South Yorkshire				Soprano pipistrelle	122	Species ID method = UN: Unspecified ID method
Eric Bennett	28/06/2000	SE352032						Soprano pipistrelle	366	
Eric Bennett	28/06/2000	SE352032		Worsbrough	Barnsley			Pipistrelle sp.	366	
Mr Eric Bennett	28/06/2000	SE352032	Barnsley	South Yorkshire				Soprano pipistrelle	366	Species ID method = UN: Unspecified ID method
Jerry Brown	15/07/2001	SE353030		Worsbrough	Barnsley			Soprano pipistrelle	4	Species ID method = UN: Unspecified ID method
Nicky Rivers	31/05/2009	SE3503						Soprano pipistrelle	73	
Nicky Rivers	31/05/2009	SE351034	Barnsley	South Yorkshire				Soprano pipistrelle	730	Species ID method = UN: Unspecified ID method
Martin Derbyshire	01/06/2009	SE351032	The Pub			Known summer roost	Observed emerging	Common pipistrelle	44	
SYBG/NBM	01/06/2009		The Button Mill Inn	Dunmirc Road			Observed emerging	Common pipistrelle	44	
Nicky Rivers	13/06/2009	SE351034	Barnsley	South Yorkshire				Soprano pipistrelle	0	Species ID method = UN: Unspecified ID method
Nicky Rivers	21/06/2009	SE351034	Barnsley	South Yorkshire				Soprano pipistrelle	0	Species ID method = UN: Unspecified ID method
Nicky Rivers	06/06/2010	SE3503						Soprano pipistrelle	44	
Nicky Rivers	06/06/2010	SE351034	Barnsley	South Yorkshire				Soprano pipistrelle	44	Species ID method = UN: Unspecified ID method
Nicky Rivers	20/06/2010	SE351034	Barnsley	South Yorkshire				Soprano pipistrelle	0	Species ID method = UN: Unspecified ID method
Nicky Rivers	19/06/2011	SE3503						Soprano pipistrelle	38	
Martin Derbyshire	19/06/2011	SE351032	The Pub			Known summer roost	Observed emerging from roost	Soprano pipistrelle	38	Species ID method = UN: Unspecified ID method
Nicky Rivers	19/06/2011	SE351034	Barnsley	South Yorkshire				Soprano pipistrelle	38	Species ID method = UN: Unspecified ID method
Nicky Rivers	06/07/2011	SE3503						Soprano pipistrelle	58	
Martin Derbyshire	06/07/2011	SE351032	The Pub			Known summer roost	Observed emerging from roost	Soprano pipistrelle	58	Species ID method = UN: Unspecified ID method
Nicky Rivers	06/07/2011	SE351034	Barnsley	South Yorkshire				Soprano pipistrelle	58	Species ID method = UN: Unspecified ID method
Nicky Rivers	17/06/2012	SE351034	Barnsley	South Yorkshire				Soprano pipistrelle	5	Species ID method = UN: Unspecified ID method
Nicky Rivers	09/06/2013	SE351034	Barnsley	South Yorkshire				Soprano pipistrelle	0	Species ID method = UN: Unspecified ID method
Nicky Rivers	16/06/2013	SE351034	Barnsley	South Yorkshire				Soprano pipistrelle	52	Species ID method = UN: Unspecified ID method
Undisclosed	15/06/2014	SE351034	Barnsley	South Yorkshire				Soprano pipistrelle	0	Species ID method = UN: Unspecified ID method
Brooks Ecological	06/08/2014	SE358036	Broadway	Barnsley				No bats	Unknown	
Karen Larkin	24/09/2016	SE355035					Bat Care/Callout - CAT VICTIM - PIP		1	Bat Care/Callout
Robert Bell	08.06.18	SE351032	Red Lion Pub				Bat recorded in flight	Noctule	1	Detector
Robert Bell	08.06.18	SE351032	Red Lion Pub				Bat recorded in flight	Soprano pipistrelle	1	Detector
Eric Bennett	20/07/1987	SE3504		Worsborough	Barnsley	House		Pipistrelle sp.	21	
Jerry Brown	20/07/1987	SE3504		Worsbrough Bridge	Barnsley			Pipistrelle sp.	21	
Eric Bennett	21/08/1991	SE351044		Ward Green	Barnsley	House	Gable apex	Pipistrelle sp.	+	
Eric Bennett	01/09/2000	SE352049		Worsbrough	Barnsley			Soprano pipistrelle	1	Bat trapped in house & released.
Eric Bennett	05/07/2003	SE357040		Worsbrough	Barnsley	Residential Home	Fascia	Staff count	91	
Karen Larkin	12/07/2012	SE354044						Common pipistrelle pup male	1	
Karen Larkin	15/07/2012	SE354044						Common pipistrelle	1	
Eric Bennett	28/06/1995	SE351050	Milden Place	Barnsley	Barnsley		Interference with roost	Mr Soprano pipistrelle	Unknown	
Eric Bennett	11/06/2001	SE3505		Barnsley	Barnsley			Pipistrelle sp.	13	
Eric Bennett	10/09/1987	SE356069	Dearne Valley Park Canal Aqueduct	Hoyle Mill	Barnsley			Soprano pipistrelle	1	
Eric Bennett	24/09/2001	SE356062	Substation Barnsley Brewery	Oakwell	Barnsley	Electricity Sub-Station	Fascia	Pipistrelle sp.	1	
Eric Bennett	24/09/2001	SE356062	Substation Barnsley Brewery	Oakwell	Barnsley	Electricity Sub-Station	Fascia	Soprano pipistrelle	3	
English Nature	08/08/2005	SE351061	Market Close	Barnsley		Roost		Probably pipistrelle	Unknown	
Eric Bennett	17/08/2005	SE351061	Market Street	Oakwell	Barnsley	House	Gable apex	Pipistrelle sp.	dr	Bats probably left.
P Middleton	07/08/2011	SE356068	River Dearne			foraging		Common pipistrelle	1	
P Middleton	07/08/2011	SE356068	River Dearne			commuting		Daubenton's bat	1	
P Middleton	07/08/2011	SE356069	River Dearne			foraging		Common pipistrelle	2	
P Middleton	09/08/2011	SE358067	River Dearne			foraging		Common pipistrelle	2	
Jerry Brown	18/07/1983	SE3602		Worsbrough Village	Barnsley			Noctule/Leislars	3	
Karen Larkin	12/07/2014	SE368021	Woodhead Drive	Barnsley		Bat Care	DOA	Common pipistrelle	1	
Jerry Brown	24/03/1982	SE3603		Worsbrough	Barnsley			Vespertillionidae	7	
Derek Drew	26/03/1982	SE3603		Worsbrough	Barnsley			Pipistrelle sp.	1	
Eric Bennett	30/07/2003	SE360041		Worsbrough Dale	Barnsley	House		Owner report bats emerging + dr	Dr	roost identified. Taken into
English Nature	12/10/2006	SE363055	Lambert Road	Kendray	Barnsley			Pipistrelle sp.	1	
Karen Larkin	01/10/2011	SE3605	Reginald Road					Common pipistrelle	1	
Eric Bennett	20/06/1987	SE361068	Pontefract Road	Hoyle Mill	Barnsley			Daubenton's bat	Unknown	
Eric Bennett	20/06/1987	SE361068	Pontefract Road	Hoyle Mill	Barnsley			Noctule	2	
Eric Bennett	10/09/1987	SE360068	Pontefract Road	Hoyle Mill	Barnsley			Noctule	1	
Eric Bennett	10/09/1987	SE360068	Pontefract Road	Hoyle Mill	Barnsley			Pipistrelle sp.	Unknown	
Eric Bennett	10/09/1987	SE360068	Pontefract Road	Hoyle Mill	Barnsley			Daubenton's bat	1	
English Nature	21/05/2005	SE362067	Pontefract Road	Hoyle Mill	Barnsley			Bat caught on fishing line in tree over lake. EB visit - bat gone.	1	Vespertillionidae
P Middleton	09/08/2011	SE360066	Old Mill Lane			foraging		Daubenton's bat	2	
P Middleton	09/08/2011	SE361067	Pontefract Road	Hoyle Mill	Barnsley	foraging (16 minimum)		Common pipistrelle	16	
P Middleton	09/08/2011	SE361067	Pontefract Road	Hoyle Mill	Barnsley	foraging (7 minimum)		Daubenton's bat	7	
P Middleton	09/08/2011	SE361067	Pontefract Road	Hoyle Mill	Barnsley	foraging		Noctule	1	
P Middleton	27/08/2011	SE367064	Old Mill Lane			foraging		Common pipistrelle	1	
Robert Bell	29/09/2013	SE374044	Cork Lane	Swaithe	Barnsley	Dwelling		Pipistrelle sp.	Unknown	By droppings
Eric Bennett	16/06/1999	SE377057	Chapel Street	Ardsley	Barnsley			Pipistrelle sp.	1	
English Nature	07/07/2004	SE372055	Wombwell Lane	Ardsley		Roost		Bat found dead in kitchen 86 Bats getting into house & babies falling from roost EB suggested	Unknown	Vespertillionidae

DRAWING
1001-WLD-LA-PA-001 PHASE 1 HABITAT SURVEY

NOTES
 Although this map has been produced with the intention of indicating and classifying the occurrence of semi-natural habitats, it is not to be regarded as a definitive representation of the conservation value or interest of any piece of land. In particular, the absence of any symbol such as a colour code or target symbol should not be taken as denoting a lack of conservation value.

Habitat Type Key:

-  Site Boundary
-  A1.1.1 Broadleaved woodland - semi-natural
-  C3.1 Tall ruderal
-  J1.4 Cultivated/disturbed land - introduced shrub
-  J2.1.2 Intact hedge - species-poor
-  J2.4 Fence
-  J2.5 Wall
-  J4 Bare ground

-  Botanical Target Notes (BTN)
- 1 - Japanese Knotweed
- 2 - Ivy Understory

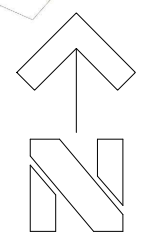
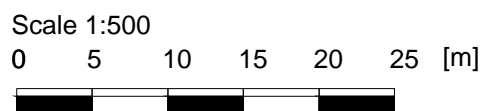

Weddle Landscape Design
 LANDSCAPE ARCHITECTURE
 ENVIRONMENTAL PLANNING
 Mews Studio, Charnwood House, Tel (0114) 250 1181
 8 Kenwood Bank, Sheffield S7 1NU Fax (0114) 250 1188
 www.weddles.co.uk mail@weddles.co.uk

Job **BANK END ROAD, BARNSELEY**

Title **PHASE 1 HABITAT SURVEY**

scale@A3	drawn	date	job number	number	revision
1:500	CB	SEP 19	1001	001	-

DRAWING
1001-WLD-LA-PA-003 TREE SURVEY PLAN

NO	TREE SPECIES		HIGHT	SPREAD	Clear stem (m)	DIA mm	N	CAT.	Life Stage	Life exp yrs	NOTES
	Common Name	Scientific Name									
T1	English Oak	Quercus robur	20	10	3	800	B1	Mature	+40		
T2	English Oak	Quercus robur	18	7	2	500	B1	Semi-Mature	+40	Suppressed.	
T3	English Oak	Quercus robur	14	4	1	350	C1	Early-Mature	+40	Main leader broken at 10m.	
T4	English Oak	Quercus robur	20	6	-	750	B1	Mature	+40		
T5	English Oak	Quercus robur	18	7	2	500	B1	Mature	+40		
T6	English Oak	Quercus robur	20	9	-	450	B1	Semi-Mature	+40	Some dead wood.	
T7	English Oak	Quercus robur	18	11	3	600	B1	Mature	+40	Some dead wood.	
T8	English Oak	Quercus robur	18	9	5	500	B1	Mature	+40	Cavity at 1m on west.	
T9	English Oak	Quercus robur	20	8	4	500	B1	Mature	+40	Some dead wood.	
T10	English Oak	Quercus robur	20	10	6	500	B1	Mature	+40		
T11	English Oak	Quercus robur	18	7	5	500	B1	Mature	+40	Suppressed. Some dead wood.	
T12	English Oak	Quercus robur	18	10	2	600	B1	Mature	+40		
T13	English Oak	Quercus robur	18	7	5	600	B1	Mature	+40	Some dead wood.	
T14	Sweet Chestnut	Castanea sativa	15	10	-	800	C1	Mature	+40	Epicormic growth. Some dead wood.	
T15	English Oak	Quercus robur	20	8	-	700	C1	Mature	+40	Lean east.	
T16	Ash	Fraxinus excelsior	16	16	-	600	B1	Mature	+40		
T17	Sycamore	Acer pseudoplatanus	18	16	2	600	B1	Mature	+40	Ivy covered stem.	
T18	English Oak	Quercus robur	18	10	2	300	C1	Semi-Mature	+40		
T19	English Oak	Quercus robur	20	9	2	400	C1	Mature	+40		
T20	English Oak	Quercus robur	18	8	5	500	B1	Mature	+40		
T21	English Oak	Quercus robur	20	6	2	300	B1	Semi-Mature	+40		
T22	English Oak	Quercus robur	20	7	-	350	C1	Semi-Mature	+40		
T23	Ash	Fraxinus excelsior	12	5	-	200	N C1	Early-Mature	+40	Suppressed. Multi-stemmed	
T24	Ash	Fraxinus excelsior	12	6	-	300	C2	Semi-Mature	+40	Suppressed.	
T25	Sycamore	Acer pseudoplatanus	15	5	-	250	N C1	Early-Mature	+40	Multi-stemmed. Epicormic growth. Ivy covered stem	
T26	Sycamore	Acer pseudoplatanus	16	12	-	800	N C1	Mature	+40	Multi-stemmed. Epicormic growth. Ivy covered stem	
T27	English Oak	Quercus robur	22	15	-	850	C1	Mature	+40	Ivy covered stem. Some dead wood	
T28	English Oak	Quercus robur	10	2	-	250	C1	Early-Mature	+40	Ivy covered stem. Suppressed	
T29	English Oak	Quercus robur	10	4	-	200	N C1	Early-Mature	+40	Ivy covered stem. Multi-stemmed	
T30	English Oak	Quercus robur	20	9	6	700	B1	Mature	+40	Ivy covered stem.	
T31	English Oak	Quercus robur	18	10	3	550	B1	Mature	+40	Ivy covered stem.	
T32	English Oak	Quercus robur	10	6	-	150	C1	Early-Mature	+40	Ivy covered stem. Suppressed.	
T33	Ash	Fraxinus excelsior	15	8	2	600	N C1	Mature	+40	Multi-stemmed. Dieback. Some dead wood.	
T34	Sycamore	Acer pseudoplatanus	18	10	-	425	N C1	Semi-Mature	+20	Multi-stemmed. Ivy covered stem.	
T35	Sycamore	Acer pseudoplatanus	12	6	1	350	N C1	Early-Mature	+40	Suppressed. Multi-stemmed. Ivy covered stem.	
T36	English Oak	Quercus robur	18	11	-	700	B1	Mature	+40		
T37	English Oak, Sycamore, Beech	Quercus robur, Acer pseudoplatanus, Fagus sylvatica	18	10	-	700	B1	Mature	+40	Ivy covered stem.	
T38	Sycamore	Acer pseudoplatanus	10	6	-	200	N C1	Early-Mature	+40	Ivy covered stem. Multi-stemmed.	
T39	English Oak	Quercus robur	18	16	-	700	C1	Mature	+40	Ivy covered stem.	
G40	Lawson Cypress	Chamaecyparis lawsoniana	10	3	-	150	C2	Early-Mature	+40		
T41	English Oak	Quercus robur	15	15	4	750	C1	Mature	+40	Ivy covered stem.	
T42	English Oak	Quercus robur	13	12	3	300	C1	Semi-Mature	+40	Ivy covered stem. Lean west	
G43	English Oak	Quercus robur	14	10	-	100-200	N C1	Young	+40	Ivy covered stem. Multi-stemmed	
T44	English Oak	Quercus robur	20	12	5	700	C1	Mature	+40	Some dead wood. Ivy covered stem. Girdling rope at 2m. Cavity at base on east.	
T45	English Oak	Quercus robur	20	11	4	750	B1	Mature	+40	Some dead wood.	
T46	English Oak	Quercus robur	20	14	4	750	B1	Mature	+40	Ivy covered stem.	
G47	English Oak	Quercus robur	8-15	10	-	75-150	C1	Young	+40	30. No. Ivy covered stem.	
T48	English Oak	Quercus robur	18	10	5	500	B1	Mature	+40	Some dead wood.	
T49	English Oak	Quercus robur	18	9	4	500	C1	Mature	+40	Some dead wood. Lean east. Old wound healing. Girdling damage.	
T50	English Oak	Quercus robur	18	10	6	550	C1	Mature	+40	Nails in trunk. Cavity at base.	
T51	English Oak	Quercus robur	18	7	2	450	B1	Mature	+40		
T52	English Oak	Quercus robur	18	7	5	600	B1	Mature	+40	Some dead wood.	
T53	English Oak	Quercus robur	18	11	6	500	C1	Mature	+40	Cavity at base on west side. Healing split between 4-8m height.	
T54	English Oak	Quercus robur	16	11	6	500	C1	Mature	+40	Some dead wood. Ivy covered stem. Epicormic growth.	
T55	Sycamore	Acer pseudoplatanus	8	6	-	100	N C1	Young	+40	Multi-stemmed.	
T56	English Oak	Quercus robur	18	8	-	500	C1	Mature	+40	Cavity at base on west.	
T57	English Oak	Quercus robur	18	6	2	400	C1	Mature	+40		
T58	English Oak	Quercus robur	18	7	-	400	U	Mature	+40	Some dead wood. Decay through trunk.	
T59	English Oak	Quercus robur	20	10	7	600	B1	Mature	+40	Nest in canopy at 18m.	
T60	English Oak	Quercus robur	20	10	5	700	B1	Mature	+40	Some dead wood.	
T61	English Oak	Quercus robur	20	6	-	500	C1	Mature	+40	Suppressed.	
T62	English Oak	Quercus robur	18	8	3	500	C1	Mature	+40	Limb broken from vehicle collision at 2m. Some dead wood.	
T63	English Oak	Quercus robur	20	17	1	700	B1	Mature	+40	Limb broken vehicle collision at 2m. Some dead wood.	
T64	English Oak	Quercus robur	18	7	-	500	C1	Mature	+40		
T65	English Oak	Quercus robur	11	8	2	400	C1	Mature	+40	Some dead wood.	
T66	English Oak	Quercus robur	11	9	4	600	B1	Mature	+40		
T67	English Oak	Quercus robur	11	9	6	700	B1	Mature	+40	Some dead wood.	
T68	English Oak	Quercus robur	8	5	-	150	C1	Young	+40	Lean north. Suppressed.	
T69	English Oak	Quercus robur	18	9	-	450	C1	Mature	+40	Broken branch at 10m.	
T70	English Oak	Quercus robur	7	4	-	200	C1	Young	+40	Suppressed.	
T71	English Oak	Quercus robur	20	12	4	700	C1	Mature	+40	Lean south. Branch damage from vehicle collision.	
T72	English Oak	Quercus robur	20	9	4	500	C1	Mature	+40		
T73	English Oak	Quercus robur	20	8	7	700	B1	Mature	+40		
T74	English Oak	Quercus robur	20	10	8	500	C1	Mature	+40	Some dead wood. Cavity at base.	
T75	English Oak	Quercus robur	20	10	-	550	U	Mature	0-10	Fire damage at the base. 60% of bark lost.	
T76	English Oak	Quercus robur	18	10	15	500	B1	Mature	+40	Some dead wood.	
T77	English Oak	Quercus robur	20	12	-	600	B1	Mature	+40	Some dead wood.	
T78	English Oak	Quercus robur	8	8	-	400	U	Mature	+40	Lean south-west. Decay in cavity on trunk.	
T79	English Oak	Quercus robur	14	10	-	250	C2	Early-Mature	+40	On wall above site.	
T80	English Oak	Quercus robur	18	12	2	700	B1	Semi-Mature	+40	Ivy covered stem.	
T81	English Oak	Quercus robur	18	12	3	600	C1	Mature	+40	Ropeswing girdling to branch. Wet cavity on south-west at 6m. Cavity at base on south-west and north-west.	

Site covered entirely by Barnsley Metropolitan Borough Council TPO no 13, Woodland Group W1.

Scale 1:500

0 5 10 15 20 25 [m]

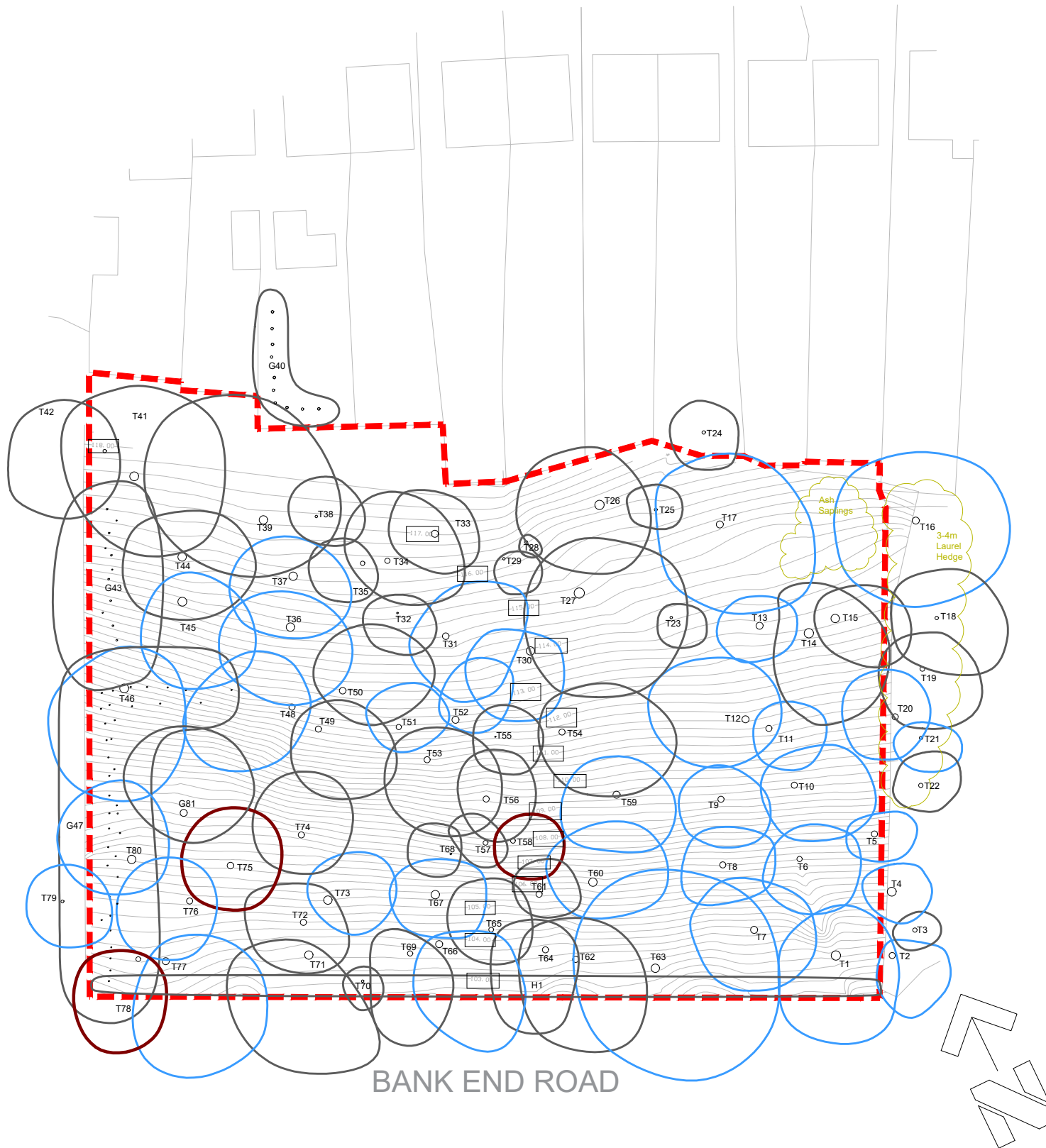

TREE SURVEY TO BS5837:2012

KEY COLOUR	QUALITY	DESCRIPTION
GREEN	A: HIGH	Vigorous healthy good form, visually important, historic or rare
BLUE	B: MODERATE	Slightly impaired condition, numerous immature, A' potential
GREY	C: LOW	Adequate condition requiring minimal surgery
RED	U: FELL	Dead dying, dangerous insecure rooting, significant fungal disease
GREEN	SHRUBS	

SUB-CATEGORY:

- 1 ARBORICULTURAL
- 2 LANDSCAPE
- 3 CULTURAL/CONSERVATION

--- Site Boundary

In accordance with BS5837:2012 'Trees in relation to design, demolition and construction', offsite trees within a distance equal to 12x stem diameter from boundary should be surveyed. In accordance with good working practice, all trees within 12m of the site boundary have been surveyed.

The original of this drawing is produced in colour - a monochrome copy should not be relied upon.

LIMITATION OF THIS SURVEY
This survey records amenity quality and desirability of tree retention in relation to proposed construction by visual inspection from ground level where accessible.

It does not constitute a Tree Inspection or detailed report on condition.

Tree heights and spread approximate. The diameter of single stem trees is taken at 1.5m above ground level. For the diameter of multistemmed trees, each multistem is measured at 1.5m above ground level and calculated to give a notional diameter as if all multistems were fused into one stem.

The branch spread is an accurate representation of the crown as clause 4.4.2.5 (e)

Tree inspections should take place annually in September/October when trees are in leaf.

Several trees have girdling damage by wire or rope garotting. This is noted where visible. There may be other girdling damage not visible due to density of shrubberies. Detailed inspection of retained trees should be carried out at time of site clearance.

Based on Star Surveys Topographic Survey drawing no. 2966/19 rec'd OCT 2019

Weddle Landscape Design
LANDSCAPE ARCHITECTURE
ENVIRONMENTAL PLANNING
Mews Studio, Charnwood House, Tel (0114) 250 1181
8 Kenwood Bank, Sheffield S7 1NU Fax (0114) 250 1188
www.weddles.co.uk mail@weddles.co.uk

Job BANK END ROAD, BARNSELEY

Title TREE SURVEY

scale	drawn	date	job number	number	revision
1:500	TH	JAN 20	1001	003	-