

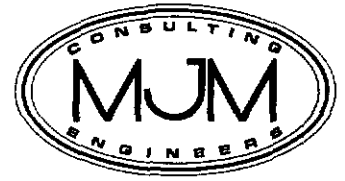

**GP PRACTICE
OAK HAVEN AVENUE
GREAT HOUGHTON
TRANSPORT STATEMENT
JULY 2009**

Prepared by:
MJM Consulting Engineers Ltd
Southgate House
Southgate
Wakefield
WF1 1TL

Tel: 01924 811000
Fax: 01924 811118
Email: keithd@mjmc.co.uk



Contents

- 1.0 Introduction
- 2.0 Scope of the Study
- 3.0 *The Site, Proposed Development and Existing Transport Infrastructure*
- 4.0 Proposed Operations and Traffic Impact
- 5.0 Conclusions

Figures

- Figure 1 - Bus Stop Location Plan
- Figure 2 - AM Peak Hour Traffic Flows
- Figure 3 - PM Peak Hour Traffic Flows
- Figure 4 - Visitors Car Park Accumulation Analysis

Appendices

- Appendix A - Location Plan
- Appendix B - Proposed Layout Plans
- Appendix C - Bus Services Information
- Appendix D - Traffic Count Data

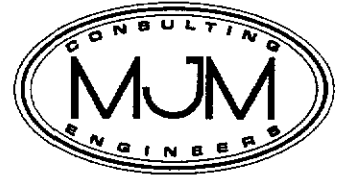

1.0 Introduction

- 1.1 MJM Consulting Engineers Ltd have been appointed by Morgan Ashurst to provide a Transport Statement in support of the proposals to build a 314.5 sq m GP Practice (GPP) on land accessed off Oak Haven Avenue in Great Houghton near Barnsley to replace the existing GP Practice building that currently occupies on the site, as shown on plans in Appendix A and B.
- 1.2 The proposed scheme will provide improved facilities for the existing medical practice currently operating from the site.
- 1.3 Early consultations were sought place with the Planning and Highway Authority to agree the scope of the information required to support the application. See Section 2.0.
- 1.4 To provide a clear understanding of the existing and proposed traffic movements local to the proposed development access, a survey was undertaken on the 13th March 2009 between the periods of 0730 – 0930 and 1500 - 1900.

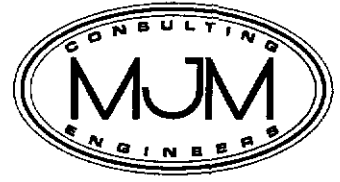

2.0 Scope of the Study

2.1 Discussions with the Development Control officers at Barnsley Metropolitan Borough Council (BMBC) indicated that the following issues need to be assessed in a Transport Statement to accompany the planning application for the proposed development:-

- Base level traffic
- Traffic generation
- Traffic distribution
- Car parking levels
- Oak Haven Avenue/High Street junction layout
- Refuse collection
- Cycle parking

2.2 It was agreed that capacity assessment of the junction of Oak Haven Avenue and High Street were not necessary at the initial stage but may be required dependent on the levels of the existing and predicted traffic flows.

2.3 There is also a requirement to provide a Travel Plan Framework and this is to be submitted as a separate document with the planning application.

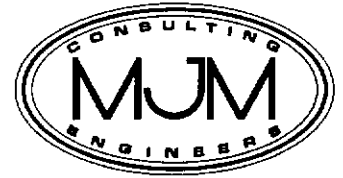

3.0 The Site, Proposed Development and Existing Transport Infrastructure

3.1 Site Location

- 3.1.1 The location of the site in relation to the local transport network and nearby residential areas of Great Houghton is as shown on the plan in Appendix A.
- 3.1.2 The proposed location for the development is central to the patient catchment area of Great Houghton.
- 3.1.3 The main site access road is Oak Haven Avenue which is adopted and maintained by the Highway Authority. It is 4.5m wide, subject to a 30mph speed limit and road lighting is provided.
- 3.1.4 On both sides of Oak Haven Avenue surfaced footways are provided and these link to footways on High Street.
- 3.1.5 Access to Oak Haven Avenue from the local highway network is via High Street which is subject to a 30mph speed limit, traffic speeds are also limited by traffic calming features on High Street.
- 3.1.6 On-street parking is allowed outside the residential properties adjacent the site on Oak Haven Avenue and there are also no waiting restrictions in force on High Street.
- 3.1.7 There are no dedicated cycle route facilities local to the development however BMBC's Cycling Guide 5 designates High Street as part of the circular cycle route between Thurnscoe, Clayton and Great Houghton.

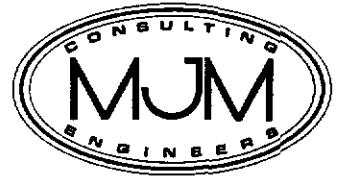

3.2 *Description of the Proposed Development*

- 3.2.1 The proposed development is for a GP Practice of 314.5sq m GFA will operate from Monday to Friday with times varying from 0830 – 1100 to 0830 – 1930.
- 3.2.2 The proposal is to provide 9 parking spaces for staff and visitors, with 1 being allocated for disabled parking.
- 3.2.3 Visibility splays for the patient car park access at its junction with Oak Haven Avenue are 2.4 x 20m.
- 3.2.4 Works within the adopted highway will be required to form the reconfigured car park entrance.
- 3.2.5 Cycle parking areas are to be provided for both visitors and staff sufficient for 3 cycles as indicated on the Architects' site layout plan in Appendix B.
- 3.2.6 A secure bin store is located adjacent to the facility and refuse collections will be undertaken from the roadside as per the existing scenario.

3.3 *Existing Transport Infrastructure*

- 3.3.1 A number of bus services operate on High Street and the nearest bus stops is located on High Street approximately 65 distance respectively from the entrance of the proposed GP Practice and a total of 4 bus stops are located within 500m of the site. The schedule of services is as summarised in Table 3.3 and the bus stop locations are as indicated in Figure 1.

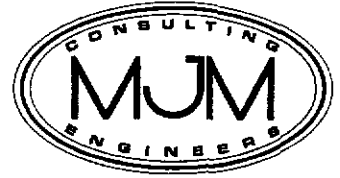

Table 3.3

Service No.	Route	Operator
68	Barnsley – Great Houghton	Stagecoach
219	Barnsley – Doncaster	Stagecoach

3.3.2 The proposed GPP would therefore be reasonably well served by buses with 5 services per hour full details are as shown in Appendix C. The frequency of services provided on these routes are likely to be attractive for use by both staff and visitors.

3.4 Traffic Count Data

3.4.1 In order to ascertain current traffic movements along High Street and at the junction with Station Road a fully classified turning count was undertaken on the 13th March 2009 between the hours 0730 - 0930 and 1500 - 1900. The full count data is attached at Appendix D.

3.4.2 Analysis of the count data indicates that the AM and PM peak hour traffic flows for the Oak Haven Avenue/High Street junction occur between 0815 - 0915 hours and 1630 - 1730 hours respectively. For High Street in the AM peak, there were 567 two way vehicle movements and for Oak Haven Avenue there were 51 two way vehicle movements.

For High Street in the PM peak, there were 659 two way vehicle movements and for Oak Haven Avenue there were 59 two way vehicle movements. The AM and PM peak hour traffic flows are as shown on Figures 2 and 3.

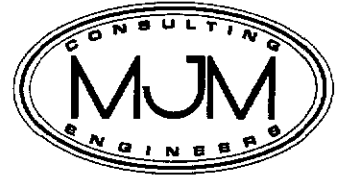

4.0 Proposed Operations and Traffic Impact

4.1 The Proposed Operations

4.1.1 The proposed operations schedule between the hours of 0800 and 1930 is as shown below in Table 4.1. Appointments are scheduled over a 4 hour period in the AM and PM sessions.

Table 4.1

	Mon am/pm	Tue am/pm	Wed am/pm	Thu am/pm	Fri am/pm
GP1	1S 20P 10C	1S 20P 10C	1S 20P 10C	1S 20P 10C	1S 20P 10C
District Nurse	1S	1S	1S	1S	1S
Practice Nurse	1S 20P 10C	1S 20P 10C	1S 20P 10C	1S 20P 10C	1S 20P 10C
Health Visitors	1S 25 P/C	1S 25 P/C	1S 25 P/C	1S 25 P/C	1S 25 P/C
Midwife	1S 15P 10C	1S 15P 10C	1S 15P 10C	1S 15P 10C	1S 15P 10C
S = Staff P = Patient C = Carer / Relative					

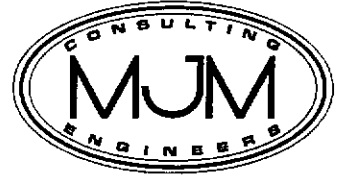

- 4.1.2 In addition to the above the GP practice will employ 2 full time administration staff and 6 part – time reception staff.
- 4.1.3 The new facility will regenerate the locality and consultations are underway with the users from the Great Houghton area to identify the types of services they would wish to see from the new centre and how the centre could be utilised within the community.

4.2 *Generated Traffic and Access Design*

- 4.2.1 On the basis of the activity schedule shown in Table 4.1 the number of visits per day can be calculated as follows:-

GP carrying out 40 consultations over 8 hour period = 40 patient appointments per day.

1 Practice Nurses carrying out 40 consultations over 8 hour period = 40 patient appointments per day.

Health Visitor carrying out 50 consultations in total over 8 hour period = 50 patient appointments per day.

Midwife carrying out 30 consultations in total over 8 hour period = 30 patient appointments per day.

Total visits per day = 160 which equates to an average of 20 per hour excluding staff.



4.3 *Car park demand*

4.3.1 Based on the proposed operations schedule set out in para 4.1.1 above an assessment of the demand for the visitor's car park has been undertaken and the results of this assessment are as shown in Figure 4.

4.3.2 The following assumptions were made in the assessment of the demand for the visitor's car park:-

- All visitors arrive by car
- All visitors arrive 5mins early for appointments
- AM and PM sessions are 4 hours duration
- Duration of stay averages between 20 to 30 mins
- Minimum predictions assume no delays
- Maximum predictions assume slight delays in appointment system

4.3.3 Based on the worst case assumptions above the analysis indicates that a demand of between 9 and 11 spaces will be required. These are currently catered for in the form of on-street parking, but the proposals provide 9 parking spaces including 1 disabled and therefore will provide significant reduction on parking congestion on Oak Haven Avenue. Additionally, whilst it is expected that a percentage of trips will be by other modes of transport this will be subject to both seasonal and daily variations.

4.3.4 Further assessment of the maximum parking standards using the guidance in SPD32 part of the Barnsley UDP document results in a maximum allowance of 23 spaces. The current PPG13 guidance seeks to address these issues by the introduction of Travel Plan Frameworks and in order to meet the Government objectives in that respect the operators of the proposed GPP are endorsing the measures detailed in the Travel Framework Plan for this application.



4.3.5 All of the assessment methods confirm that the proposed parking provision is commensurate with the scale and operations of the proposed GPP.

4.3.6 There is no specific guidance for parking standards at Health Care Facilities in PPG13.

4.4 *Cycle Parking Demand and Provision*

4.4.1 A total of 3 cycle racks are to be provided, 1 for use by staff and 2 for use by visitors. Staff demand has not yet been established, but staff surveys at the existing GP practice are being undertaken so that the data can be used in the Travel Plan Framework document.

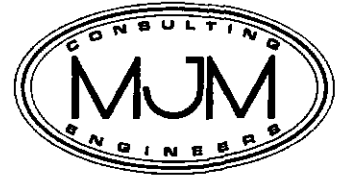

5.0 Conclusions

- 5.1 The proposals embrace the stated aims of PPG13 in that the GPP is positioned centrally in Great Houghton, thereby reducing the requirement to travel by car for both patients and staff. Additionally, the proposals do not change the existing site usage.
- 5.2 The GPP is well served by public transport with 5 buses per hour on High Street which will be attractive to both patients and staff.
- 5.3 The provision of cycle racks and the central positioning of the proposed GPP will encourage more journeys to be made by bicycle.
- 5.4 The proposed GPP is located centrally to the catchment area and is well linked by surfaced and well lit footways, therefore it is to be expected that the existing high proportion of visits on foot will be maintained.
- 5.5 The existing GP practice on the site has minimal off road parking facilities hence there will be reduced on-street parking and pedestrian crossing movements in the current location and this will improve safety for all road users in the locality.
- 5.6 The proposals seek to provide a new surgery for the existing GP Practice. As such there will be no increase in trip generation over the existing and therefore no mitigation measures are proposed.
- 5.7 It is considered that the proposals are in accordance with existing and emerging transport related policies and that there is no demonstrable harm to other road users or the highway network.

On this basis there are considered to be no traffic or transport related reasons why the proposals should not be granted planning permission.



FIGURES 1 TO 4



FIGURE 1 - BUS STOP LOCATION PLAN

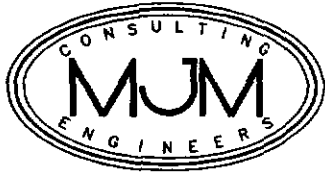

MJM CONSULTING ENGINEERS LTD
Southgate House
Southgate, Wakefield
United Kingdom, WF1 1TL
Tel: 01924 811000 Fax 01924 811118

E-mail: info@mjmc.co.uk
Web: www.mjmc.co.uk
Company Registration Number 2545894

CIVIL & STRUCTURAL GEOTECHNICAL & ENVIRONMENTAL TRAFFIC & HIGHWAYS

Project
Great Houghton GP Practice
Barnsley

Scale
NTS

Date
April 09 CAS

Client
Morgan Ashurst

Path
4672\High\Traffic Calcs

Project No
4672

Draw Title
AM Peak Hour Traffic Flow Diagram
0815 - 0915

Draw No
Figure 2

© THIS DRAWING MAY NOT BE COPIED WITHOUT PRIOR WRITTEN PERMISSION
DO NOT SCALE FROM THIS DRAWING, IF IN DOUBT ASK

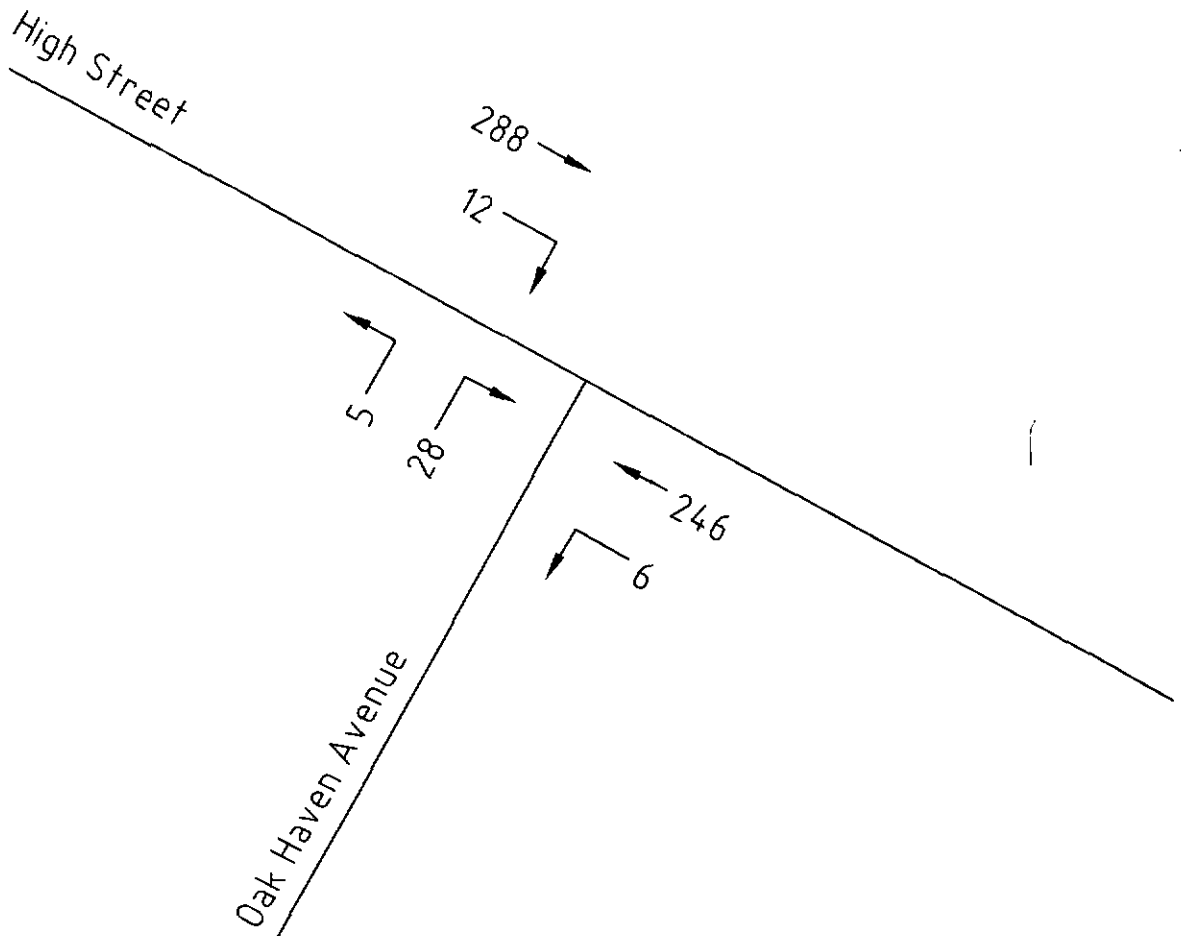

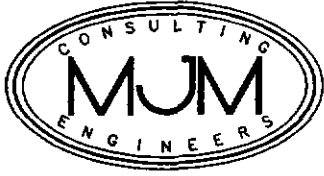

MJM CONSULTING ENGINEERS LTD
Southgate House
Southgate, Wakefield
United Kingdom, WF1 1TL
Tel: 01924 811000 Fax 01924 811118

E-mail: info@mjmc.co.uk
Web: www.mjmc.co.uk

Company Registration Number 3162694

CIVIL & STRUCTURAL GEOTECHNICAL & ENVIRONMENTAL TRAFFIC & HIGHWAYS

Project
Great Houghton GP Practice
Barnsley

Scale
NTS

Date
April 09 CAS

Client
Morgan Ashurst

Path
4672\High\Traffic Calcs

Project No
4672

Draw Title
PM Peak Hour Traffic Flow Diagram
1630 - 1730

Draw No
Figure 3

© THIS DRAWING MAY NOT BE COPIED WITHOUT PRIOR WRITTEN PERMISSION
DO NOT SCALE FROM THIS DRAWING, IF IN DOUBT ASK

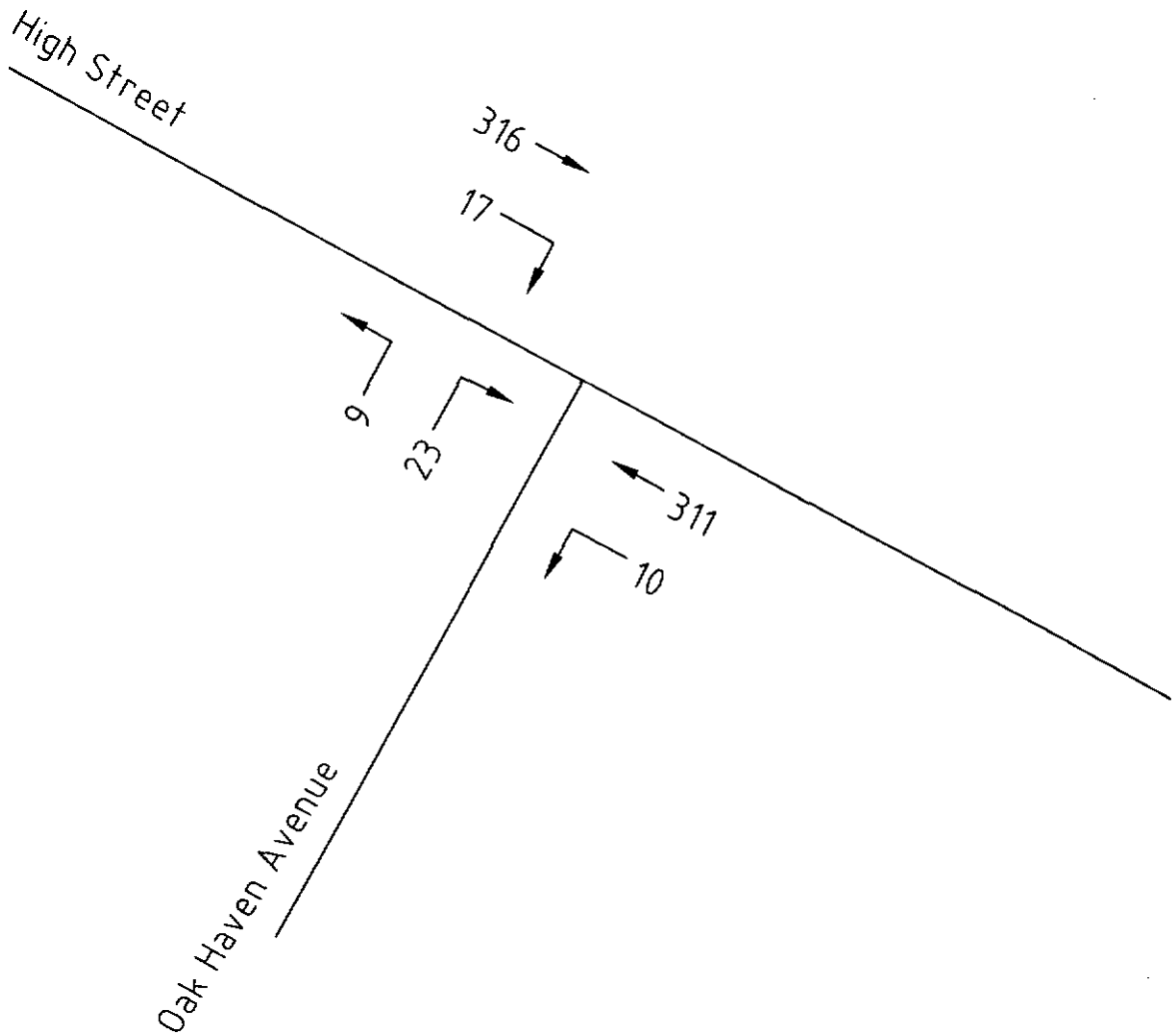

GREAT HOUGHTON CAR PARK ACCUMULATION

Assumptions

1. All patients arrive by car
2. 20-30 min cycle per patient
3. Patients arrive 5 mins early

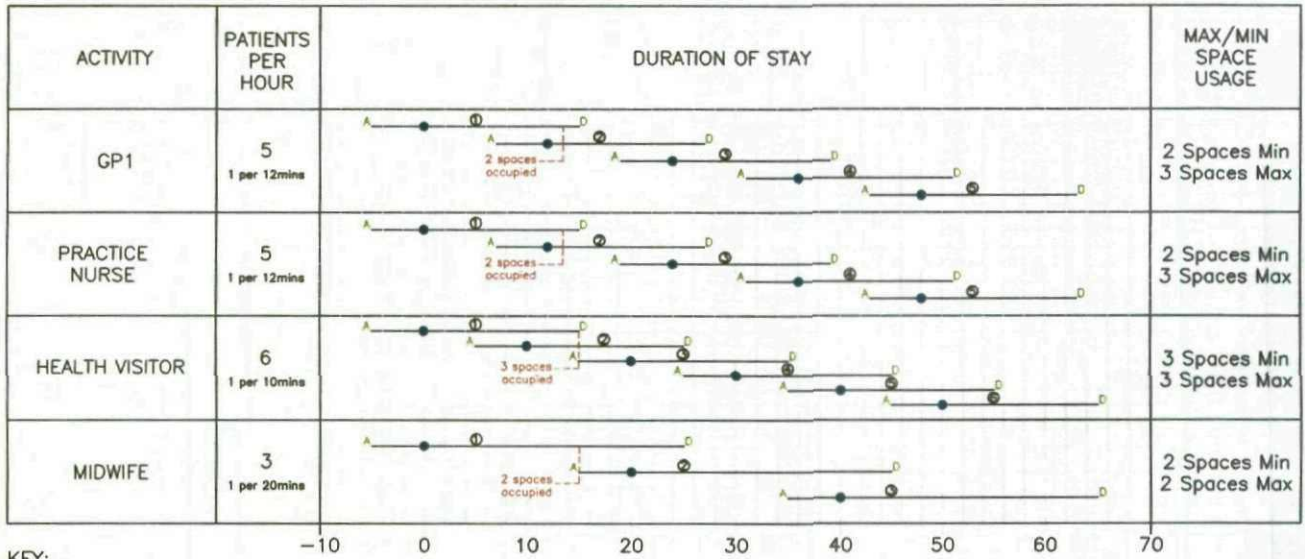

KEY:

- Appointment time
- ▲ Arrival time
- ◻ Departure time
- ⊙ Appointment number

-10 0 10 20 30 40 50 60 70

APPOINTMENTS INTERVAL (MINS)

AM & PM SESSION STARTS

TOTAL PATIENTS SPACES = 8 MIN PARKING DEMAND = 9
MAX PARKING DEMAND = 11

FIGURE 4



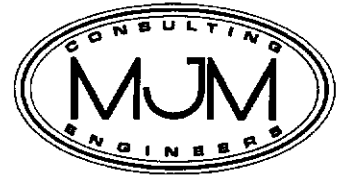

APPENDIX A

LOCATION PLAN

HDP

The Healthcare
Design
Partnership

www.hdpi.co.uk

1 Merchant's Quay
Ashley Lane
Shipley
West Yorkshire
BD17 7DB

Tel: (01274) 539900
Fax: (01274) 987642
Email: enquiries@hdp.co.uk

Also Located At:
11 Victoria Road
Salford
Tel: (01274) 207790

Project
**GREAT HOUGHTON
MEDICAL CENTRE**

Client
MORGAN ASHURST

Title
SITE LOCATION PLAN

Drawn	Scale	Date	Checked
OS	1:1250	APR 09	MD
Job No.	Dwg.No.	Rev.	
120	(10) 001		

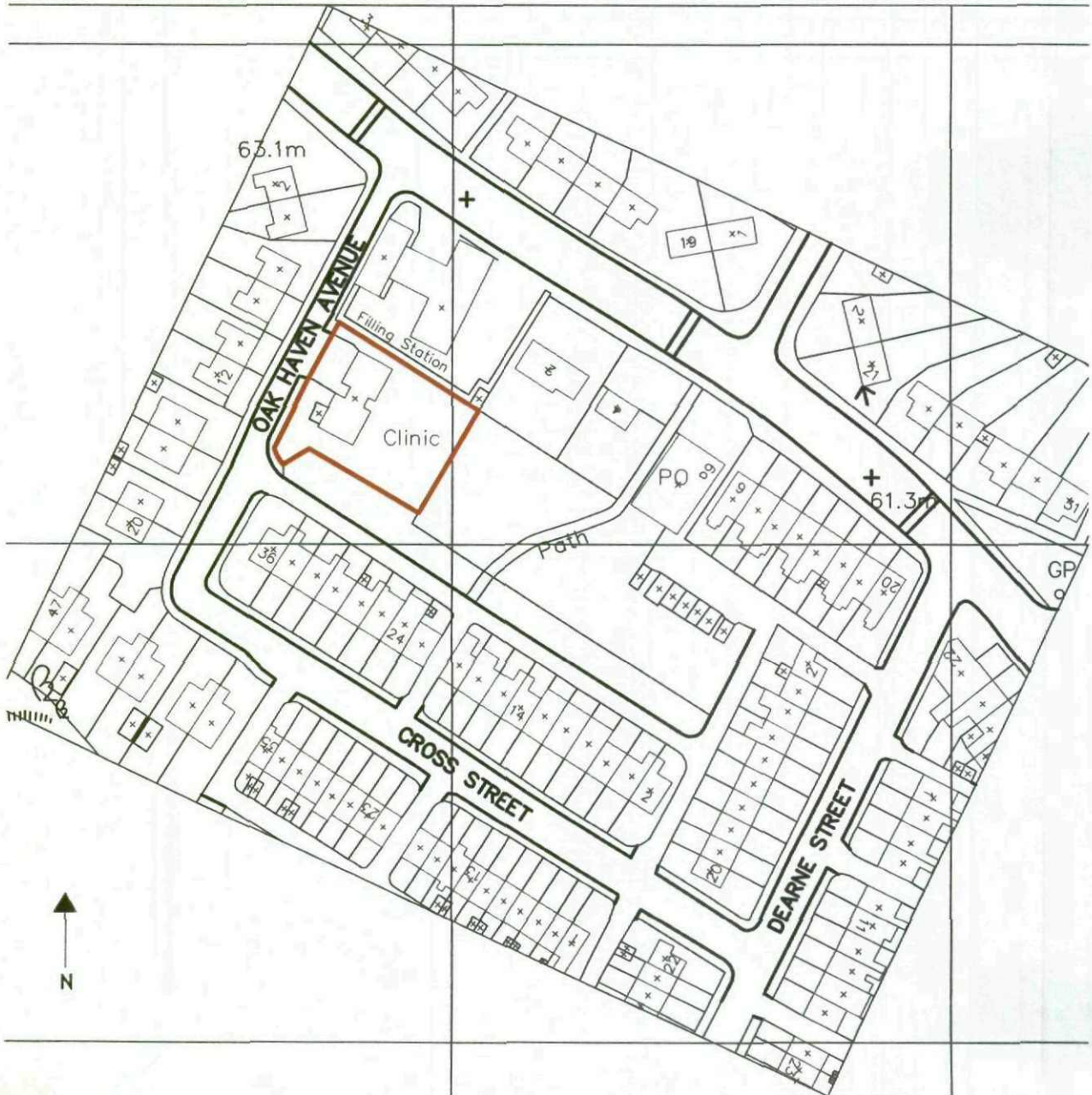

NOTES

- 1 ALL WORK TO BE CARRIED OUT IN ACCORDANCE WITH THE BUILDING REGULATIONS AND THE REQUIREMENTS OF THE LOCAL AUTHORITY.
- 2 NO DIMENSIONS TO BE SCALED FROM THIS DRAWING.
- 3 THE CONTRACTOR SHALL VERIFY ALL LEVELS AND DIMENSIONS ON SITE BEFORE COMMENCEMENT OF WORK.
- 4 ON SITE ALTERATIONS TO THE CONSTRUCTION OR FINISHES SHOWN OR IMPLIED ON THIS DRAWING MUST BE DRAWN TO THE ATTENTION OF THE ARCHITECT BEFORE SUCH WORK IS IMPLEMENTED.

© COPYRIGHT RESERVED

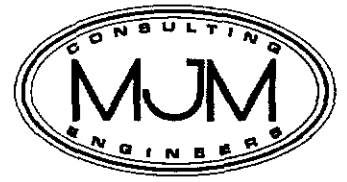

APPENDIX B

PROPOSED LAYOUT PLANS

NOTES

- 1 ALL WORK TO BE CARRIED OUT IN ACCORDANCE WITH THE BUILDING REGULATIONS AND THE REQUIREMENTS OF THE LOCAL AUTHORITY.
 - 2 NO DIMENSIONS TO BE SCALED FROM THIS DRAWING.
 - 3 THE CONTRACTOR SHALL VERIFY ALL LEVELS AND DIMENSIONS ON SITE BEFORE COMMENCEMENT OF WORK.
 - 4 ON SITE ALTERATIONS TO THE CONSTRUCTION OR FINISHES SHOWN OR IMPLIED ON THIS DRAWING MUST BE DRAWN TO THE ATTENTION OF THE ARCHITECT BEFORE SUCH WORK IS IMPLEMENTED.
- © COPYRIGHT RESERVED

PARKING LAYOUT UPDATED
- ADDITIONAL CAR SPACE
- DISCUSSED MTG. 23/06/09

PARKING LAYOUT UPDATED
TITLE CHANGED FROM SITE
LOCATION PLAN

UPDATED DUE TO PLAN
ALTERNATIONS.

BIN STORE AND CYCLE RACK
RELOCATED FURTHER TO DISCUSSION
WITH USERS OF 22.01.09

Revision	date	checked	no
JUNE 09	MD	D	
APR 09	MD	C	
MAR 09	MD	B	
JAN 09	MT	A	

PRELIMINARY ISSUE

Project
**GREAT HOUGHTON
MEDICAL CENTRE**

Client
MORGAN ASHURST

HDP
The Healthcare
Design
Partnership

11 Moorpark Road
Salford
Tel: 01274 207150
Fax: 01274 207140
Email: enquiries@hdp.co.uk

Title
SITE LAYOUT PLAN

Drawn	Scale	Rev.
RVF/TSO	1:500 @ A3	D
Checked	Date	
	JAN 09	
Job No.	Dwg. No.	
120 ALT	(12) 001	

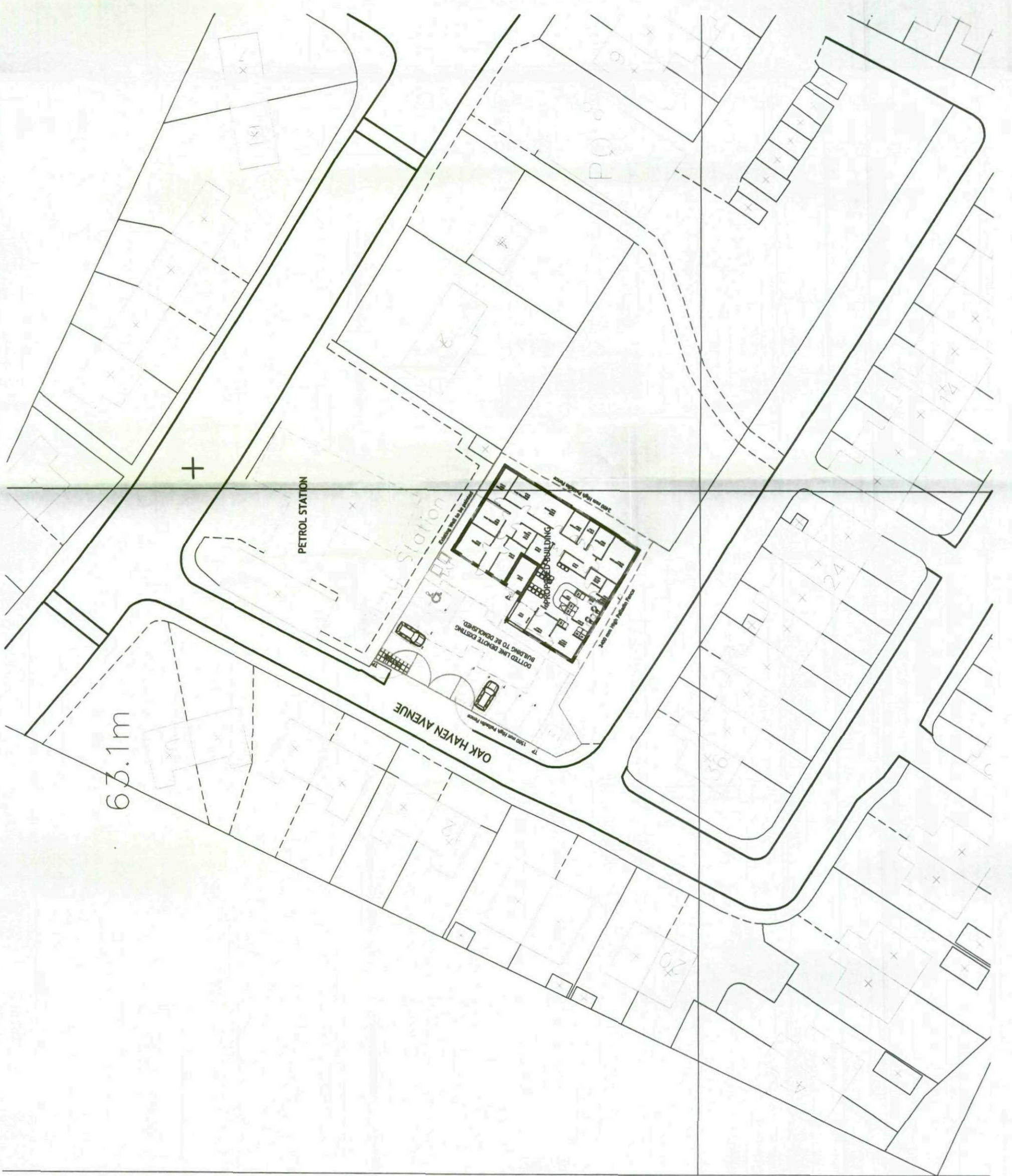

Existing PFS Entry/Exit

PETROL STATION

Existing PFS Entry/Exit

New Buff coloured facilities with dropped kerbs to improve pedestrian facilities. Footway to be reshaped to new levels

2.4 x 7m Visibility Splay

Bin Store

MAIN ENTRANCE

Cycle Parking

KEY:

- New Full Depth Footway Construction
- Existing footway bituminous layers removed, reshape sub-base to new levels and resurfaced

Rev	Date	Amendment	slc	CAS
B	30.06.09	Car park layout amended to suit HDP latest drawing.		
A	03.04.09	Tactile Paving and notes updated		

MJM CONSULTING ENGINEERS LTD
 Southgate House
 United Kingdom, WF1 1TL
 Tel: 01924 811000 Fax: 01924 811118
 E-mail: info@mjmc.co.uk
 Web: www.mjmc.co.uk

CONSULTING ENGINEERS

CIVIL & STRUCTURAL GEOTECHNICAL & ENVIRONMENTAL TRAFFIC & HIGHWAYS

Project	Comments
Great Houghton Medical Centre	Pricing/Preliminary
	Contract/Construction
	Left Corret. Issue
	H.A. Approved

Client: **Morgan Ashurst**

Dwg Title: **Proposed Layout**

Scale	1:250 @ A3	CAS	✓
Date	March 09	Path	4672\High\Sketches
Project No	4672	Dwg No	SK100
		Rev	B

DO NOT SCALE FROM THIS DRAWING. IF IN DOUBT ASK THE DRAWING MAY NOT BE COPIED WITHOUT PRIOR WRITTEN PERMISSION



APPENDIX C

BUS SERVICES INFORMATION



68 68A 69

Full Timetable

Barnsley
Wombwell
Low Valley
Darfield
Billingley
Middlecliffe
Little Houghton
Great Houghton

Also serves:
Kendray Hospital

From 26/01/2008

In partnership with:



What's changed

From Saturday 26 January 2008, changes will be made to the route and times of services 68, 68A and 69.

The change of route affects journeys in Darfield.

The timetable changes affect all of these services to improve the reliability of the services and on services 68 and 68A journeys will operate approximately 5 minutes earlier throughout.

Hail & Ride

Service 69

Along part of the route you can stop the bus at any safe and convenient point - but please avoid parked vehicles and road junctions.

You can Hail & Ride service 69 along the following sections of the route:

Darfield: Bellbrooke Avenue
Rose Avenue
Edderthorpe Lane

68 68A Barnsley ▶ Great Houghton

From:
BARNSELY,
Interchange via

Eldon Street North
Eldon Street
Market Hill
Shambles Street
West Way
Sheffield Road
Taylor Row
Doncaster Road

KENDRAY

STAIRFOOT

Wombwell Lane
Barnsley Road
Aldham House Lane
Pearson Crescent
Aldham House Lane
Summer Lane
Newsome Avenue

Wilson Street
Barnsley Road

WOMBWELL

High Street
Station Road
Stonyford Road

LOW VALLEY

George Street
Snape Hill Road
Garden Street

DARFIELD

Nanny Marr Road

▼
Doncaster Road
Cathill Roundabout
Rotherham Road
MIDDLECLIFFE
Middlecliffe Lane
LITTLE HOUGHTON
Middlecliffe Lane
Rotherham Road
High Street

To :
GREAT HOUGHTON,
Lister Row

*In Darfield service 68A
operates via Upperwood
Road and Barnsley
Road instead of Garden
Street.

*Between Cathill
Roundabout and
Rotherham Road
some journeys serve
Dearne Valley Parkway,
Billingley Green Lane,
BILLINGLEY, High Street
and West Kirk Lane.

68 68A Great Houghton ▶ Barnsley

From:
GREAT HOUGHTON,
Lister Row via

High Street
Rotherham Road
MIDDLECLIFFE
Cathill Roundabout
Doncaster Road
Nanny Marr Road

DARFIELD

Garden Street
Snape Hill Road

George Street

LOW VALLEY

Stonyford Road
Station Road

High Street

WOMBWELL

Barnsley Road
Wilson Street
Newsome Avenue
Summer Lane

Aldham House Lane

Pearson Crescent

Aldham House Lane

Barnsley Road

Wombwell Lane

STAIRFOOT

KENDRAY

Doncaster Road

Taylor Row

Sheffield Road

▼
West Way
Shamble Street
St. Mary's Place
Sadler Gate
Church Street
Regent Street
Eldon Street
Eldon Street North

To :
BARNSELY,
Interchange

*Certain 68, 68A
journeys travel via
Kendray Street and
Harborough Hill Road,
into and out of Barnsley
Interchange.

69 Barnsley ▶ Darfield ▶ Barnsley

From:
BARNESLEY,
Interchange via

Sheffield Road
Taylor Row
Doncaster Road
KENDRAY
STAIRFOOT
Wombwell Lane
Barnsley Road
Aldham House Lane
Pearson Crescent
Aldham House Lane
Summer Lane
Newsome Avenue
Wilson Street
Barnsley Road
WOMBWELL
High Street
Station Road
Stonyford Road
LOW VALLEY
George Street
Snape Hill Road
Upperwood Road
Barnsley Road
Saltersbrook Road
DARFIELD
Bellbrooke Avenue
Edderthorpe Lane
Rose Avenue
Saltersbrook Road

▼
Nanny Marr Road
Illesley Road
Morrison Road
Bly Road
DARFIELD
Barnsley Road
Upperwood Road
Snape Hill Road
George Street
LOW VALLEY
Stonyford Road
Station Road
High Street
WOMBWELL
Barnsley Road
Wilson Street
Newsome Avenue
Summer Lane
Aldham House Lane
Pearson Crescent
Aldham House Lane
Barnsley Road
Wombwell Lane
STAIRFOOT
KENDRAY
Doncaster Road
Taylor Row
Sheffield Road
Harborough Hill Road

69 Barnsley ▶ Darfield ▶ Barnsley

▼
Kendray Street
Interchange Way
Eldon Street North

To:
BARNESLEY,
Interchange

68, 68A, 69 ▶ Monday to Saturday

Barnsley ▶ Great Houghton ▶ Barnsley

Service number:	68A	68A	68A	68	68A	69	68	69	68	69	68	69	68	
See notes:	NS					NS								
Barnsley, Interchange	-	-	-	0700	-	-	-	0840	0905	0940	1005	1040	1105	
Wombwell, Pearson Cres/Wortley Ave	-	-	-	0713	-	-	-	0855	0920	0955	1020	1055	1120	
Wombwell, Post Office	-	-	-	0720	-	-	-	0904	0929	1004	1029	1104	1129	
Darfield, The Longbow	-	-	-	-	-	-	-	-	-	-	-	-	-	
Darfield, The Foulstone School	-	-	-	0727	-	-	-	-	0936	-	1036	-	1136	
Billingley, High Street	-	-	-	-	-	-	-	-	-	-	1043	-	-	
Middlecliffe, Little Houghton Post Office	-	-	-	0732	-	-	-	-	0942	-	-	-	1142	
Little Houghton, Ings Lane	-	-	-	-	-	-	-	-	0943	-	-	-	1143	
Great Houghton, Lister Row	-	0600	0700	0736	0739	-	0849	-	0949	-	1049	-	1149	
Middlecliffe, Little Houghton Post Office	-	0604	0704	-	0743	-	0854	-	0954	-	1054	-	1154	
Darfield, Nanny Marr Road/School Street	0507	0607	0707	-	0749	-	0859	-	0959	-	1059	-	1159	
Darfield, The Foulstone School	0508	0608	0708	-	0750	-	0900	-	1000	-	1100	-	1200	
Darfield, Barnsley Road	-	-	-	-	-	-	-	0912	-	1012	-	1112	-	
Darfield, Bellbrooke Avenue/Rose Avenue	-	-	-	-	-	0817	-	0917	-	1017	-	1117	-	
Darfield, Morrison Road/Clarehurst Road	-	-	-	-	-	0821	-	0921	-	1021	-	1121	-	
Darfield, The Longbow	0510	0610	0710	-	0754	0824	-	0924	-	1024	-	1124	-	
Wombwell, Post Office	0516	0616	0716	-	0803	0833	0908	0933	1008	1033	1108	1133	1208	
Wombwell, Pearson Cres/Wortley Ave	0523	0623	0723	-	0812	0842	0917	0942	1017	1042	1117	1142	1217	
Barnsley, Interchange	0537	0637	0737	-	0828	0858	0933	0958	1033	1058	1133	1158	1233	

68, 68A, 69 ▶ Monday to Saturday (continued)

Barnsley ▶ Great Houghton ▶ Barnsley

Service number:	69	68	69	68	69	68	68	69	68A	68	69	69	68A
See notes:						SD S SH		S SH SD					
Barnsley, Interchange	1140	1205	1240	1305	1340	1405	1405	1440	1505	-	1540	-	1605
Wombwell, Pearson Cres/Wortley Ave	1155	1220	1255	1320	1355	1420	1420	1455	1520	-	1555	-	1620
Wombwell, Post Office	1204	1229	1304	1329	1404	1429	1429	1504	1529	-	1604	-	1629
Darfield, The Longbow	-	-	-	-	-	-	-	-	1537	-	-	-	1637
Darfield, The Foulstone School	-	1236	-	1336	-	1436	1436	-	1541	-	-	-	1641
Billingley, High Street	-	1243	-	-	-	-	1443	-	-	-	-	-	1648
Middlecliffe, Little Houghton Post Office	-	-	-	1342	-	1442	-	-	1547	-	-	-	-
Little Houghton, Ings Lane	-	-	-	1343	-	1443	-	-	1548	-	-	-	-
Great Houghton, Lister Row	-	1249	-	1349	-	1449	1449	-	1554	1554	-	-	1654
Middlecliffe, Little Houghton Post Office	-	1254	-	1354	-	-	1454	-	-	1559	-	-	-
Darfield, Nanny Marr Road/School Street	-	1259	-	1359	-	-	1459	-	-	1604	-	-	-
Darfield, The Foulstone School	-	1300	-	1400	-	-	1500	-	-	1605	-	-	-
Darfield, Barnsley Road	1212	-	1312	-	1412	-	-	1512	-	-	1612	-	-
Darfield, Bellbrooke Avenue/Rose Avenue	1217	-	1317	-	1417	-	-	1517	-	-	1617	1627	-
Darfield, Morrison Road/Clarehurst Road	1221	-	1321	-	1421	-	-	1521	-	-	1621	1631	-
Darfield, The Longbow	1224	-	1324	-	1424	-	-	1524	-	-	1624	1634	-
Wombwell, Post Office	1233	1308	1333	1408	1433	-	1508	1533	-	1613	1633	1643	-
Wombwell, Pearson Cres/Wortley Ave	1242	1317	1342	1417	1442	-	1517	1542	-	1622	1642	1658	-
Barnsley, Interchange	1258	1333	1358	1433	1458	-	1533	1558	-	1638	1658	1708	-

68, 68A, 69 ▶ Monday to Saturday (continued)

Barnsley ▶ Great Houghton ▶ Barnsley

Service number:	68	69	68A	68	69
See notes:		NS			NS
Barnsley, Interchange	-	1650	1720	-	1750
Wombwell, Pearson Cres/Wortley Ave	-	1705	1735	-	1805
Wombwell, Post Office	-	1714	1744	-	1814
Darfield, The Longbow	-	-	1752	-	-
Darfield, The Foulstone School	-	-	1756	-	-
Billingley, High Street	-	-	-	-	-
Middlecliffe, Little Houghton Post Office	-	-	1802	-	-
Little Houghton, Ings Lane	-	-	1803	-	-
Great Houghton, Lister Row	1654	-	1809	1809	-
Middlecliffe, Little Houghton Post Office	1659	-	-	1814	-
Darfield, Nanny Marr Road/School Street	1704	-	-	1819	-
Darfield, The Foulstone School	1705	-	-	1820	-
Darfield, Barnsley Road	-	1722	-	-	1822
Darfield, Bellbrooke Avenue/Rose Avenue	-	1727	-	-	1827
Darfield, Morrison Road/Clairehurst Road	-	1731	-	-	1831
Darfield, The Longbow	-	1734	-	-	-
Wombwell, Post Office	1713	1743	-	1828	-
Wombwell, Pearson Cres/Wortley Ave	1722	1752	-	1837	-
Barnsley, Interchange	1738	1808	-	1853	-

Notes: NS - Not Saturday, SD - Schooldays Only, S - Saturday only, SH - School Holidays Only



219

Full Timetable

- Barnsley
- Stairfoot
- Darfield
- Great Houghton
- Thurnscoe
- Goldthorpe
- Scawsby
- Doncaster

Also serves:
Kendray Hospital
Fields End Business Park

From 19/07/2008

In partnership with:



What's changed

From Saturday 19 July 2008, changes will be made to the times of service 219 on Monday to Saturday mornings and early evenings.

On journeys from Barnsley to Doncaster, buses will run 30 minutes later in the evenings and after 1600 on Sundays.

Variations

Certain Journeys operate direct from Station Road to Briget Lane.

Barnsley ▶ Doncaster

From:

BARNSLEY,

Interchange via

Eldon Street North
Interchange Way
Kendray Street
Harborough Hill Road
Sheffield Road
Taylor Row
Doncaster Road
KENDRAY
STAIRFOOT
ARDSLEY
Barnsley Road
Upperwood Road
Snape Hill Road
Garden Street
DARFIELD
Nanny Marr Road
Saltersbrook Road
Doncaster Road
Rotherham Road
MIDDLECLIFFE
GREAT HOUGHTON
High Street
Moor Lane
High Street
Thurnscoe Lane
Houghton Road
THURNSCOE
Merrill Road
Lingamoor Leys

▼
School Street
Houghton Road
Station Road
Windsor Street
Roman Street
Briton Street
Hanover Street
Lancaster Street
Grange Crescent
Stuart Street
Lidget Lane
The Windings
Phoenix Lane
Barrowfield Road
Fields End Business
Park
Fields End Road
GOLDTHORPE
Barnsley Road
Doncaster Road
HICKLETON
Barnsley Road
MARR
SCAWSBY
St David's Drive
Kempton Park Road
Back Lane
CUSWORTH
Cusworth Lane
▼

Barnsley ▶ Doncaster (continued)

▼
York Road
St. Mary's
North Bridge Road
Church Way
Church View
Greyfriars Road

To :
DONCASTER,
Interchange

Doncaster ▶ Barnsley

From:
DONCASTER,
Interchange via

Trafford Way
North Bridge Road
St. Mary's
York Road
Cusworth Lane
CUSWORTH
Back Lane
Kempton Park Road
St David's Drive
SCAWSBY
MARR
Barnsley Road
HICKLETON
Doncaster Road
Barnsley Road
GOLDTHORPE
Fields End Road
Fields End Business
Park
Barrowfield Road
Phoenix Lane
The Windings
Lidget Lane
Windsor Street
Roman Street
Briton Street
Hanover Street
Lancaster Street
Grange Crescent

▼
Stuart Street
Lidget Lane
Station Road
Houghton Road
School Street
Lingamoor Leys
Merrill Road
THURNSCOE
Houghton Road
Thurnscoe Lane
High Street
Moor Lane
High Street
GREAT HOUGHTON
MIDDLECLIFFE
Rotherham Road
Doncaster Road
Saltersbrook Road
Nanny Marr Road
DARFIELD
Garden Street
Snape Hill Road
Upperwood Road
Barnsley Road
ARDSLEY
STAIRFOOT
KENDRAY
Doncaster Road
Taylor Row
▼

Doncaster ▶ Barnsley (continued)

▼
Sheffield Road
Harborough Hill Road
Kendray Street

To :
BARNSELY,
Interchange

219 ▶ Monday to Saturday

Barnsley ▶ Doncaster

See notes:

	NS	SD	SH										
Barnsley, Interchange	0600	0650	0720	0750	0755	0825	0855	0925	0955	1025	1055	1125	1155
Stairfoot, Post Office	0608	0658	0728	0758	0803	0833	0903	0933	1003	1033	1103	1133	1203
Ardley, Oaks Working Mens Club	0610	0702	0732	0802	0807	0837	0907	0937	1007	1037	1107	1137	1207
Darfield, Nanny Marr Road/School Street	-	-	-	0808	-	-	-	-	-	-	-	-	-
Darfield, The Foulstone School	-	-	-	0809	-	-	-	-	-	-	-	-	-
Darfield, The Longbow	-	-	-	0814	-	-	-	-	-	-	-	-	-
Darfield, The Foulstone School	0620	0713	0743	0818	0818	0848	0918	0948	1018	1048	1118	1148	1218
Darfield, Nanny Marr Road/School Street	0621	0714	0744	0819	0819	0849	0919	0949	1019	1049	1119	1149	1219
Middlecliffe, Little Houghton Post Office	0625	0719	0749	0824	0824	0854	0924	0954	1024	1054	1124	1154	1224
Great Houghton, Lister Row	0629	0721	0751	0828	0828	0858	0928	0958	1028	1058	1128	1158	1228
Thurnscoe, Merrill Road/Manor Road	0634	0730	0800	0835	0835	0905	0935	1005	1035	1105	1135	1205	1235
Thurnscoe, Hanover Street	0641	0738	0808	0843	0843	0913	0943	1013	1043	1113	1143	1213	1243
Goldthorpe, Doncaster Rd/Lockwood Rd.	0646	0744	0814	0849	0849	0919	0949	1019	1049	1119	1149	1219	1249
Hickleton, Doncaster Road/Fir Tree Close	0650	0748	0818	0853	0853	0923	0953	1023	1053	1123	1153	1223	1253
Marr, Barnsley Road/Church Lane	0654	0752	0822	0857	0857	0927	0957	1027	1057	1127	1157	1227	1257
Scawsby, Roman Ridge	0658	0756	0826	0901	0901	0931	1001	1031	1101	1131	1201	1231	1301
Scawsby, Kempton Park Rd/St Pauls Parade	0701	0759	0829	0904	0904	0934	1004	1034	1104	1134	1204	1234	1304
Doncaster, Interchange	0710	0810	0840	0915	0915	0945	1015	1045	1115	1145	1215	1245	1315

219 ▶ Monday to Saturday (continued)

Barnsley ▶ Doncaster

Barnsley, Interchange	1225	1255	1325	1355	1425	1455	1525	1555	1625	1655	1725	1755	1825
Stairfoot, Post Office	1233	1303	1333	1403	1433	1503	1533	1603	1633	1703	1733	1803	1833
Ardley, Oaks Working Mens Club	1237	1307	1337	1407	1437	1507	1537	1607	1637	1707	1737	1807	1835
Darfield, Nanny Marr Road/School Street	-	-	-	-	-	-	-	-	-	-	-	-	-
Darfield, The Foulstone School	-	-	-	-	-	-	-	-	-	-	-	-	-
Darfield, The Longbow	-	-	-	-	-	-	-	-	-	-	-	-	-
Darfield, The Foulstone School	1248	1318	1348	1418	1448	1518	1548	1618	1648	1718	1748	1818	1843
Darfield, Nanny Marr Road/School Street	1249	1319	1349	1419	1449	1519	1549	1619	1649	1719	1749	1819	1844
Middlecliffe, Little Houghton Post Office	1254	1324	1354	1424	1454	1524	1554	1624	1654	1724	1754	1823	1848
Great Houghton, Lister Row	1258	1328	1358	1428	1458	1528	1558	1628	1658	1728	1758	1827	1852
Thurnscoe, Merrill Road/Manor Road	1305	1335	1405	1435	1505	1535	1605	1635	1705	1735	1805	1833	1858
Thurnscoe, Hanover Street	1313	1343	1413	1443	1513	1543	1613	1643	1713	1743	1813	-	-
Goldthorpe, Doncaster Rd/Lockwood Rd.	1319	1349	1419	1449	1519	1549	1619	1649	1719	1749	1819	1843	1908
Hickleton, Doncaster Road/Fir Tree Close	1323	1353	1423	1453	1523	1553	1623	1653	1723	1753	1823	1847	-
Marr, Barnsley Road/Church Lane	1327	1357	1427	1457	1527	1557	1627	1657	1727	1757	1827	1851	-
Scawsby, Roman Ridge	1331	1401	1431	1501	1531	1601	1631	1701	1731	1801	1831	1855	-
Scawsby, Kempton Park Rd/St Pauls Parade	1334	1404	1434	1504	1534	1604	1634	1704	1734	1804	1834	1858	-
Doncaster, Interchange	1345	1415	1445	1515	1545	1615	1645	1715	1745	1815	1845	1908	-

219 ▶ Monday to Saturday (continued)

Barnsley, Interchange	1948	2048	2148	2248	2315
Stairfoot, Post Office	1956	2056	2156	2256	2323
Ardsley, Oaks Working Mens Club	1958	2058	2158	2258	2325
Darfield, Nanny Marr Road/School Street	-	-	-	-	-
Darfield, The Foulstone School	-	-	-	-	-
Darfield, The Longbow	-	-	-	-	-
Darfield, The Foulstone School	2006	2106	2206	2306	2333
Darfield, Nanny Marr Road/School Street	2007	2107	2207	2307	2334
Middlecliffe, Little Houghton Post Office	2011	2111	2211	2311	2338
Great Houghton, Lister Row	2015	2115	2215	2315	2342
Thurnscoe, Merrill Road/Manor Road	2021	2121	2221	2321	-
Thurnscoe, Hanover Street	-	-	-	-	-
Goldthorpe, Doncaster Rd/Lockwood Rd.	2031	2131	2231	2331	-
Hickleton, Doncaster Road/Fir Tree Close	2035	2135	2235	2335	-
Marr, Barnsley Road/Church Lane	2039	2139	2239	2339	-
Scawsby, Roman Ridge	2043	2143	2243	2343	-
Scawsby, Kempton Park Rd/St Pauls Parade	2046	2146	2246	2346	-
Doncaster, Interchange	2056	2156	2256	2356	-

Barnsley ▶ Doncaster

219 ▶ Monday to Saturday

	Doncaster ▶ Barnsley												
See notes:			NS		NS	S		NS	S				
Doncaster, Interchange	-	-	0650	0720	0750	-	0820	0850	-	0920	0950	1020	1050
Scawsby, Kempton Park Rd/St Pauls Parade	-	-	0702	0732	0802	-	0832	0902	-	0932	1002	1032	1102
Scawsby, Roman Ridge	-	-	0705	0735	0805	-	0835	0905	-	0935	1005	1035	1105
Marr, Barnsley Road/Church Lane	-	-	0709	0739	0809	-	0839	0909	-	0939	1009	1039	1109
Hickleton, Doncaster Road/Fir Tree Close	-	-	0713	0743	0813	-	0843	0913	-	0943	1013	1043	1113
Goldthorpe, Police Station	0556	0647	0717	0747	0817	0817	0847	0917	0917	0947	1017	1047	1117
Thurnscoe, Hanover Street	0600	0654	0724	0754	0824	0824	0854	0924	0924	0954	1024	1054	1124
Thurnscoe, Merrill Road/Manor Road	0606	0702	0732	0802	0832	0832	0902	0932	0932	1002	1032	1102	1132
Great Houghton, Lister Row	0612	0710	0740	0810	0840	0840	0910	0940	0940	1010	1040	1110	1140
Middlecliffe, Little Houghton Post Office	0615	0715	0745	0815	0845	0845	0915	0945	0945	1015	1045	1115	1145
Darfield, Nanny Marr Road/School Street	0619	0719	0749	0819	0849	0849	0919	0949	0949	1019	1049	1119	1149
Darfield, The Foulstone School	0621	0721	0751	0821	0851	0851	0921	0951	0951	1021	1051	1121	1151
Ardsley, Oaks Working Mens Club	0629	0732	0802	0832	0902	0902	0932	1002	1002	1032	1102	1132	1202
Stairfoot, Post Office	0631	0736	0806	0836	0906	0906	0936	1006	1006	1036	1106	1136	1206
Barnsley, Interchange	0640	0745	0815	0845	0915	0915	0945	1015	1015	1045	1115	1145	1215

219 ▶ Monday to Saturday (continued)

	Doncaster ▶ Barnsley												
Doncaster, Interchange	1120	1150	1220	1250	1320	1350	1420	1450	1520	1550	1620	1655	1725
Scawsby, Kempton Park Rd/St Pauls Parade	1132	1202	1232	1302	1332	1402	1432	1502	1532	1602	1632	1707	1737
Scawsby, Roman Ridge	1135	1205	1235	1305	1335	1405	1435	1505	1535	1605	1635	1710	1740
Marr, Barnsley Road/Church Lane	1139	1209	1239	1309	1339	1409	1439	1509	1539	1609	1639	1714	1744
Hickleton, Doncaster Road/Fir Tree Close	1143	1213	1243	1313	1343	1413	1443	1513	1543	1613	1643	1718	1748
Goldthorpe, Police Station	1147	1217	1247	1317	1347	1417	1447	1517	1547	1617	1647	1722	1752
Thurnscoe, Hanover Street	1154	1224	1254	1324	1354	1424	1454	1524	1554	1624	1654	1729	1759
Thurnscoe, Merrill Road/Manor Road	1202	1232	1302	1332	1402	1432	1502	1532	1602	1632	1702	1737	1807
Great Houghton, Lister Row	1210	1240	1310	1340	1410	1440	1510	1540	1610	1640	1710	1745	1815
Middlecliffe, Little Houghton Post Office	1215	1245	1315	1345	1415	1445	1515	1545	1615	1645	1715	1750	1820
Darfield, Nanny Marr Road/School Street	1219	1249	1319	1349	1419	1449	1519	1549	1619	1649	1719	1754	1824
Darfield, The Foulstone School	1221	1251	1321	1351	1421	1451	1521	1551	1621	1651	1721	1756	1826
Ardsley, Oaks Working Mens Club	1232	1302	1332	1402	1432	1502	1532	1602	1632	1702	1732	1807	1837
Stairfoot, Post Office	1236	1306	1336	1406	1436	1506	1536	1606	1636	1706	1736	1811	1841
Barnsley, Interchange	1245	1315	1345	1415	1445	1515	1545	1615	1645	1715	1745	1820	1850

219 ▶ Monday to Saturday (continued)

Doncaster ▶ Barnsley

See notes:						S	NS
Doncaster, Interchange	1755	1900	2000	2100	2200	2300	2300
Scawsby, Kempton Park Rd/St Pauls Parade	1805	1910	2010	2110	2210	2310	2310
Scawsby, Roman Ridge	1808	1913	2013	2113	2213	2313	2313
Marr, Barnsley Road/Church Lane	1811	1916	2016	2116	2216	2316	2316
Hickleton, Doncaster Road/Fir Tree Close	1815	1920	2020	2120	2220	2320	2320
Goldthorpe, Police Station	1819	1924	2024	2124	2224	2324	2324
Thurnscoe, Hanover Street	1825	-	-	-	-	-	-
Thurnscoe, Merrill Road/Manor Road	1833	1933	2033	2133	2233	2333	2333
Great Houghton, Lister Row	1839	1939	2039	2139	2239	2339	2339
Middlecliffe, Little Houghton Post Office	1842	1942	2042	2142	2242	2342	2342
Darfield, Nanny Marr Road/School Street	1846	1946	2046	2146	2246	-	2346
Darfield, The Foulstone School	1848	1948	2048	2148	2248	-	2348
Ardsley, Oaks Working Mens Club	1856	1956	2056	2156	2256	-	2356
Stairfoot, Post Office	1858	1958	2058	2158	2258	-	2358
Barnsley, Interchange	1907	2007	2107	2207	2307	-	0007

219 ▶ Sunday

Barnsley ▶ Doncaster

Barnsley, Interchange	0915	1015	1115	1215	1315	1415	1515	1648	1748	1848	1948	2048	2148
Stairfoot, Post Office	0923	1023	1123	1223	1323	1423	1523	1656	1756	1856	1956	2056	2156
Ardsley, Oaks Working Mens Club	0925	1025	1125	1225	1325	1425	1525	1658	1758	1858	1958	2058	2158
Darfield, The Foulstone School	0933	1033	1133	1233	1333	1433	1533	1706	1806	1906	2006	2106	2206
Darfield, Nanny Marr Road/School Street	0934	1034	1134	1234	1334	1434	1534	1707	1807	1907	2007	2107	2207
Middlecliffe, Little Houghton Post Office	0938	1038	1138	1238	1338	1438	1538	1711	1811	1911	2011	2111	2211
Great Houghton, Lister Row	0942	1042	1142	1242	1342	1442	1542	1715	1815	1915	2015	2115	2215
Thurnscoe, Merrill Road/Manor Road	0948	1048	1148	1248	1348	1448	1548	1721	1821	1921	2021	2121	2221
Goldthorpe, Doncaster Rd/Lockwood Rd.	0958	1058	1158	1258	1358	1458	1558	1731	1831	1931	2031	2131	2231
Hickleton, Doncaster Road/Fir Tree Close	1002	1102	1202	1302	1402	1502	1602	1735	1835	1935	2035	2135	2235
Marr, Barnsley Road/Church Lane	1006	1106	1206	1306	1406	1506	1606	1739	1839	1939	2039	2139	2239
Scawsby, Roman Ridge	1010	1110	1210	1310	1410	1510	1610	1743	1843	1943	2043	2143	2243
Scawsby, Kempton Park Rd/St Pauls Parade	1013	1113	1213	1313	1413	1513	1613	1746	1846	1946	2046	2146	2246
Doncaster, Interchange	1023	1123	1223	1323	1423	1523	1623	1756	1856	1956	2056	2156	2256

219 ▶ Sunday (continued)

Barnsley ▶ Doncaster

Barnsley, Interchange	2248	2315
Stairfoot, Post Office	2256	2323
Ardsley, Oaks Working Mens Club	2258	2325
Darfield, The Foulstone School	2306	2333
Darfield, Nanny Marr Road/School Street	2307	2334
Middlecliffe, Little Houghton Post Office	2311	2338
Great Houghton, Lister Row	2315	2342
Thurnscoe, Merrill Road/Manor Road	2321	-
Goldthorpe, Doncaster Rd/Lockwood Rd.	2331	-
Hickleton, Doncaster Road/Fir Tree Close	2335	-
Marr, Barnsley Road/Church Lane	2339	-
Scawsby, Roman Ridge	2343	-
Scawsby, Kempton Park Rd/St Pauls Parade	2346	-
Doncaster, Interchange	2356	-

219 ▶ Sunday**Doncaster ▶ Barnsley**

Doncaster, Interchange	0900	1000	1100	1200	1300	1400	1500	1600	1700	1800	1900	2000	2100
Scawsby, Kempton Park Rd/St Pauls Parade	0910	1010	1110	1210	1310	1410	1510	1610	1710	1810	1910	2010	2110
Scawsby, Roman Ridge	0913	1013	1113	1213	1313	1413	1513	1613	1713	1813	1913	2013	2113
Marr, Barnsley Road/Church Lane	0916	1016	1116	1216	1316	1416	1516	1616	1716	1816	1916	2016	2116
Hickleton, Doncaster Road/Fir Tree Close	0920	1020	1120	1220	1320	1420	1520	1620	1720	1820	1920	2020	2120
Goldthorpe, Police Station	0924	1024	1124	1224	1324	1424	1524	1624	1724	1824	1924	2024	2124
Thurnscoe, Merrill Road/Manor Road	0933	1033	1133	1233	1333	1433	1533	1633	1733	1833	1933	2033	2133
Great Houghton, Lister Row	0939	1039	1139	1239	1339	1439	1539	1639	1739	1839	1939	2039	2139
Middlecliffe, Little Houghton Post Office	0942	1042	1142	1242	1342	1442	1542	1642	1742	1842	1942	2042	2142
Darfield, Nanny Marr Road/School Street	0946	1046	1146	1246	1346	1446	1546	1646	1746	1846	1946	2046	2146
Darfield, The Foulstone School	0948	1048	1148	1248	1348	1448	1548	1648	1748	1848	1948	2048	2148
Ardsley, Oaks Working Mens Club	0956	1056	1156	1256	1356	1456	1556	1656	1756	1856	1956	2056	2156
Stairfoot, Post Office	0958	1058	1158	1258	1358	1458	1558	1658	1758	1858	1958	2058	2158
Barnsley, Interchange	1007	1107	1207	1307	1407	1507	1607	1707	1807	1907	2007	2107	2207

219 ▶ Sunday (continued)**Doncaster ▶ Barnsley**

Doncaster, Interchange	2200
Scawsby, Kempton Park Rd/St Pauls Parade	2210
Scawsby, Roman Ridge	2213
Marr, Barnsley Road/Church Lane	2216
Hickleton, Doncaster Road/Fir Tree Close	2220
Goldthorpe, Police Station	2224
Thurnscoe, Merrill Road/Manor Road	2233
Great Houghton, Lister Row	2239
Middlecliffe, Little Houghton Post Office	2242
Darfield, Nanny Marr Road/School Street	2246
Darfield, The Foulstone School	2248
Ardsley, Oaks Working Mens Club	2256
Stairfoot, Post Office	2258
Barnsley, Interchange	2307

Notes:

- S - Saturdays only.
- SD - Schooldays only.
- SH - Saturdays and school holidays only.
- NS - Not Saturdays.



APPENDIX D

TRAFFIC COUNT DATA

Barnsley Health Centre - Manual Traffic Survey, Friday 13th March 2009

Produced by Road Data Services Ltd

Junction: (3) High Street / Oak Haven Avenue

Approach: High Street (East)

TIME	Left to Oak Haven Avenue						W/B to High Street (West)									
	P/CYCLE	M/CYCLE	CAR	LGV	OGV1	OGV2	BUS	TOTAL	P/CYCLE	M/CYCLE	CAR	LGV	OGV1	OGV2	BUS	TOTAL
0730 - 0745	0	0	1	0	0	0	0	1	0	0	35	4	0	2	1	42
0745 - 0800	0	0	2	0	0	0	0	2	0	0	47	7	0	1	2	57
Hourly Total	0	0	3	0	0	0	0	3	0	0	82	11	0	3	3	99
0800 - 0815	0	0	2	0	0	0	0	2	0	0	52	4	0	3	1	60
0815 - 0830	0	0	1	0	0	0	0	1	0	0	57	3	0	3	1	64
0830 - 0845	0	0	1	0	0	0	0	1	0	0	46	5	1	2	1	55
0845 - 0900	0	0	1	0	0	0	0	1	0	0	45	2	0	2	2	51
Hourly Total	0	0	5	0	0	0	0	5	0	0	200	14	1	10	5	230
0900 - 0915	0	0	3	0	0	0	0	3	0	1	49	4	0	2	2	58
0915 - 0930	0	0	3	0	0	0	0	3	0	0	37	4	0	1	2	44
Hourly Total	0	0	6	0	0	0	0	6	0	1	86	8	0	3	4	102
Session Total	0	0	14	0	0	0	0	14	0	1	368	33	1	16	12	431

1500 - 1515	0	0	1	0	0	0	0	1	0	0	65	10	0	1	1	77
1515 - 1530	0	0	0	0	0	0	0	0	0	0	60	11	0	2	0	73
1530 - 1545	0	0	0	0	0	0	0	0	0	0	59	5	0	2	0	66
1545 - 1600	0	0	1	0	0	0	0	1	0	0	61	3	0	2	1	67
Hourly Total	0	0	2	0	0	0	0	2	0	0	245	29	0	7	2	283
1600 - 1615	0	0	2	0	0	0	0	2	0	1	55	4	1	2	2	65
1615 - 1630	0	0	1	0	0	0	0	1	0	0	57	2	0	2	3	64
1630 - 1645	0	0	4	0	0	0	0	4	0	0	67	3	0	1	2	73
1645 - 1700	0	0	1	0	0	0	0	1	0	0	60	8	0	0	3	71
Hourly Total	0	0	8	0	0	0	0	8	0	1	239	17	1	5	10	273
1700 - 1715	0	0	2	0	0	0	0	2	0	0	73	9	0	0	2	84
1715 - 1730	0	0	3	0	0	0	0	3	0	0	64	9	0	0	1	74
1730 - 1745	0	0	3	0	0	0	0	3	0	0	71	9	0	0	1	81
1745 - 1800	0	0	2	0	0	0	0	2	0	0	69	8	0	0	1	78
Hourly Total	0	0	10	0	0	0	0	10	0	0	277	35	0	0	5	317
1800 - 1815	0	0	1	0	0	0	0	1	0	0	56	5	0	1	1	63
1815 - 1830	0	0	0	0	0	0	0	0	0	0	60	3	0	0	1	64
1830 - 1845	0	0	0	0	0	0	0	0	0	0	48	4	0	0	1	53
1845 - 1900	0	0	0	0	0	0	0	0	0	0	35	4	0	0	0	39
Hourly Total	0	0	1	0	0	0	0	1	0	0	199	16	0	1	3	219
Session Total	0	0	21	0	0	0	0	21	0	1	960	97	1	13	20	1092

Barnsley Health Centre - Manual Traffic Survey, Friday 13th March 2009

Produced by Road Data Services Ltd

Junction: (3) High Street / Oak Haven Avenue

Approach: Oak Haven Avenue

TIME	Left to High Street (West)							Right to High Street (East)								
	P/CYCLE	M/CYCLE	CAR	LGV	OGV1	OGV2	BUS	TOTAL	P/CYCLE	M/CYCLE	CAR	LGV	OGV1	OGV2	BUS	TOTAL
0730 - 0745	0	0	2	0	0	0	0	2	0	0	3	0	0	0	0	3
0745 - 0800	0	0	0	0	0	0	0	0	0	0	2	0	0	0	0	2
Hourly Total	0	0	2	0	0	0	0	2	0	0	5	0	0	0	0	5
0800 - 0815	0	0	0	0	0	0	0	0	0	0	3	0	0	0	0	3
0815 - 0830	0	0	0	0	0	0	0	0	0	0	2	0	0	0	0	2
0830 - 0845	0	0	1	0	0	0	0	1	0	0	4	0	0	0	0	4
0845 - 0900	0	0	2	0	0	0	0	2	0	0	4	6	0	0	0	10
Hourly Total	0	0	3	0	0	0	0	3	0	0	13	6	0	0	0	19
0900 - 0915	0	0	2	0	0	0	0	2	0	0	8	4	0	0	0	12
0915 - 0930	0	0	1	0	0	0	0	1	0	0	7	2	0	0	0	9
Hourly Total	0	0	3	0	0	0	0	3	0	0	15	6	0	0	0	21
Session Total	0	0	8	0	0	0	0	8	0	0	33	12	0	0	0	45

1500 - 1515	0	0	1	0	0	0	0	1	0	0	2	0	0	0	0	2
1515 - 1530	0	0	1	0	0	0	0	1	0	0	5	0	0	0	0	5
1530 - 1545	0	0	3	0	0	0	0	3	0	0	4	1	0	0	0	8
1545 - 1600	0	0	0	0	0	0	0	0	0	0	8	0	0	0	0	8
Hourly Total	0	0	5	0	0	0	0	5	0	0	19	1	0	0	0	20
1600 - 1615	0	0	0	0	0	0	0	0	0	0	3	0	0	0	0	3
1615 - 1630	0	0	2	0	0	0	0	2	0	0	2	0	0	0	0	2
1630 - 1645	0	0	5	0	0	0	0	5	0	0	6	1	0	0	0	7
1645 - 1700	0	0	3	0	0	0	0	3	0	0	3	0	0	0	0	3
Hourly Total	0	0	10	0	0	0	0	10	0	0	14	1	0	0	0	15
1700 - 1715	1	0	1	0	0	0	0	2	0	0	6	0	1	0	0	7
1715 - 1730	0	0	0	0	0	0	0	0	0	0	5	0	0	0	0	5
1730 - 1745	0	0	1	0	0	0	0	1	0	0	1	0	0	0	0	1
1745 - 1800	0	0	1	0	0	0	0	1	0	0	3	0	0	0	0	3
Hourly Total	1	0	3	0	0	0	0	4	0	0	15	0	1	0	0	16
1800 - 1815	0	0	2	0	0	0	0	2	0	0	2	0	0	0	0	2
1815 - 1830	0	0	1	0	0	0	0	1	0	0	1	0	0	0	0	1
1830 - 1845	0	0	1	0	0	0	0	1	0	0	1	0	0	0	0	1
1845 - 1900	0	0	0	0	0	0	0	0	0	0	3	0	0	0	0	3
Hourly Total	0	0	4	0	0	0	0	4	0	0	7	0	0	0	0	7
Session Total	1	0	22	0	0	0	0	23	0	0	55	2	1	0	0	58

Barnsley Health Centre - Manual Traffic Survey, Friday 13th March 2009

Produced by Road Data Services Ltd

Junction: (3) High Street / Oak Haven Avenue

Approach: High Street (West)

TIME	E/B to High Street (East)							Right to Oak Haven Avenue								
	P/CYCLE	M/CYCLE	CAR	LGV	OGV1	OGV2	BUS	TOTAL	P/CYCLE	M/CYCLE	CAR	LGV	OGV1	OGV2	BUS	TOTAL
0730 - 0745	0	0	62	10	0	2	1	75	0	0	0	0	0	0	0	0
0745 - 0800	0	0	64	11	0	0	2	77	0	0	0	0	0	0	0	0
Hourly Total	0	0	126	21	0	2	3	152	0	0	0	0	0	0	0	0
0800 - 0815	0	1	63	5	0	1	1	71	0	0	0	0	0	0	0	0
0815 - 0830	0	0	69	2	0	3	1	75	0	0	3	0	0	0	0	3
0830 - 0845	0	0	59	4	0	2	1	67	0	0	4	1	0	0	0	5
0845 - 0900	0	0	63	5	0	2	1	71	0	0	2	0	0	0	0	2
Hourly Total	0	1	254	16	0	9	4	284	0	0	9	1	0	0	0	10
0900 - 0915	0	0	46	5	0	3	2	56	0	0	2	0	0	0	0	2
0915 - 0930	0	0	40	1	0	2	1	44	0	0	1	0	0	0	0	1
Hourly Total	0	0	86	6	0	5	3	100	0	0	3	0	0	0	0	3
Session Total	0	1	466	43	0	16	10	536	0	0	12	1	0	0	0	13

1500 - 1515	0	0	59	11	1	2	2	75	0	0	4	0	0	0	0	4
1515 - 1530	0	0	56	9	0	1	0	66	0	0	2	0	0	0	0	2
1530 - 1545	0	0	54	12	0	1	0	67	0	0	3	0	0	0	0	3
1545 - 1600	0	0	47	11	0	2	0	60	0	0	1	0	0	0	0	1
Hourly Total	0	0	216	43	1	6	2	268	0	0	10	0	0	0	0	10
1600 - 1615	0	0	58	16	0	6	1	81	0	0	0	0	0	0	0	0
1615 - 1630	0	0	58	15	0	1	0	74	0	0	0	0	0	0	0	0
1630 - 1645	0	1	79	5	0	1	1	87	0	0	3	0	0	0	0	3
1645 - 1700	0	0	61	3	0	0	1	65	0	0	5	0	0	0	0	5
Hourly Total	0	1	256	39	0	8	3	307	0	0	8	0	0	0	0	8
1700 - 1715	0	0	69	6	0	1	2	78	0	0	7	0	0	0	0	8
1715 - 1730	0	0	75	3	0	0	1	79	0	0	2	0	0	0	0	2
1730 - 1745	0	0	68	4	0	0	1	73	0	0	1	0	0	0	0	1
1745 - 1800	0	0	68	4	0	0	0	72	0	0	0	0	0	0	0	0
Hourly Total	0	0	280	17	0	1	4	302	1	0	10	0	0	0	0	11
1800 - 1815	0	0	74	5	0	1	1	81	0	0	1	1	0	0	0	2
1815 - 1830	0	0	64	5	0	0	1	70	0	0	0	0	0	0	0	0
1830 - 1845	0	1	49	3	0	3	1	57	0	0	1	0	0	0	0	1
1845 - 1900	0	0	28	3	0	0	0	31	0	0	0	0	0	0	0	0
Hourly Total	0	1	215	16	0	4	3	239	0	0	2	1	0	0	0	3
Session Total	0	2	967	115	1	19	12	1116	1	0	30	1	0	0	0	32