

## BGS Flood GFS Data

### General

-  Specified Site
-  Specified Buffer(s)
-  Bearing Reference Point

### Agency and Hydrological (Flood)

-  Limited Potential for Groundwater Flooding to Occur
-  Potential for Groundwater Flooding of Property, Situated Below Ground Level
-  Potential for Groundwater Flooding to Occur at Surface

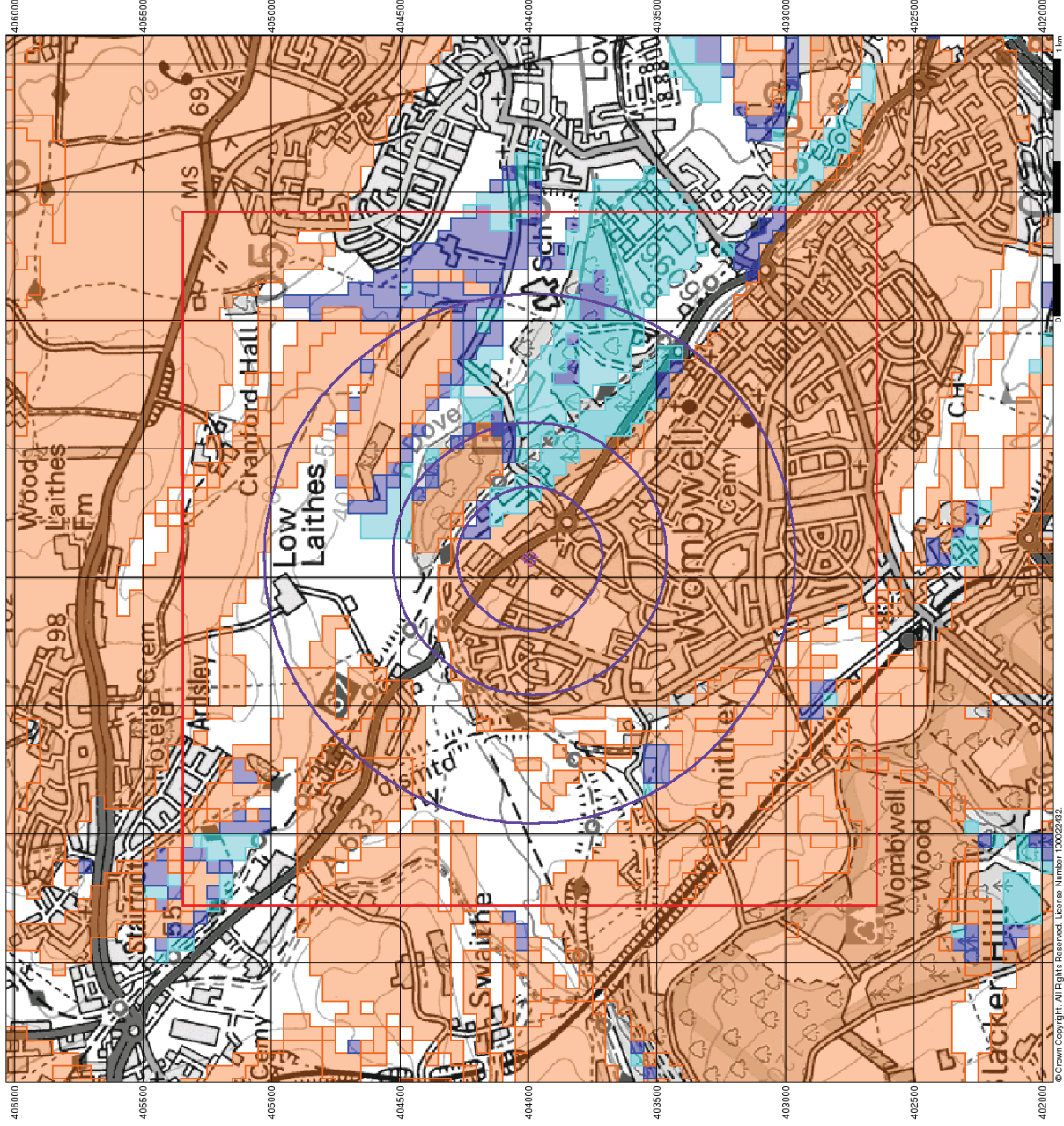

Site Sensitivity Context Map - Slice A

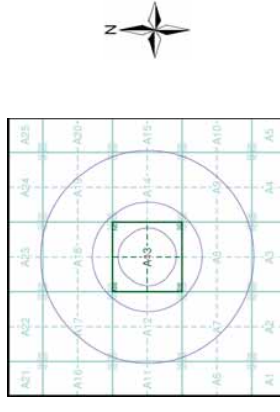

### Order Details

Order Number: 164345359\_1\_1  
 Customer Ref: 0770  
 National Grid Reference: 439070, 403990  
 Slice: A  
 Site Area (Ha): 0.19  
 Search Buffer (m): 1000

### Site Details

245, Barnsley Road, Wombwell, BARNLSLEY, S73 8DT

## Historical Mapping & Photography included:

Mapping Type	Scale	Date	Pg
Yorkshire	1:2,500	1892	2
Yorkshire	1:2,500	1906	3
Yorkshire	1:2,500	1931	4
Ordnance Survey Plan	1:2,500	1962	5
Additional SIMs	1:2,500	1970 - 1971	6
Ordnance Survey Plan	1:2,500	1978 - 1980	7
Additional SIMs	1:1,250	1982	8
Large-Scale National Grid Data	1:2,500	1985 - 1986	9
Large-Scale National Grid Data	1:1,250	1993	10
Large-Scale National Grid Data	1:1,250	1994 - 1994	11
Large-Scale National Grid Data	1:1,250	1994	12
Historical Aerial Photography	1:2,500	1999	13

## Historical Mapping Legends

### Ordnance Survey County Series and Ordnance Survey Plan 1:2,500

Quarry, Sand Pit, Gravel Pit, Refuse Heap, Clay Pit, Shingle, Sloping Masonry, Flat Rock, Marsh, Reeds, Furze, Wood, Orchard, Mixed Wood, Brushwood, Fir, Ford, Waterfall, Ferry, Trig. Station, Altitude at Trig. Station, Bench Mark, Surface Level, Antiquities (site of), Embankment, Cutting, Railway crossing Road, Level Crossing, Road over Railway, Road over River or Canal, River or Canal, Police Call Box, Pump, Signal Post, Sluice, Spring, Foot Path, Telephone Call Box, Mile Stone, Trough, Well, M.P. M.T. Mooring Post or Ring

### Large-Scale National Grid Data 1:2,500 and 1:1,250

Inactive Quarry, Chalk Pit or Clay Pit, Rock, Boulders, Slopes, Top, Roofed Building, Glazed Roof Building, Archway, Non-Confiferous Tree (surveyed), Confiferous Tree (not surveyed), Orchard Tree, Scrub, Bracken, Coppice, Osier, Reeds, Marsh, Saltings, Rough Grassland, Heath, Culvert, Direction of water flow, Bench Mark, Antiquity (site of), Cave Entrance, Triangulation Station, Electricity Pylon, Electricity Transmission Line, County Boundary (Geographical), County & Civil Parish Boundary, Civil Parish Boundary, Admin. County or County Bor. Boundary, London Borough Boundary, Symbol marking point where boundary merging changes

### Ordnance Survey Plan, Additional SIMs and Supply of Unpublished Survey Information 1:2,500 and 1:1,250

Active Quarry, Chalk Pit or Clay Pit, Rock, Boulders, Slopes, Top, Roofed Building, Glazed Roof Building, Archway, Non-Confiferous Tree (surveyed), Confiferous Tree (not surveyed), Orchard Tree, Scrub, Bracken, Coppice, Osier, Reeds, Marsh, Saltings, Rough Grassland, Heath, Culvert, Direction of water flow, Bench Mark, Antiquity (site of), Cave Entrance, Triangulation Station, Electricity Pylon, Electricity Transmission Line, County Boundary (Geographical), County & Civil Parish Boundary, Civil Parish Boundary, Admin. County or County Bor. Boundary, London Borough Boundary, Symbol marking point where boundary merging changes

Barreness, Battery, Cemetery, Chimney, Cistern, Dismantled Railway, El Gen Sta, Electricity Generating Station, El P, El Sub Sta, Fm/D Fm, Gas Gov, GP, MH, MP, MS, Barracks, By, Cem, City, Cls, Diamd Rly, El Gen Sta, El P, El Sub Sta, Fm/D Fm, Gas Gov, GP, MH, MP, MS, Pillar, Pole or Post, Post Office, Public Convenience, Pump, Pumping Station, Place of Worship, Sewage Pkg Sta, Sewage Pumping Station, SB, S Br, Signal Box or Bridge, SP, SL, Signal Post or Light, Spr, Spring, Tank or Trunk, Trough, Wd Pp, Wind Pump, Wk, Works (building or area), W, Well

Barreness, Battery, Cemetery, Chimney, Cistern, Dismantled Railway, El Gen Sta, Electricity Generating Station, El P, El Sub Sta, Fm/D Fm, Gas Gov, GP, MH, MP, MS, Barracks, By, Cem, City, Cls, Diamd Rly, El Gen Sta, El P, El Sub Sta, Fm/D Fm, Gas Gov, GP, MH, MP, MS, Pillar, Pole or Post, Post Office, Public Convenience, Pump, Pumping Station, Place of Worship, Sewage Pkg Sta, Sewage Pumping Station, SB, S Br, Signal Box or Bridge, SP, SL, Signal Post or Light, Spr, Spring, Tank or Trunk, Trough, Wd Pp, Wind Pump, Wk, Works (building or area), W, Well

Barreness, Battery, Cemetery, Chimney, Cistern, Dismantled Railway, El Gen Sta, Electricity Generating Station, El P, El Sub Sta, Fm/D Fm, Gas Gov, GP, MH, MP, MS, Barracks, By, Cem, City, Cls, Diamd Rly, El Gen Sta, El P, El Sub Sta, Fm/D Fm, Gas Gov, GP, MH, MP, MS, Pillar, Pole or Post, Post Office, Public Convenience, Pump, Pumping Station, Place of Worship, Sewage Pkg Sta, Sewage Pumping Station, SB, S Br, Signal Box or Bridge, SP, SL, Signal Post or Light, Spr, Spring, Tank or Trunk, Trough, Wd Pp, Wind Pump, Wk, Works (building or area), W, Well

## Historical Map - Segment A13

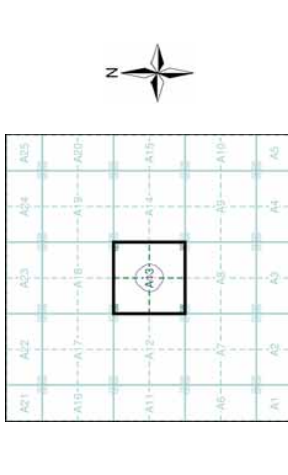

**Order Details**  
 Order Number: 164345359\_1\_1  
 Customer Ref: 0770  
 National Grid Reference: 439070, 403990  
 Site Area (Ha): A  
 Slice: 0.19  
 Search Buffer (m): 100

**Site Details**  
 245, Barnsley Road, Wombwell, BARNLSLEY, S73 8DT

The historical maps shown were reproduced from maps predominantly held at the scale adopted for England, Wales and Scotland in the 1840's. In 1854 the 1:2,500 scale was adopted for mapping urban areas and by 1896 in Great Britain the scale was extended to the rural areas. The published maps of Great Britain were based on the Ordnance Survey of 1830. The Ordnance Survey maps were based on the Cassini Projection, with independent surveys of a single county or group of counties, giving rise to significant inaccuracies in outlying areas.

### Map Name(s) and Date(s)

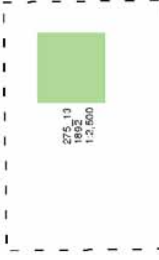

### Historical Map - Segment A13

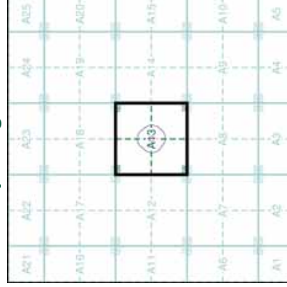

### Order Details

Order Number: 164345359\_1\_1  
 Customer Ref: 0770  
 National Grid Reference: 439070, 403990  
 Site: A  
 Site Area (Ha): 0.19  
 Search Buffer (m): 100

### Site Details

245, Barnsley Road, Wombwell, BARNLSLEY, S73 8DT

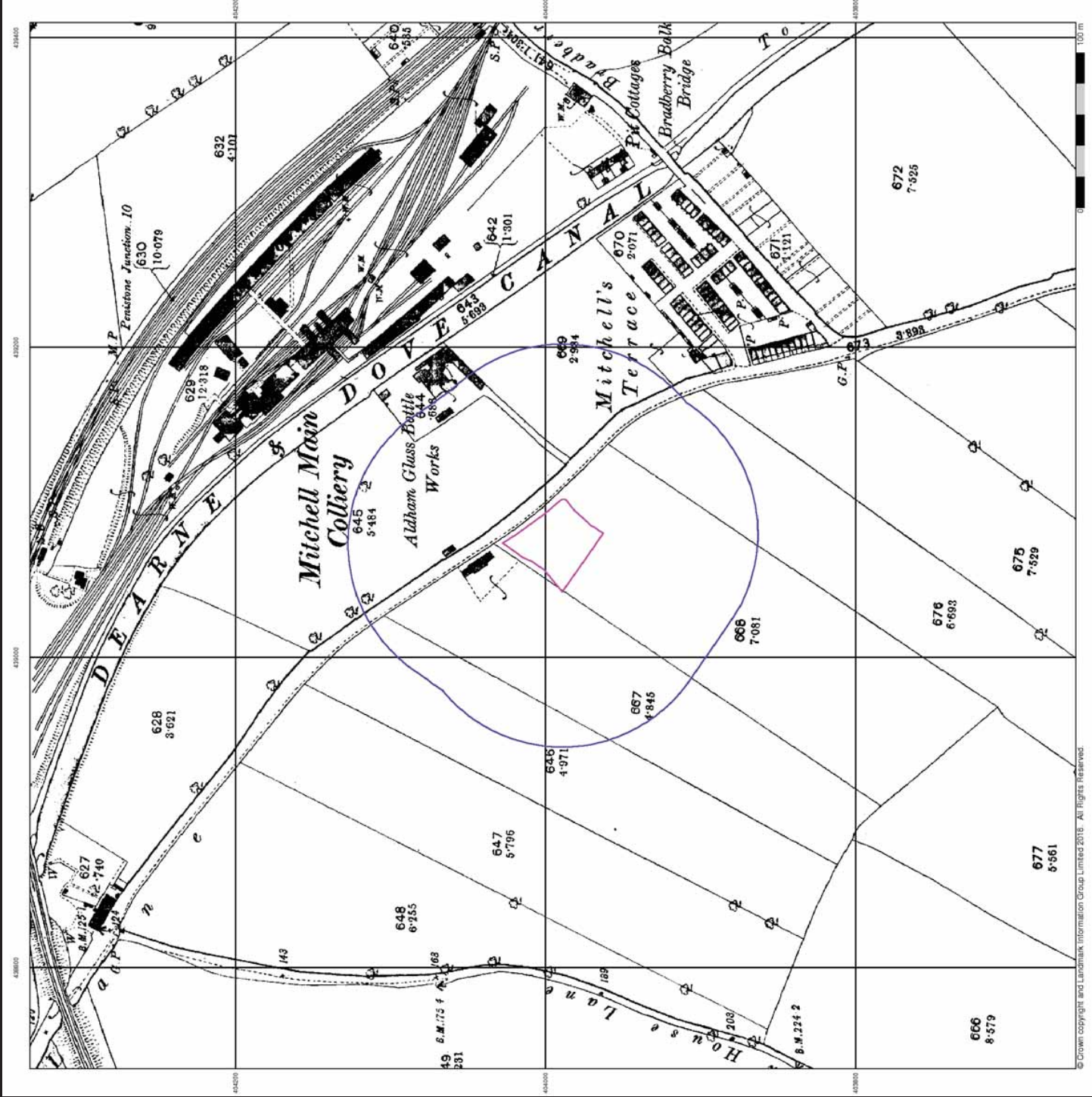

The historical maps shown were reproduced from maps predominantly held at the scale adopted for England, Wales and Scotland in the 1840's. In 1854 the 1:2,500 scale was adopted for mapping urban areas and by 1896 for Great Britain. The maps were compiled to use the Ordnance Survey's Great Britain datum. Before 1938 all OS maps were based on the Cassini Projection, with independent surveys of a single county or group of counties, giving rise to significant inaccuracies in outlying areas.

**Map Name(s) and Date(s)**

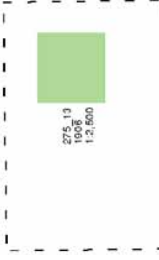

**Historical Map - Segment A13**

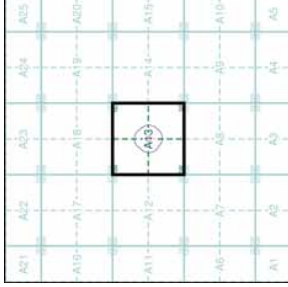

**Order Details**

Order Number: 164345359\_1\_1  
 Customer Ref: 0770  
 National Grid Reference: 439070, 403990  
 Slice: A  
 Site Area (Ha): 0.19  
 Search Buffer (m): 100

**Site Details**

245, Barnsley Road, Wombwell, BARNLSLEY, S73 8DT

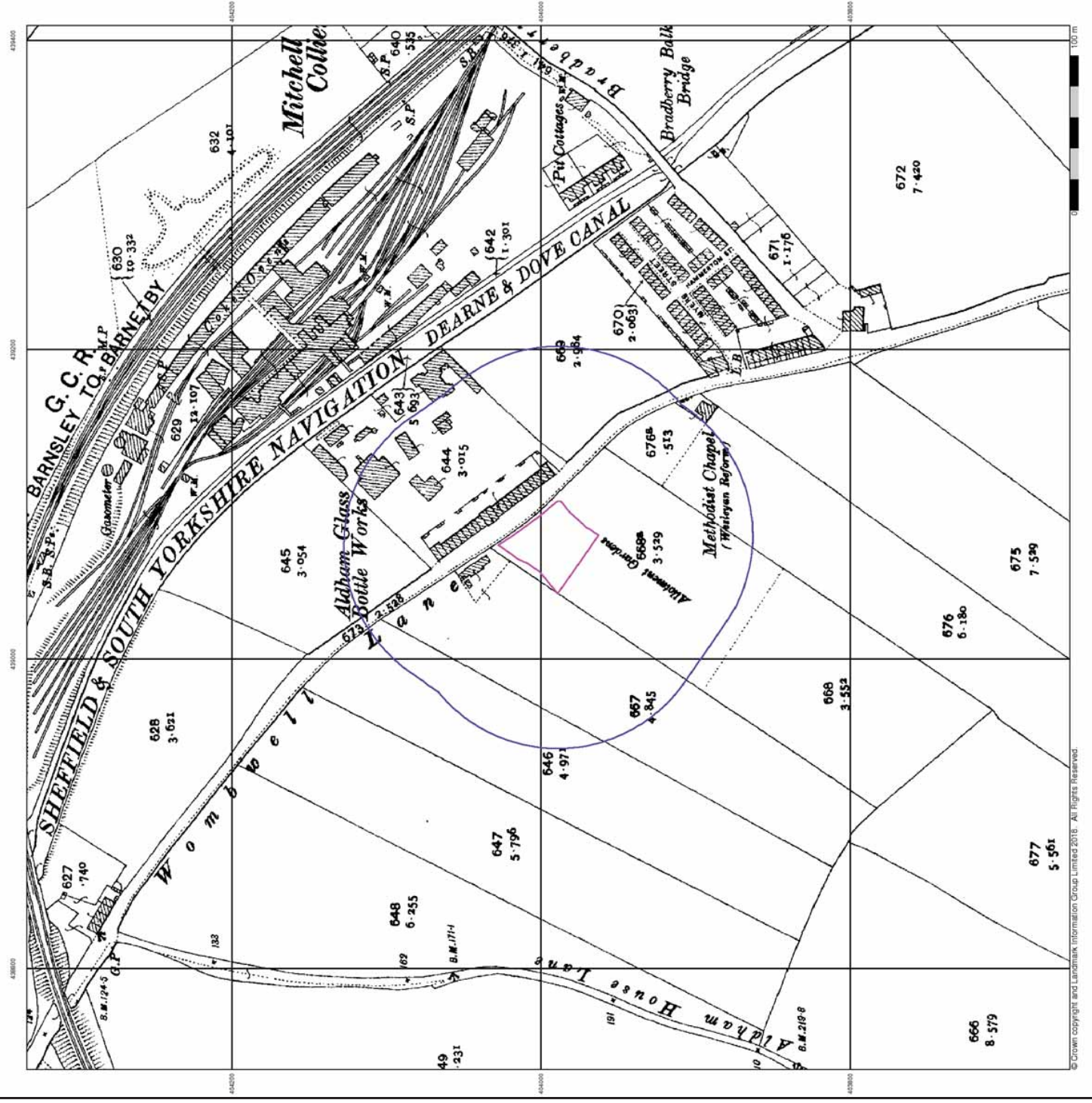

© Crown copyright and Landmark Information Group Limited 2016. All Rights Reserved.

The historical maps shown were reproduced from maps predominantly held at the scale adopted for England, Wales and Scotland in the 1840's. In 1854 the 1:2,500 scale was adopted for mapping urban areas and by 1896 the Great Britain Ordnance Survey maps were produced to be the standard plans of Great Britain. The published data were based on the original plans of the surveyed date. Before 1938 all OS maps were based on the Cassini Projection, with independent surveys of a single county or group of counties, giving rise to significant inaccuracies in outlying areas.

Map Name(s) and Date(s)

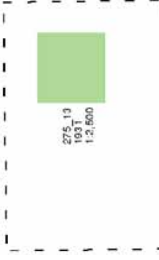

Historical Map - Segment A13

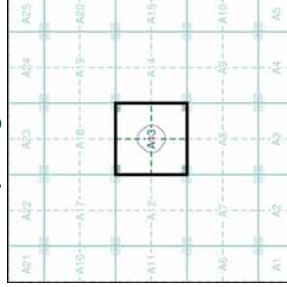

Order Details

Order Number: 164345359\_1\_1  
 Customer Ref: 0770  
 National Grid Reference: 439070, 403990  
 Slice: A  
 Site Area (Ha): 0.19  
 Search Buffer (m): 100

Site Details

245, Barnsley Road, Wombwell, BARNLSLEY, S73 8DT

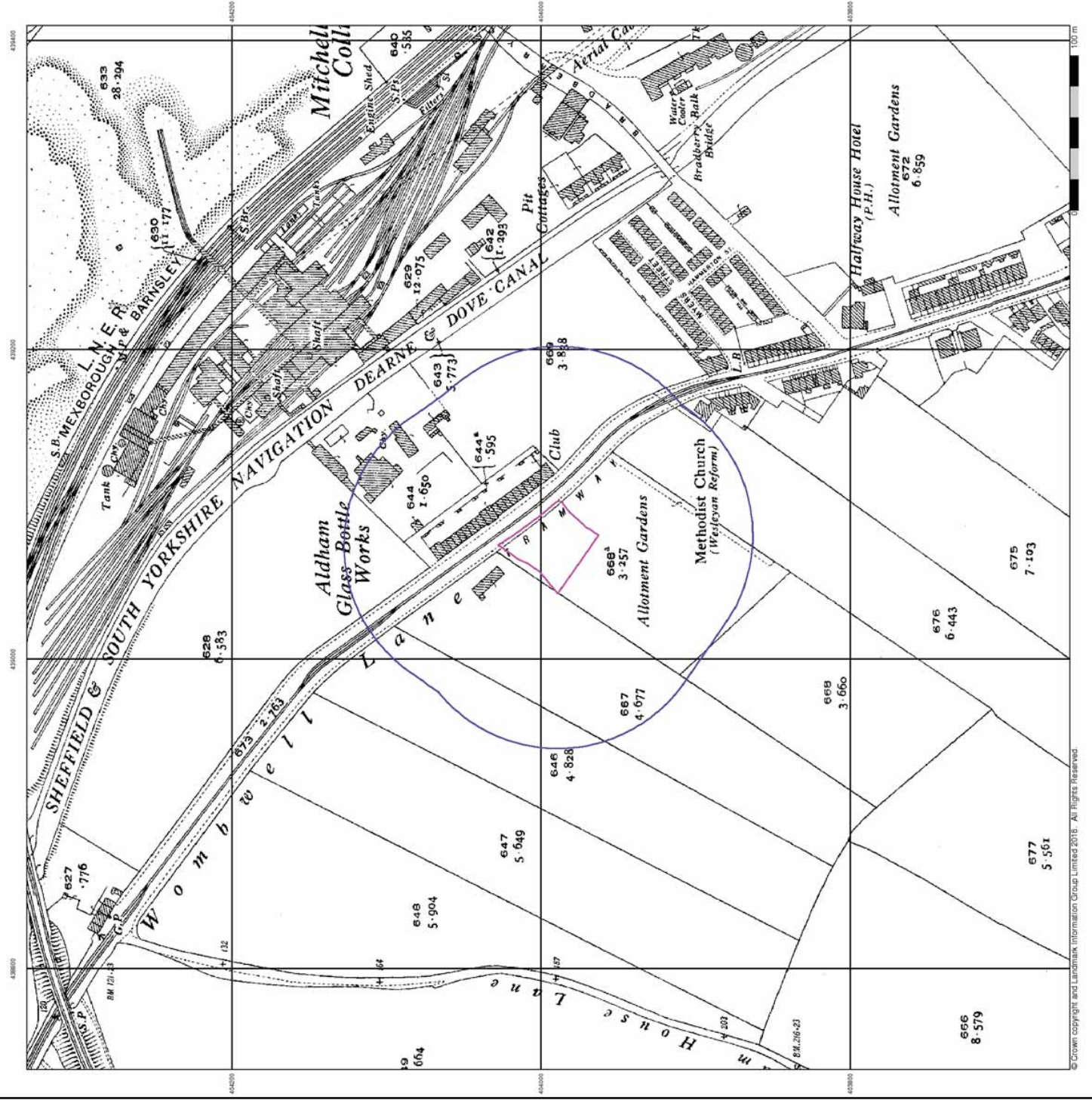

## Ordnance Survey Plan Published 1962

Source map scale - 1:2,500

The historical maps shown were reproduced from maps predominantly held at the scale adopted for England, Wales and Scotland in the 1840's. In 1854 the 1:2,500 scale was adopted for mapping urban areas and by 1896 the Great Britain maps were extended to the uncoloured parts of Great Britain. The published data were based on the Ordnance Survey's 1938 projection. Before 1938 all OS maps were based on the Cassini projection, with independent surveys of a single county or group of counties, giving rise to significant inaccuracies in outlying areas.

### Map Name(s) and Date(s)

SE 3804	1962	1:2,500
SE 3803	1962	1:2,500

### Historical Map - Segment A13

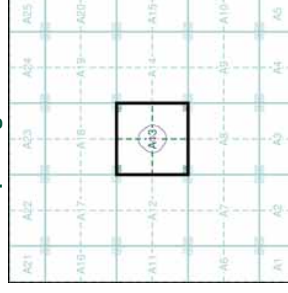

### Order Details

Order Number: 164345359\_1\_1  
 Customer Ref: 0770  
 National Grid Reference: 439070, 403990  
 Slice: A  
 Site Area (Ha): 0.19  
 Search Buffer (m): 100

### Site Details

245, Barnsley Road, Wombwell, BARNLSLEY, S73 8DT

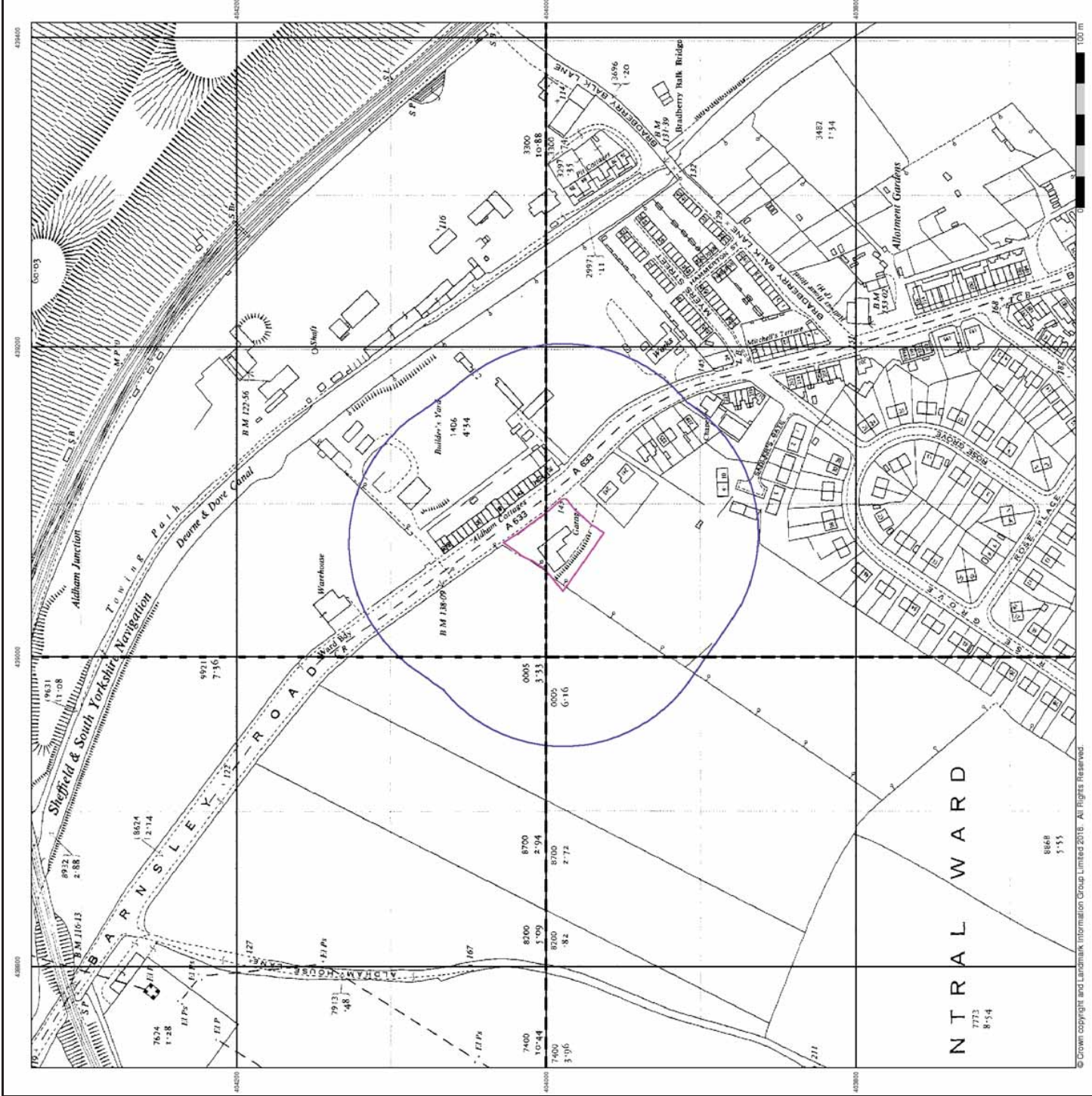

## Ordnance Survey Plan

Published 1970 - 1971

Source map scale - 1:2,500

The historical maps shown were reproduced from maps predominantly held at the scale adopted for England, Wales and Scotland in the 1840's. In 1854 the 1:2,500 scale was adopted for mapping urban areas and by 1896 the Great Britain maps were extended to cover the uncoloured parts of Great Britain. The published data were based on the original plans of the surveyed date. Before 1938 all OS maps were based on the Cassini Projection, with independent surveys of a single county or group of counties, giving rise to significant inaccuracies in outlying areas.

### Map Name(s) and Date(s)

SE 3804	1970	1:2,500
SE 3803	1970	1:2,500

### Historical Map - Segment A13

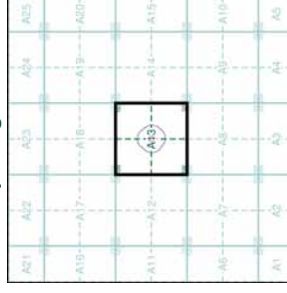

### Order Details

Order Number: 164345359\_1\_1  
 Customer Ref: 0770  
 National Grid Reference: 439070, 403990  
 Site: A  
 Site Area (Ha): 0.19  
 Search Buffer (m): 100

### Site Details

245, Barnsley Road, Wombwell, BARNLSLEY, S73 8DT

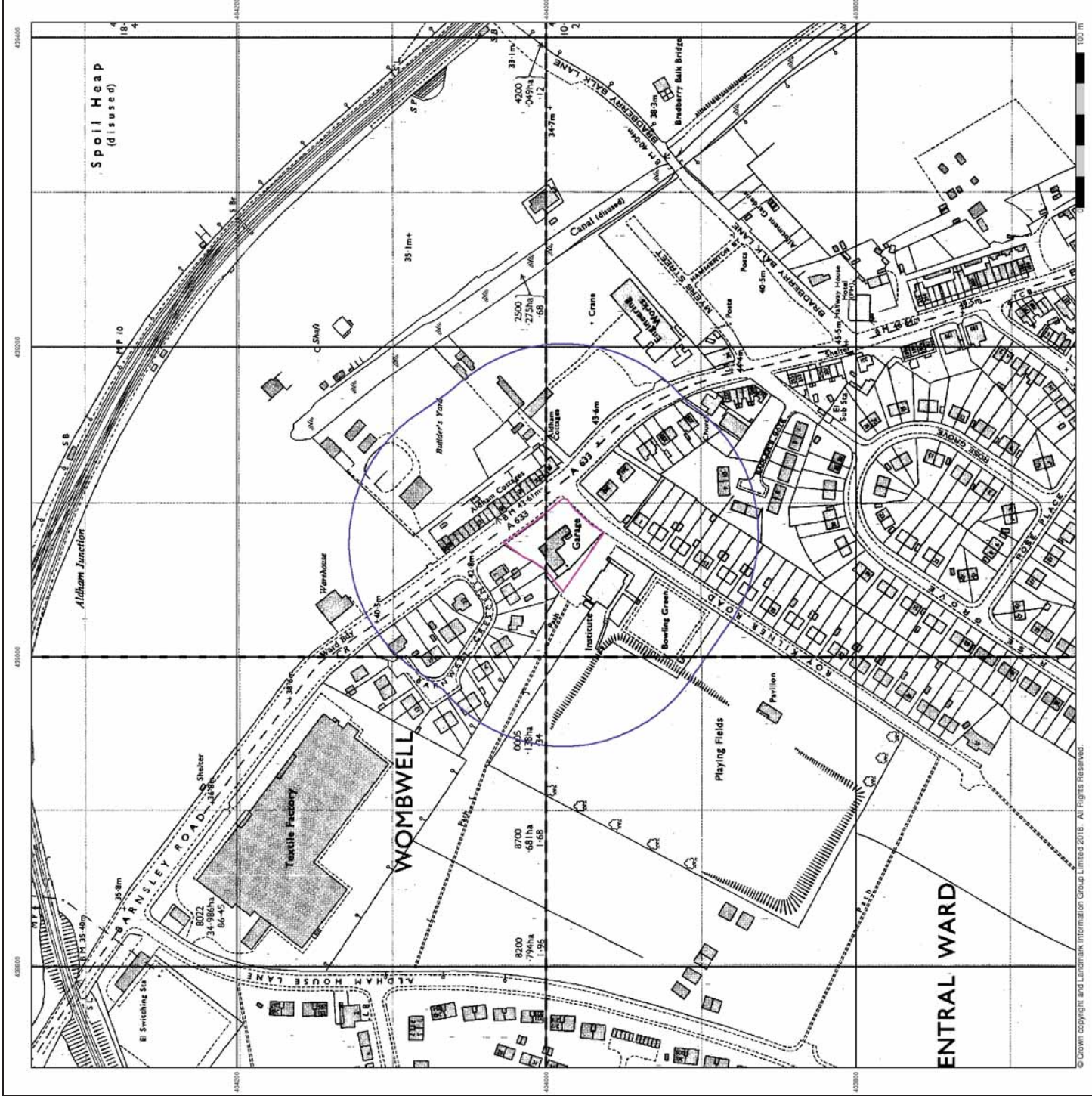

## Additional SIMs

Published 1978 - 1980

Source map scale - 1:2,500

The SIM cards (Ordnance Survey's 'Survey of Information on Microfilm') are further, minor editions of mapping which were produced and published in between the main editions as an area was updated. They date from 1947 to 1994, and contain detailed information on buildings, roads and land-use. These maps were produced at both 1:2,500 and 1:1,250 scales.

### Map Name(s) and Date(s)

SE3804	1980	1:2,500
SE3803	1978	1:2,500

### Historical Map - Segment A13

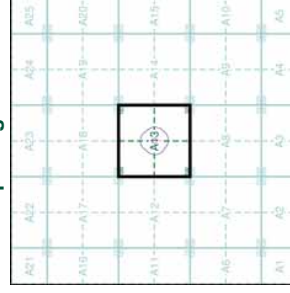

### Order Details

Order Number: 164345359\_1\_1  
 Customer Ref: 0770  
 National Grid Reference: 439070, 403990  
 Site: A  
 Site Area (Ha): 0.19  
 Search Buffer (m): 100

### Site Details

245, Barnsley Road, Wombwell, BARNSLEY, S73 8DT

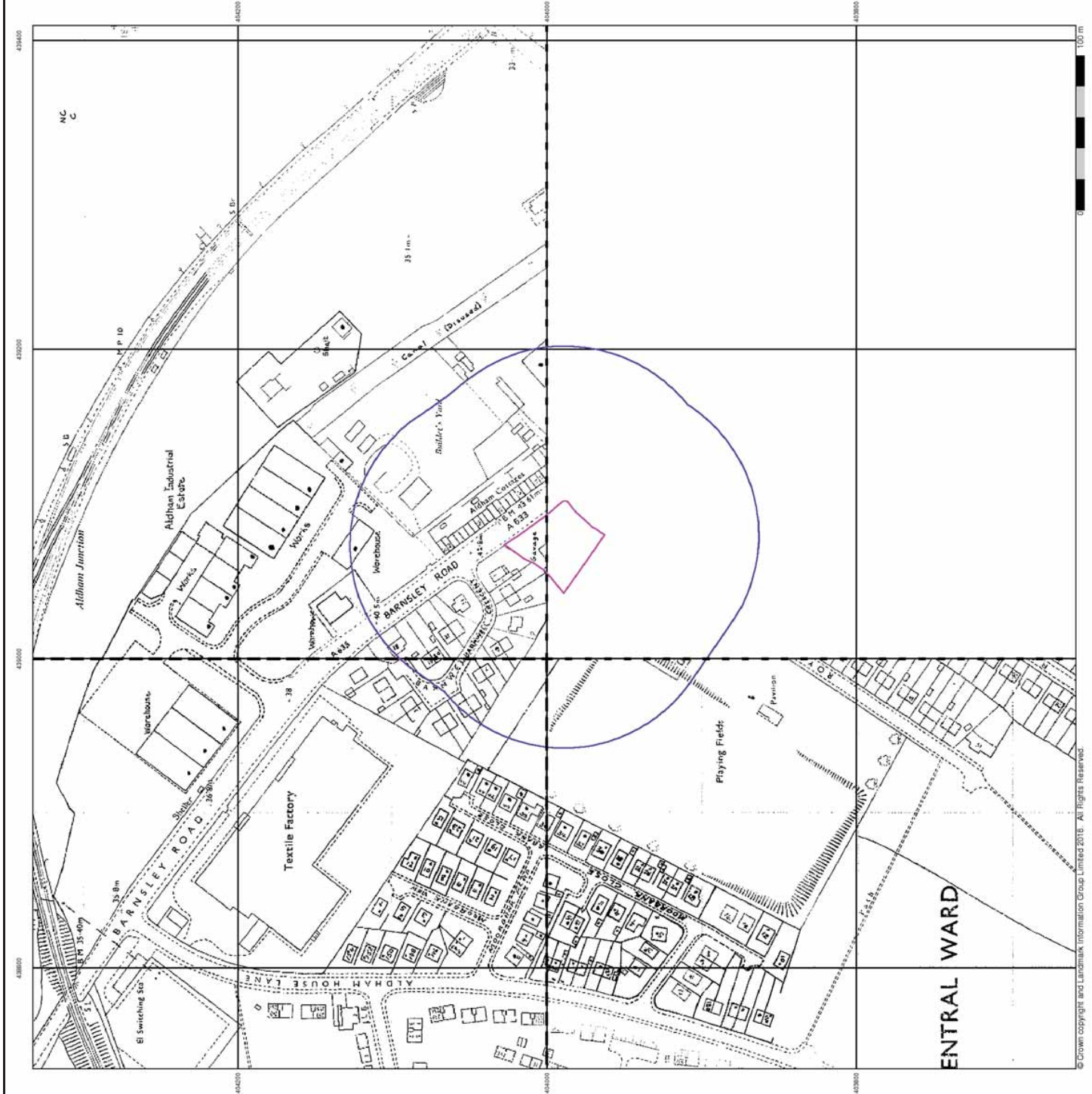

## Ordnance Survey Plan Published 1982

### Source map scale - 1:1,250

The historical maps shown were reproduced from maps predominantly held at the scale adopted for England, Wales and Scotland in the 1840's. In 1854 the 1:2,500 scale was adopted for mapping urban areas and by 1896 the Great Britain maps were extended to the outland parts of the British Isles. The published maps were based on the Cassini projection, with independent surveys of a single county or group of counties, giving rise to significant inaccuracies in outlying areas.

### Map Name(s) and Date(s)

SE2004SE	SE 2004SW
1982	1982
1:1,250	1:1,250
SE2004NE	SE2004NW
1982	1982
1:1,250	1:1,250

### Historical Map - Segment A13

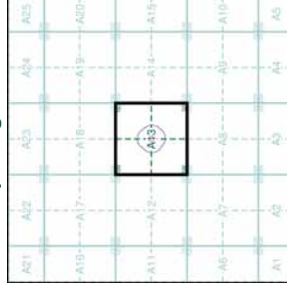

### Order Details

Order Number: 164345359\_1\_1  
 Customer Ref: 0770  
 National Grid Reference: 439070, 403990  
 Site: A  
 Site Area (Ha): 0.19  
 Search Buffer (m): 100

### Site Details

245, Barnsley Road, Wombwell, BARNLSLEY, S73 8DT

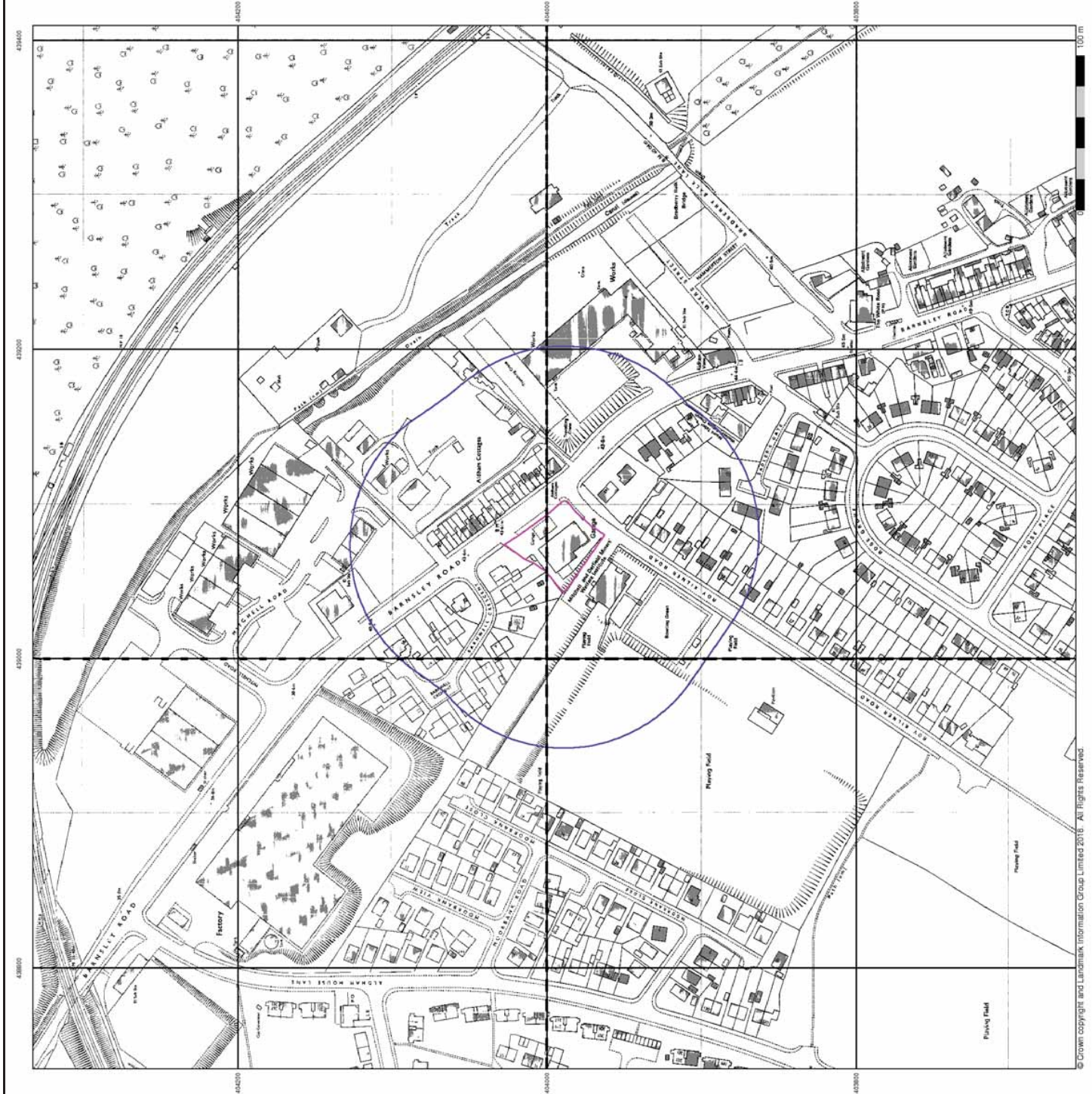

## Additional SIMs

Published 1985 - 1986

Source map scale - 1:2,500

The SIM cards (Ordnance Survey's 'Survey of Information on Microfilm') are further, minor editions of mapping which were produced and published in between the main editions as an area was updated. They date from 1947 to 1994, and contain detailed information on buildings, roads and land-use. These maps were produced at both 1:2,500 and 1:1,250 scales.

### Map Name(s) and Date(s)

SEC9004	1995	1:2,500
SEC9003	1986	1:2,500

### Historical Map - Segment A13

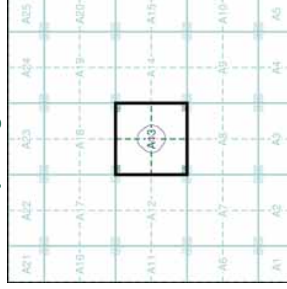

### Order Details

Order Number: 164345359\_1\_1  
 Customer Ref: 0770  
 National Grid Reference: 439070, 403990  
 Site: A  
 Site Area (Ha): 0.19  
 Search Buffer (m): 100

### Site Details

245, Barnsley Road, Wombwell, BARNSDLEY, S73 8DT

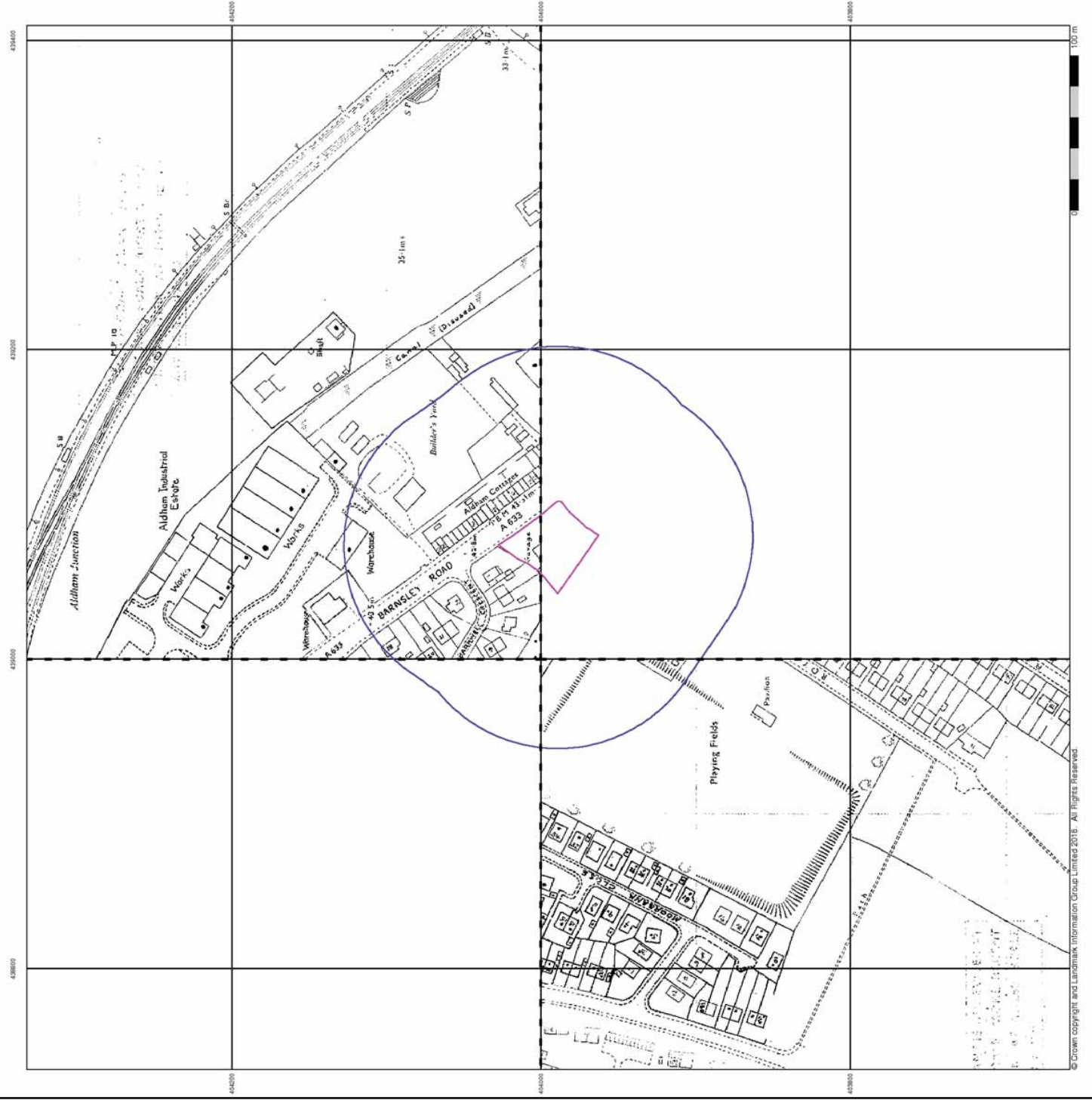

## Large-Scale National Grid Data Published 1993

Source map scale - 1:1,250

\*Large Scale National Grid Data superseded SIM cards (Ordnance Survey's 'Survey of Information on Microfilm') in 1992, and continued to be produced until 1999. These maps were the forerunners of digital mapping and so provide more information on houses and roads, but tend to show less detail on features such as vegetation. These maps were produced at both 1:2,500 and 1:1,250 scales.

### Map Name(s) and Date(s)

SE3903ASE	SE3903ASW
1993	1993
1:1,250	1:1,250
SE3903NE	SE3903NW
1993	1993
1:1,250	1:1,250

### Historical Map - Segment A13

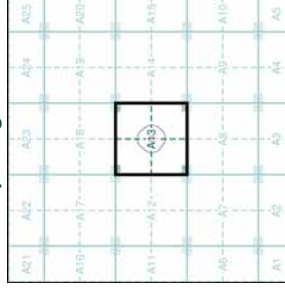

### Order Details

Order Number: 164345359\_1\_1  
 Customer Ref: 0770  
 National Grid Reference: 439070, 403990  
 Site: A  
 Site Area (Ha): 0.19  
 Search Buffer (m): 100

### Site Details

245, Barnsley Road, Wombwell, BARNLSLEY, S73 8DT



## Large-Scale National Grid Data Published 1993 - 1994

Source map scale - 1:1,250

\*Large Scale National Grid Data superseded SIM cards (Ordnance Survey's 'Survey of Information on Microfilm') in 1992, and continued to be produced until 1999. These maps were the forerunners of digital mapping and so provide the information on houses and roads, but tend to show less detail than maps published at scales as low as 1:2,500 and 1:1,250 scales.

### Map Name(s) and Date(s)

SE 2004 SE	SE 2004 SW
1994	1994
1:1,250	1:1,250
SE 2004 NE	SE 2004 NW
1994	1994
1:1,250	1:1,250

### Historical Map - Segment A13

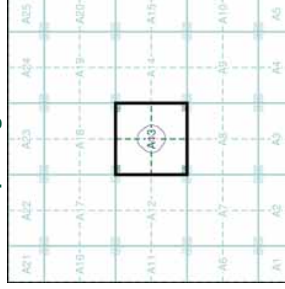

### Order Details

Order Number: 164345359\_1\_1  
 Customer Ref: 0770  
 National Grid Reference: 439070, 403990  
 Site: A  
 Site Area (Ha): 0.19  
 Search Buffer (m): 100

### Site Details

245, Barnsley Road, Wombwell, BARNLSLEY, S73 8DT

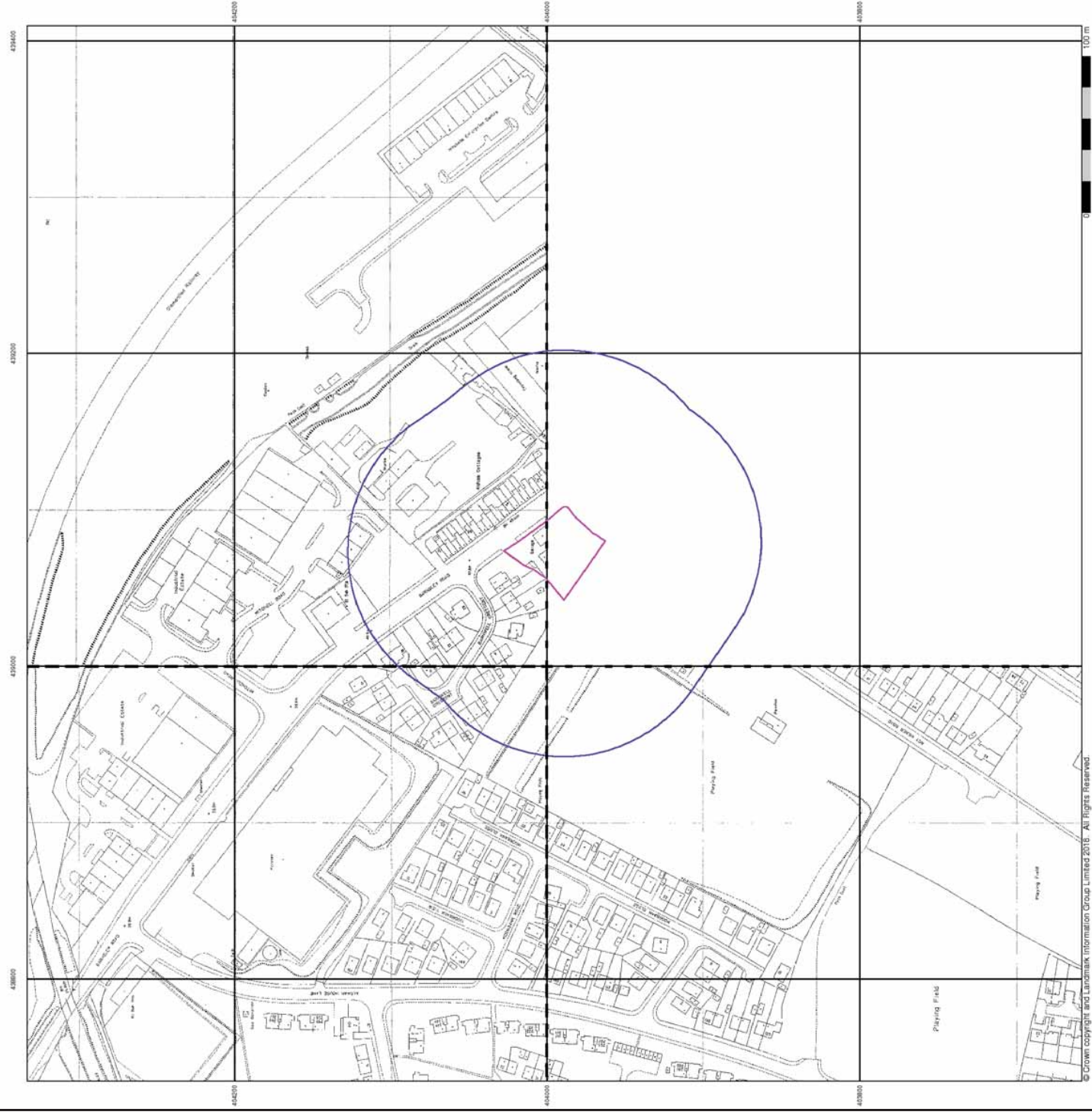

## Large-Scale National Grid Data Published 1994

Source map scale - 1:1,250

\*Large Scale National Grid Data superseded SIM cards (Ordnance Survey's 'Survey of Information on Microfilm') in 1992, and continued to be produced until 1999. These maps were the forerunners of digital mapping and so provide the information on houses and roads, but tend to show less detail than maps published as vegetation. These maps were produced at both 1:2,500 and 1:1,250 scales.

### Map Name(s) and Date(s)

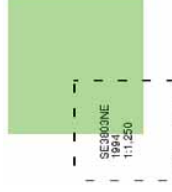

### Historical Map - Segment A13

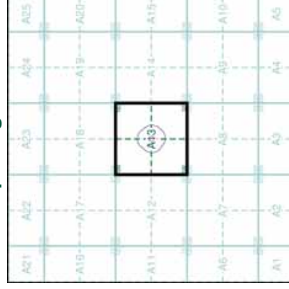

### Order Details

Order Number: 164345359\_1\_1  
 Customer Ref: 0770  
 National Grid Reference: 439070, 403990  
 Site: A  
 Site Area (Ha): 0.19  
 Search Buffer (m): 100

### Site Details

245, Barnsley Road, Wombwell, BARNLSLEY, S73 8DT

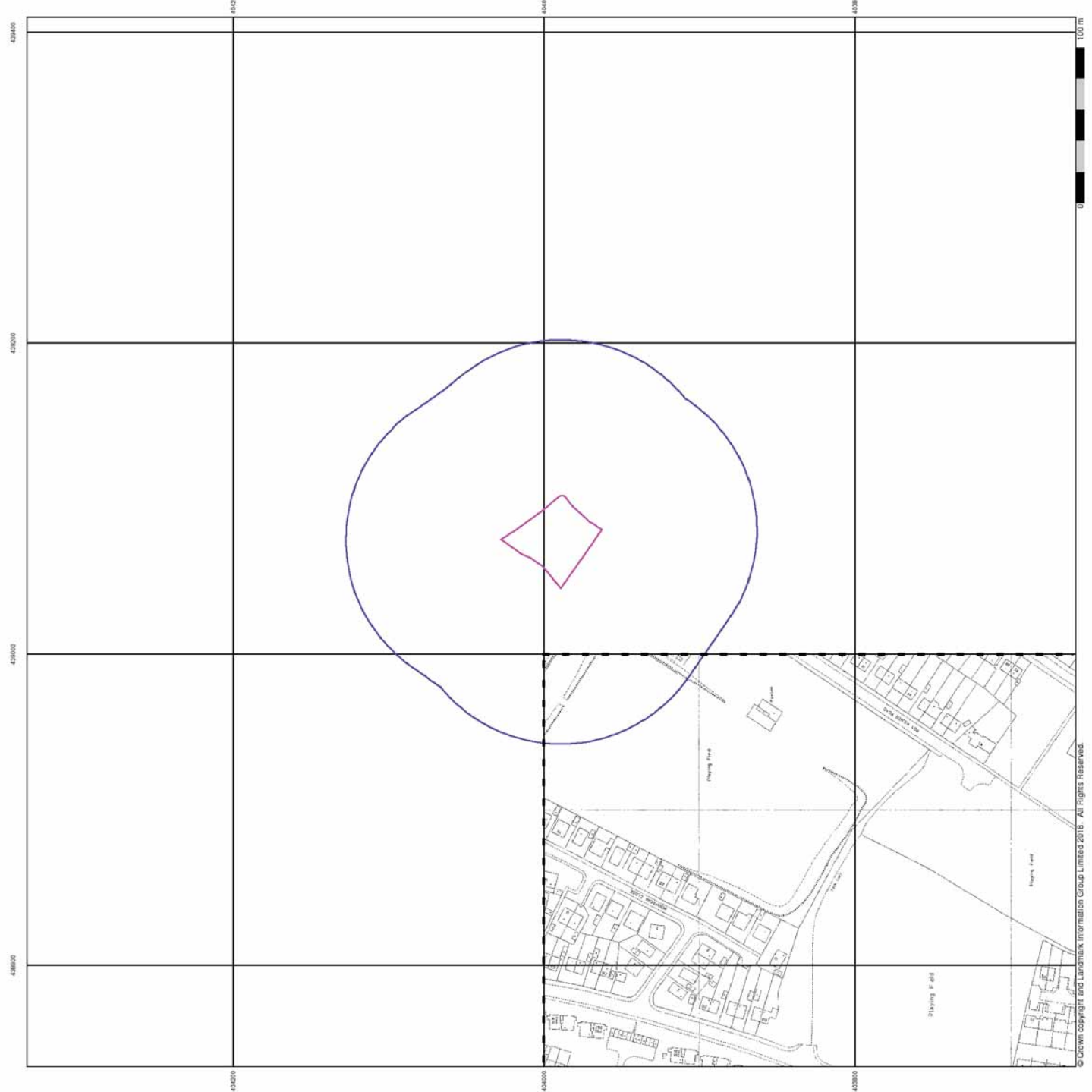

© Crown copyright and Landmark Information Group Limited 2016. All Rights Reserved.

## Historical Aerial Photography Published 1999

This aerial photography was produced by Geomapping, these vertical aerial photographs provide a seamless, full colour survey of the whole of Great Britain.

### Historical Aerial Photography - Segment A13

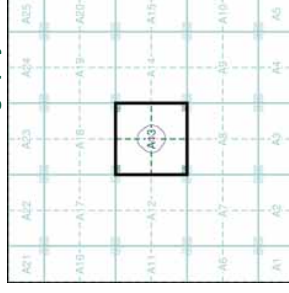

#### Order Details

Order Number: 164345359\_1\_1  
 Customer Ref: 0770  
 National Grid Reference: 439070, 403990  
 Slice: A  
 Site Area (Ha): 0.19  
 Search Buffer (m): 100

#### Site Details

245, Barnsley Road, Wombwell, BARNSLY, S73 8DT



## Historical Mapping & Photography included:

Mapping Type	Scale	Date	Pg
Yorkshire	1:10,560	1854 - 1855	2
Yorkshire	1:10,560	1893	3
Yorkshire	1:10,560	1894	4
Yorkshire	1:10,560	1905 - 1907	5
Yorkshire	1:10,560	1931	6
Yorkshire	1:10,560	1938	7
Yorkshire	1:10,560	1939 - 1948	8
Yorkshire	1:10,560	1948	9
Ordnance Survey Plan	1:10,000	1955 - 1956	10
Ordnance Survey Plan	1:10,000	1966 - 1967	11
Ordnance Survey Plan	1:10,000	1974	12
Ordnance Survey Plan	1:10,000	1989 - 1984	13
Ordnance Survey Plan	1:10,000	1989	14
Ordnance Survey Plan	1:10,000	1993	15
10K Raster Mapping	1:10,000	2006	16
VectorMap Local	1:10,000	2018	18

## 1:10,000 Raster Mapping

Gravel Pit	Refuse tip or slag heap
Rock	Rock (scattered)
Boulders	Boulders (scattered)
Shingle	Mud
Sand	Sand Pit
Slopes	Top of cliff
General detail	Underground detail
Overhead detail	Narrow gauge railway
Multi-track railway	Single track railway
County boundary (England only)	Civil, parish or community boundary
District, Unitary, Metropolitan, London Borough boundary	Constituency boundary
Area of wooded vegetation	Non-coniferous trees
Non-coniferous trees (scattered)	Coniferous trees
Coniferous trees (scattered)	Positioned tree
Orchard	Coppice or Osiers
Rough Grassland	Heath
Scrub	Marsh, Salt Marsh or Reeds
Water feature	Flow arrows
Mean high water (springs)	Mean low water (springs)
Telephone line (where shown)	Electricity transmission line (with poles)
Bench mark (where shown)	Triangulation station
Point feature (e.g. Guide Post or Mile Stone)	Pylon, flare stack or lighting tower
Site of (antiquity)	Glasshouse
General Building	Important Building

## Historical Mapping Legends

### Ordnance Survey Plan 1:10,000

Chalk Pit, Clay Pit or Quarry	Gravel Pit
Sand Pit	Disused Pit or Quarry
Refuse or Slag Heap	Lake, Loch or Pond
Dunes	Boulders
Coniferous Trees	Non-Coniferous Trees
Orchard	Coppice
Bracken	Scrub
Marsh	Heath
Reeds	Rough Grassland
Building	Saltings
Glasshouse	Direction of Flow of Water
Sloping Masonry	Pylon
Electricity Transmission Line	Pole
Cutting	Embankment
Road Under	Road Over
Level Crossing	Foot Bridge
Siding, Tramway or Mineral Line	Narrow Gauge
Geographical County	Administrative County, County Borough or County of City
Municipal Borough, Urban or Rural District, Borough, Burgh or County Constituency	Shows only when not coincident with other boundaries
Civil Parish	Shows alternately when coincidence of boundaries occurs
BP, BS	Boundary Post or Stone
Ch	Church
CH	Club House
FE Sta	Fire Engine Station
FB	Foot Bridge
Fn	Fountain
GP	Guide Post
MP	Mile Post
MS	Mile Stone
	Police Station
	Post Office
	Public Convenience
	Public House
	Signal Box
	Spring
	Telephone Call Box
	Telephone Call Post
	Well

### Ordnance Survey County Series 1:10,560

Gravel Pit	Other Pits
Quarry	Orchard
Osiers	Marsh
Mixed Wood	Brushwood
Fir	Furze
Arrow denotes flow of water	Trigonometrical Station
Site of Antiquities	Bench Mark
Pump, Guide Post, Signal Post	Well, Spring, Boundary Post
Surface Level	
Sketched Contour	Instrumental Contour
Main Roads	Minor Roads
Sunken Road	Raised Road
Road over Railway	Railway over River
Railway over Road	Level Crossing
Road over River or Canal	Road over Stream
Road over Stream	
County Boundary (Geographical)	County & Civil Parish Boundary
County & Civil Parish Boundary	Administrative County & Civil Parish Boundary
Co. Boro. Bdy.	County Borough Boundary (England)
Co. Burgh Bdy.	County Burgh Boundary (Scotland)
R.D. Bdy.	Rural District Boundary
	Civil Parish Boundary

## Historical Map - Slice A

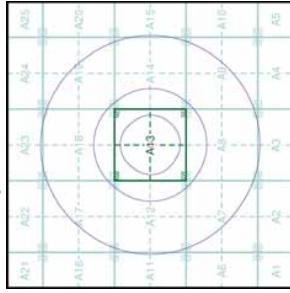

## Order Details

Order Number: 164345359\_1\_1  
 Customer Ref: 0770  
 National Grid Reference: 439070, 403990  
 Slice: A  
 Site Area (Ha): 0.19  
 Search Buffer (m): 1000

## Site Details

245, Barnsley Road, Wombwell, BARNESLEY, S73 8DT

Yorkshire

Published 1854 - 1855

Source map scale - 1:10,560

The historical maps shown were reproduced from maps predominantly held at the scale adopted for England, Wales and Scotland in the 1840's. In 1854 the 1:2,500 scale was adopted for mapping urban areas; these maps were used to update the 1:10,560 scale maps. The published maps on this site were based on the Cassini Projection, with independent surveys of a single county or group of counties, giving rise to significant inaccuracies in outlying areas. In the late 1940's, a Provisional Edition was produced, which updated the 1:10,560 mapping from a number of sources. The maps appear unfinished - with all military camps and other strategic sites removed. These maps were initially overprinted with the National Grid. In 1970, the first 1:10,000 maps were produced using the Transverse Mercator Projection. The revision process continued until recently, with new editions appearing every 10 years or so for urban areas.

### Map Name(s) and Date(s)

27500	1854	1:10,560
28300	1855	1:10,560

### Historical Map - Slice A

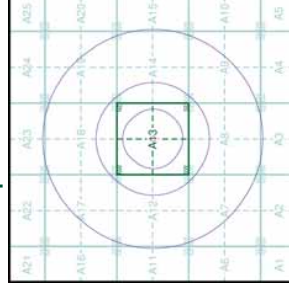

### Order Details

Order Number: 164345359\_1\_1  
 Customer Ref: 0770  
 National Grid Reference: 439070, 403990  
 Slice: A  
 Site Area (Ha): 0.19  
 Search Buffer (m): 1000

### Site Details

245, Barnsley Road, Wombwell, BARNLSLEY, S73 8DT

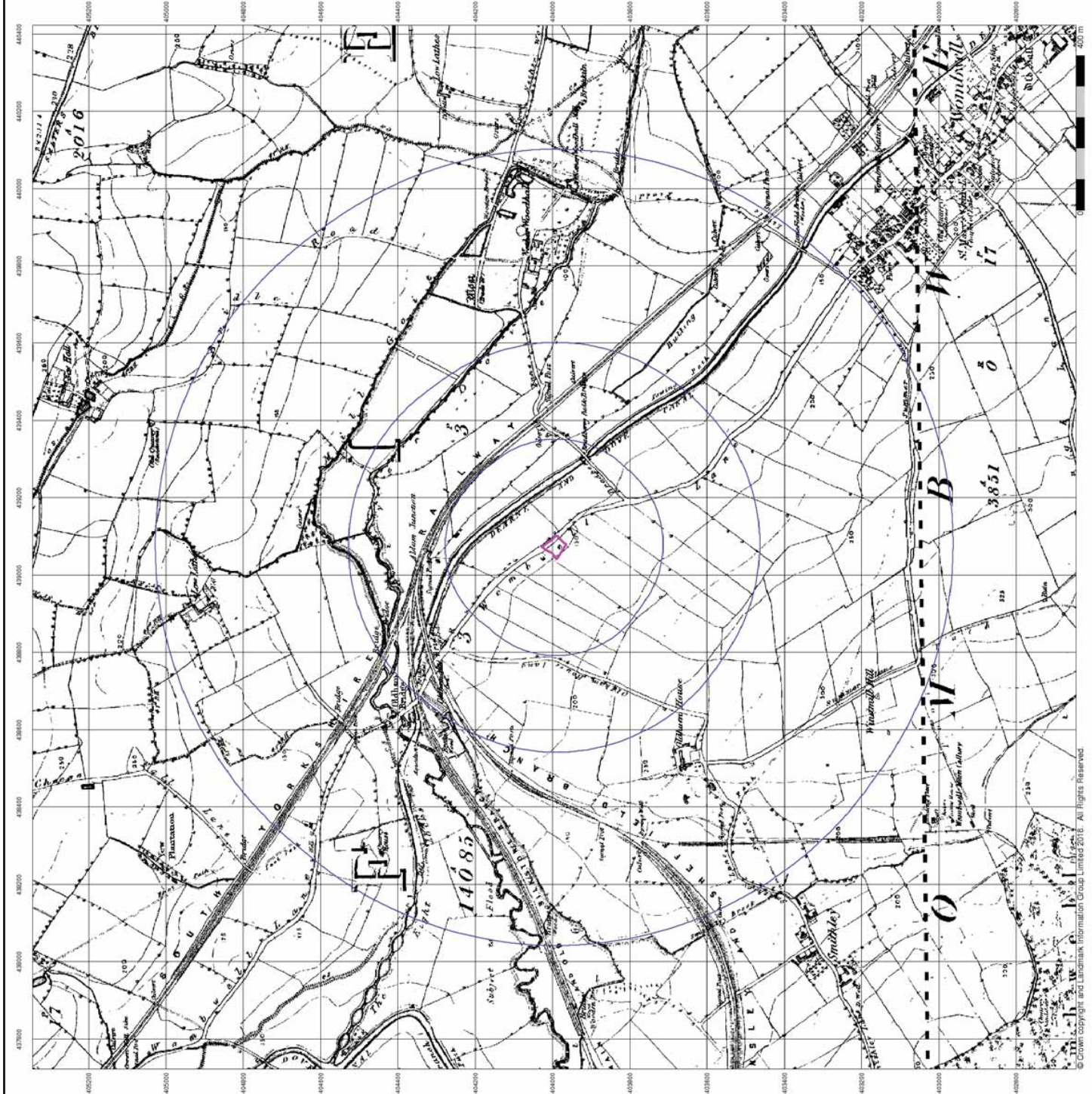

The historical maps shown were reproduced from maps predominantly held at the scale adopted for England, Wales and Scotland in the 1840's. In 1854 the 1:2,500 scale was adopted for mapping urban areas; these maps were used to update the 1840's maps. The published maps on urban areas are based on the Cassini Projection, with independent surveys of a single county or group of counties, giving rise to significant inaccuracies in outlying areas. In the late 1940's, a Provisional Edition was produced, which updated the 1:10,560 mapping from a number of sources. The maps appear unfinished - with all military camps and other strategic sites removed. These maps were initially overprinted with the National Grid. In 1970, the first 1:10,000 maps were produced using the Transverse Mercator Projection. The revision process continued until recently, with new editions appearing every 10 years or so for urban areas.

**Map Name(s) and Date(s)**

283NW	1853
1:10,560	

**Historical Map - Slice A**

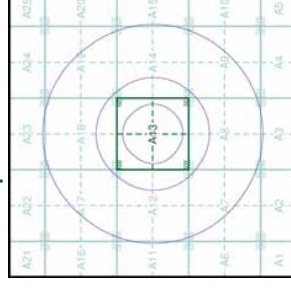

**Order Details**

Order Number: 164345359\_1\_1  
 Customer Ref: 0770  
 National Grid Reference: 439070, 403990  
 Slice: A  
 Site Area (Ha): 0.19  
 Search Buffer (m): 1000

**Site Details**

245, Barnsley Road, Wombwell, BARNLSLEY, S73 8DT

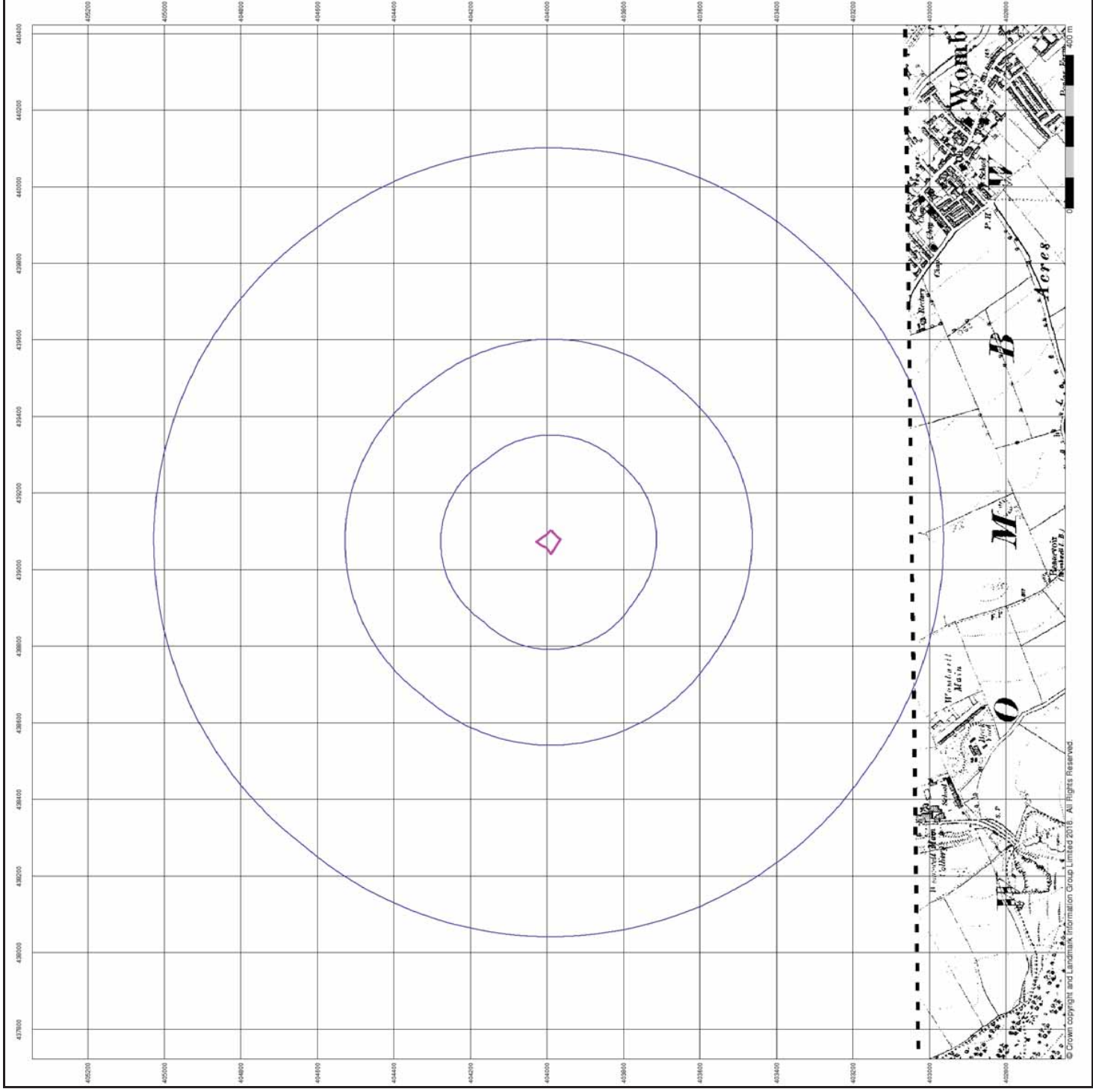

© Crown copyright and Landmark Information Group Limited 2016. All Rights Reserved.

The historical maps shown were reproduced from maps predominantly held at the scale adopted for England, Wales and Scotland in the 1840's. In 1854 the 1:2,500 scale was adopted for mapping urban areas; these maps were used to update the 1:10,560 scale maps. The published maps were based on the Cassini Projection, with independent surveys of a single county or group of counties, giving rise to significant inaccuracies in outlying areas. In the late 1940's, a Provisional Edition was produced, which updated the 1:10,560 mapping from a number of sources. The maps appear unfinished - with all military camps and other strategic sites removed. These maps were initially overprinted with the National Grid. In 1970, the first 1:10,000 maps were produced using the Transverse Mercator Projection. The revision process continued until recently, with new editions appearing every 10 years or so for urban areas.

**Map Name(s) and Date(s)**

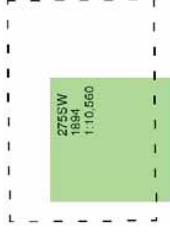

**Historical Map - Slice A**

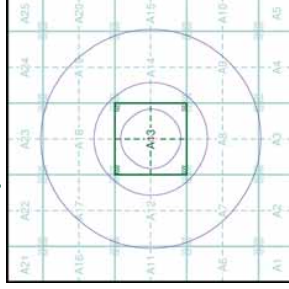

**Order Details**

Order Number: 164345359\_1\_1  
 Customer Ref: 0770  
 National Grid Reference: 439070, 403990  
 Slice: A  
 Site Area (Ha): 0.19  
 Search Buffer (m): 1000

**Site Details**

245, Barnsley Road, Wombwell, BARNLSLEY, S73 8DT

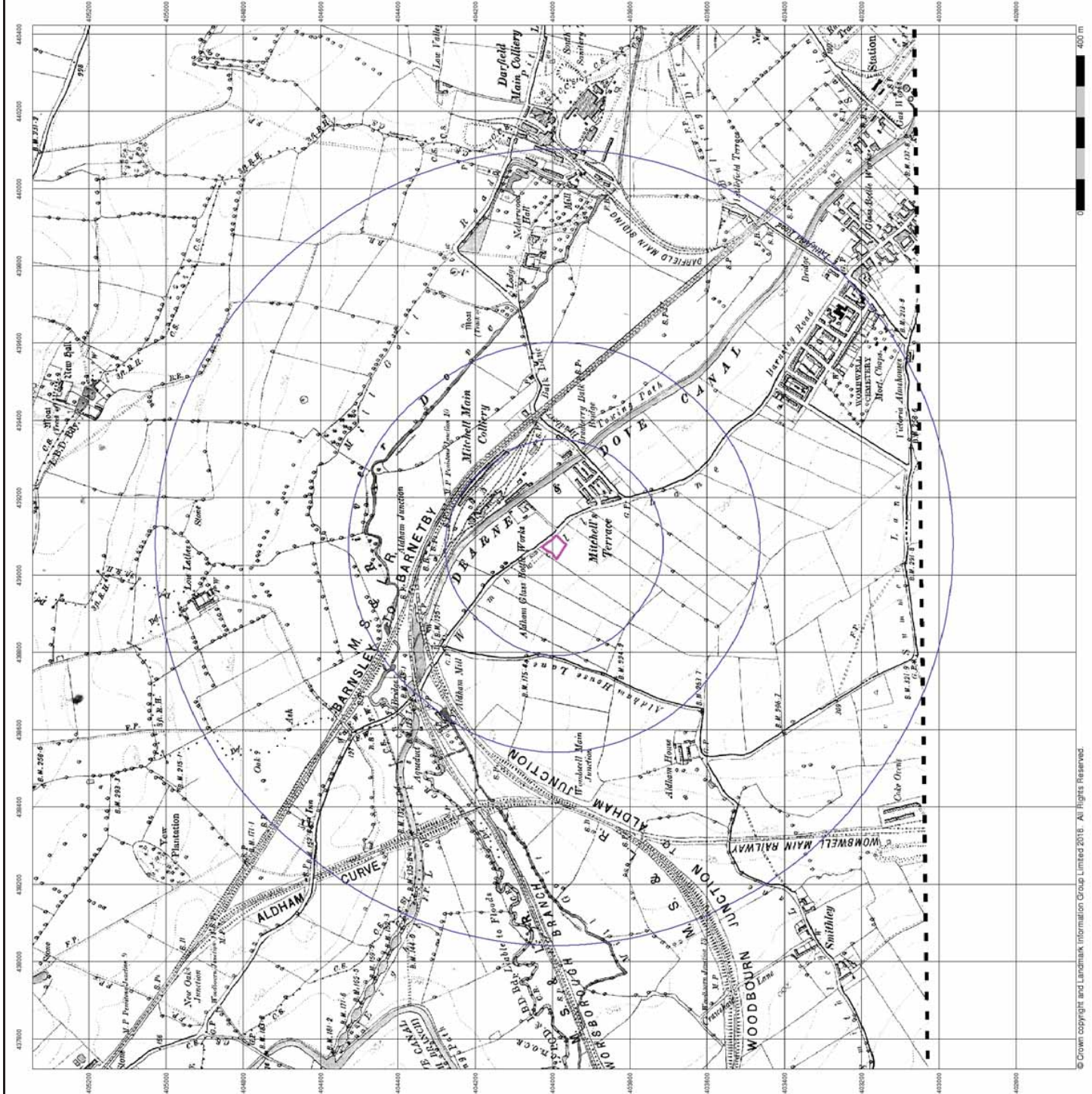

## Yorkshire

Published 1905 - 1907

Source map scale - 1:10,560

The historical maps shown were reproduced from maps predominantly held at the scale adopted for England, Wales and Scotland in the 1840's. In 1854 the 1:2,500 scale was adopted for mapping urban areas; these maps were used to update the 1:10,560 maps. The published maps on this site are based on the Cassini Projection, with independent surveys of a single county or group of counties, giving rise to significant inaccuracies in outlying areas. In the late 1940's, a Provisional Edition was produced, which updated the 1:10,560 mapping from a number of sources. The maps appear unfinished - with all military camps and other strategic sites removed. These maps were initially overprinted with the National Grid. In 1970, the first 1:10,000 maps were produced using the Transverse Mercator Projection. The revision process continued until recently, with new editions appearing every 10 years or so for urban areas.

### Map Name(s) and Date(s)

275SW	1907
283NW	1905

### Historical Map - Slice A

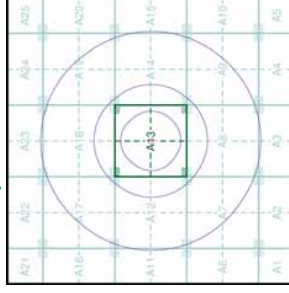

### Order Details

Order Number: 164345359\_1\_1  
 Customer Ref: 0770  
 National Grid Reference: 439070, 403990  
 Slice: A  
 Site Area (Ha): 0.19  
 Search Buffer (m): 1000

### Site Details

245, Barnsley Road, Wombwell, BARNLSLEY, S73 8DT

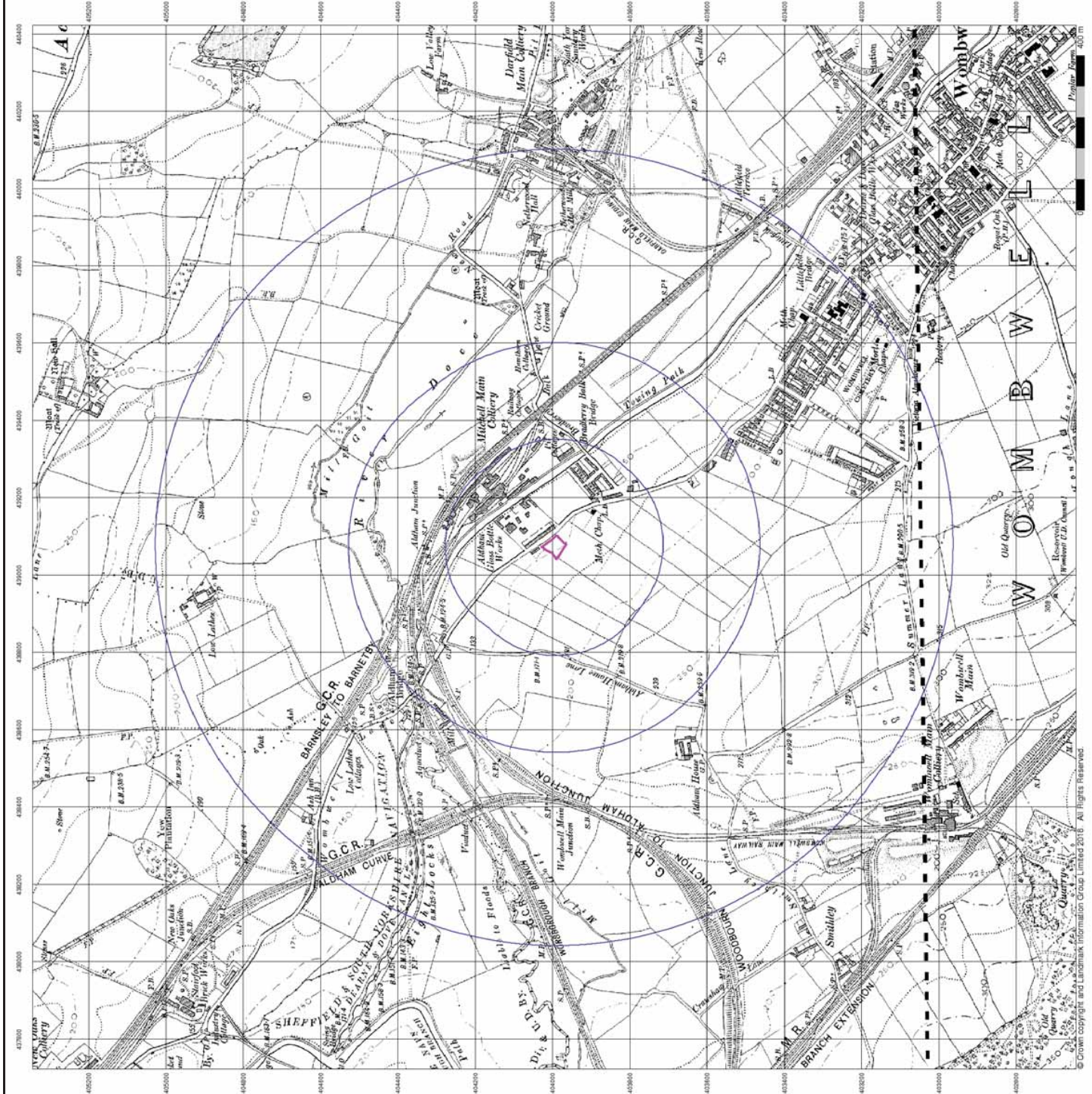

© Crown copyright and Landmark Information Group Limited 2016. All Rights Reserved.

## Yorkshire

### Published 1931

### Source map scale - 1:10,560

The historical maps shown were reproduced from maps predominantly held at the scale adopted for England, Wales and Scotland in the 1840's. In 1854 the 1:2,500 scale was adopted for mapping urban areas; these maps were used to update the 1:10,560 maps. The published maps on this site are based on the Cassini Projection, with independent surveys of a single county or group of counties, giving rise to significant inaccuracies in outlying areas. In the late 1940's, a Provisional Edition was produced, which updated the 1:10,560 mapping from a number of sources. The maps appear unfinished - with all military camps and other strategic sites removed. These maps were initially overprinted with the National Grid. In 1970, the first 1:10,000 maps were produced using the Transverse Mercator Projection. The revision process continued until recently, with new editions appearing every 10 years or so for urban areas.

### Map Name(s) and Date(s)

275SW	1931
1:10,560	
283NW	1931
1:10,560	

### Historical Map - Slice A

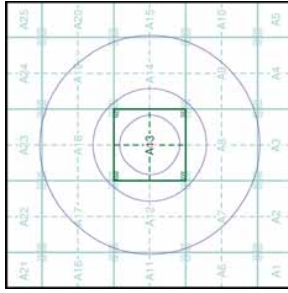

### Order Details

Order Number: 164345359\_1\_1  
 Customer Ref: 0770  
 National Grid Reference: 439070, 403990  
 Slice: A  
 Site Area (Ha): 0.19  
 Search Buffer (m): 1000

### Site Details

245, Barnsley Road, Wombwell, BARNLSLEY, S73 8DT



© Crown copyright and Landmark Information Group Limited 2016. All Rights Reserved.