

DATED 31st July 2018

BARNSELY METROPOLITAN BOROUGH COUNCIL

and

MCDONALD'S RESTAURANTS LIMITED

AGREEMENT

under Sections 72 and 278 of the Highways Act 1980 and Section 111 of the Local Government Act 1972 relating to highway improvements at Upper New Street Barnsley South Yorkshire

A.C. Frosdick, LL.B., DipLG,
Executive Director of Core
Services & Solicitor to the
Council
Town Hall
Barnsley
S70 2TA

THIS AGREEMENT is made the 31st day of July
Two thousand and eighteen

BETWEEN

1. **BARNSELY METROPOLITAN BOROUGH COUNCIL** of the Town Hall
Barnsley South Yorkshire S70 2TA ("the Council")
2. **MCDONALD'S RESTAURANTS LIMITED** (Company number 01002769)
whose registered office is at 11/59 High Road East Finchley London N2 8AW
("the Company")

INTERPRETATION

In this Agreement:-

"Act" means the Highways Act 1980 as amended by the New Roads and Street Works Act 1991

"Blue Land" means the land shown edged blue on Drawing number 3210-001 revision B attached at Schedule 1 hereto which is intended to become highway maintainable at public expense as provided herein

"CDM Regulations" means the Construction (Design and Management) Regulations 2007

"Certificate of Completion" means the certificate to be issued by the Highways Officer upon the satisfactory completion of the Works

"Company" includes the successors in title and assigns of the Company

"Conditions of Contract" means the Institution of Civil Engineers Conditions of Contract with such additions or amendments thereto as may be approved by the Highways Officer

"Development" means the retail development at the Site for which planning permission has been granted (ref 2017/0353)

“Drawings” means the drawings listed and attached at Schedule 1 hereof

“Final Certificate” means the certificate to be issued by the Highways Officer upon the satisfactory expiration of the Maintenance Period

“Highway” means the highway called Upper New Street Barnsley

“Highways Officer” means the Head of Highways Engineering and Transportation for the time being of the Council and includes any professional officer appointed by him for the purpose of the supervision or inspection of the Works

“Maintenance Period” means a period of twelve calendar months from the date of the issue of the Certificate of Completion

“Safety Audit” means a specified stage or stages of independent road safety audit procured pursuant to the Design Manual for Roads and Bridges

“Safety Audit Works” means any amended or additional works or any other measures necessary in order to comply with the recommendations of a Safety Audit

“Section 115 Agreement” means an agreement entered into between the Council and a relevant sewerage undertaker pursuant to section 115 of the Water Industry Act 1991 to allow connections of highway drainage to the public sewerage system made pursuant to or ancillary to the Works

“Security Deposit” means the sum of £150,662.11 (one hundred and fifty thousand six hundred and sixty two pounds and eleven pence) being the sum required to be deposited with the Council by the Company as security for the satisfactory completion of the Works

“Site” means the land between Upper New Street and Burleigh Street Barnsley

“Supervision Fee” means the sum of £9,217.46 (nine thousand two hundred and Seventeen pounds and forty six pence) being the fees which are estimated will be incurred by the Council in checking and approving the drawings site inspections and

administration of the Works of which a sum of £4,000.00 (four thousand pounds) has already been paid to the Council receipt of which is hereby acknowledged

"Specification" means the Specification for Highway Works published by HMSO with all amendments up to the date hereof

"Traffic Order Costs" means the costs which are estimated will be incurred by the Council in the preparation and publication of a traffic regulation order made pursuant to the Road Traffic Regulation Act 1980 to implement changes to traffic controls to facilitate access and egress from the Site

"Works" means the works described generally in Schedule 2 hereof and indicated in outline on the Drawings and any amended or additional works as provided for herein

Clause headings are for ease of reference only and shall not form part of this Agreement for the purposes of its construction or interpretation

WHEREAS

- (1) The Council is the Highway Authority for the purposes of the Act
- (2) Planning permission has been granted for the Development at the Site and the Council and the Company are desirous that the Works shall be carried out to facilitate the Development
- (3) The Works are wholly required to improve access to the Site to a standard required for traffic safety and thus facilitate the Development and the Company will derive a special benefit if the Works are executed
- (4) The Company is the freehold owner of the Site which is registered under title SYK269555 which includes the Blue Land and warrants that at the date hereof the Blue Land is free from any restrictions or incumbrances that might affect its

dedication as highway maintainable at public expense and enters into this agreement with the intention that the Blue Land shall be dedicated as highway for use by the public as provided for herein

(5) The Company shall execute or procure the execution of the Works as agent for and on behalf of the Council

(6) This Agreement is made pursuant to Sections 72 and 278 of the Act and Section 111 of the Local Government Act 1972 and the Council is satisfied that it will be of benefit to the public

(7) Nothing herein contained shall operate to restrict or prejudice the powers duties and rights of the Council under the Highways Act 1980 and the New Roads and Street Works Act 1991

NOW IT IS HEREBY AGREED by and between the parties as follows:-

1. SAFETY AUDITS

1.1 The Company has procured Stage 1 and Stage 2 Safety Audits and has supplied copies of the reports to the Highways Officer

1.2 The Company shall procure a Stage 3 Safety Audit and shall immediately upon receipt supply a copy of the report to the Highways Officer

1.3 The Company shall prepare and submit to the Highways Officer for his approval details of any Safety Audit Works and if the Highways Officer deems that no amended or additional works or any other measures are necessary he shall notify the Company in writing to that effect

1.4 The Company shall carry out and complete the Safety Audit Works at its own expense and in the same manner as the Works

1.5 The Company shall certify to the Highways Officer in writing that it has fully complied with the recommendations of the Safety Audit in respect of the Works or if the Highways Officer has notified the Company that no Safety Audit Works are required it shall submit to the Highways Officer a written statement of the reasons why the recommendations of the Safety Audit have not been complied with

2. **CONSENT TO WORK IN THE HIGHWAY**

2.1 The Council shall during such hours of working as may be agreed in advance with the Highways Officer permit the Company to enter upon the Highway for the purpose of carrying out the Works and all matters in connection with the carrying out of the Works

3. **EXECUTION OF THE WORKS**

3.1 The Company shall at its own expense for the purpose of carrying out the Works:-

(a) carry out surveys as required by the Highways Officer of the Highway and the Site

(b) carry out site investigation works

(c) appoint a designer approved by the Highways Officer to design a scheme for the Works (including all necessary drawings and documents to be approved by the Council) ("**the Approved Documents**")

(d) appoint a contractor approved by the Highways Officer for the construction of the Works in accordance with a form of contract which shall be approved by the Highways Officer ("**the Contract**")

3.2 The Company shall:

- (a) procure the provision in writing of a programme and timetable for the Works which shall be submitted to and approved by the Highways Officer prior to the commencement of the Works or any part thereof (**"the Approved Programme"**)
- (b) upon the request of the Highways Officer procure the provision of a written programme and timetable for any temporary traffic arrangements or any other measures which may be necessary or required in connection with the carrying out of the Works which shall be submitted to and approved by the Highways Officer prior to the commencement of the Works or any part thereof and shall comply with any further requests of the Highways Officer at any time during the carrying out of the Works
- (c) procure that the Works are carried out at its own expense in a good and workmanlike manner with proper and suitable materials to the reasonable satisfaction of the Highways Officer in accordance with the Specification and the Approved Documents and once commenced to proceed diligently with the Works and to use reasonable endeavours to complete the Works in accordance with the Approved Programme and in any case within two years from the date of this Agreement
- (d) before the commencement of the Works take whatever steps are necessary to locate and identify any services apparatus and equipment of any utility company Local Authority or other body which is situated in on under or over the Highway or which may otherwise be affected by the Works and shall supply to the Highways Officer copies of all consultations which have been carried out copies of all consents and

approvals obtained and details of any diversion or other works required to any services equipment or apparatus affected by the Works

("Apparatus Works")

- (e) carry out and complete the Apparatus Works at its own expense and in the same manner as the Works
- (f) procure compliance with all conditions and requirements imposed by any utility company local authority or other body in respect of any services equipment or apparatus affected by the Works
- (g) give the Highways Officer free access to the Site as is reasonably necessary for the proper inspection of the Works
- (h) procure that the Works are undertaken pursuant to the CDM Regulations
- (i) ensure the Works comply in every respect with the latest edition of Chapter 8 of the Traffic Signs Manual published by the Department of Transport

to permit the Council to inspect all site preparations undertaken before the commencement of the Works and the progress of the Works when underway with the right to sample and test all materials used and Works executed and generally to supervise the Works and to afford the Highways Officer free access to any part of the Works at all times prior to the issue of the Final Certificate subject to complying with safety requirements

3.3 In the event the Highways Officer determines that any variations to the Works are required the Highways Officer shall notify the Company as soon as reasonably practicable of any revised or additional works which may be

necessary and the Company shall carry out and complete the revised or additional works at its own expense and in the same manner as the Works

4. FEES AND COSTS

4.1 The Company shall on the completion of this Agreement pay to the Council:

- (i) the remaining balance of the Supervision Fee; and
- (ii) the sum of £1,000.00 being the Council's legal fees in the preparation and completion of this Agreement
- (iii) the sum of £4,000.00 (four thousand pounds) in respect of the Traffic Order Costs

4.2 In the event the fees incurred by the Council exceed the Supervision Fee the Highways Officer shall provide a certified estimate of the sum of the increased fees and the Company shall pay the said sum of the increased fees to the Council within 28 days of receiving a written request therefor

5. CERTIFICATES AND MAINTENANCE PERIOD

5.1 The Company may at any time when it believes the Works have been completed notify the Highways Officer in writing whereupon the Highways Officer shall make arrangements to inspect the Works and if the Works have been completed to his satisfaction the Highways Officer shall issue the Certificate of Completion to the Company or if not the Highways Officer shall notify the Company of any outstanding items and the Company shall provide the Highways Officer with a program for their completion

5.2 The Company shall at its own expense maintain the Works and the Blue Land throughout the Maintenance Period and shall make good any defects or damage arising or occurring in the Works during that period to the satisfaction of the Highways Officer

5.3 After the expiration of the Maintenance Period the Company shall submit to the Highways Officer in an electronic format 'as-built' drawings and the whole of the Health and Safety file pursuant to the CDM Regulations and then provided the Company has made good any defects or damage to the entire satisfaction of the Highways Officer and provided that all monies due to the Council hereunder have been paid the Highways Officer shall issue the Final Certificate to the Company

5.4 For the avoidance of doubt the covenants on the part of the Company contained in Clause 7 of this Agreement shall not be affected by the issue of the Final Certificate

6. **DEDICATION AND ADOPTION OF THE BLUE LAND**

6.1 The Company hereby acknowledges and agrees that upon the issue of the Certificate of Completion the Company shall be deemed to have dedicated the Blue Land as highway for use by the public and the Company shall not grant any wayleave licence easement or right in respect of any part or parts of the Blue Land without the written consent of the Council

6.2 Upon the issue of the Final Certificate the Blue Land shall become highway maintainable at the public expense

7. **COMPENSATION AND INDEMNITY**

7.1 The Company will on demand reimburse the Council with all expenditure it may properly incur in relation to any valid and proper claims made pursuant to the Noise Insulation Regulations 1975 or Part I of the Land Compensation Act 1973 arising from the use of the Highway as altered by the Works and the Roads constructed by the Works together with the reasonable legal costs and surveyor's fees incurred either by the Council or any third party whose costs

the Council is legally obliged to pay in connection with the processing and settlement of any such claims

- 7.2 The Company will indemnify and keep indemnified the Council against all costs actions proceedings claims demands damages and losses of whatever nature arising out of the non-observance non-performance or other breach of the Company's obligations under this Agreement and all claims demands damages and losses of whatever nature which may be suffered by the Council due to any reason connected with the carrying out of the Works
- 7.3 The Company will indemnify and keep indemnified the Council against all costs actions proceedings claims demands damages and losses of whatever nature arising as a consequence of the discharge of water or any other substance or material whatsoever from the highway drainage system
- 7.4 The Company shall insure or shall procure that the Contractor carrying out the Works shall insure against any damage loss or injury which may occur to any property or person arising by or out of the execution of the Works otherwise than due to any act or omission of the Council and such insurance shall be effected prior to the commencement of the Works with an insurer on terms approved by the Council (such approval not to be unreasonably withheld or delayed) for at least the sum of £10,000,000 for each and every claim
- 7.5 The Company shall be responsible for:
- (a) all of the costs that the Council may incur in entering into a section 115 Agreement including any costs the sewerage undertaker may charge under the Section 115 Agreement for technical administrative supervisory or legal costs from time to time

- (b) notifying the relevant sewerage undertaker of their intention to commence drainage connection works
- (c) carrying out any maintenance or remedial works required by the sewerage undertaker pursuant to the Section 115 Agreement; and
- (d) shall indemnify the Council against all losses liabilities claims costs damages and expenses arising from any claim by a sewerage undertaker any person or competent authority arising from or ancillary to the connection of the highway drains to the public sewer

8. DETERMINATION BY THE COUNCIL

- 8.1 In the event the Company fails to perform or observe any of the obligations herein contained or if a receiving order in bankruptcy is made against the Company or of the Company is wound up or enters into a composition or arrangement (otherwise than for the purpose of amalgamation or reconstruction) the Council may without prejudice to any of its rights claims or remedies against the Company for such non-performance or non-observance determine this Agreement by notice in writing to the Company sent to the address stated in this Agreement Subject always to the provisions of clauses 9 and 10 hereof

9. DEFAULT POWERS

- 9.1 Without prejudice to clauses 6 and 8 hereof if the Company fails to execute or complete the Works in accordance with the Company's obligations hereunder the Council shall be entitled to execute or complete the Works in default by its own employees contractors or otherwise and to recover from the Company all of the costs incurred by the Council thereby as certified in writing by the Highways Officer Provided that this default power shall only be exercisable by

the Council after at least twenty eight days notice of that intention has been given in writing to the Company

10. SECURITY DEPOSIT

- 10.1 The Company shall prior to the commencement of the Works pay the Security Deposit to the Council
- 10.2 Upon the issue of the Certificate of Completion the sum of the Security Deposit shall be reduced to a sum equal to ten percent of its original sum and the Council shall arrange as soon as practicable thereafter to refund the sum of the excess to the Company
- 10.3 As soon as practicable and in any event within one month after the issue of the Final Certificate the Council shall refund the remaining sum of the Security Deposit to the Company
- 10.4 If at any time the Company fails to observe or perform any of the covenants necessary for the construction of the Works on the Company's part herein contained or to pay any sums due from the Company to the Council under this Agreement or if circumstances shall arise which would entitle the Council to terminate this Agreement then without prejudice to any other rights and remedies of the Council against the Company under this Agreement or under statutory powers the Council shall be entitled to deduct the amount of any costs and expenditure which the Council may suffer or incur by reason thereof from the Security Deposit and the Council shall be entitled to retain any such sums so deducted and apply the same to discharge any such amounts or sums due from the Company to the Council
- 10.5 If the Council gives notice pursuant to clause 9 hereof and the amount as certified by the Highways Officer to be the estimated cost of carrying out and completing the Works or any part thereof or otherwise remedying any breach by the Company of the provisions hereof shall exceed the sum of the Security Deposit being held at that time the Company shall forthwith on demand pay

the difference between the estimated cost and the sum of the Security Deposit to the Council and the same shall be held by the Council as part of the Security Deposit

10.6 The amount of the costs and expenditure estimated to be incurred by the Council shall be that certified by the Highways Officer in writing and such certificate shall be final and binding on the parties hereto

11. **IT IS HEREBY AGREED AND DECLARED** as follows:-

- 11.1 If at any time prior to the commencement of the Works the Company wishes to terminate this Agreement it may do so by giving notice to the Council and the Council shall give the Company an account of all abortive costs reasonably and properly incurred by the Council in respect of this Agreement Within 28 days from the date of that account if that account shows that the payments made by the Company under the foregoing provisions of this Agreement have exceeded those costs the Council shall refund that excess and if that account shows that those costs exceed the payment made by the Company under the foregoing provisions of this Agreement the Company shall pay to the Council a sum equal to that excess
- 11.2 That for the purpose of carrying out its obligations under this Agreement but for no other purpose whatsoever the Company will act as agent for and on behalf of the Council
- 11.3 The Company is to act as the only client in respect of the Works pursuant to the CDM Regulations
- 11.4 The development shall not be opened for trading purposes until the Completion Certificate has been issued by the Highways Officer

- 11.5 Any monies due to be paid under the provisions of this Agreement shall be paid within twenty one days of the due date or if not paid within that period shall bear interest at 3% above the Base Rate of Barclays Bank Plc for the time being such interest being payable from the due date to the date of payment
- 11.6 Once executed the Contract shall be deemed incorporated in this Agreement insofar as it is applicable and does not conflict with the provisions herein
- 11.7 The Company shall not assign any of its rights and obligations arising under this Agreement without the prior written consent of the Council
- 11.8 Any notice or demand required by this Agreement to be given or made shall be in writing
- 11.9 The land which is to be benefited by the Works is the land to which the planning application hereinbefore referred to relates
- 11.10 This Agreement will be of benefit to the public
- 11.11 In the event of any dispute or difference between the parties hereto arising as to the construction of this Agreement or any of the provisions hereof such dispute or difference shall be referred to the President for the time being of the Institution of Civil Engineers whose decision shall be final and binding on the parties hereto Provided that nothing in this clause shall authorise the reference to arbitration of any question as to whether the whole or any part of the Works has been carried out and completed to the satisfaction of the Highways Officer

SCHEDULE 1
THE DRAWINGS

- 3210 – 001 revision B s278 works
- 3210 – 101 revision B off-site highway works general arrangement
- 3210 – 102 revision B off-site highway works site clearance
- 3210 – 103 revision B on-site highway works construction types
- 3210 – 104 revision B off-site highway works road markings and signage
- 3210 – 105 revision A off-site highway works proposed levels
- 3210 – 120 revision B off-site highway works standard details

SCHEDULE 2
THE WORKS

- a) Construction of new slip road entry to the site;
- b) Provision of left turn exit only onto Upper New Street;
- c) Construction of new traffic island;
- d) Re kerbing;
- e) Carriageway construction reconstruction and resurfacing;
- f) Footway construction reconstruction and resurfacing;
- g) Drainage;
- h) Street Lighting;
- i) Provision of road markings and signing;
- j) Any works ancillary to the above.

EXECUTED by the parties hereto as a Deed the day and year first before written

THE COMMON SEAL of Barnsley)

Metropolitan Borough Council was)

hereunto affixed in the presence of: - 



Executive Director of Core Services & Solicitor to the Council/Authorised Signatory

No. 1054
IN REGISTER

EXECUTED as a **DEED** by

McDONALD'S RESTAURANTS LIMITED

acting by:

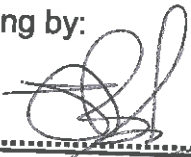

..... JODIE BARRACOUGH

Authorised Signatory

as Attorney pursuant to a power of attorney dated 21 May 2018

in the presence of:

Witness signature: 

Witness name: MICHAELA JOHNSON

Witness address: 11-59 High Road,
East Finchley, London N2 8AW



McDonald's™

1. Do not scale from this drawing
2. All details to be confirmed on site.

KEY

S278 WORKS

LAND TO BE DEDICATED BOUNDARY



| Rev | Description | Date | By | CHK |
|-----|-------------------------------------|----------|----|-----|
| B | Land to be dedicated boundary added | 29.05.18 | ct | |
| A | Section 38 area removed | 11.05.18 | MT | CT |

AMENDMENTS



ADL Traffic & Highways Engineering Ltd.
 ADL House
 The Oaklands Business Park
 Yate, Bristol
 BS37 5NA
 Tel : 01454 332100
 Fax : 01454 327983
 E-Mail : hcad@adlhighways.co.uk

ADL Job No. **3210**

Project **McDonalds Restaurant
 Upper New Street
 Barnsley**

Title **S278
 Works**

Date **15.12.17** Drawn **MT**

Checked _____ Date _____ Approved _____ Date _____

Scale **1:500** Drg No. **3210-001** Rev. **B**

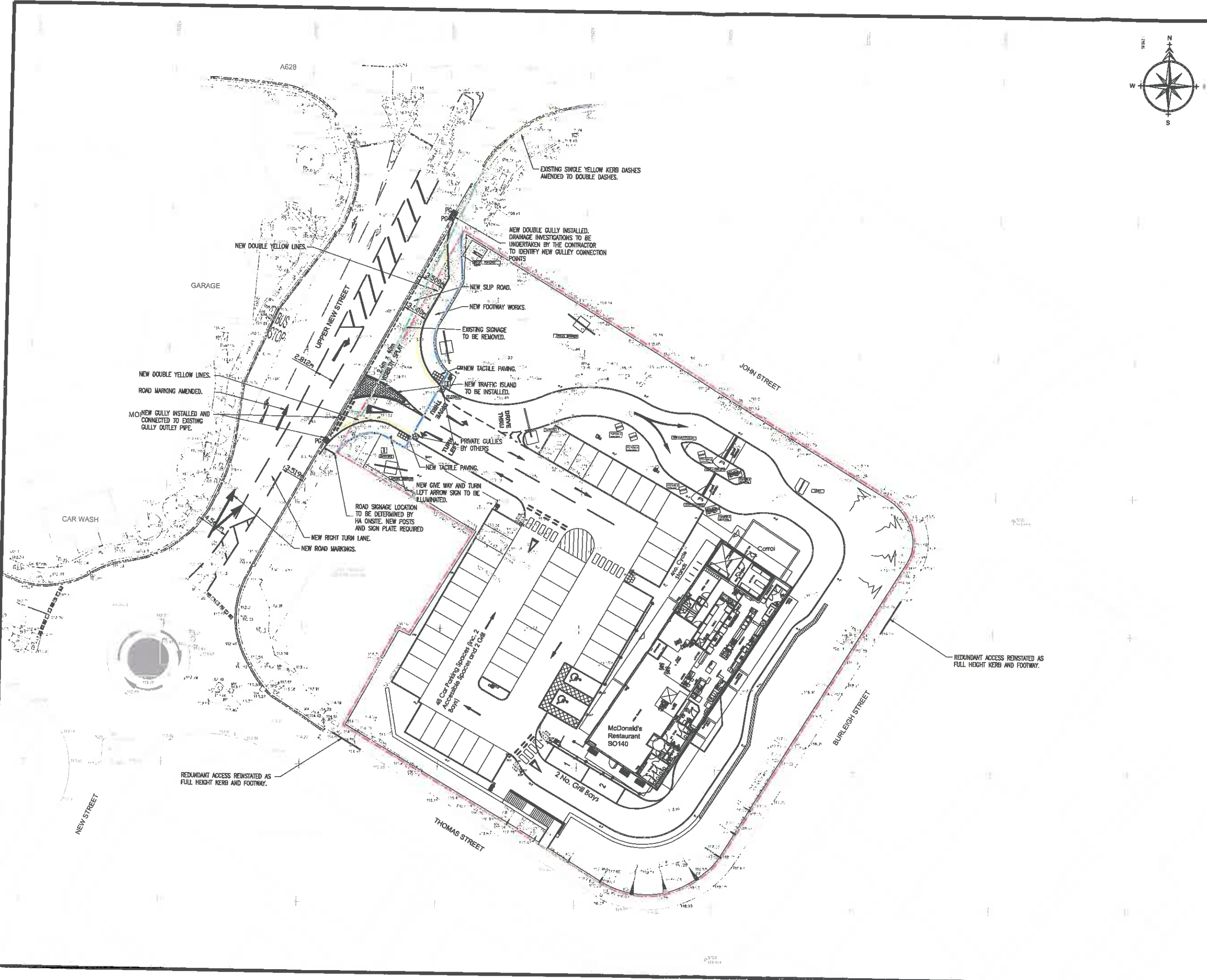

© Copyright ADL Traffic & Highways Engineering Ltd

- NOTES**
1. Do not scale from this drawing
 2. All details to be confirmed on site.
 3. Background plan is based upon topographical survey provided by Glenville, and architects site plan supplied by AEW Architects and Design Ltd. Drawing no: 8835_AEW_B543_D004C.
 4. Mechanical handling equipment to be used with materials in excess of 20 kg.

KEY

EXISTING SITE BOUNDARY ---

PROPOSED SITE BOUNDARY ---

[Handwritten signature]

| No. | Revision Note | Date | By | Checked |
|-----|---|----------|----|---------|
| B | Storage note amended | 11.05.18 | MT | TC |
| A | Drawing changed accordingly to client comments dated 18-02-18 | 24.04.18 | MT | |



ADL Traffic & Highways Engineering Ltd.
 ADL House
 The Oaklands Business Park
 Yeta, Bristol
 BS37 5NA
 Tel : 01454 932100
 Fax : 01454 927883
 E-Mail : hcad@adlhighways.co.uk

ADL Job No. **3210**
 Project **McDonald's Restaurant Upper New Street Barnsley**

Title **Off-site Highway Works General Arrangement**

| | | | |
|----------|----------|----------|----------|
| Date | 14.11.17 | Drawn | MT |
| Checked | TC | Date | 03.01.18 |
| Approved | | Date | |
| Scale | 1:250 | Drwg No. | 3210-101 |
| Rev. | | Rev. | B |

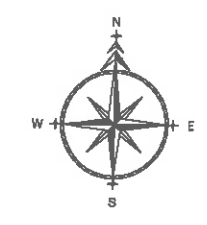
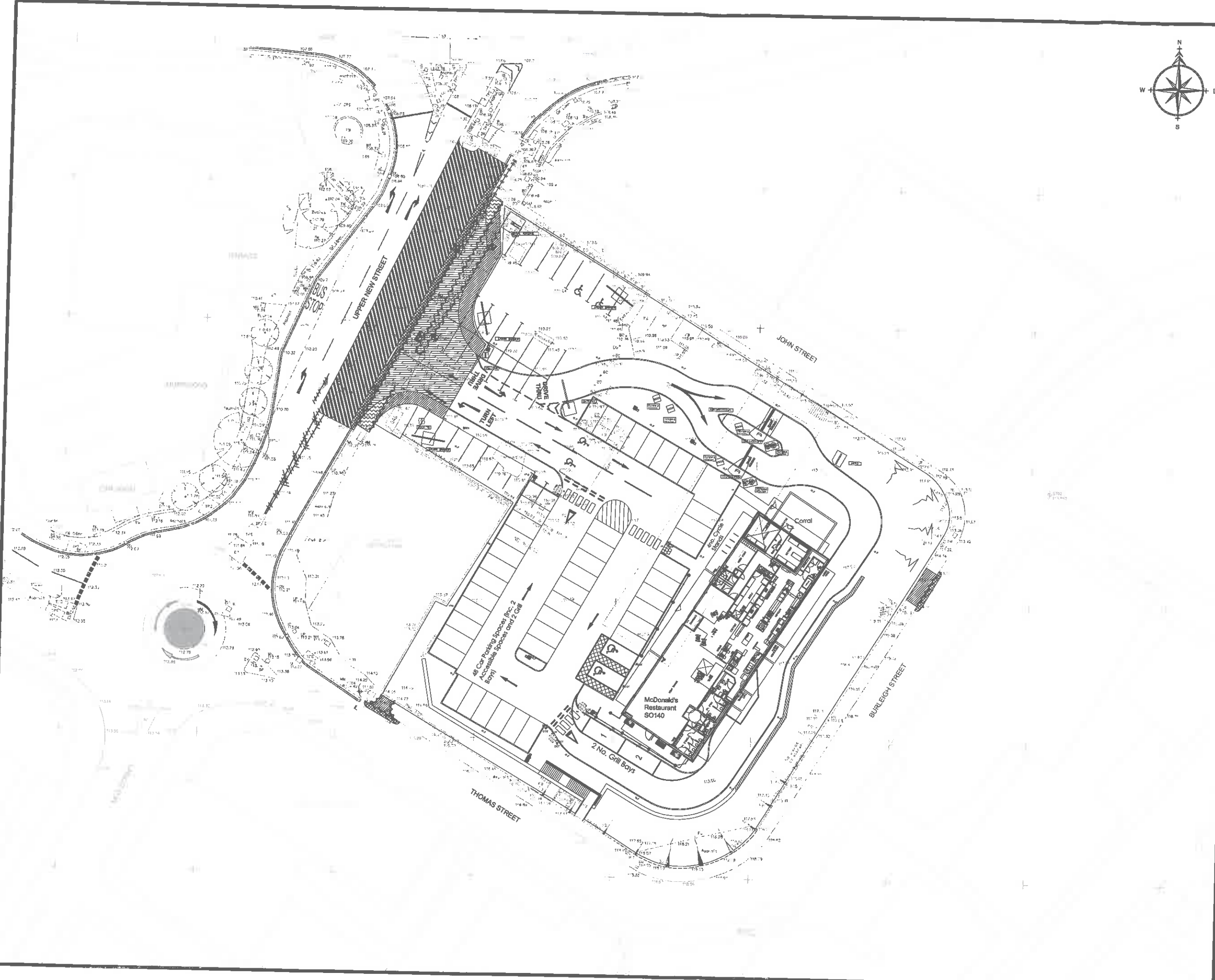

© Copyright ADL Traffic & Highways Engineering Ltd

- NOTES**
1. Do not scale from this drawing
 2. All details to be confirmed on site.
 3. Background plan is based upon topographical survey provided by Gierwils, and architects site plan supplied by AEW Architects and Design Ltd. Drawing no: 6635_AEW_8543_0004C.
 4. Mechanical handling equipment to be used with materials in excess of 20 kg.

- KEY**
- CARRIAGEWAY TO BE PLANNED OFF 40mm.
 - AREA REDUCED TO CARRIAGEWAY FORMATION.
 - AREA REDUCE TO ACCOMMODATE CARRIAGEWAY TIE IN.
 - AREA REDUCED TO FOOTWAY FORMATION.
 - FOOTWAY SURFACE COURSE TO BE PLANNED OFF.
 - KERBS TO BE REMOVED.
 - GUARD RAILING TO BE REMOVED.
 - ROAD MARKINGS TO BE HYDROBLASTED.
 - SERVICE COVERS TO BE ADJUSTED TO SUIT DESIGN LEVELS. COVERS WITHIN NEW CARRIAGEWAY TO BE REPLACED WITH HEAVY DUTY COVERS AND FRAMES.
 - REMOVE EXISTING GULLY COVER AND FRAME. CLEAN OUT AND BACK FILL POT WITH LEAN MIX CONCRETE. EXISTING GULLY CONNECTION TO BE UTILISED.
 - EXISTING SIGN PLATE AND POSTS TO BE REMOVED TO TIP.

| | | | | |
|-----|--|----------|----|---------|
| B | Key amended | 11.05.18 | MT | CI |
| A | Shading changed accompanying outside comments dated 18-02-18 | 24.04.18 | MT | |
| No. | Revision Note | Date | By | Checked |

AMENDMENTS



ADL Traffic & Highways Engineering Ltd.
 ADL House
 The Oaklands Business Park
 Yate, Bristol
 BS37 5NA
 Tel : 01454 382100
 Fax : 01454 3827993
 E-Mail : hcad@adhighways.co.uk

ADL Job No. 3210

Project
 McDonald's Restaurant
 Upper New Street
 Barnsley

Title
 Off-site Highway Works
 Site Clearance

| | | | |
|---------|----------|----------|----------|
| Date | 22.11.17 | Drawn | MT |
| Checked | TC | Date | 03.01.18 |
| Scale | 1:250 | Orig No. | 3210-102 |
| | | Rev. | B |

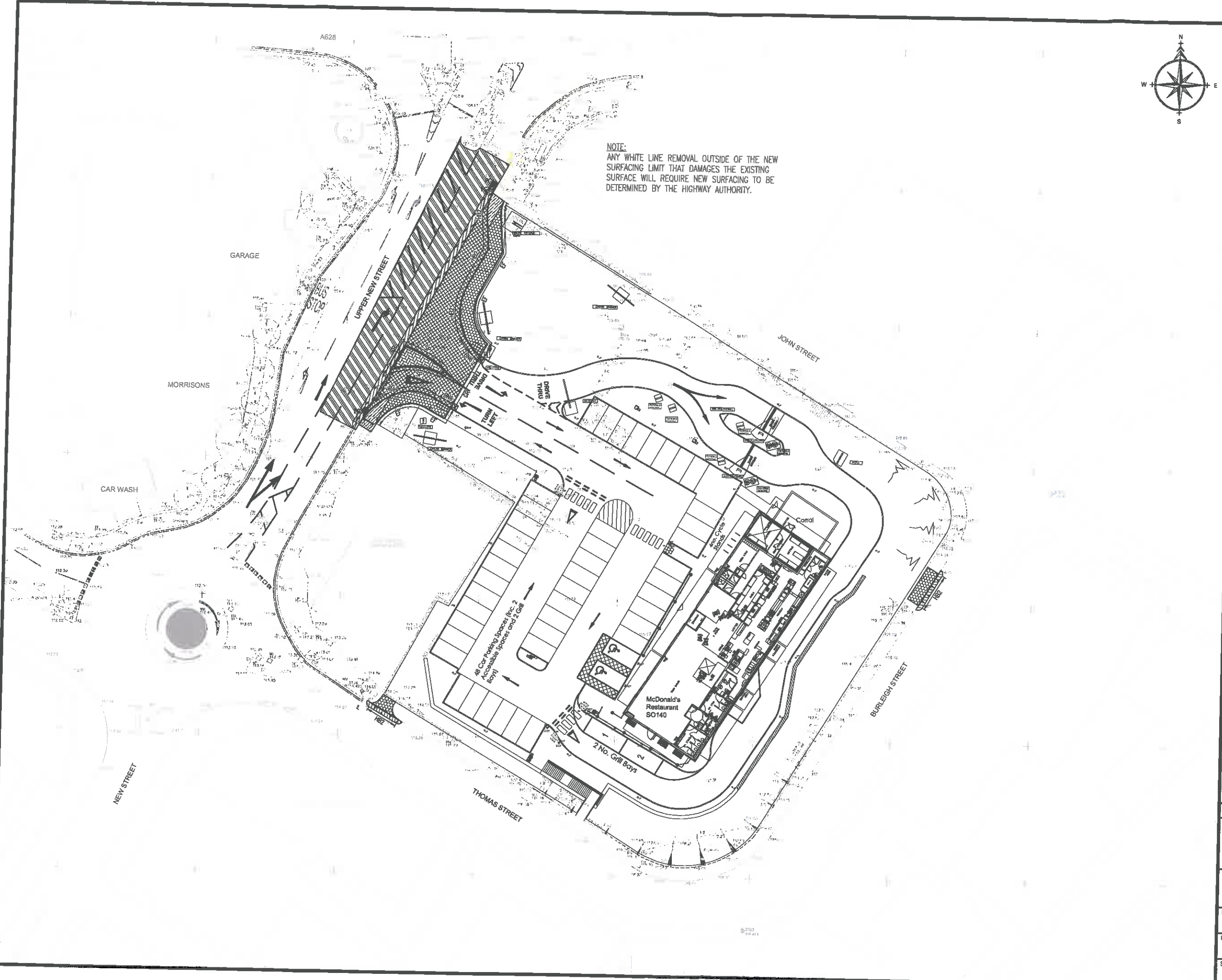

NOTE:
 ANY WHITE LINE REMOVAL OUTSIDE OF THE NEW SURFACING LIMIT THAT DAMAGES THE EXISTING SURFACE WILL REQUIRE NEW SURFACING TO BE DETERMINED BY THE HIGHWAY AUTHORITY.



© Copyright ADL Traffic & Highways Engineering Ltd

- NOTES**
1. Do not scale from this drawing
 2. All details to be confirmed on site.
 3. Background plan is based upon topographical survey provided by Glamville, and architects site plan supplied by AEW Architects and Design Ltd. Drawing no: 8835_AEW_B543_0004C.
 4. Mechanical handling equipment to be used with materials in excess of 20 kg.

- KEY**
- TYPE F1 - FULL DEPTH FOOTWAY CONSTRUCTION.
 - TYPE F2 - FOOTWAY OVERLAY CONSTRUCTION.
 - TYPE P1 CONSTRUCTION FULL DEPTH.
 - TYPE P2 FULL DEPTH VEHICULAR CROSSOVER CONSTRUCTION.
 - TYPE P3 CONSTRUCTION CARRIAGEWAY TIE IN WITH EXISTING.
 - TYPE P4 CONSTRUCTION CARRIAGEWAY OVERLAY.
 - TOPSOIL AND SEED
 - TACTILE PAVING BUFF COLOURED

- KERB TYPE KEY**
- HALF BATTERED KERB
TYPE HB2 - 125 FACE
 - STANDARD TRANSITION KERBS
TYPE DL1 OR DR1
 - BULL HOSED KERB
TYPE BN 0-6mm UPSTAND
 - EDGING KERB
 - SPLAYED KERB
TYPE SP 75mm UPSTAND
 - GRANITE SETS
TYPE GR 100mm x 100mm

SEE DRAWING NO. H2122-300 FOR CONSTRUCTION STANDARDS

| | | | | |
|-----|---|----------|----|---------|
| B | Note added | 11.05.18 | MT | CT |
| A | Drawings changed to accommodate overall comments dated 12-02-18 | 24.04.18 | MT | |
| No. | Revision No. | Date | By | Checked |



ADL Traffic & Highways Engineering Ltd.
 ADL House
 The Oaklands Business Park
 Yate, Bristol
 BS37 5NA
 Tel : 01454 392100
 Fax : 01454 327983
 E-Mail : hcad@adlhighways.co.uk

ADL Job No. 3210
 Project
 McDonald's Restaurant
 Upper New Street
 Barnsley

Tab
 Off-site Highway Works
 Construction Types

| | | | |
|----------|----------|---------|----------|
| Des | 22.11.17 | Drawn | MT |
| Checked | TC | Date | 03.01.18 |
| Approved | | Date | |
| Scale | 1:250 | Drp No. | 3210-103 |
| | | Rev. | B |

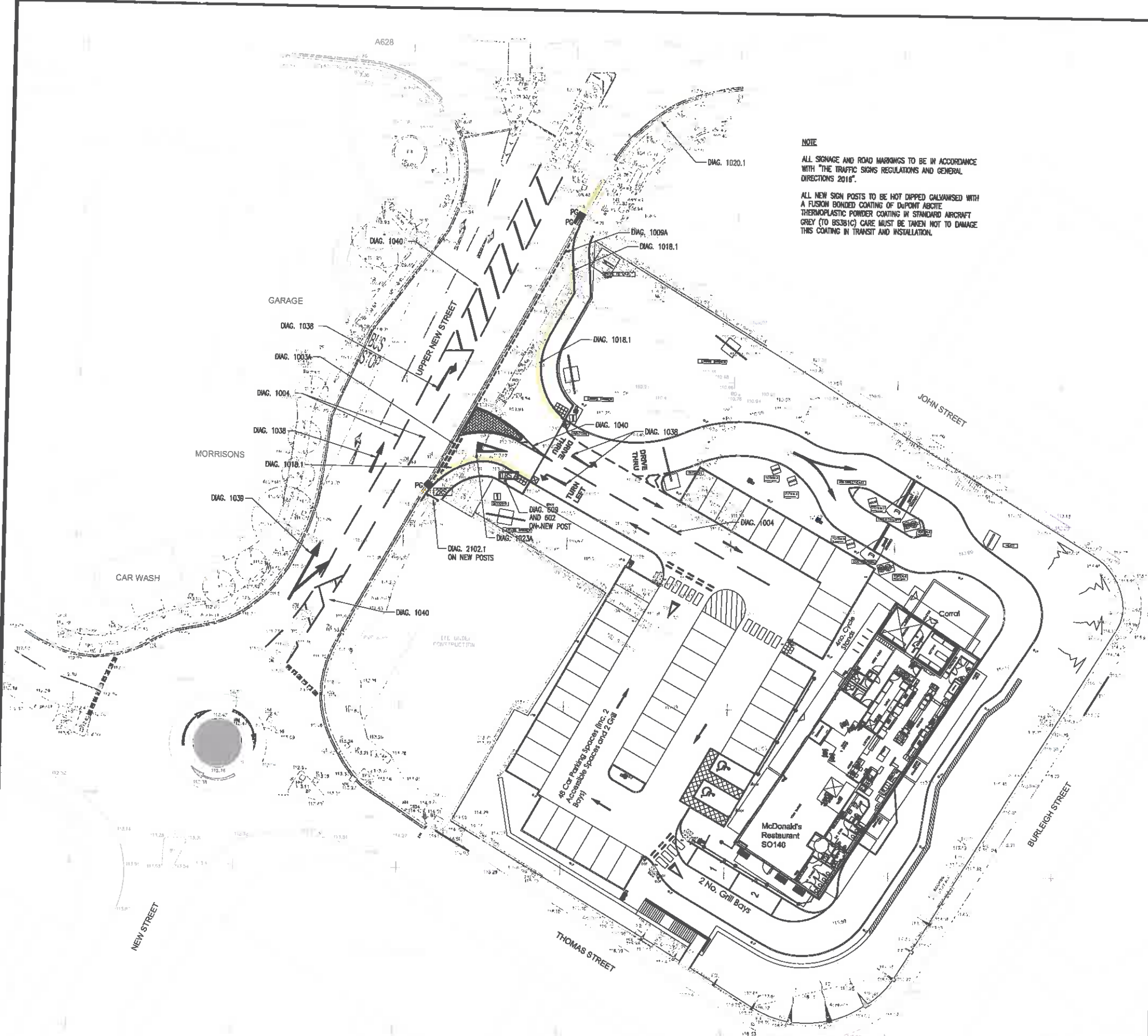

NOTE
 ALL SIGNAGE AND ROAD MARKINGS TO BE IN ACCORDANCE WITH "THE TRAFFIC SIGNS REGULATIONS AND GENERAL DIRECTIONS 2016".

ALL NEW SIGN POSTS TO BE HOT DIPPED GALVANISED WITH A FUSION BONDED COATING OF DUPONT ABCITE THERMOPLASTIC POWDER COATING IN STANDARD AIRCRAFT GREY (TO BS381C) CARE MUST BE TAKEN NOT TO DAMAGE THIS COATING IN TRANSIT AND INSTALLATION.



© Copyright ADL Traffic & Highways Engineering Ltd

- NOTES**
- Do not scale from this drawing
 - All details to be confirmed on site.
 - Background plan is based upon topographical survey provided by Glenville, and architects site plan supplied by AEW Architects and Design Ltd. Drawing no: 8835_AEW_8543_0004C.
 - Mechanical handling equipment to be used with materials in excess of 20 kg.

- ROAD MARKINGS**
- DIAG. 1003A - 600mm MARK, 300mm GAP, 100mm WIDE DOUBLE LINES AT 200mm APART.
 - DIAG. 1004 - 400mm MARK, 2000mm GAP, 100mm WIDE.
 - DIAG. 1008A - 600mm MARK, 300mm GAP, 100mm WIDE.
 - DIAG. 1018.1 - DOUBLE YELLOW LINE, 100mm WIDE LINE, 100mm GAP, 100mm WIDE LINE.
 - DIAG. 1020.1 - DOUBLE YELLOW FLASHES 100mm WIDE LINE, 100mm GAP, 250mm LENGTH.
 - DIAG. 1023A - 3750mm MARK LONGITUDINAL.
 - DIAG. 1038 - 4000mm MARK LONGITUDINAL ARROW.
 - DIAG. 1039 - 6000mm MARK LONGITUDINAL ARROW.
 - DIAG. 1040 - 4000mm MARK, 100mm WIDE, 2000mm GAP.

- SIGNAGE**
- DIAG. 602 - VEHICLE TRAFFIC MUST GIVE WAY TO BE ILLUMINATED.
 - DIAG. 609 - VEHICLE TRAFFIC MUST TURN LEFT AHEAD.
 - DIAG. 2102.1 - DIRECTIONAL SIGNAGE.

NOTE
 ALL SIGNAGE AND ROAD MARKINGS TO BE IN ACCORDANCE WITH "THE TRAFFIC SIGNS REGULATIONS AND GENERAL DIRECTIONS 2016".

| | | | | |
|-----|---|----------|----|---------|
| B | By amended | 11.05.18 | MT | CI |
| A | Drawing changed corresponding to site comments dated 19-02-18 | 24.04.18 | MT | |
| No. | Revision Note | Date | By | Checked |



ADL Traffic & Highways Engineering Ltd.
 ADL House
 The Oaklands Business Park
 Yeta, Bristol
 BS37 5NA
 Tel : 01454 332100
 Fax : 01454 327983
 E-Mail : hcad@adlhighways.co.uk

ADL Job No. **3210**
 Project
**McDonald's Restaurant
 Upper New Street
 Barnsley**

Title
**Off-site Highway Works
 Road Markings & Signage**

| | | | |
|----------|----------|---------|----------|
| Date | 22.11.17 | Drawn | MT |
| Checked | TC | Date | 03.01.18 |
| Approved | | Date | |
| Scale | 1:250 | Dwg No. | 3210-104 |
| | | Plac | B |

SIGNAGE DETAILS



1 RS
 DIAG. 609
 DIAG. 602



2 RS
 DIAG. 2102.1



McDonald's™

NOTES

1. Do not scale from this drawing
2. All details to be confirmed on site.
3. Background plan is based upon topographical survey provided by Glanville, and architects site plan supplied by AEW Architects and Design Ltd. Drawing no:- 6635_AEW_8543_0004C.

KEY

- EXISTING LEVELS + 108.910
- PROPOSED LEVELS + 108.910
- TOP OF KERB LEVEL + 108.910
- GRADIENT 1:40

| Rev | Description | Date | By | Ch |
|-----|--|----------|----|----|
| A | Drawing changed accommodating councils comments dated 19-02-18 | 24.04.18 | MT | |

AMENDMENTS



ADL Traffic & Highways Engineering Ltd.
 ADL House
 The Oaklands Business Park
 Yate, Bristol
 BS37 5NA
 Tel : 01454 332100
 Fax : 01454 327983
 E-Mail : hoad@adhighways.co.uk

ADL Job No. **3210**

Project **McDonald's Restaurant
 Upper New Street
 Barnsley**

Title **Off-site Highway Works
 Proposed Levels**

Date **23.11.17** Drawn **MT**

Checked _____ Date _____ Approved _____ Date _____

Scale **1:250** Dwg No. **3210-105** Rev. **A**

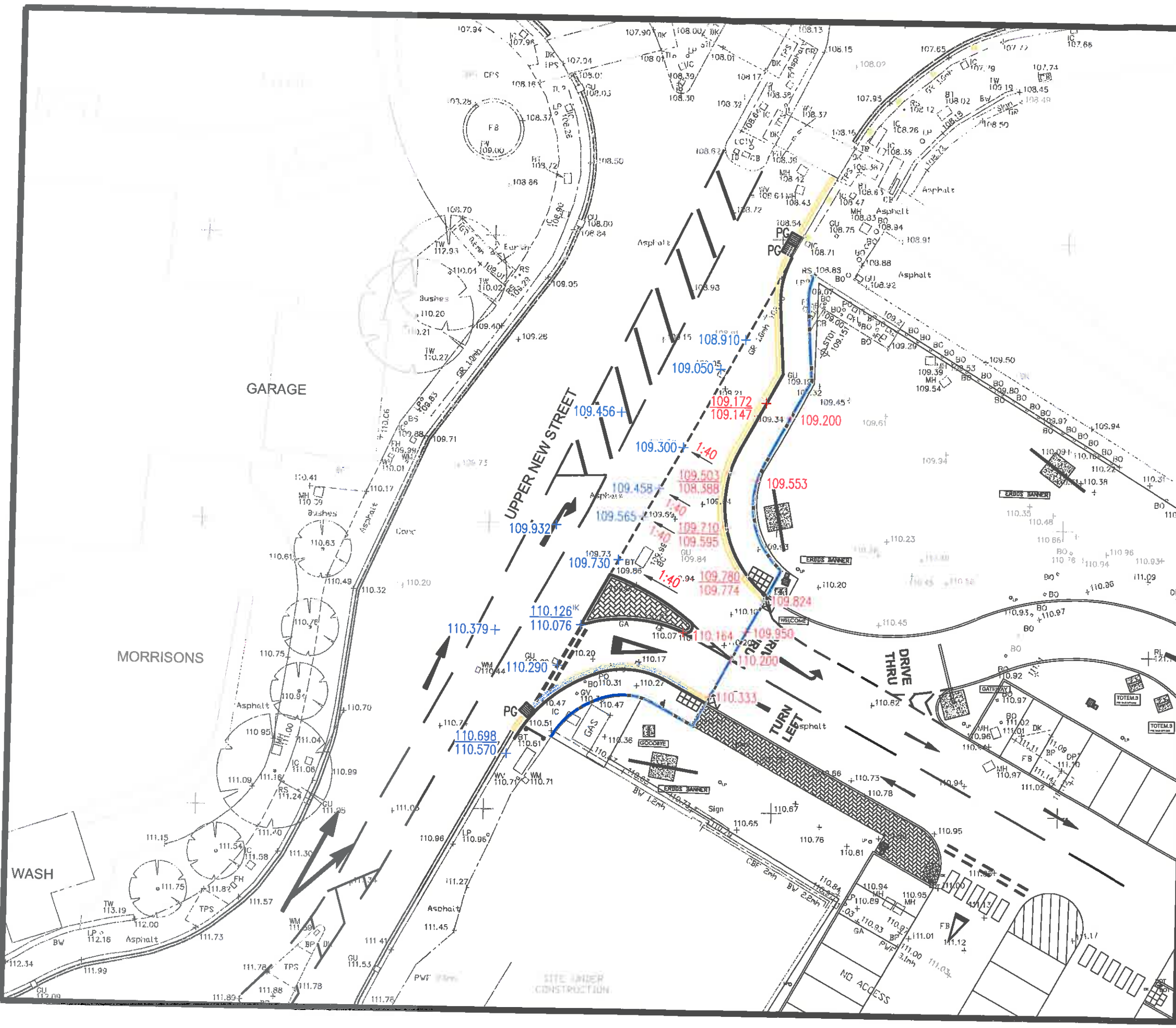

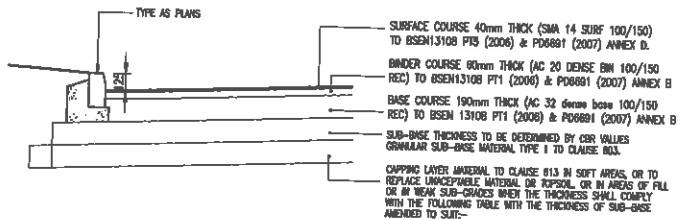

| Sub-Grade Cor % | Capping Layer Thickness (mm) | Sub-Base Layer Thickness (mm) | Overall Thickness (mm) |
|-----------------|------------------------------|-------------------------------|------------------------|
| <2 | 300 | 150 | 500 |
| 2 - 3 | 300 | 150 | 500 |
| 3 - 4 | 200 | 150 | 350 |
| 4 - 8 | 150 | 150 | 300 |
| 8 - 15 | 0 | 225 | 225 |
| >15 | 0 | 150 | 150 |

CARRIAGEWAY CONSTRUCTION TYPE P1

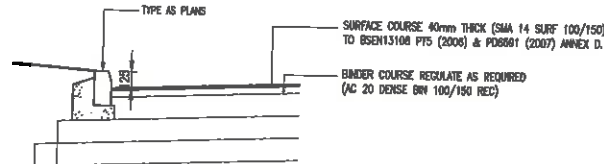

TYPE P4 CONSTRUCTION CARRIAGEWAY OVERLAY

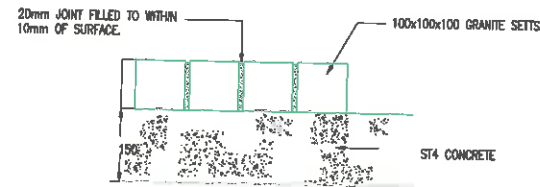

GRANITE SETTS 100x100x100

- NOTES:
- JOINTS IN SURFACE COURSE TO BE SAW CUT.
 - TACK COAT TO BE APPLIED TO ALL EXPOSED FACES OF EXISTING BITUMINOUS MATERIALS THAT ARE TO BE OVERLAID BY NEW MATERIALS.
 - VERTICAL FACES OF JOINTS TO BE PAINTED WITH BITULCOID OR EQUIVALENT.
 - THE MINIMUM THICKNESS OF ANY REGULATING LAYER TO BE 2.0 x STONE SIZE.

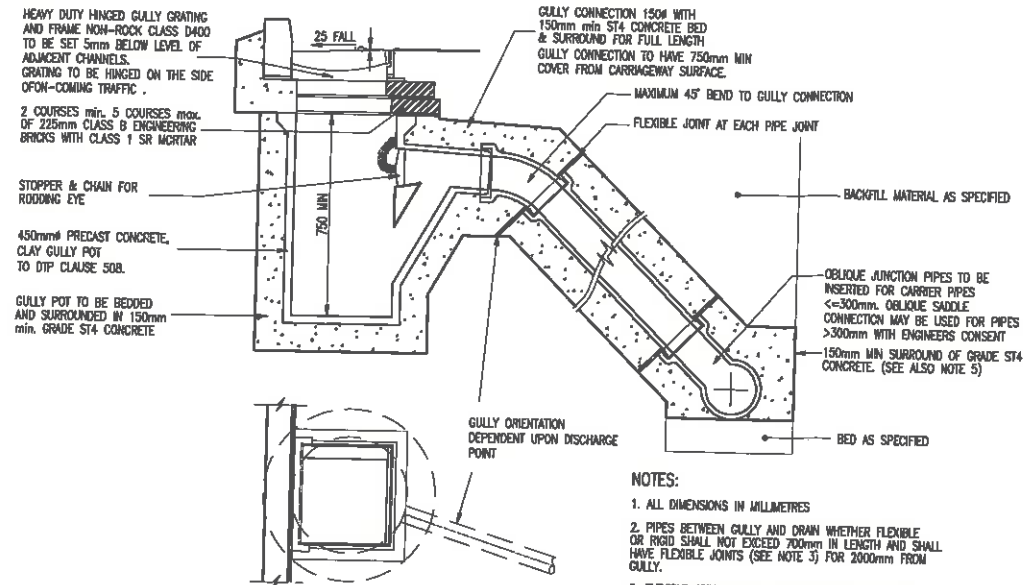

NOTES:

- ALL DIMENSIONS IN MILLIMETRES.
- PIPES BETWEEN GULLY AND DRAIN WHETHER FLEXIBLE OR RIGID SHALL NOT EXCEED 700mm IN LENGTH AND SHALL HAVE FLEXIBLE JOINTS (SEE NOTE 3) FOR 2000mm FROM GULLY.
- FLEXIBLE JOINTS SHALL BE FORMED WITH 18mm THICK FIBRE BOARD, PRE-CUT TO PIPE DIA. THE HEIGHT AND WIDTH EQUAL TO THE CONCRETE CROSS SECTION.
- UNLESS OTHERWISE STATED, CONCRETE TO HAVE CLASS II RESISTANCE TO SULPHATES.
- WHERE COVER TO PIPES IS MORE THAN OR EQUAL TO 900mm, THE CONCRETE SURROUND TO THE DRAIN MAY BE OMITTED.
- EXCAVATION FOR GULLY UNDER PAVED AREA TO BE BACKFILLED IN ACCORDANCE WITH DTP CLAUSE 508.
- GULLY POTS TO BE 900mm DEEP.

TRAPPED ROAD GULLY DETAIL

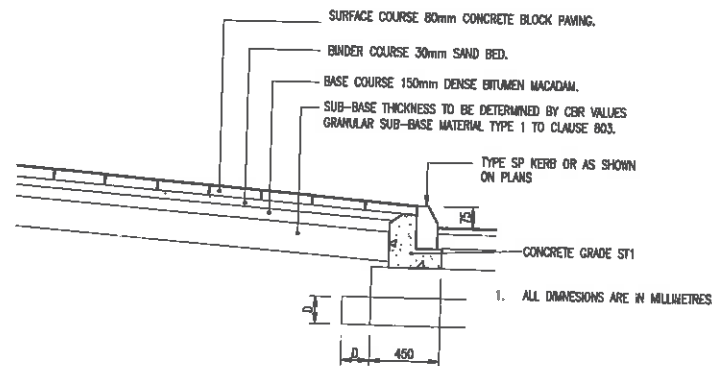

VEHICLE CROSSOVER CONSTRUCTION TYPE P2

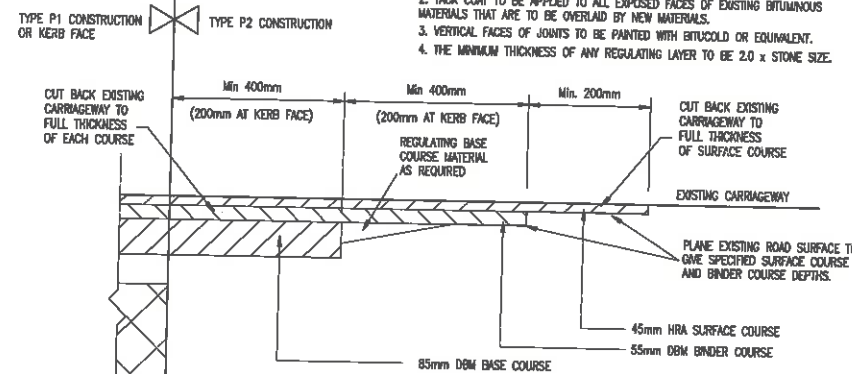

ALL NEW MATERIALS TO BE AS TYPE P1 CONSTRUCTION

CARRIAGEWAY TYPE P3 TIE IN CONSTRUCTION

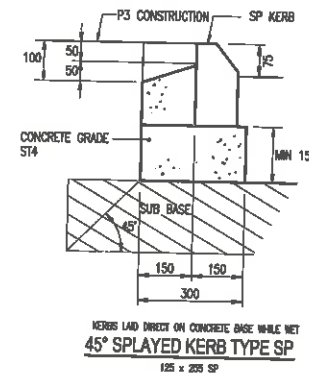

KERBS LAD DIRECT ON CONCRETE BASE WHILE NET 45° SP LAYED KERB TYPE SP 125 x 255 SP

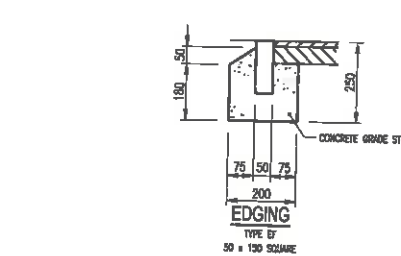

KERBS LAD DIRECT ON CONCRETE BASE WHILE NET BN 0-6 mm FACE BULLNOSE KERB TYPE BN 125x150

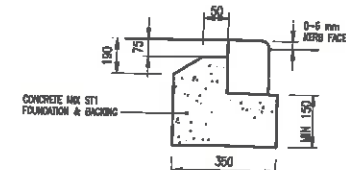

KERBS LAD DIRECT ON CONCRETE BASE WHILE NET BN 0-6 mm FACE BULLNOSE KERB TYPE BN 125x150

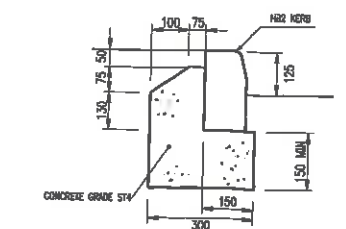

KERBS LAD DIRECT ON CONCRETE BASE WHILE NET HB2 - HALF BATTERED KERB 125 x 255 HALF BATTER

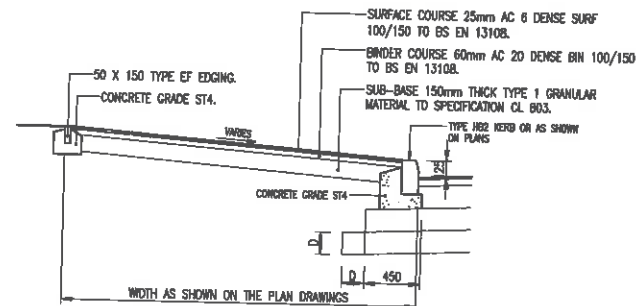

FOOTWAY CONSTRUCTION TYPE F1

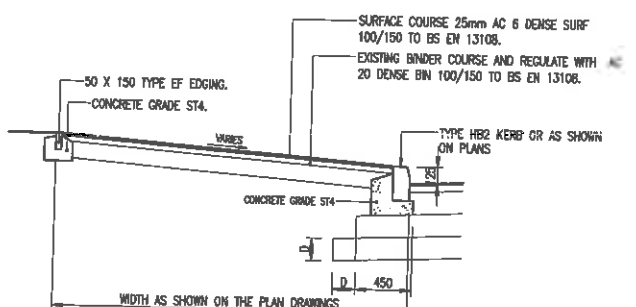

FOOTWAY CONSTRUCTION TYPE F2

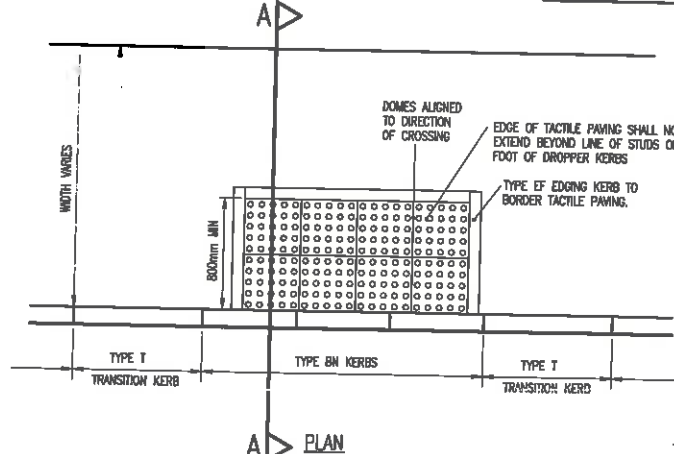

- NOTES:
- TACTILE PAVING SLABS SHALL COMPLY WITH B.S. 7263 PART 1.
 - CLAY PAINTS ARE NOT PERMITTED.
 - FLAGS SHALL BE BEDDED ON 30mm SAND/CEMENT MORTAR IN ACCORDANCE WITH THE PAVING MANUFACTURERS RECOMMENDATIONS, ON 150mm SUB BASE TYPE 1.
 - FLAGS TO BE 400mm x 400mm BY 65mm COLOURED RED AT CONTROLLED CROSSINGS AND BUFF ELSEWHERE.
 - THE SPECIFICATION AND LAYING ARRANGEMENT OF THE TACTILE FLAGS SHALL BE IN ACCORDANCE WITH DETR DOCUMENT 'GUIDANCE ON THE USE OF TACTILE PAVING SURFACES'.
 - CARE MUST BE TAKEN TO ENSURE ADEQUATE DRAINAGE WHEN KERB IS FLUSH WITH THE CARRIAGEWAY.
 - MAXIMUM KERB FACE SHALL NOT EXCEED 6mm.

TACTILE PAVING CONSTRUCTION DETAIL

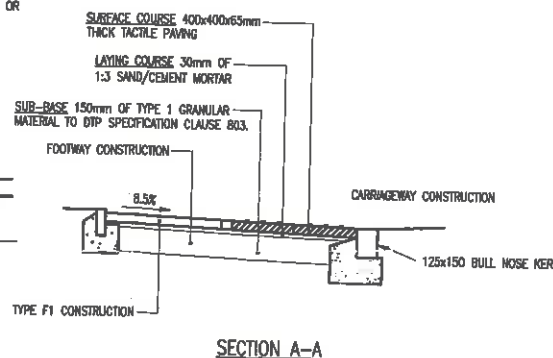

SECTION A-A



Copyright ADL Traffic & Highways Engineering Ltd

- NOTES
- Do not scale from this drawing.
 - All details to be confirmed on site.
 - Background plan is based upon topographical survey provided by Glenville, and architects site plan supplied by AEW Architects and Design Ltd. Drawing no: 6835_AEW_B543_0104A.
 - Mechanical handling equipment to be used with materials in excess of 20 kg.

Handwritten signature

| | | | | |
|----|--|----------|----|---------|
| B | Carriageway overlay detail substituted P4 | 11.08.10 | MT | CT |
| A | Edging added to tactile paving. P2 altered overall | 25.04.10 | MT | CT |
| No | Revision No. | Date | By | Checked |



ADL Traffic & Highways Engineering Ltd.
ADL House
The Oaklands Business Park
Yate, Bristol
BS37 5NA
Tel: 01454 332100
Fax: 01454 327993
E-Mail: hced@adlhighways.co.uk

ADL Job No. 3210

Project
McDonald's Restaurant
Upper New Street
Barnsley

Title
Off-site Highway Works
Standard Details

| | | | |
|---------|----------|----------|----------|
| Date | 30.11.17 | Drawn | MT |
| Checked | | Approved | |
| Date | | Date | |
| Scale | N.T.S | Proj No. | 3210-120 |
| Rev. | | | B |