

This drawing is copyright of Topping Engineers LTD and must not be copied or reproduced in any way without written consent.
DO NOT SCALE OFF THIS DRAWING

Notes:
 1. This drawing is to be read in conjunction with all relevant Architects and Engineers Drawings.
 2. It is assumed that all works will be carried out by a competent contractor working, where appropriate, to an approved method statement.

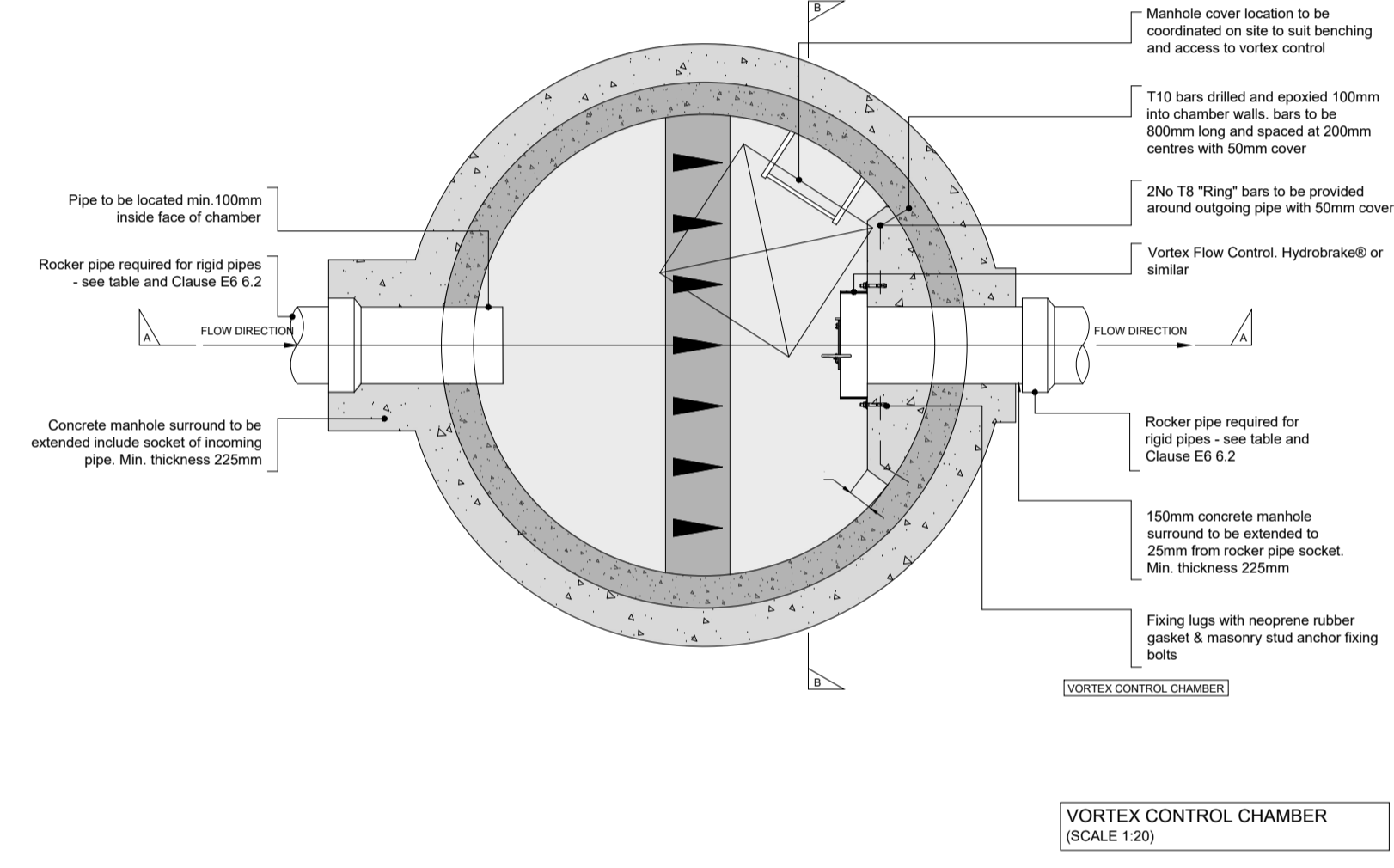
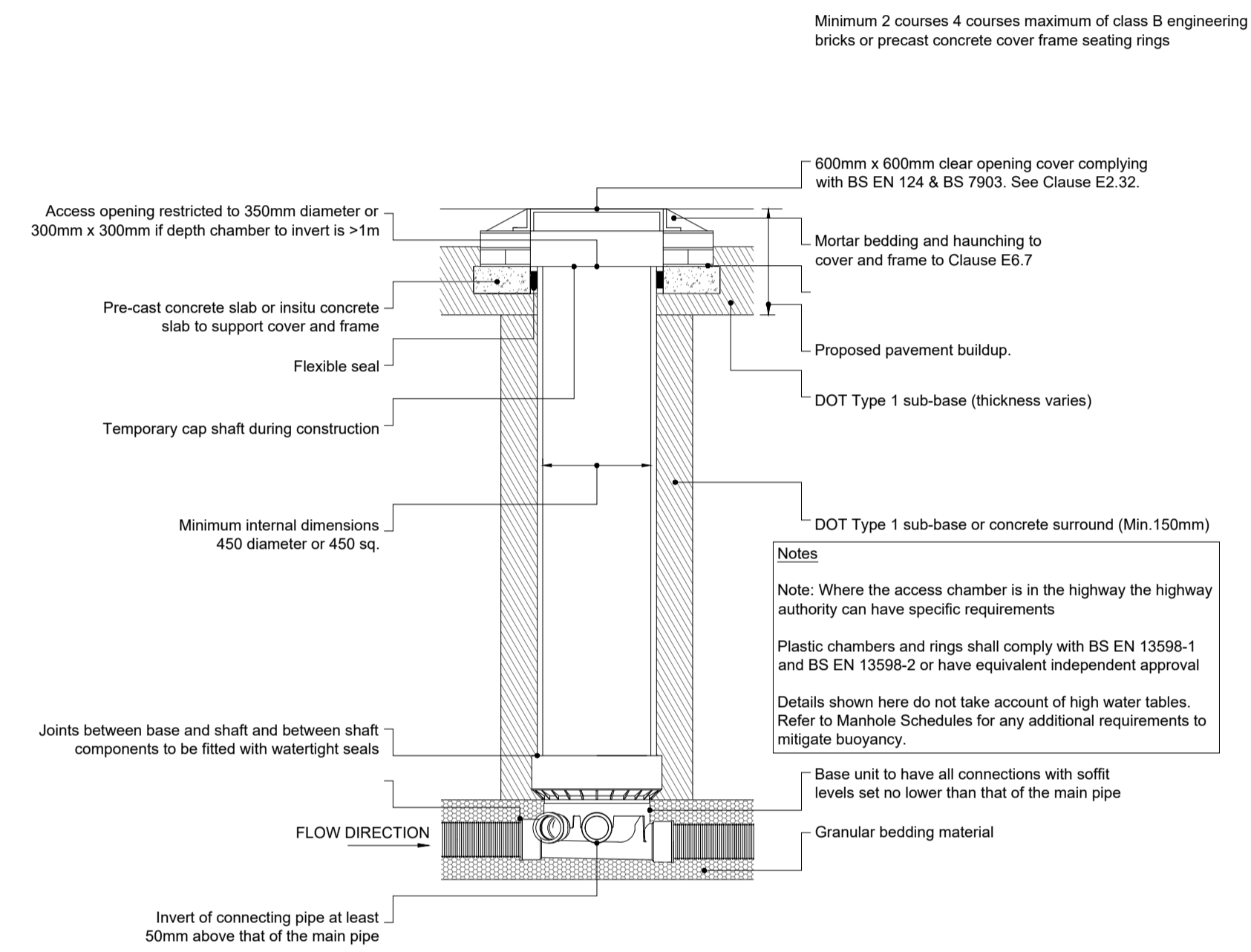
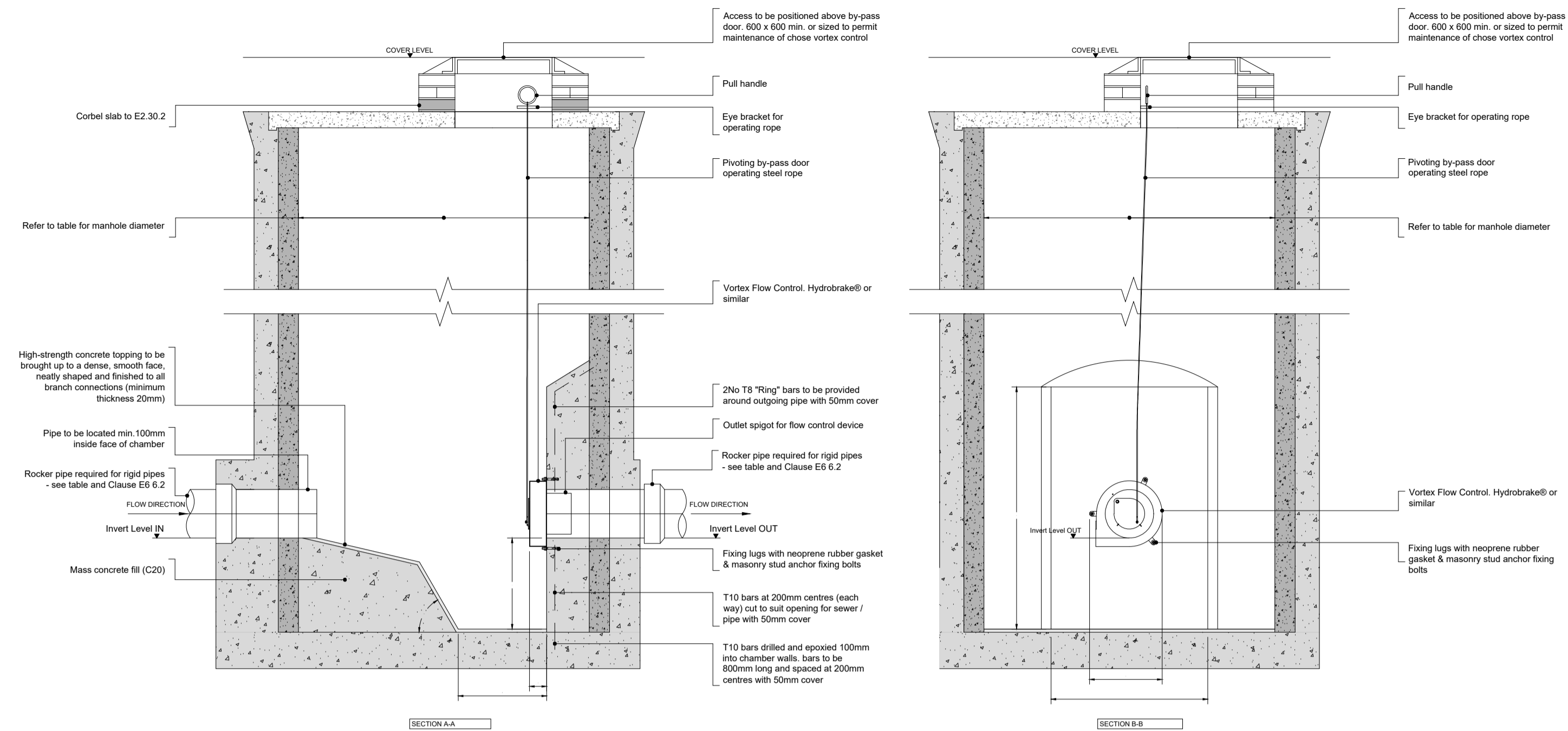

WATER AUTHORITY WARNING NOTES
 1. Warning signs are to be 40mm high red lettering on a white plastic base. The plastic base dimensions are to be approx. 300mm x 300mm x 6mm.
 2. The base is to be resistant to attack by sewage environment.
 3. The warning sign is to be mounted on a removable safety grid available from cover manufacturer.
 4. The sign in this manhole must read "Caution - Vortex Control located here".
 5. A sign must be fitted in the upstream MH to read "Caution - Vortex Control down stream".
 6. A sign must be fitted in the downstream stream MH to read "Caution - Vortex Control up stream".

TYPICAL INSPECTION CHAMBER DETAIL - TYPE 3 (FLEXIBLE MATERIAL DETAIL) [MAXIMUM DEPTH FROM COVER LEVEL TO SOFFIT OF PIPE IN AREAS SUBJECT TO VEHICLE LOADING 3m, NON ENTRY] (NOT TO SCALE)

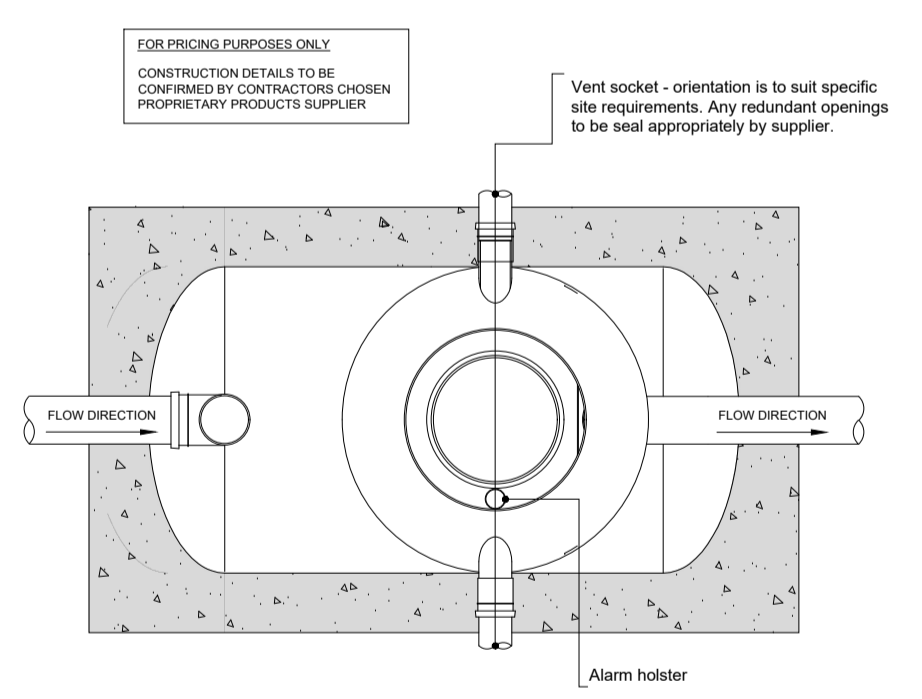
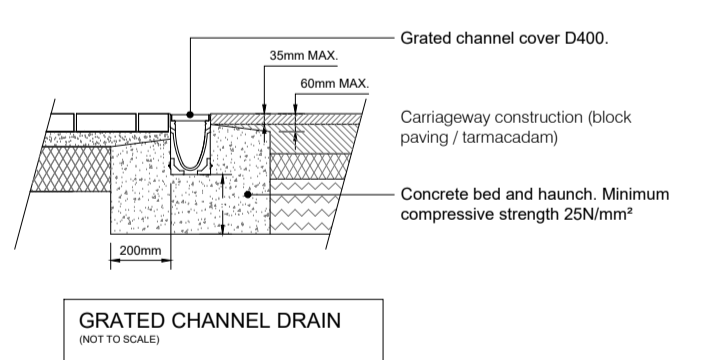

- Petrol Interceptor Notes:**
- The extension of vent pipes above ground must be located where vented vapour will be dispersed safely into the atmosphere. Locations must take into account conditions at or near the site which could adversely affect safe dispersal of any discharge and cause a flammable atmosphere to reach a source of ignition including, but not limited to:
 - the nature, height and location of surrounding buildings and properties;
 - the direction of prevailing winds and the possibility of unusual air currents caused by high buildings;
 - the proximity of possible ducts for vapour, such as roof gutters, down pipes, chimney stacks, ventilation shafts, trees, narrow passages and gaps between buildings.
 - Vent pipes should be as short as practicable and be terminated not less than 2.5m above paving level nor less than 1m above the head of an operable window. The vent discharge point should not be within a horizontal distance of 3m of opening windows or any other opening to a building. Vent pipes should not be less than 3m from the boundary, but where there is an impermeable wall at the boundary extending from ground level and for at least 3m in any direction from the vent discharge point, they may be located close to the boundary.
 - All interceptors shall be fitted with power, telemetry and an oil level alarm. Alarms are to provide a visual indication of the separator status and to include an additional audible alarm when the separator needs emptying. Alarms are to be located in the most appropriate location on site to ensure high level / maintenance warnings are quickly identified (e.g. reception / gatehouse etc).
 - All separators must comply with the requirements of the Environment Agency and BS EN 858-202 A1 2004 and BS EN 858-2:2003.
 - Where the Petroleum Act applies interceptors must comply with the licensing authority requirements.

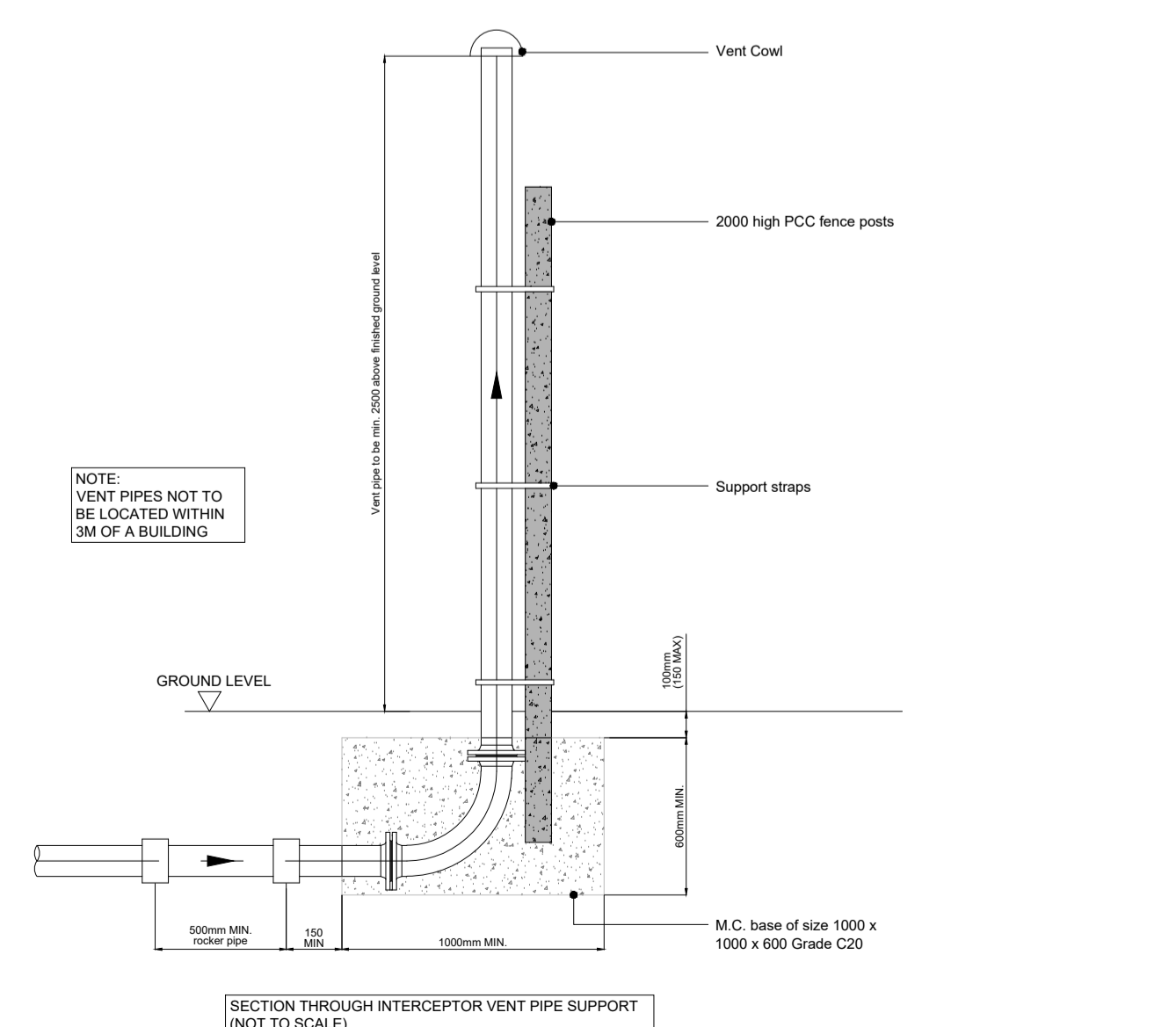
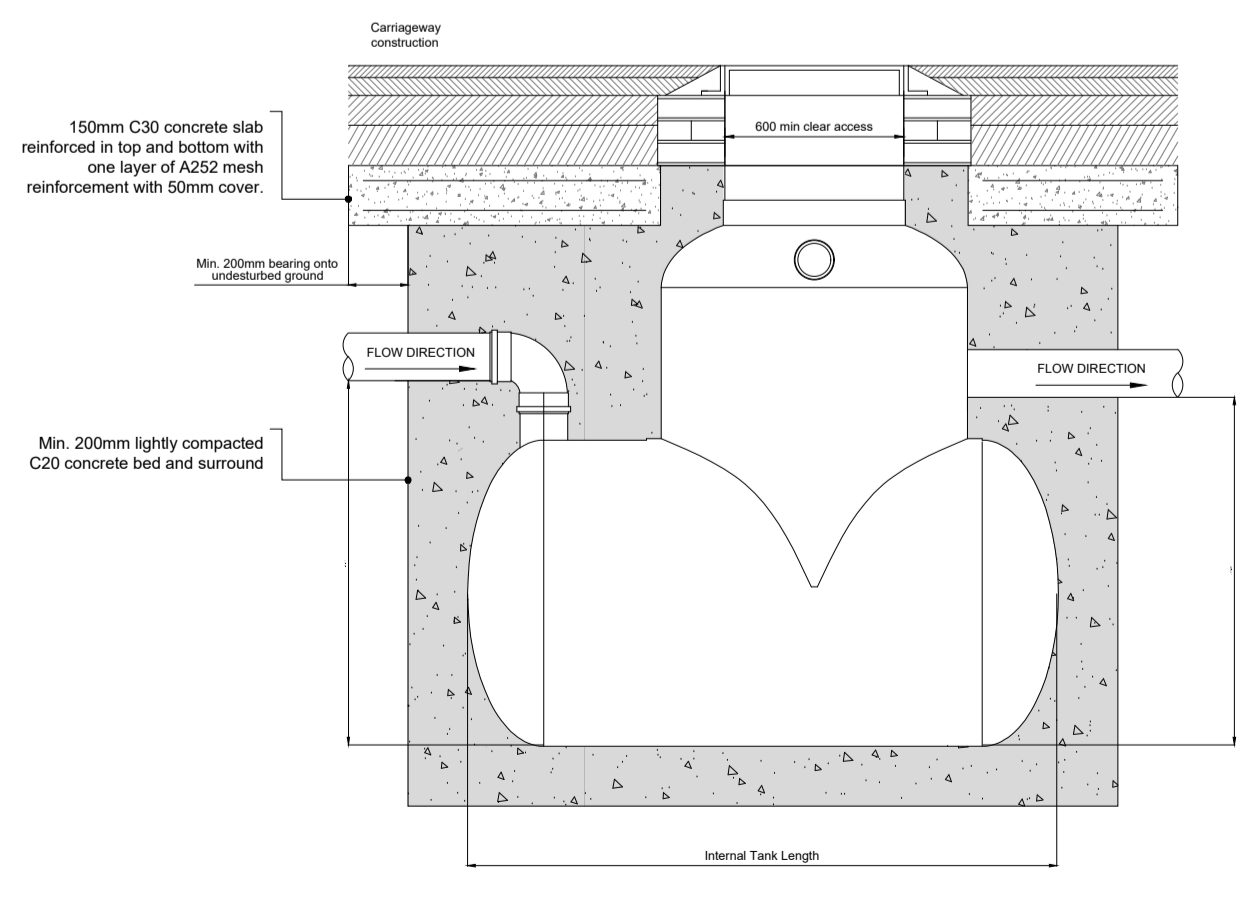
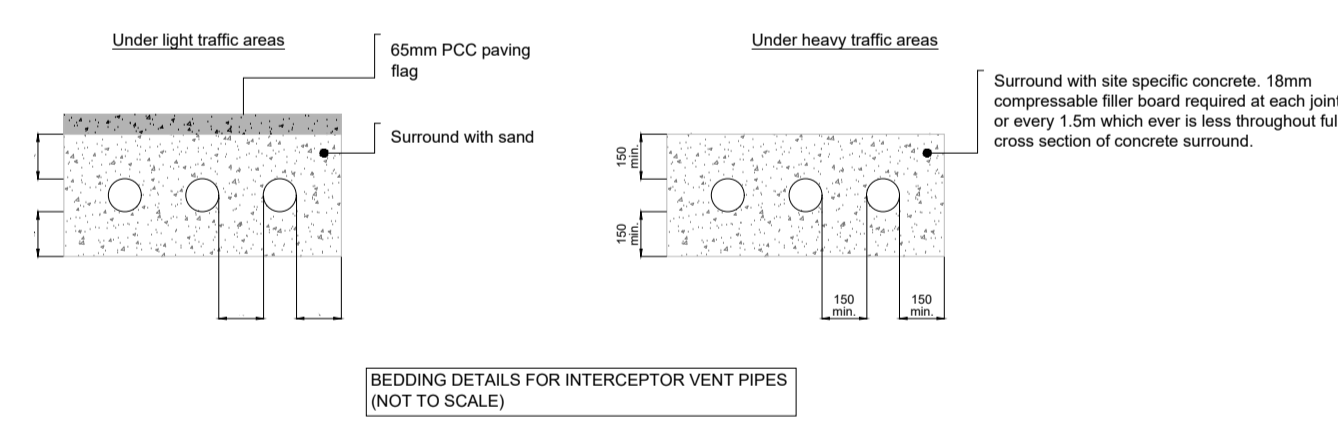

P01	Initial Issue	19/06/26	JA
No.	Revision	Date	Drwn

Status: Preliminary

TOPPING ENGINEERS
 CONSULTING CIVIL & STRUCTURAL ENGINEERS
 Aire House 12 Victoria Avenue Harrogate HG1 1ED
 t: 01423 522 293
 w: www.topping-engineers.com
 e: info@topping-engineers.com

Client: Bradley Stankler

Project: KDA Wholesale Fall Bank Industrial Estate

Drawing title: Drainage Details

Drawn	JA	Chkd	CG	Date	June 2026	Scale	NTS
Sheet Size	A1	Drawing No.	25542-DR-C-0102	Revision	P01		