

© 2020 RPS Group

Notes

1. This drawing has been prepared in accordance with the scope of RPS's appointment with its client and is subject to the terms and conditions of that appointment. RPS accepts no liability for any use of this document other than by its client and only for the purposes for which it was prepared and provided.
2. If received electronically it is the recipient's responsibility to print to correct scale. Only written dimensions should be used.
3. This drawing should be read in conjunction with all other relevant drawings and specifications.

Key:

— 2.4m x 120m Visibility Splay

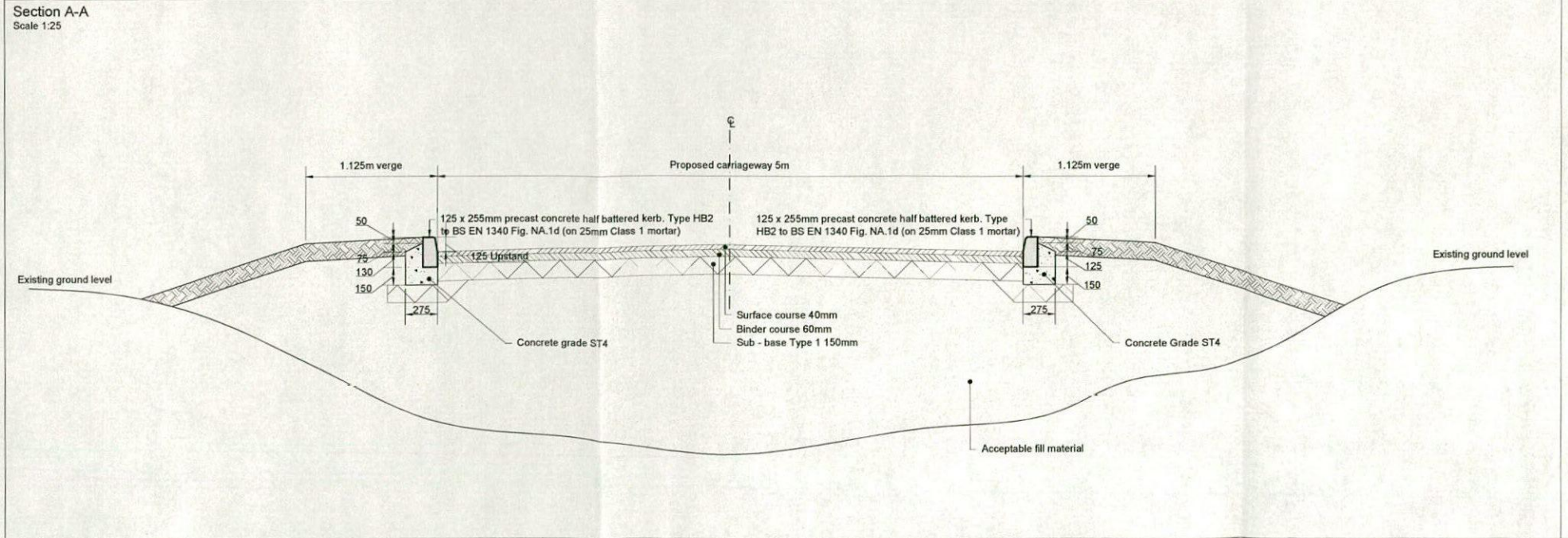
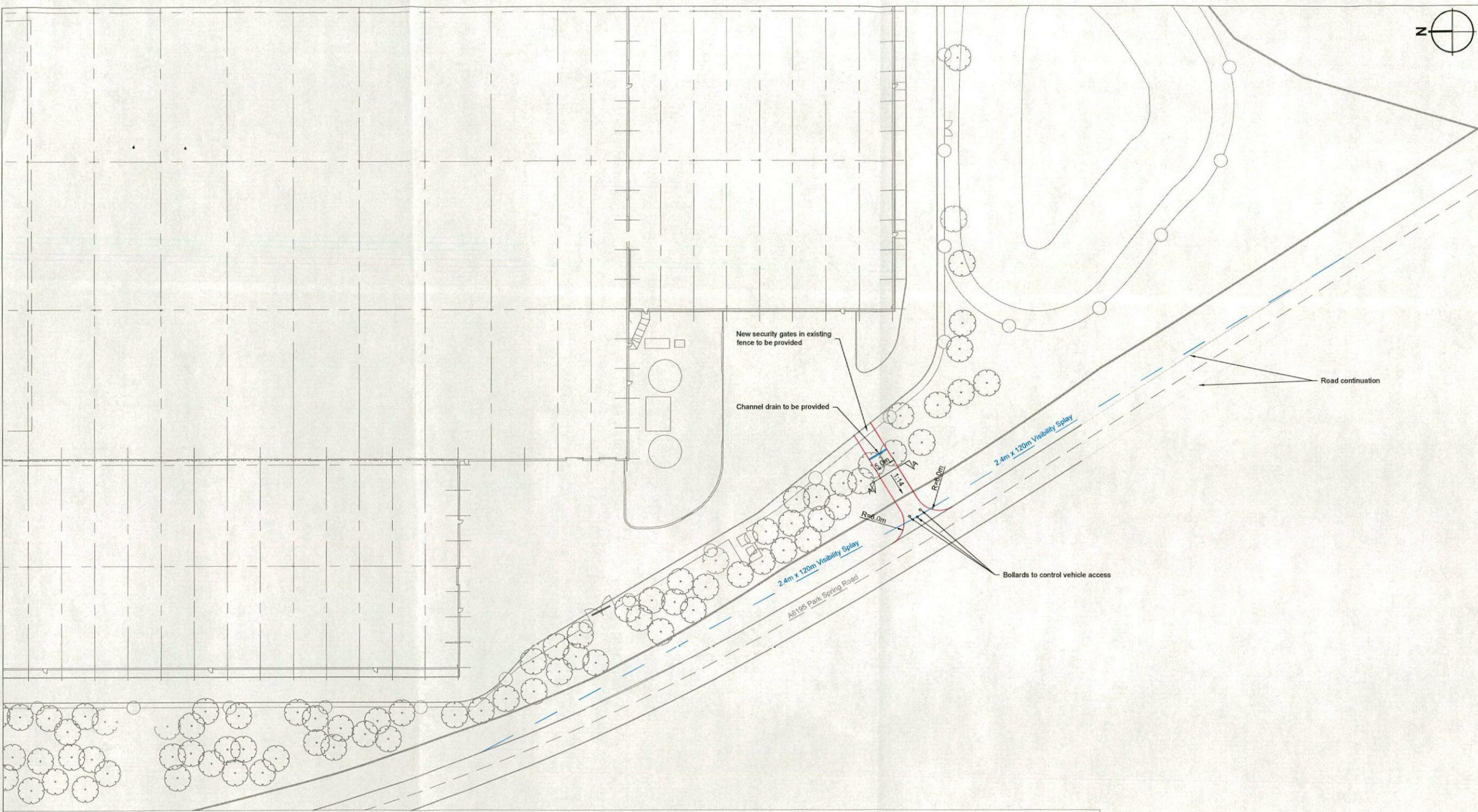

Rev	Description	By	Ckd	Date
P01	First issue	AB	ANT	06.10.20



Sherwood House, Sherwood Avenue,
Newark, Nottinghamshire, NG24 1GQ
T:01636 605 700 E: rpsnewark@rpsgroup.com

Client
XPO Logistics

Project
Park Spring Road, Little Houghton
Yorkshire

Title
Emergency Access Location

RPS Project Number NK018641
Scale @ A1 as shown
Date Created 07.10.20

Task Team Manager SG
Information Author AB
Task Information Manager ANT

Status
S2 (Suitable for information)

Document Number NK018641-RPS-XX-DR-CR-SK001
Revision P01

Project Code - Originator - Zone - Level - Type - Role - Drawing Number
rpsgroup.com



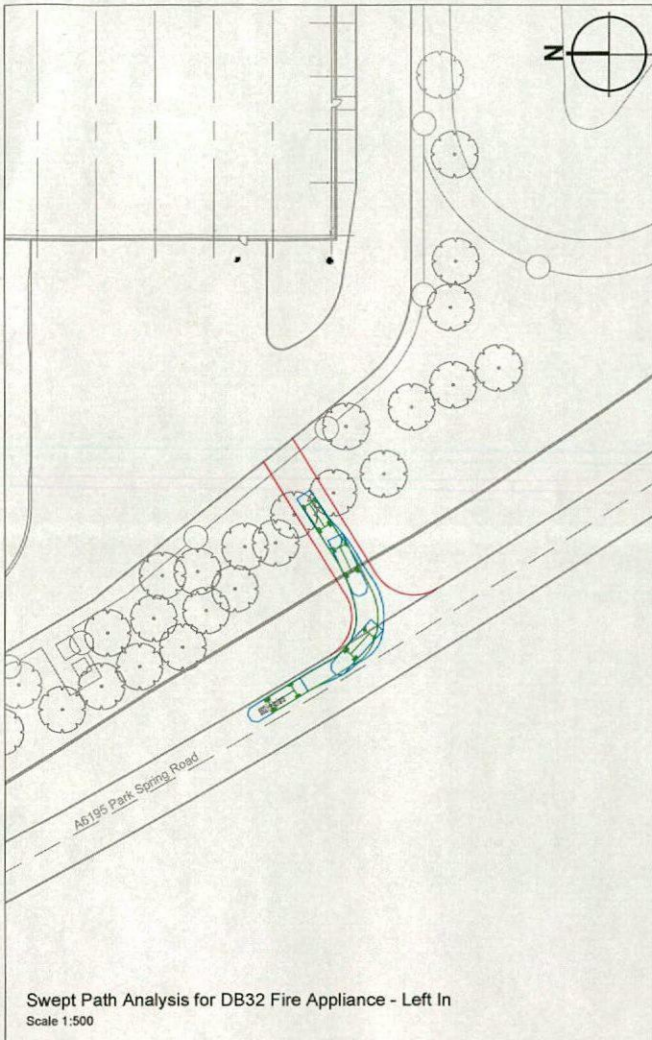

Swept Path Analysis for DB32 Fire Appliance - Left In
Scale 1:500

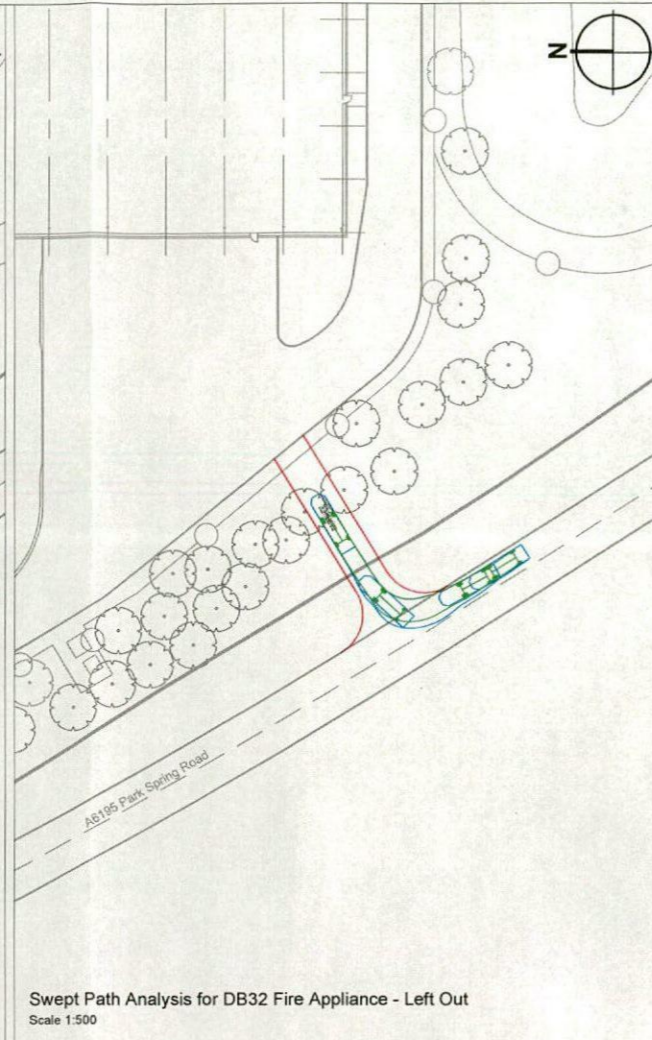

Swept Path Analysis for DB32 Fire Appliance - Left Out
Scale 1:500

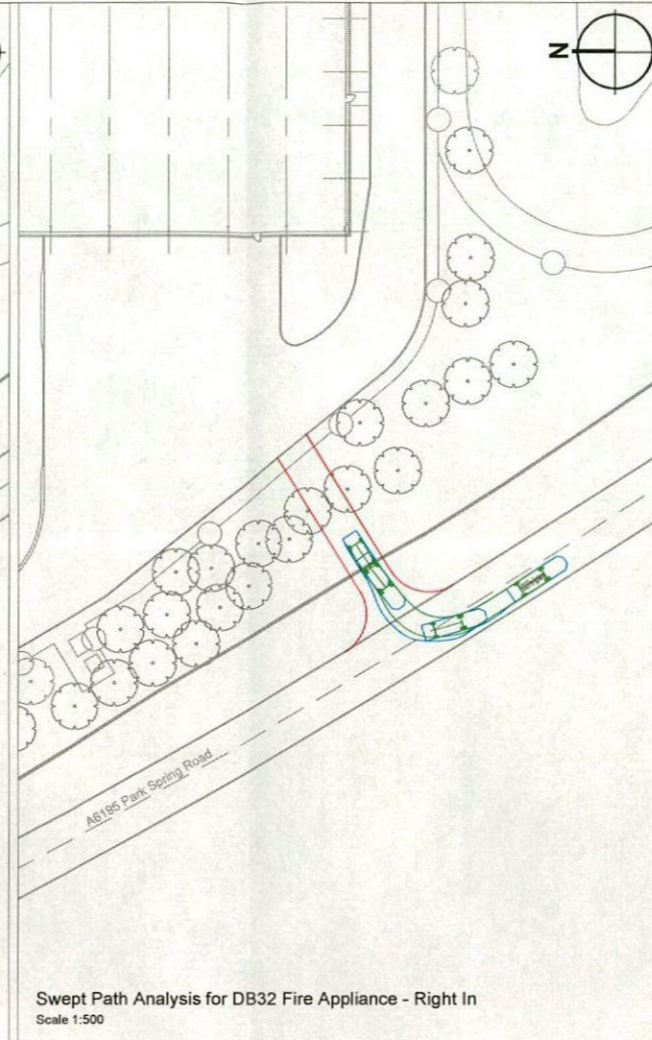

Swept Path Analysis for DB32 Fire Appliance - Right In
Scale 1:500

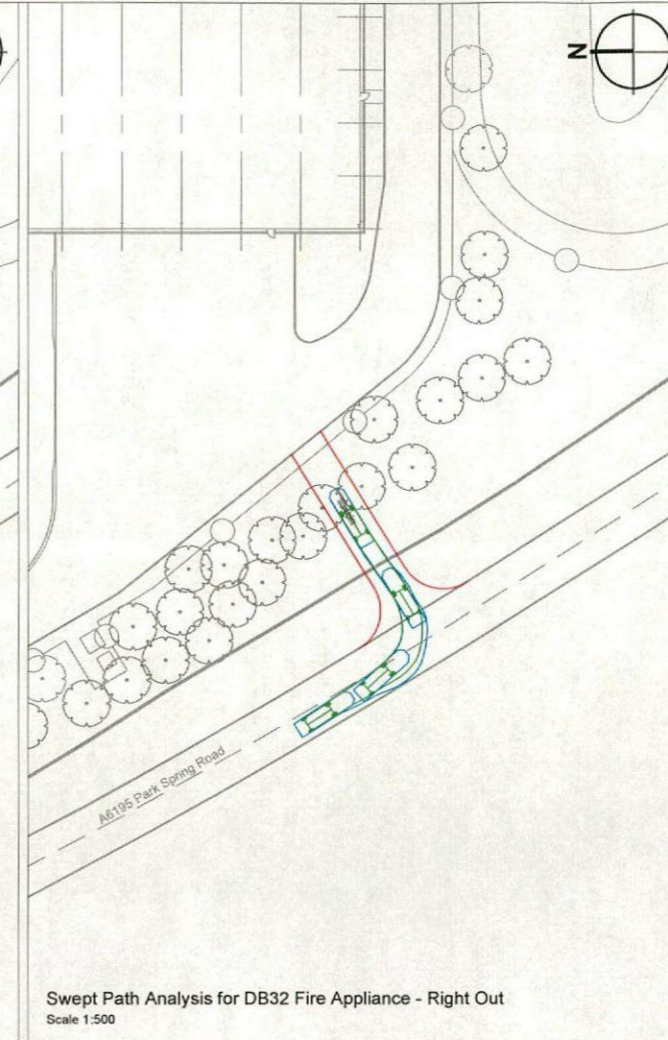

Swept Path Analysis for DB32 Fire Appliance - Right Out
Scale 1:500

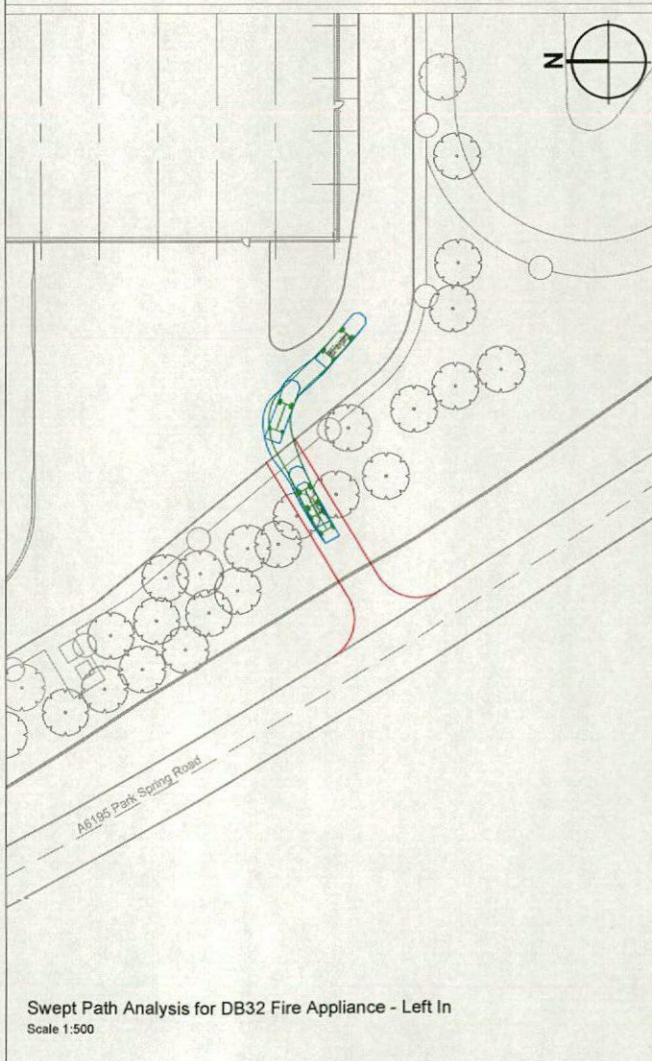

Swept Path Analysis for DB32 Fire Appliance - Left In
Scale 1:500

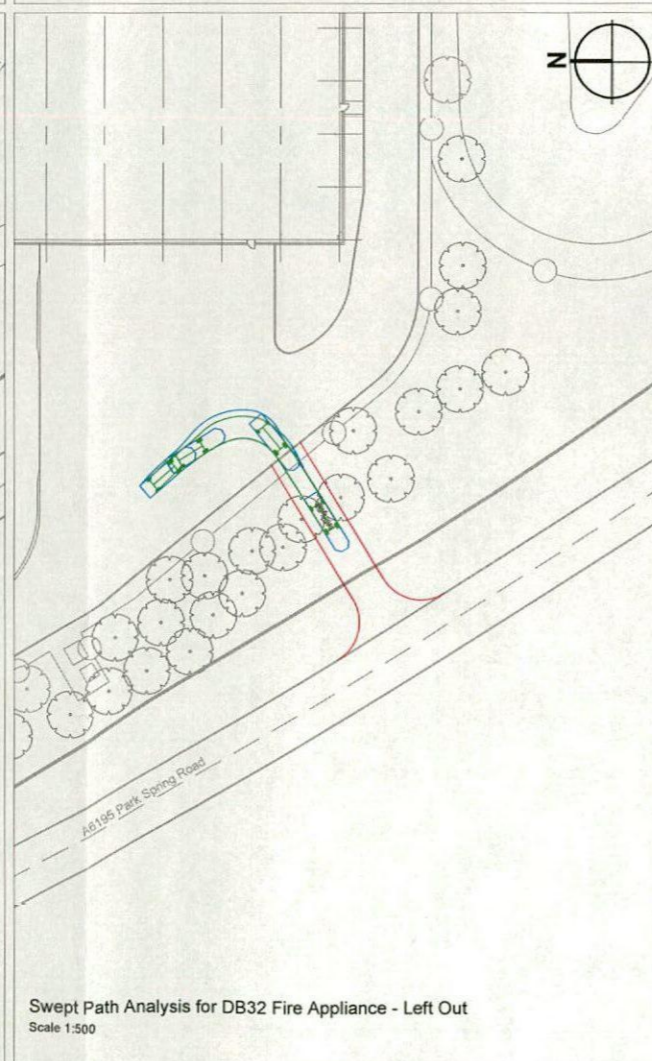

Swept Path Analysis for DB32 Fire Appliance - Left Out
Scale 1:500

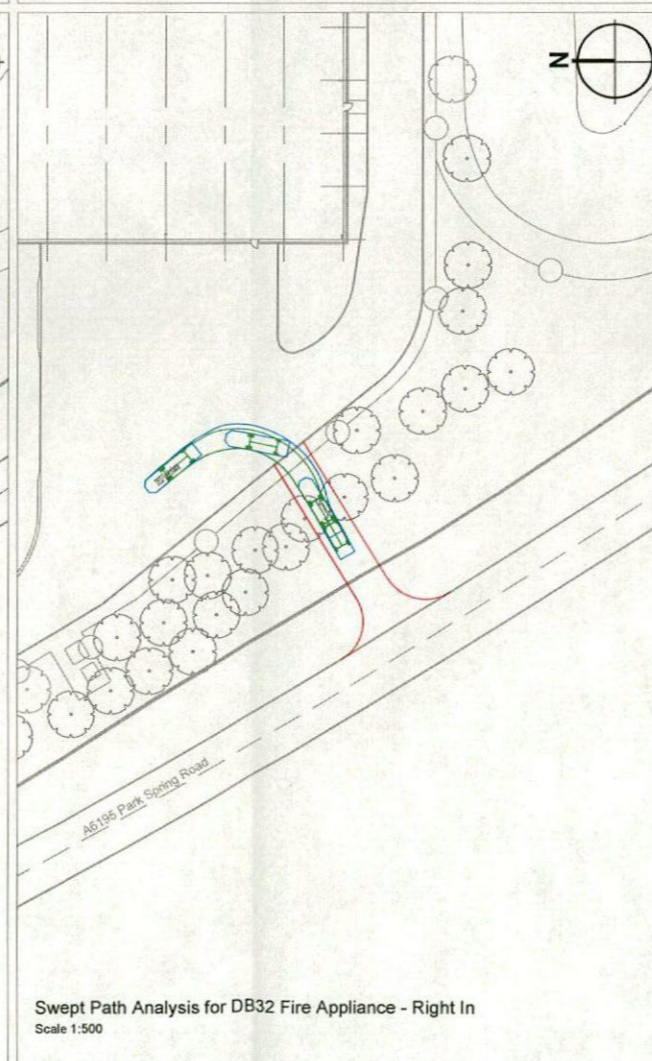

Swept Path Analysis for DB32 Fire Appliance - Right In
Scale 1:500

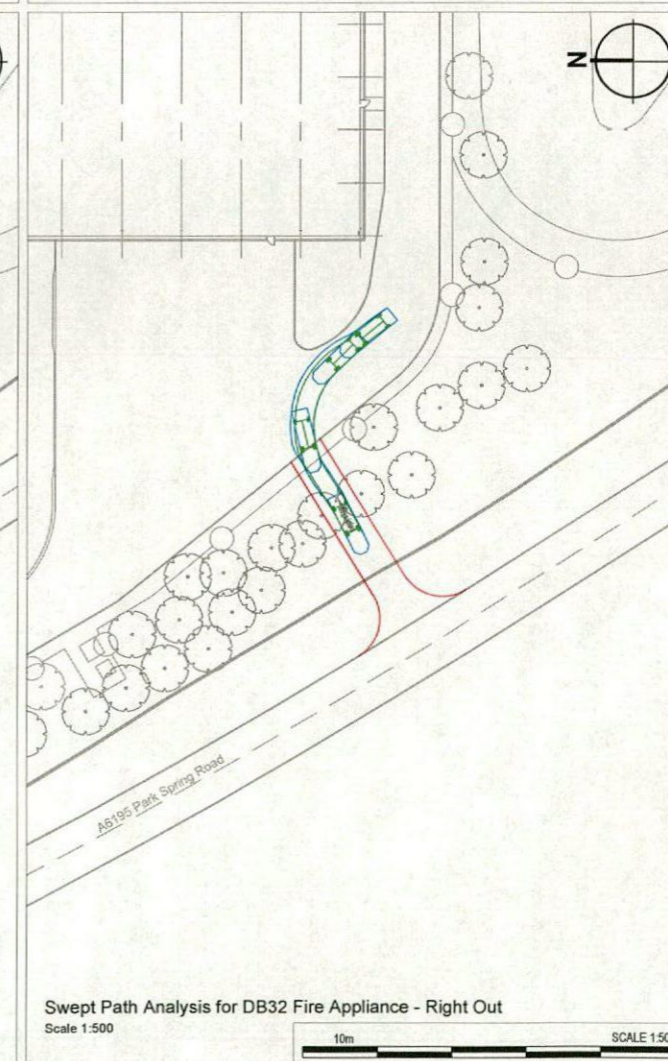

Swept Path Analysis for DB32 Fire Appliance - Right Out
Scale 1:500

© 2020 RPS Group
Notes
1. This drawing has been prepared in accordance with the scope of RPS's appointment with its client and is subject to the terms and conditions of that appointment. RPS accepts no liability for any use of this document other than by its client and only for the purposes for which it was prepared and provided.
2. If received electronically it is the recipient's responsibility to print to correct scale. Only written dimensions should be used.
3. This drawing should be read in conjunction with all other relevant drawings and specifications.
4. Swept path analysis undertaken with the use of Autodesk's Vehicle Tracking software. Design speed in the approach to a junction used during analysis is 5km/h.

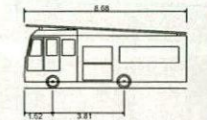

DB32 Fire Appliance
Overall Length 8.680m
Overall Width 2.180m
Overall Body Height 3.452m
Min Body Ground Clearance 0.337m
Max Track Width 2.121m
Lock to lock time 6.00s
Kerb to Kerb Turning Radius 7.910m

P01	First issue	AB	ANT	08.10.20
Rev	Description	By	Ckd	Date



Sherwood House, Sherwood Avenue,
Newark, Nottinghamshire, NG24 1QG
T: 01636 605 700 E: rpsnewark@rpsgroup.com

Client
XPO Logistics
Project Park Spring Road, Little Houghton
Yorkshire

Title Swept Path Analysis for DB32
Fire Appliance

RPS Project Number	Scale @ A1	Date Created
NK018641	as shown	08.10.20
Task Team Manager	Information Author	Task Information Manager
SG	AB	ANT

Status
S2 (Suitable for information)
Document Number NK018641-RPS-XX-DR-CR-SK002
Project Code - Originator - Zone - Level - Type - Role - Drawing Number
Revision P01
rpsgroup.com

