

Notes

1. This drawing has been prepared in accordance with the scope of RPS's appointment with its client and is subject to the terms and conditions of that appointment. RPS accepts no liability for any use of this document other than by its client and only for the purposes for which it was prepared and provided.
2. If received electronically it is the recipient's responsibility to print to correct scale. Only written dimensions should be used.
3. This drawing should be read in conjunction with all other relevant drawings and specifications.

Key

- 2.4m x 90m Visibility Display
- Planning Boundary

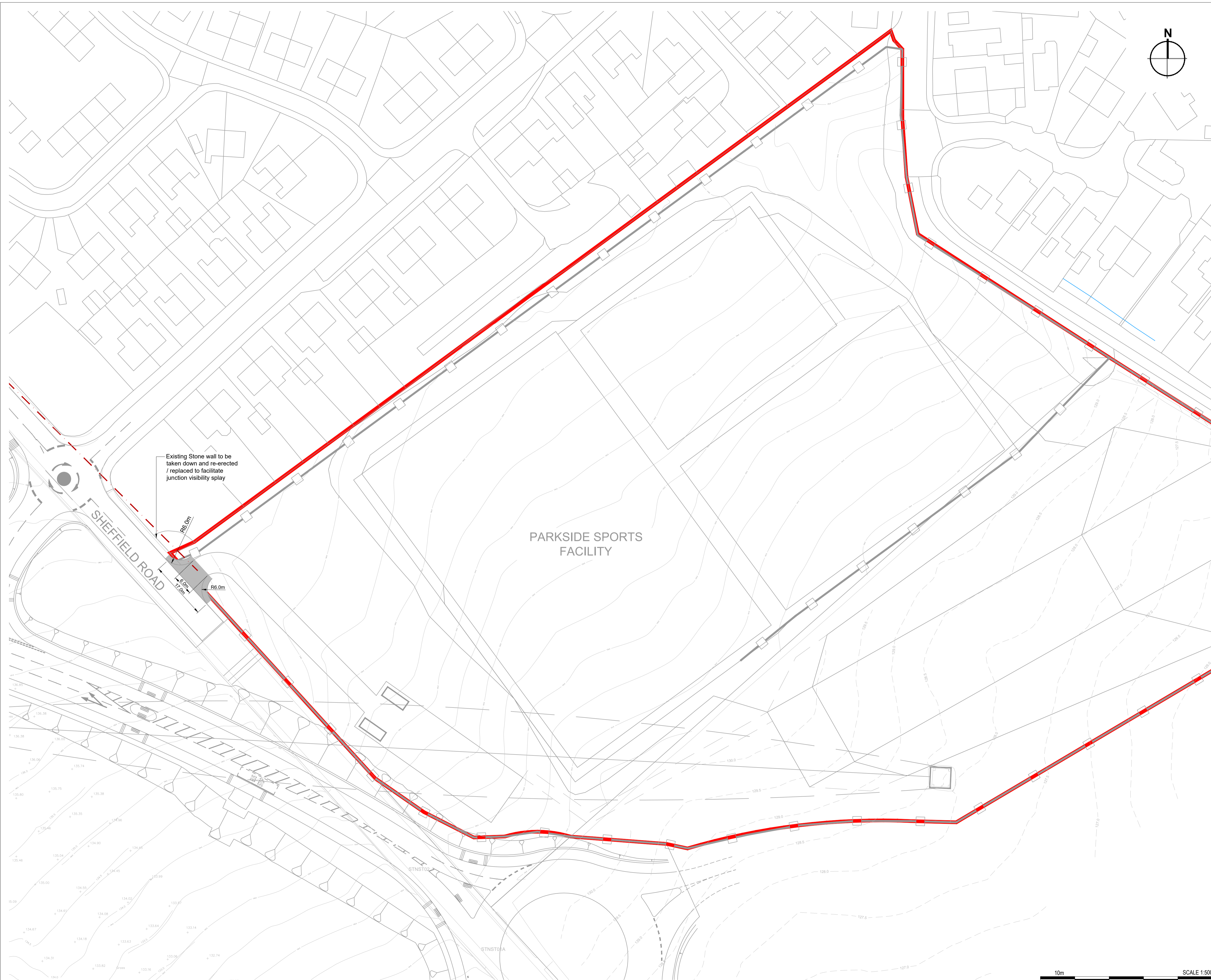

PARKSIDE SPORTS FACILITY

SHEFFIELD ROAD

Existing Stone wall to be taken down and re-erected / replaced to facilitate junction visibility splay

R6.0m

R6.0m

L9.0m

L1.0m

<b>P01</b>	First Issue	KA	AE	28.08.20
Rev	Description	By	Ckd	Date



Sherwood House, Sherwood Avenue,  
Newark, Nottinghamshire, NG24 1QQ  
T:01636 605 700 E: rpsnewark@rpsgroup.com



Project **Hoyland**

Title **Sports Facility Access Proposals**

RPS Project Number NK020040	Scale @ A1 1:500	Date Created 28.08.2020
Task Team Manager SG	Information Author KA	Task Information Manager AE

Status <b>S2 (Suitable for Information)</b>	Revision
Document Number <b>HOYLA-RPS-SI-XX-DR-CR-0895</b>	<b>P01</b>
Project Code - Originator - Zone - Level - Type - Role - Drawing Number	
rpsgroup.com	

