

Technical Note 300794-001

Project:	Orchard Views, 39 Gawber Road, Barnsley	Project No:	300794
Subject:	Proposed Parking Arrangement		
Prepared by:	Ashley Armitage MIHE	Date:	04.05.2022
Checked by:	Karen Smith MIHE	Date:	05.05.2022

Sanderson Associates (Consulting Engineers) Limited has been appointed by Omar Sharif, to advise on parking arrangements relating to a proposed extension of the Orchards Views care home, located off Gawber Road in Barnsley

The existing care home has 48 bedrooms and a car park off Gawber Lane providing 8 parking spaces. The care home operator has advised that the maximum number of staff on shift at any one time is 10 staff which equates to 0.2 staff per bedroom. The operator has also confirmed that the average number of visitors throughout the day is 5, with about 1-2 visitors at a given time.

The proposed development consists of the erection of a two and three storey extension which would result in an additional 21 bedrooms. Based on current staffing levels (0.2 per bed) the client would expect an additional 4-5 members of staff to be required on site at any one time.

Table 1 of Barnsley Councils Parking SPD provides standards for C2 uses. The following are the stated number of spaces recommended for the Urban Barnsley area.

- 1 space per 4-8 staff and 1 space per 4 daily visitors.

Based on these standards the proposal would be expected to provide 2-4 spaces for staff. As a worse case, if it is assumed that there is a visitor every day for each bedroom (69 visitors), then 17 spaces would be recommended, however, this is considered to be a highly unlikely scenario.

It is, therefore, proposed to provide a total of 18 spaces. The parking area, accessed from Gawber Road as at present, would also include a dedicated ambulance bay. The proposed car parking arrangements are shown on Drawing 300794-001 and Drawing 300794-002 demonstrates that a car can access the spaces and exiting the site in a forward gear. Both of these plans are attached at **Appendix A**.

To provide a robust assessment of the vehicle trips that could be generated, trip rates for the land use category 05 - Health / F – Care Home have been obtained from the TRICS (v7.9.1) database. These have then been used to estimate the potential parking accumulation at the application site. The search parameters have been refined to resemble the location of the site and excludes sites within Greater London and Ireland. The TRICS data is contained at **Appendix B** and are summarised in the following table.

Time Period		Trip Rate per bed		Trip Generation		Accumulation
		Arr	Dep	Arr	Dep	
07:00	08:00	0.122	0.053	9	4	5
08:00	09:00	0.089	0.058	6	4	7
09:00	10:00	0.096	0.043	7	3	11
10:00	11:00	0.076	0.053	5	4	12
11:00	12:00	0.078	0.066	5	4	13
12:00	13:00	0.086	0.071	6	5	14
13:00	14:00	0.106	0.099	7	7	14
14:00	15:00	0.109	0.144	8	10	12
15:00	16:00	0.099	0.147	7	10	9
16:00	17:00	0.061	0.122	4	8	5
17:00	18:00	0.048	0.081	3	6	2
18:00	19:00	0.046	0.030	3	2	3
19:00	20:00	0.048	0.071	3	5	2
20:00	21:00	0.033	0.048	2	3	0

Table 1 - Predicted Parking Accumulation, Care Home – 69 beds

As can be seen from the above table, the parking accumulation assessment estimates a peak occupancy of 14 vehicles. It is, therefore, considered that the level of car parking to be provided is sufficient and that the parking proposal provides an appropriate layout as well as including disabled provision and an ambulance bay.



APPENDIX A

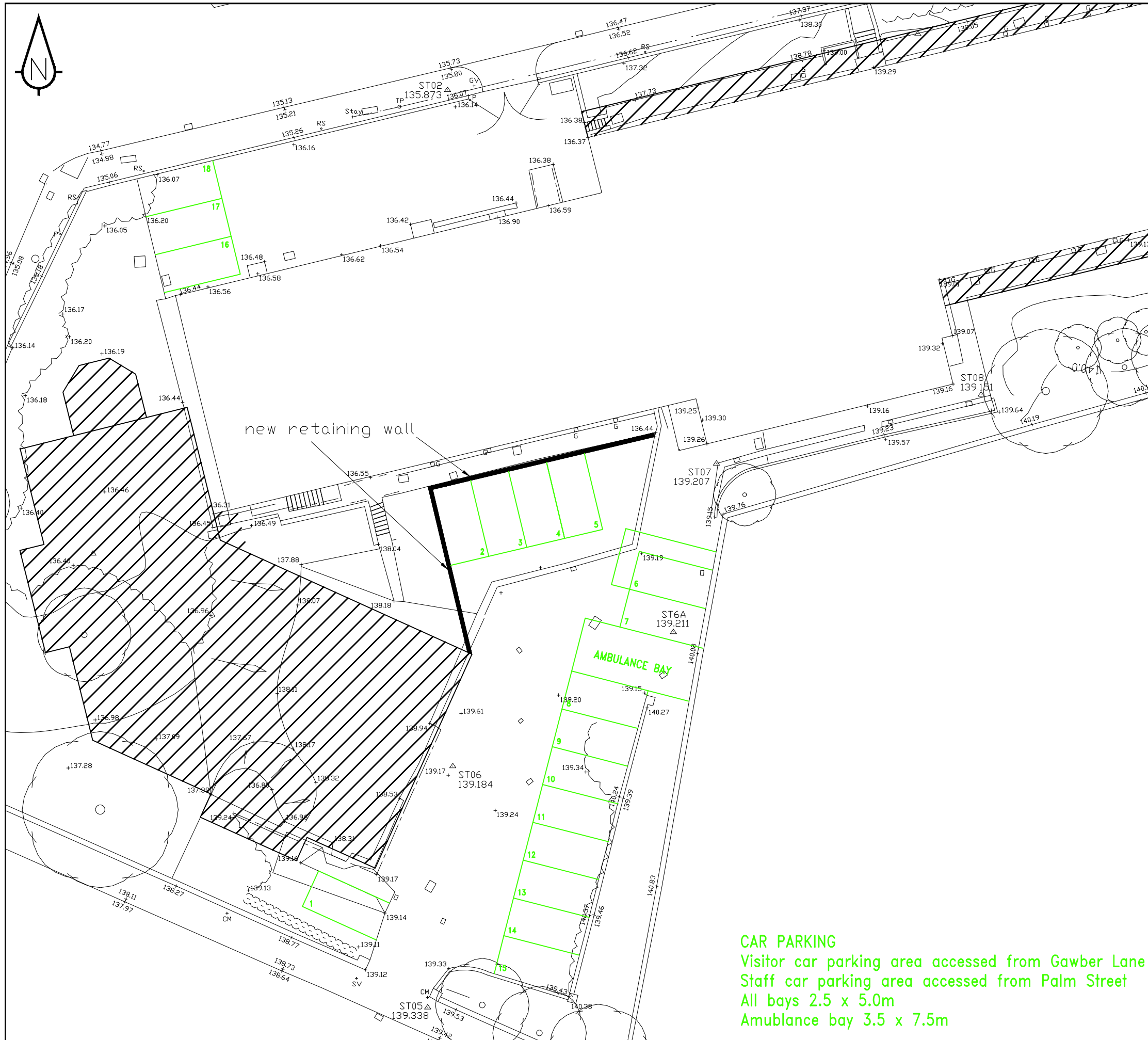

- Sanderson Associates (Consulting Engineers) Ltd ("the consultant"), has not checked or verified, and shall have no liability whatsoever for any inaccuracies which may be attributable to any data, reports, base plan(s) and drawings provided by the client, or purchased by the consultant on the client's behalf, that may have been utilised within this drawing.
- The consultant shall not be liable for the use by any person of any document for any purpose other than that for which the same were provided by the consultant.
- No liability whatsoever is accepted by the consultant for any error or omissions.
- The consultant accepts no liability for any vehicle specification errors within the vehicle track software used and / or it's vehicle libraries.
- The locations of utilities apparatus, if shown, is reproduced from plans supplied to the consultant, although care has been taken when duplicating this information. These locations are approximate only and no guarantee can be given for their accuracy. It is the client's or it's appointed agent/contractors responsibility to verify the exact locations on site by hand dug trial holes or other appropriate means prior to mechanical excavation.
- Service connections are not shown but their presence should be anticipated.
- Reference to any third party equipment shown on this drawing was only relevant at the time the drawing was prepared.
- It is the client's responsibility to ensure that any equipment ordered meets the design.

--	--	--	--	--

Rev	Amendment	Drawn	Date	Checked
-----	-----------	-------	------	---------

--	--	--	--	--

sanderson
 associates
 (consulting engineers) ltd

Highways | Traffic | Transportation | Water

T 01924 844080 mail@sandersonassociates.co.uk
 F 01924 844081 www.sandersonassociates.co.uk

Project Name
Orchard Views, 39 Gawber Road, Barnsley

Drawing Title
Proposed Parking Arrangements

Scale 1:250	Drawn By AA
-------------	-------------

Drawing Size A3	Checked By KS
-----------------	---------------

Date April 2022	Approved By KS
-----------------	----------------

Drawing Number 300794-001	Rev
------------------------------	-----

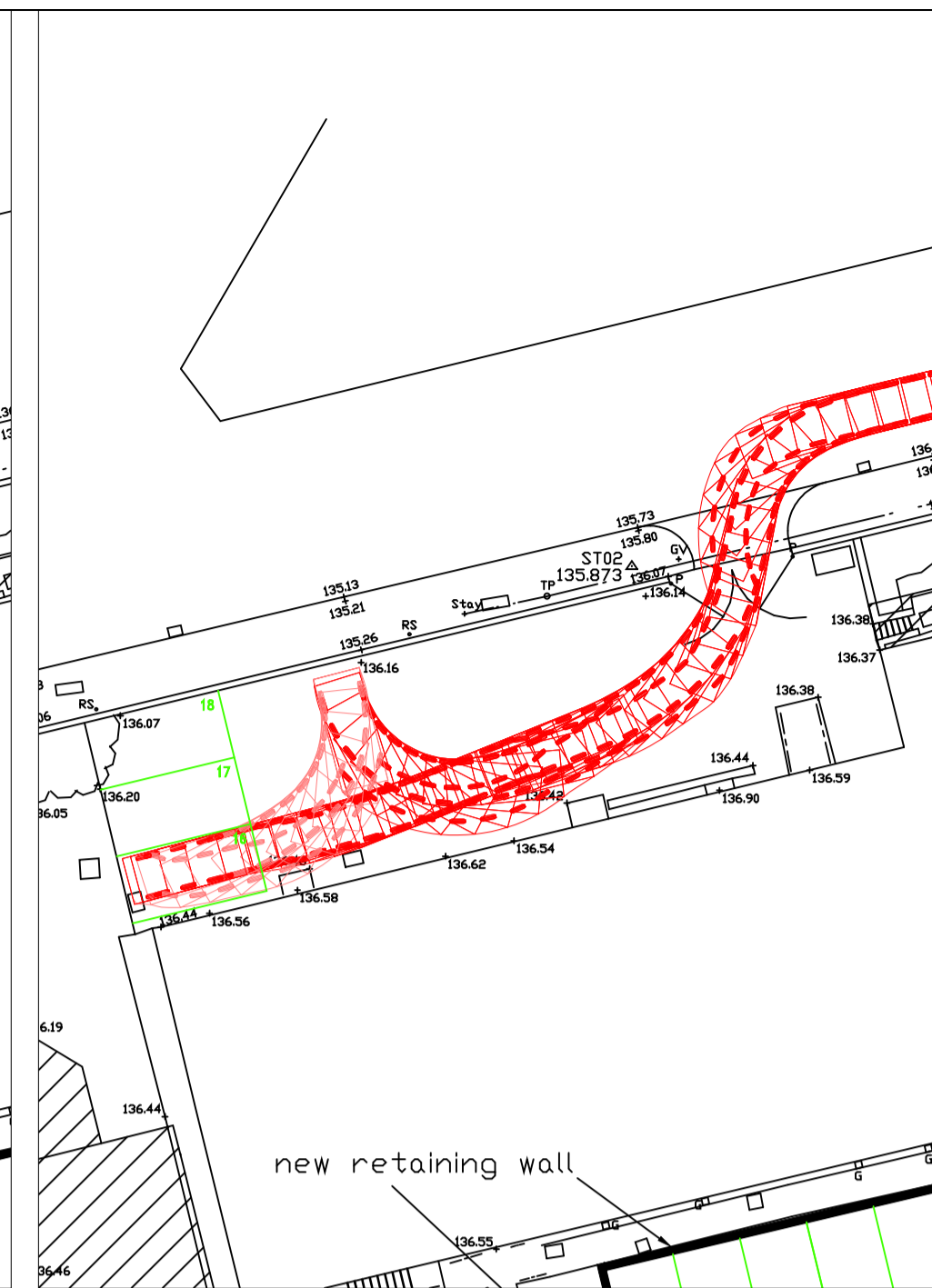
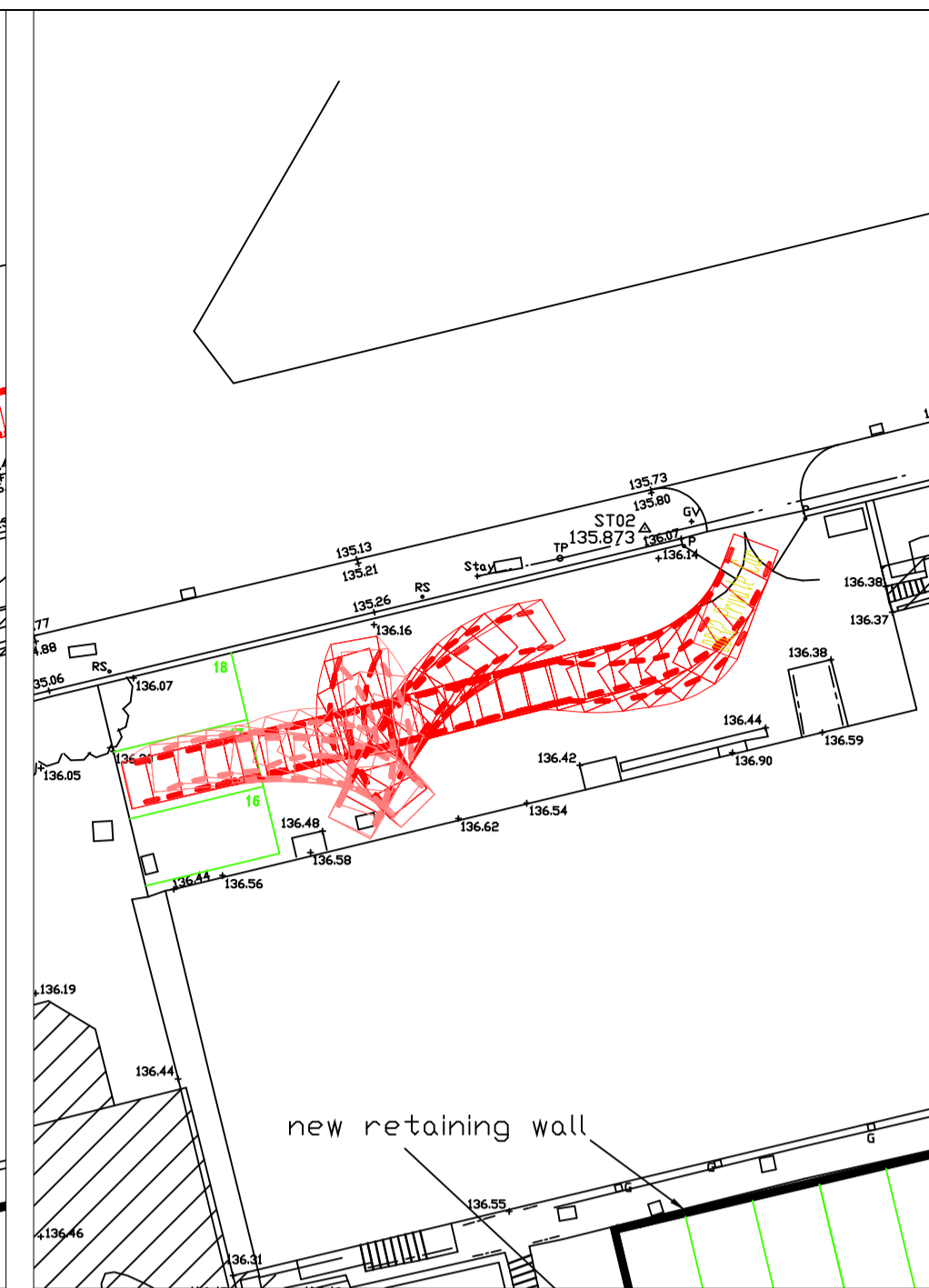
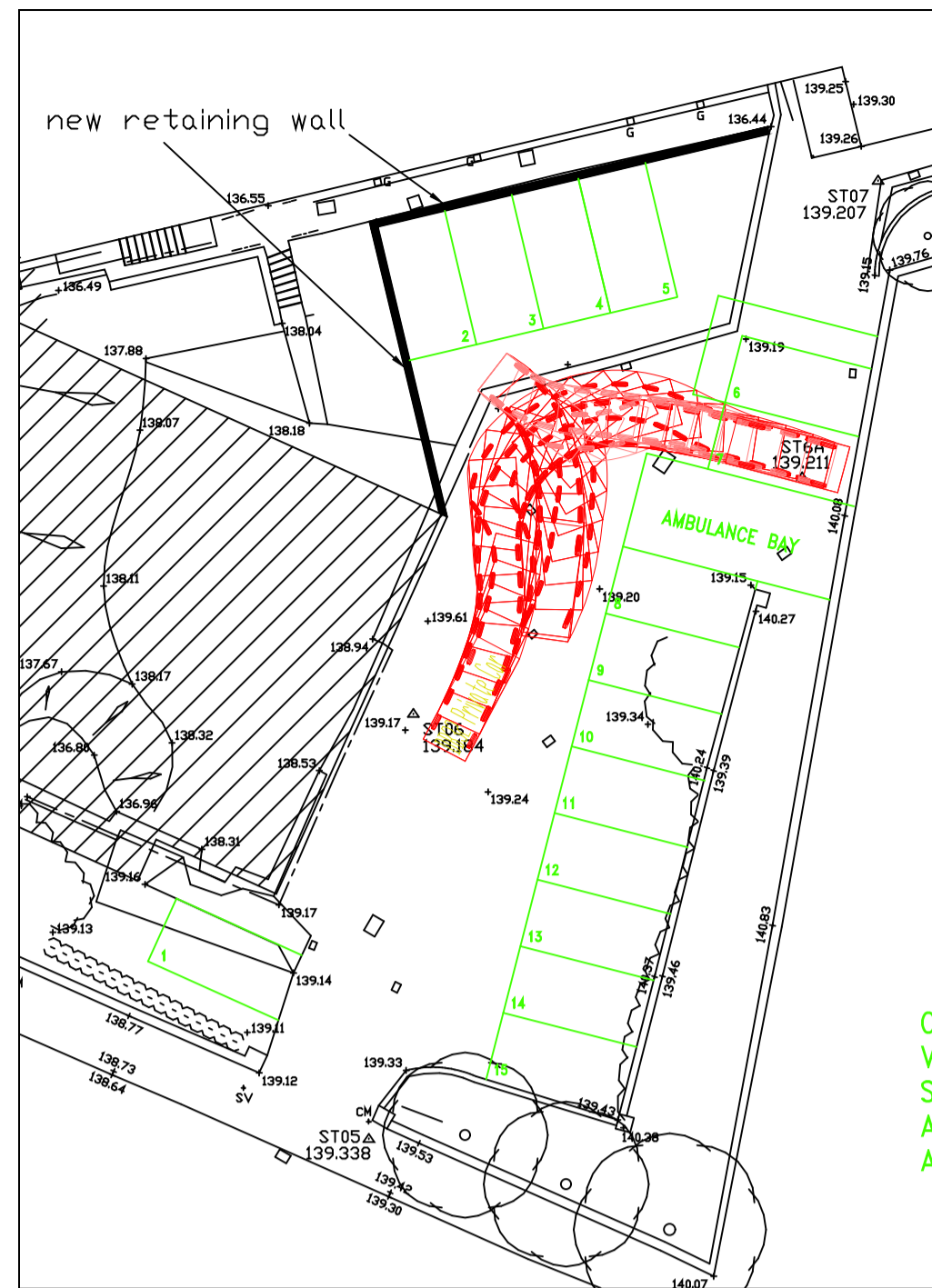

- Sanderson Associates (Consulting Engineers) Ltd ("the consultant"), has not checked or verified, and shall have no liability whatsoever for any inaccuracies which may be attributable to any data, reports, base plans) and drawings provided by the client, or purchased by the consultant on the client's behalf, that may have been utilised within this drawing.
- The consultant shall not be liable for the use by any person of any document for any purpose other than that for which the same were provided by the consultant.
- No liability whatsoever is accepted by the consultant for any error or omissions.
- The consultant accepts no liability for any vehicle specification errors within the vehicle track software used and / or its vehicle libraries.
- The locations of utilities apparatus, if shown, is reproduced from plans supplied to the consultant, although care has been taken when duplicating this information. These locations are approximate only and no guarantee can be given for their accuracy. It is the client's or its appointed agent/contractors responsibility to verify the exact locations on site by hand dug trial holes or other appropriate means prior to mechanical excavation.
- Service connections are not shown but their presence should be anticipated.
- Reference to any third party equipment shown on this drawing was only relevant at the time the drawing was prepared.
- It is the client's responsibility to ensure that any equipment ordered meets the design.

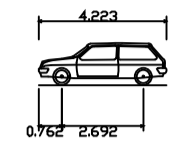

DB32 Private Car
 Overall Length 4.223m
 Overall Width 1.718m
 Overall Body Height 1.352m
 Min Body Ground Clearance 0.229m
 Max Track Width 1.629m
 Lock to lock time 4.005s
 Kerb to Kerb Turning Radius 5.700m

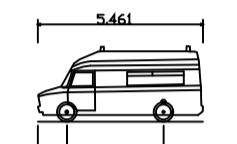

Ambulance
 Overall Length 5.461m
 Overall Width 2.050m
 Overall Body Height 2.498m
 Min Body Ground Clearance 0.229m
 Track Width 1.660m
 Lock to lock time 4.936s
 Kerb to Kerb Turning Radius 6.500m

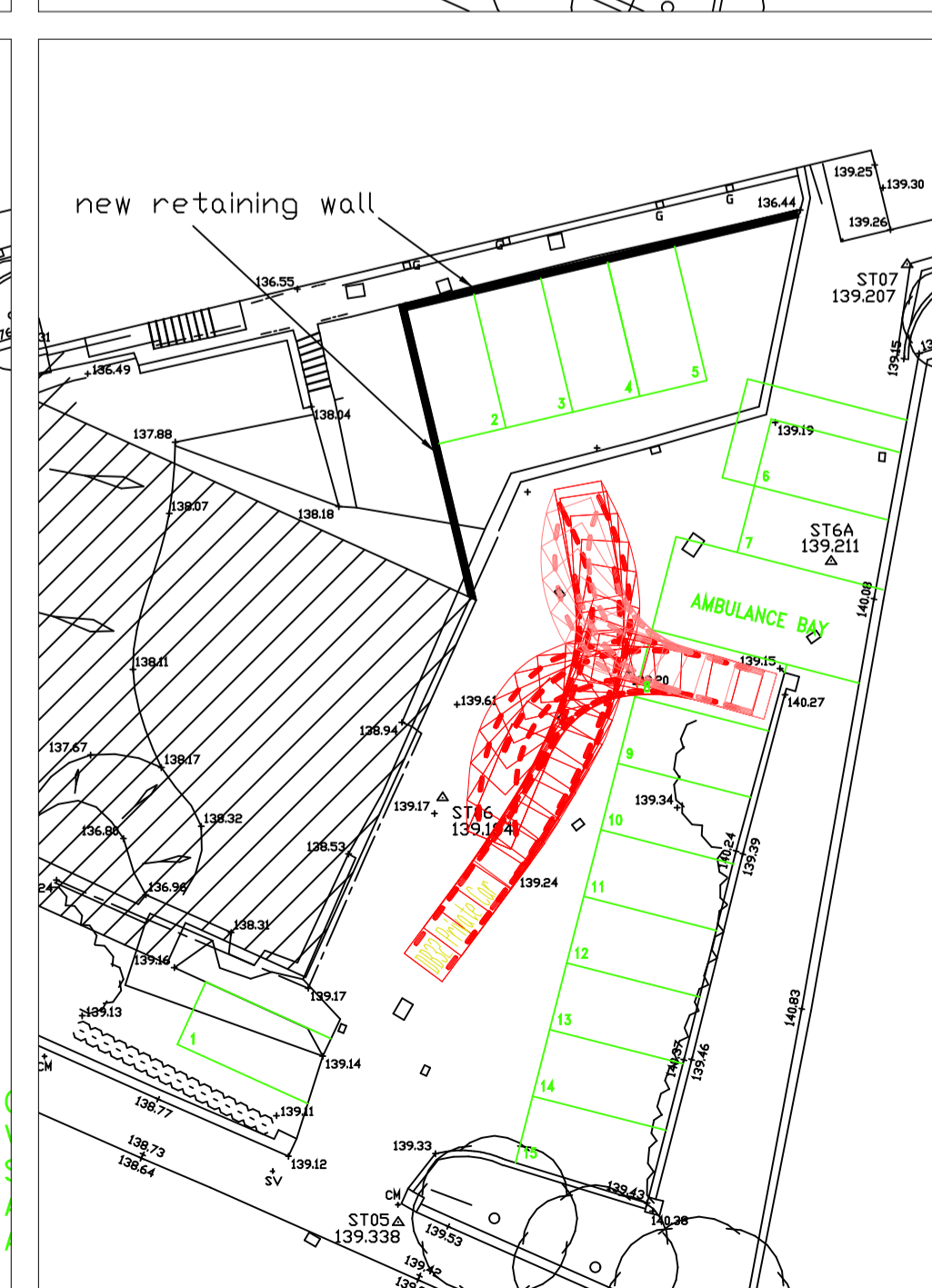
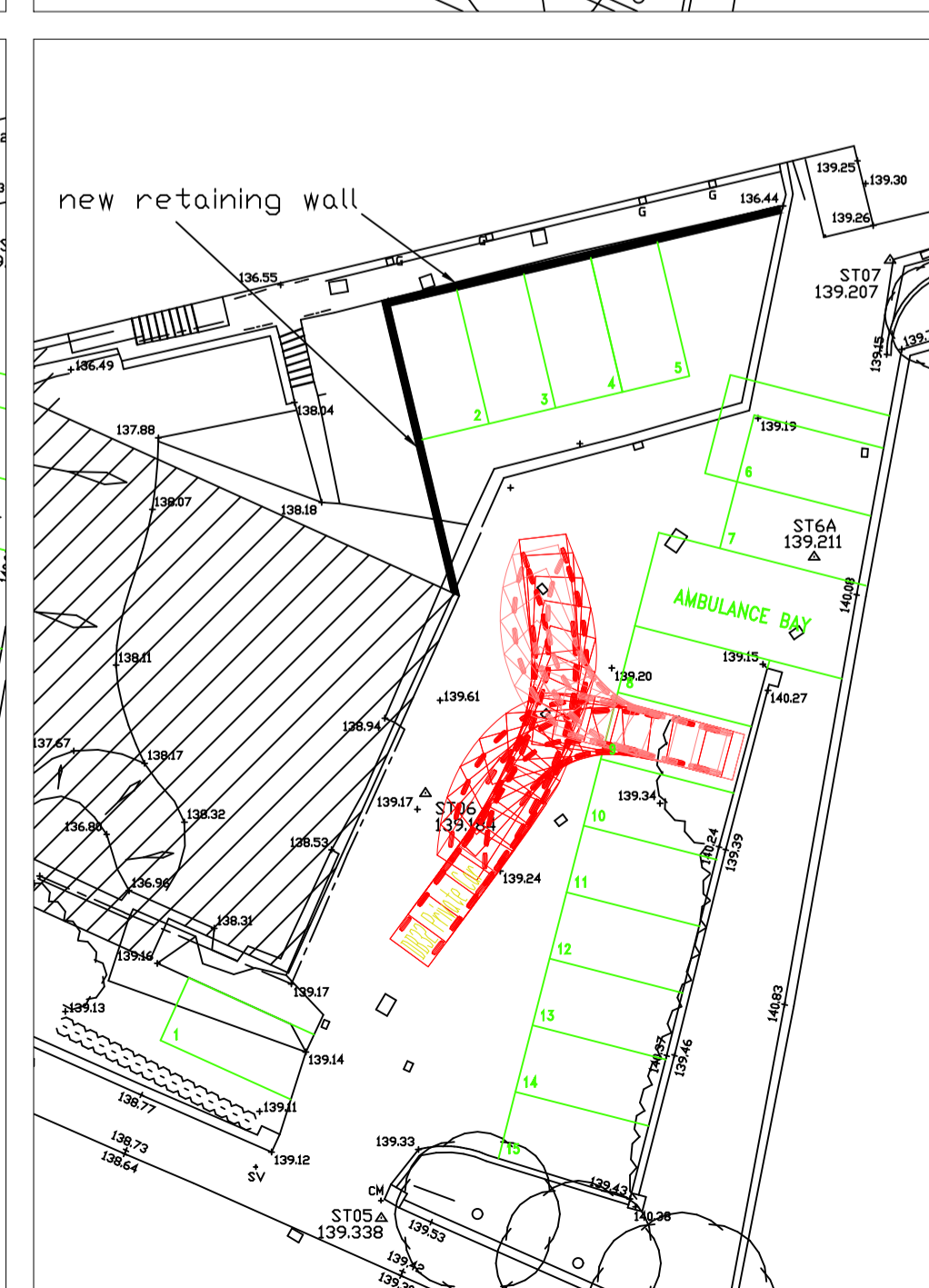
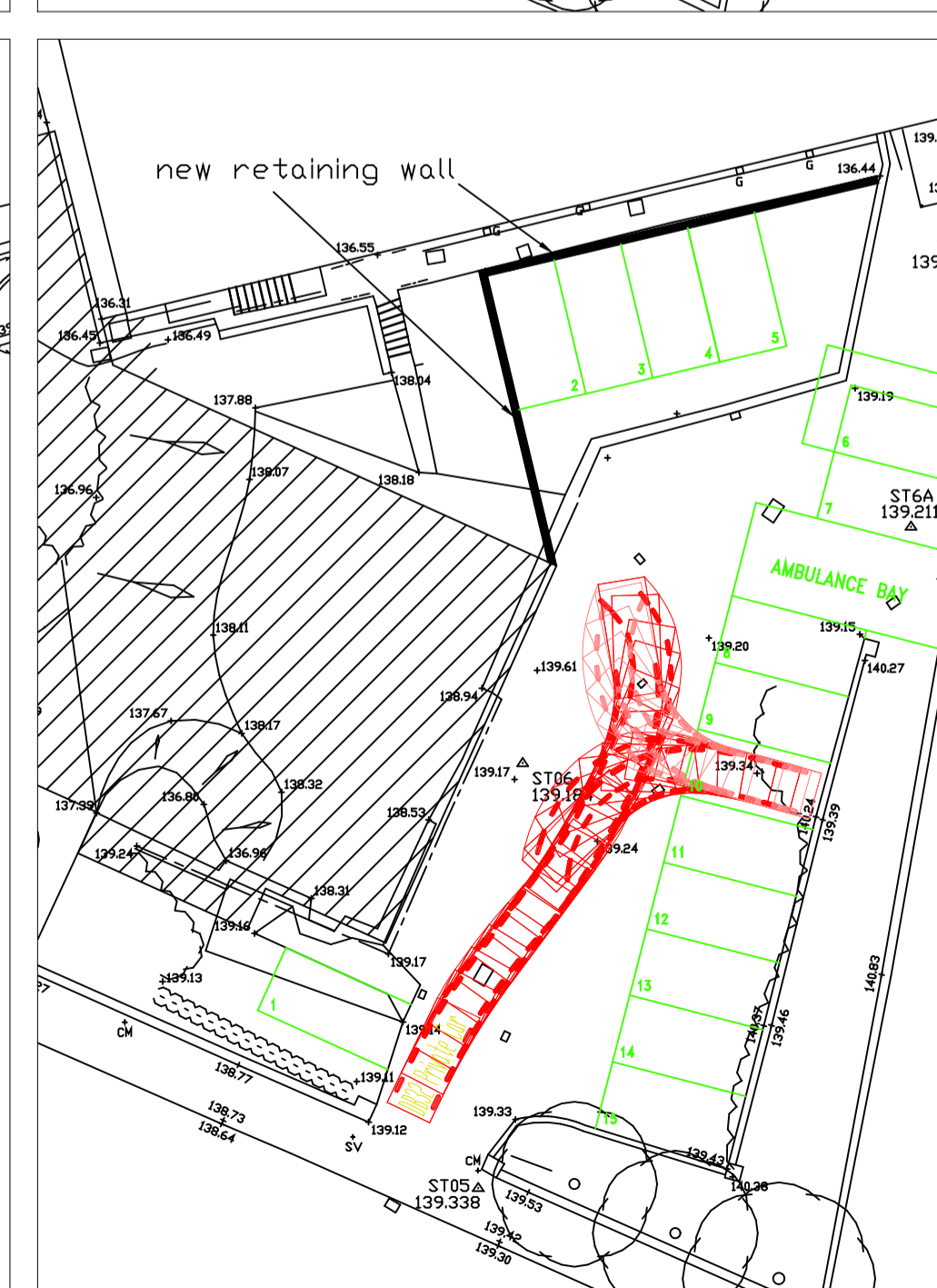
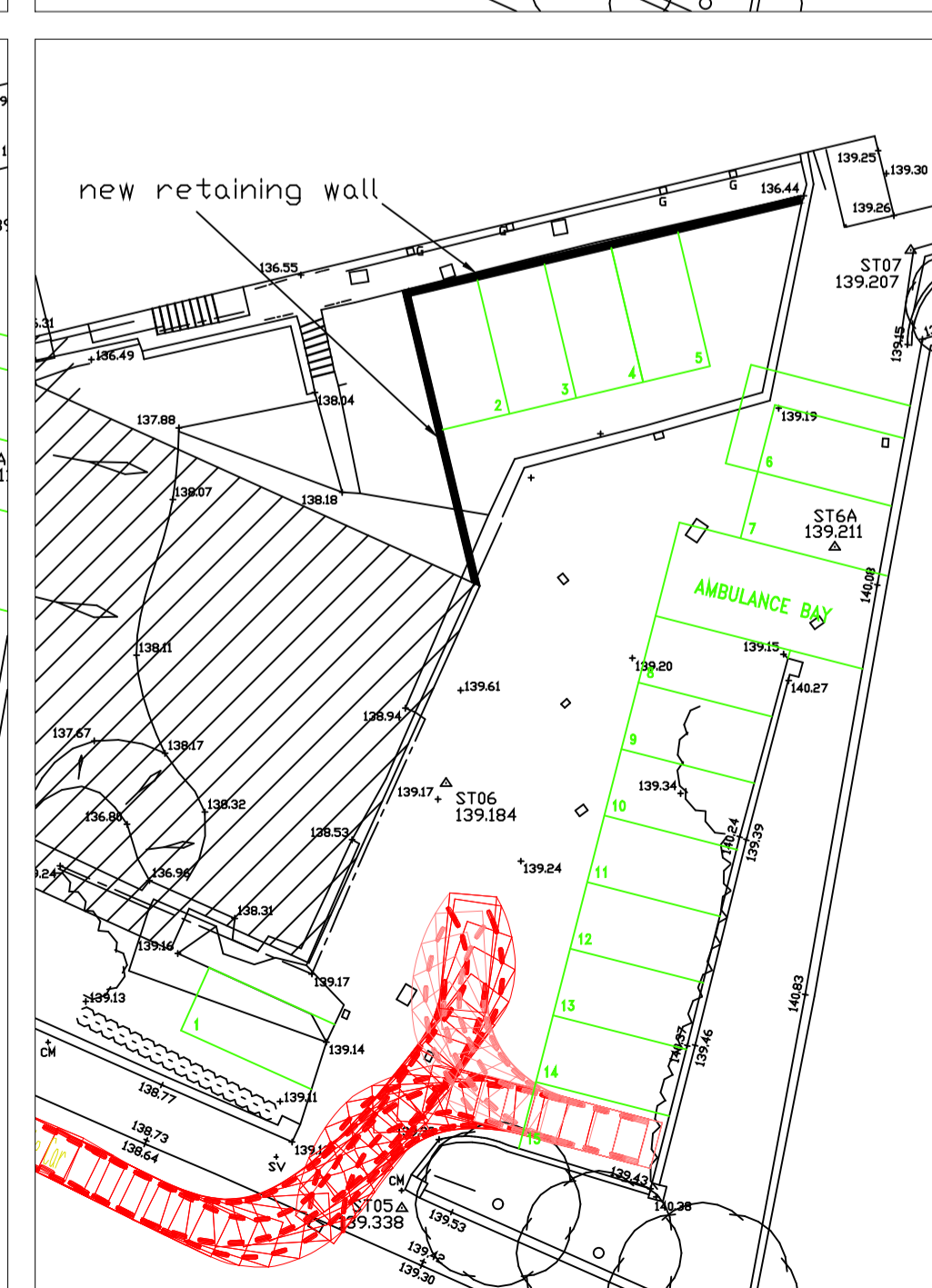
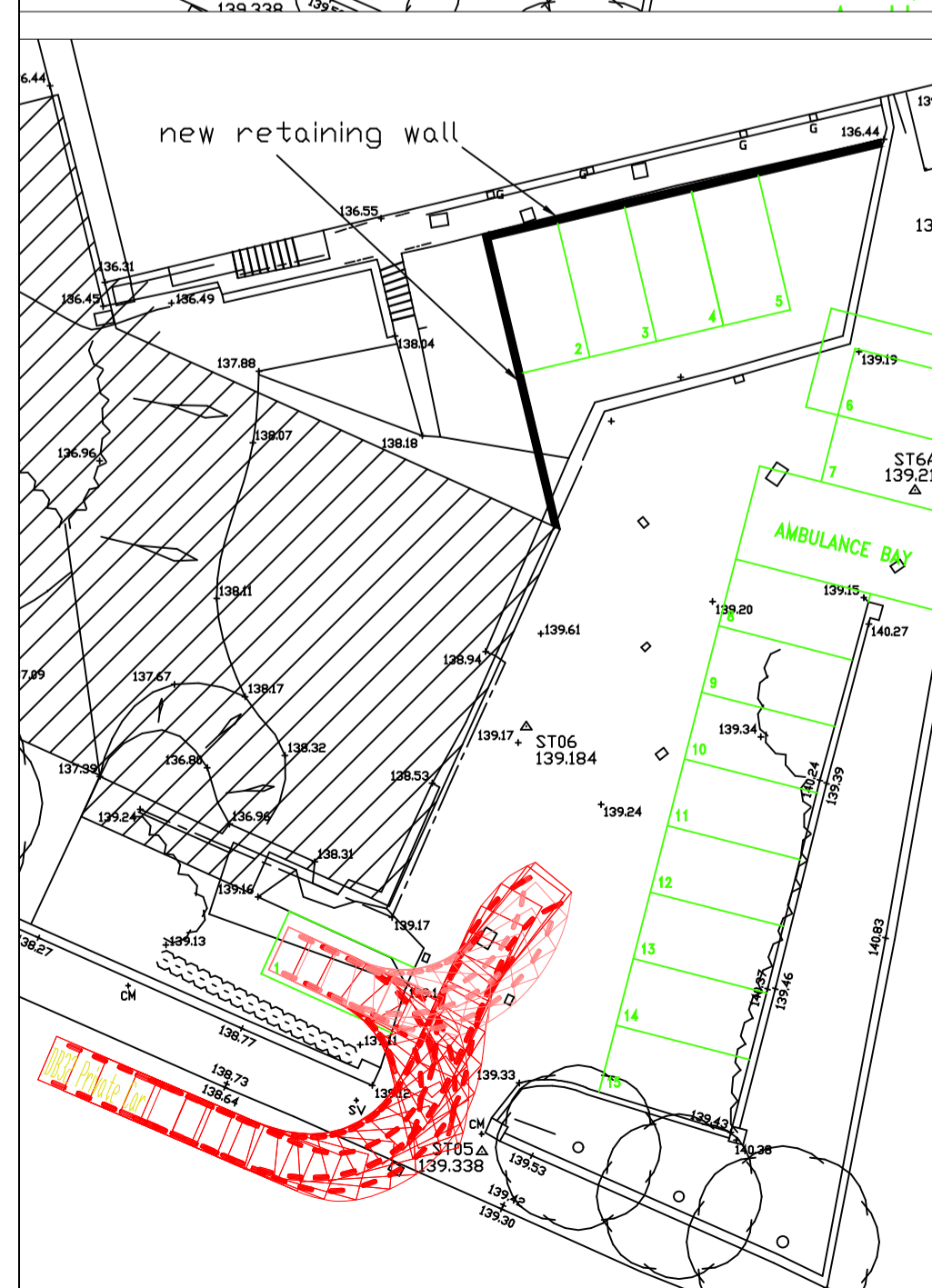
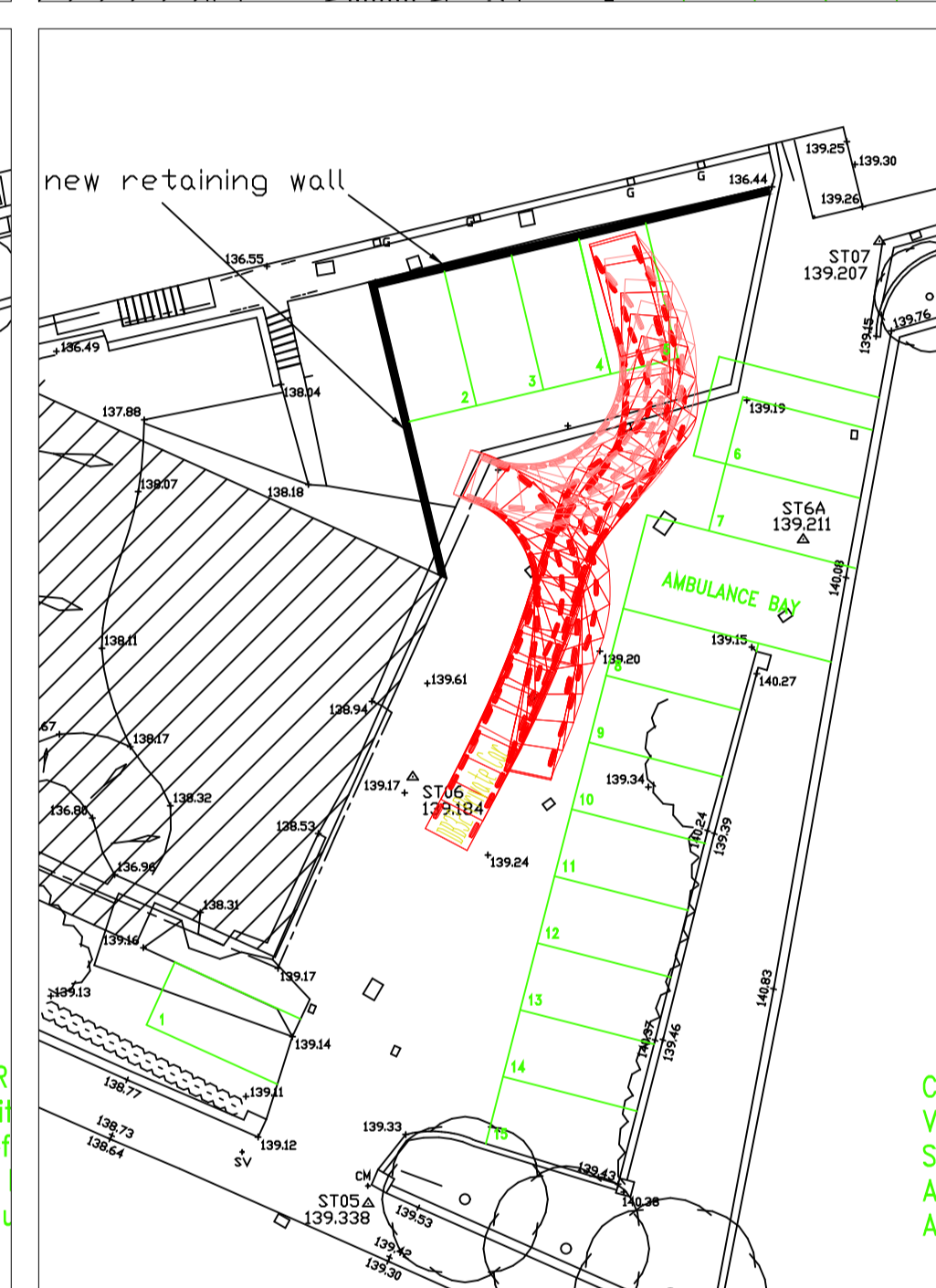
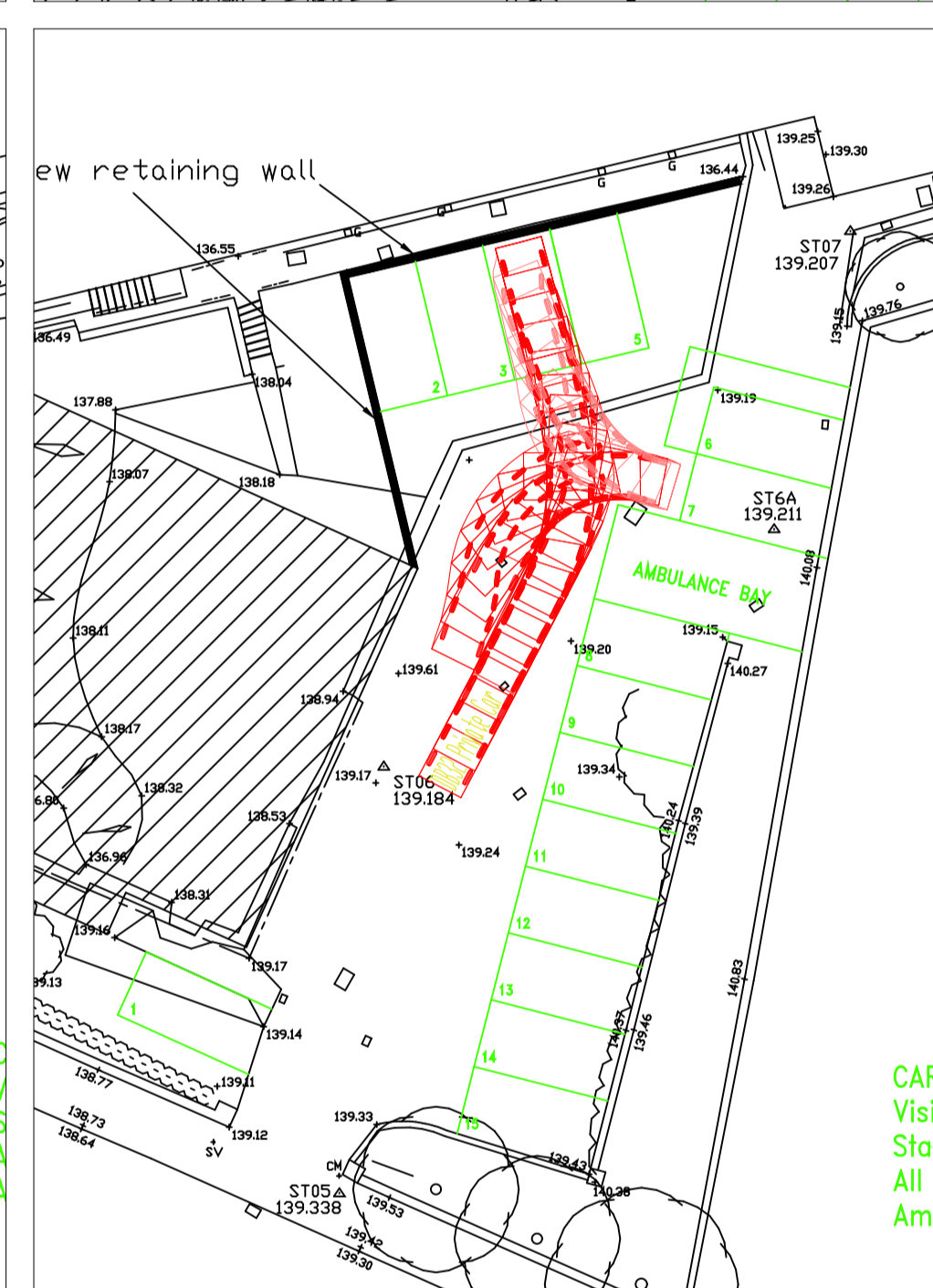
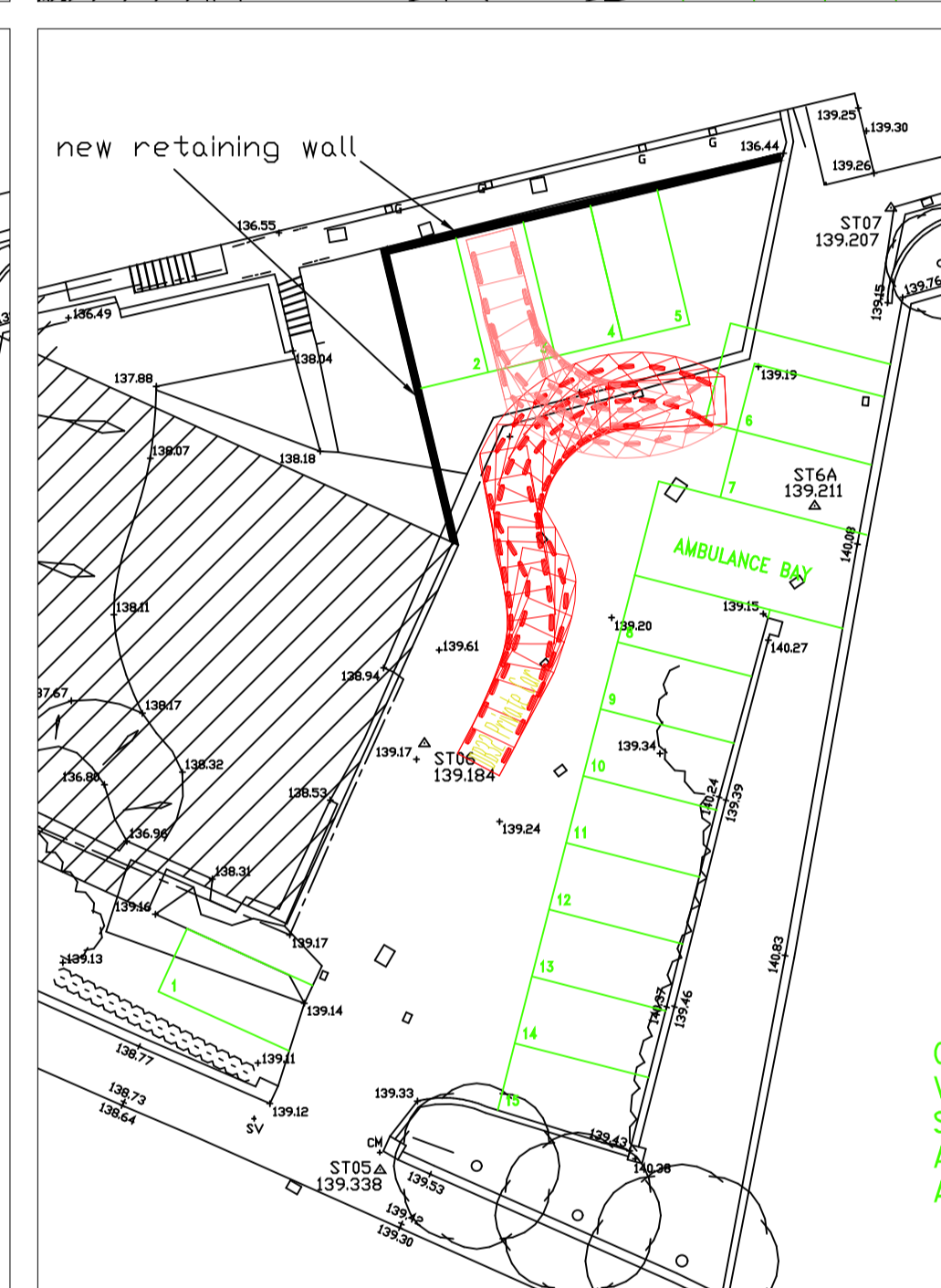
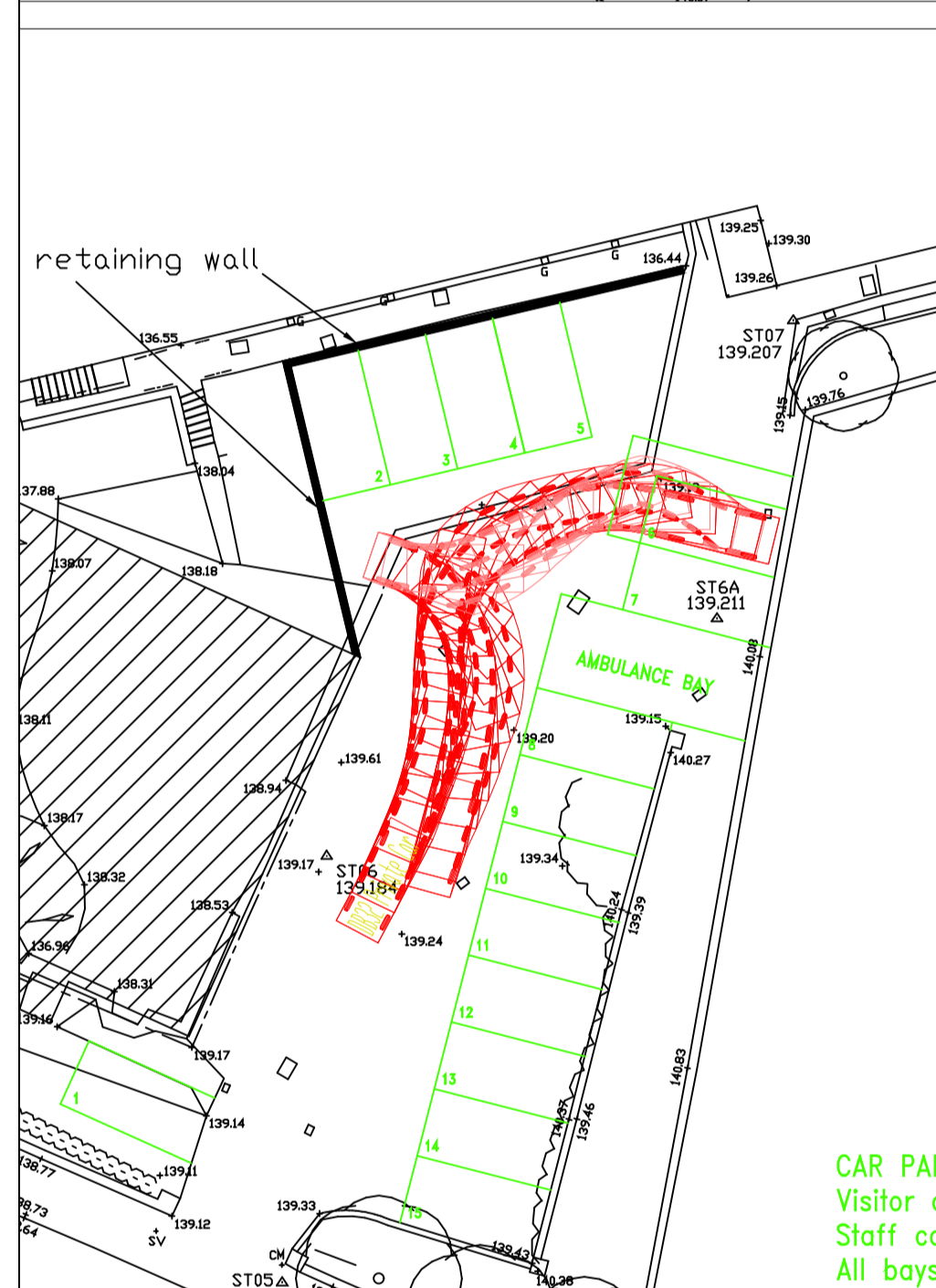

Rev	Amendment	Drawn	Date	Checked

CAR VISITOR STAFF ALL AMBULANCE

sanderson
 associates
 (consulting engineers) ltd
 Highways | Traffic | Transportation | Water
 T 01924 844080 mail@sandersonassociates.co.uk
 F 01924 844081 www.sandersonassociates.co.uk

Client: Omar Sharif

Project Title: Orchard Views, 39 Gawber Road, Barnsley

Drawing Title: Swept Path Analysis

Scale: 1:250	Drawn By: AA
Drawing Size: A1	Checked By: KS
Date: April 2022	Approved By: KS

Drawing Number: 300794-002



APPENDIX B

TRIP RATE CALCULATION SELECTION PARAMETERS:

Land Use : 05 - HEALTH
 Category : F - CARE HOME (ELDERLY RESIDENTIAL)
 TOTAL VEHICLES

Selected regions and areas:

02	SOUTH EAST	
	ES EAST SUSSEX	1 days
	HC HAMPSHIRE	1 days
05	EAST MIDLANDS	
	DS DERBYSHIRE	1 days
	NT NOTTINGHAMSHIRE	1 days
07	YORKSHIRE & NORTH LINCOLNSHIRE	
	NY NORTH YORKSHIRE	1 days
08	NORTH WEST	
	LC LANCASHIRE	1 days
09	NORTH	
	TW TYNE & WEAR	1 days
11	SCOTLAND	
	SR STIRLING	1 days

Primary Filtering selection:

Parameter: Number of residents
 Actual Range: 31 to 70 (units:)
 Range Selected by User: 30 to 90 (units:)

Parking Spaces Range: All Surveys Included

Public Transport Provision:

Selection by: Include all surveys

Date Range: 01/01/14 to 02/05/19

Selected survey days:

Monday	2 days
Tuesday	3 days
Wednesday	2 days
Thursday	1 days

Selected survey types:

Manual count	8 days
Directional ATC Count	0 days

Selected Locations:

Edge of Town Centre	2
Suburban Area (PPS6 Out of Centre)	3
Edge of Town	3

Selected Location Sub Categories:

Residential Zone	6
No Sub Category	2

Secondary Filtering selection:

Use Class:

C2 8 days

Population within 500m Range:

All Surveys Included

Secondary Filtering selection (Cont.):

Population within 1 mile:

5,001 to 10,000	3 days
10,001 to 15,000	1 days
15,001 to 20,000	2 days
25,001 to 50,000	2 days

Population within 5 miles:

25,001 to 50,000	2 days
50,001 to 75,000	2 days
125,001 to 250,000	1 days
250,001 to 500,000	3 days

Car ownership within 5 miles:

0.6 to 1.0	3 days
1.1 to 1.5	5 days

Travel Plan:

No	8 days
----	--------

PTAL Rating:

No PTAL Present	8 days
-----------------	--------

LIST OF SITES relevant to selection parameters

1	DS-05-F-01 29 VILLAGE STREET DERBY	NURSING HOME	DERBYSHIRE
	Suburban Area (PPS6 Out of Centre) Residential Zone Total Number of residents: 70 <i>Survey date: TUESDAY 21/10/14</i>		
2	ES-05-F-02 BATTLE ROAD HAILSHAM	CARE HOME	EAST SUSSEX
	Edge of Town Centre Residential Zone Total Number of residents: 69 <i>Survey date: WEDNESDAY 13/07/16</i>		
3	HC-05-F-01 BOTLEY ROAD SOUTHAMPTON	CARE HOME	HAMPSHIRE
	Edge of Town No Sub Category Total Number of residents: 42 <i>Survey date: TUESDAY 24/11/15</i>		
4	LC-05-F-02 LYTHAM ROAD BLACKPOOL SQUIRES GATE	NURSING HOME	LANCASHIRE
	Edge of Town Residential Zone Total Number of residents: 31 <i>Survey date: TUESDAY 27/09/16</i>		
5	NT-05-F-02 MOOR LANE NEAR NOTTINGHAM BINGHAM	NURSING HOME	NOTTINGHAMSHIRE
	Edge of Town Centre No Sub Category Total Number of residents: 34 <i>Survey date: MONDAY 14/11/16</i>		
6	NY-05-F-05 SEAGRIM CRESCENT RICHMOND	NURSING HOME	NORTH YORKSHIRE
	Edge of Town Residential Zone Total Number of residents: 37 <i>Survey date: MONDAY 04/03/19</i>		
7	SR-05-F-01 PERTH ROAD DUNBLANE	NURSING HOME	STIRLING
	Suburban Area (PPS6 Out of Centre) Residential Zone Total Number of residents: 60 <i>Survey date: WEDNESDAY 18/06/14</i>		

LIST OF SITES relevant to selection parameters (Cont.)

8	TW-05-F-03	NURSING HOME	TYNE & WEAR
	MOORE STREET		
	GATESHEAD		
	FELLING SHORE		
	Suburban Area (PPS6 Out of Centre)		
	Residential Zone		
	Total Number of residents:	52	
	<i>Survey date: THURSDAY</i>	<i>02/05/19</i>	<i>Survey Type: MANUAL</i>

TRIP RATE for Land Use 05 - HEALTH/F - CARE HOME (ELDERLY RESIDENTIAL)

TOTAL VEHICLES

Calculation factor: 1 RESIDE

BOLD print indicates peak (busiest) period

Time Range	ARRIVALS			DEPARTURES			TOTALS		
	No. Days	Ave. RESIDE	Trip Rate	No. Days	Ave. RESIDE	Trip Rate	No. Days	Ave. RESIDE	Trip Rate
00:00 - 01:00									
01:00 - 02:00									
02:00 - 03:00									
03:00 - 04:00									
04:00 - 05:00									
05:00 - 06:00									
06:00 - 07:00									
07:00 - 08:00	8	49	0.122	8	49	0.053	8	49	0.175
08:00 - 09:00	8	49	0.089	8	49	0.058	8	49	0.147
09:00 - 10:00	8	49	0.096	8	49	0.043	8	49	0.139
10:00 - 11:00	8	49	0.076	8	49	0.053	8	49	0.129
11:00 - 12:00	8	49	0.078	8	49	0.066	8	49	0.144
12:00 - 13:00	8	49	0.086	8	49	0.071	8	49	0.157
13:00 - 14:00	8	49	0.106	8	49	0.099	8	49	0.205
14:00 - 15:00	8	49	0.109	8	49	0.144	8	49	0.253
15:00 - 16:00	8	49	0.099	8	49	0.147	8	49	0.246
16:00 - 17:00	8	49	0.061	8	49	0.122	8	49	0.183
17:00 - 18:00	8	49	0.048	8	49	0.081	8	49	0.129
18:00 - 19:00	8	49	0.046	8	49	0.030	8	49	0.076
19:00 - 20:00	8	49	0.048	8	49	0.071	8	49	0.119
20:00 - 21:00	8	49	0.033	8	49	0.048	8	49	0.081
21:00 - 22:00									
22:00 - 23:00									
23:00 - 24:00									
Total Rates:			1.097			1.086			2.183

Parameter summary

Trip rate parameter range selected: 31 - 70 (units:)
 Survey date date range: 01/01/14 - 02/05/19
 Number of weekdays (Monday-Friday): 8
 Number of Saturdays: 0
 Number of Sundays: 0
 Surveys automatically removed from selection: 0
 Surveys manually removed from selection: 0