

KEY PLAN - 1:2500

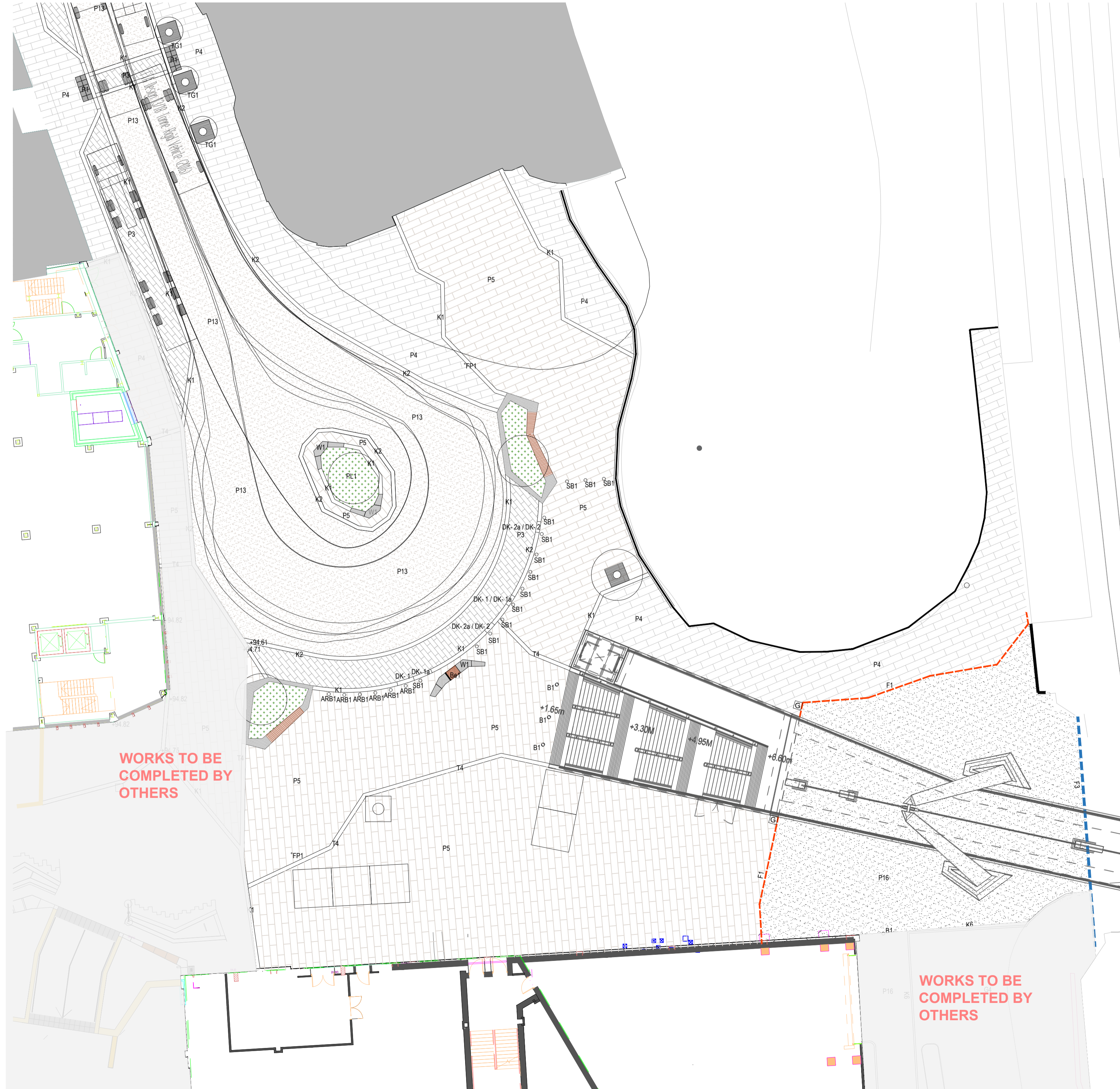

WORKS TO BE COMPLETED BY OTHERS

WORKS TO BE COMPLETED BY OTHERS

LEGEND

Extent of Works

PROPOSED HARD SURFACES

- P3 Paving Type 3:** Natural Coated Concrete Setts  
Q25 / 335
- P4 Paving Type 4:** Natural Coated Concrete Flags  
Q25 / 315
- P5 Paving Type 5:** Yorkstone Flags  
Q25 / 310
- P13 Paving Type 13:** Hot Rolled Asphalt with Chippings  
Q22 / 140 & to engineers details
- P16 Paving Type 16:** Vehicular Grade Asphalt  
Q22 / 110 & to engineers details

PROPOSED WALLS

- W1 Wall Type 1:** Solid Granite Seating Walls  
- Q50 / 220A
- F1 Fence Type 1:** Metal Profile clad Fencing  
- 2100mm high fence to match bridge stair enclosure
- F3 Fence Type 3:** Metal Profile clad Fencing  
- 2100mm high fence to match bridge stair enclosure

PROPOSED KERBS & EDGES

- K1 Kerb Type 1:** 300mm wide Flush Granite Kerb  
Q10 / 120
- K2 Kerb Type 2:** 300mm wide, 125mm Upstand Granite Kerb  
Q10 / 120A
- K3 Kerb Type 3:** 300mm wide, 150mm Upstand Granite Kerb  
Q10 / 120B
- E1 Edging Type 1:** Lawn Steel Edging  
Q10 / 200
- DK Kerb:** 300mm wide, 100mm high - 6mm high, Concrete drop kerb [Left hand sided]  
Q10 / 120B
- DK Kerb:** 300mm wide, 100mm high - 6mm high, Concrete drop kerb [Right hand sided]  
Q10 / 120B

SOFT SURFACES

- G1 Grass Type 1**  
Artificial: Q26 / 350A
- PL1 Planting Type 1** - See Planting Plan: Q31 + Q28

TREES

- Proposed Tree:** Q31 + Q28

STREET FURNITURE

- TG1 Tree Grille & Guard Type 1:**  
- Q50 / 262+260
- Be1 Bench Type 1**  
- Q50 / 220A
- LB1 Litter Bin Type 1**  
Q50 / 240A
- B1 Bollard Type 1**  
Fixed Bollard: Q50 / 190
- CS1 Cycle Stand Type 1**  
Cycle Stand: Q50 / 210A
- FP1 Finger Post Sign**  
Q50 / 320A (clause detail TBC)
- Static Bollard Stainless Steel - BSI PAS 68:2013 or IWA 14-1:2013**  
in response to HVM measures. NBS TBC
- Automatic Retractable Stainless Steel Bollard - BSI PAS 68:2013 or IWA 14-1:2013**  
in response to HVM measures. NBS TBC

LIGHTING

- LC1 - Lighting Column 1**  
- V91 / 3456A and Lighting Engineers Details
- ELC1 - Existing Lighting Column 1**  
- lighting columns repositioned as necessary. Final details [location / height TBC].  
- see Lighting Engineers Details

Notes:  
 • This drawing is copyright.  
 • Do not scale dimensions from this drawing.  
 • This drawing is to be read in conjunction with all other relevant drawings.  
 • All discrepancies on this drawing are to be reported to the architect.  
 • Do not modify any element of this drawing.  
 • Use drawing only for purpose(s) issued.  
 North Sign / Key Plan

The following external model files are included within this drawing:

Rev	Date	Revision Notes	Client / Contractor
P05	02/07/21	Vehicle tracking added	DW RW
P04	28/06/21	Amendments made to turning area following client consultation and comments	JH DW
P03	29/03/21	Issued for Planning purposes. GA updated to reflect highways drawing. Key updated to suit.	DW NV
P02	19/10/20	Amendments made to suit client comments and Safety Audit recommendations. Issued for planning purposes.	JH DW
P01	24/04/20	Tender Issue	MJS CL
D	08/04/20	Layout updated in response to BMBC request 25.03.20	JH CL
C	07/01/20	Bollards added following client comments	JH CL
B	17/12/19	Arrangement update to allow two way vehicle access	JH CL
A	03/12/19	Tender Issue	DW DW
Rev	Date	Revision Notes	Dn Rv



Project  
 BETTER BARNSELY TOWN CENTRE

Drawing Title  
 PUBLIC REALM  
 GENERAL ARRANGEMENT PLAN  
 - INTERCHANGE SQUARE

Job Number 51268	Drawing Originated Date 25/01/2018	PAS 1192 Status Code
Scale@A1 1:200	Purpose PLANNING	

Drawing Number BBTC-IBI-N4-L-G700-PL-00-04	Revision P05
---	-----------------