

KEY:

RM 01 INDICATES ROOM NUMBER THAT CORRESPONDS WITH ROOM DATA SHEET

J55 INDICATES MICAD ROOM NUMBERS

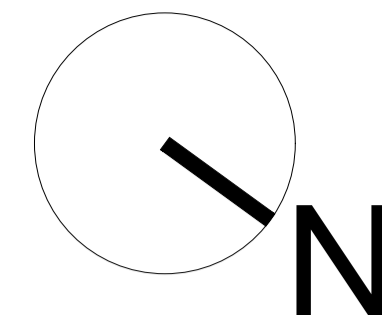

Drawing status

Notes	Status	Rev	Date
FEASIBILITY STUDY	F	-	-
AMENDMENTS: Minor changes made to suit the comments received.	F	A	21/01/21
AMENDMENTS: - Structural upstand added as per engineer's comment, - Glazed walls and smart glass windows added to the scheme.	F	B	22/01/21
AMENDMENTS: - Updated to minor comments - Updated to site survey	F	C	22/02/21
AMENDMENTS: - location of VCs and WHBs in Theatre Recovery area amended for better drainage connection, - waiting area obscured glass changed to partition wall with windows	F	D	26/02/21
AMENDMENTS: - Wall between Bed Bay 10 and 11 removed and isolation room 16 flipped	F	E	15/03/21
AMENDMENTS: - Column between Bed Bay 10 and 11 added for power and data, - Existing wall line of the shop to be retained. Drawing amended to suit the requirement. In Partry Room relocated; Staff WC omitted; Patients WC added.	F	F	15/04/21
TENDER ISSUE	T	G	07/05/21
AMENDMENTS: Curtain tracks added, furniture added to SNODS and Clinical Educator Rooms	T	G	17/05/21
FINAL TENDER ISSUE	T	G	20/05/2021
FOLLOWING THE REVIEW	-	-	-
- Nurse Base 1 and 2 desk amended	-	-	-
- 2no. WHB added (Bulk Storage and Lobby 1)	-	-	-
CONSTRUCTION ISSUE	C	H	01/09/2021
AMENDMENTS (related to drainage addendum during tender period):	-	-	-
- Internal area number updated,	-	-	-
- Renal units on IPS added,	-	-	-
- Pipework boxings added to Iso lobby 2, Iso room 15, Iso lobby 3, Iso room 16.	-	-	-
AMENDMENTS: - Drawing revised following the revised fire strategy plan. New door sets and partitions highlighted.	C	I	09/09/2021
AMENDMENTS: - MICAD room numbers added to Globe plan.	C	J	16/09/2021
AMENDMENTS: - MICAD room numbers amended and the short numbers were changed with the longer MICAD room codes.	C	K	20/09/2021
AMENDMENTS: - SD02 renamed D68.	C	L	21/09/2021

Extra MICAD numbers used in addition to those provided to Globe:
D35 - New Shop Store
R99 - Lobby 5
R100 - Relocated Shop Store

TOTAL INTERNAL AREA (INCLUDING COURTYARD)
80.9m² & RELATIVES ROOM
(26.7m²):
APPROX. 1305 m²

16 ICU BEDS
8 ESCALATION SPACES

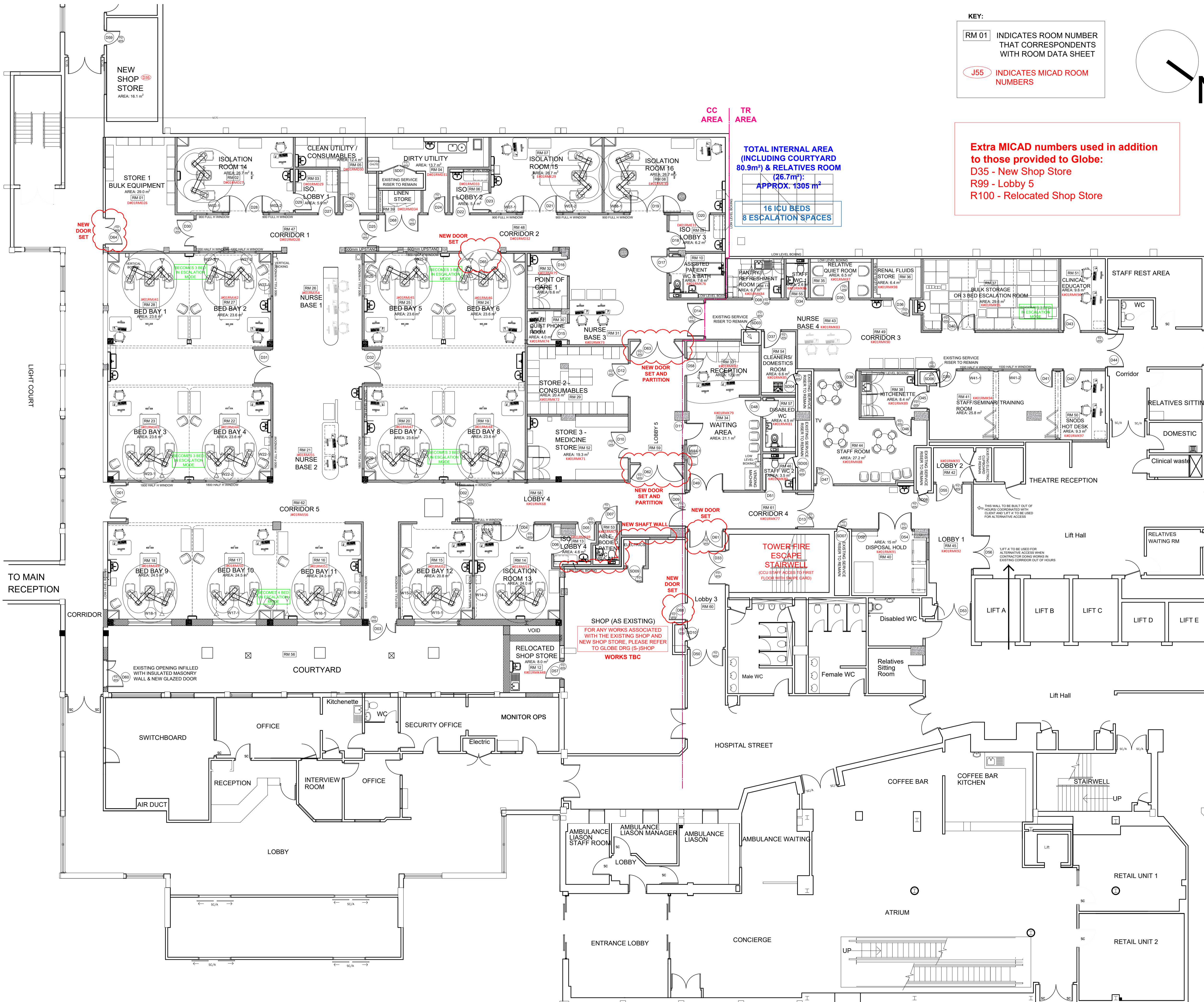

SHOP (AS EXISTING)
FOR ANY WORKS ASSOCIATED WITH THE EXISTING SHOP AND NEW SHOP STORE, PLEASE REFER TO GLOBE DRG (S)SHOP WORKS TBC

PROPOSED GROUND FLOOR PLAN
1:100

Drawing status annotation
P-Preliminary T-Tender D-Design (post preliminary) C-Construction As-As Built

Client

BARNSEY HOSPITAL NHS FOUNDATION TRUST

Project title

CRITICAL CARE UNIT

Project no

170-033

Drawing title

PROPOSED GROUND FLOOR PLAN

CC AND TR AREA

Drawing no

CC-TR(0)-J01

Status

C

Revision

L