

**NOTES**

1. Driveway and car park surfacing design and construction to Engineer's Specification (by others).
2. All dimensions are in millimetres unless otherwise stated.
3. Pre-cast concrete products shall comply with the relevant provisions of BS 5911 and be 'Kite Marked'.
4. Manhole covers and frames, grids and frames shall comply with the relevant provisions of BS EN 124. D400 class manhole cover to be used within trafficked areas. A15 class manhole cover to be used in untrafficked areas.
5. Do not scale from this drawing. If in doubt ask.

Estimated discharge rate of 8.6l/s from Area1 based on existing ADAS 345 greenfield runoff rate.  
 Estimated discharge rate of 1.1l/s from Area2 based on existing ADAS 345 greenfield runoff rate. Therefore, YW practical minimum rate of 3.5l/s adopted.

**KEY:**

- Area 1 development  
1.313 ha total area
- Area 2 development  
0.1628 ha total area
- Roofed & Paved Areas  
Roofed areas to sealed downpipes
- Permeable Paving to private drives to provide treatment and attenuation. Sub base depth 200mm. Contributing area taken as 10%
- Indicative Adoptable SW Manhole
- Indicative SW Manhole
- Control manhole with hydrobrake
- Storage Tanks
- Approx location of YW public sewer within highway

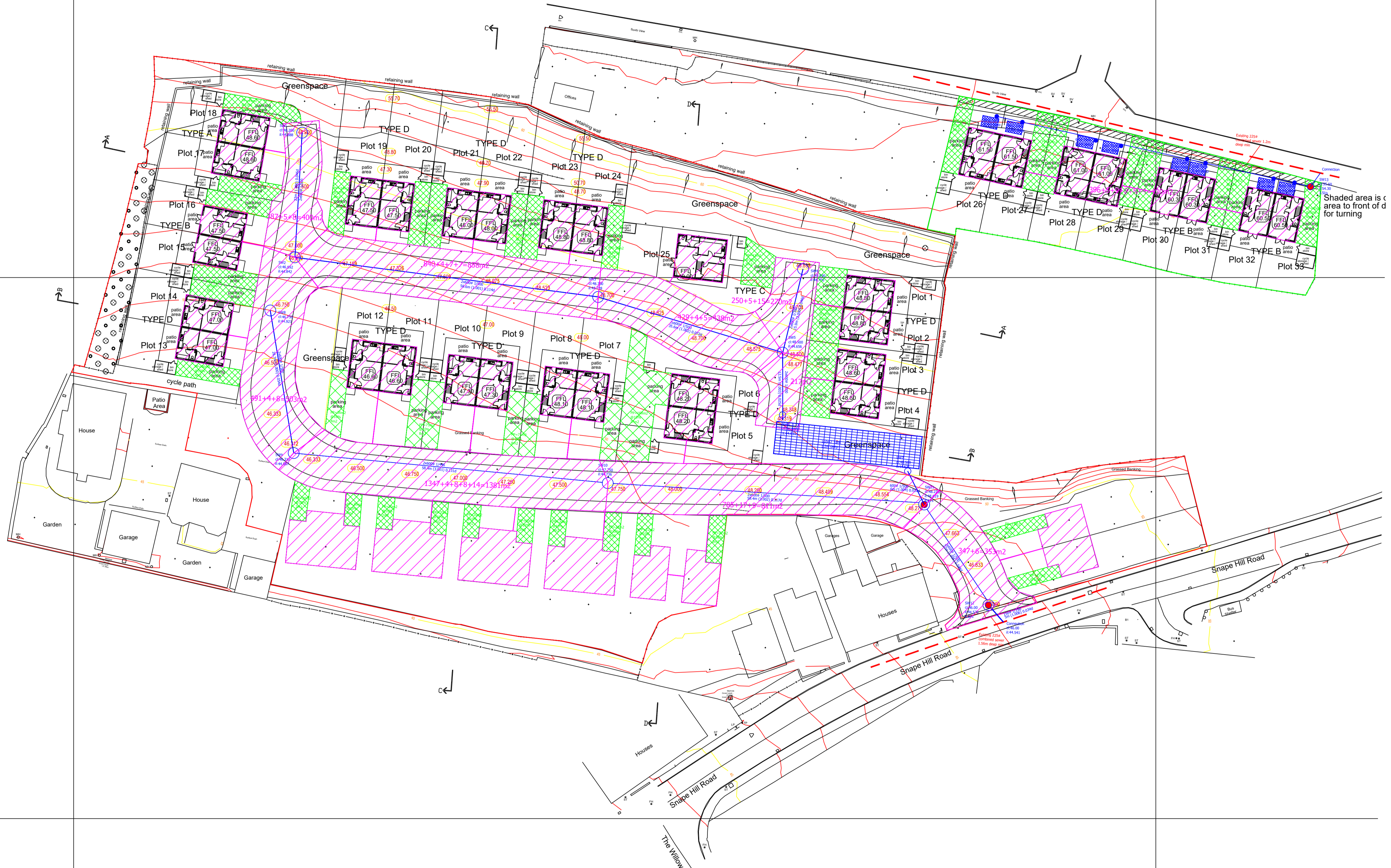

REV	DESCRIPTION	DATE
0	For Approval	22/10/24

**EWE Associates Ltd**  
 EWE Associates Limited  
 7 Waveney Close  
 Burton Upon Stather  
 Scunthorpe  
 DN15 9DT  
 Tel: 07875 972270  
 Email: lea.favill@eweassociates.com

**PROJECT**  
 South View Darfield

**CLIENT**  
 Mr Jason Hughes

**DRAWING TITLE**  
 Surface Water Drainage Layout

**SCALE**  
 1:350

**DATE**  
 22/10/24

**DRAWN BY**  
 LjF

**CHECKED BY**  
 JF

**REVISION**  
 0

**DRAWING No**  
 EWE/2976/01

**PLANNING APPROVAL DRAWING ONLY**