

OVERVIEW (SCALE 1:1000@A1)

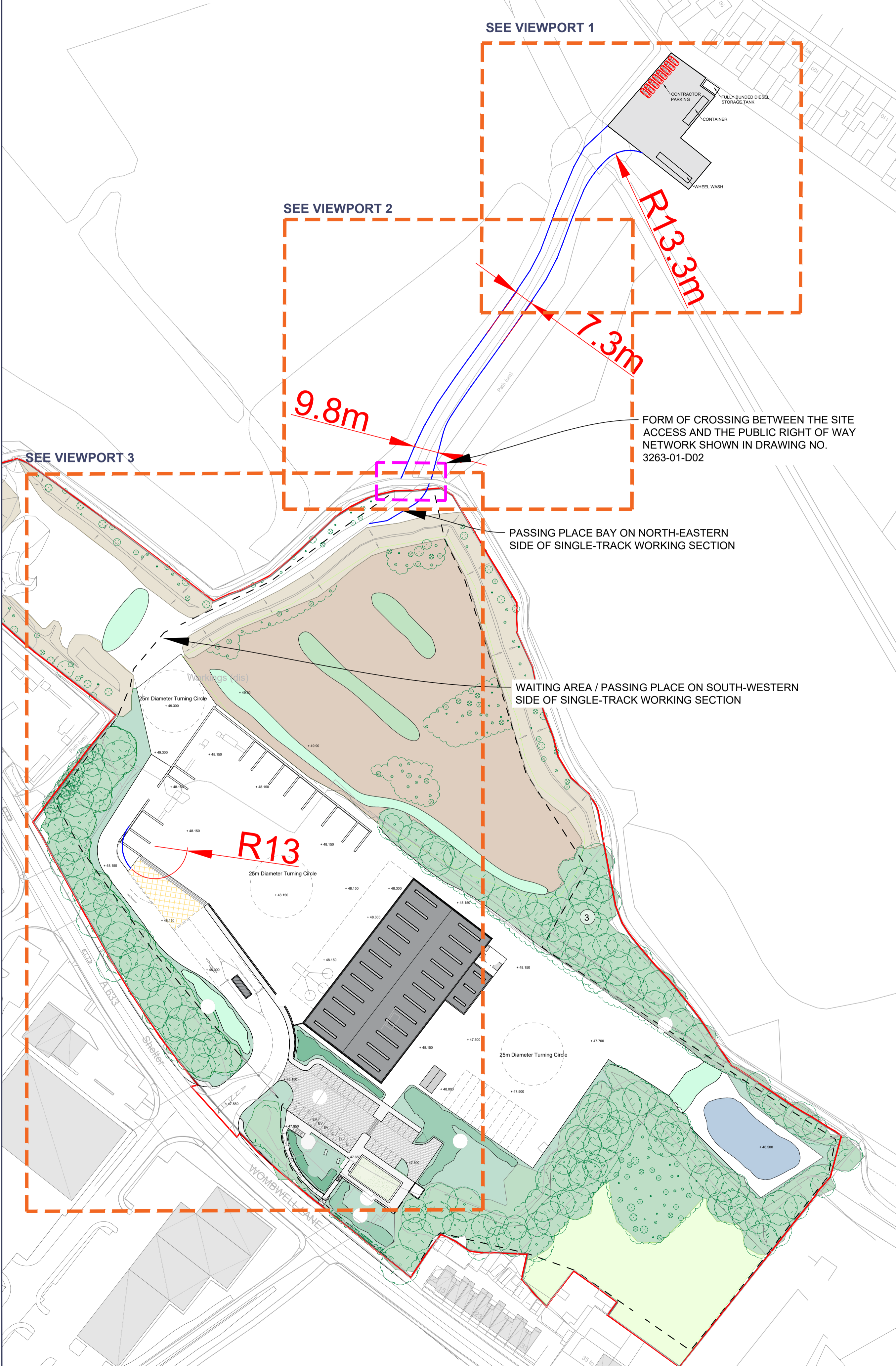

VIEWPORT 1 - PROPOSED SITE COMPOUND (SCALE 1:500@A1)

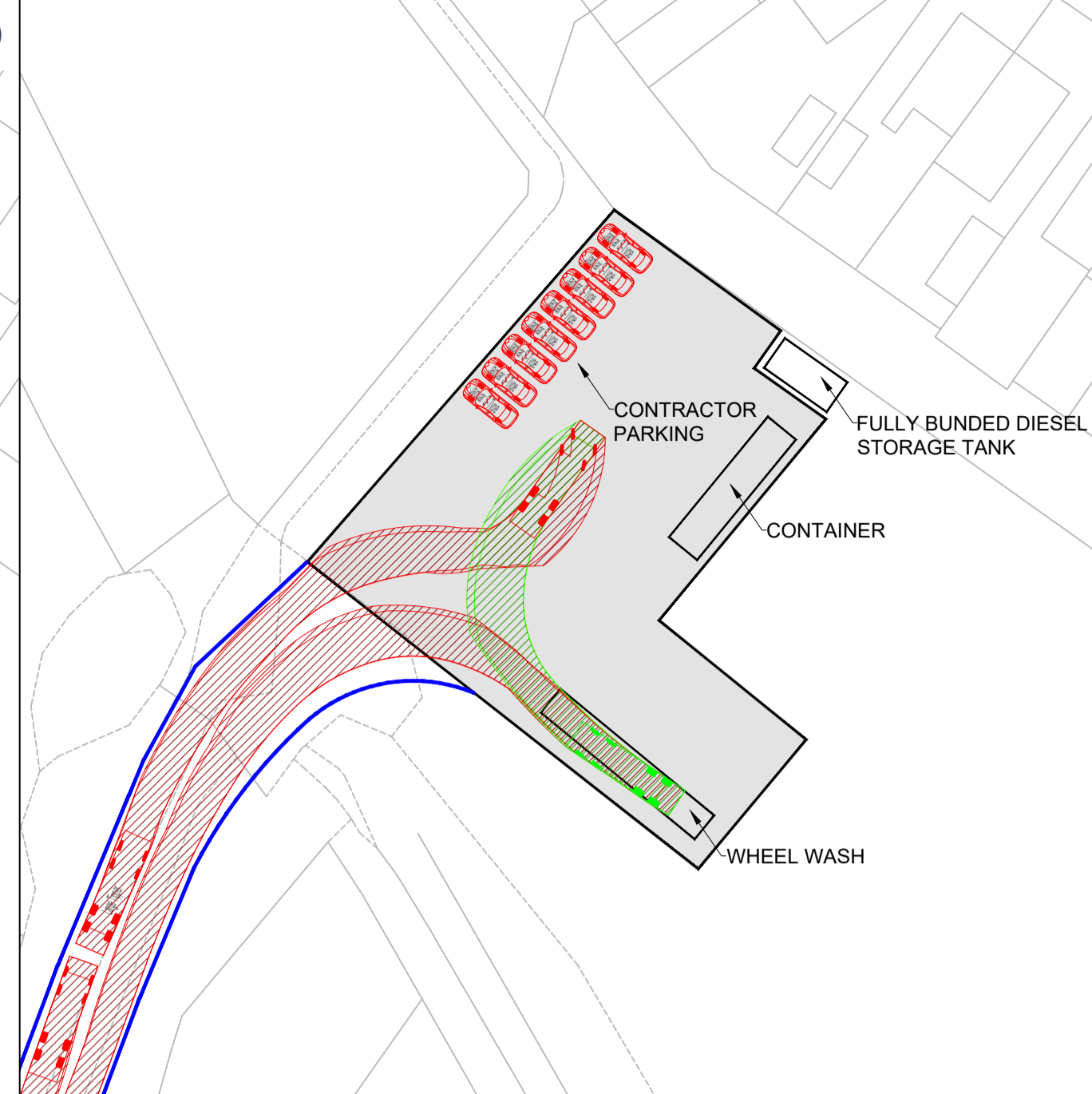
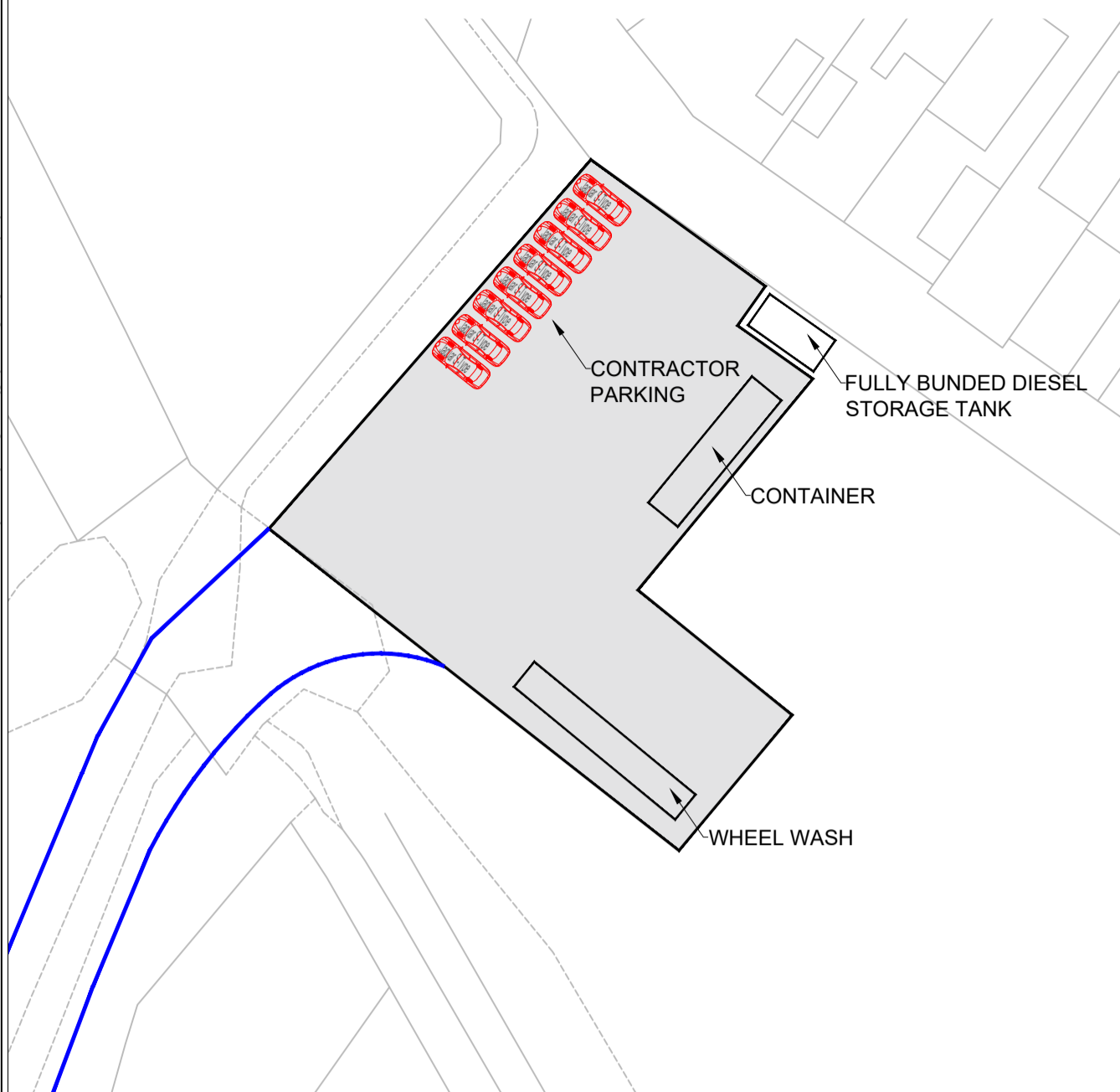

Proposed Widening to Access

Application Ref. 2024/0373 Site Boundary

Design Vehicle:

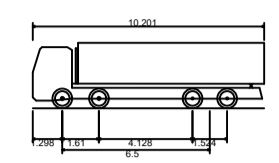

Large Tipper
 Overall Length 10.201m
 Overall Width 2.855m
 Overall Body Height 2.800m
 Min. Body Ground Clearance 0.241m
 Track Width 0.271m
 Load to front 4.50t
 Kerb to Kerb Turning Radius 11.550m

VIEWPORT 2 - SWEEP PATH ANALYSIS (SCALE 1:1000@A1)



VIEWPORT 3 - SWEEP PATH ANALYSIS (SCALE 1:1000@A1)

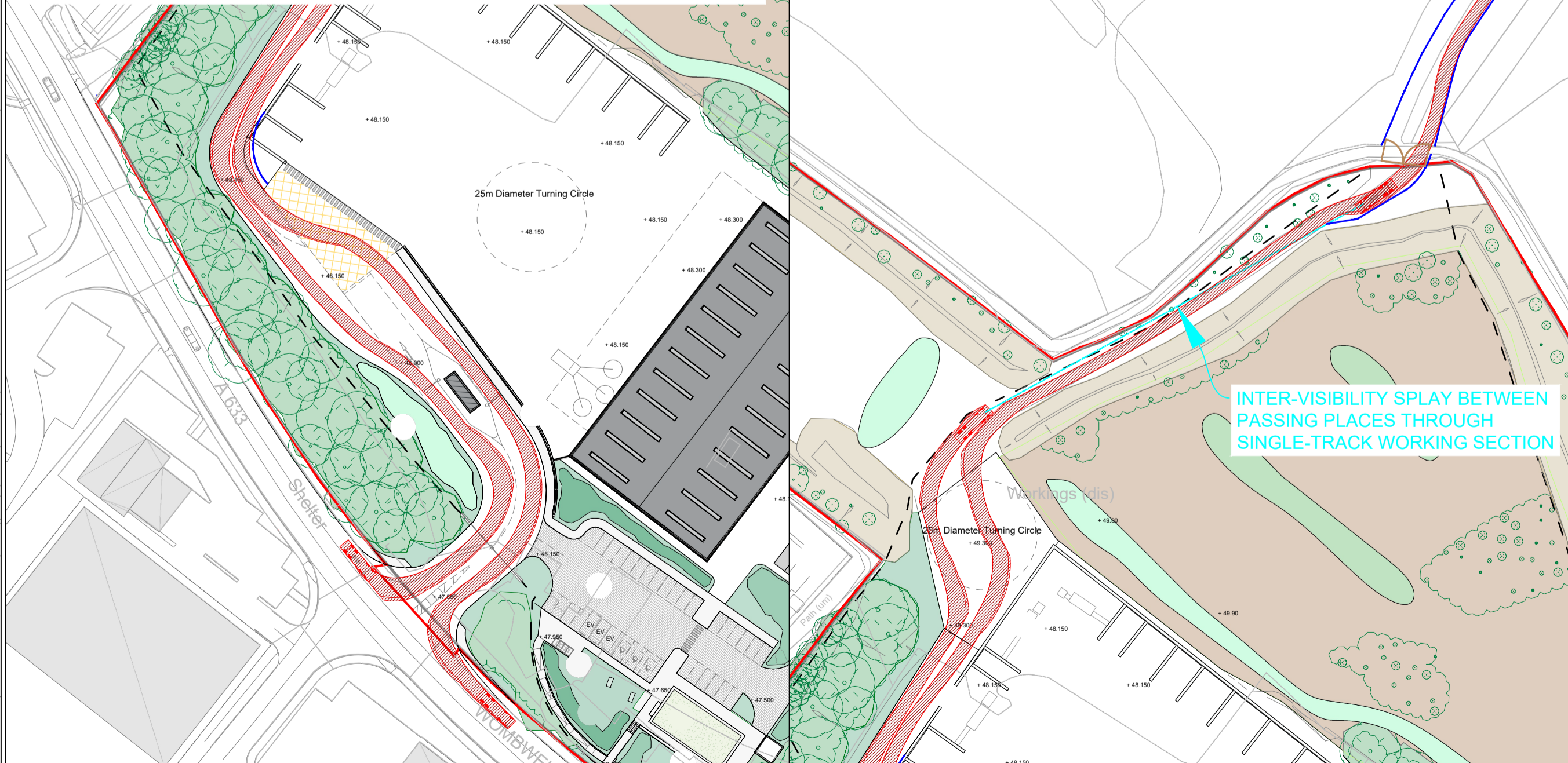

0344 8700 007
 axis.co.uk



Client
Green Earth (Stairfoot) Limited

Project
Stairfoot Quarry

Drawing Title

Proposed Site Access Arrangements

Scale **As Stated** Status

Date **October 2025** Drawn **JD** Checked **SH**

Dwg no **3263-01-02** Rev



revision: desc:

date: