

**DRAINAGE LAYOUT PART PLAN 1**

Scale: 1: 250

**KEY:**

- PROPOSED SURFACE WATER DRAIN NOT ADOPTABLE
- SURFACE WATER MANHOLE
- ACO Q-BRAKE - HYDRO BREAK
- EXISTING SURFACE WATER DRAIN
- PROPOSED LINEAR DRAINAGE CHANNEL
- GEOCELLULAR ATTENUATION TANK
- KINGSPAN BYPASS INTERCEPTOR
- PROPOSED FOUL WATER 150mm DIA. DRAIN NOT ADOPTABLE
- FOUL WATER MANHOLE

**MANHOLE SCHEDULE**

Scale: 1: 1

	S1	S2	S3	S4	S5	S6	S7	S8
C.L.	251.688	252.680	252.680	256.688	249.880	248.390	247.200	246.650
I.L.	250.188	250.004	249.922	250.188	248.380	246.965	245.700	245.150

	S20	S21	S22	S23	S24
C.L.	254.000	254.000	253.630	254.000	254.000
I.L.	252.480	252.421	252.205	252.480	252.421

	F1	F2	F3	F4
C.L.	251.688	252.680	254.000	254.000
I.L.	250.288	249.400	252.421	252.480

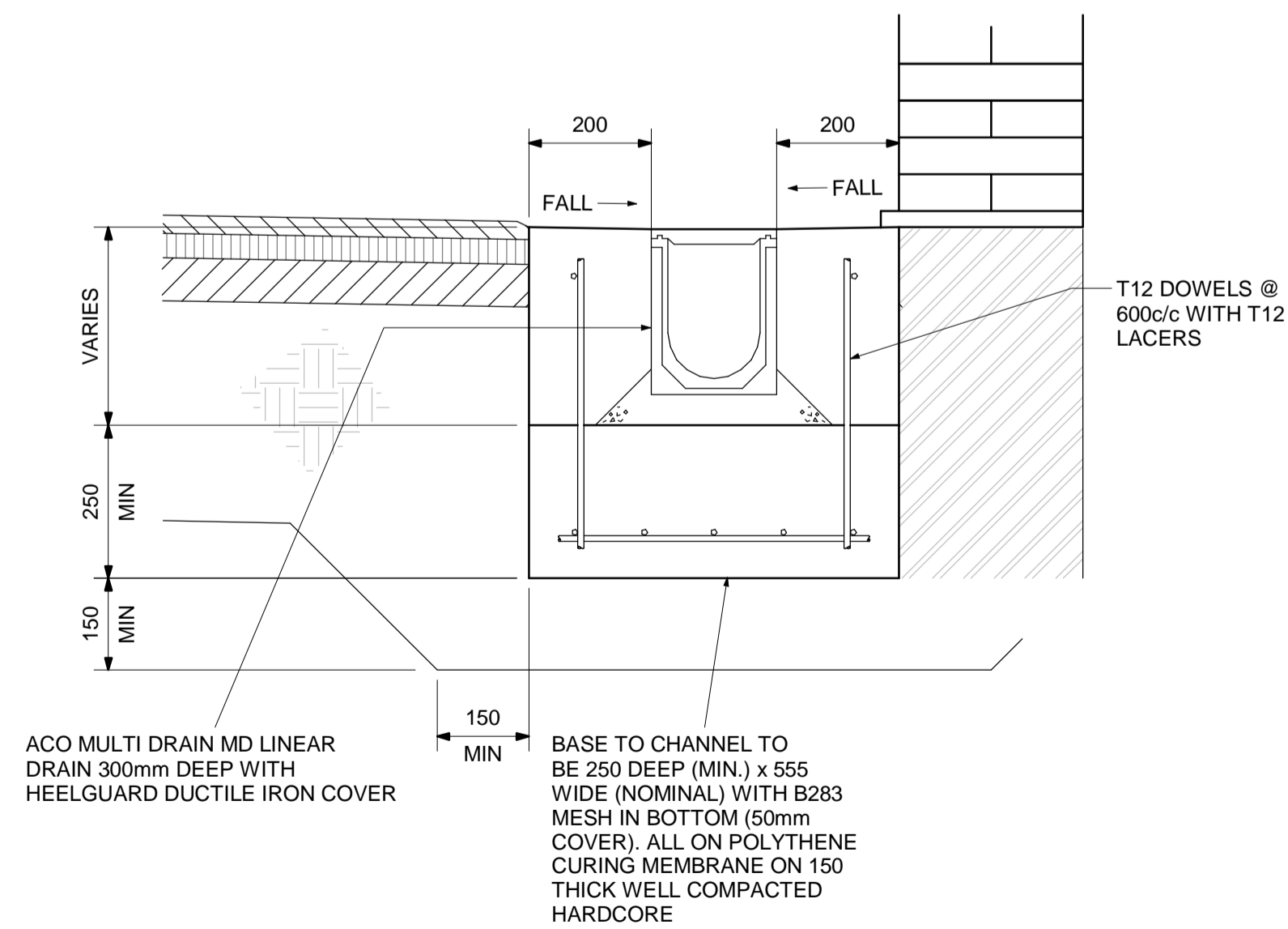

**LINEAR DRAIN DETAIL**  
SCALE 1:10

**NOTES**

**GENERAL:**

1. DO NOT SCALE.
2. THIS DRAWING TO BE READ IN CONJUNCTION WITH ALL OTHER RELEVANT ENGINEERING, ARCHITECTURAL AND SPECIALIST SUPPLIER DRAWINGS, SPECIFICATION OF WORKS, DESIGN RISK ASSESSMENTS AND METHOD STATEMENTS.
3. THE PRINCIPAL DIMENSIONS AND LEVELS FOR SETTING OUT ARE INDICATED. THE CONTRACTOR IS TO TAKE ACCURATE SITE MEASUREMENTS TO VERIFY PRINCIPAL SETTING OUT DIMENSIONS AND LEVELS PRIOR TO THE EXECUTION OF ANY WORK. ALL DIMENSIONS ARE IN MILLIMETRES UNLESS NOTED OTHERWISE. ALL LEVELS IN METRES ABOVE OS DATUM UNLESS NOTED OTHERWISE.
4. ALL WORK IS TO BE CARRIED OUT TO THE APPROVAL OF THE ENGINEER AND **BUILDING CONTROL** AND TO BE IN ACCORDANCE WITH THE REQUIREMENTS OF THE PLANNING PERMISSION WHERE APPROPRIATE. ALL WORKMANSHIP AND MATERIALS TO BE IN ACCORDANCE WITH THE LATEST EDITION OF THE RELEVANT BRITISH STANDARD CODES, CODES OF PRACTICE OR EUROCODES AND THE AGREED PROJECT SPECIFICATION.
5. THE CONTRACTOR IS TO ENSURE COMPATIBILITY AND GOOD FIT BETWEEN NEW AND EXISTING CONSTRUCTION THROUGHOUT. TAKING SITE DIMENSIONS AS NECESSARY PRIOR TO COMMENCEMENT OF ANY WORK. THE CONTRACTOR IS TO MAINTAIN STABILITY OF ALL WALLS, FLOORS, COLUMNS, TRUSSES AND OTHER STRUCTURAL AND NON-STRUCTURAL ELEMENTS AND TO DESIGN, DETAIL, SUPPLY AND FIX ALL TEMPORARY SUPPORTS TO MAINTAIN VERTICAL AND HORIZONTAL STABILITY OF THE STRUCTURE AND ADJACENT STRUCTURES FOR THE DURATION OF THE WORKS.
6. ALL PROPRIETARY PRODUCT DETAILS ARE INDICATIVE. FOR CONSTRUCTION DETAILS SEE SPECIALIST SUPPLIERS INFORMATION. ALTERNATIVE PROPRIETARY PRODUCTS MAY BE PROPOSED BUT SHOULD BE IN ALL RESPECTS EQUAL TO THE PRODUCT DETAILED AND WILL BE SUBJECT TO THE APPROVAL OF THE ENGINEER AND NEXUS/BUILDING CONTROL. ALL PROPRIETARY PRODUCTS ARE TO BE INSTALLED STRICTLY IN ACCORDANCE WITH THE MANUFACTURERS WRITTEN INSTRUCTIONS.

**SAFETY, HEALTH AND ENVIRONMENTAL INFORMATION**

THE FOLLOWING NOTES HIGHLIGHT SIGNIFICANT RESIDUAL HAZARDS IDENTIFIED BY THE DESIGNER. TYPICAL HAZARDS THAT SHOULD BE IDENTIFIED BY A COMPETENT CONTRACTOR ARE NOT INCLUDED. THE CONTRACTOR SHALL CARRY OUT THE WORKS USING AN APPROVED SAFE SYSTEM OF WORK

FURTHER INFORMATION ON HAZARDS CAN BE FOUND IN THE DRA AND / OR CSM HAZARD LOG.



REF.	HAZARD	STAGE	MITIGATING MEASURE
A	CONTAMINATES	CONSTRUCTION	SEE XX-XXX-DRA-001
B	BURIED SERVICES	CONSTRUCTION	SEE XX-XXX-DRA-001

P01	FIRST ISSUE	SG	LJH	AJH	11/02/2022
Rev	Description	Drm / Chk / App	Date		

**ORIGINAL DRAWING IN COLOUR**



Telephone +44 (0)3330 142 926  
Email: info@matrixce.co.uk  
www.matrixce.co.uk

Barnsley Business and Innovation Centre  
Barnsley, S75 1JL

**MR E DILLINGHAM**

**CENTURY WORKS**

**DRAINAGE GENERAL ARRANGEMENT (EAST)**

Scale:	As indicated @ A1	Role:	CIVIL
Matrix Job Number:	21-032	Suitability:	S1 - SUITABLE FOR COORDINATION
Drawing No.	21-032-MCE-ZZ-XX-DR-C-5000	Revision:	P01