

GENERAL NOTES  
 This drawing shows the provisional design only and is subject to Local Authority approval. This drawing should not be scaled for setting out purposes unless specified.

This drawing is based on a topographical/ordnance survey provided by others.

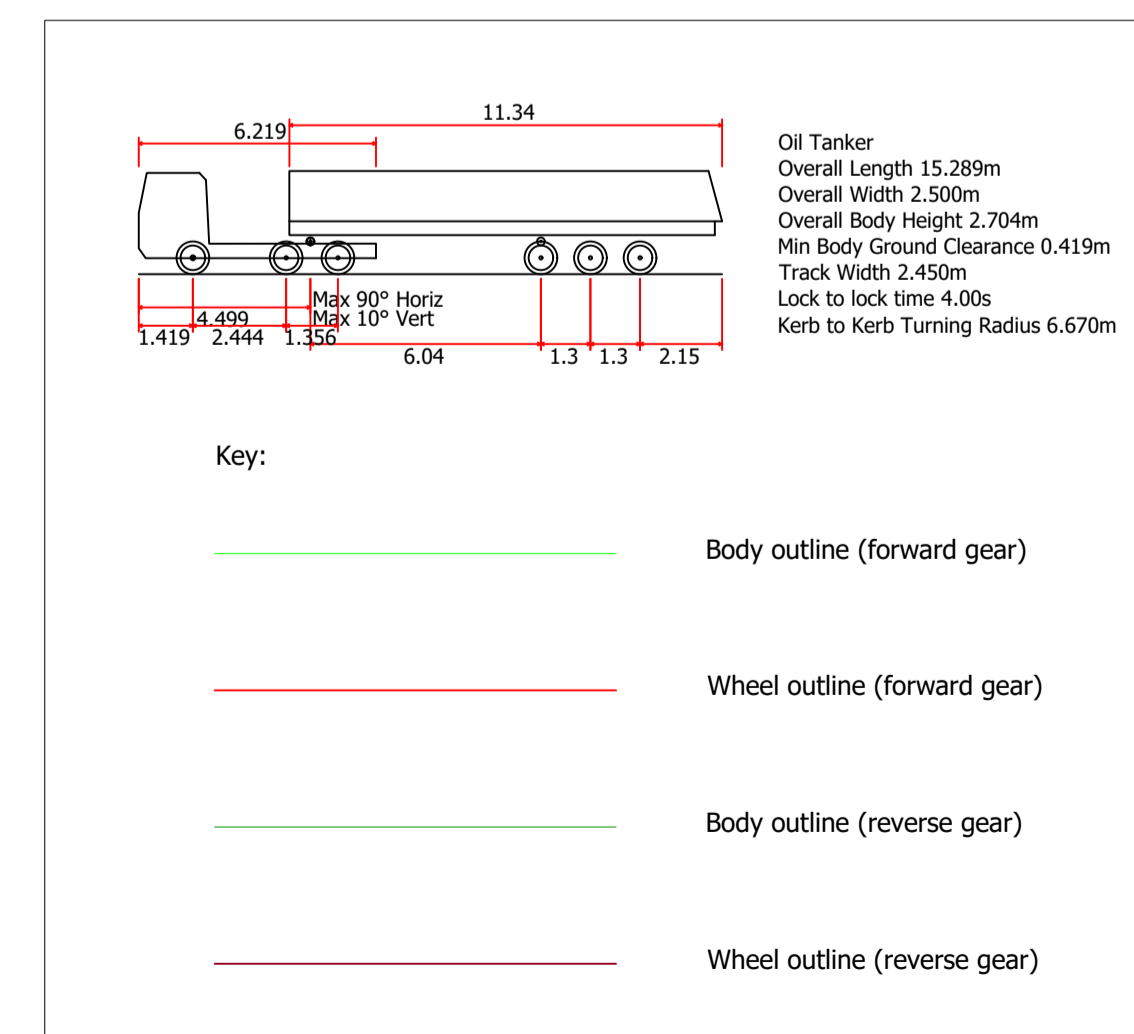
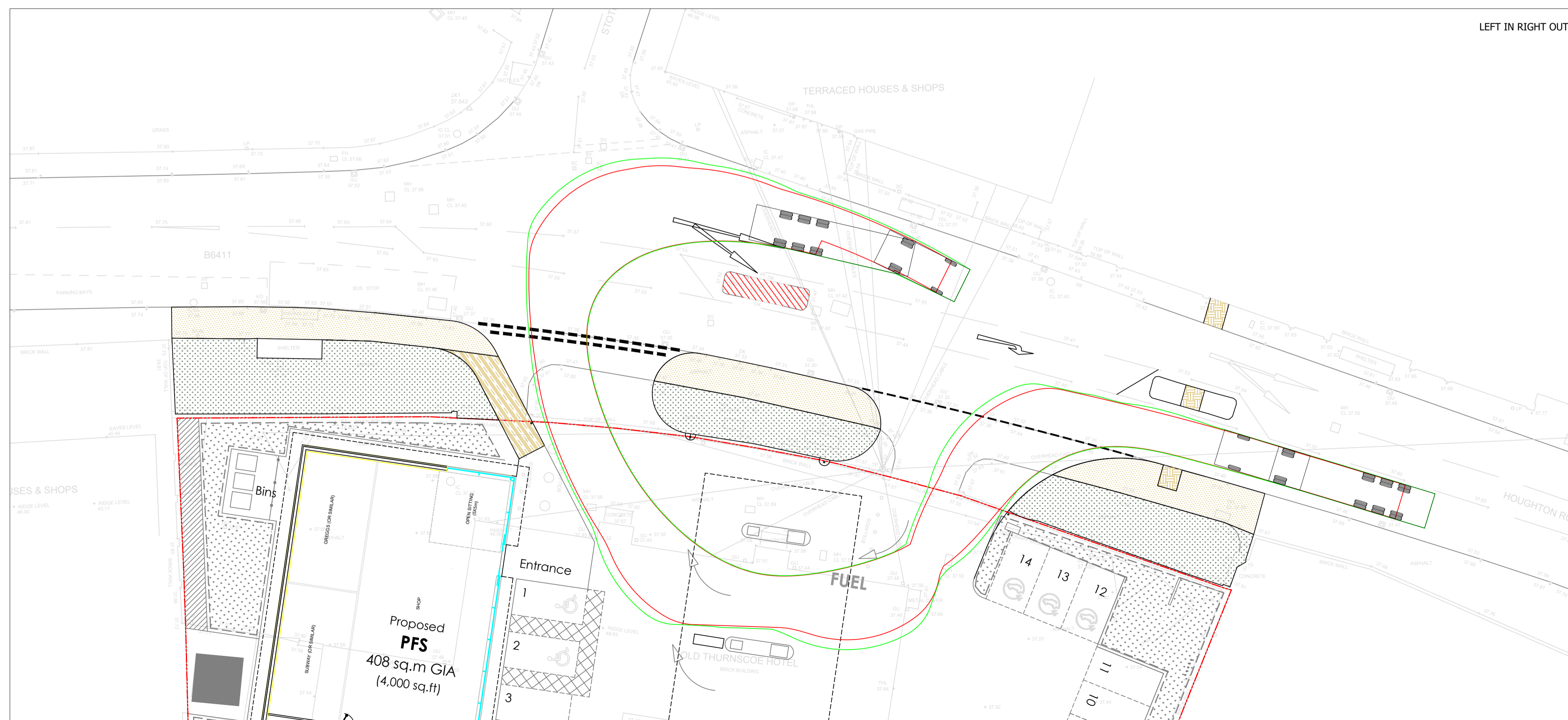
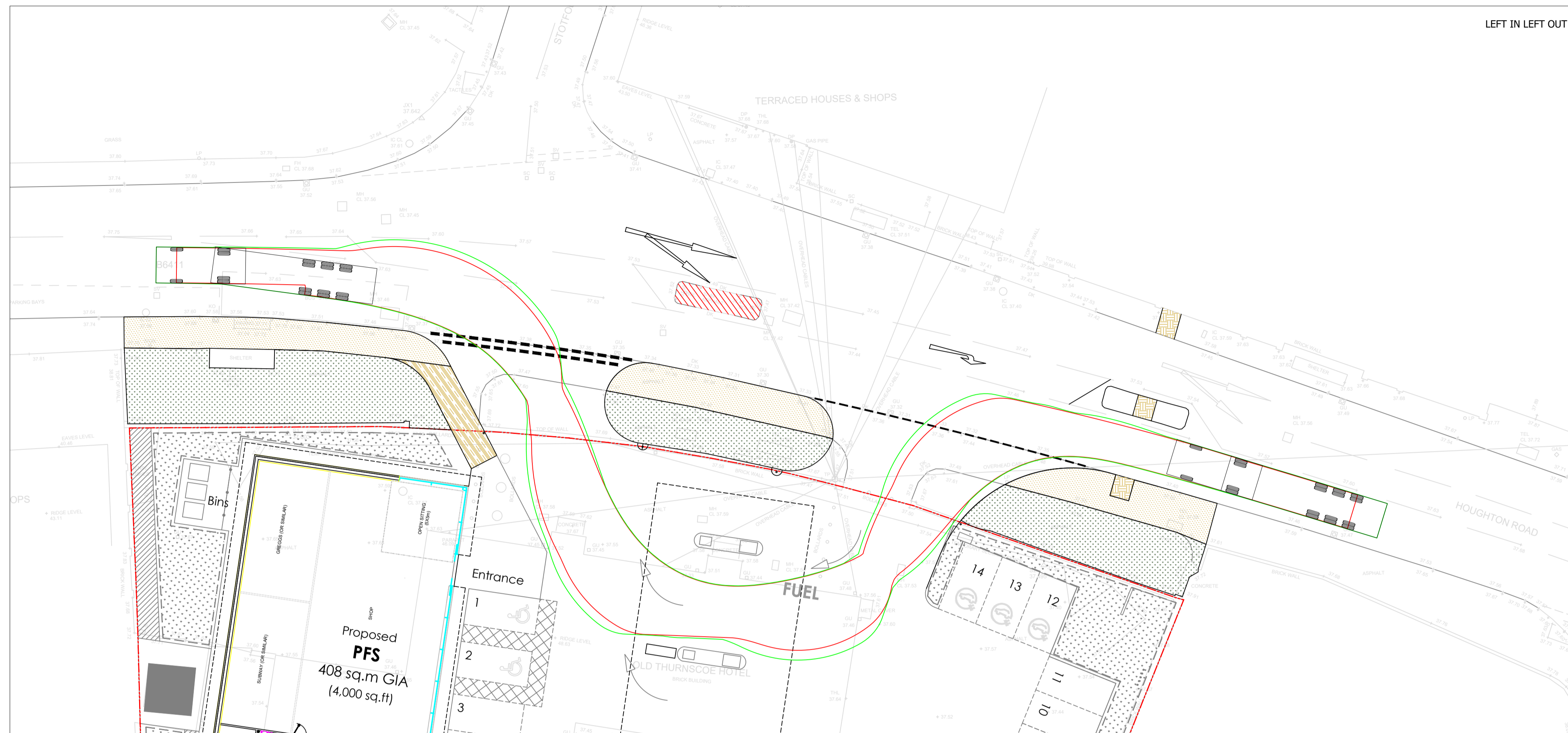
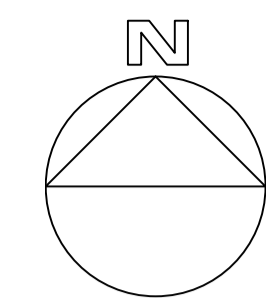

B 12.10.2022 AMENDED FOLLOWING COUNCIL COMMENTS

PROJECT  
 THURNSCOE HOTEL, ROTHERHAM

TITLE  
 VEHICLE TRACKING #1 OF 2

SCALE  
 1:200 @ A1

DRAWING  
 2075 -102B

DATE  
 12.10.2022