

This drawing is copyright of DART Engineers Ltd and must not be copied or reproduced in any way without written consent.

DO NOT SCALE OFF THIS DRAWING

No.	Revision	Date	Drwn

**Drainage Strategy**  
The site is located within flood zone 1 with a low risk of flooding from rivers or the sea, therefore a site specific flood risk assessment is not required

NPPF guidelines require that surface water arising from a developed site should as far as practicable be managed in a sustainable manner to mimic the surface water flows arising from the site prior to development.

Under the SUDS Hierarchy the first point of discharge is via infiltration. This was successful with a rate of 0.468m/hr see Dart Engineers Report

**Surface Water:**  
The driveway area is 150m<sup>2</sup> this will drain via the sub base at 150m<sup>2</sup> surface area 350mm depth and 30% Void Ratio

The plot is 120m<sup>2</sup> this will drain via attenuation crates at 6m<sup>2</sup> surface area and 2m depth giving 12m<sup>3</sup> of storage, soakaway to be 5m away from habitable building

These are for the 1 in 100 Year Storm +45% CC and 10% Urban Creep

**Foul Water**  
Foul to connect to the existing sewer on the applicants land this discharges to the North East as shown inset

**Maintenance**  
The site is to remain private and homeowners will be responsible for the maintenance and management of the sewers, please see Maintenance Schedule for list of actions to be undertaken.

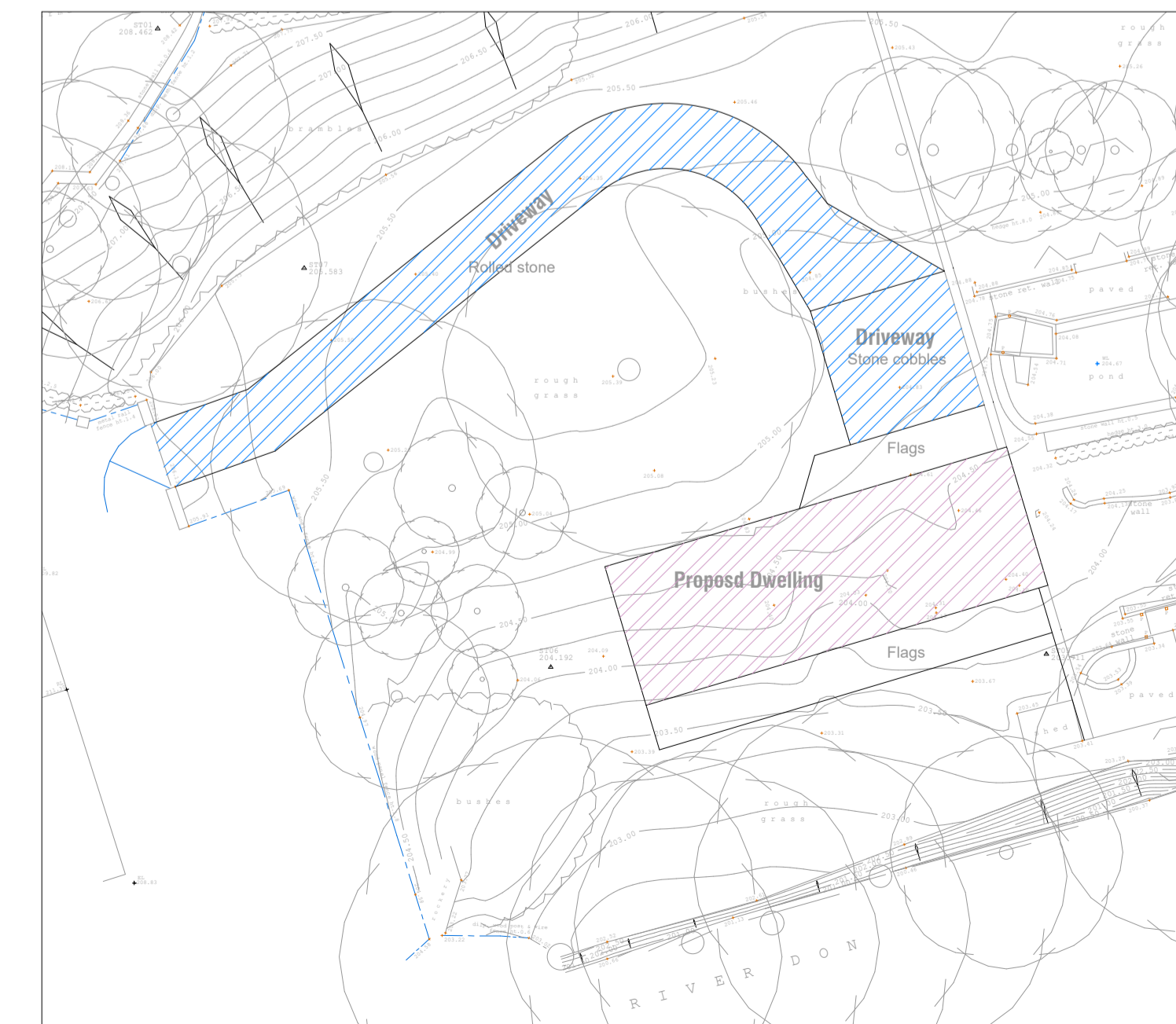

**Key**

	Proposed Surface Water Drainage
	Proposed Foul Water Drainage
	Existing Foul Sewer

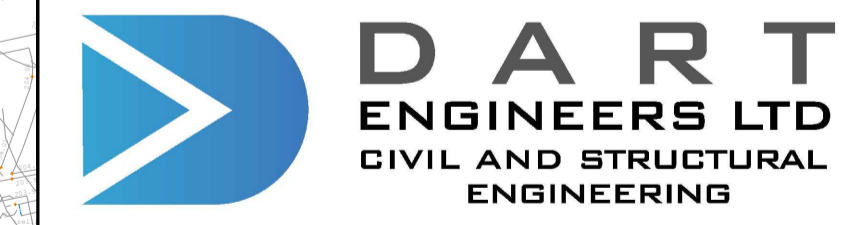

**CONTACT**  
e: andy@dart-engineers.com  
e: robt@dart-engineers.com  
m: 07725281902  
w: www.dart-engineers.com

**CLIENT**  
GERRY TREW

**PROJECT**  
CORN MILL,  
THURLSTONE

**DRAWING TITLE**  
DRAINAGE STRATEGY

Drawn	RT	Chkd	AD	Date	11.04.24	Scale	-
Sheet Size	A1	Drawing No.	24166-DR-C-0100	Revision			P1