

APPENDIX A

Historical Maps

Historical Mapping & Photography included:

Mapping Type	Scale	Date	Pg
Yorkshire	1:2,500	1893	2
Yorkshire	1:2,500	1906	3
Yorkshire	1:2,500	1931	4
Ordnance Survey Plan	1:2,500	1960	5
Ordnance Survey Plan	1:2,500	1968 - 1971	6
Additional SIMs	1:2,500	1978 - 1988	7
Additional SIMs	1:2,500	1979 - 1980	8
Additional SIMs	1:2,500	1981 - 1986	9
Additional SIMs	1:2,500	1983 - 1988	10
Additional SIMs	1:2,500	1985	11
Large-Scale National Grid Data	1:2,500	1992 - 1993	12
Large-Scale National Grid Data	1:2,500	1993 - 1996	13
Large-Scale National Grid Data	1:2,500	1995 - 1998	14
Large-Scale National Grid Data	1:2,500	1996	15

Large-Scale National Grid Data 1:2,500 and 1:1,250

Symbol	Description	Symbol	Description
	Cliff		Barracks
	Rock		Battery
	Boulders		Cemery
	Positioned Boulder		Chymey
	Non-Confiferous Tree (surveyed)		Cistern
	Non-Confiferous Trees (not surveyed)		Disamtd Rly
	Orchard		El Gen Sta
	Coppice, Osler		El Sub Sta
	Rough Grassland		Elctricity Sub Station
	Direction of water flow		Filter Bed
	Electricity Transmission Line		Fountain/Drinking Fm.
	Bench Mark		Gas Valve Compound
	Roofed Building		GVC
	Civil parish/community boundary		MH
	District boundary		MP, MS
	County boundary		Pillar, Pole or Post
	Boundary post/stone		PO
	Boundary mering symbol (note: these always appear in opposed pairs or groups of three)		PC
	Public Convenience		PP
	Pump		Pp Sta
	Pumping Station		PW
	Place of Worship		Sewage Png Sta
	Pumping Station		SB, S Br
	Signal Box or Bridge		SP, SL
	Signal Post or Light		Spr
	Tank or Truck		Tk
	Trough		Tr
	Wind Pump		Wd Pp
	Works (building or area)		Wr Pt, W T
	Works (building or area)		Wks
	Works (building or area)		W

Historical Mapping Legends

Ordnance Survey Plan, Additional SIMs and Supply of Unpublished Survey Information 1:2,500 and 1:1,250

Symbol	Description	Symbol	Description
	Inactive Quarry, Chalk Pit or Clay Pit		Barracks
	Active Quarry, Chalk Pit or Clay Pit		Battery
	Rock		Cemery
	Boulders		Chymey
	Positioned Boulder		Cistern
	Non-Confiferous Tree (surveyed)		Disamtd Rly
	Non-Confiferous Trees (not surveyed)		El Gen Sta
	Orchard		El Sub Sta
	Coppice, Osler		Elctricity Sub Station
	Rough Grassland		Filter Bed
	Direction of water flow		Fountain/Drinking Fm.
	Electricity Transmission Line		Gas Valve Compound
	Bench Mark		GVC
	Roofed Building		MH
	Civil parish boundary		MP, MS
	District boundary		Pillar, Pole or Post
	County boundary		PO
	Boundary post/stone		PC
	Boundary mering symbol (note: these always appear in opposed pairs or groups of three)		PH
	Public Convenience		Pp
	Pump		Pp Sta
	Pumping Station		PW
	Place of Worship		Sewage Png Sta
	Pumping Station		SB, S Br
	Signal Box or Bridge		SP, SL
	Signal Post or Light		Spr
	Tank or Truck		Tk
	Trough		Tr
	Wind Pump		Wd Pp
	Works (building or area)		Wr Pt, W T
	Works (building or area)		Wks
	Works (building or area)		W

Ordnance Survey County Series and Ordnance Survey Plan 1:2,500

Symbol	Description	Symbol	Description
	Quarry		County Boundary (Geographical)
	Gravel Pit		County & Civil Parish Boundary
	Shingle		Administrative County & Civil Parish Boundary
	Refusa Heap		County Borough Boundary (England)
	Flat Rock		County Burch Boundary (Scotland)
	Sloping Masonry		Boundary Post or Stone
	Marsh		Capstan, Crane
	Reeds		Chymey
	Furze		Cistern
	Wood		Disamtd Rly
	Orchard		El Gen Sta
	Stepping Stones		El Sub Sta
	Look		Elctricity Sub Station
	Triq. Station		Filter Bed
	Bench Mark		Fountain/Drinking Fm.
	Surface Level		Gas Valve Compound
	Antiquities (site of)		GVC
	Cutting		MH
	Embankment		MP, MS
	Road crossing railway		Pillar, Pole or Post
	Level Crossing		PO
	Road over River or Canal		PC
	Road over single stream		PH
	Road over River or Canal		Pp
	Road over River or Canal		Pp Sta
	Road over River or Canal		PW
	Road over River or Canal		Sewage Png Sta
	Road over River or Canal		SB, S Br
	Road over River or Canal		SP, SL
	Road over River or Canal		Spr
	Road over River or Canal		Tk
	Road over River or Canal		Tr
	Road over River or Canal		Wd Pp
	Road over River or Canal		Wr Pt, W T
	Road over River or Canal		Wks
	Road over River or Canal		W

Historical Map - Segment A13



Order Details

Order Number: 26815318_1_1
 Customer Ref: J-S0099
 National Grid Reference: 425250, 403260
 Site: A
 Site Area (Ha): 1.7
 Search Buffer (m): 100

Site Details

Sheffield Road, Penistone, SHEFFIELD



Tel: 0844 844 9952
 Fax: 0844 844 9951
 Web: www.envirocheck.co.uk

Yorkshire

Published 1893

Source map scale - 1:2,500

The historical maps shown were reproduced from maps predominantly held at the scale adopted for England, Wales and Scotland in the 1940's. In 1884 the 1:2,500 scale was adopted for mapping urban areas, and by 1886 it covered the whole of what were considered to be the cultivated parts of Great Britain. The publication year below is often some years later than the surveyed date. Before 1938, all OS maps were based on the Cassini Projection, with modern surveys of a single county or group of counties, giving rise to significant inaccuracies in outlying areas.

Map Name(s) and Date(s)

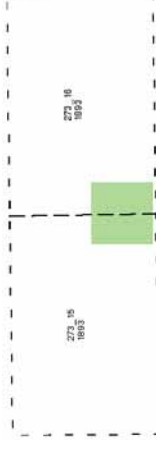

Historical Map - Segment A13

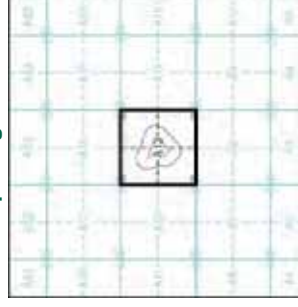

Order Details

Order Number: 26815318_1_1
 Customer Ref: J-S0099
 National Grid Reference: 425250, 403260
 Slice: A
 Site Area (Ha): 1.7
 Search Buffer (m): 100

Site Details

Sheffield Road, Penistone, SHEFFIELD

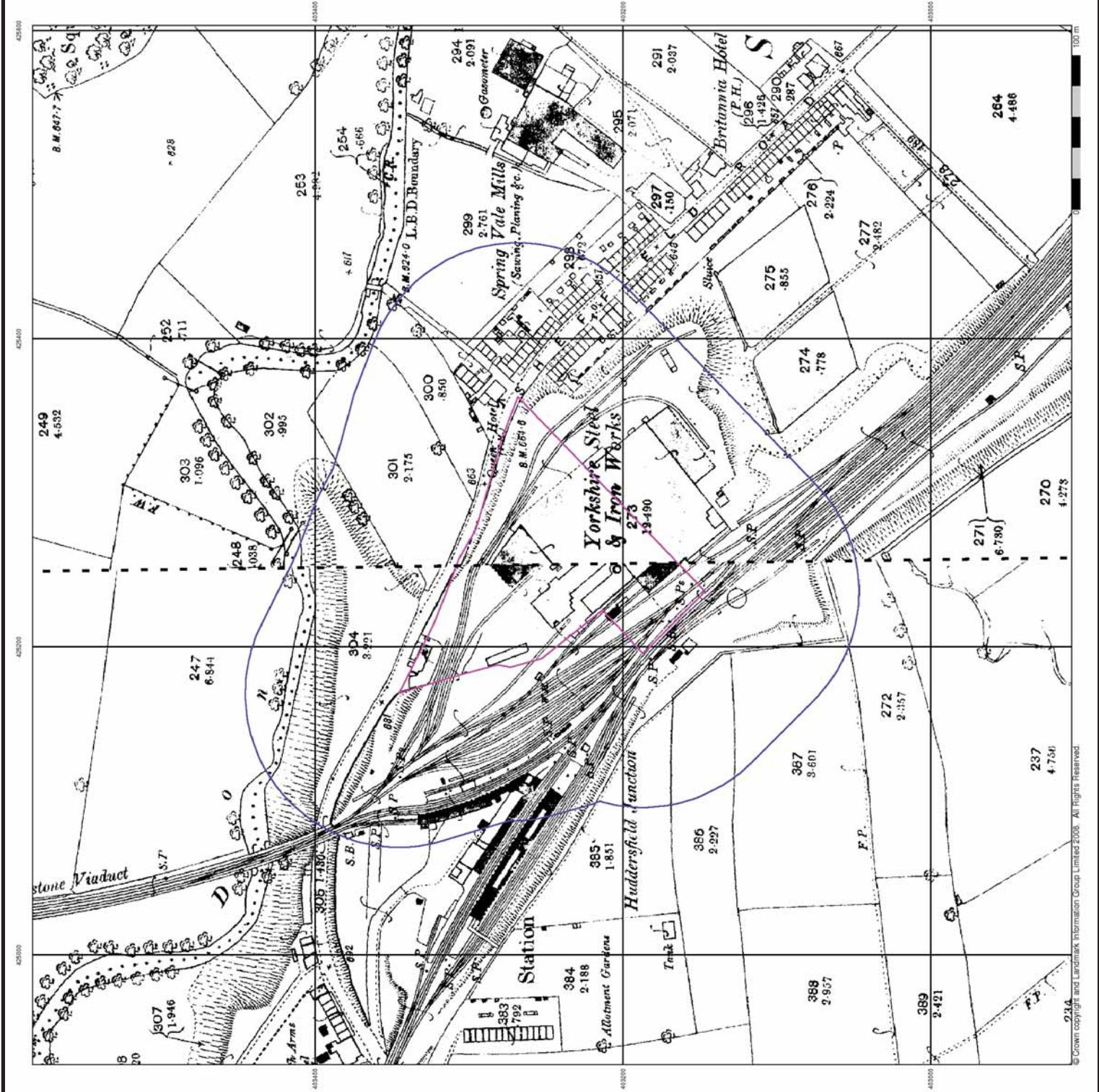

**Yorkshire
Published 1906**

Source map scale - 1:2,500

The historical maps shown were reproduced from maps predominantly held at the scale adopted for England, Wales and Scotland in the 1940's. In 1984 the 1:2,500 scale was adopted for mapping urban areas, and by 1986 it covered the whole of what were considered to be the cultivated parts of Great Britain. The published maps shown below is often some years later than the surveyed data. Before 1938, all OS maps were based on the Cassini Projection, with modern surveys of a single county or group of counties, giving rise to significant inaccuracies in outlying areas.

Map Name(s) and Date(s)

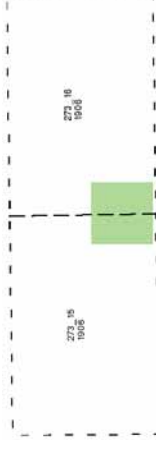

Historical Map - Segment A13

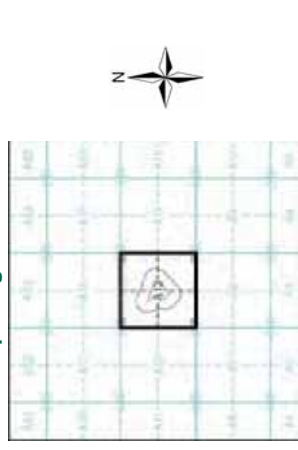

Order Details

Order Number: 26815318_1_1
Customer Ref: J-S0099
National Grid Reference: 425250, 403260
Slice: A
Site Area (Ha): 1.7
Search Buffer (m): 100

Site Details

Sheffield Road, Penistone, SHEFFIELD

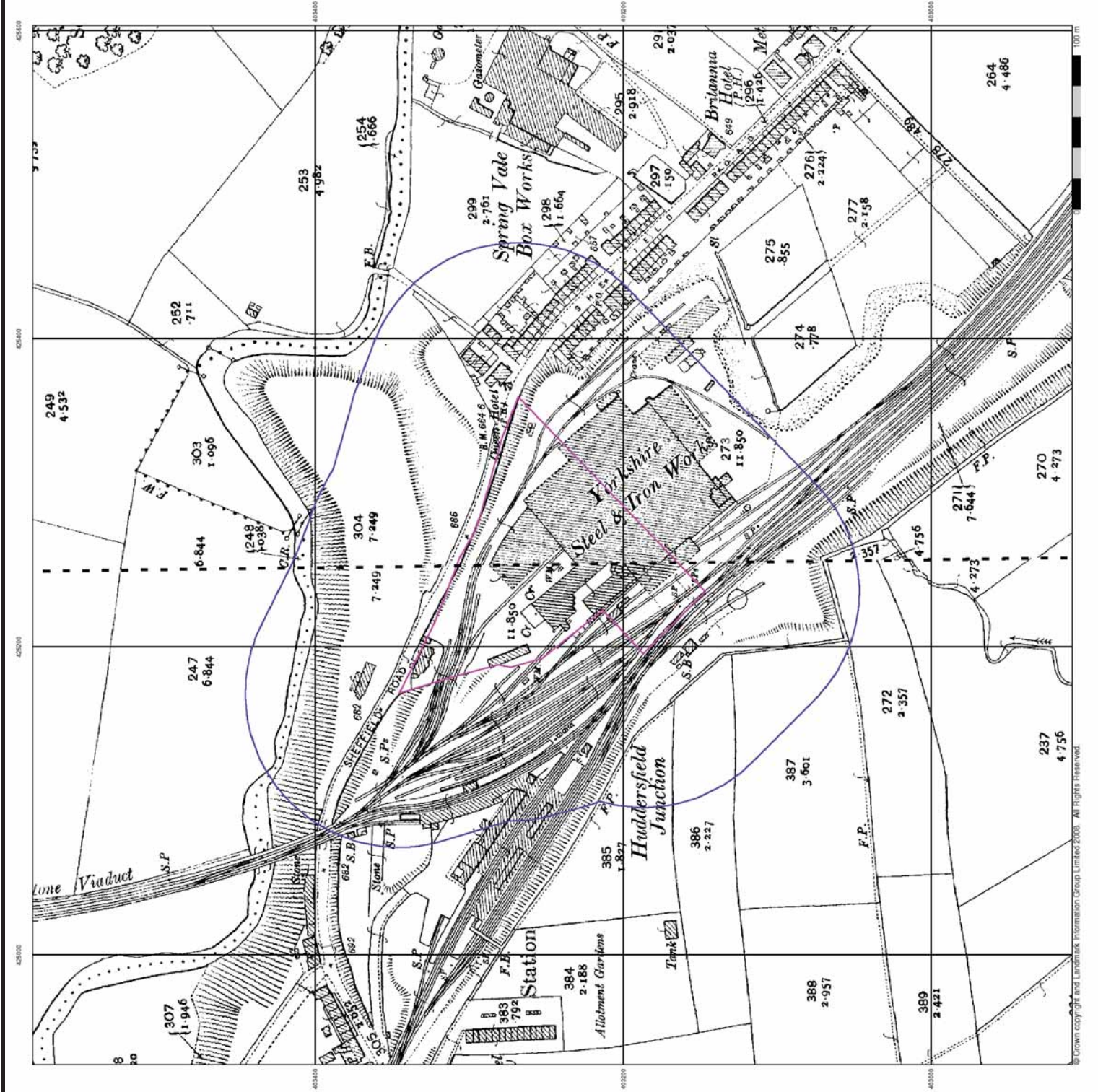

© Crown copyright and Landmark Information Group Limited 2008. All Rights Reserved.

**Yorkshire
Published 1931**

Source map scale - 1:2,500

The historical maps shown were reproduced from maps predominantly held at the scale adopted for England, Wales and Scotland in the 1940's. In 1884 the 1:2,500 scale was adopted for mapping urban areas, and by 1886 it covered the whole of what were considered to be the cultivated parts of Great Britain. The publication year below is often some years later than the surveyed date. Before 1938, all OS maps were based on the Cassini Projection, with modern surveys of a single county or group of counties, giving rise to significant inaccuracies in outlying areas.

Map Name(s) and Date(s)

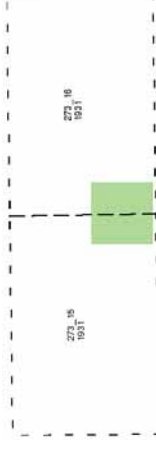

Historical Map - Segment A13

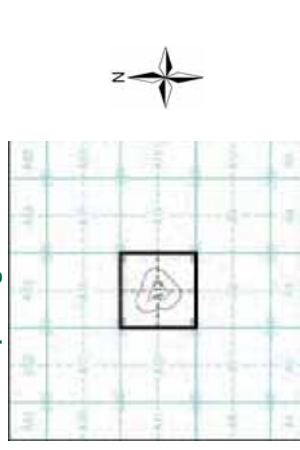

Order Details

Order Number: 26815318_1_1
Customer Ref: J-S0099
National Grid Reference: 425250, 403260
Slice: A
Site Area (Ha): 1.7
Search Buffer (m): 100

Site Details

Sheffield Road, Penistone, SHEFFIELD

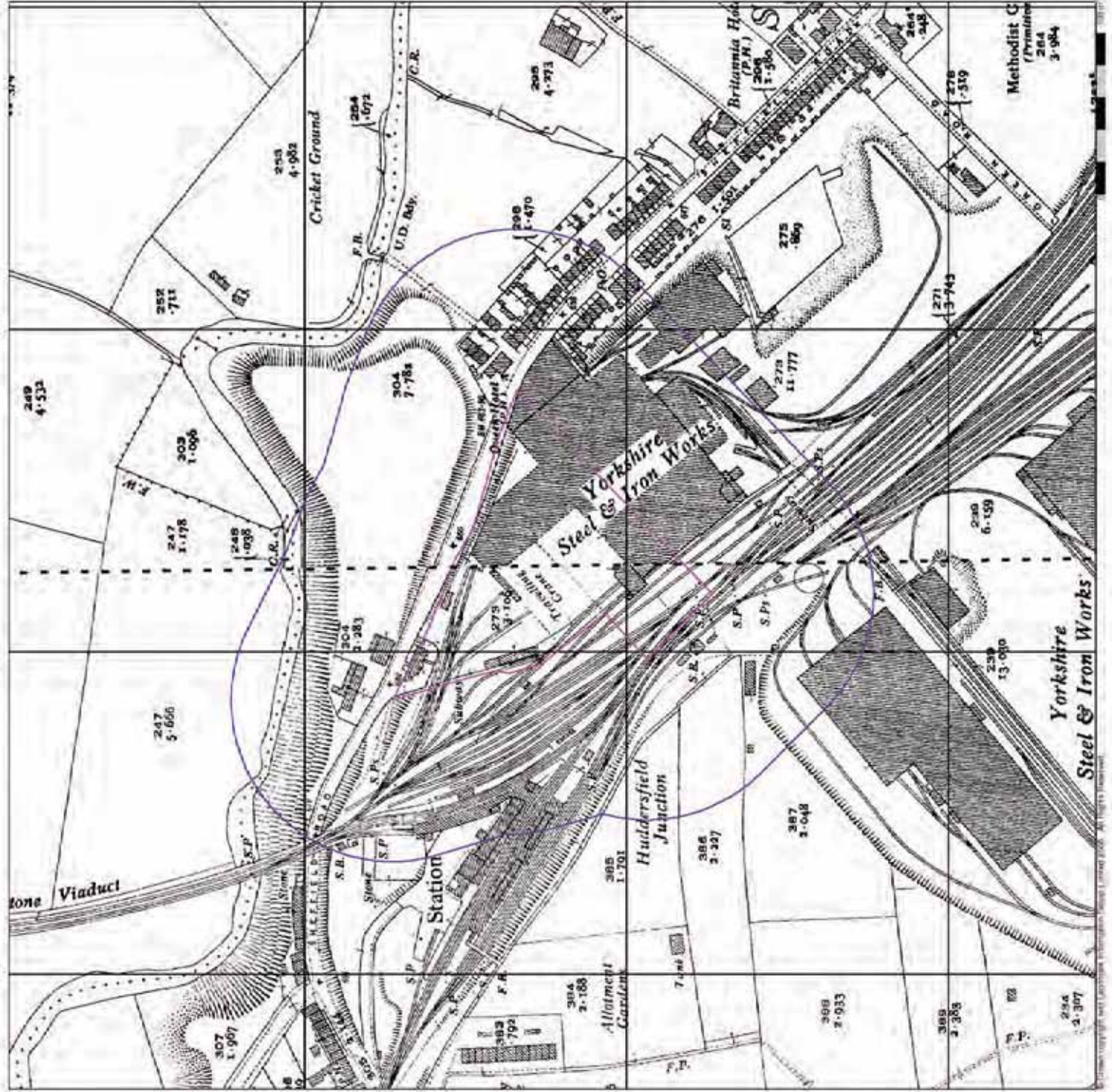

Ordnance Survey Plan

Published 1960

Source map scale - 1:2,500

The historical maps shown were reproduced from maps predominantly held at the scale adopted for England, Wales and Scotland in the 1940's. In 1954 the 1:2,500 scale was adopted for mapping urban areas, and by 1956 it covered the whole of what were considered to be the cultivated parts of Great Britain. The publication grid below is given some years later than the surveyed data. Before 1938, all OS maps were based on the Cassini Projection, with modern surveys of a single county or group of counties, giving rise to significant inaccuracies in outlying areas.

Map Name(s) and Date(s)

SE2403 1960	SE2003 1960
SE2402 1960	SE2502 1960

Historical Map - Segment A13

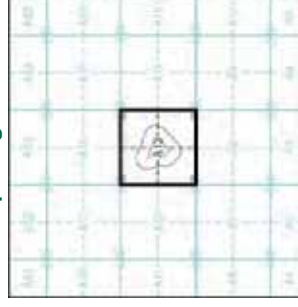

Order Details

Order Number: 26815318_1_1
 Customer Ref: J-S0099
 National Grid Reference: 425250, 403260
 Slice: A
 Site Area (Ha): 1.7
 Search Buffer (m): 100

Site Details

Sheffield Road, Penistone, SHEFFIELD

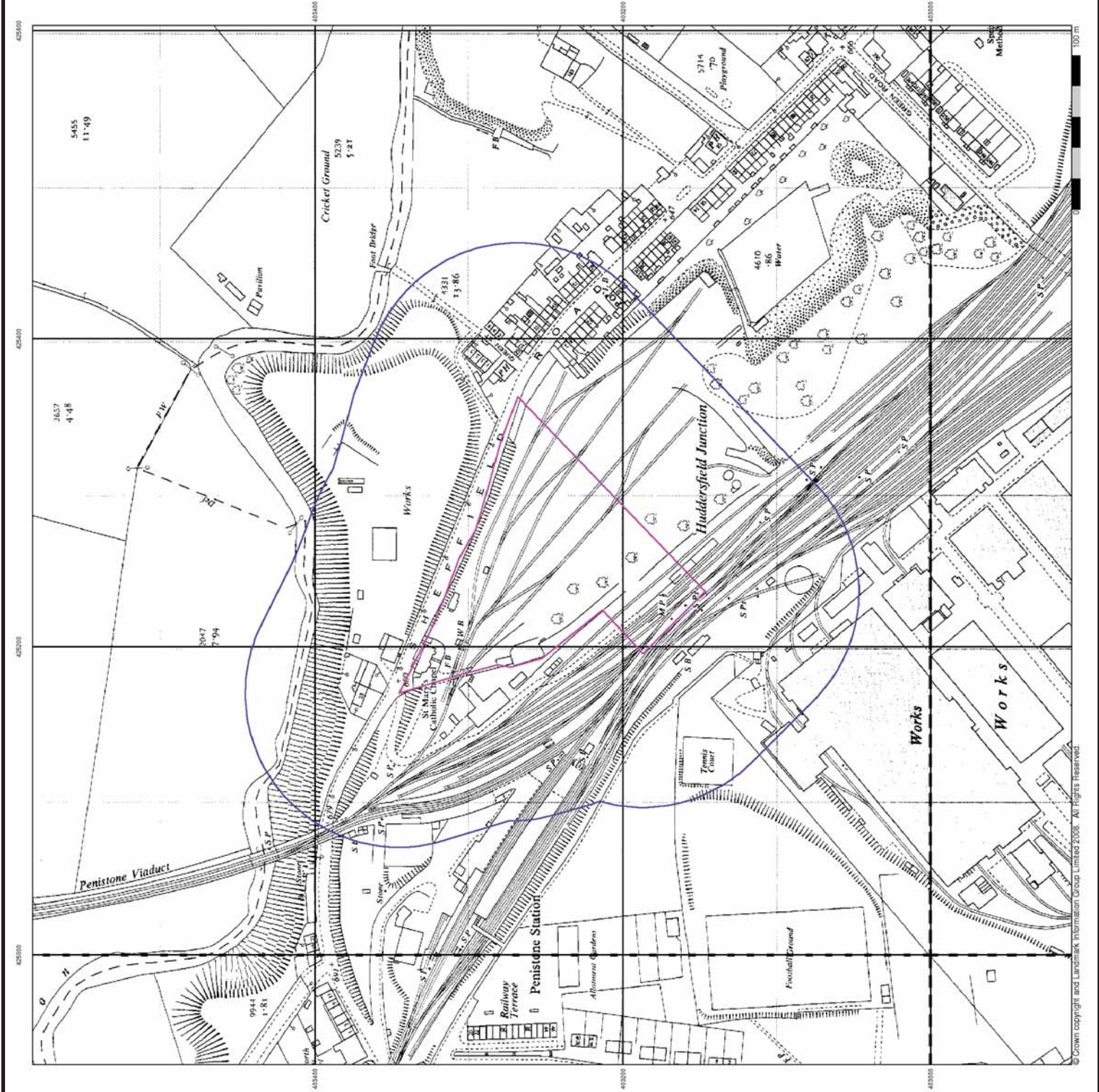

**Ordnance Survey Plan
Published 1968 - 1971**

Source map scale - 1:2,500

The historical maps shown were reproduced from maps predominantly held at the scale adopted for England, Wales and Scotland in the 1940's. In 1954 the 1:2,500 scale was adopted for mapping urban areas, and by 1956 it covered the whole of what were considered to be the cultivated parts of Great Britain. The publication date below is often some years later than the surveyed date. Before 1938, all OS maps were based on the Cassini Projection, with modern surveys of a single county or group of counties, giving rise to significant inaccuracies in outlying areas.

Map Name(s) and Date(s)

SE2403 1968	SE2403 1968
SE2402 1971	SE2402 1971

Historical Map - Segment A13

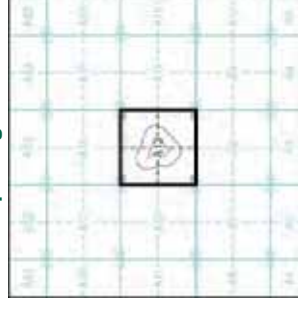

Order Details

Order Number: 26815318_1_1
 Customer Ref: J-S0099
 National Grid Reference: 425250, 403260
 Slice: A
 Site Area (Ha): 1.7
 Search Buffer (m): 100

Site Details

Sheffield Road, Penistone, SHEFFIELD

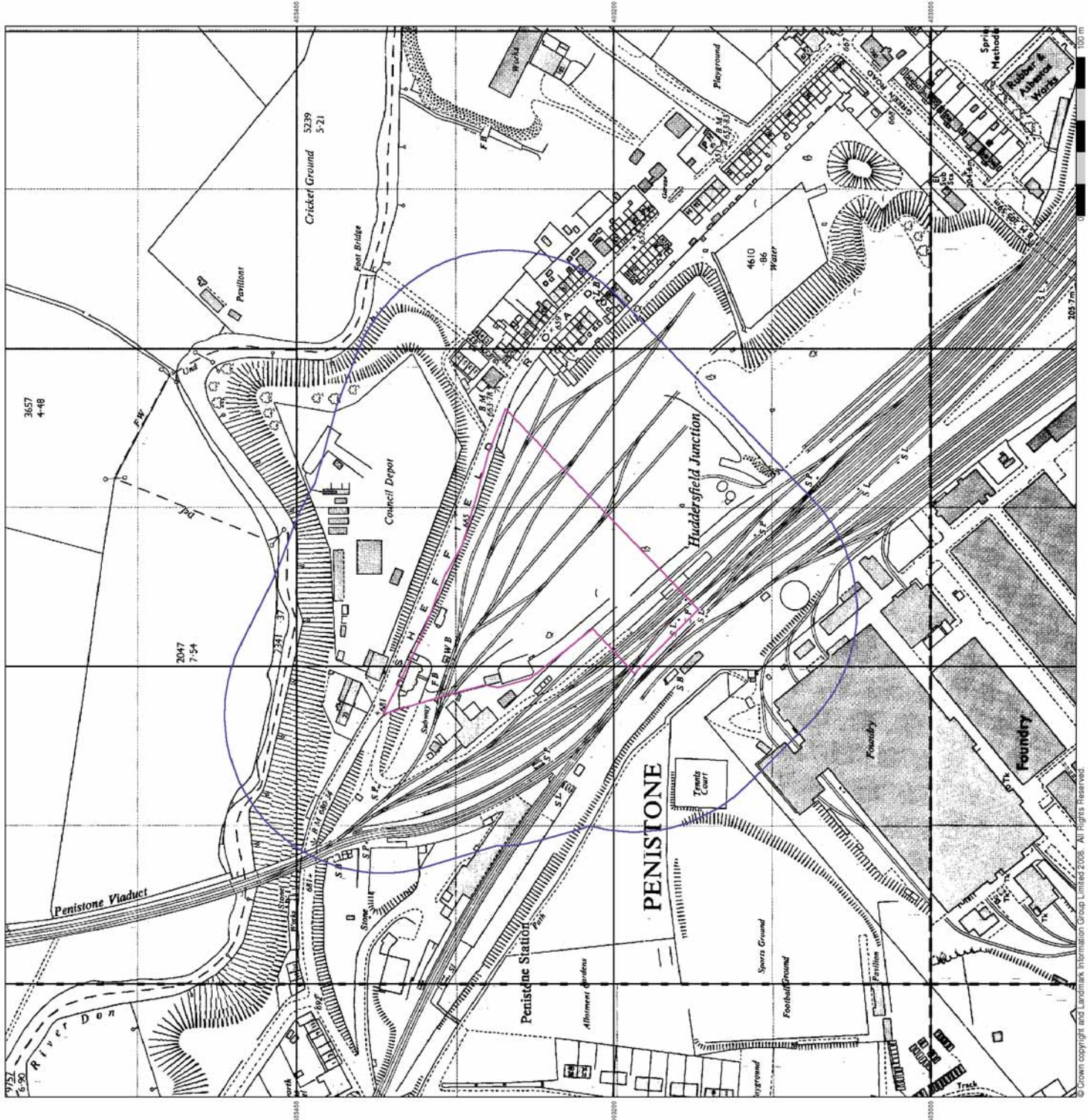

© Crown copyright and Landmark Information Group Limited 2008. All Rights Reserved.

Additional SIMs

Published 1978 - 1988

Source map scale - 1:2,500

The SIM cards (Ordnance Survey's 'Survey of Information on Microfilm') are further, minor editions of mapping which were produced and published in between the main editions as an area was updated. They date from 1947 to 1994, and contain detailed information on buildings, roads and land-use. These maps were produced at both 1:2,500 and 1:1,250 scales.

Map Name(s) and Date(s)

SE2403	1978	SE2403	1988
[Green shaded area]		[Green shaded area]	
SE2402	1978	SE2402	1988

Historical Map - Segment A13

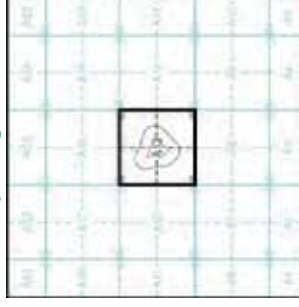

Order Details

Order Number: 26815318_1_1
 Customer Ref: J-S0099
 National Grid Reference: 425250, 403260
 Slice: A
 Site Area (Ha): 1.7
 Search Buffer (m): 100

Site Details

Sheffield Road, Penistone, SHEFFIELD

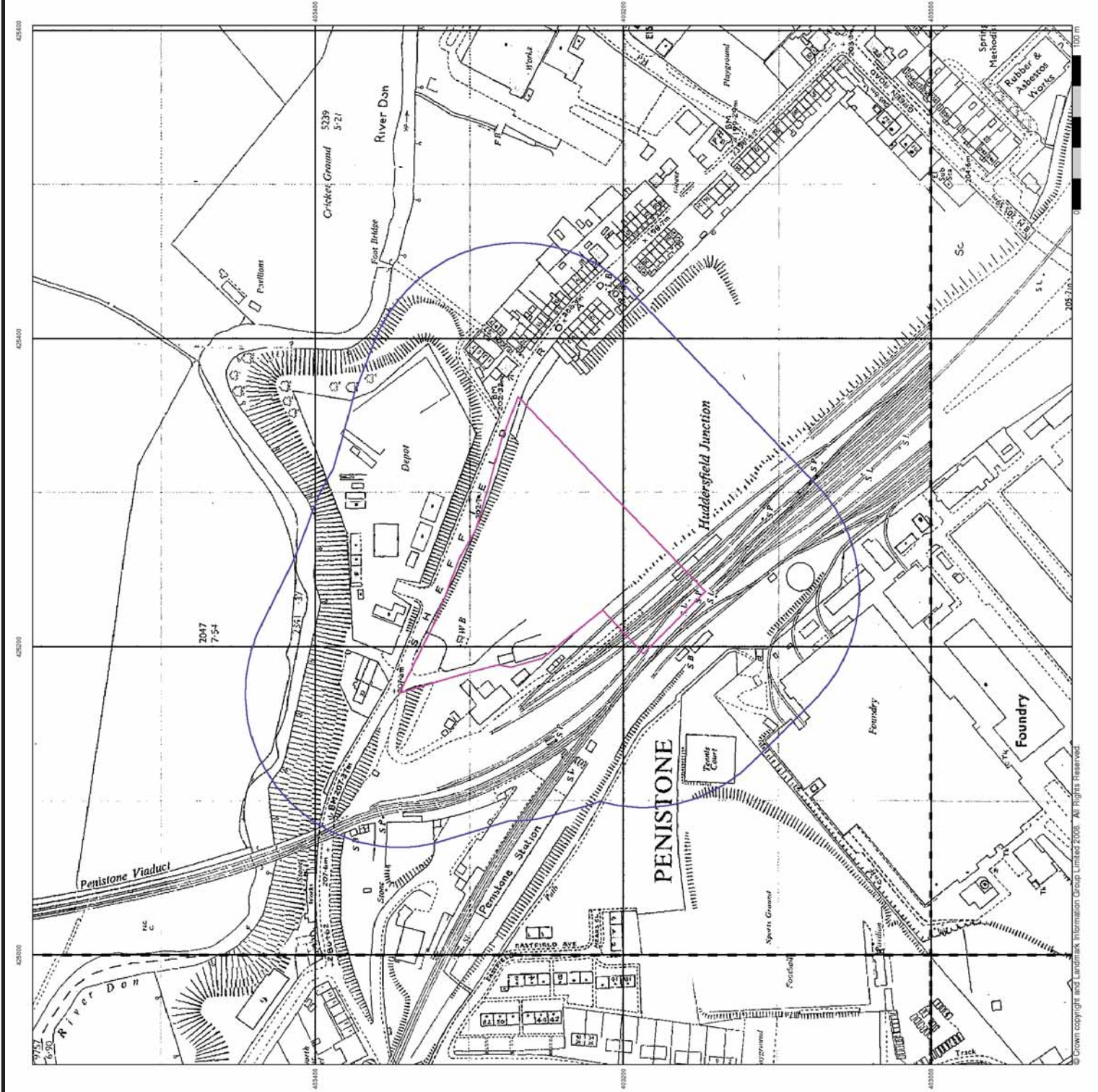

© Crown copyright and Landmark Information Group Limited 2008. All Rights Reserved.

Additional SIMs

Published 1979 - 1980

Source map scale - 1:2,500

The SIM cards (Ordnance Survey's 'Survey of Information on Microfilm') are further, minor editions of mapping which were produced and published in between the main editions as an area was updated. They date from 1947 to 1994, and contain detailed information on buildings, roads and land-use. These maps were produced at both 1:2,500 and 1:1,250 scales.

Map Name(s) and Date(s)

SE2409	1980
SE2402	1979

Historical Map - Segment A13

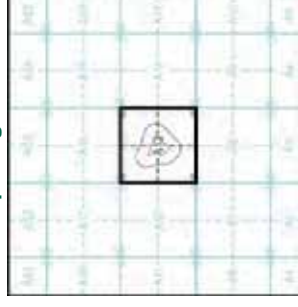

Order Details

Order Number: 26815318_1_1
 Customer Ref: J-S0099
 National Grid Reference: 425250, 403260
 Slice: A
 Site Area (Ha): 1.7
 Search Buffer (m): 100

Site Details

Sheffield Road, Penistone, SHEFFIELD

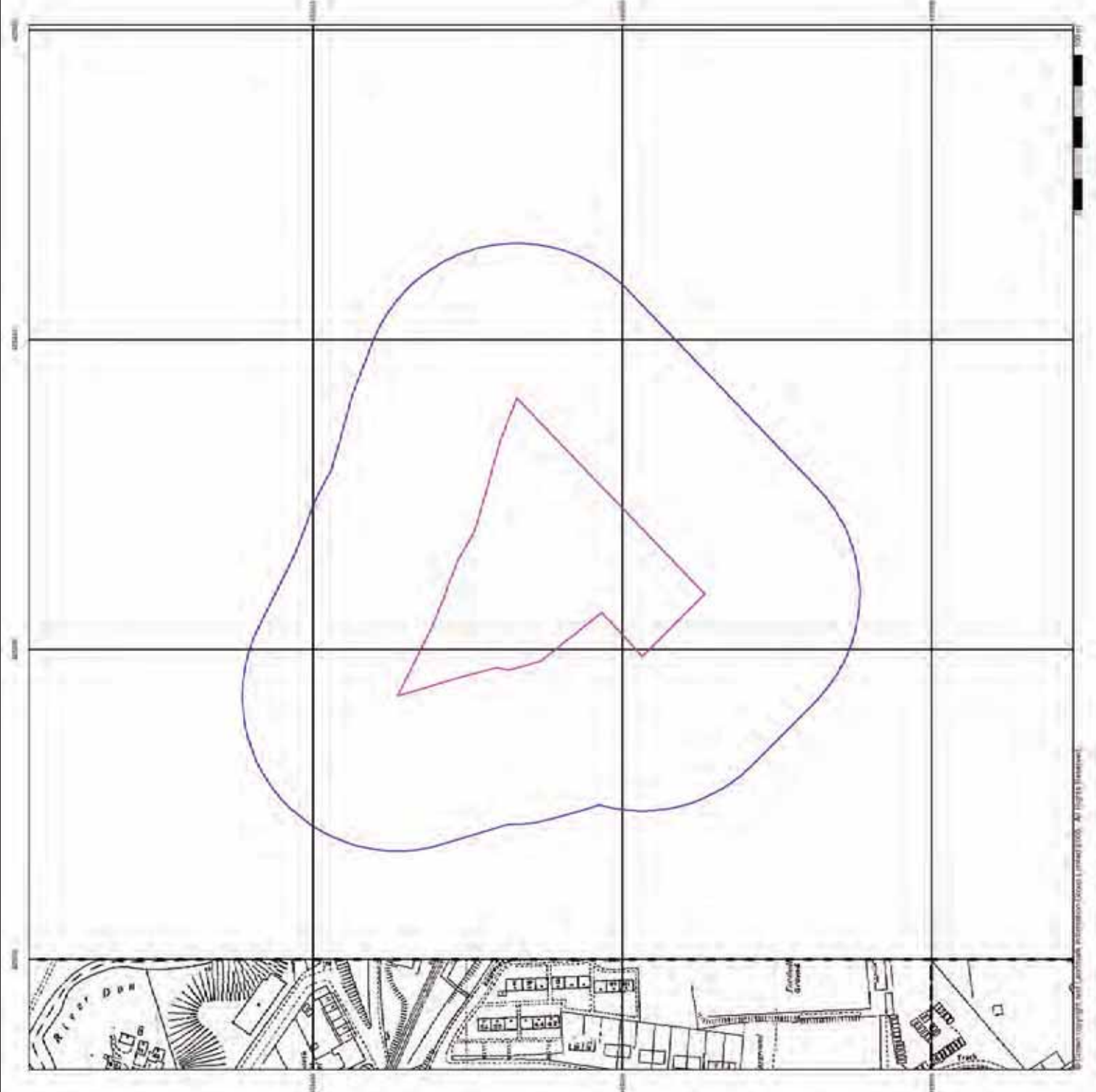

© Crown Copyright and Geomatics Information Group Limited (2008). All Rights Reserved.

Additional SIMs

Published 1981 - 1986

Source map scale - 1:2,500

The SIM cards (Ordnance Survey's 'Survey of Information on Microfilm') are further, minor editions of mapping which were produced and published in between the main editions as an area was updated. They date from 1947 to 1994, and contain detailed information on buildings, roads and land-use. These maps were produced at both 1:2,500 and 1:1,250 scales.

Map Name(s) and Date(s)

SE2409	1981
SE2402	1986

Historical Map - Segment A13

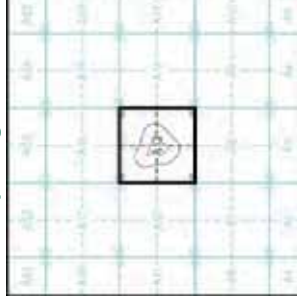

Order Details

Order Number: 26815318_1_1
 Customer Ref: J-S0099
 National Grid Reference: 425250, 403260
 Slice: A
 Site Area (Ha): 1.7
 Search Buffer (m): 100

Site Details

Sheffield Road, Penistone, SHEFFIELD

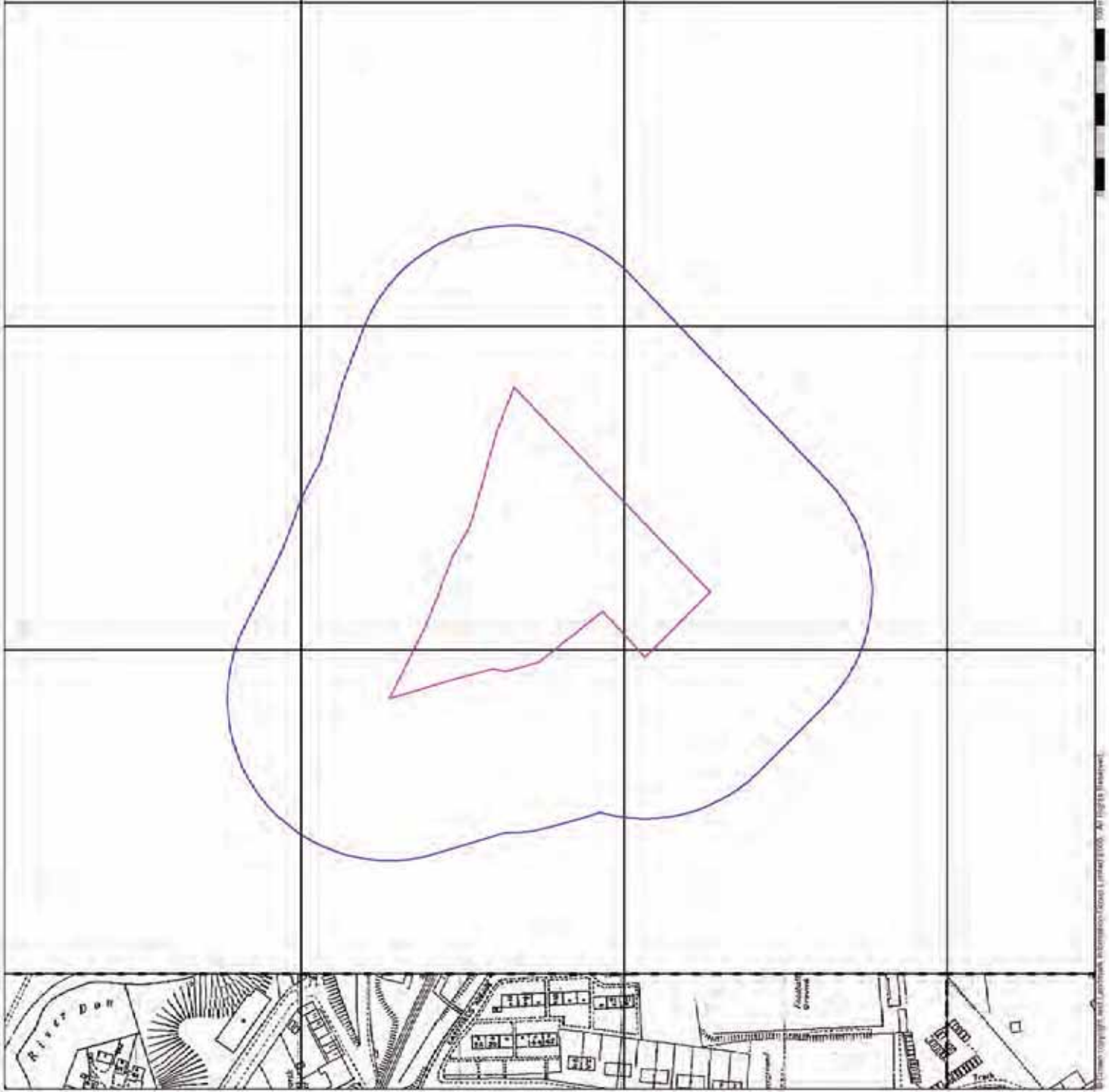

Additional SIMs

Published 1983 - 1988

Source map scale - 1:2,500

The SIM cards (Ordnance Survey's 'Survey of Information on Microfilm') are further, minor editions of mapping which were produced and published in between the main editions as an area was updated. They date from 1947 to 1994, and contain detailed information on buildings, roads and land-use. These maps were produced at both 1:2,500 and 1:1,250 scales.

Map Name(s) and Date(s)

SE2409	1983
SE2402	1988

Historical Map - Segment A13

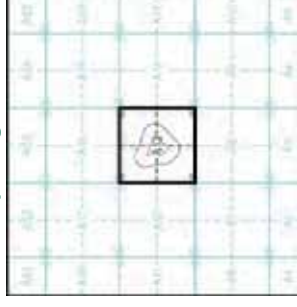

Order Details

Order Number: 26815318_1_1
 Customer Ref: J-S0099
 National Grid Reference: 425250, 403260
 Slice: A
 Site Area (Ha): 1.7
 Search Buffer (m): 100

Site Details

Sheffield Road, Penistone, SHEFFIELD

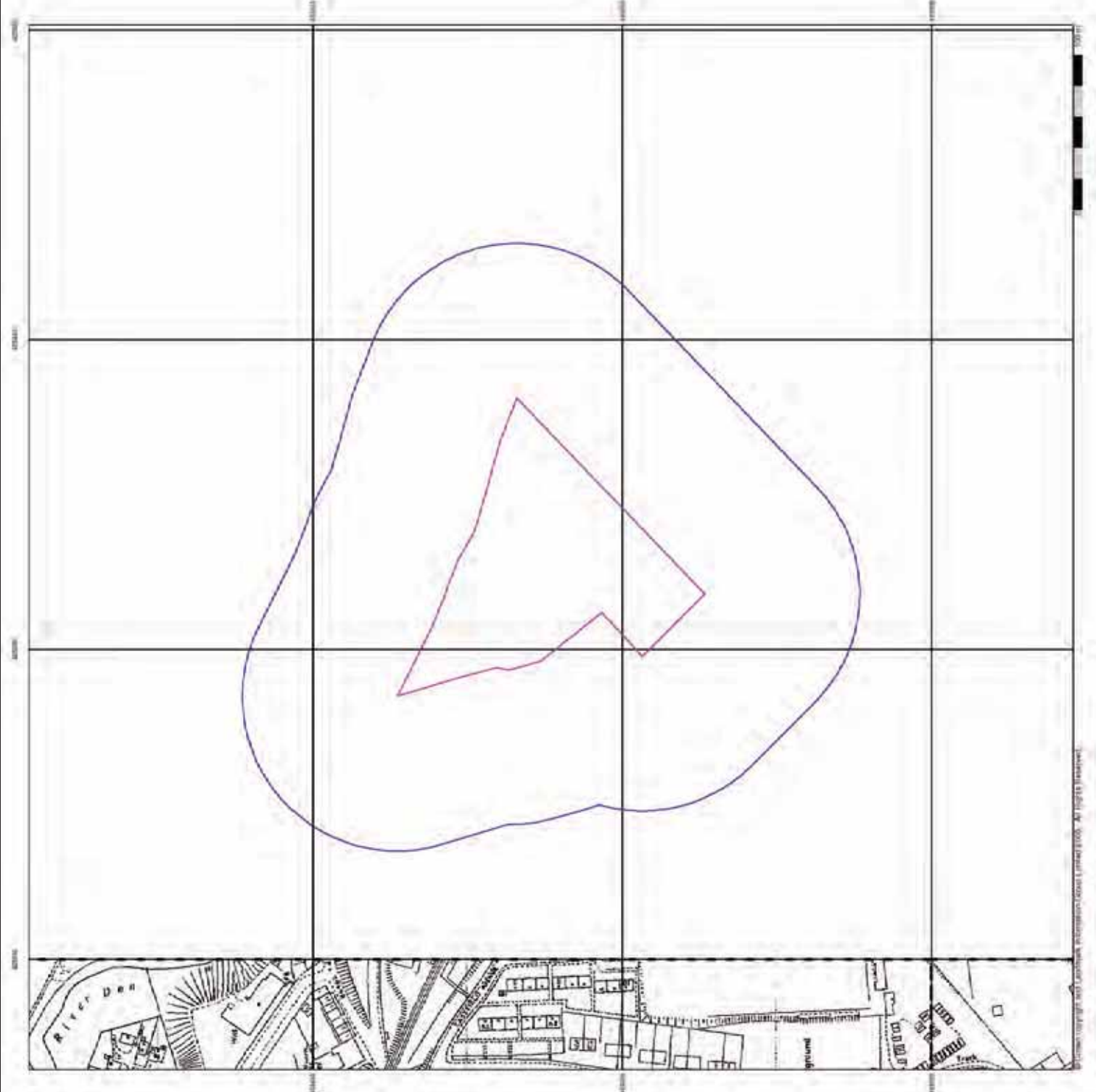

© Crown Copyright and Database Right. Ordnance Survey (printed) 1000. All Rights Reserved.

Ordnance Survey Plan Published 1985

Source map scale - 1:2,500

The historical maps shown were reproduced from maps predominantly held at the scale adopted for England, Wales and Scotland in the 1940's. In 1984 the 1:2,500 scale was adopted for mapping urban areas, and by 1986 it covered the whole of what were considered to be the cultivated parts of Great Britain. The publications shown below is often some years later than the surveyed data. Before 1988, all OS maps were based on the Cassini Projection, with modern surveys of a single county or group of counties, giving rise to significant inaccuracies in outlying areas.

Map Name(s) and Date(s)

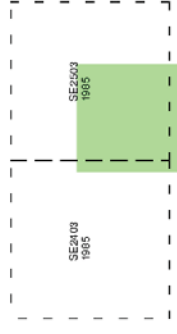

Historical Map - Segment A13

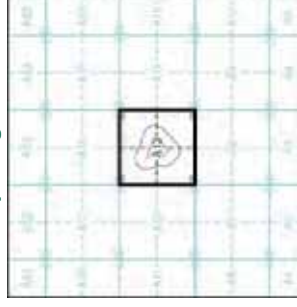

Order Details

Order Number: 26815318_1_1
 Customer Ref: J-S0099
 National Grid Reference: 425250, 403260
 Slice: A
 Site Area (Ha): 1.7
 Search Buffer (m): 100

Site Details

Sheffield Road, Penistone, SHEFFIELD

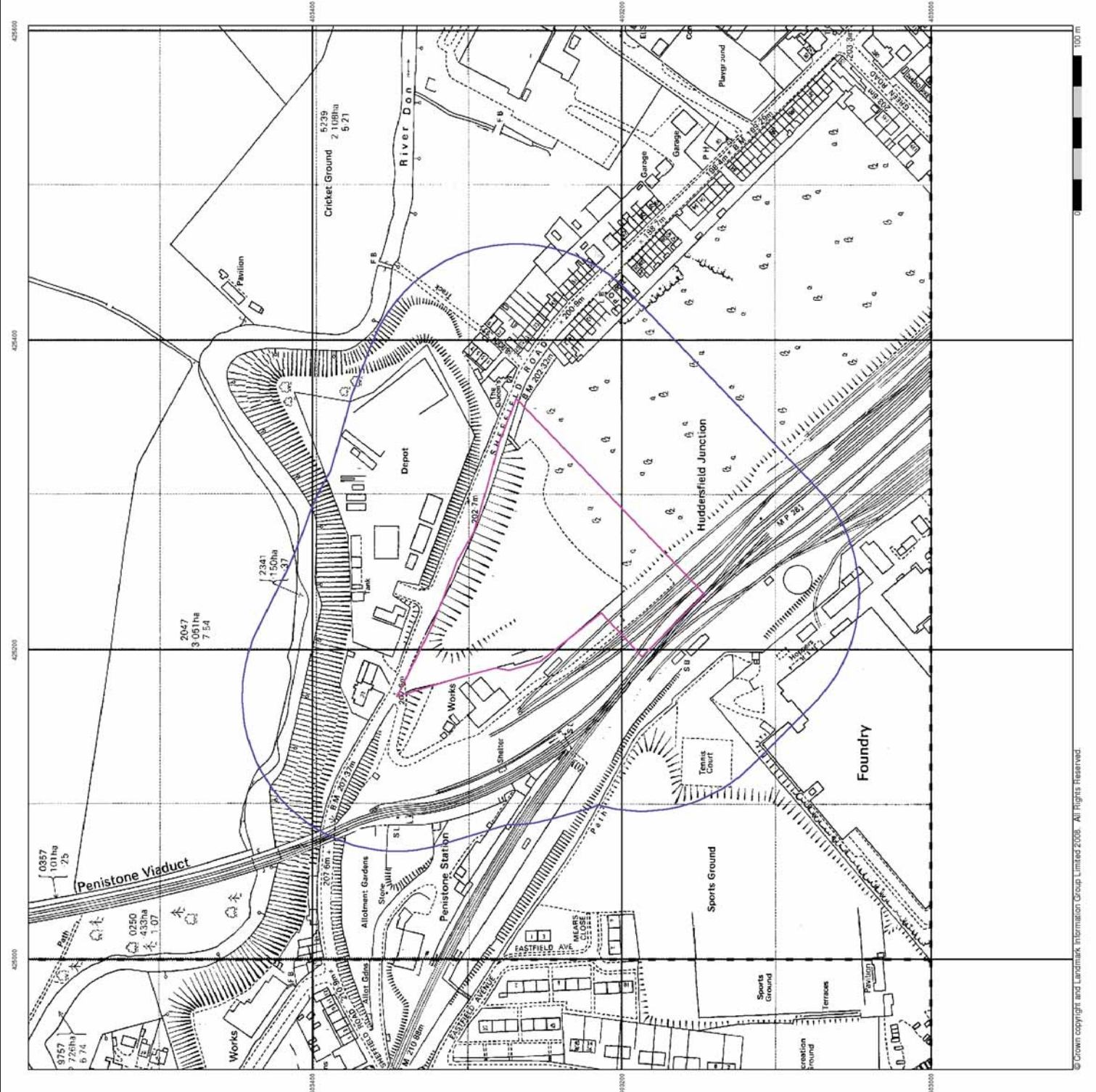

Large-Scale National Grid Data

Published 1992 - 1993

Source map scale - 1:2,500

Large Scale National Grid Data: superseded SIM cards (Ordnance Survey's Survey of Information on Microfilm) in 1992, and continued to be produced until 1993. These maps were the forerunners of digital mapping and so provide detailed information on houses and roads, but tend to show less topographic features such as vegetation. These maps were produced at both 1:2,500 and 1:1,250 scales.

Map Name(s) and Date(s)

SE2403 1992	SE2503 1993
SE2402 1992	SE2502 1993

Historical Map - Segment A13

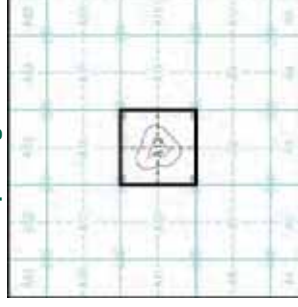

Order Details

Order Number: 26815318_1_1
Customer Ref: J-S0099
National Grid Reference: 425250, 403260
Slice: A
Site Area (Ha): 1.7
Search Buffer (m): 100

Site Details

Sheffield Road, Penistone, SHEFFIELD

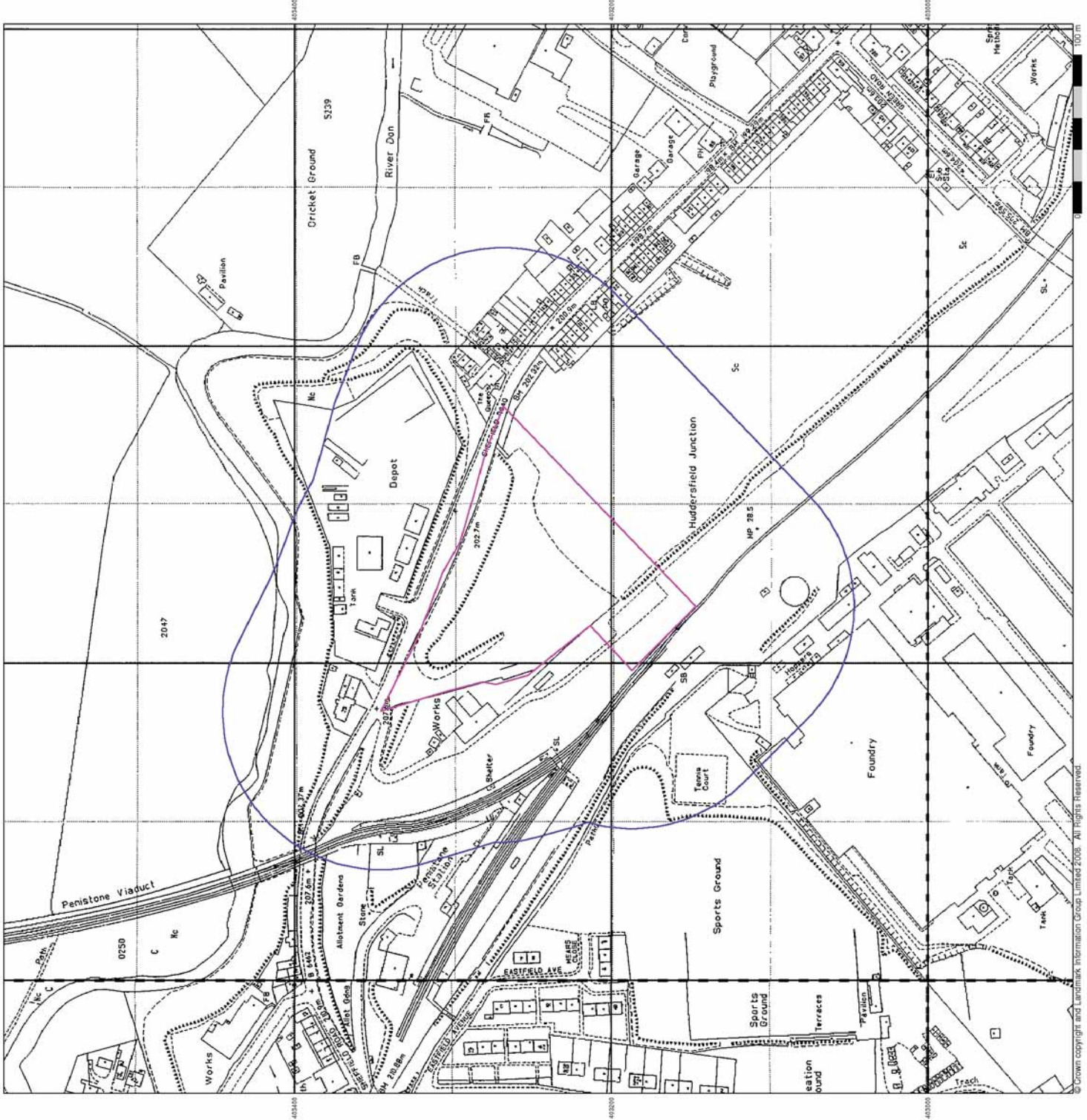

**Large-Scale National Grid Data
Published 1996**

Source map scale - 1:2,500

Large Scale National Grid Data: superseded SIM cards (Ordnance Survey's Survey of Information on Microfilm) in 1992, and continued to be produced until 1999. These maps were the forerunners of digital mapping and so provide detailed information on houses and roads, but tend to show less topographic features such as vegetation. These maps were produced at both 1:2,500 and 1:1,250 scales.

Map Name(s) and Date(s)

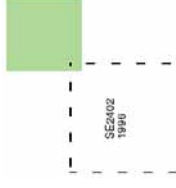

Historical Map - Segment A13

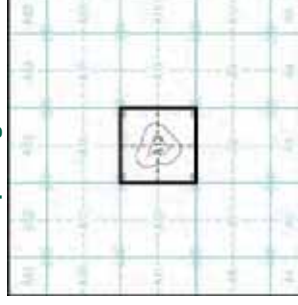

Order Details

Order Number: 26815318_1_1
 Customer Ref: J-S0099
 National Grid Reference: 425250, 403260
 Slice: A
 Site Area (Ha): 1.7
 Search Buffer (m): 100

Site Details

Sheffield Road, Penistone, SHEFFIELD

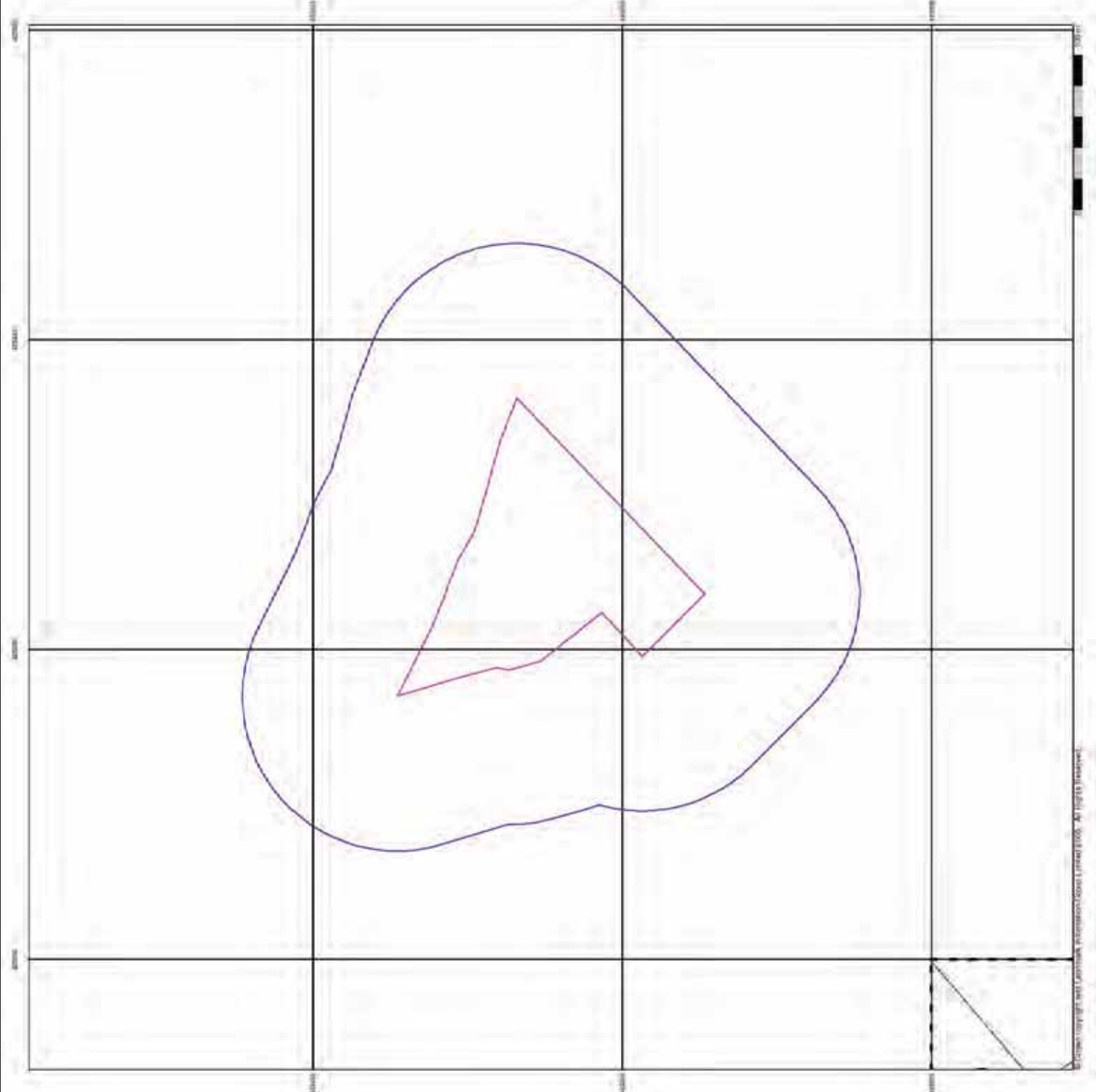

Historical Mapping Legends

Ordnance Survey County Series and Ordnance Survey Plan 1:10,560

Gravel Pit	Sand Pit	Shingle	Reeds	Deciduous	Furze	Rough Pasture	Trigonometrical Station	Bench Mark	Well, Spring, Boundary Post	Surface Level	Sketched Contour	Main Roads	Minor Roads	Sunken Road	Road over Railway	Railway over Road	Road over River or Canal	Road over Stream	County Boundary (Geographical)	County & Civil Parish Boundary	Administrative County & Civil Parish Boundary	County Borough Boundary (England)	County Borough Boundary (Scotland)	Rural District Boundary	Civil Parish Boundary

Ordnance Survey Plan 1:10,000

Chalk Pit, Clay Pit or Quarry	Sand Pit	Refuse or Slag Heap	Dunes	Coniferous Trees	Orchard	Bracken	Marsh	Building	Glasshouse	Sloping Masonry	Pylon	Electricity Transmission Line	Culting	Standard Gauge Multiple Track	Standard Gauge Single Track	Sliding, Tramway or Mineral Line	Narrow Gauge	Geographical County	Administrative County, County Borough or County of City	Municipal Borough, Urban or Rural District, Borough, Burgh or County Constabulary	Civil Parish	Boundary Post or Stone	Church	Club House	Fire Engine Station	Foot Bridge	Fountain	Guide Post	Mile Post	Police Station	Post Office	Public Convenience	Public House	Signal Box	Spring	Telephone Call Box	Telephone Call Post	Well

1:10,000 Raster Mapping

Gravel Pit	Rock	Boulders	Shingle	Sand	Slopes	General detail	Overhead detail	Multi-track railway	Single track railway	Civil, parish or community boundary	District, Unitary, Metropolitan, London Borough boundary	County boundary (England only)	Area of wooded vegetation	Non-coniferous trees (scattered)	Coniferous trees (scattered)	Orchard	Rough Grassland	Scrub	Water feature	Mean High water (springs)	Telephone line (where shown)	Bench mark (where shown)	Point feature (e.g. Guide Post or Mile Stone)	Site of (antiquity)	General Building

Mapping Type	Scale	Date	Eq.
Yorkshire	1:10,560	1851 - 1855	2
Yorkshire	1:10,560	1894	3
Yorkshire	1:10,560	1906 - 1907	4
Yorkshire	1:10,560	1938 - 1948	5
Ordnance Survey Plan	1:10,560	1955	6
Ordnance Survey Plan	1:10,560	1965 - 1967	7
Ordnance Survey Plan	1:10,000	1989	8
10K Raster Mapping	1:10,000	2000	9
10K Raster Mapping	1:10,000	2008	10

Historical Mapping & Photography included:



Historical Map - Slice A

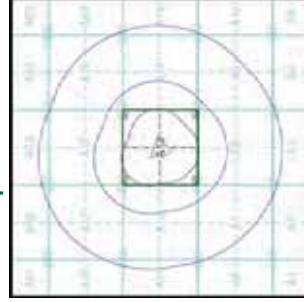

Order Details

Order Number: 26815318_1_1
 Customer Ref: J-S0099
 National Grid Reference: 425250, 403260
 Slice: A
 Site Area (Ha): 1.7
 Search Buffer (m): 1000

Site Details

Sheffield Road, Penistone, SHEFFIELD



Tel: 0844 844 9852
 Fax: 0844 844 9951
 Web: www.envirocheck.co.uk

Yorkshire

Published 1851 - 1855

Source map scale - 1:10,560

The historical maps shown were reproduced from maps predominantly held at the scale adopted for England, Wales and Scotland in the 1840's. In 1854 the 1:2,500 scale was adopted for mapping urban areas, these maps were used to update the 1:10,560 maps. The published data given therefore is often some years later than the surveyed date. Before 1856, all OS maps were based on the Cassini Projection, with dependent surveys of a single county or group of counties. From 1856, the Ordnance Survey was reduced to a single map of the United Kingdom. The 1851 Ordnance Survey was produced with all military camps and other strategic sites removed. These maps were initially overprinted with the National Grid. In 1970, the first 1:10,000 maps were produced using the Transverse Mercator Projection. The revision process continued until recently, with new editions appearing every 10 years or so for urban areas.

Map Name(s) and Date(s)

273_00	1851
281_00	1855

Historical Map - Slice A

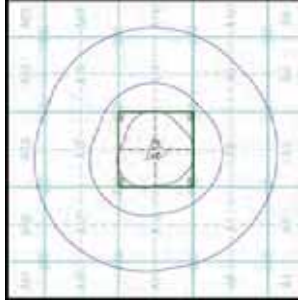

Order Details

Order Number: 26815318_1_1
 Customer Ref: J-S0099
 National Grid Reference: 425250, 403260
 Slice: A
 Site Area (Ha): 1.7
 Search Buffer (m): 1000

Site Details

Sheffield Road, Penistone, SHEFFIELD

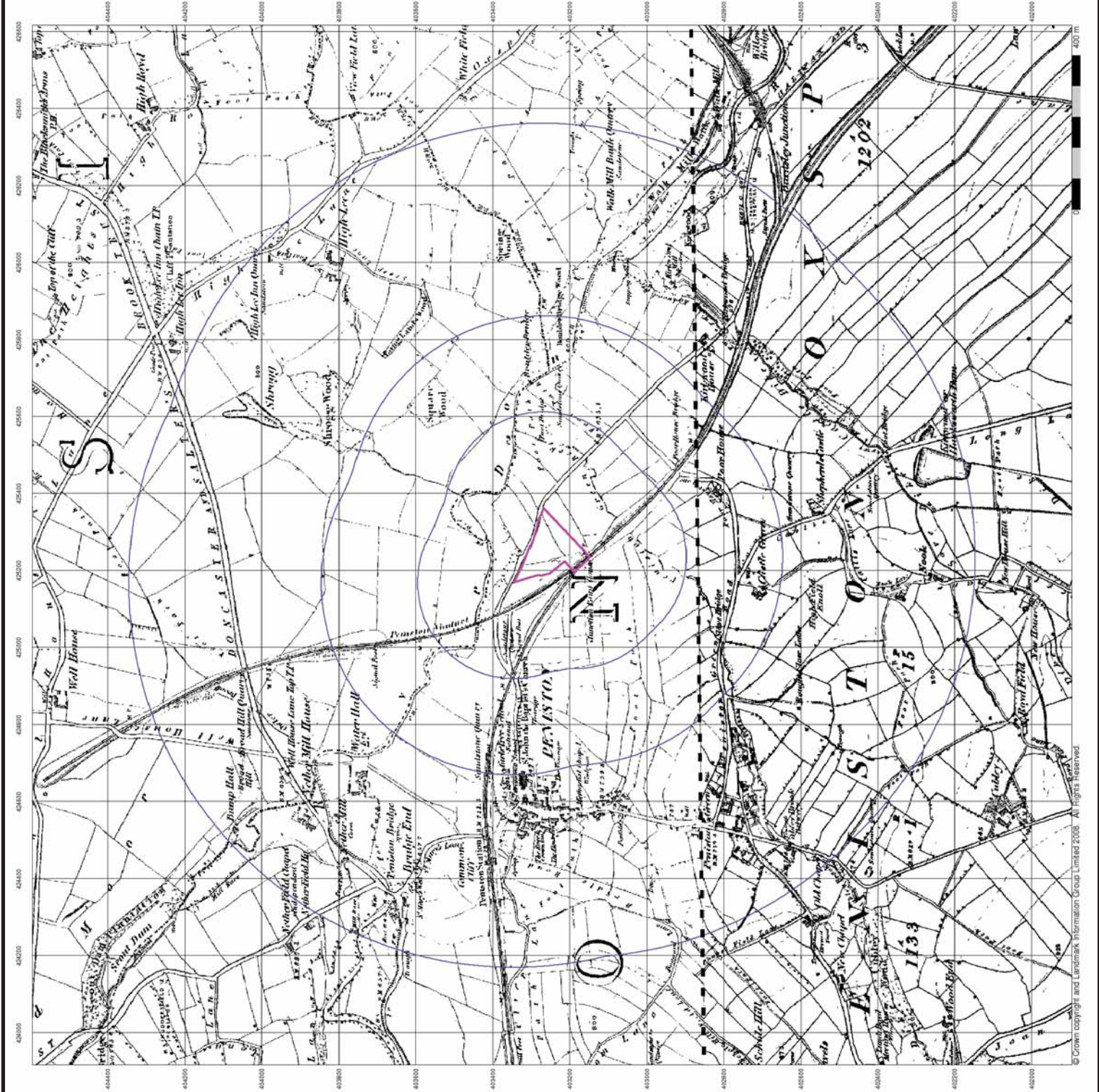

Yorkshire

Published 1906 - 1907

Source map scale - 1:10,560

The historical maps shown were reproduced from maps predominantly held at the scale adopted for England, Wales and Scotland in the 1840's. In 1854 the 1:2,500 scale was adopted for mapping urban areas, these maps were used to update the 1:10,560 maps. The published data given therefore is often some years later than the surveyed date. Before 1858, all OS maps were based on the Cassini Projection, with independent surveys of a single county or group of counties later being joined together to form a larger area. In 1906 the Ordnance Survey (OS) map scale was reduced which updated the 1:10,560 maps from a number of sources. The maps appear unfinished - with all military camps and other strategic sites removed. These maps were initially overlaid with the National Grid. In 1970, the first 1:10,000 maps were produced using the Transverse Mercator Projection. The revision process continued until recently, with new editions appearing every 10 years or so for urban areas.

Map Name(s) and Date(s)

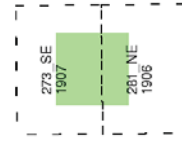

Historical Map - Slice A

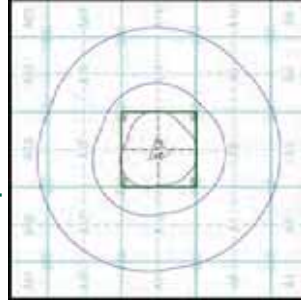

Order Details

Order Number: 26815318_1_1
Customer Ref: J-S0099
National Grid Reference: 425250, 403260
Slice: A
Site Area (Ha): 1.7
Search Buffer (m): 1000

Site Details

Sheffield Road, Penistone, SHEFFIELD

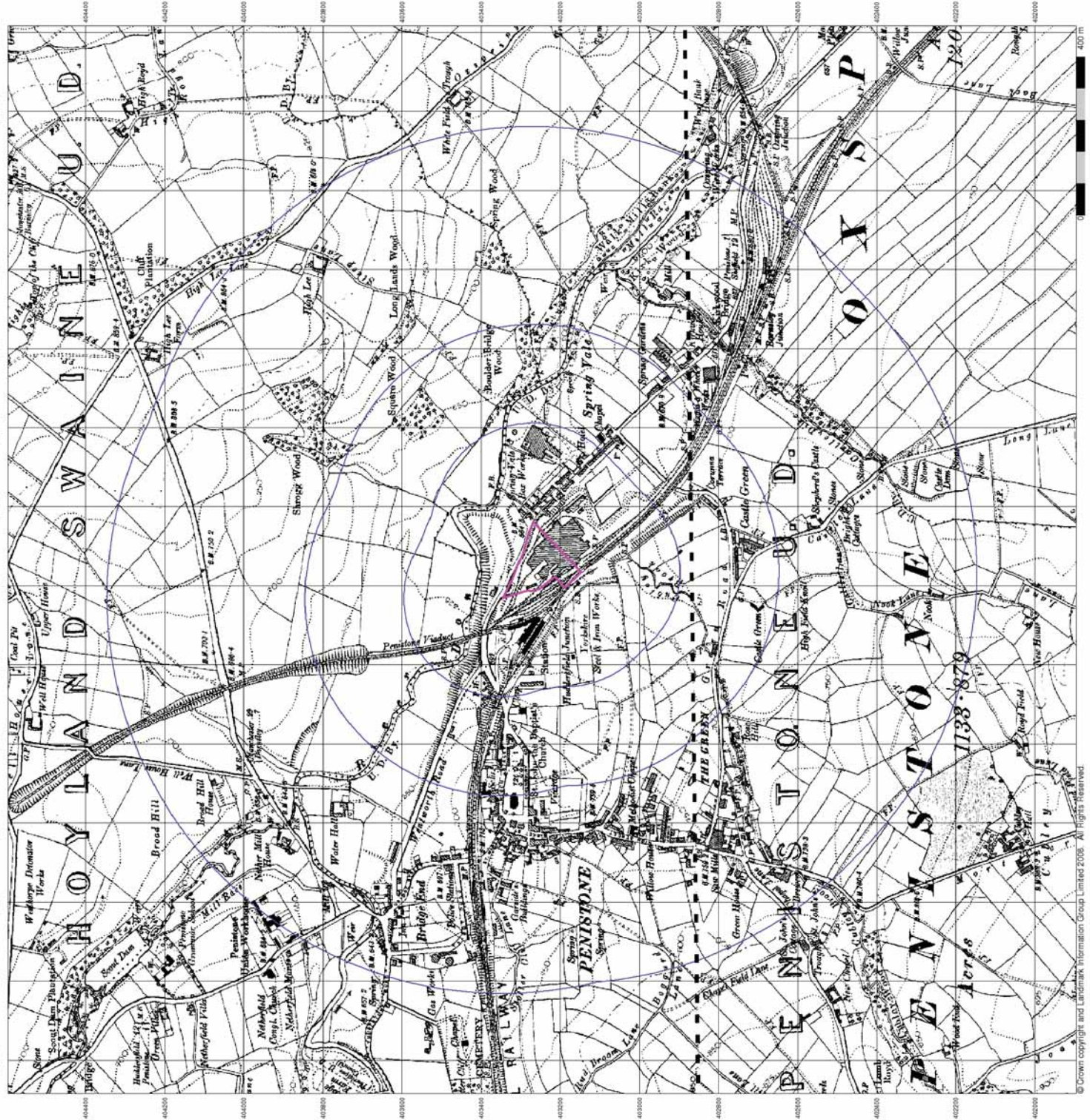

Yorkshire

Published 1938 - 1948

Source map scale - 1:10,560

The historical maps shown were reproduced from maps predominantly held at the scale adopted for England, Wales and Scotland in the 1840's. In 1854 the 1:2,500 scale was adopted for mapping urban areas, these maps were used to update the 1:10,560 maps. The published data given therefore is often some years later than the surveyed date. Before 1938, all OS maps were based on the Cassini Projection, with dependent surveys of a single county or group of counties. From 1938, the Ordnance Survey was required to produce the 1:10,560 Ordnance Survey (OS) maps of England, which were produced in the 1:10,560 map scale from a number of sources. The maps appear unfinished, with all military camps and other strategic sites removed. These maps were initially overlaid with the National Grid. In 1970, the first 1:10,000 maps were produced using the Transverse Mercator Projection. The revision process continued until recently, with new editions appearing every 10 years or so for urban areas.

Map Name(s) and Date(s)

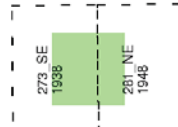

Historical Map - Slice A

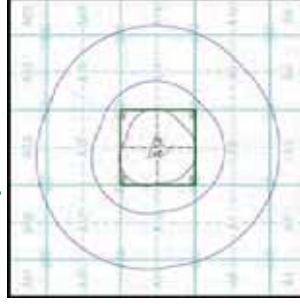

Order Details

Order Number: 26815318_1_1
 Customer Ref: J-S0099
 National Grid Reference: 425250, 403260
 Slice: A
 Site Area (Ha): 1.7
 Search Buffer (m): 1000

Site Details

Sheffield Road, Penistone, SHEFFIELD

