

**Planting schedule**

Species	Size	Quantity
Betula pendula	1.8-2.4m feathered	10nr
Magnolia soulangeana	30L 100-125cm	14nr
Hedera hibernica (4/m <sup>2</sup> )	2L 0.4-0.6m	1205nr
Rubus 'Betty Ashburner' (4/m <sup>2</sup> )	2L 0.2-0.3m	1252nr
Rosa spinosissima (3/m <sup>2</sup> )	2L 0.6-0.8m	140nr
Euphorbia characias 'Wulfenii'	3L	31nr
Narcissus 'Mount Hood' (50/m <sup>2</sup> )	12/14cm	5600nr
Corylus avellana	600-900 1+1	96
Ilex aquifolium	3L	48
Betula pendula	600-900 1+1	60
Quercus robur	600-900 1+1	12
Crataegus monogyna	600-900 1+1	24

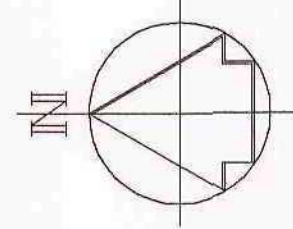

Hatched area to be cleared of existing poplar and cherry saplings and planted with the following native mix:

40%	Corylus avellana	(96nr)
20%	Ilex aquifolium	(48nr)
25%	Betula pendula	(60nr)
5%	Quercus robur	(12nr)
10%	Crataegus monogyna	(24nr)

Planting at 1plant/m<sup>2</sup>

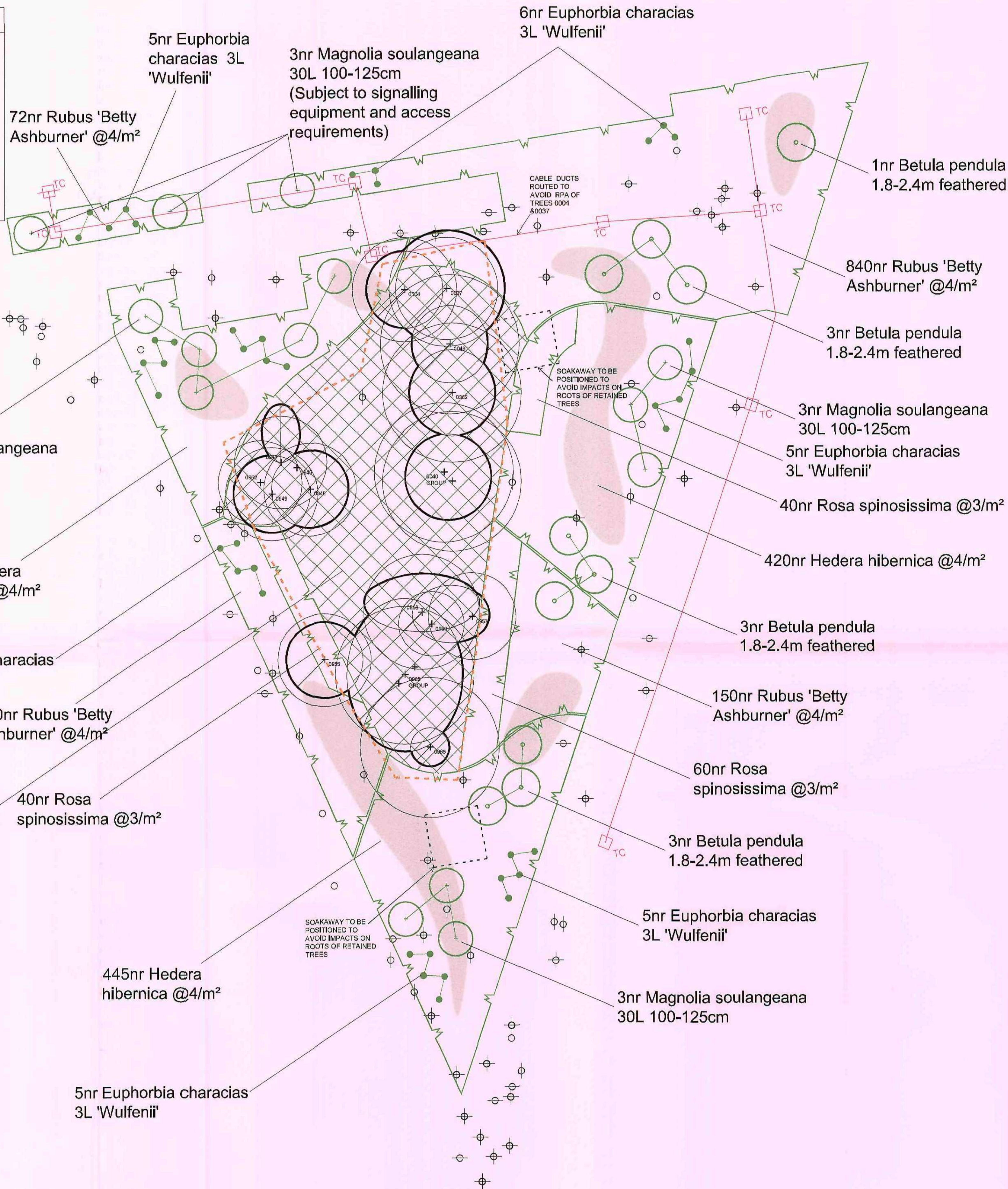

Landscaping Plan  
Scale 1:125

**SPECIFICATION:**

- a) All tree pits to be excavated to 900mm depth below proposed finished level and made available for inspection by landscape architect prior to backfilling. Bases and sides of tree pit excavations must be free draining. Tree pits shall be minimum 500 x 500mm in plan and backfilled with topsoil. General planting areas shall be prepared to 300mm below proposed finished level. Topsoil to new embankment faces shall be 300mm depth. All imported topsoil shall meet the classification of 'multi purpose' as defined by BS3882:2007. Declaration of analysis for proposed topsoil source to be supplied for approval. (As annex E BS3882:2007)
- b) All areas shall be ameliorated with 50mm depth approved compost material e.g. spent mushroom compost / green waste compost. Material shall be fine grade & must be well composted. Compost to be applied shortly prior to cultivation and incorporated evenly into top 150mm of soil.
- c) All plant material shall consist of healthy stock with well balanced branch structures and well developed fibrous root systems. Planting generally shall accord with CPSE 'Handling and establishing landscape plants' (obtainable from the Horticultural Trades Association) Part III, paragraphs 6.2 to 6.6. Plant handling, storage and transport shall accord with CPSE 'Handling and establishing landscape plants' (obtainable from the Horticultural Trades Association) Part I, Part II and Part III, paragraphs 1.3.3 to 1.3.6, 3.0, and 4.0.
- d) Lightly firm soil around plants and fork and/ or rake soil, without damaging roots, to a fine till with gentle cambers and no hollows. Immediately after planting and prior to mulching, water all planting areas thoroughly to field capacity, without damaging or displacing plants or soil.
- a. After watering, apply 75mm settled depth of Melcourt Amenity grade bark mulch or equivalent. (Sample to be provided for approval in advance of ordering)
- e) Any plants that fail to thrive (unless due to theft or malicious damage after completion) during the period of 12 months following Practical Completion, will be regarded as defects due to materials or workmanship and shall be replaced with equivalent plants to match size of adjacent or nearby plants of same species or match original specification, whichever is the greater.
- g) Bulb planting shall take place during autumn. Planting depth 12cm. Bulbs shall be grade 1. Bulb size 12/14cm
- h) Tree Protection Fencing around existing trees shall be erected prior to commencement of engineering activity. Barriers shall be in accordance with recommendations in BS5837:2005 and consist of a well braced scaffolding pole framework with weldmesh panels. NB Heras type fencing is not suitable

- Key:**
- Trees to be Retained
  - Trees to be Removed
  - Root Protection Area
  - Bulb Planting
  - Tree Protection Fencing

**DO NOT SCALE**

**NOTES**

1. ALL DIMENSIONS ARE IN MILLIMETRES, UNLESS STATED OTHERWISE.
2. ALL LEVELS ARE IN METRES AND RELATE TO AN OBM LOCATED ON O/B 73 (VALUE=33.510).
3. BOLTON-ON-DEARNE STATION FOOT CROSSING LOCATED ON THE YORK / LEEDS TO SHEFFIELD LINE, ENGINEERS LINE REFERENCE (ELR) SMJ2 @ 16 MILES 56 CHAINS. ORDINANCE SURVEY GRID REFERENCE SE 457 027.

Barnsley Metropolitan Borough Council  
19 MAY 2009  
Corporate Mail Room

Rev.	Date	Descriptions of Revision	Des.	Chkd.	Appr.

Landscaping Consultant

**Chesler Office:**  
Well House  
Barns  
Bretton  
Chester  
CH4 0DH

Client

Network Rail  
London North Eastern  
Territory  
Infrastructure Enhancements  
George Stephenson House  
Traf Green, York  
YO1 6JT

**Railway Infrastructure Services**  
PO Box 298  
York  
YO1 6YH  
T: 01904 454600  
F: 01904 454601

**PLANNING APPLICATION**

Designed	J.MASON	Checked	A.McNAY
Approved	M.R.PARKER	Date	06/04/09

ELR: SMJ2 @ 16 Miles 56 Ch.  
BOLTON-ON-DEARNE STATION  
PROPOSED CLOSURE OF FOOT CROSSING  
LANDSCAPING PLAN

Scale#	AS SHOWN	CAD	SM
GAP Ref.:	K5/BENH Moorhops & Bolton On Dearne Infrastructure Station On Dearne Line Survey 05/04/09 Landscaping Planning		
Drawing Number	B50034-901	Revision	—

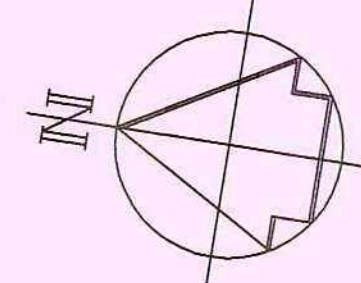

PLAN OF STATION  
SCALE 1:200

- SERVICES**
- WATER
  - GAS
  - BT
  - LOW VOLTAGE ELECTRICITY CABLE
  - 11KV ELECTRICITY CABLE
  - HAND DUG TRIAL PIT



GENERAL VIEW FROM THE ROADBRIDGE  
LOOKING NORTH, EXISTING CROSSING IN  
THE BACKGROUND



EXISTING FOOT CROSSING VIEW  
FROM DOWN PLATFORM



VIEW OF UP PLATFORM, NEAR LOWFIELD  
ROAD OVERBRIDGE. THIS IS THE  
PROPOSED PLACE FOR A FOOTBRIDGE



LOWFIELD ROAD  
OVERBRIDGE ABUTMENTS



SITE OF PROPOSED FOOTBRIDGE  
ADJACENT TO UP PLATFORM



STATION FORECOURT VIEW FROM  
DOWN PLATFORM



STATION FORECOURT VIEW FROM  
STATION WAY



VIEW FROM STATION ENTRANCE  
TOWARDS EXISTING CAR PARK

- NOTES**
1. ALL DIMENSIONS UNLESS STATED
  2. ALL LEVELS ARE AN OBM LOGIC (VALUE=33.51)
  3. BOLTON-ON-CROSSING TO SHEFFIELD REFERENCE CHAINS, ORD REFERENCE S
  4. THIS DRAWING WITH DRAWING B50034-211 ARRANGEMENT B50034-212 B50034-213
  5. BURIED SERVICE INFORMATION ON 11th JUN
  6. DRAINAGE SYSTEM INFORMATION "BOLTON-ON-RENEWAL" DR NEWCASTLE
  7. REPRODUCED SUPERPLAN FOR ALL RIGHTS R
  8. ADDITIONAL DRAINAGE-RELATED ROAD OVERBR
  9. LAND OWNERS KEY NETWORK TAKEN FROM 2007
  10. LIMIT OF DEVIATION SIDE OF RAIL
  11. FOR DETAILS OF AGRICULTURE UNDERTAKEN OF SHIELD SU 04/10/06

- LAND OWNER**
- LIMITS NORTH
  - NETWORK OWNER
  - NETWORK (ROAD)
  - NETWORK STATION
  - DEED N.B. TH WITH M
  - UNKNOWN
  - MAINTAINED
  - EXISTING

A	26	EXISTING TR
	03	
	09	
	10	
	11	
	12	
	13	
	14	
	15	
	16	
	17	
	18	
	19	
	20	
	21	
	22	
	23	
	24	
	25	
	26	
	27	
	28	
	29	
	30	
	31	
	32	
	33	
	34	
	35	
	36	
	37	
	38	
	39	
	40	
	41	
	42	
	43	
	44	
	45	
	46	
	47	
	48	
	49	
	50	
	51	
	52	
	53	
	54	
	55	
	56	
	57	
	58	
	59	
	60	
	61	
	62	
	63	
	64	
	65	
	66	
	67	
	68	
	69	
	70	
	71	
	72	
	73	
	74	
	75	
	76	
	77	
	78	
	79	
	80	
	81	
	82	
	83	
	84	
	85	
	86	
	87	
	88	
	89	
	90	
	91	
	92	
	93	
	94	
	95	
	96	
	97	
	98	
	99	
	100	

**Network**

**coru**

**PLANNING**

Designed: K.BRISTOW

Approved: M.R.PARKE

ELR: SMJ2

BOLTON-ON-PROPOSED CLOS

EXISTING G

Scale: AS SHOWN

© 2003 Bentley & John D. Bentley

Drawing Number: B50034-211

DO NOT SCALE

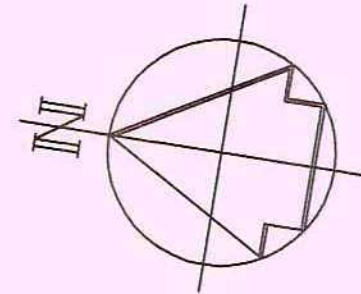

- NOTES**
- ALL DIMENSIONS ARE IN MILLIMETRES, UNLESS STATED OTHERWISE.
  - ALL LEVELS ARE IN METRES AND RELATE TO AN OBM LOCATED ON O/B 73 (VALUE=33.510).
  - BOLTON-ON-DEARNE STATION FOOT CROSSING LOCATED ON THE YORK/LEEDS TO SHEFFIELD LINE, ENGINEERS LINE REFERENCE (ELR) SMJ2 AT 16 MILES 56 CHAINS. ORDNANCE SURVEY GRID REFERENCE SE 457 027.
  - THIS DRAWING IS TO BE READ IN CONJUNCTION WITH DRAWING No: B50034-211 - PROPOSED GENERAL ARRANGEMENT B50034-212 - PROPOSED SECTIONS B50034-213 - PROPOSED DETAILS
  - BURIED SERVICES ARE TAKEN FROM INFORMATION PROVIDED BY NETWORK RAIL ON 11th JUNE 2007.
  - DRAINAGE SYSTEMS AND ELECTRICAL WORKS INFORMATION IS TAKEN FROM "BOLTON-ON-DEARNE STATION PLATFORM RENEWAL" DRAWINGS BY SPENCER, NEWCASTLE
  - REPRODUCED FROM ORDNANCE SURVEY SUPERPLAN DATA CROWN COPYRIGHT 2007. ALL RIGHTS RESERVED.
  - ADDITIONAL DATA OBTAINED BY SURVEY, CO-RELATED TO BENCHMARK ON LOWFIELD ROAD OVERBRIDGE.
  - LAND OWNERSHIP DETAILS INDICATED IN THE KEY. NETWORK RAIL OWNED/LEASED LAND TAKEN FROM MARLIN PRINT DATED 7 JUNE 2007.
  - LIMIT OF DEVIATION IS OFF PLAN ON EAST SIDE OF RAILWAY.
  - FOR DETAILS OF WOODED AREA REFER TO ARBORICULTURAL TREE SURVEY AND REPORT UNDERTAKEN BY EXPERTREES ON BEHALF OF SHIELD SUPPORT SERVICES, DATED 04/10/08.

- LAND OWNERSHIP**
- LIMITS OF DEVIATION, MIDLAND AND NORTH-EASTERN RAILWAYS ACT, 1874
  - NETWORK RAIL FREEHOLD OWNERSHIP
  - NETWORK RAIL OWNED BRIDGE (ROAD OVER RAIL)
  - NETWORK RAIL FREEHOLD OWNERSHIP STATION LEASE (NORTHERN TRAINS)
  - DEED NO. SYK325729. N.B. THIS REGISTER ITEM CONFLICTS WITH MARLIN DATA
  - UNKNOWN OWNERSHIP
  - MAINTAINABLE HIGHWAY
  - EXISTING VEGETATION
- Barnsley Metropolitan Council  
19 MAY 2009  
Corporate Mail Room

A	26	03	09	EXISTING TREE DETAILS REMOVED	KB	ACH	MRP
Rev.	Date	Descriptions of Revision	Des.	Chkd.	Appr.		

**Network Rail**  
Network Rail  
London North Eastern Territory  
Infrastructure Enhancements  
George Stephenson House  
Toft Green, York  
YO1 4JT

**CORUS**  
Railway Infrastructure Services  
PO Box 298  
York  
YO1 6YH  
T: 01904 454600  
F: 01904 454601

**PLANNING APPLICATION**

Designed	K.BRISTOWE	Checked	R.HISEMAN
Approved	M.R.PARKER	Date	22/10/08

ELR: SMJ2 @ 16 Miles 56 Ch.  
BOLTON-ON-DEARNE STATION  
PROPOSED CLOSURE OF FOOT CROSSING  
EXISTING GENERAL ARRANGEMENT

Scale	AS SHOWN	CAO	KB
Drawing Number	B50034-210	Revision	A

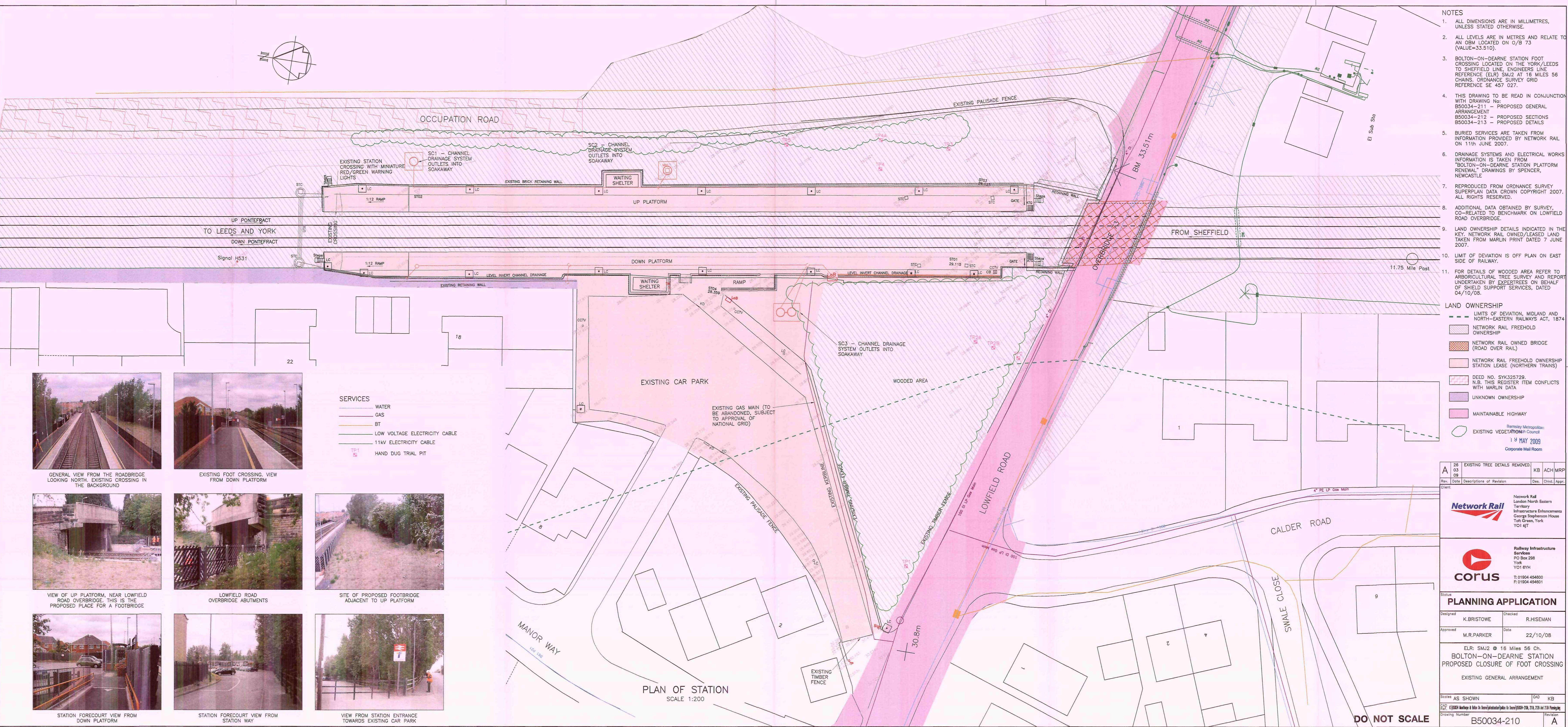

- SERVICES**
- WATER
  - GAS
  - BT
  - LOW VOLTAGE ELECTRICITY CABLE
  - 11KV ELECTRICITY CABLE
  - HAND DUG TRIAL PIT



GENERAL VIEW FROM THE ROADBRIDGE LOOKING NORTH. EXISTING CROSSING IN THE BACKGROUND



EXISTING FOOT CROSSING. VIEW FROM DOWN PLATFORM



VIEW OF UP PLATFORM, NEAR LOWFIELD ROAD OVERBRIDGE. THIS IS THE PROPOSED PLACE FOR A FOOTBRIDGE



LOWFIELD ROAD OVERBRIDGE ABUTMENTS



SITE OF PROPOSED FOOTBRIDGE ADJACENT TO UP PLATFORM

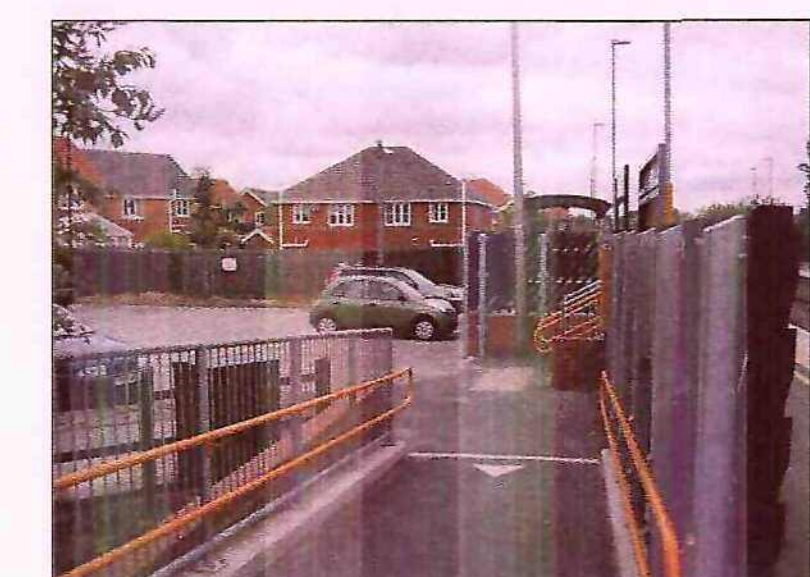

STATION FORECOURT VIEW FROM DOWN PLATFORM



STATION FORECOURT VIEW FROM STATION WAY



VIEW FROM STATION ENTRANCE TOWARDS EXISTING CAR PARK

PLAN OF STATION  
SCALE 1:200

DO NOT SCALE

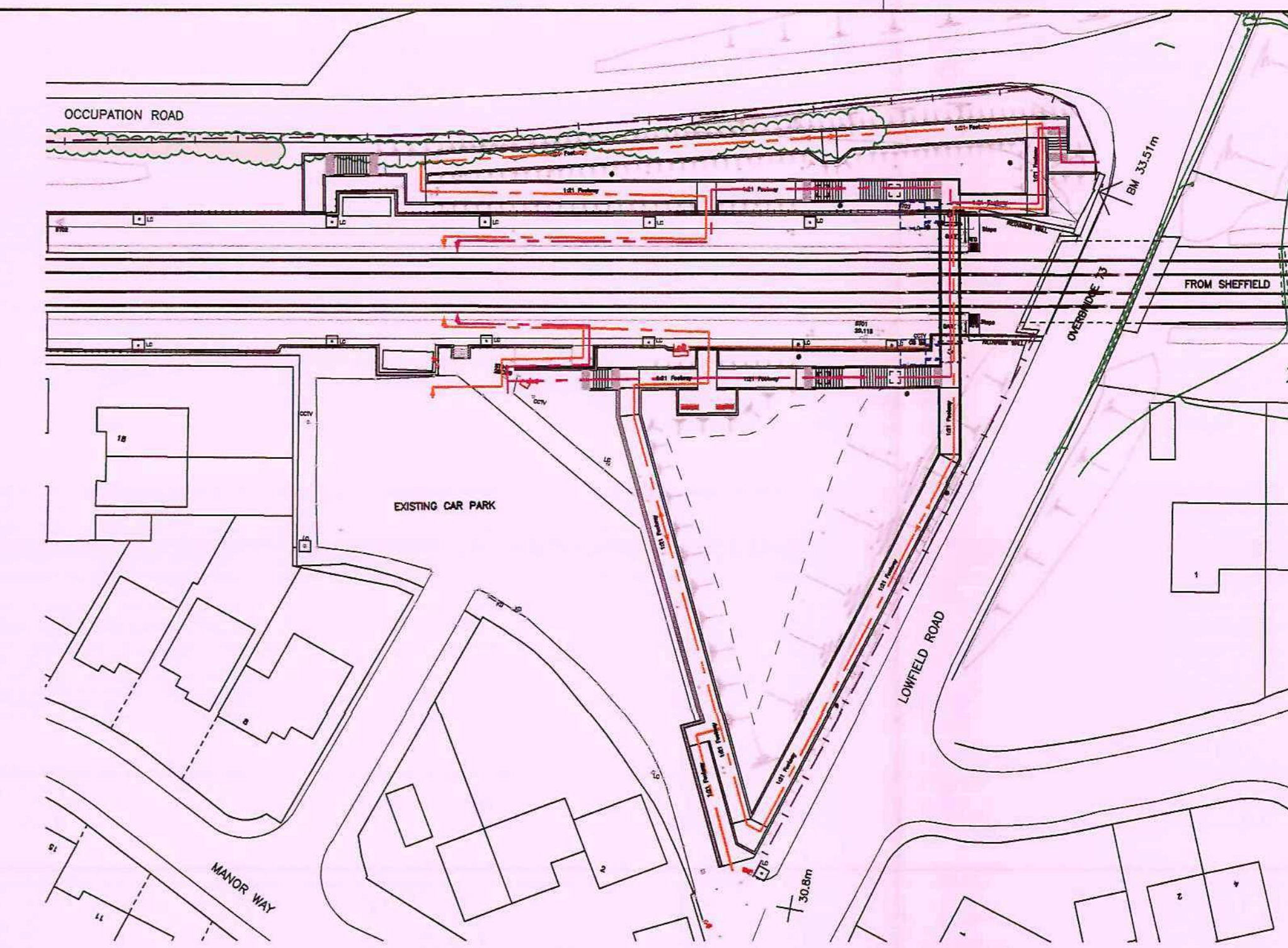
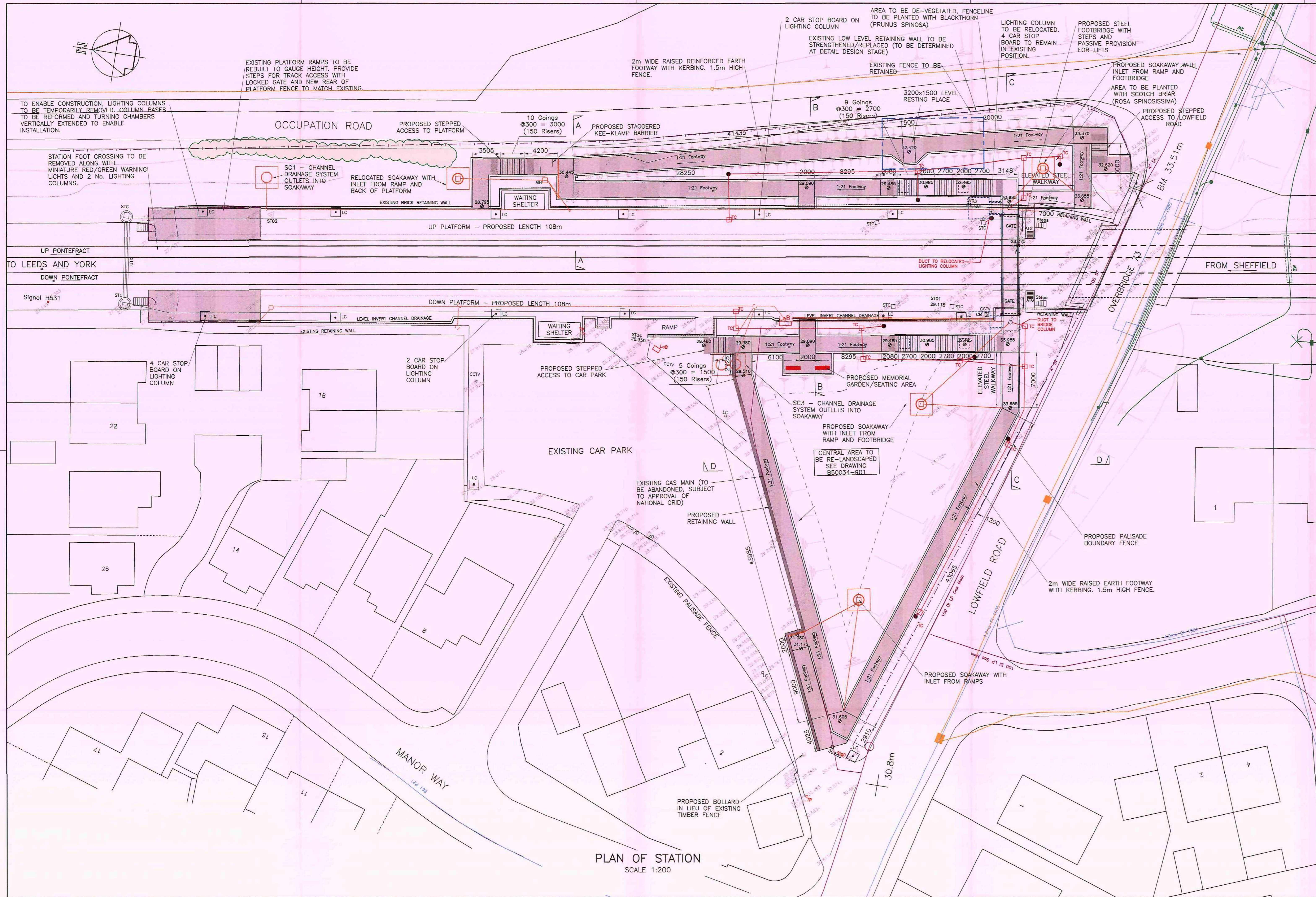

PLAN SHOWING DISABLED ACCESS ROUTE  
SCALE 1:500

--- DISABLED ACCESS ROUTE  
--- ABLE BODIED ACCESS ROUTE

KEY TO PROPOSED

- PROPOSED ASPHALT FOOTWAYS ON EARTHWORKS
  - PROPOSED STEEL FOOTWAYS AND STEPS
  - PROPOSED LAMP POST WITH CABLE ROUTE AND TURNING CHAMBERS
  - PROPOSED FENCE LINE
  - PASSIVE PROVISION FOR LIFTS
  - SUGGESTED CRANE LOCATION (TEMPORARY REGRADING OF GROUND LEVEL TO BE UNDERTAKEN FOR ACCESS)
- SERVICES
- WATER
  - GAS
  - BT
  - LOW VOLTAGE ELECTRICITY CABLE
  - 11kV ELECTRICITY CABLE

- NOTES
1. ALL DIMENSIONS ARE IN MILLIMETRES, UNLESS STATED OTHERWISE.
  2. ALL LEVELS ARE IN METRES AND RELATE TO AN OBM LOCATED ON O/B 73 (VALUE=33.510).
  3. BOLTON-ON-DEARNE STATION FOOT CROSSING LOCATED ON THE YORK / LEEDS TO SHEFFIELD LINE, ENGINEERS LINE REFERENCE (ELR) SMJ2 AT 16 MILES 56 CHAINS, ORDNANCE SURVEY GRID REFERENCE SE 457 027.
  4. BURIED SERVICES ARE TAKEN FROM INFORMATION PROVIDED BY NETWORK RAIL ON 11th JUNE 2007.
  5. DRAINAGE SYSTEMS AND ELECTRICAL WORKS INFORMATION IS TAKEN FROM "BOLTON-ON-DEARNE STATION PLATFORM RENEWAL" DRAWINGS BY SPENCER, NEWCASTLE
  6. REPRODUCED FROM ORDNANCE SURVEY SUPERPLAN DATA CROWN COPYRIGHT 2007. ALL RIGHTS RESERVED.
  7. ADDITIONAL DATA OBTAINED BY SURVEY, CO-RELATED TO BENCHMARK ON LOWFIELD ROAD OVERBRIDGE.
  8. LAND OWNERSHIP DETAILS INDICATED IN THE KEY, NETWORK RAIL OWNED/LEASED LAND TAKEN FROM MARLIN PRINT DATED 7 JUNE 2007.
  9. THE FOOTBRIDGE RAMP AND FOOTWAY ARRANGEMENT IS BASED UPON A RAIL TO FOOTBRIDGE SOFFIT HEIGHT OF 5.45m. HEIGHT DIFFERENCE BETWEEN PLATFORM LEVEL AND FOOTBRIDGE FTL IS 4855mm. THEREFORE SLOPE LENGTH OF FOOTWAY AT 1 IN 21 EQUATES TO 103m. FOR DETAILS OF FOOTBRIDGE AND STAIRS SEE DRAWING NO. B50034-710.
  10. LIMIT OF DEVIATION IS OFF PLAN ON EAST SIDE OF RAILWAY.
  11. TEMPORARY PLATFORM ARRANGEMENTS WILL REQUIRE SELECTIVE DOOR OPENING PROCEDURES. DETAILS TO BE CONFIRMED WITH T.O.C. & SIGNAL ENGINEERS.
  12. SEE DRAWING B50034-212 FOR CROSS SECTION DETAILS.
  13. FOR DETAILS OF WOODED AREA REFER TO ARBORICULTURAL TREE SURVEY AND REPORT UNDERTAKEN BY EXPERTREES ON BEHALF OF SHIELD SUPPORT SERVICES, DATED 04/10/08. ALSO REFER TO LANDSCAPING PLAN B50034-901.

Barnsley Metropolitan Borough Council  
1 MAY 2009  
Corporate Mail Room

A	26	DOWN SIDE REVISED TO 1:2	KB	ACH	MRP
	03	EARTH EMBANKMENTS, MEMORIAL GARDEN ADDED, STAR ACCESS TO LOWFIELD ROAD ADDED ON THE UP SIDE.			
Rev.	Date	Descriptions of Revision	Des.	Chkd.	Appr.

Client: Network Rail  
London North Eastern Territory  
Infrastructure Enhancements  
George Stephenson House  
Toft Green, York  
YO1 6JT

**corus** Railway Infrastructure Services  
PO Box 288  
York  
YO1 6YH  
T: 01904 454600  
F: 01904 454601

Status: **PLANNING APPLICATION**

Designed	K.BRISTOWE	Checked	R.HISEMAN
Approved	M.R.PARKER	Date	22/10/08

ELR: SMJ2 @ 16 Miles 56 Ch.  
BOLTON-ON-DEARNE STATION  
PROPOSED CLOSURE OF FOOT CROSSING  
PROPOSED GENERAL ARRANGEMENT

Scale:	AS SHOWN	CAD	KB
Drawing Number	B50034-211	Revision	A

DO NOT SCALE



PHOTO OF TYPICAL REINFORCED EARTH STRUCTURE

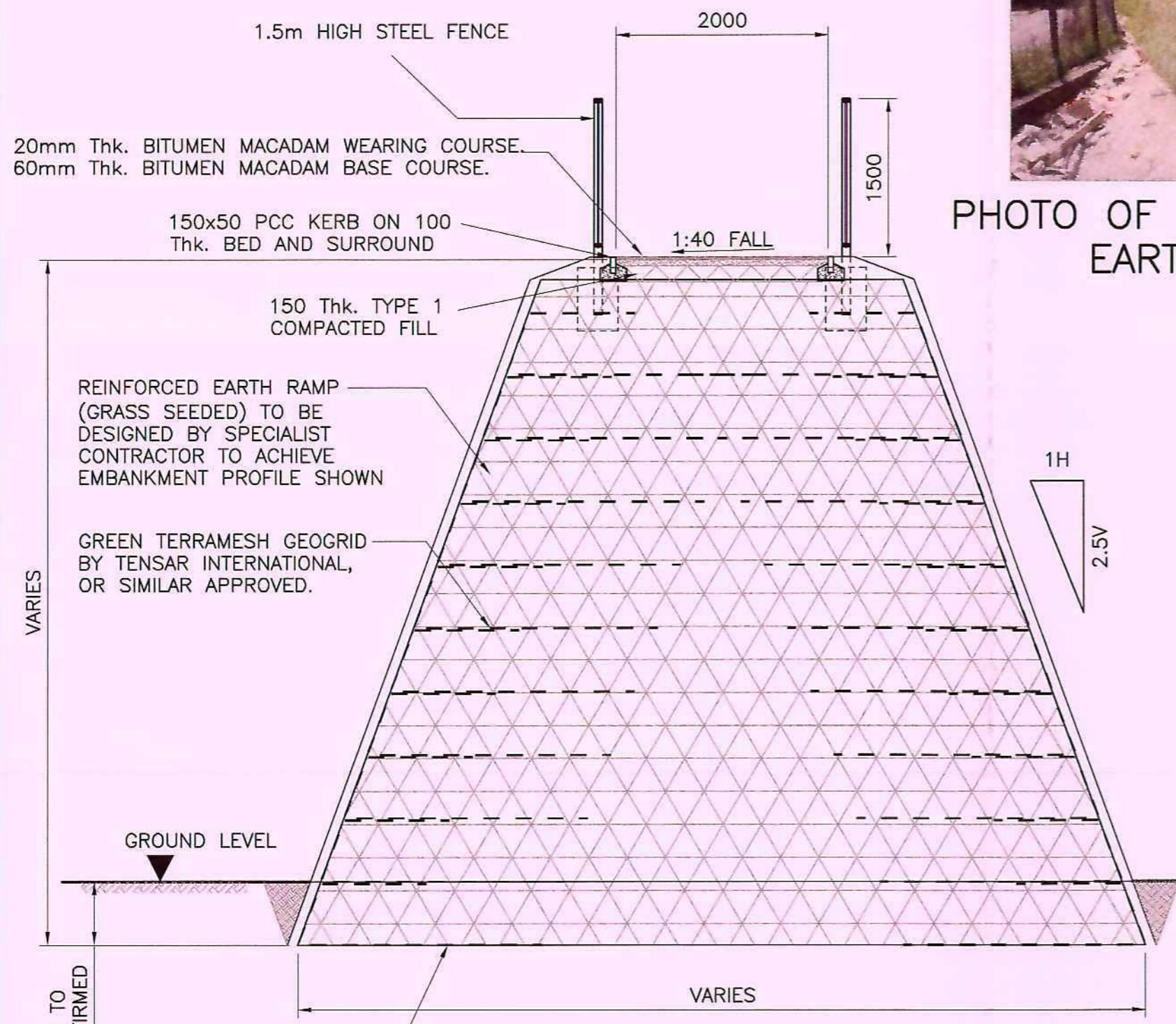

TYPICAL SECTION THROUGH REINFORCED EARTH FOOTWAY  
SCALE 1:50

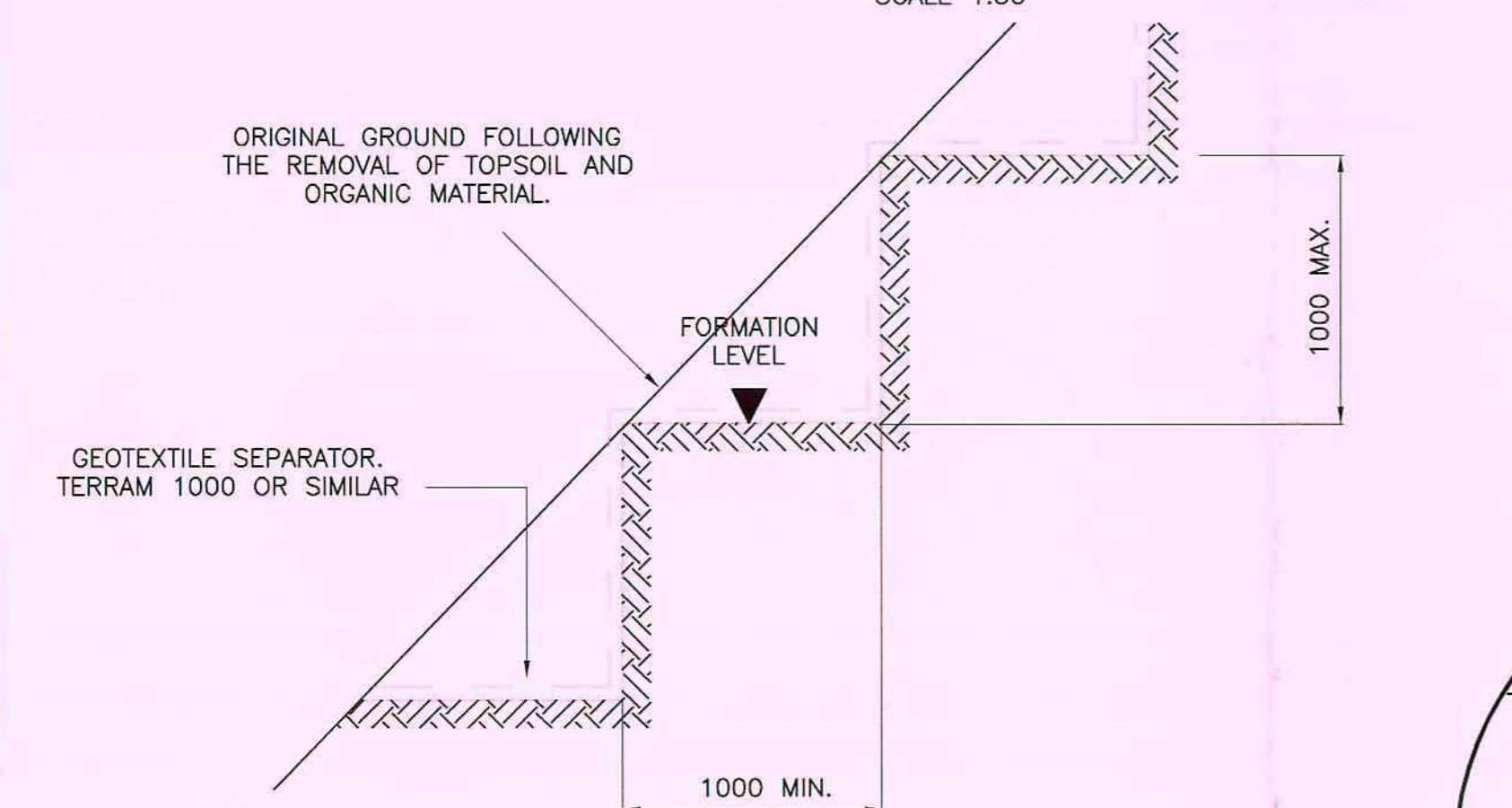

TYPICAL EARTH FOOTWAY ADJACENT TO LOWFIELD ROAD  
SCALE 1:50

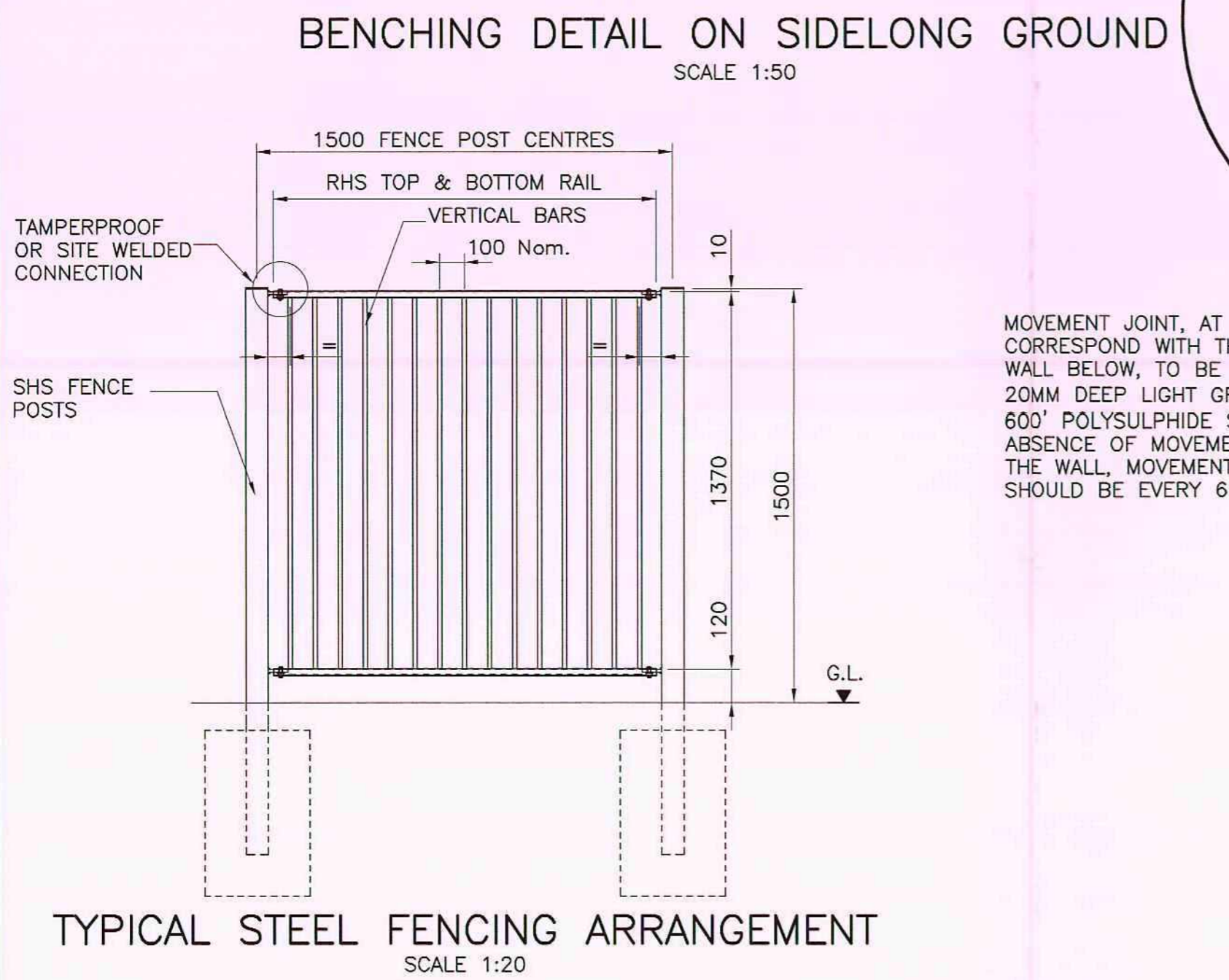

TYPICAL STEEL FENCING ARRANGEMENT  
SCALE 1:20

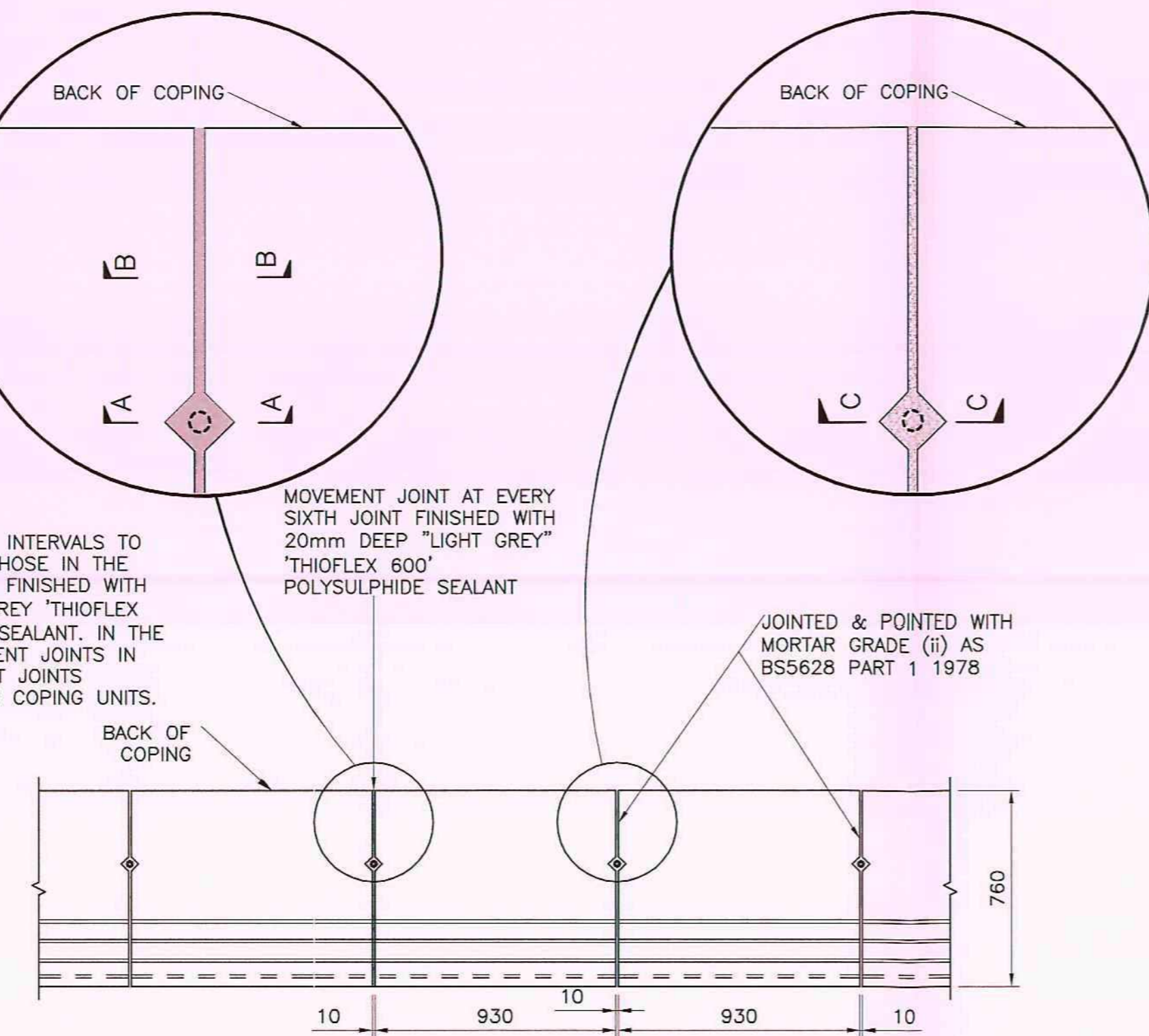

LAYOUT OF COPING UNITS  
SCALE 1:20 (BLOWUP DETAILS 1:5)

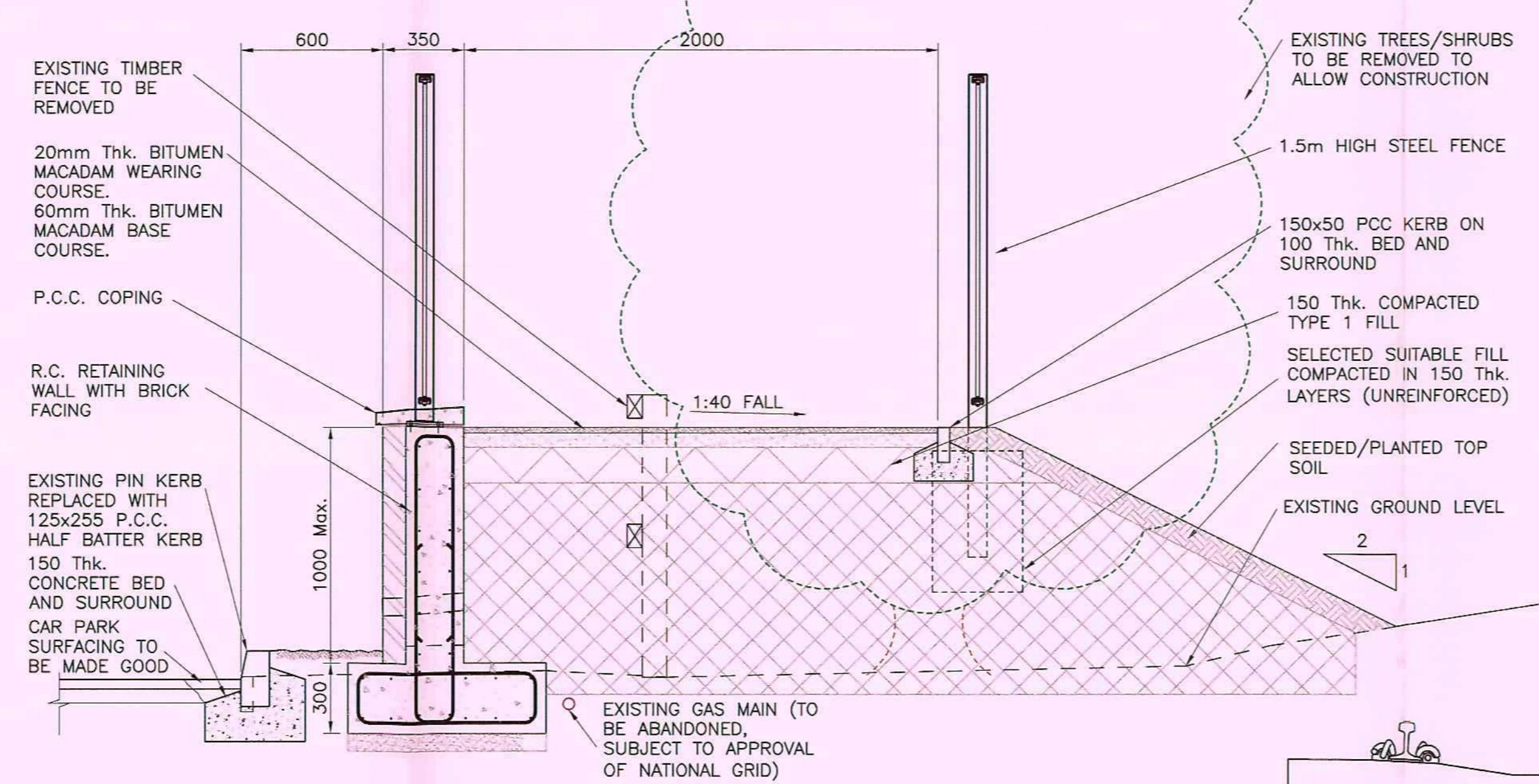

TYPICAL REINFORCED CONCRETE RETAINING WALL  
(MAXIMUM 1m RETAINED HEIGHT)  
SCALE 1:20

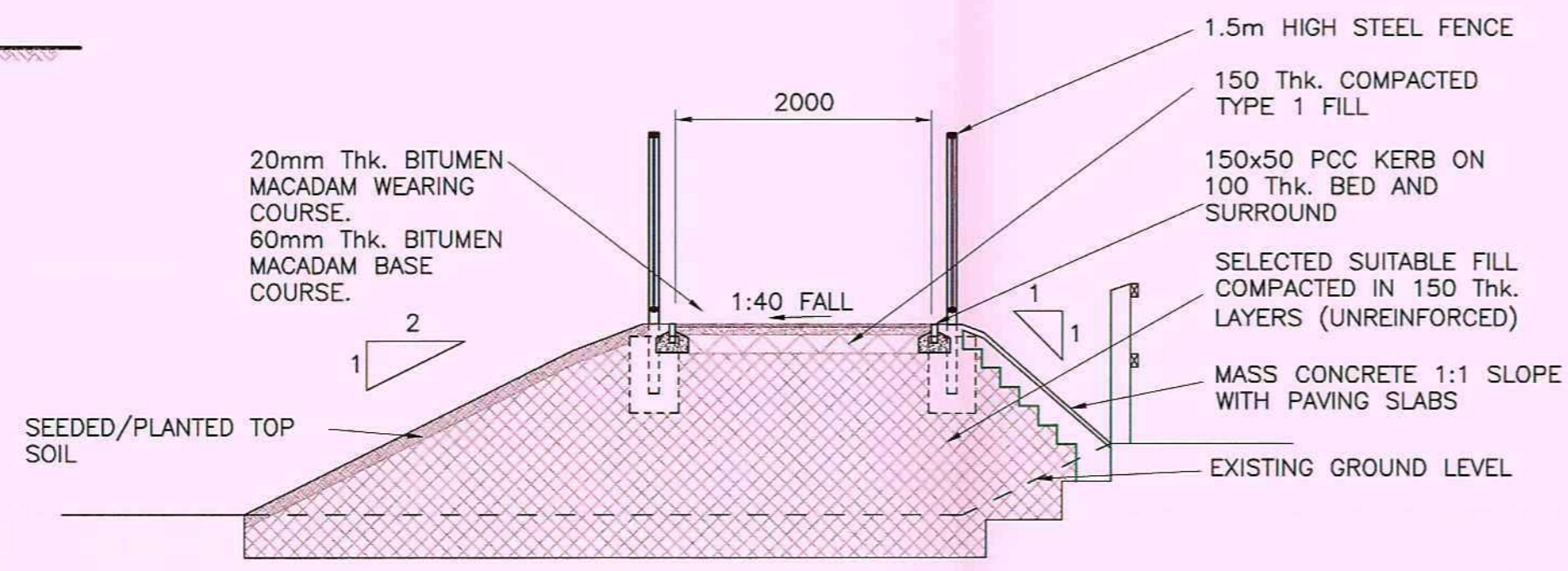

TYPICAL SECTION THROUGH REINFORCED EARTH RAMP  
SCALE 1:50

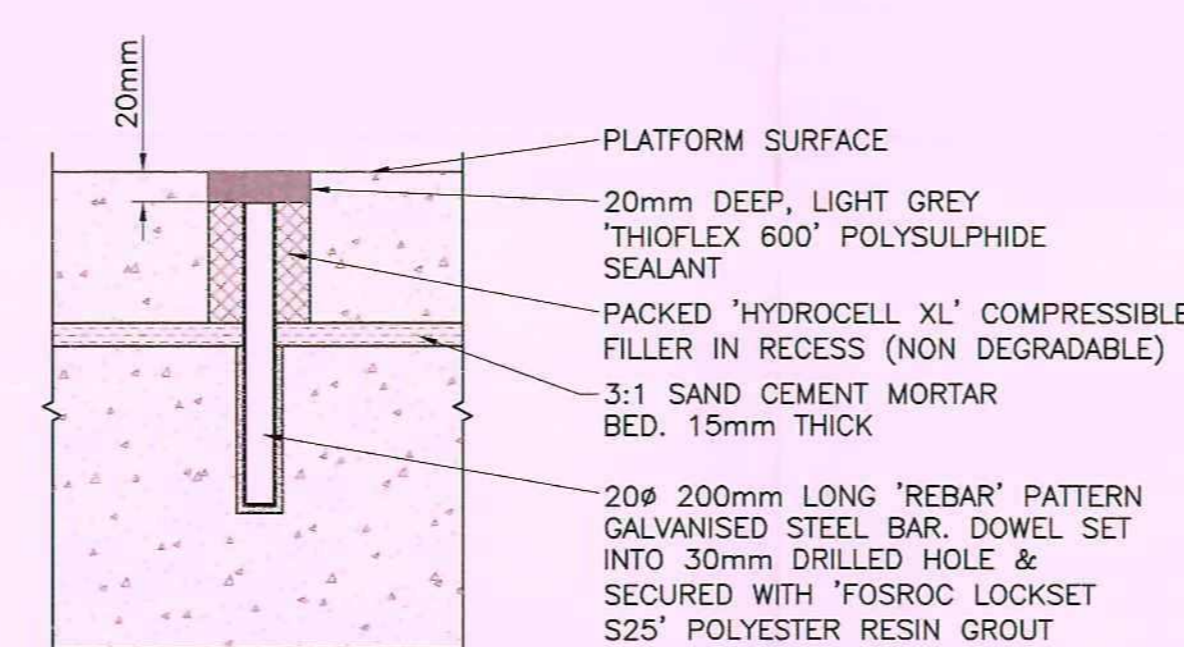

COPING UNIT DOWEL DETAIL:  
SECTION A-A  
SCALE 1:5

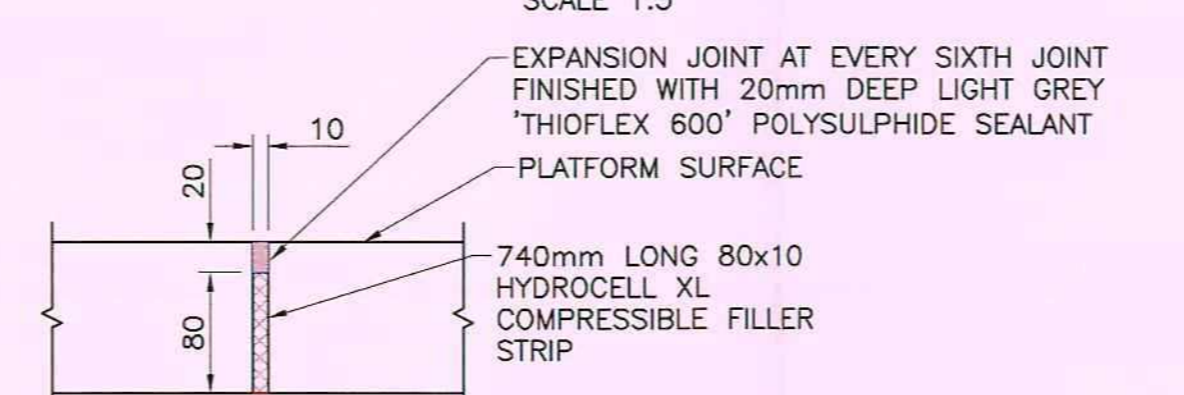

COPING UNIT MOVEMENT JOINT:  
SECTION B-B  
SCALE 1:5

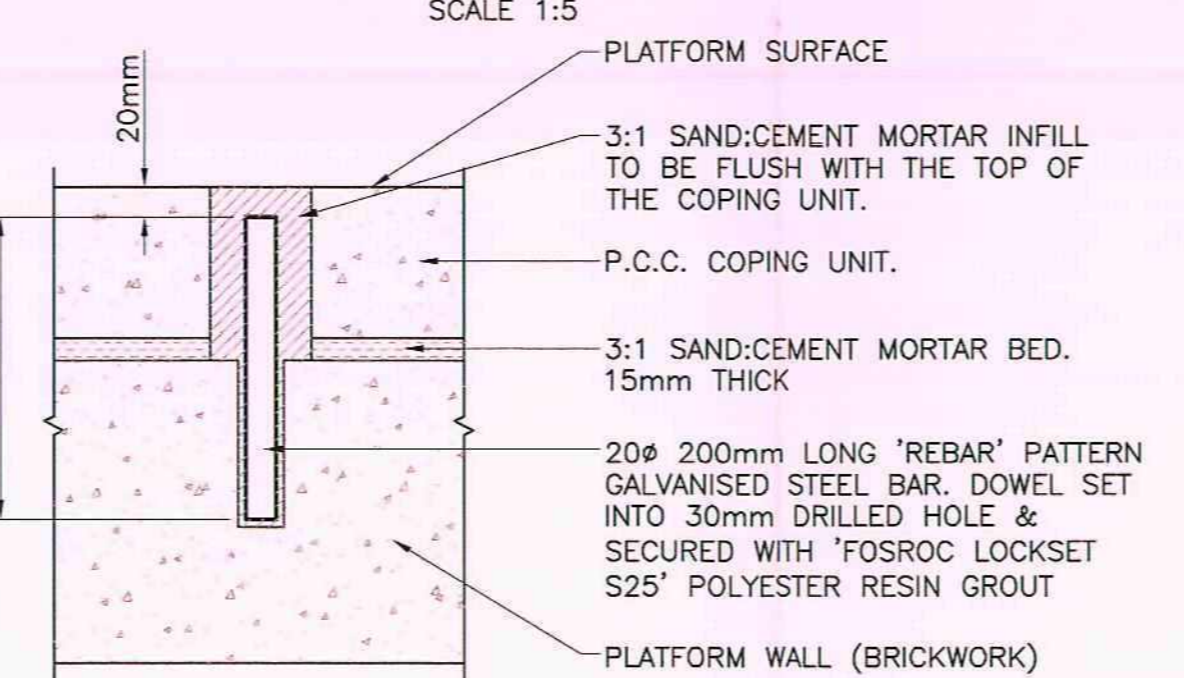

COPING UNIT DOWEL DETAIL:  
SECTION C-C  
SCALE 1:5

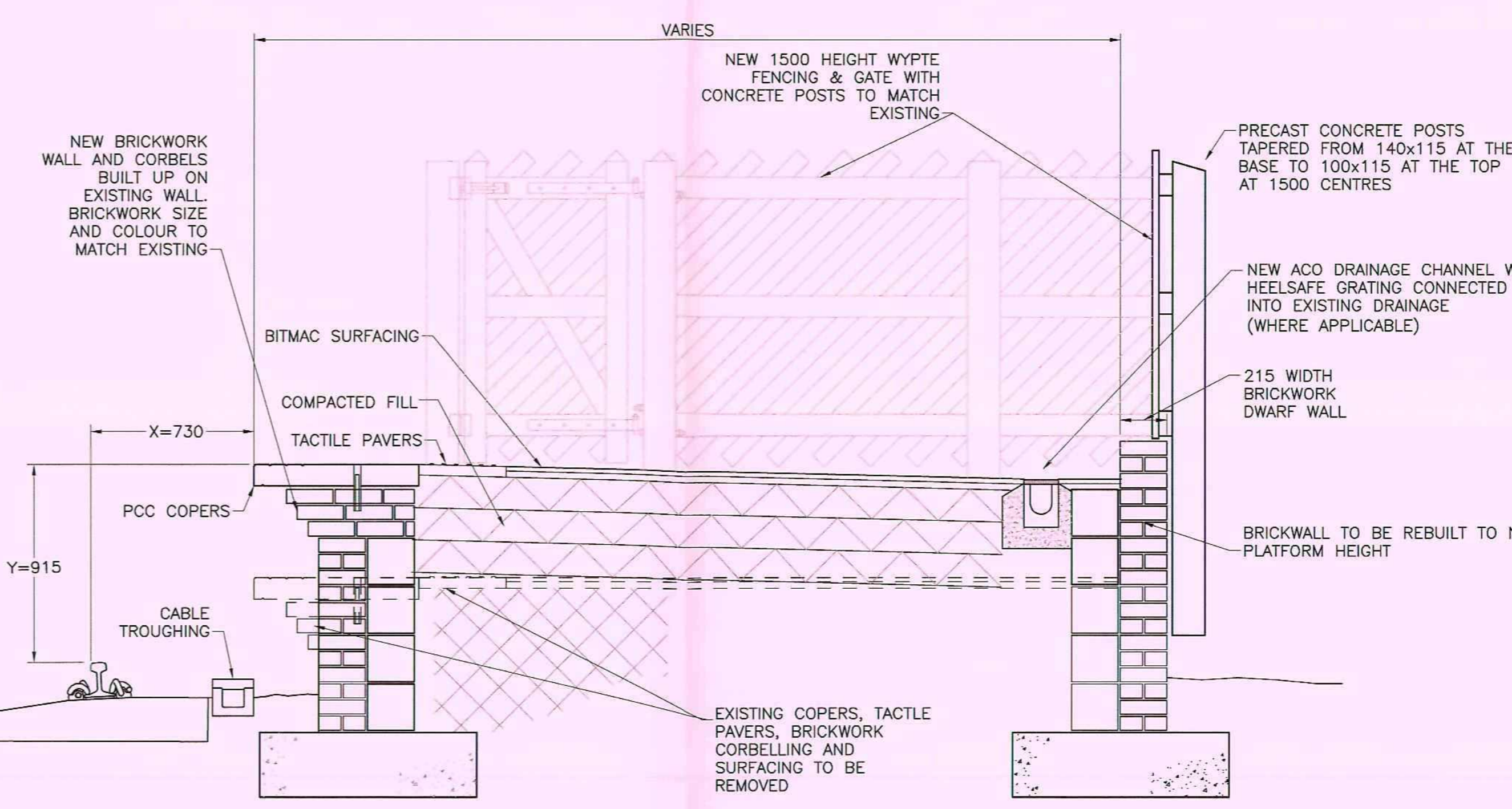

TYPICAL SECTION THROUGH REBUILT RAMP  
SCALE 1:20

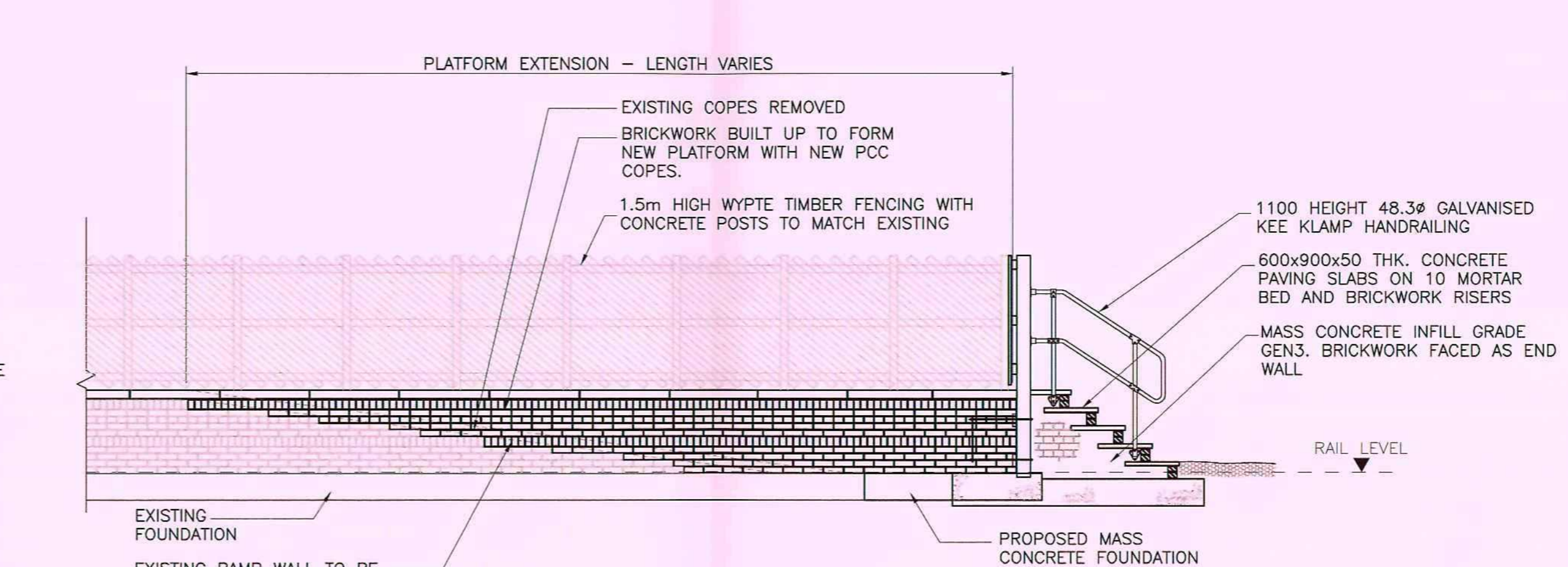

ELEVATION ON PLATFORM EXTENSION  
SCALE 1:50

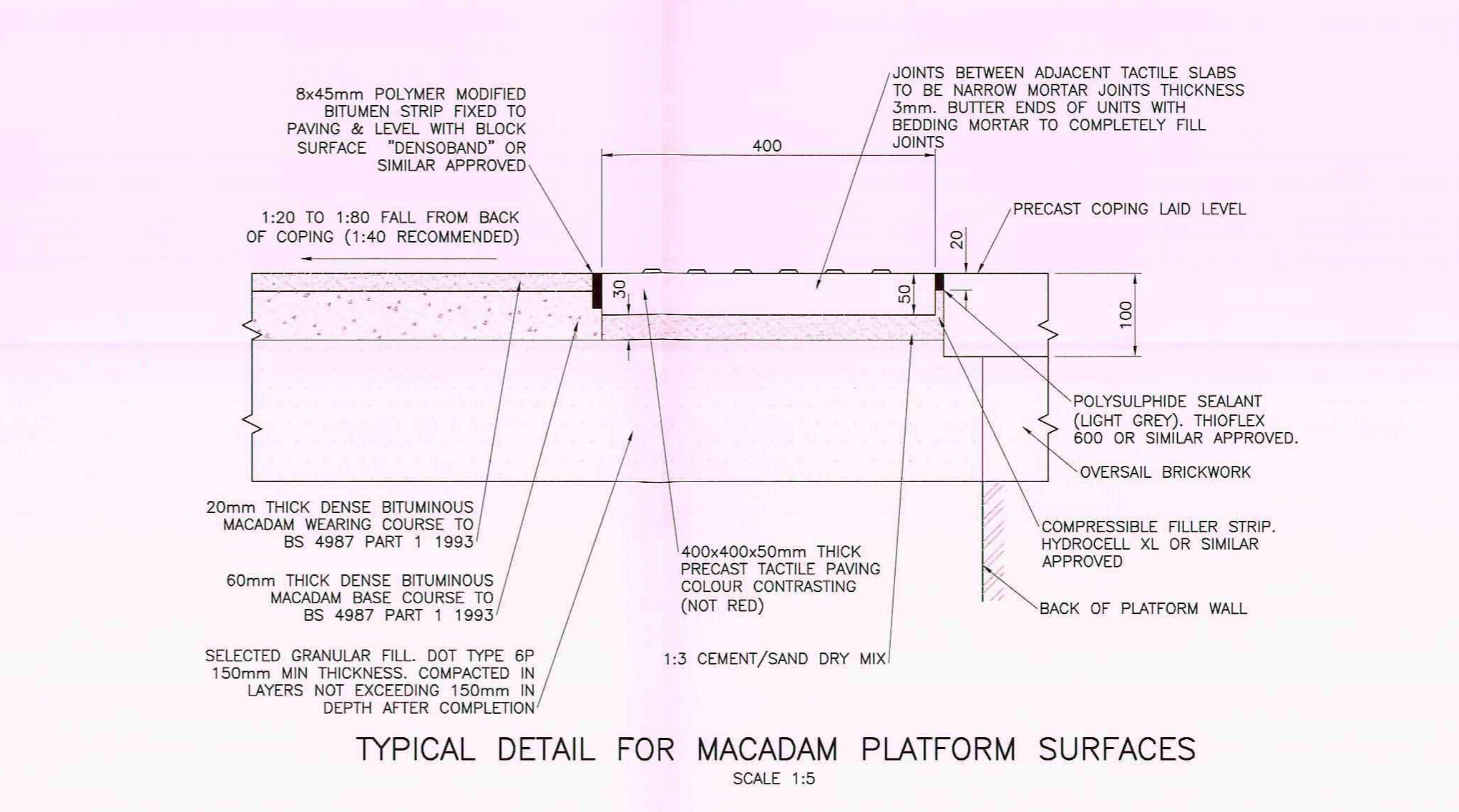

TYPICAL DETAIL FOR MACADAM PLATFORM SURFACES  
SCALE 1:5

- NOTES
- ALL DIMENSIONS ARE IN MILLIMETRES, UNLESS STATED OTHERWISE.
  - ALL LEVELS ARE IN METRES.
  - THIS DRAWING IS TO BE READ IN CONJUNCTION WITH DRAWING NUMBER B50034-211 - PROPOSED GENERAL ARRANGEMENT.
  - PLATFORM COMPONENTS, COPINGS, TACTILES AND SURFACING TO BE IN ACCORDANCE WITH NETWORK RAIL BUSINESS PROCESS DOCUMENT NR/PS/RES/00030 "PLATFORM COMPONENTS AND PREFABRICATED CONSTRUCTION SYSTEMS".
  - THE PLATFORM COPES ARE TO BE SET USING A CALIBRATED PLATFORM GAUGE PLACED IN THE PLANE OF THE RAILS (SEE SKETCH) "X" AND "Y" VALUES FOR EACH STATION TO BE DESIGNED BY OTHERS.

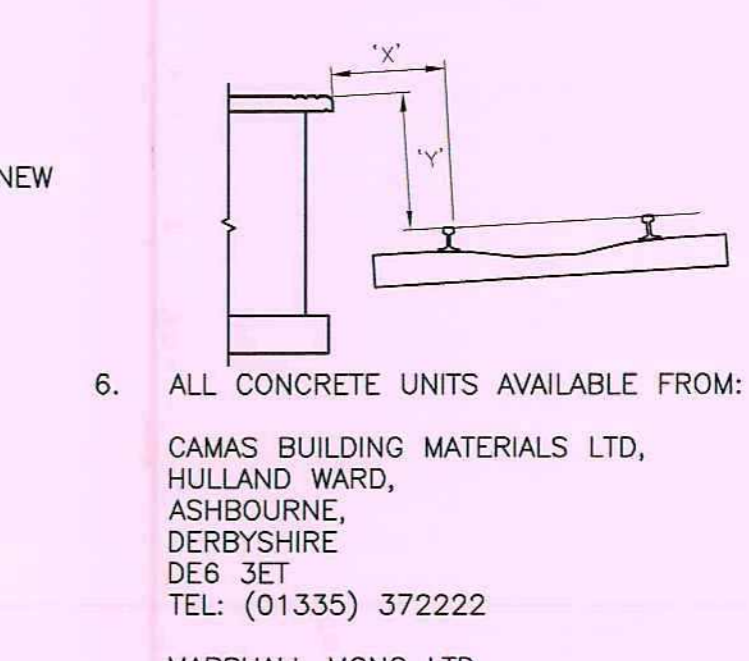

- ALL CONCRETE UNITS AVAILABLE FROM:  
GAMAS BUILDING MATERIALS LTD, HULLAND WARD, ASHBORNE, DERBYSHIRE DEB 3ET  
TEL: (01335) 372222  
MARSHALL MONO LTD, SOUTHWRAM, HALIFAX, WEST YORKSHIRE HA16 8XB  
TEL: (01565) 750147  
S. G. BALDWIN TARMAC PRECAST CONCRETE LIMITED, TALLINGTON, STAMFORD LINCOLNSHIRE PE9 4RL  
TEL: (01778) 345455  
MARLEY BUILDING MATERIALS LTD, STATION ROAD, COLESHILL, BIRMINGHAM, B46 1HP  
TEL: (01675) 468400

- PLATFORM SURFACING TO BE DENSE BITUMEN MACADAM: 20 THICK WEARING COURSE (6# NOMINAL AGGREGATE SIZE) 60 THICK BASE COURSE (20# NOMINAL AGGREGATE SIZE).
- BRICKWORK TO PLATFORM WALLS TO BE 215x102x65 FACING BRICK TO MATCH EXISTING. MIN. COMPRESSIVE STRENGTH 10N/mm<sup>2</sup> WITH CLASS 1 MORTAR TO BS5628 - PART 1:1992.
- DENSOBAND JOINT SEALER TO BE USED IN ACCORDANCE WITH THE MANUFACTURERS INSTRUCTIONS & IS AVAILABLE FROM:  
WINN & COALES (DENSO) LTD, DENSO HOUSE, CHAPEL ROAD, LONDON, SE27 0TR  
Tel: (0208) 670 7511

- ALL TUBULAR SECTIONS TO BE HOT FINISHED HOLLOW SECTION, TO BS EN 10 210 GRADE S355J2H OR EQUIVALENT. ALL CHANNELS, ANGLES AND PLATE TO BE BS EN 10 025 GRADE S275J0.
- ALL STEEL TO BE HOT DIP GALVANISED TO BS EN ISO 1461.
- BOLTS AND WASHERS ARE HOT DIP GALVANISED TO BS EN ISO 1461 UNLESS STATED OTHERWISE.
- ALL WELDS TO BE 6MM CONTINUOUS FILLET WELDS UNLESS STATED OTHERWISE. ALL WELDS TO BE MADE IN FACTORY CONDITIONS OFF-SITE.
- STEELWORK TO RECEIVE RT98 PROTECTIVE SYSTEM IN MICACEOUS IRON OXIDE TO GIVE AN ANTI-GRAFFITI, LOW SHEEN FINISH FINAL COLOUR TO BE DETERMINED

- NOTES
- THE PLATFORM IS DESIGNED TO CARRY A UNIFORMLY DISTRIBUTED LOAD OF 5kN/m<sup>2</sup>. THIS SHOULD BE CONSIDERED WHEN THE TYPE & WEIGHT OF PLANT TO BE USED IS DETERMINED.
  - 'LOCKSETS 25', THIOFLEX 600 & 'HYDROCELL XL' ARE AVAILABLE FROM:  
FOSROC LIMITED, COLESHILL ROAD, TAMWORTH, STAFFORDSHIRE, B78 3TL  
Tel: (01827) 262222
  - CONCRETE WALL FOUNDATION TO BE FND2 IN ACCORDANCE WITH BS 8500.
  - DATUM PLATES ON PLATFORM WALL TO BE ERECTED IN ACCORDANCE WITH RAILWAY GROUP STANDARD GC/RT 5212. REQUIREMENTS FOR DEFINING AND MAINTAINING CLEARANCES. FOLLOWING COMPLETION OF PLATFORM DATUM PLATES TO BE INSTALLED AT EVERY 20m. PLATES TO BE SET AND MARKED TO RETAIN EXISTING TRACK ALIGNMENT AND LEVEL. TRACK DATUM PLATES AVAILABLE FROM:  
PLATE & LOCATE 5 THE GROVE, PARKGATE INDUSTRIAL ESTATE, KNUTSFORD, CHESHIRE WA16 8XB  
Tel: 01565 750147  
(OR SIMILAR APPROVED SUPPLIER) PLATES TO BE SECURELY MECHANICALLY FIXED TO PLATFORM WALL.
  - PLATFORM FRONT WALL TO HAVE FULLY FILLED VERTICAL AND HORIZONTAL JOINTS. BEDDING FOR COPINGS AND FOR VERTICAL INFILLING BETWEEN COPINGS TO HAVE A WATERPROOF ADDITIVE AND BE FULL DEPTH FILLED ON THE VERTICAL JOINTS.
  - WHERE ANY PRODUCTS OR MATERIALS ARE SPECIFIED THE CONTRACTOR MAY USE OTHER PRODUCTS OR MATERIALS OF EQUAL OR BETTER QUALITY, PERFORMANCE & APPEARANCE, SUBJECT TO APPROVAL.
  - CHANNEL DRAINAGE SYSTEMS SHOULD BE ACO NI100K RESIN CONCRETE CHANNELS OR SIMILAR APPROVED. IN ACCORDANCE WITH BS EN752 AND BS EN1433. SPECIFIED FOR LOAD CLASS A15 AND WITH SLOTTED GALVANISED STEEL GRATINGS. CHANNELS AVAILABLE FROM:  
ACO TECHNOLOGIES PLC ACO BUSINESS PARK HITCHIN ROAD SHEFFORD BEDFORDSHIRE SG17 5TE

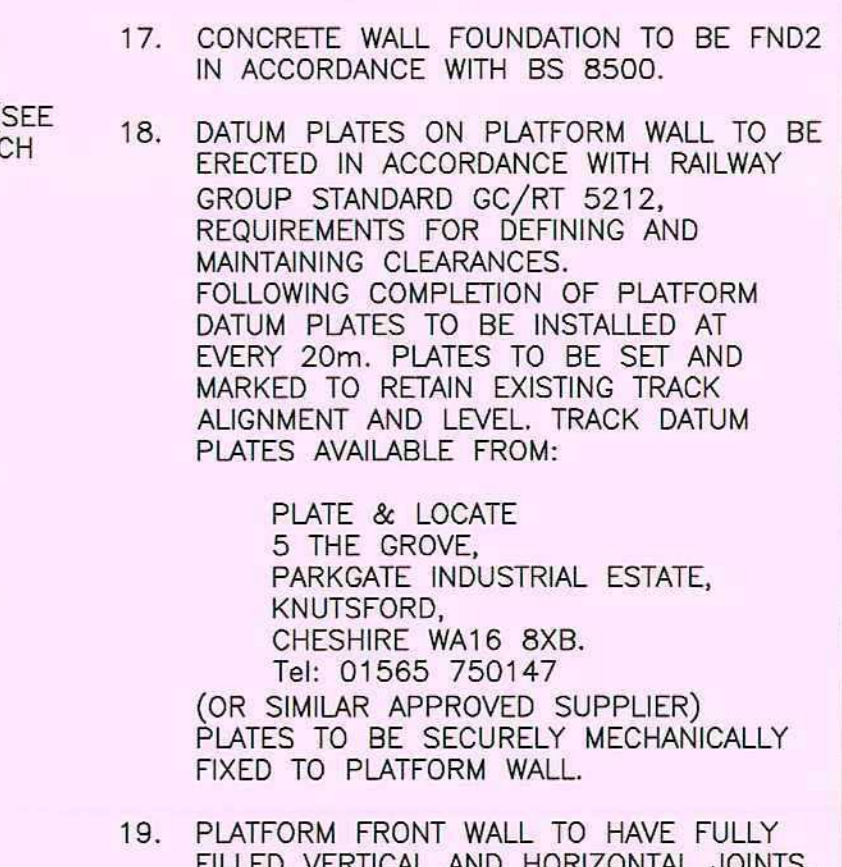

- ALL TUBULAR SECTIONS TO BE HOT FINISHED HOLLOW SECTION, TO BS EN 10 210 GRADE S355J2H OR EQUIVALENT. ALL CHANNELS, ANGLES AND PLATE TO BE BS EN 10 025 GRADE S275J0.
- ALL STEEL TO BE HOT DIP GALVANISED TO BS EN ISO 1461.
- BOLTS AND WASHERS ARE HOT DIP GALVANISED TO BS EN ISO 1461 UNLESS STATED OTHERWISE.
- ALL WELDS TO BE 6MM CONTINUOUS FILLET WELDS UNLESS STATED OTHERWISE. ALL WELDS TO BE MADE IN FACTORY CONDITIONS OFF-SITE.
- STEELWORK TO RECEIVE RT98 PROTECTIVE SYSTEM IN MICACEOUS IRON OXIDE TO GIVE AN ANTI-GRAFFITI, LOW SHEEN FINISH FINAL COLOUR TO BE DETERMINED

- ALL TUBULAR SECTIONS TO BE HOT FINISHED HOLLOW SECTION, TO BS EN 10 210 GRADE S355J2H OR EQUIVALENT. ALL CHANNELS, ANGLES AND PLATE TO BE BS EN 10 025 GRADE S275J0.
- ALL STEEL TO BE HOT DIP GALVANISED TO BS EN ISO 1461.
- BOLTS AND WASHERS ARE HOT DIP GALVANISED TO BS EN ISO 1461 UNLESS STATED OTHERWISE.
- ALL WELDS TO BE 6MM CONTINUOUS FILLET WELDS UNLESS STATED OTHERWISE. ALL WELDS TO BE MADE IN FACTORY CONDITIONS OFF-SITE.
- STEELWORK TO RECEIVE RT98 PROTECTIVE SYSTEM IN MICACEOUS IRON OXIDE TO GIVE AN ANTI-GRAFFITI, LOW SHEEN FINISH FINAL COLOUR TO BE DETERMINED

Rev.	Date	Descriptions of Revision	Des.	Chkd.	Appr.
26	03/09/08	DOWN SIDE REVISED TO 1:2	KB	ACH	MRP

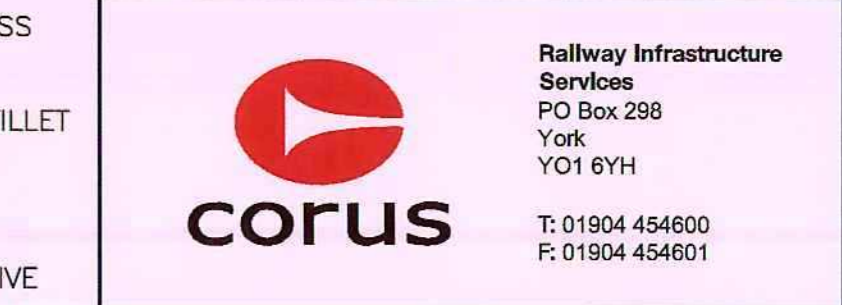

PLANNING APPLICATION

Designed	K.BRISTOWE	Checked	R.HISEMAN
Approved	M.R.PARKER	Date	22/10/08

ELR: SMJ @ 16 Miles 56 Ch.  
BOLTON-ON-DEARNE STATION  
PROPOSED CLOSURE OF FOOT CROSSING

Scale	AS SHOWN	CAD	KB
Drawing Number	B50034-213	Revision	A

DO NOT SCALE

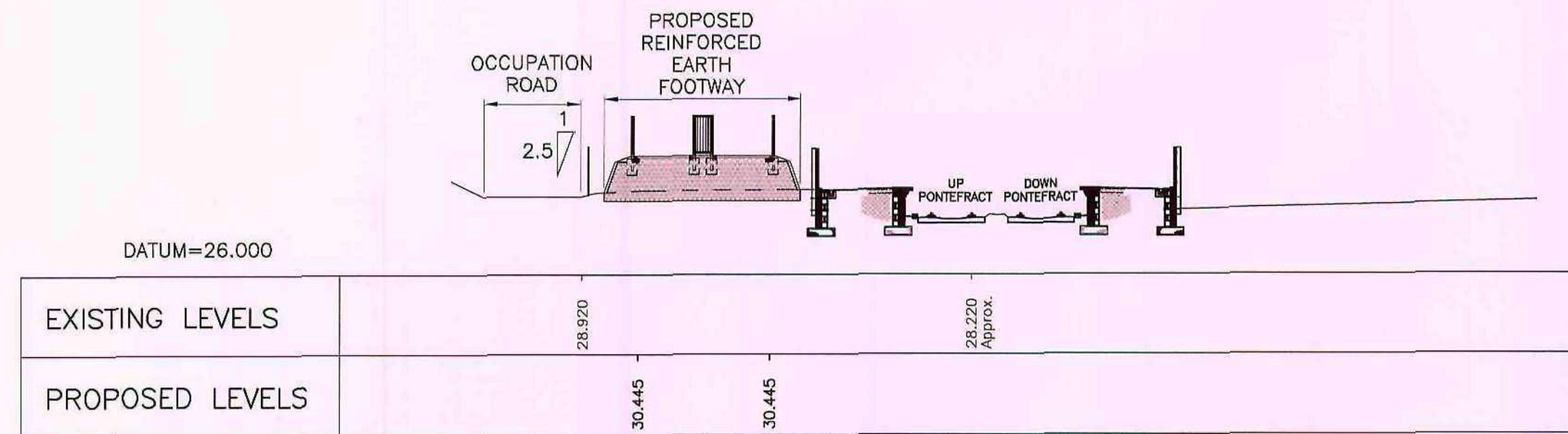

SECTION A-A  
SCALE 1:200

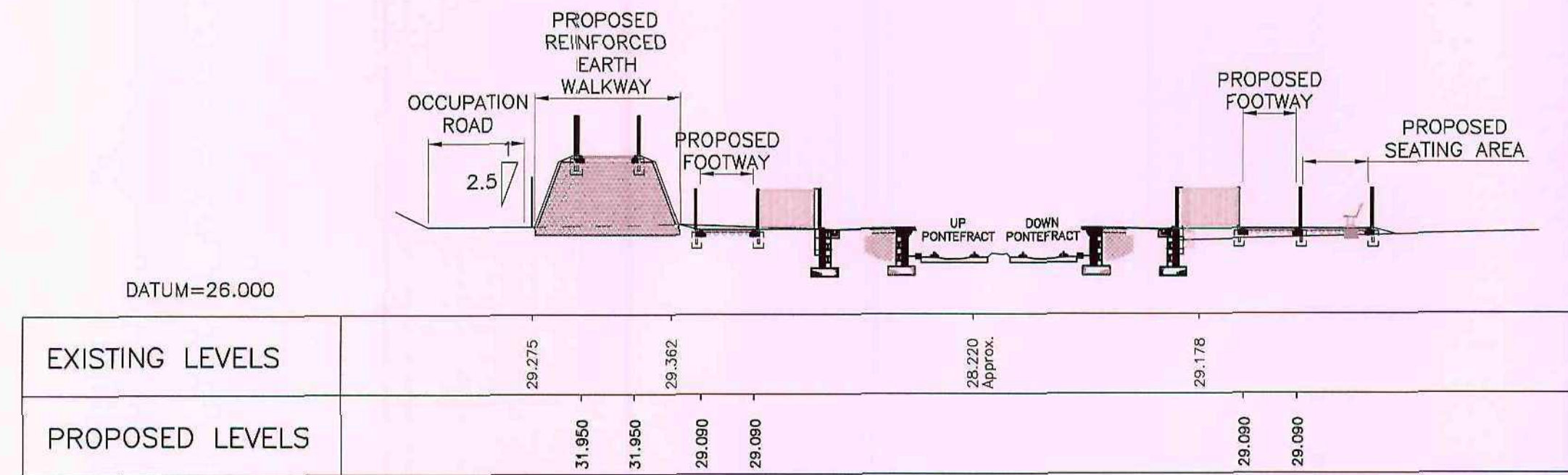

SECTION B-B  
SCALE 1:200

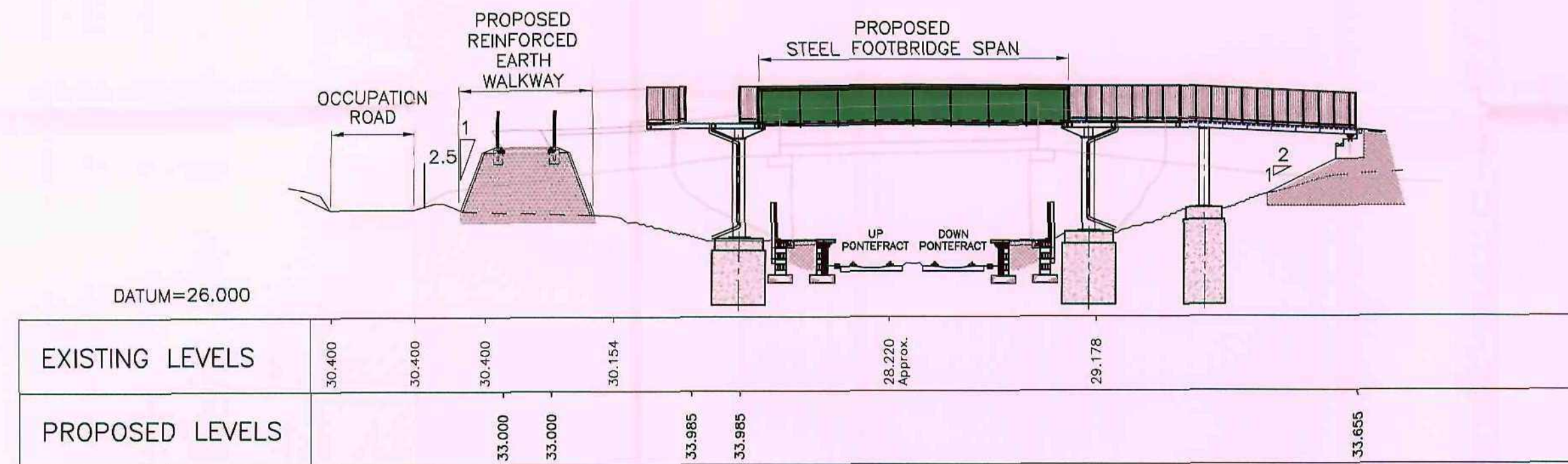

SECTION C-C  
SCALE 1:200

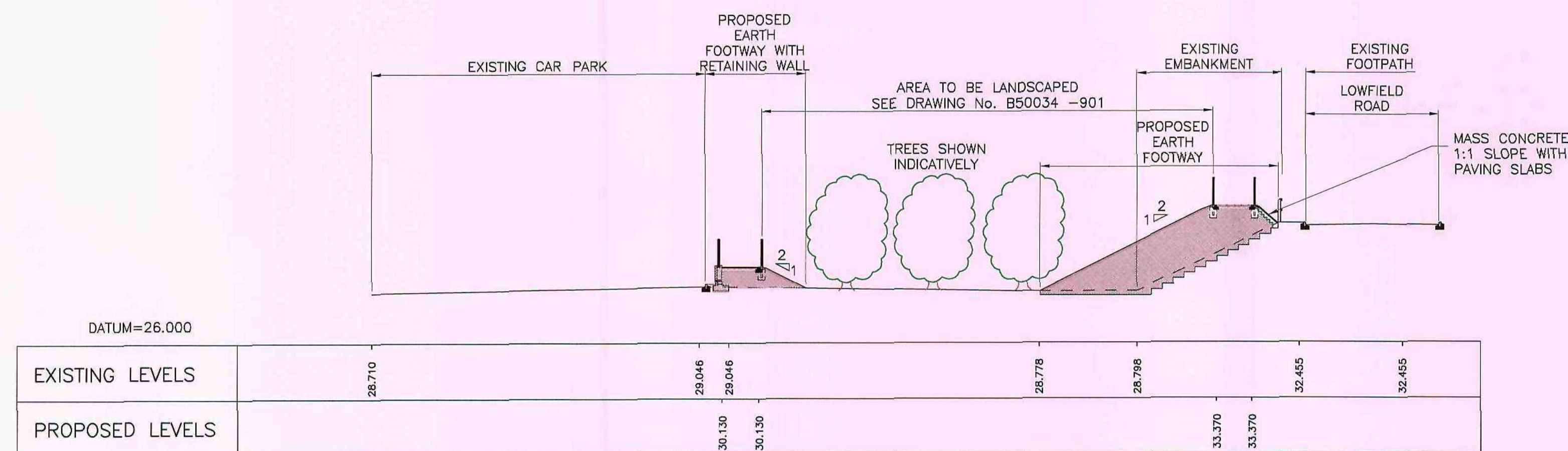

SECTION D-D  
SCALE 1:200

NOTES

1. ALL DIMENSIONS ARE IN MILLIMETRES, UNLESS STATED OTHERWISE.
2. ALL LEVELS ARE IN METRES AND RELATE TO AN OBM LOCATED ON O/B 73 (VALUE=33.510).
3. BOLTON-ON-DEARNE STATION FOOT CROSSING LOCATED ON THE YORK / LEEDS TO SHEFFIELD LINE, ENGINEERS LINE REFERENCE (ELR) SMJ2 AT 16 MILES 56 CHAINS, ORDNANCE SURVEY GRID REFERENCE SE 457 027.
4. THE FOOTBRIDGE RAMP AND FOOTWAY ARRANGEMENT IS BASED UPON A RAIL TO FOOTBRIDGE SOFFIT HEIGHT OF 5.45m. FOR DETAILS OF FOOTBRIDGE AND STAIRS SEE DRAWING No. B50034-710.
5. FOR LOCATIONS OF CROSS SECTIONS SEE DRAWING No. B50034-211 - PROPOSED GENERAL ARRANGEMENT.

Barnsley Metropolitan Borough Council  
14 MAY 2008  
Corporate Mail Room

A	26	DOWN SIDE REVISED TO 1:2	KB	ACH	MRP
	03	EARTH EMBANKMENTS			
	09				
Rev.	Date	Descriptions of Revision	Des.	Chkd.	Appr.

**Network Rail**  
Network Rail  
London North Eastern  
Territory  
Infrastructure Enhancements  
George Stephenson House  
Toft Green, York  
YO1 6JT

**CORUS**  
Railway Infrastructure  
Services  
PO Box 298  
York  
YO1 6YH  
T: 01904 454600  
F: 01904 454601

Status  
**PLANNING APPLICATION**

Designed	K. BRISTOWE	Checked	R. HISEMAN
Approved	M. R. PARKER	Date	22/10/08

ELR: SMJ2 @ 16 Miles 56 Ch.  
BOLTON-ON-DEARNE STATION  
PROPOSED CLOSURE OF FOOT CROSSING  
PROPOSED SECTIONS

Scales	AS SHOWN	CAD	KB
CAD Ref.	B50034-211, 212, 213, 214, 215, 216, 217, 218, 219, 220, 221, 222, 223, 224, 225, 226, 227, 228, 229, 230, 231, 232, 233, 234, 235, 236, 237, 238, 239, 240, 241, 242, 243, 244, 245, 246, 247, 248, 249, 250, 251, 252, 253, 254, 255, 256, 257, 258, 259, 260, 261, 262, 263, 264, 265, 266, 267, 268, 269, 270, 271, 272, 273, 274, 275, 276, 277, 278, 279, 280, 281, 282, 283, 284, 285, 286, 287, 288, 289, 290, 291, 292, 293, 294, 295, 296, 297, 298, 299, 300, 301, 302, 303, 304, 305, 306, 307, 308, 309, 310, 311, 312, 313, 314, 315, 316, 317, 318, 319, 320, 321, 322, 323, 324, 325, 326, 327, 328, 329, 330, 331, 332, 333, 334, 335, 336, 337, 338, 339, 340, 341, 342, 343, 344, 345, 346, 347, 348, 349, 350, 351, 352, 353, 354, 355, 356, 357, 358, 359, 360, 361, 362, 363, 364, 365, 366, 367, 368, 369, 370, 371, 372, 373, 374, 375, 376, 377, 378, 379, 380, 381, 382, 383, 384, 385, 386, 387, 388, 389, 390, 391, 392, 393, 394, 395, 396, 397, 398, 399, 400, 401, 402, 403, 404, 405, 406, 407, 408, 409, 410, 411, 412, 413, 414, 415, 416, 417, 418, 419, 420, 421, 422, 423, 424, 425, 426, 427, 428, 429, 430, 431, 432, 433, 434, 435, 436, 437, 438, 439, 440, 441, 442, 443, 444, 445, 446, 447, 448, 449, 450, 451, 452, 453, 454, 455, 456, 457, 458, 459, 460, 461, 462, 463, 464, 465, 466, 467, 468, 469, 470, 471, 472, 473, 474, 475, 476, 477, 478, 479, 480, 481, 482, 483, 484, 485, 486, 487, 488, 489, 490, 491, 492, 493, 494, 495, 496, 497, 498, 499, 500, 501, 502, 503, 504, 505, 506, 507, 508, 509, 510, 511, 512, 513, 514, 515, 516, 517, 518, 519, 520, 521, 522, 523, 524, 525, 526, 527, 528, 529, 530, 531, 532, 533, 534, 535, 536, 537, 538, 539, 540, 541, 542, 543, 544, 545, 546, 547, 548, 549, 550, 551, 552, 553, 554, 555, 556, 557, 558, 559, 560, 561, 562, 563, 564, 565, 566, 567, 568, 569, 570, 571, 572, 573, 574, 575, 576, 577, 578, 579, 580, 581, 582, 583, 584, 585, 586, 587, 588, 589, 590, 591, 592, 593, 594, 595, 596, 597, 598, 599, 600, 601, 602, 603, 604, 605, 606, 607, 608, 609, 610, 611, 612, 613, 614, 615, 616, 617, 618, 619, 620, 621, 622, 623, 624, 625, 626, 627, 628, 629, 630, 631, 632, 633, 634, 635, 636, 637, 638, 639, 640, 641, 642, 643, 644, 645, 646, 647, 648, 649, 650, 651, 652, 653, 654, 655, 656, 657, 658, 659, 660, 661, 662, 663, 664, 665, 666, 667, 668, 669, 670, 671, 672, 673, 674, 675, 676, 677, 678, 679, 680, 681, 682, 683, 684, 685, 686, 687, 688, 689, 690, 691, 692, 693, 694, 695, 696, 697, 698, 699, 700, 701, 702, 703, 704, 705, 706, 707, 708, 709, 710, 711, 712, 713, 714, 715, 716, 717, 718, 719, 720, 721, 722, 723, 724, 725, 726, 727, 728, 729, 730, 731, 732, 733, 734, 735, 736, 737, 738, 739, 740, 741, 742, 743, 744, 745, 746, 747, 748, 749, 750, 751, 752, 753, 754, 755, 756, 757, 758, 759, 760, 761, 762, 763, 764, 765, 766, 767, 768, 769, 770, 771, 772, 773, 774, 775, 776, 777, 778, 779, 780, 781, 782, 783, 784, 785, 786, 787, 788, 789, 790, 791, 792, 793, 794, 795, 796, 797, 798, 799, 800, 801, 802, 803, 804, 805, 806, 807, 808, 809, 810, 811, 812, 813, 814, 815, 816, 817, 818, 819, 820, 821, 822, 823, 824, 825, 826, 827, 828, 829, 830, 831, 832, 833, 834, 835, 836, 837, 838, 839, 840, 841, 842, 843, 844, 845, 846, 847, 848, 849, 850, 851, 852, 853, 854, 855, 856, 857, 858, 859, 860, 861, 862, 863, 864, 865, 866, 867, 868, 869, 870, 871, 872, 873, 874, 875, 876, 877, 878, 879, 880, 881, 882, 883, 884, 885, 886, 887, 888, 889, 890, 891, 892, 893, 894, 895, 896, 897, 898, 899, 900, 901, 902, 903, 904, 905, 906, 907, 908, 909, 910, 911, 912, 913, 914, 915, 916, 917, 918, 919, 920, 921, 922, 923, 924, 925, 926, 927, 928, 929, 930, 931, 932, 933, 934, 935, 936, 937, 938, 939, 940, 941, 942, 943, 944, 945, 946, 947, 948, 949, 950, 951, 952, 953, 954, 955, 956, 957, 958, 959, 960, 961, 962, 963, 964, 965, 966, 967, 968, 969, 970, 971, 972, 973, 974, 975, 976, 977, 978, 979, 980, 981, 982, 983, 984, 985, 986, 987, 988, 989, 990, 991, 992, 993, 994, 995, 996, 997, 998, 999, 1000		
Drawing Number	B50034-212	Revision	A

DO NOT SCALE

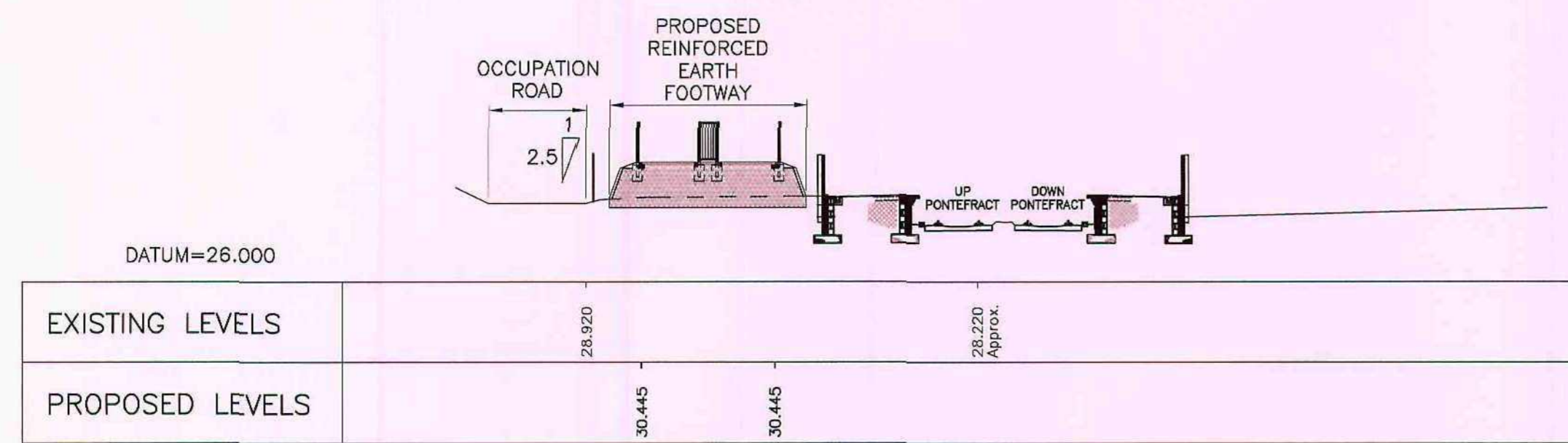

SECTION A-A  
SCALE 1:200

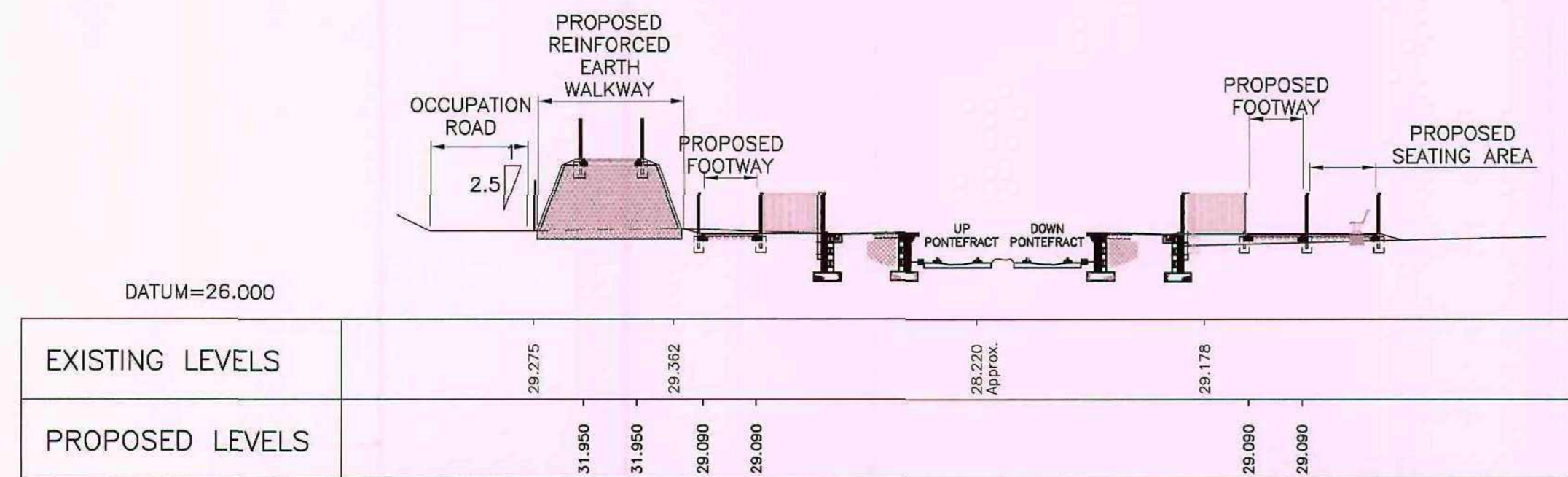

SECTION B-B  
SCALE 1:200

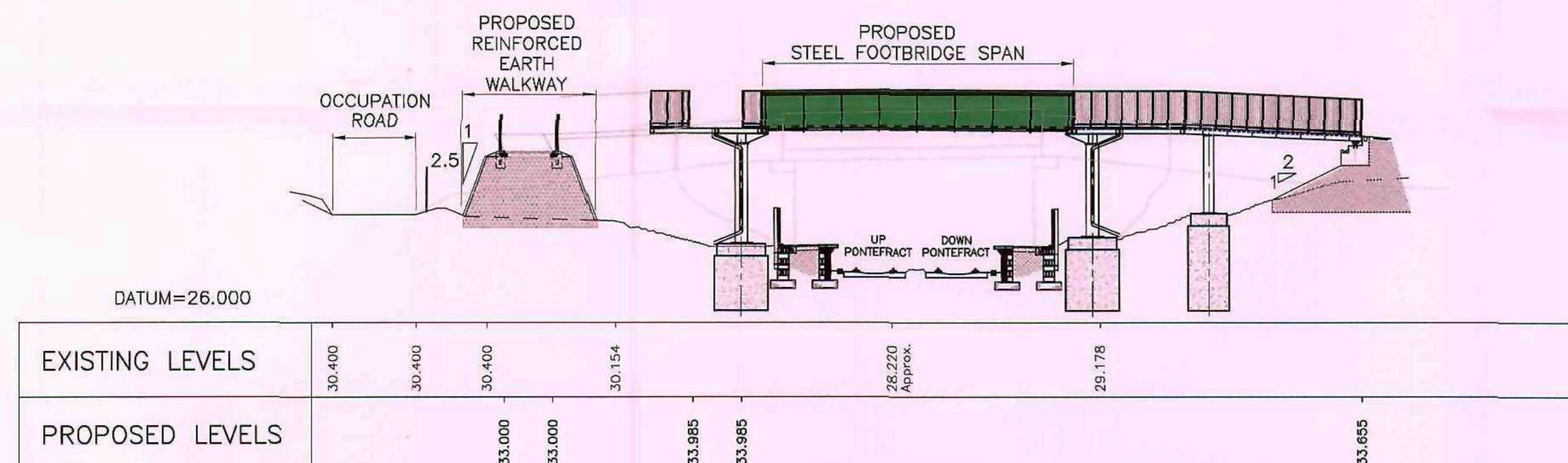

SECTION C-C  
SCALE 1:200

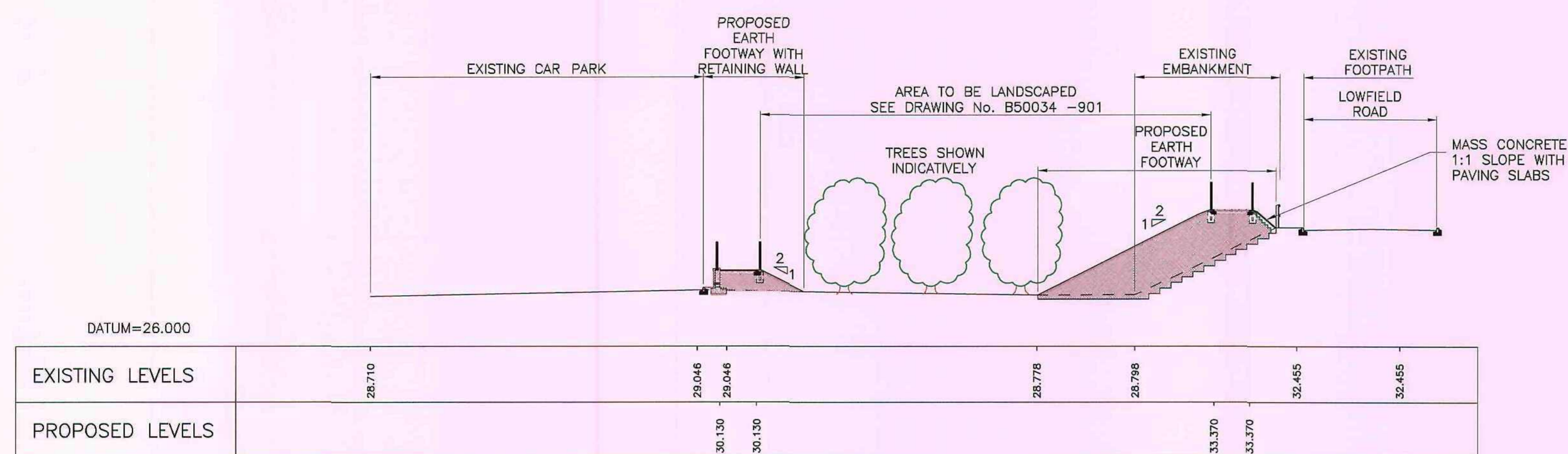

SECTION D-D  
SCALE 1:200

- NOTES
1. ALL DIMENSIONS ARE IN MILLIMETRES, UNLESS STATED OTHERWISE.
  2. ALL LEVELS ARE IN METRES AND RELATE TO AN OBM LOCATED ON O/B 73 (VALUE=33.510).
  3. BOLTON-ON-DEARNE STATION FOOT CROSSING LOCATED ON THE YORK / LEEDS TO SHEFFIELD LINE, ENGINEERS LINE REFERENCE (ELR) SMJ2 AT 16 MILES 56 CHAINS, ORDNANCE SURVEY GRID REFERENCE SE 457 027.
  4. THE FOOTBRIDGE RAMP AND FOOTWAY ARRANGEMENT IS BASED UPON A RAIL TO FOOTBRIDGE SOFFIT HEIGHT OF 5.45m. FOR DETAILS OF FOOTBRIDGE AND STAIRS SEE DRAWING No. B50034-710.
  5. FOR LOCATIONS OF CROSS SECTIONS SEE DRAWING No. B50034-211 - PROPOSED GENERAL ARRANGEMENT.

Barnsley Metropolitan  
Borough  
18 May 2009  
Corporate Mail Room

A	26	DOWN SIDE REVISED TO 1:2	KB	ACH	MRP
Rev	Date	Descriptions of Revision	Des.	Chkd.	Appr.

Client

Network Rail  
London North Eastern  
Territory  
Infrastructure Enhancements  
George Stephenson House  
Toll Green, York  
YO1 6JT

Railway Infrastructure  
Services  
PO Box 298  
York  
YO1 6YH  
T: 01904 454600  
F: 01904 454601

Status  
**PLANNING APPLICATION**

Designed	K.BRISTOWE	Checked	R.HISEMAN
Approved	M.R.PARKER	Date	22/10/08

ELR: SMJ2 @ 16 Miles 56 Ch.  
BOLTON-ON-DEARNE STATION  
PROPOSED CLOSURE OF FOOT CROSSING  
PROPOSED SECTIONS

Scales	AS SHOWN	CAD	KB
CAD Ref.	© 2008 Network Rail Infrastructure Services Ltd. Drawing No. B50034-212, 213, 214 and 215 Planning App		
Drawing Number	B50034-212	Revision	A

DO NOT SCALE