

1) This drawing and the design and details depicted thereon are the copyright of Peter Dimberline Chartered Architect.
 2) All dimensions on this drawing are to be checked by the Contractor and any discrepancies are to be reported to the Architect.
 3) Do not scale critical dimensions off this drawing.
 4) Contractor to ensure that all Health & Safety requirements (CDM Regulations) in relation to this project will be complied with.

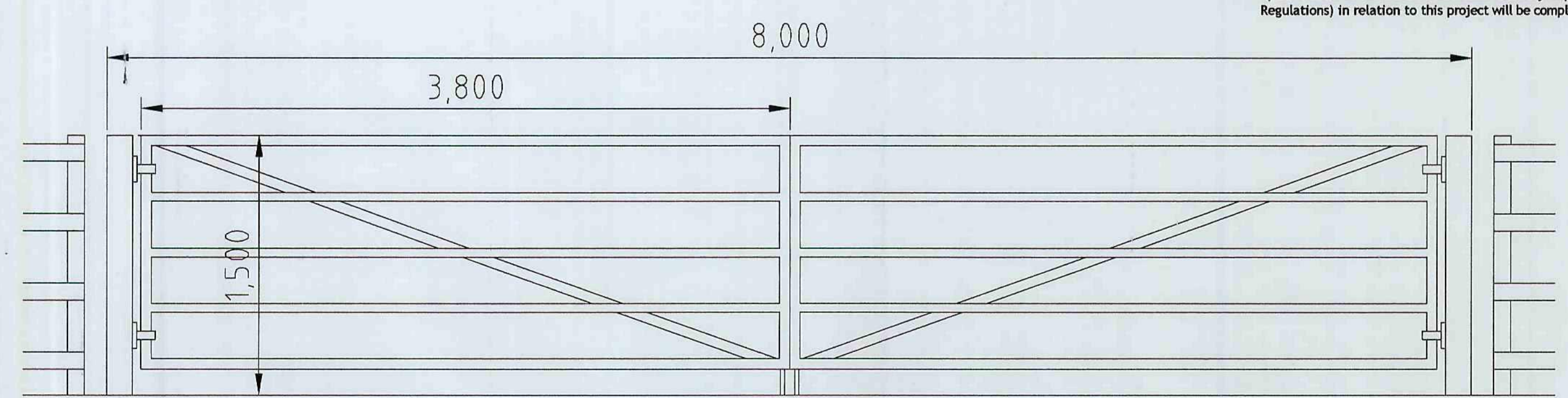

Elevation on new pair of metal security gates 1:25

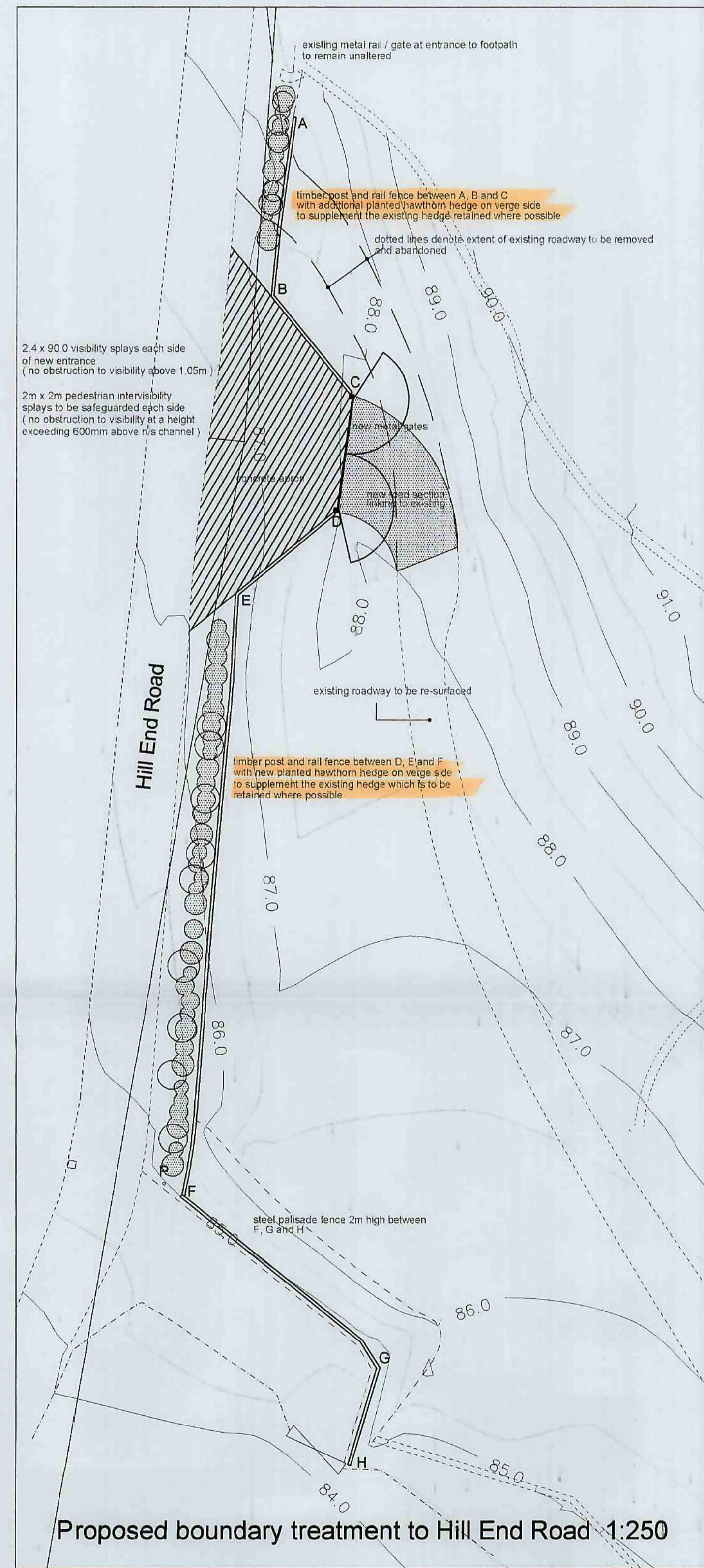
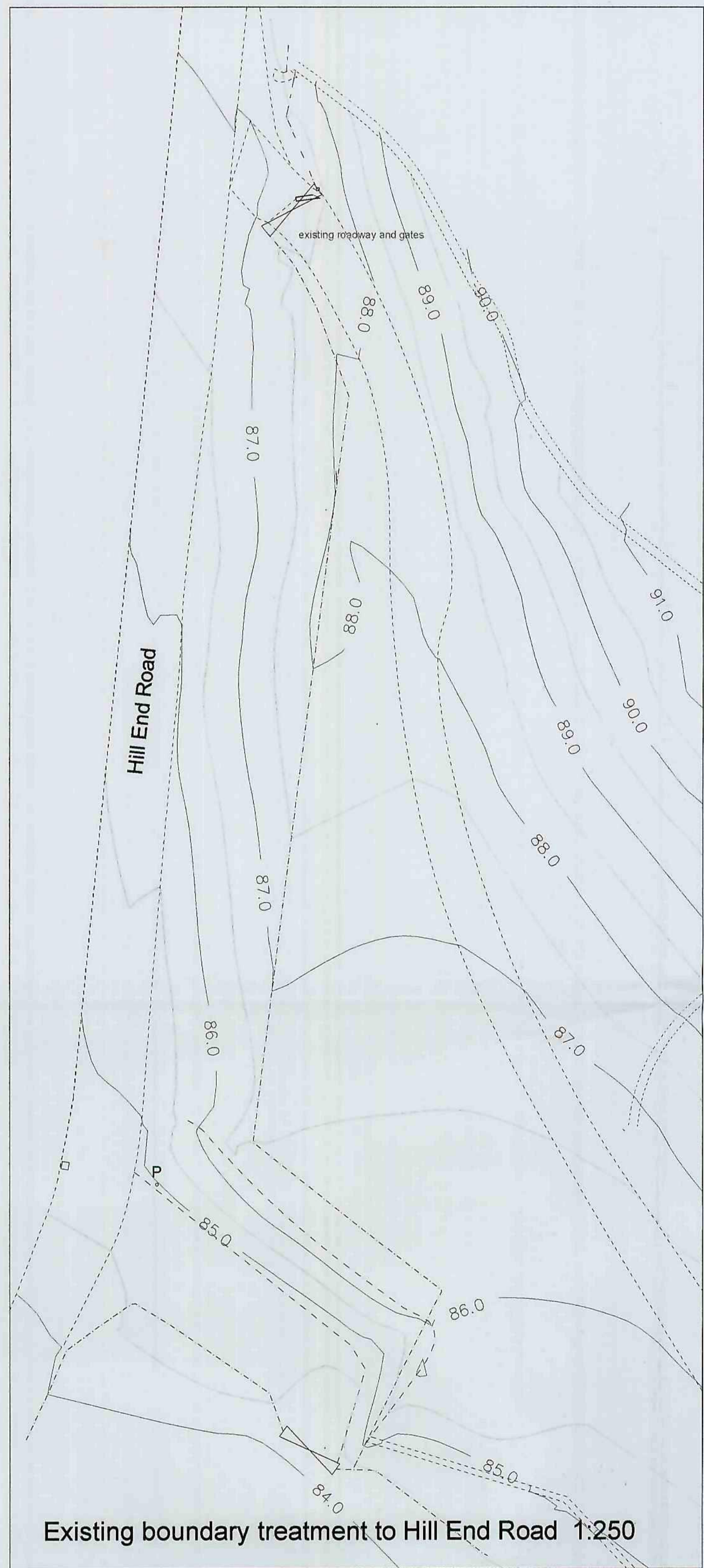
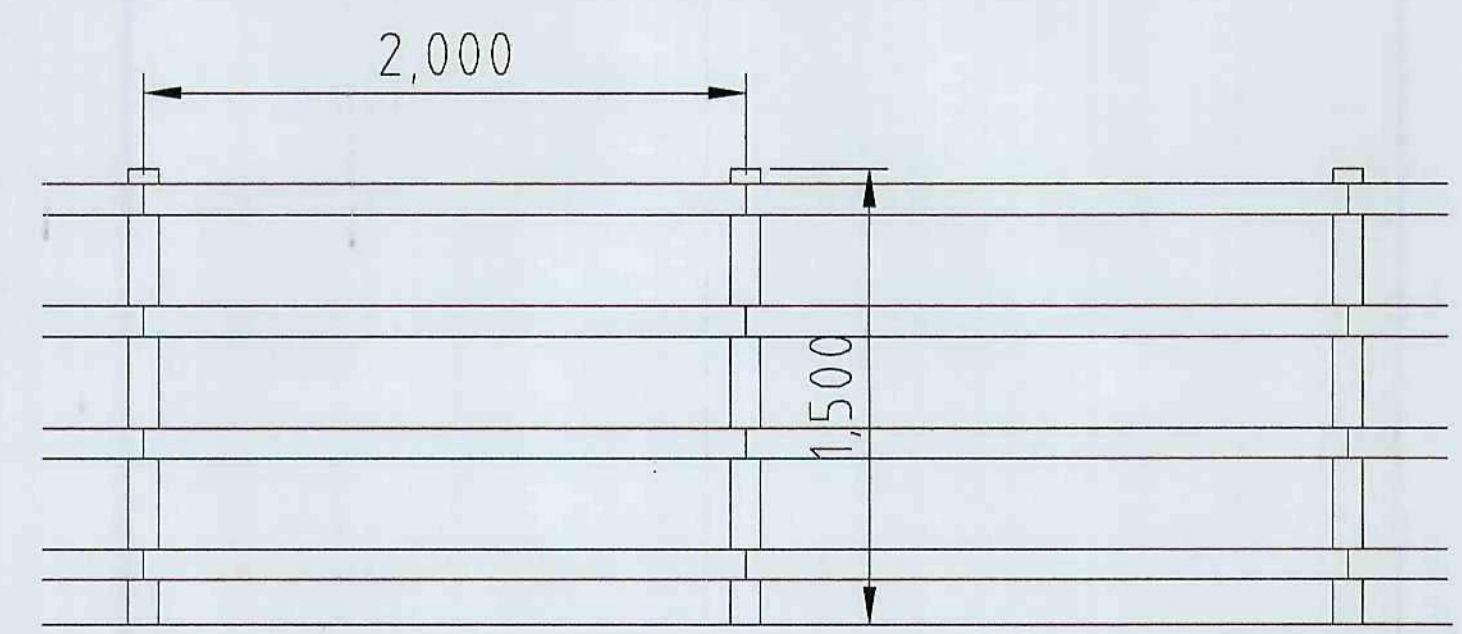

Elevation to timber post and rail fence 1:25

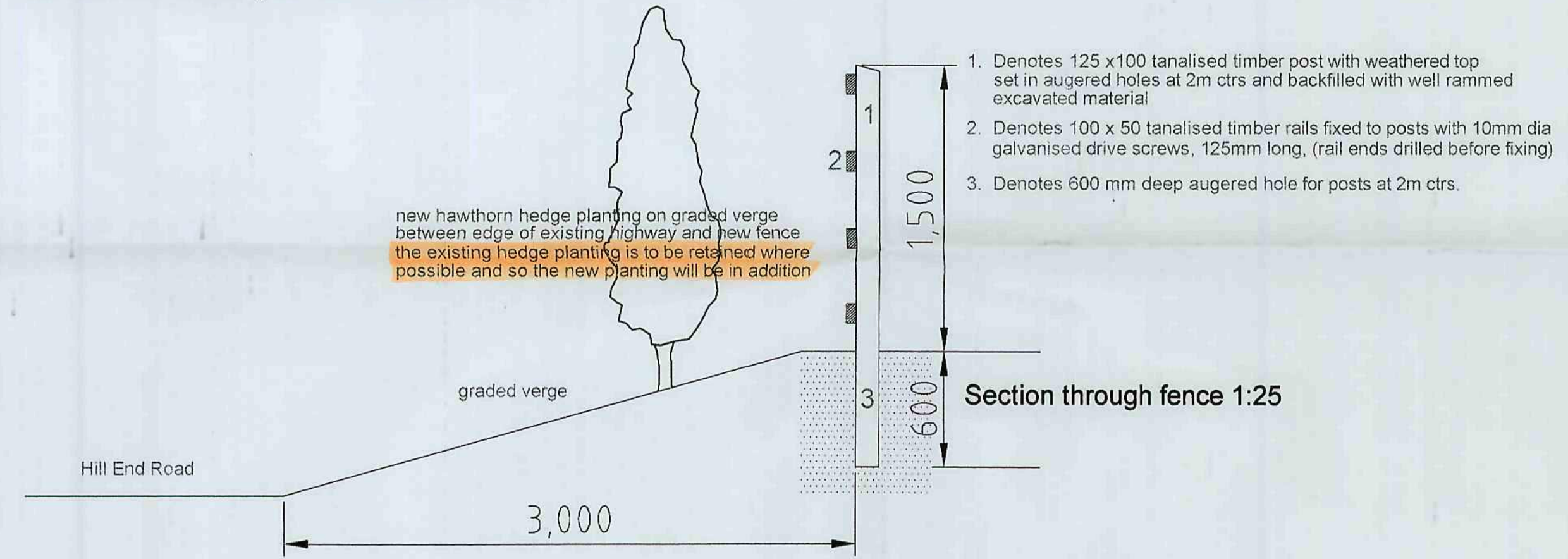

Section through fence 1:25

Typical section through upgraded tracks 1:25

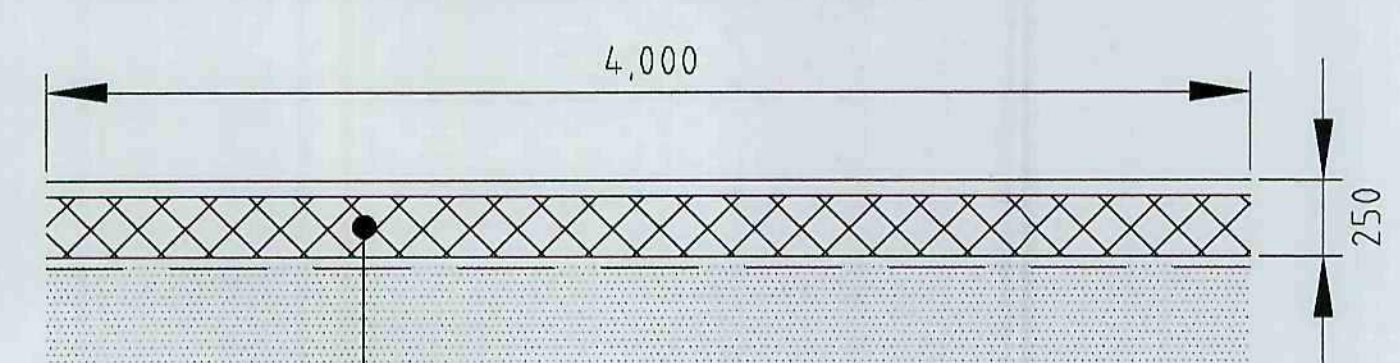

Approx 300mm depth of top soil is to be removed from the surface of the existing tracks and a Geo-Textile membrane is to be laid over width of track prior to a 200mm thick layer of well compacted Class 1 limestone surfaced with a 50mm layer of clean self draining tarmac road planings

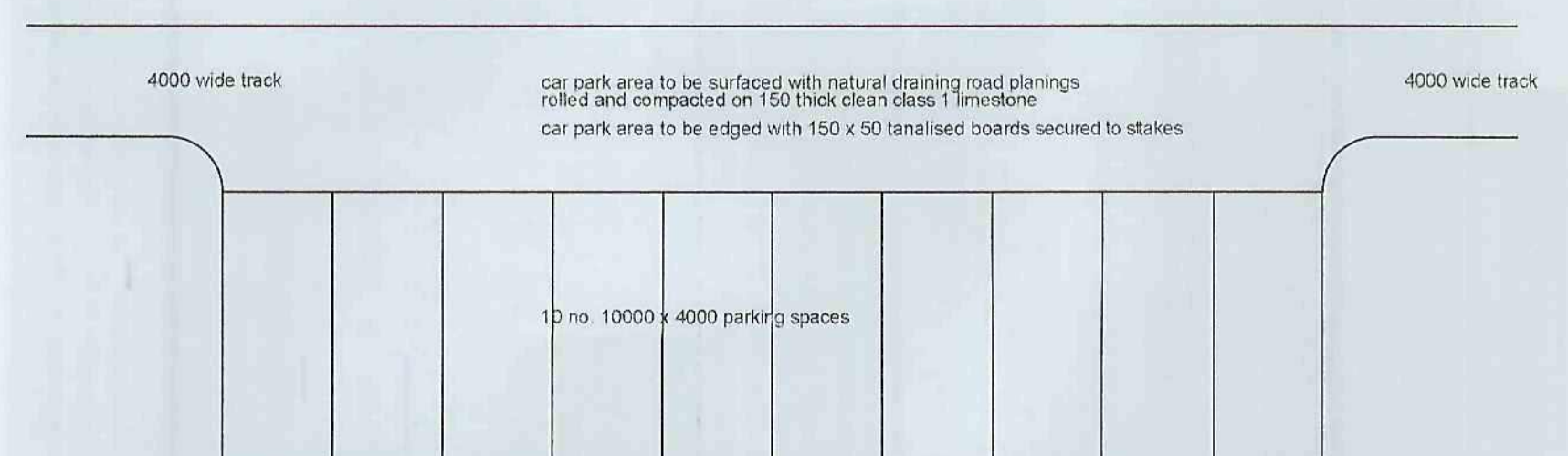

Proposed car park area 'A' (10 no. spaces for horsebox & vehicle)

Proposed car park layouts 1:250

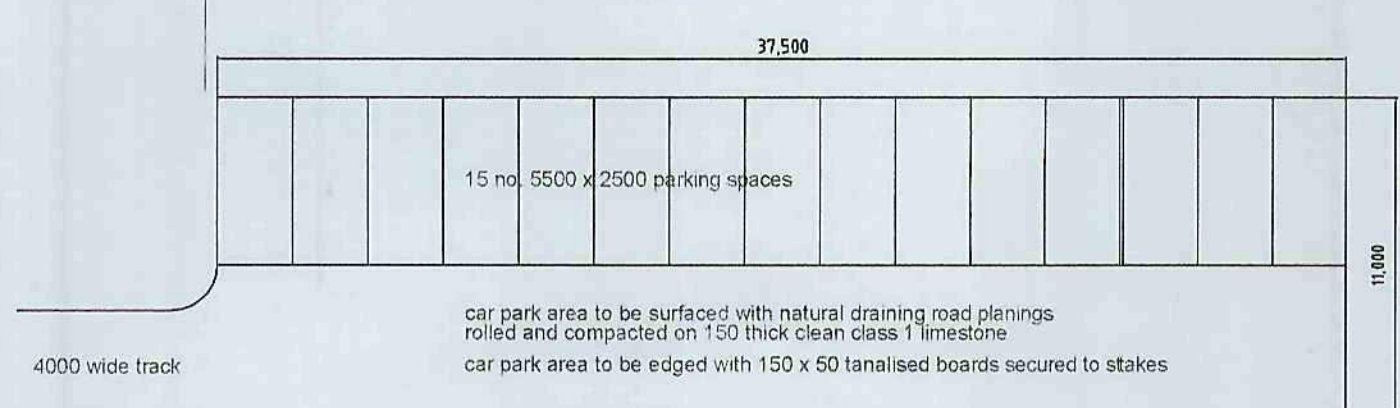

Proposed car park area 'B' (15 no. spaces)

REVISIONS

PETER DIMBERLINE Dip. Arch, RIBA
CHARTERED ARCHITECT
 2 TIPSEY COURT, STAINCROSS
 BARNSELEY, S75 6FZ
 tel/fax (01226) 390947
 email: pdimberline@tiscali.co.uk

CLIENT
 Northern Services Ltd

PROJECT
 Proposed boundary treatment, new access and re-surfacing of existing tracks

LOCATION
 Site off Hill End Road, Mapplewell, Barnsley S75 6DX

DRAWING
 Details of boundary treatment and new access

SCALE 1:250, 1:25, DATE Nov. '11

DRWG No. 2011/013/01 DRAWN BY PD

REV.