

PLANTING NOTES

Subsoil: Should be ripped and free draining

Topsoil: Planted areas to be cultivated to an approximate depth of 150mm prior to planting (any existing weedgrowth to be treated with a Glyphosate based herbicide no less than 14 days prior to cultivation).

Trees: To be planted it pits exceeding dimensions of root system by 100mm in each direction. Bottom of pit to be broken up to aid drainage. Peat free compost to be incorporated into the backfill. Trees to be secured using 75mm diameter pressure treated timber stake and tied at low level. Trees should not be planted within 5m of a building. Root barrier to be installed where trees planted adjacent services.

Shrubs: To be planted it pits exceeding dimensions of root system by 50mm in each direction. Peat free compost to be incorporated into the backfill.

Bark mulch: Planted areas to be dressed with bark mulch to a settled depth of 50mm.

General: All planting material to be true to type and size and in accordance with BS 3969-1 1992. Plant stock to be watered to field capacity on completion of works and watered regularly especially during periods of warm/dry weather.

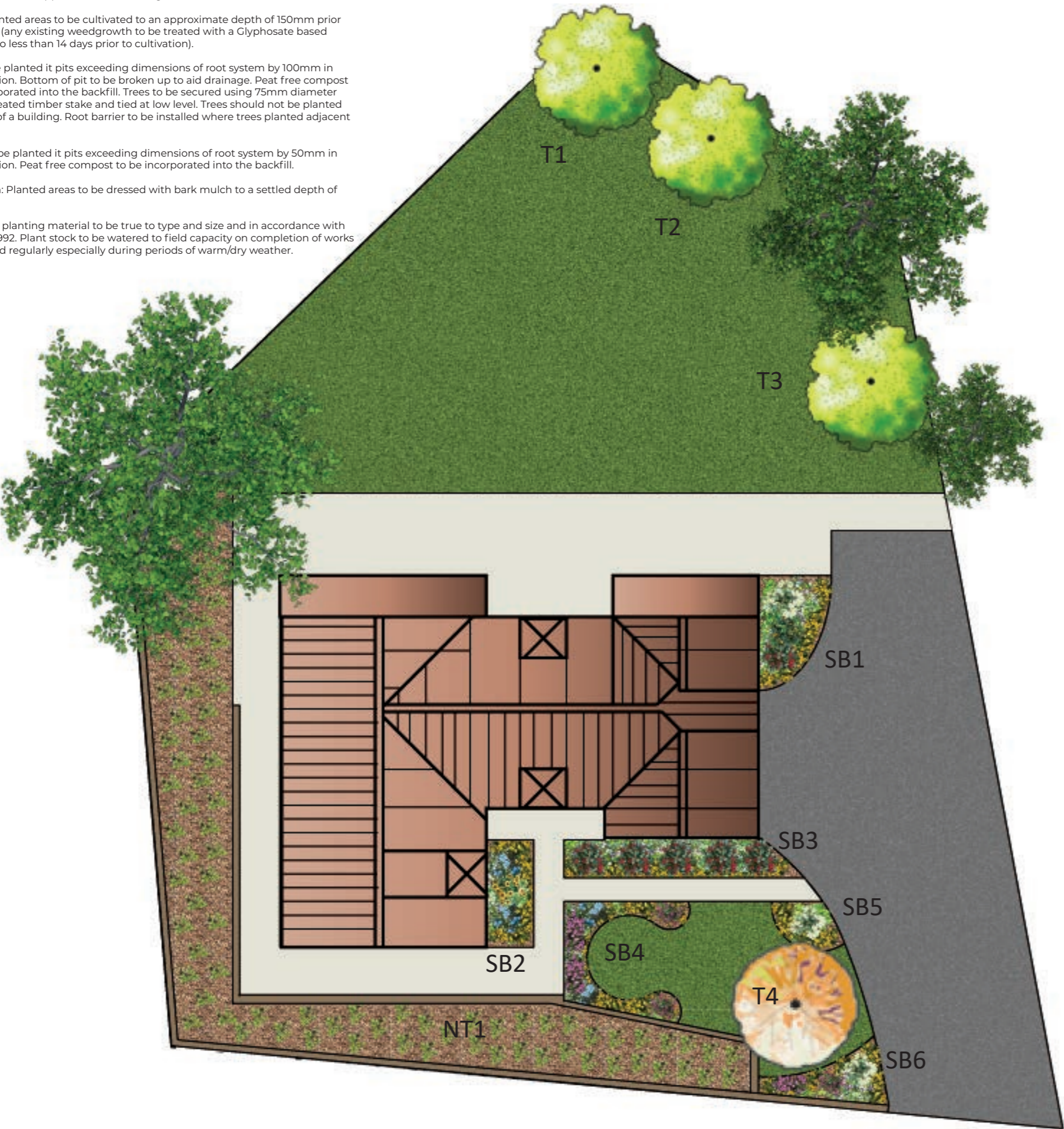

Trees	No	Girth	Root	Code
Carpinus betulus 'Fastigiata'	1	14-16cm	RB	T1
Populus nigra	1	14-16cm	RB	T2
Prunus hillieri 'Spire'	1	8-10cm	RB	T3
Prunus amanagawa	1	8-10cm	RB	T4
Shrub bed SB1	No	Height/Spread	Pot size	Density
Brachyglottis 'Sunshine'	3	30-40cm	5L	3/sq.m.
Choisya ternata 'Sundance'	3	30-40cm	5L	3/sq.m.
Lonicera nitida 'Maygreen'	15	40-60cm	3L	4/sq.m.
Shrub bed SB2	No	Height/Spread	Pot size	Density
Lavendula angustifolia 'Hidcote'	6	30-40cm	5L	3/sq.m.
Viburnum davidii	9	20-25cm	3L	4/sq.m.
Shrub bed SB3	No	Height/Spread	Pot size	Density
Choisya ternata	6	30-40cm	5L	3/sq.m.
Euonymus fortunei 'Emerald Gaiety'	6	25-30cm	5L	3/sq.m.
Lonicera nitida 'Lemon Beauty'	20	40-60m	3L	4/sq.m.
Shrub bed SB4	No	Height	Root/Pot size	Density
Cornus sanguinea 'Midwinter Fire'	6	40-60cm	5L	3/sq.m.
Euonymus fortunei 'Emerald Gaiety'	12	25-30cm	3L	4/sq.m.
Hebe pinguifolia 'Sutherlandii'	9	20-30cm	3L	4/sq.m.
Hypericum patulum 'Hidcote'	6	40-60cm	3L	4/sq.m.
Viburnum tinus Eve Price	9	40-60cm	5L	3/sq.m.
Shrub bed SB5	No	Height	Root/Pot size	Density
Euonymus japonicus 'Aureopictus'	1	60-80cm	10L	-
Potentilla fruticosa 'Sunset'	6	20-30cm	3L	4/sq.m.
Viburnum davidii	6	20-25cm	3L	4/sq.m.
Shrub bed SB6	No	Height	Root/Pot size	Density
Brachyglottis 'Sunshine'	3	20-25cm	3L	4/sq.m.
Euonymus japonicus 'Aureopictus'	1	60-80cm	10L	-
Hypericum patulum 'Hidcote'	6	30-40cm	3L	4/sq.m.
Lonicera nitida 'Baggesons Gold'	6	40-60	5L	3/sq.m.
Symphoricarpus chenaultii 'Hancock'	9	40-60	2L	4/sq.m.
Native transplants NT1	No	Height	Root/Pot size	Density
Acer campestre	24	40-60cm	BR	750mm ctrs
Corylus avellana	16	40-60cm	BR	750mm ctrs
Crataegus monogyna	48	60-80cm	BR	750mm ctrs
Ilex aquifolium	16	60-80cm	3L	750mm ctrs
Rosa rugosa	24	40-60cm	BR	750mm ctrs
Viburnum opulus	32	40-60cm	BR	750mm ctrs



Unit 22 New Mesters, 53 Mowbray Street, Sheffield S3 8EN
Tel: 0114 400 0182 / 07903 155398
info@phoenixls.co.uk / www.phoenixls.co.uk

Client
Mr Damien Clowery

Project
Bank View, Crane Moor,
Wortley, Sheffield

Title
Soft Landscape Proposals

Layout number
CLOW/CRAN/001

Rev

Drawn by
AM

Date
30/1/2023