

ICE HOUSE ACCESS/IMPROVEMENT PROPOSALS

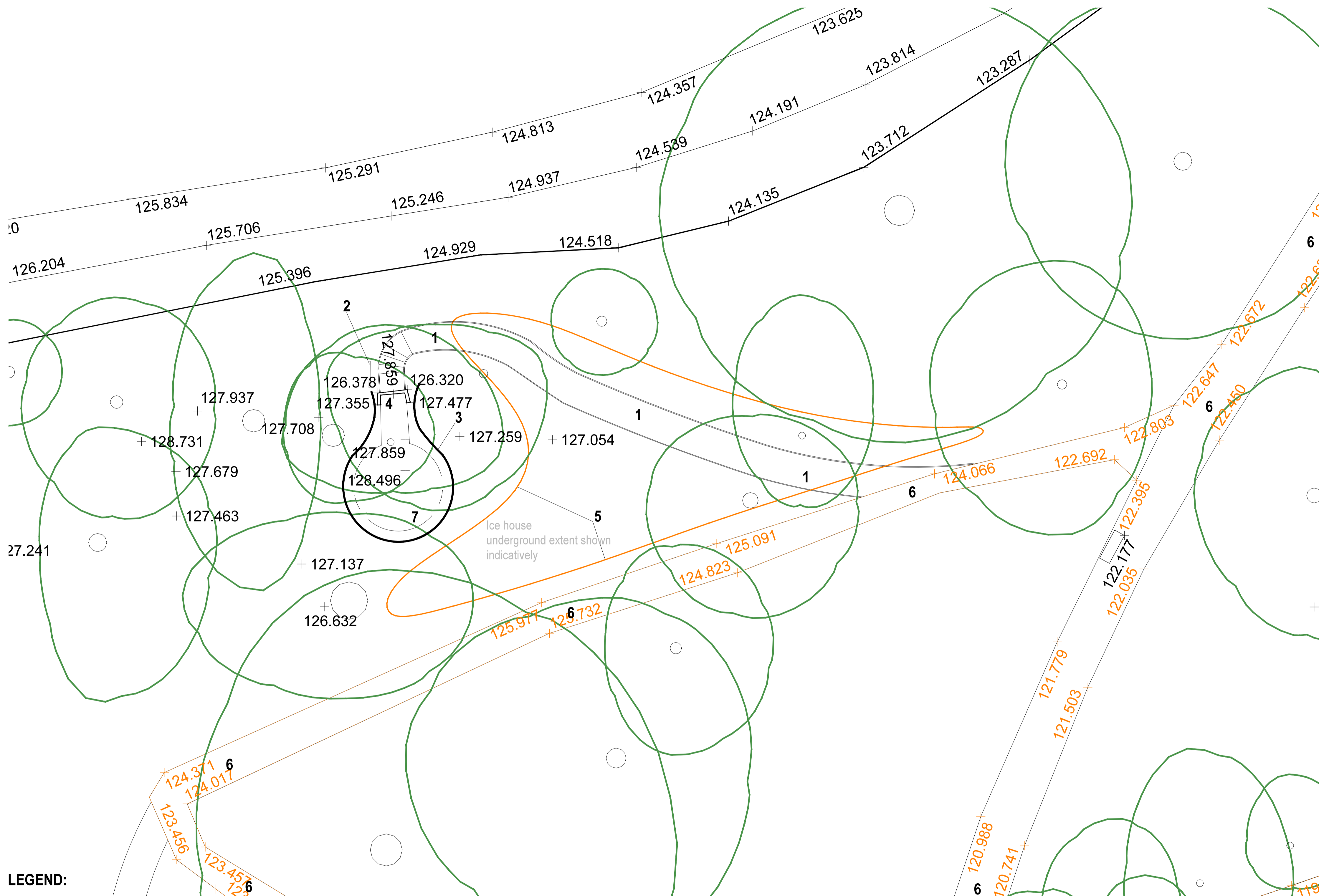

LEGEND:

- 1-New gritstone hoggin access path (ref CHP_PLI_S2_DR_SW1_0152) to the Icehouse entrance, levels re-graded, path approximately 1 in 10 maximum grade. 1a-Steps down to Ice House entrance
- 2-Signage/Interpretation point (ref CHP_PLI_S2_DR_SW3_0804)
- 3-Railing surround to provide subtle delineation to Ice house roof
Size 600mm high, 2 rows of rail, top rail 20mm round.
- 4-Entrance opened up to allow views in-wrought ironwork grating to prevent access
- 5-Vegetation clearance to open up views
- 6-Existing paths (ref CHP_PLI_S2_DR_SW1_0150)
- 7-Ice House roof treatment-vegetation removal, expose/repair top surface, new lime wash in keeping with historic covering, ref BHN information



**LISTING STATUS:
NOT SEPARATELY
LISTED ON THE
REGISTER**

DRAWING NOTES:

GENERAL:

1. COPYRIGHT OF THIS DRAWING IS VESTED IN PLINCKE AND IT MUST NOT BE COPIED OR REPRODUCED WITHOUT CONSENT.
2. DO NOT SCALE FROM THIS DRAWING - DIMENSIONS GOVERN. IF IN DOUBT ASK.
3. ALL DIMENSIONS ARE IN MILLIMETRES UNLESS NOTED OTHERWISE. ONLY FIGURED DIMENSIONS ARE TO BE TAKEN FROM THIS DRAWING.
4. ALL DIMENSIONS SHALL BE VERIFIED ON SITE BEFORE PROCEEDING WITH THE WORK. ALL CONTRACTORS MUST VISIT SITE AND BE RESPONSIBLE FOR TWINING AND CHECKING ALL DIMENSIONS RELATIVE TO THEIR WORK.
5. PLINCKE SHALL BE NOTIFIED IMMEDIATELY BY EMAIL, OF ANY DISCREPANCIES.
6. PLINCKE ACCEPTS NO LIABILITY FOR ANY EXPENSE, LOSS OR DAMAGE OF WHATSOEVER NATURE AND HOWEVER ARISING FROM ANY VARIATION MADE TO THIS DRAWING OR IN THE EXECUTION OF THE WORK TO WHICH IT RELATES WHICH HAS NOT BEEN REFERRED TO THEM AND PRIOR APPROVAL OBTAINED.
7. ALL PLINCKE DRAWINGS TO BE READ IN CONJUNCTION WITH ALL RELEVANT ARCHITECTURAL, CIVIL ENGINEERS AND M&E ENGINEERS DRAWINGS AND SPECIFICATIONS.

REFERENCE FILES:

1. THIS DRAWING IS BASED ON THE FOLLOWING EXTERNAL CONSULTANTS DRAWINGS:

CONSULTANT	REFERENCE FILE	DATE RECEIVED

HEALTH, SAFETY & ENVIRONMENTAL INFORMATION:

1. IT IS ASSUMED THAT ALL WORKS ON THIS DRAWING WILL BE CARRIED OUT BY A COMPETENT CONTRACTOR AND WHERE APPROPRIATE, WORKING TO AN APPROVED METHOD STATEMENT.
2. THIS DRAWING IS TO BE READ IN CONJUNCTION WITH ALL OTHER HAZARDS / RISKS WHICH HAVE BEEN IDENTIFIED AND RECORDED WITHIN THE PRE-CONSTRUCTION INFORMATION PACK AND / OR THE CONSTRUCTION PHASE HSS PLAN.
3. IN ADDITION TO THE HAZARDS / RISKS NORMALLY ASSOCIATED WITH THE TYPES OF WORK DETAILED ON THIS DRAWING, NOTE THE FOLLOWING:

ITEM N° | **RISK REGISTER DETAILS**

ITEM N°	RISK REGISTER DETAILS

P02 PLANNING PROPOSALS	SS	AA	05/05/16
P01 STAGE 1 PRELIMINARY PROPOSALS	SS	AA	22/01/16
REV DESCRIPTION	DRAWN	CHECK	DATE
KEY PLAN			



plincke.

MANCHESTER LONDON
 t: 0161 237 9223 t: 0207 739 3330
 e: north@plincke.co.uk e: london@plincke.co.uk

PROJECT TITLE
CANNON HALL PARKS FOR PEOPLE

DRAWING TITLE
WOODLAND/SOUTHERN APPROACH: ICE HOUSE ACCESS PROPOSALS

SCALE @ A1
1:125

DATE
30/01/16

PROJECT No. 0292 DRAWING No. CHP_PLI_S2_DR_LC10_0225 REVISION P02

SCALE BAR @ 1:125