

plans as proposed

NOTES

VENTILATION
All habitable rooms to have opening lights with aggregate area equal to not less than 1/20th floor area of respective room. 8000mm² trickle vents to be provided to each habitable room

INSULATION
all to be lapped as recommended in DLTR guidance for ensuring robustness of construction-no gaps or thermal bridges

FINISHING JOINERY
Skirtings and architraves to be mdf torus moulded unless noted otherwise

Approved Doc B - Fire Safety
60 Min fire separation to be achieved between ground and first floor-fire resistant ceiling required
Final exit doors should be only fitted with simple fastenings that can be readily operated from the side approached by people making an escape without the use of a key
A fire alarm and detection system is required in accordance with BS5839-1:2013. A min Category M system is to be installed. Manual call points are to be provided adjacent the final exit door Call points to comply with BSEN 54-11:2001
A certificate to certify that the fire alarm system has been installed and tested by a competent person in accordance with BS5839-1:2013 is to be sent to Sheffield Building Standards on completion of the work
Exit signage is to be provided and directional arrow escape signs to be provided at the rear corridor
Emergency escape lighting is required to the wc areas in accordance with BS5266-1:2011. This to be integral to the escape signage described above
A completion certificate to certify the emergency lighting system has been designed, installed and commissioned by a competent person in accordance with BS5266-1:2011 is to be sent to Sheffield Building Standards on completion of the work
The person carrying out the work shall give fire safety information to the responsible person no later than the date of completion of the work, or the date of occupation of the building.

FIRE DOORS
FD30SC-SS denotes 30 minute fire resisting door with self closing device and intumescent seal. Permanent smoke seals also to be fitted if there are smoke detectors within rooms only. No permanent smoke seals to be fitted if smoke detectors are in circulation area only

Approved Document H - Drainage and waste disposal
NO changes to below ground drainage
Please note any Yorkshire Water conditions, if applicable will be added to any approval given.

The new above ground drainage should be constructed in accordance with AD H1.Section 1.

Approved Doc J - Combustion appliances and fuel storage systems
No boilers or flues are affected by the works

Part L - Conservation of fuel and power
note the existing fabric to remain, therefore no requirement to thermally insulate

ventilation to w.c's
w.c. to have mechanical ventilator to give min 3no. air changes / hour switched with light to over run min. 15 min.
anti syphon traps to new sanitary fittings.
new drainage to connect to existing svp

open shared yard

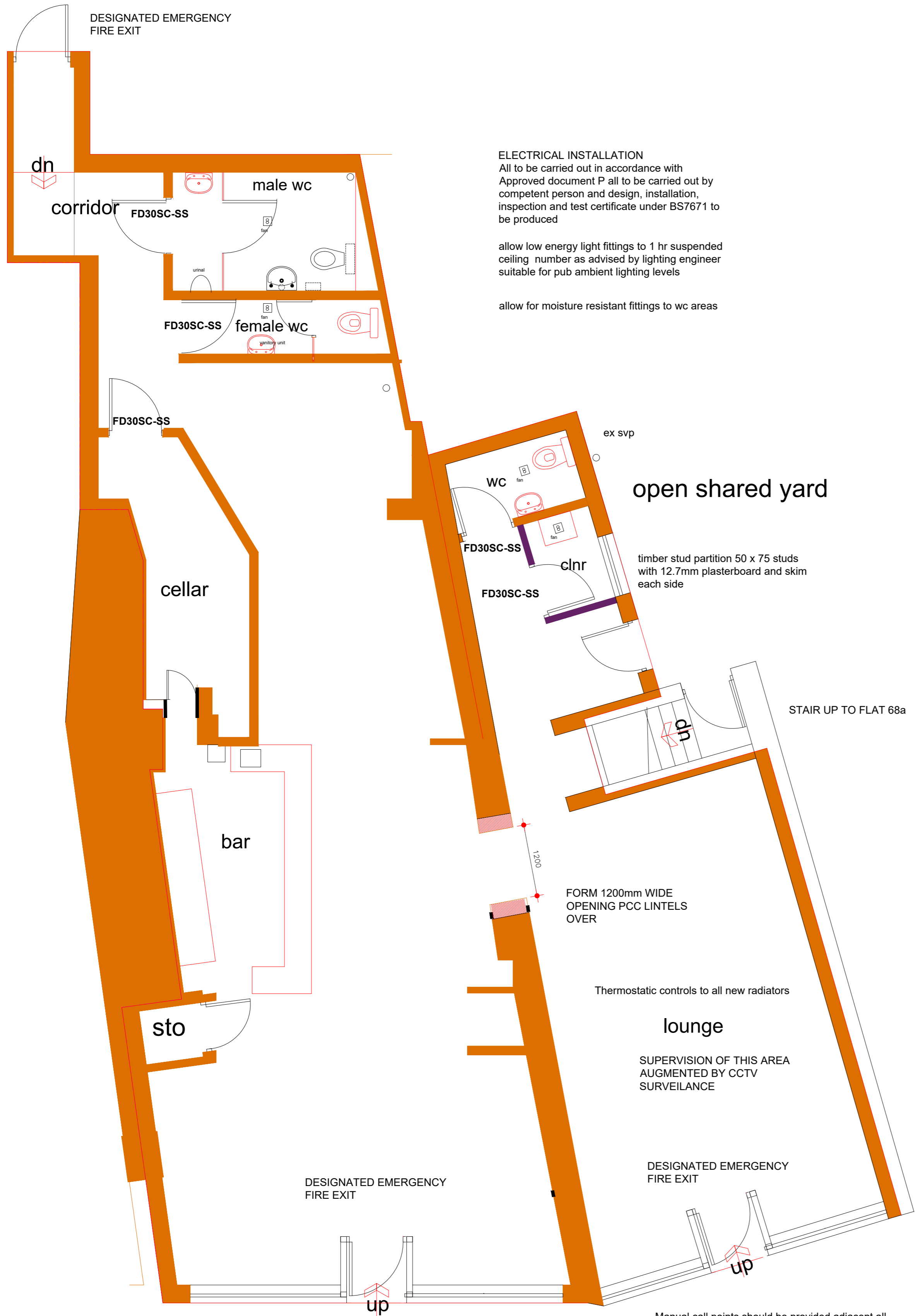

ELECTRICAL INSTALLATION
All to be carried out in accordance with Approved document P all to be carried out by competent person and design, installation, inspection and test certificate under BS7671 to be produced

allow low energy light fittings to 1 hr suspended ceiling number as advised by lighting engineer suitable for pub ambient lighting levels

allow for moisture resistant fittings to wc areas

open shared yard

Thermostatic controls to all new radiators

lounge

SUPERVISION OF THIS AREA AUGMENTED BY CCTV SURVEILLANCE

DESIGNATED EMERGENCY FIRE EXIT

Manual call points should be provided adjacent all the final exit doors to ground floor along with each storey exit. All in accordance with BS 5839-1: 2013.

Approved Document A - Structure

The suitability of the existing floors to carry the additional loads from the new stud walls should be to the satisfaction of the District Building Surveyor.

GROUND FLOOR AREAS

floor assumed to be on dpm and will be thermally insulated

Part M - Access to and use of buildings
Electrical sockets/switches to be located between 450 - 1200mm from floor level

CHURCH STREET

Car Park

open shared yard

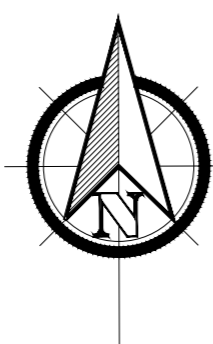

Scale 1 to 100 @A3

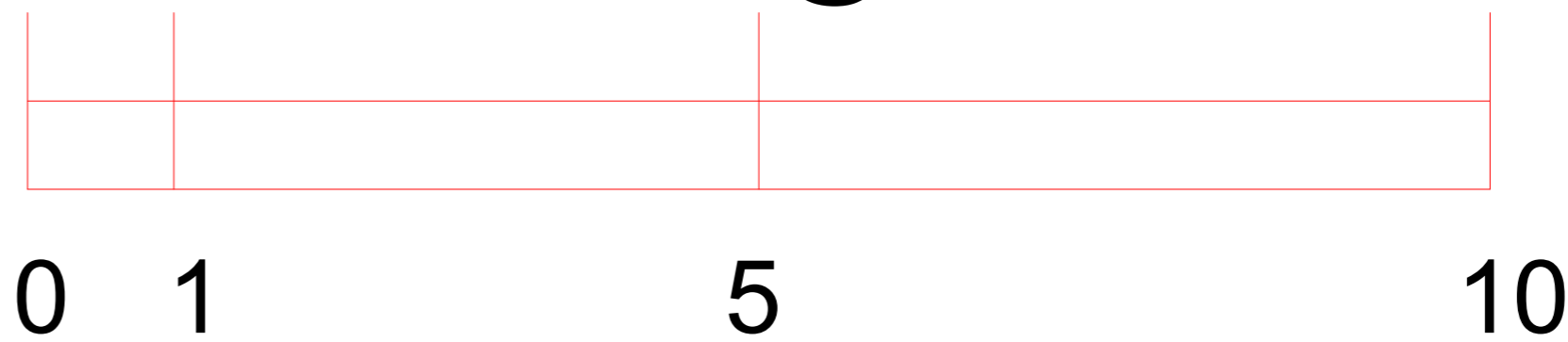

JULIE MURRAY ARCHITECTURE
4 BROOKSIDE CLOSE, HACKENTHORPE
SHEFFIELD S12 4LE 0114 247 0602

TITLE change of use
ground floor retail to micropub
68 Church St DARTON
BARNSELEY
CLIENT Mr I Simpson

PLANS AS PROPOSED

DATE 5/1/2021 SCALE 1:100 @A3
1:100 and 1:50 @A1

DRAWING No.
s/20/02

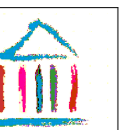

REVISION

block plan 1:500