

SITE LAYOUT (1:2500)

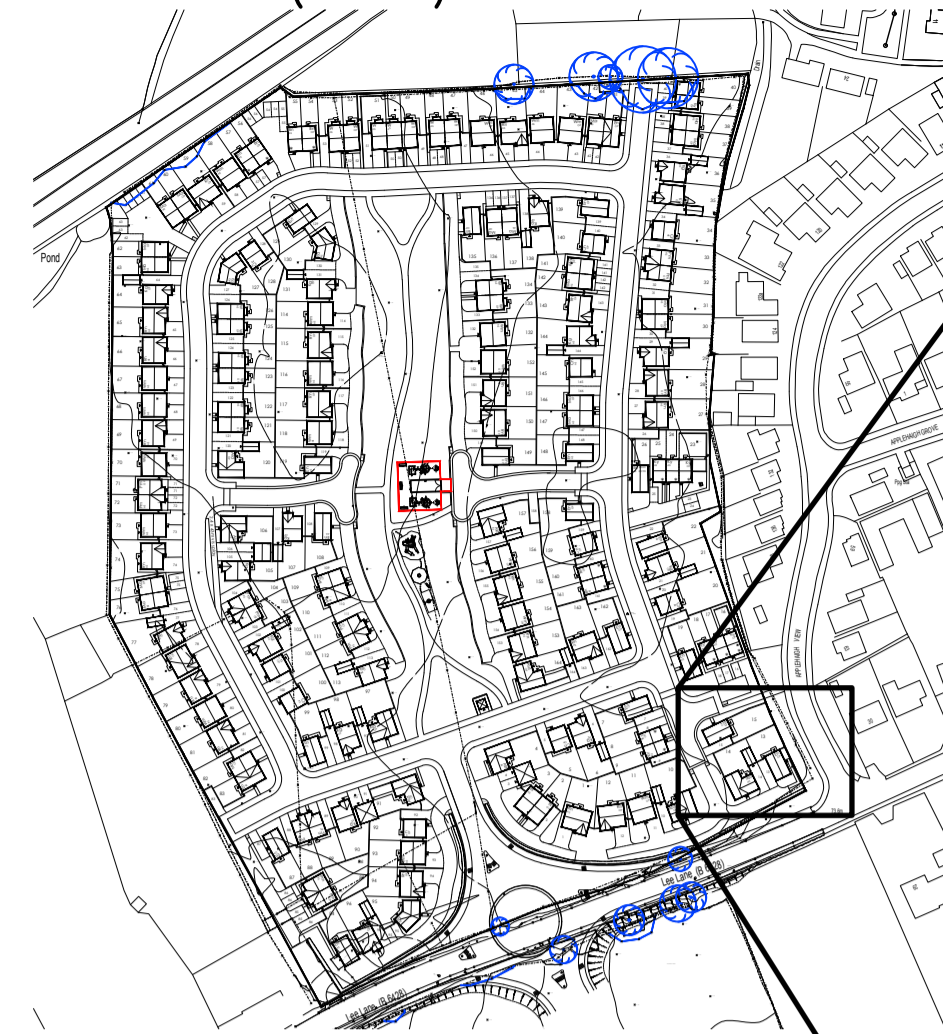

TEMPORARY ACCESS LAYOUT (1:200)

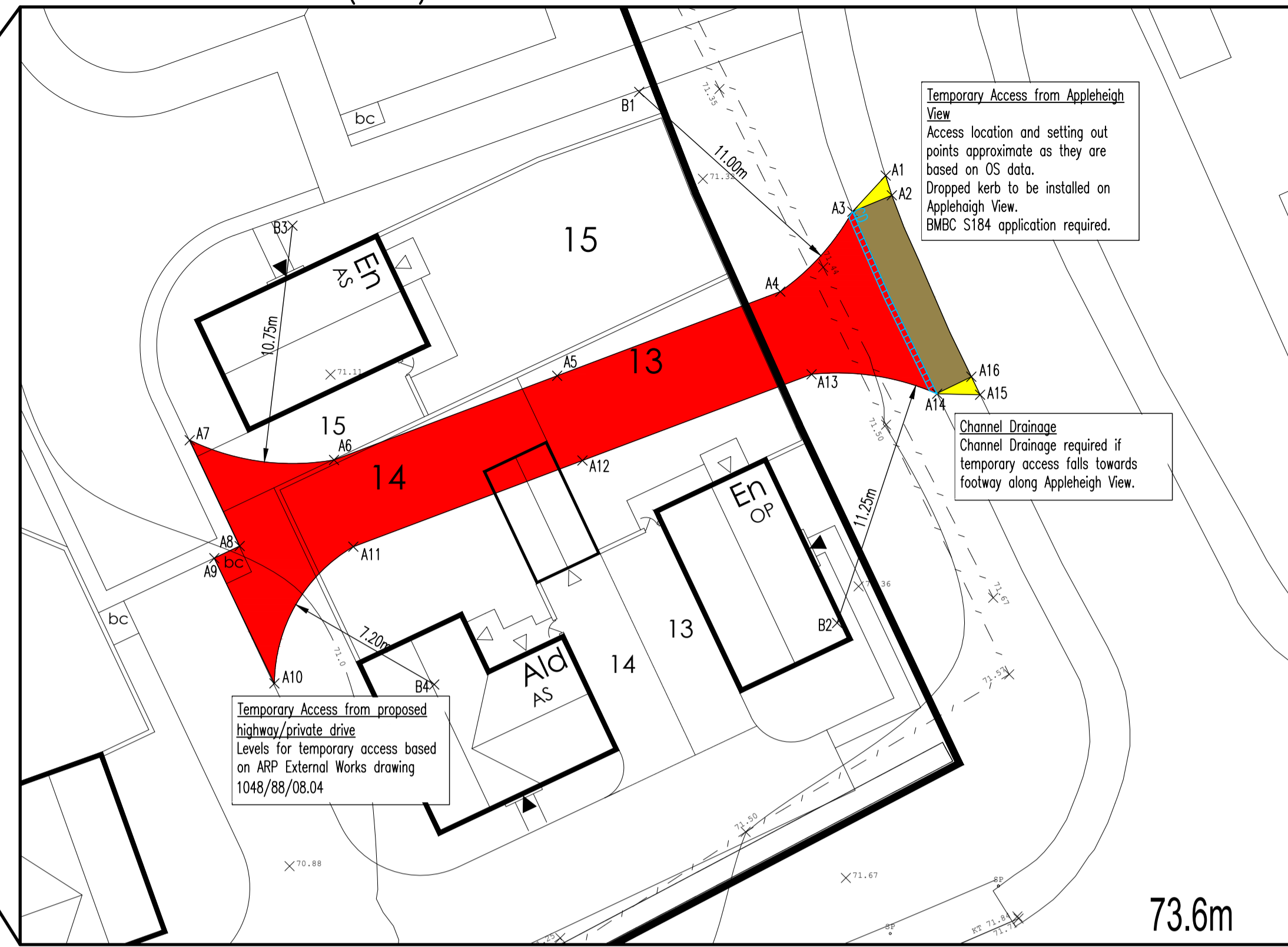

Temporary Access Setting Out Points

	X	Y	Notes
A1	435065.825	411429.489	Level as existing; no existing topo survey data available
A2	435066.100	411428.600	25mm upstand from existing carriageway, no existing topo survey data available
A3	435064.328	411427.870	Approximate; no existing topo survey available
A4	435061.086	411424.274	
A5	435051.059	411420.493	
A6	435041.032	411416.713	
A7	435034.545	411417.598	Edge of proposed adopted highway (Level=71.576)
A8	435036.793	411412.842	Edge of proposed adopted highway (Level=71.519)
A9	435035.651	411412.293	Edge of proposed adopted highway (Level=71.519)
A10	435038.353	411406.671	Edge of proposed shared drive (Level=71.430)
A11	435041.899	411412.812	
A12	435052.196	411416.686	
A13	435062.493	411420.560	
A14	435068.134	411419.682	Approximate; no existing topo survey available
A15	435070.064	411419.641	Level as existing; no existing topo survey data available
A16	435069.671	411420.451	25mm upstand from existing carriageway, no existing topo survey data available
B1	435054.747	411433.248	Approximate; no existing topo survey available
B2	435063.641	411409.386	Approximate; no existing topo survey available
B3	435039.165	411427.240	
B4	435045.536	411406.618	

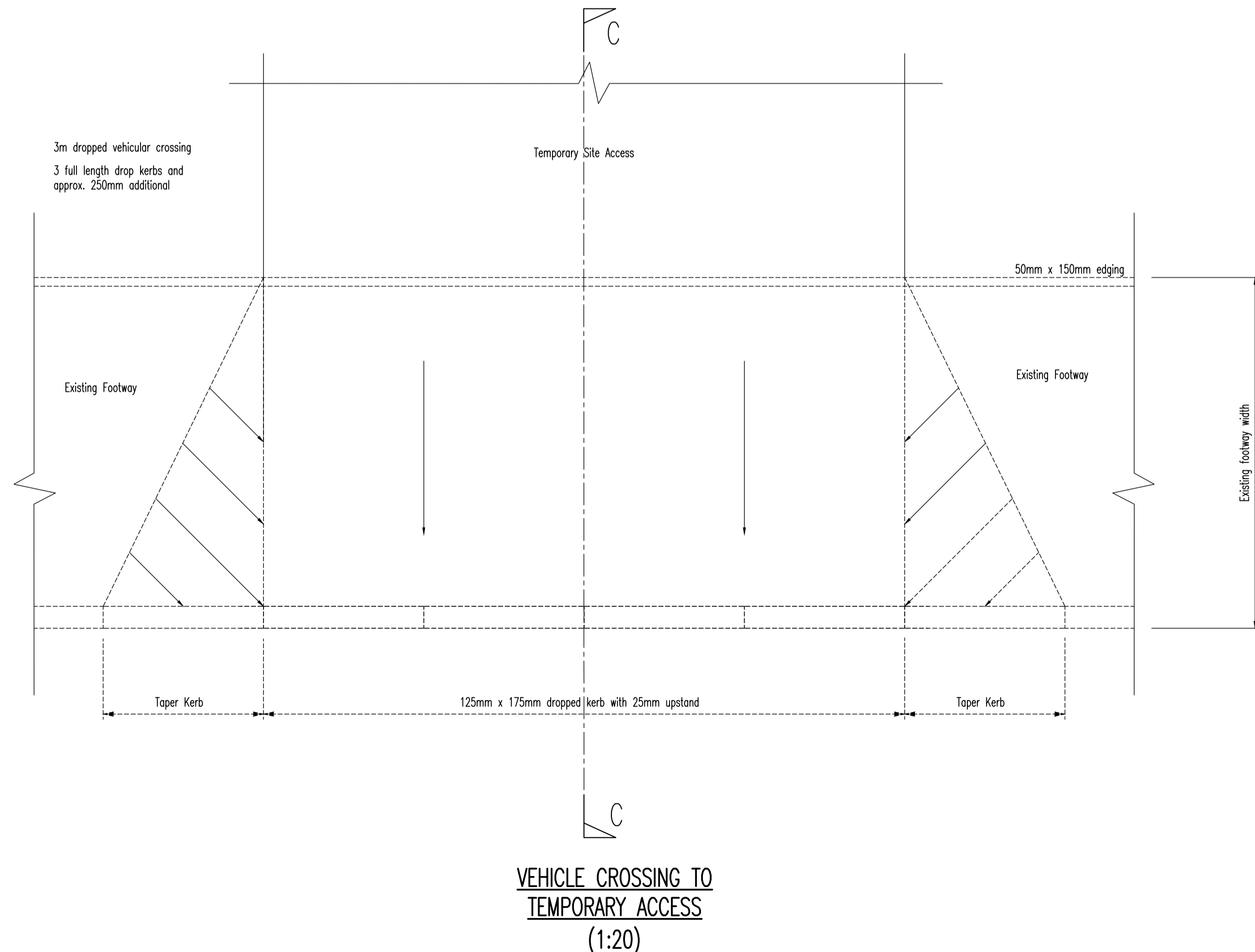
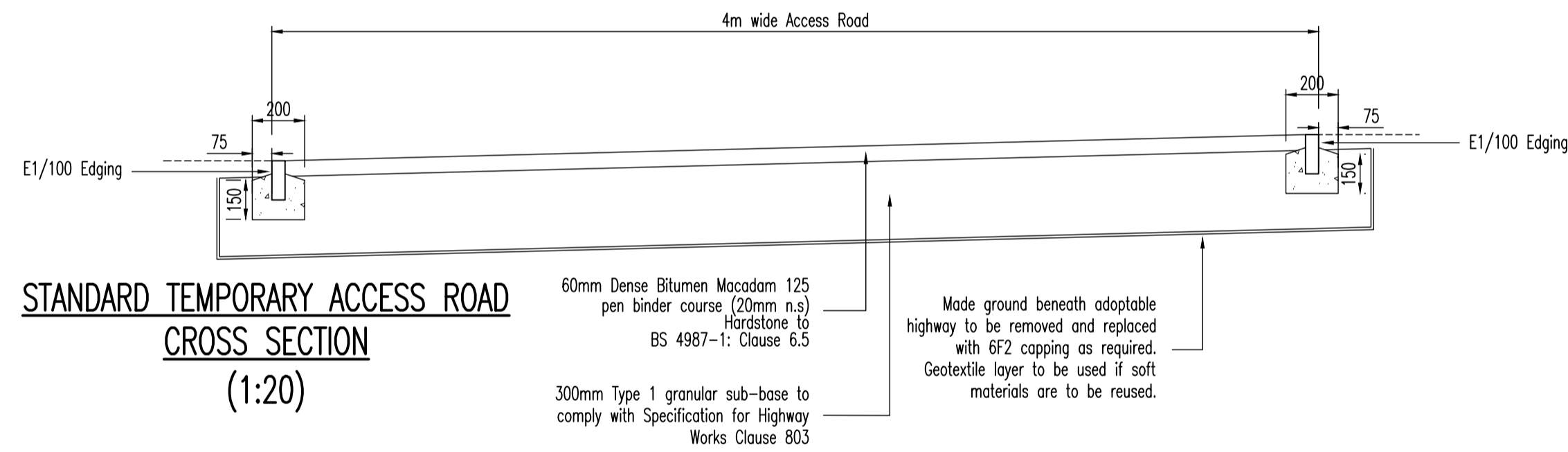
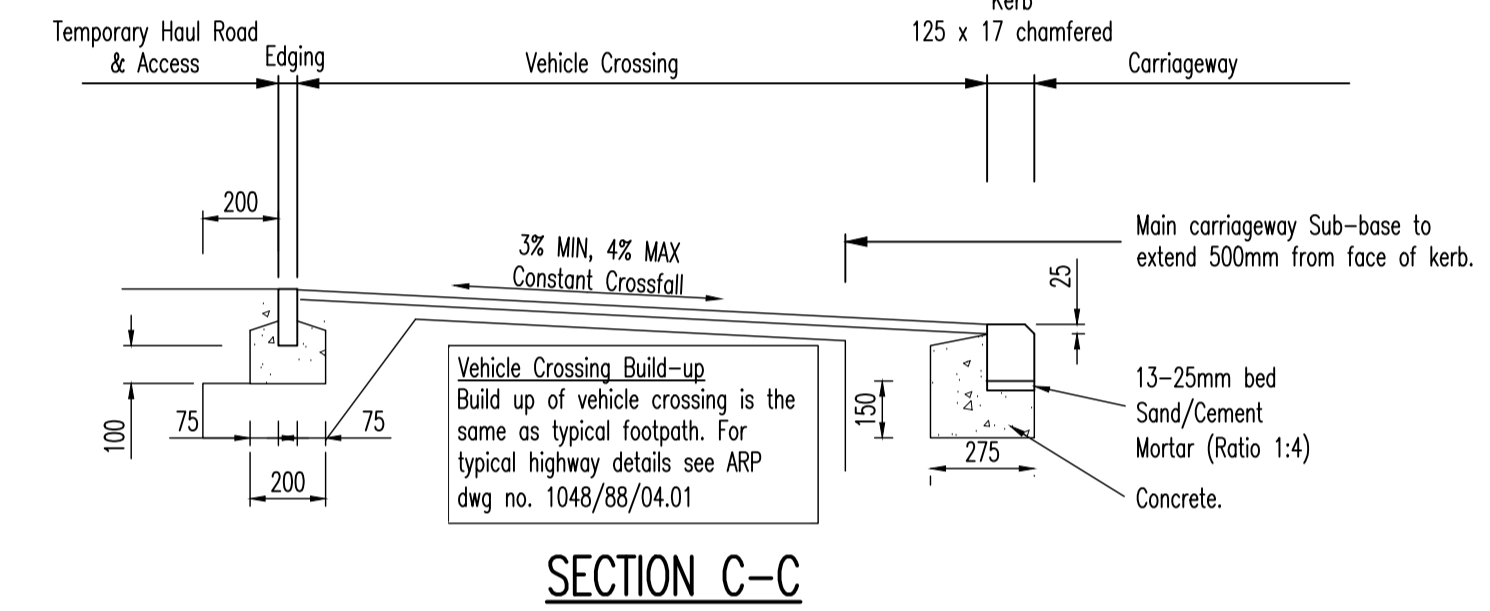

N O T E S

- KEY**
- Temporary Access Road
 - Section 184 dropped kerb crossing area with 125mm x 175mm dropped kerb with 25mm upstand
 - Section 184 dropped kerb crossing area with tapered kerb

- Refer to typical section Drawing No 1048/88/04 for typical highway details.
- For guidance, all clause numbers below relate to the Department of Transport's Specification for Highway Works 1991.
- Preparation and surface treatment of formation shall be in accordance with CI 616.
- General requirements for road pavements shall be in accordance with clauses 701 to 707 inclusive.
- All bitumen macadam shall be in accordance with BS 4987.
- All bituminous bound materials shall be transported, laid and compacted in accordance with CL 901.
- Granular Type 1 sub base shall be in accordance with CL 803.
- Laying and compaction of sub base shall be in accordance with CL 802.
- Road base shall be dense bitumen macadam in accordance with CL 903.
- Base course shall be dense bitumen macadam in accordance with CL 906.
- Wearing course shall be dense bitumen macadam in accordance with CL 912, or stone mastic asphalt in accordance with CL 942, as shown on this drawing.
- Limestone aggregate is not permitted.
- No water should be allowed to discharge from the haul road and temporary access onto the adoptable highway.
- Change of footway to dropped crossing subject to Section 184 application to Barnsley Metropolitan Borough Council.
- Any coated base material in carriageway left exposed for more than seven days to be sealed using bituminous sealing grit.
- Highway boundary to be indicated by back edgings laid flush.
- Pavement construction is based upon an assumed minimum CBR value of 2% and will need to be confirmed by contractor prior to works commencing.
- All vertical faces of joints involving flexible materials shall be treated with "Oxy-bit" or other approved joint sealant. This includes ironwork, and precast products. Overbanding will not be accepted by Barnsley MBC.
- Do not scale from this drawing.

SUBJECT TO THE APPROVAL OF ALL RELEVANT AUTHORITIES

Rev	By	Date	Revision	SAB	SAB
/	TF	26.06.18	Issued for approval	Chk	Apvd

ARP ASSOCIATES
Chartered Consulting Engineers

Northwest House • 5 & 6 Northwest Business Park • Sevia Hill, Leeds • LS6 2QH
0113 245 6498 • 0113 244 3864 • leeds@arpassociates.co.uk • www.arpassociates.co.uk

ARP Associates is a trading division of ARP Geotechnical Ltd, a company registered in England and Wales with company number 377831, whose registered office is at 5/6 Northwest Business Park, Sevia Hill, Leeds LS6 2QH

TITLE
EMPORARY ACCESS LAYOUT & DETAILS

PROJECT
LEE LANE, ROYSTON

CLIENT
BDW YORKSHIRE WEST

DRAWING STATUS
PRELIMINARY

Scale	Date	Drawn	TF
VARIOUS @ A1	JUNE 18	Chk.	SAB

Drg. No. **1048/88/15** Rev /