

Drawing status

Drawn by DB Size A1 Scale 1:100

Notes	Status	Rev	Date
FEASIBILITY STUDY	F	-	-
AMENDMENTS: Relocation of hoppers and left outlet. Changes to roof lights and guttering and roof covering layout.	F	A	04.05.21
TENDER ISSUE	T	A	07.05.21
AMENDMENTS: Steel posts supporting the louvred screens added	T	B	12.05.21
AMENDMENTS: Demolition contractor to salvage the existing guardrails for reuse.	T	C	14.05.21
AMENDMENTS: Guardrail line extended Concrete pads added	T	D	17.05.21
FINAL TENDER ISSUE FOLLOWING THE REVIEW	T	D	20/05/2021

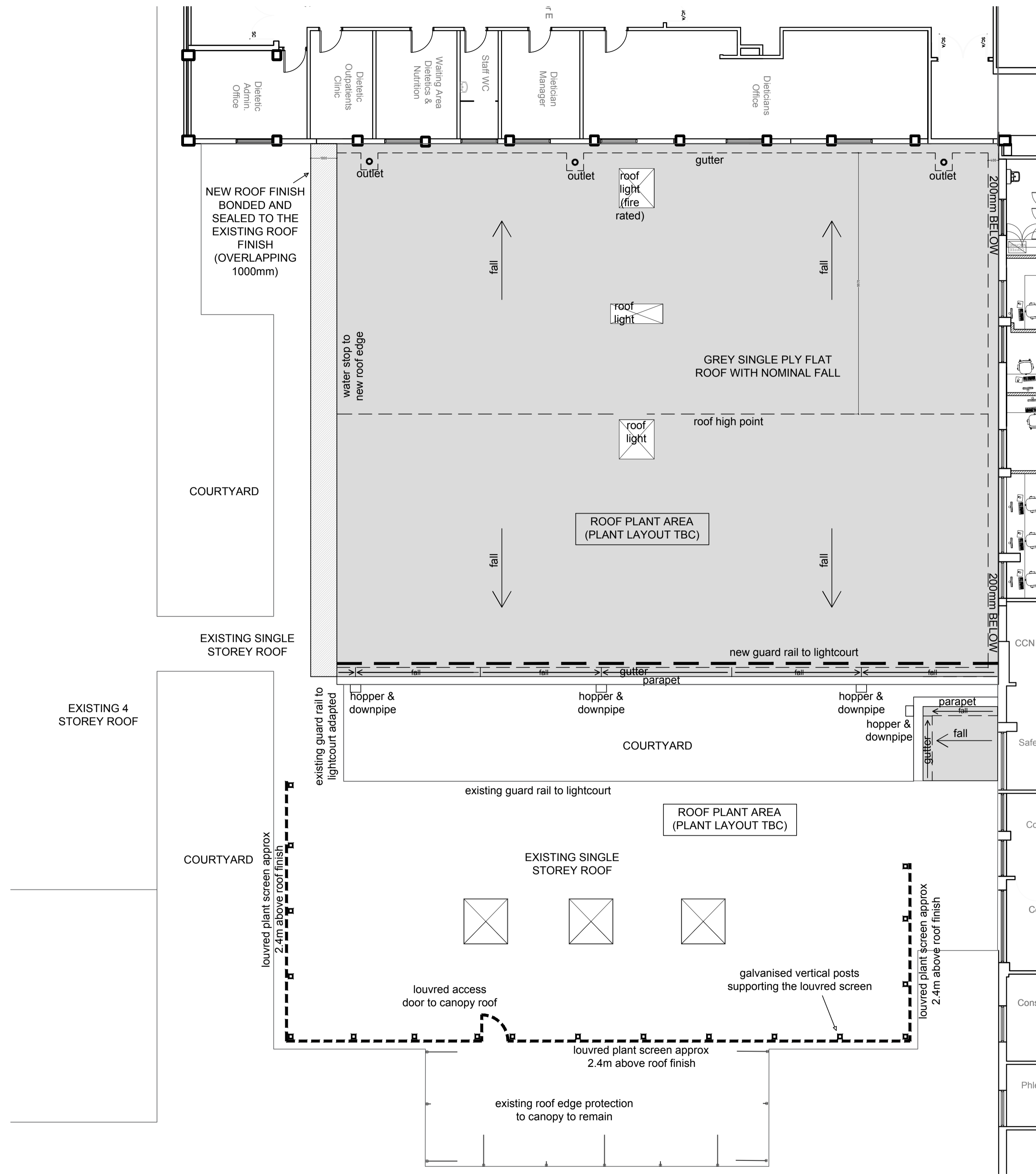

PROPOSED ROOF PLAN
1:100

Drawing status annotation
P-Preliminary T-Tender D-Design (post preliminary) C-Construction As-As Built

Client

BARNSELY HOSPITAL NHS
FOUNDATION TRUST

Project title

CRITICAL CARE UNIT

Project no

170-033

Drawing title

PROPOSED ROOF PLAN

Drawing no

CC(47)-01

Status Revision

T D