

- Key SF Soft Landscaping**
- Existing vegetation
  - Existing vegetation removed to facilitate construction
  - Existing tree
  - Grass - turf
  - Proposed shrub bed planting
  - Proposed woodland mix planting - protected with Nedon guards
  - Proposed hedge
  - Proposed tree feathered 3m height - protected with rabbit proof spiral guard
  - Proposed tree extra heavy standard 14-16cm girth - protected with rabbit proof spiral guard
  - Proposed wildflower seed (Basic mix)
  - Proposed wildflower seed (Wetland and pond mix)
  - Spot planting
- Key SF Fencing/boundaries**
- Tree protection fencing
- Key SF Landscape Features**
- Pond - to be bentonite-lined

**Schedule - LL01**

Number	Species	Girth	Specification
4 No.	Acer campestre	14-16cm	Extra Heavy Standard
3 No.	Betula pendula	14-16cm	Extra Heavy Standard
3 No.	Betula pendula 'Tristis'	14-16cm	Extra Heavy Standard
2 No.	Prunus padus 'Albertii'	14-16cm	Extra Heavy Standard
3 No.	Sorbus aucuparia	14-16cm	Extra Heavy Standard
Total : 15 No.			

Number	Species	Pot Size	Height	Specification	Density
38 No.	Corylus avellana	3L	60-90cm		1/m <sup>2</sup>
590 No.	Lonicera pileata 'Maigrun'	3L	20-30cm	Double staggered row	No.
36 No.	Rosa canina		60-90cm		1/m <sup>2</sup>
47 No.	Viburnum opulus		60-90cm		1/m <sup>2</sup>
Total : 711 No.					

%	Number	Species	Height	Specification	Density
10%	17 No.	Acer campestre	175-200cm	Feather	1.2Ctr
20%	32 No.	Corylus avellana	60-80cm	1+1	1.2Ctr
15%	24 No.	Crataegus monogyna	60-80cm	1+1	1.2Ctr
15%	24 No.	Prunus spinosa	60-80cm	1+1	1.2Ctr
25%	40 No.	Rosa canina	40-60cm		1.2Ctr
15%	24 No.	Viburnum opulus	40-60cm		1.2Ctr
Total : 100% Total : 161 No.					

Number	Species	Pot Size	Specification	Density
192 No.	Euphorbia amygdaloides robbiae	1L	Double staggered row: 4linear m	No.
Total : 192 No.				

Number	Species	Pot Size	Density
169 No.	Arundinaria veitchii	5L	4/m <sup>2</sup>
Total : 169 No.			

Number	Species	Height	Specification	Density
308 No.	Prunus laurocerasus 'Rotundifolia'	Selected to 90cm	Double staggered row	4/m
Total : 308 No.				

Number	Species	Height	Density
4 No.	Acer campestre	60-90cm	5/m
6 No.	Corylus avellana	60-90cm	5/m
105 No.	Crataegus monogyna	60-90cm	5/m
3 No.	flex aquifolium	25-30cm	5/m
Total : 118 No.			

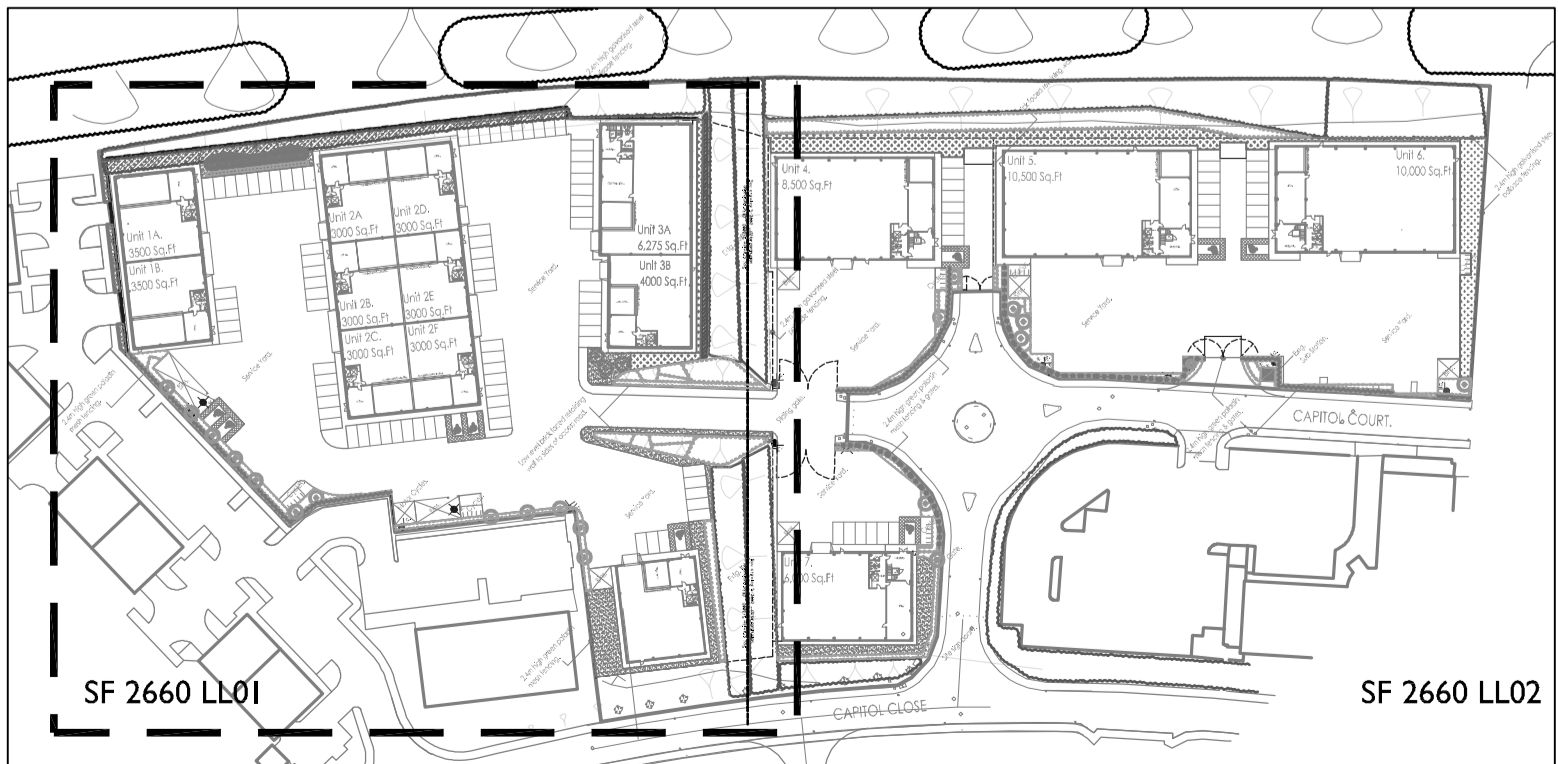

- Grass Turf**
- Rollawn Madillon® turf to BS3936 (Or equal and approved turf)
- Typical mixture:
- Eira Perennial Ryegrass 12.5%
  - Sawignon Perennial Ryegrass 12.5%
  - Casiane Slender Creeping Red Fescue 20%
  - Leonora Slender Creeping Red Fescue 15%
  - Matica Chewings Fescue 20%
  - Covei Smooth Stalked Meadow Grass 10%
  - Linouatine Smooth Stalked Meadow Grass 10%
- Supplier: Rollawn Ltd  
www.rollawn.co.uk
- Wildflower Seed**
- John Chambers Pro Basic 12.80/20 mix  
Product code - 139/C4125A or similar and approved
- | Wildflower                 | %         |
|----------------------------|-----------|
| Lady's Bedstraw            | 1.2       |
| Common Bird's-foot-trefoil | 3.0       |
| Salad Burnet               | 3.0       |
| Meadow Buttercup           | 2.0       |
| White Campion              | 1.5       |
| Wild Carrot                | 1.2       |
| Oxeye Daisy                | 0.5       |
| Black Medick               | 2.5       |
| Ribwort Plantain           | 2.4       |
| Selfheal                   | 1.2       |
| Farrow                     | 2.0       |
| Common Sorrel              | 0.5       |
| <b>Total</b>               | <b>20</b> |
- Low maintenance grasses 80
- Supplier: John Chambers Wildflowers  
www.johnchamberswildflowers.co.uk
- WFG9 - Wetland and Pond Areas** or equal and approved.  
Supplier: Germinall www.germinall.com  
Sowing rate: 5g per m<sup>2</sup>
- | Species                     | %    |
|-----------------------------|------|
| Slender creeping red fescue | 25.0 |
| Crested dogtail             | 20.0 |
| Rough stalked meadow grass  | 15.0 |
| Tall fescue                 | 10.0 |
| Tufted hair grass           | 5.0  |
| Taro small leaved           | 5.0  |
| Creeping buttercup          | 2.0  |
| Oxeye daisy                 | 1.0  |
| Meadow buttercup            | 3.0  |
| Salad burnet                | 2.8  |
| Meadow sweet                | 3.0  |
| Yellow flag                 | 3.0  |
| Loosestrife                 | 1.2  |
| Greater birdsfoot           | 0.5  |
| Yellow rattle               | 0.5  |
| Greater burnet              | 0.5  |
| Autumn hawkbit              | 0.2  |
| Gypsy wort                  | 0.2  |
| Ragged robin                | 0.1  |
| Chivitsit scabrous          | 0.1  |
| Marsh marigold              | 0.1  |
| Common Rebane               | 0.1  |
| Hard rush                   | 1.5  |
| Hemp agrimony               | 0.2  |

**SMEEDEN FOREMAN**

Project: Capitol Park  
Title: Landscape Proposals - 1 of 2  
Scale: 1:250 @A1 Drawn by: TM  
Date: 09.06.17 Checked: MS

Project No.	Drawing No.	Rev
SF 2660	LL01	E

Landscape Architects - Urban Designers  
Ecologists - Arboriculturists

Somerset House, Low Moor Lane, Scotton, Knaresborough, N. Yorks HG5 9JB  
Tel: 01423 863369 Fax: 01423 313107  
Email: office@smeedenforeman.co.uk  
www.smeedenforeman.co.uk

This drawing is the property of the Landscape Architect. Copyright reserved.

Rev.	Date	Description	Drawn	Checked
E	01.12.17	Addition of pond	CR	CW
D	24.11.17	Updated in line with new xref	TM	MS
C	10.10.17	Added woodland mix and extra trees	TM	MS
B	18.07.17	Updated in line with new xref	TM	MS
A	15.06.17	Updated following comments	TM	MS