

THIS DRAWING SHOULD NOT BE SCALED. DIMENSIONS TO BE VERIFIED ON SITE. ANY DISCREPANCIES SHOULD BE REFERRED TO THE ENGINEER PRIOR TO WORK COMMENCING.

NOTES

GENERAL NOTES

ARCHITECTURAL SITE PLAN
 THE HARRIS PARTNERSHIP
 12006-5-THP-XX-DR-A-1051-P02
 EXISTING TOPOGRAPHICAL SURVEY
 ELLAM LAND SURVEYS
 8848_2D/1

1. ALL COORDINATES RELATE TO TOPOGRAPHICAL SURVEY COORDINATION
2. ALL DIMENSION IN METRES UNLESS NOTIFIED OTHERWISE
3. ALL LEVELS IN METRES AOD IN RELATION TO TOPOGRAPHICAL SURVEY COORDINATION UNLESS NOTIFIED OTHERWISE

KEY:

- 0.000 PROPOSED FINISHED LEVEL
- 1.000 PROPOSED GRADIENT (FALL)
- PROPOSED MAJOR CONTOUR (0.5m)
- PROPOSED MINOR CONTOURS (0.1m)
- PROPOSED RETAINING (WITH INDICATIVE HEIGHT)
- SITE BOUNDARY

NOTE:
 REFER TO HJCE DRAWING 4100
 FOR ROAD LONG SECTION

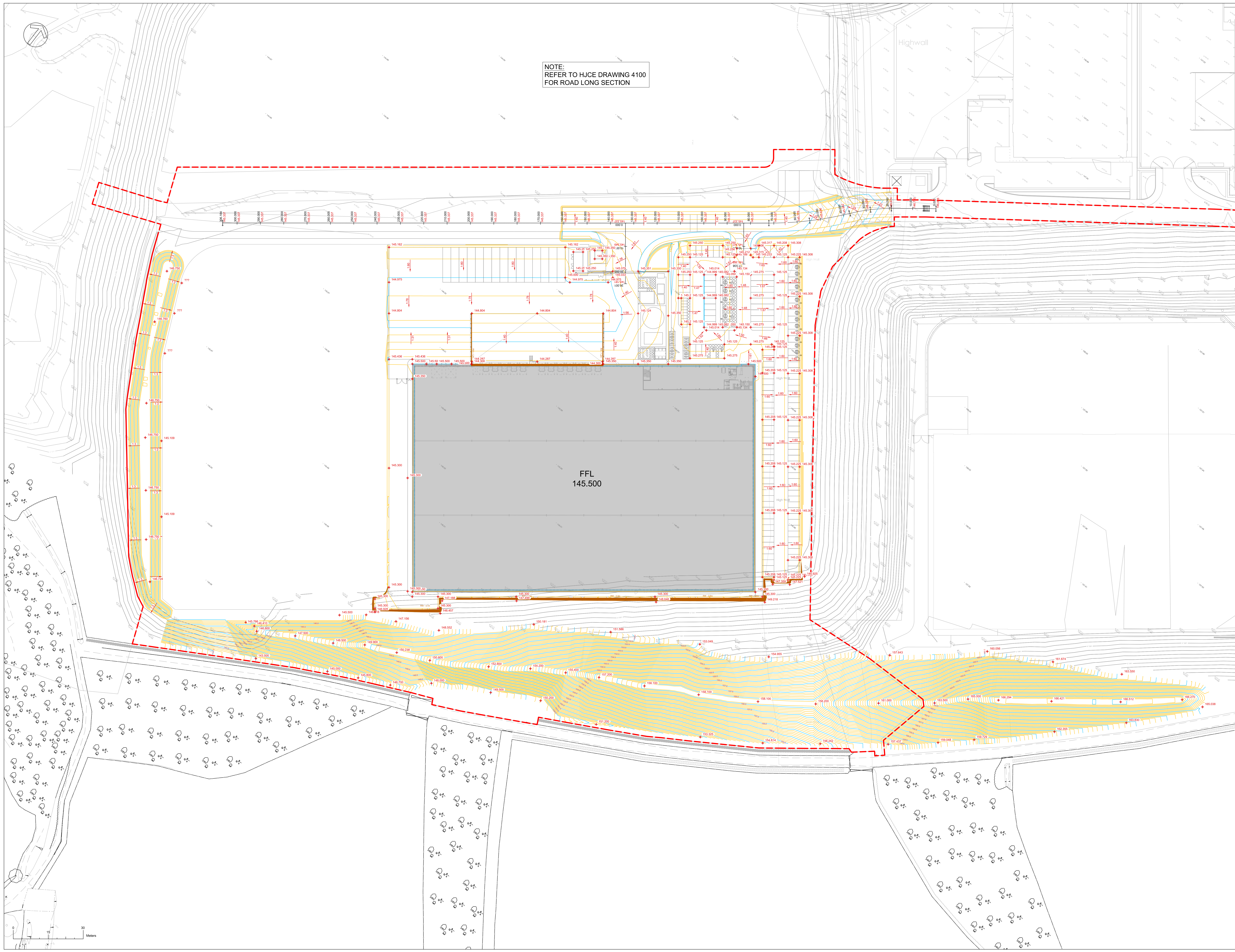

REV	DATE	DESCRIPTION	DM	AF	
P01	04.09.25	INITIAL ISSUE	DM	AF	
			DM	CHK	
REVISIONS					
PROJECT					
UNIT 7 - GATEWAY 36, ROCKINGHAM, BARNSELY					
TITLE					
EXTERNAL LEVELS OVERALL PLAN					
CLIENT					
EOS INC LIMITED					
CONSULTING CIVIL & STRUCTURAL ENGINEERS					
www.HJCE.co.uk					
T: 01924 624 423 E: admin@HJCE.co.uk					
HJCE					
STATUS					
PRELIMINARY					
DRAWN BY	DM	CHECKED BY	AF	APPROVED BY	AF
HJCE REF:	9466	DATE	04.09.25	SCALES @ A0	1:500
PROJECT - ORGANISATION - VOLUME - LEVEL - TYPE - ROLE - NUMBER					
9466-HJCE-00-XX-DR-C-4002 P01					