



Cannon Hall Farm Ltd

Erection of Substation, Beer Store, Shop Exit Porch,
Road Alterations, Café Extension and Shop Bridge
Link



Heritage Statement

June 2017

History and Development

Cannon Hall is located in 70 acres of historic parkland looking towards the village of Cawthorne located to the west of Barnsley.

The original building and parkland can be historically traced from the 13th century and records of the adjoining Farm date from conveyancing documents and references from around 1650.

After passing through several families, the estate was finally broken up in 1951 with the Home Farm eventually separated from the Main House 6 years later. The Museum has been maintained and run by Barnsley Council in its current form since 1957.

Development of both the Museum and the Farm has continued up to the present day, a significant period spanning 60 years, with a successful relationship leading to the creation of a nationally recognised venue and providing Barnsley and South Yorkshire with revenue, employment and an enviable and valuable tourism profile.

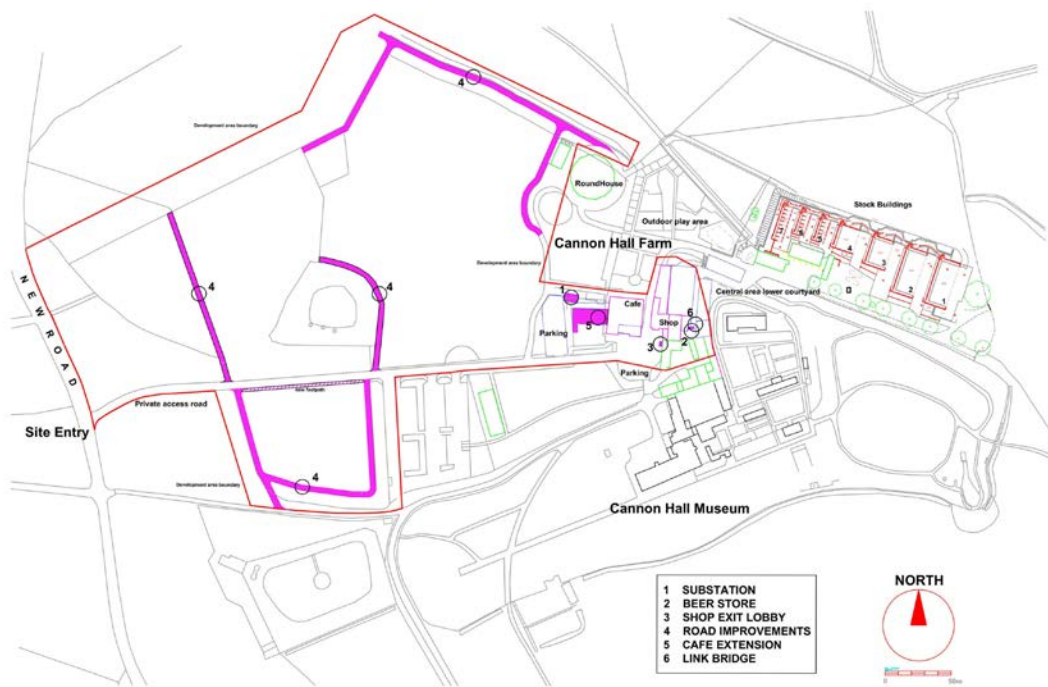

Location Plan
scale 1:2500

General Site relationship of Buildings

Photographic Record



Principal view from Museum Main Entrance towards the Farm



General site view showing premises setting in relation to the Museum



Typical Farm architectural style and low rise profiles



General scale of Farm Building roofs below the existing tree lines

Assessment of Impact

The application proposes to enhance the existing Farm facilities with a mixture of new development works providing additional safety, operational functionality and additional visitor capacity.

Key features of the proposal in relationship to the existing Museum include:-

- 1 The proposed buildings developments cannot easily be seen from the principal Museum entrances or the immediate Museum Entrance forecourt.
- 2 The proposed road alterations will have extremely limited visual impact on the Museum setting and its environment and will provide greater vehicle and operational safety for servicing Farm activities and, by association, enhanced visitor safety
- 3 The proposed sites are a considerable distance away from the Museum and its key visitor areas.
- 4 The proposed development continues a use of the existing site which does not have any record of nuisance or visual interference to the Museum over a significant period of time.
- 5 The proposed scale of the developments is not out of keeping with the low profile of the existing adjoining Farm buildings and will preserve and maintain roof ridge heights below the existing tree lines.

In summary, the Applicant believes that the proposal does not have any significant visual impact on the existing Museum building or Parkland setting.