

TYPICAL SECTION THROUGH ACCESS ROADS - TYPE 4

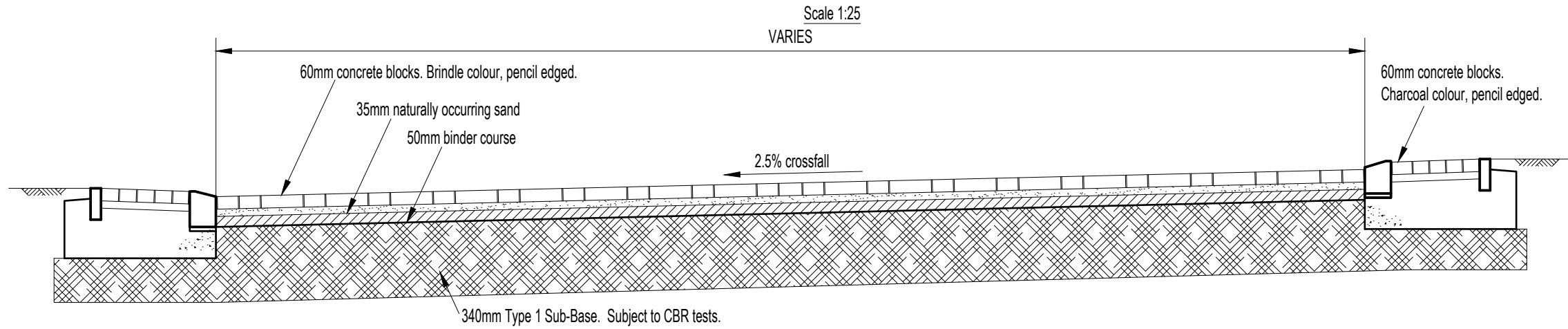

TYPICAL SECTION THROUGH ACCESS ROADS - TYPE 5B

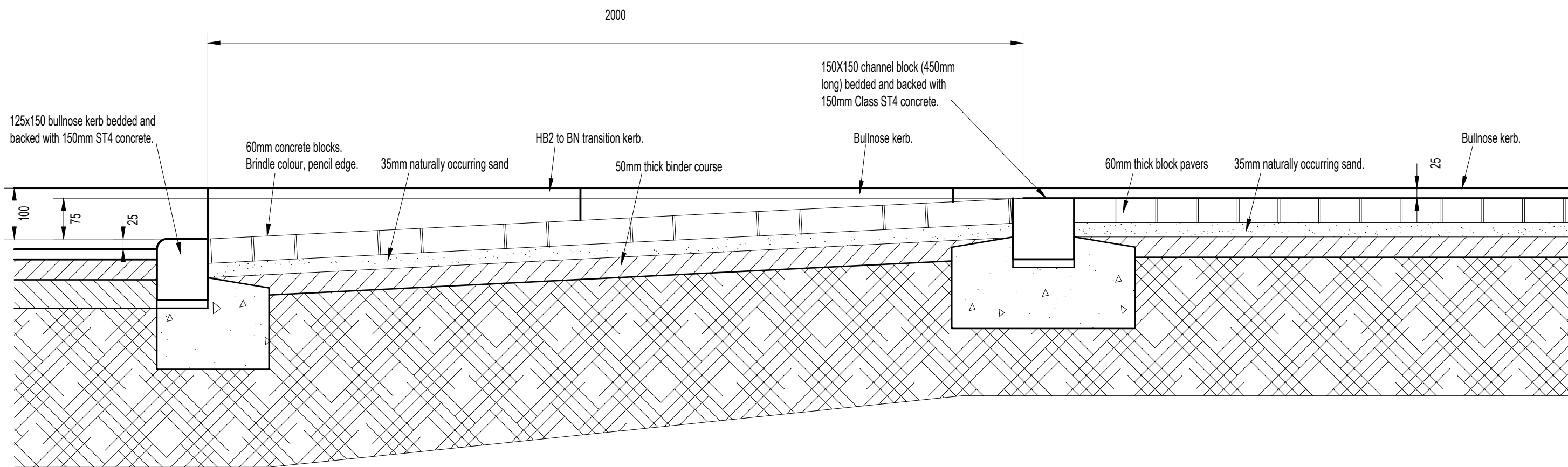

TYPICAL DETAIL THROUGH RAMP TO SHEARED SURFACE

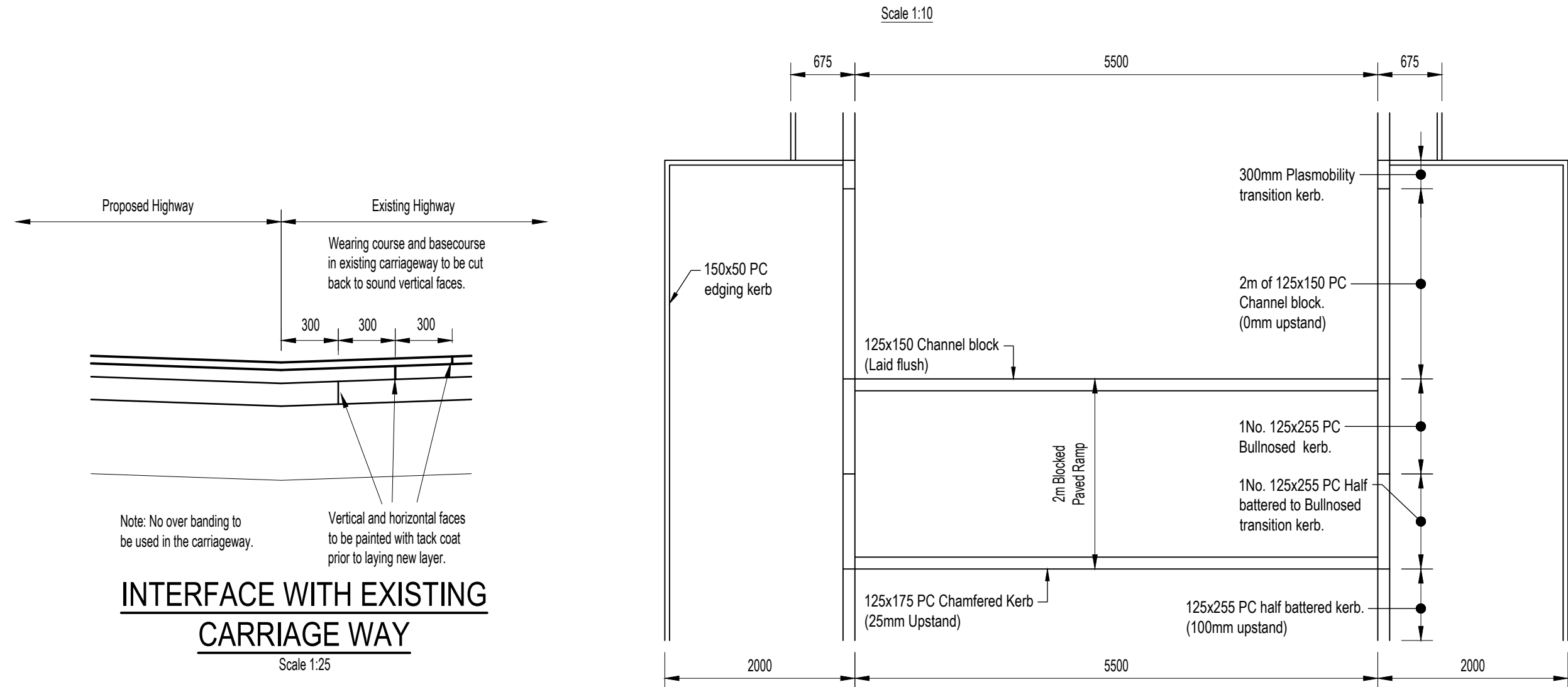

TYPICAL PLAN ON KERBING DETAIL TO RAMP THROUGH TO SHEARED SURFACE

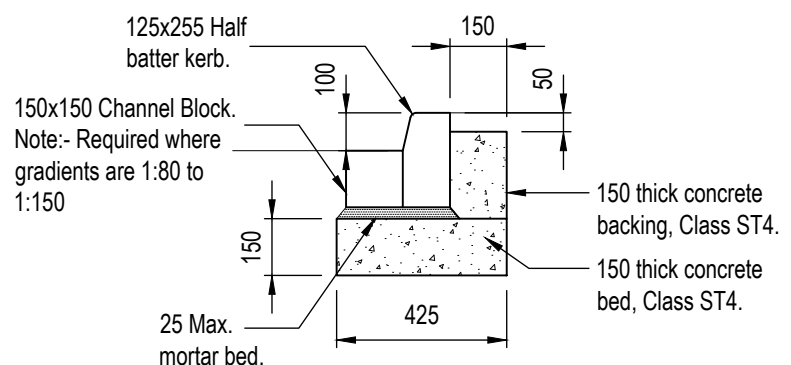

TYPICAL HB2 KERB DETAIL

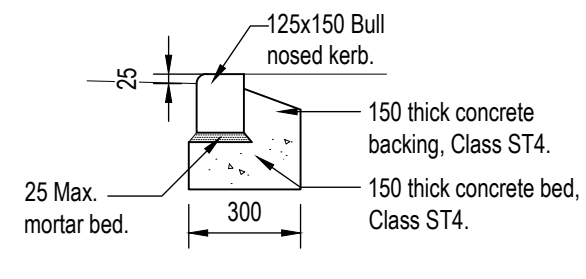

TYPICAL BULLNOSED KERB (25mm UPSTAND)

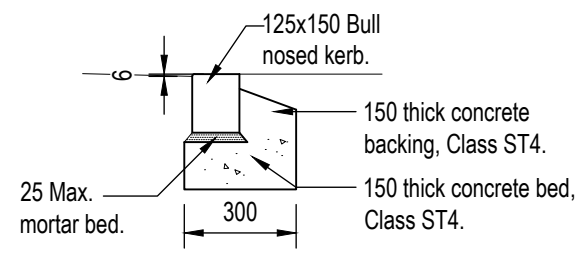

TYPICAL BULLNOSED KERB (6mm UPSTAND)

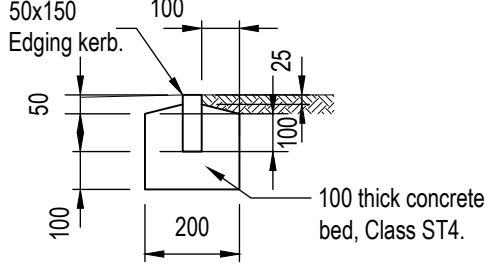

TYPICAL FOOTPATH EDGING KERB

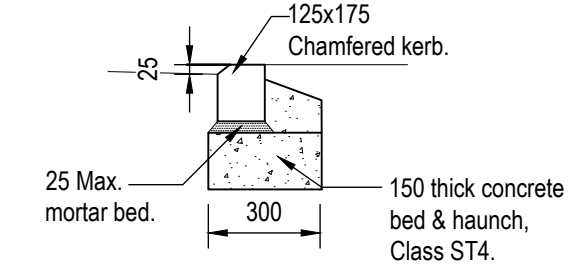

TYPICAL CHAMFERED KERB

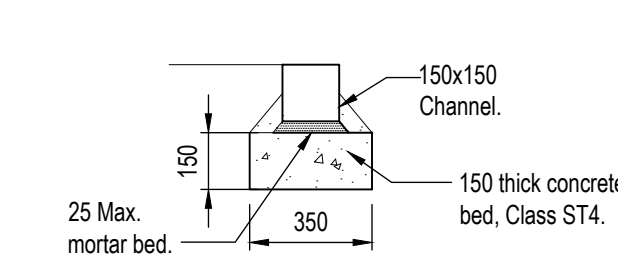

TYPICAL CHANNEL BLOCK

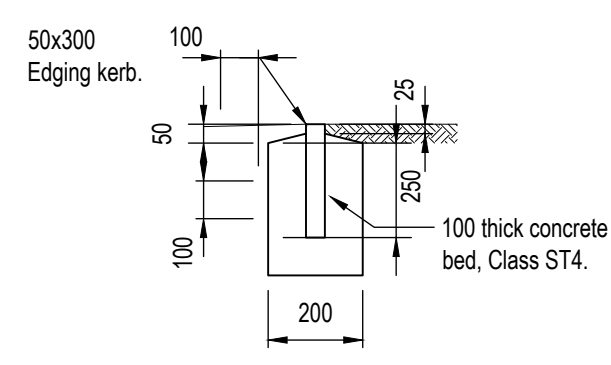

TYPICAL FOOTPATH EDGING KERB FOR PRIVATE DRIVEWAYS

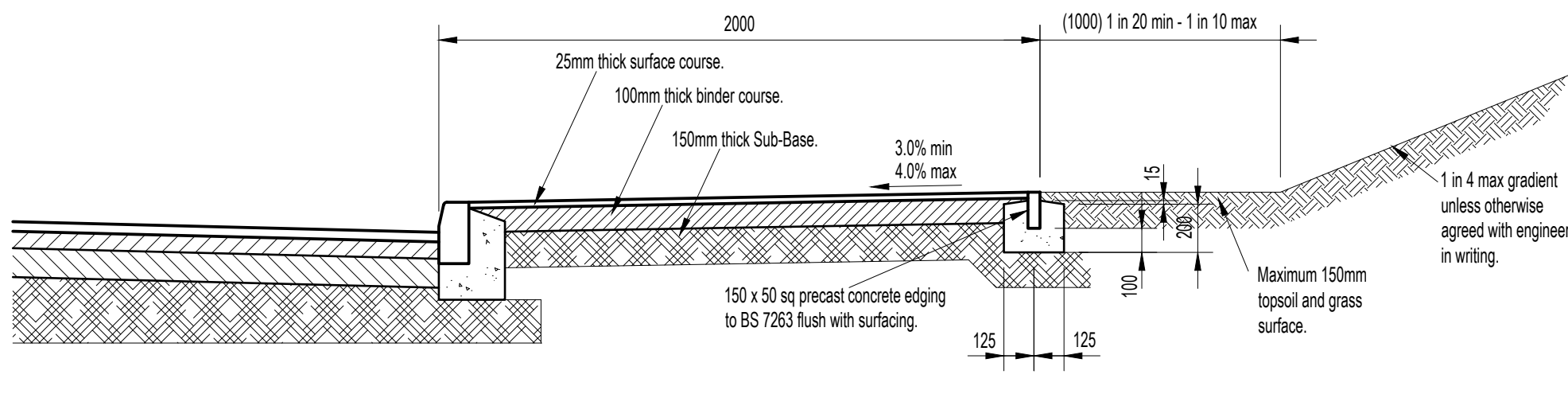

TYPICAL SECTION THROUGH FOOTPATH.

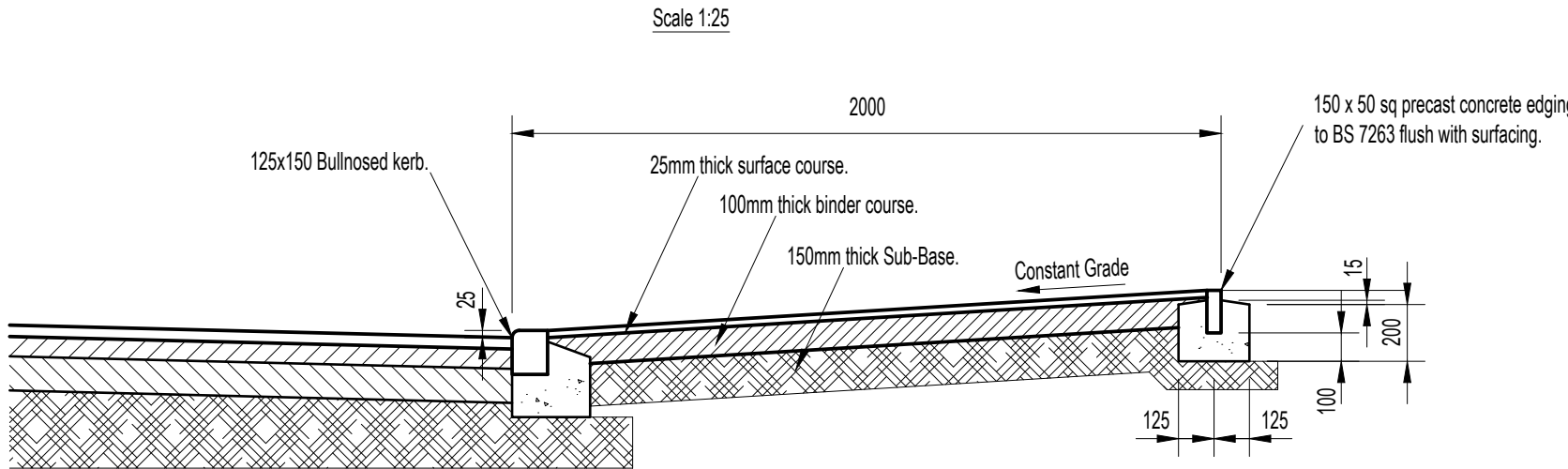

TYPICAL SECTION THROUGH VEHICLE CROSSING

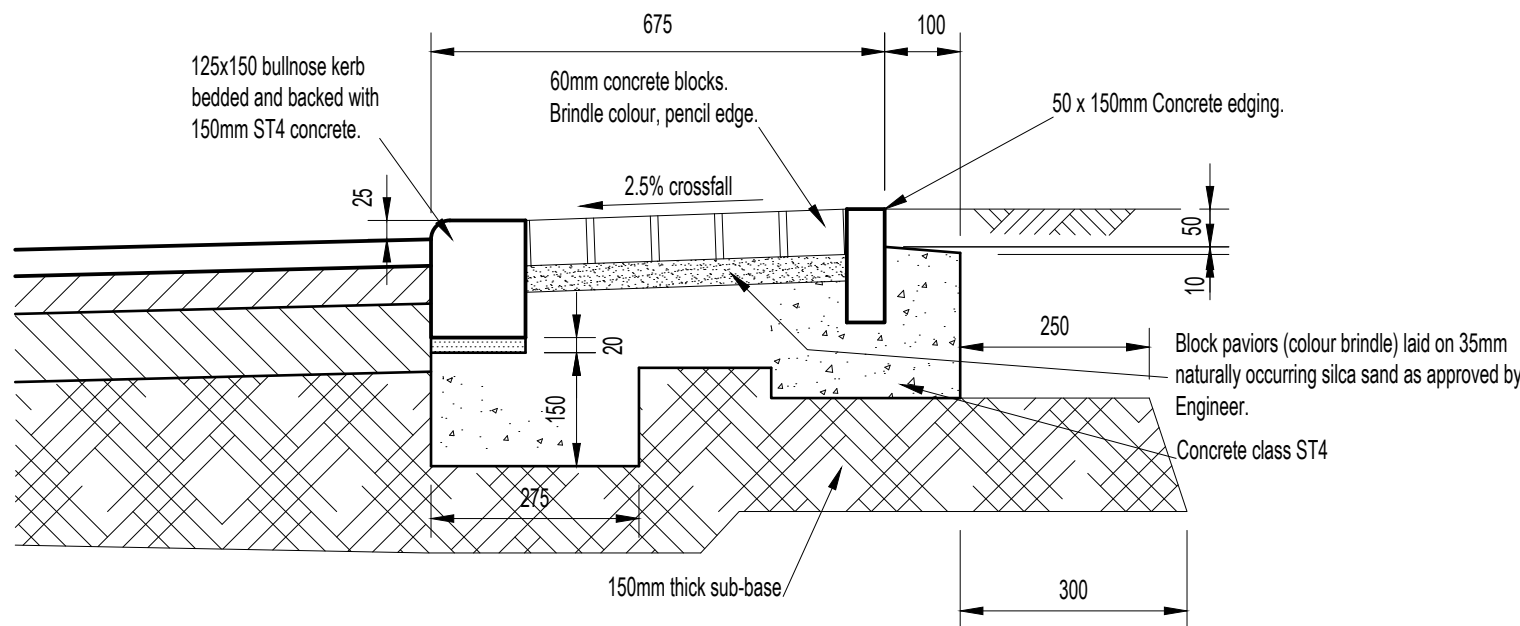

TYPICAL EDGE DETAIL THROUGH HARD MARGIN WITH HB2 KERB

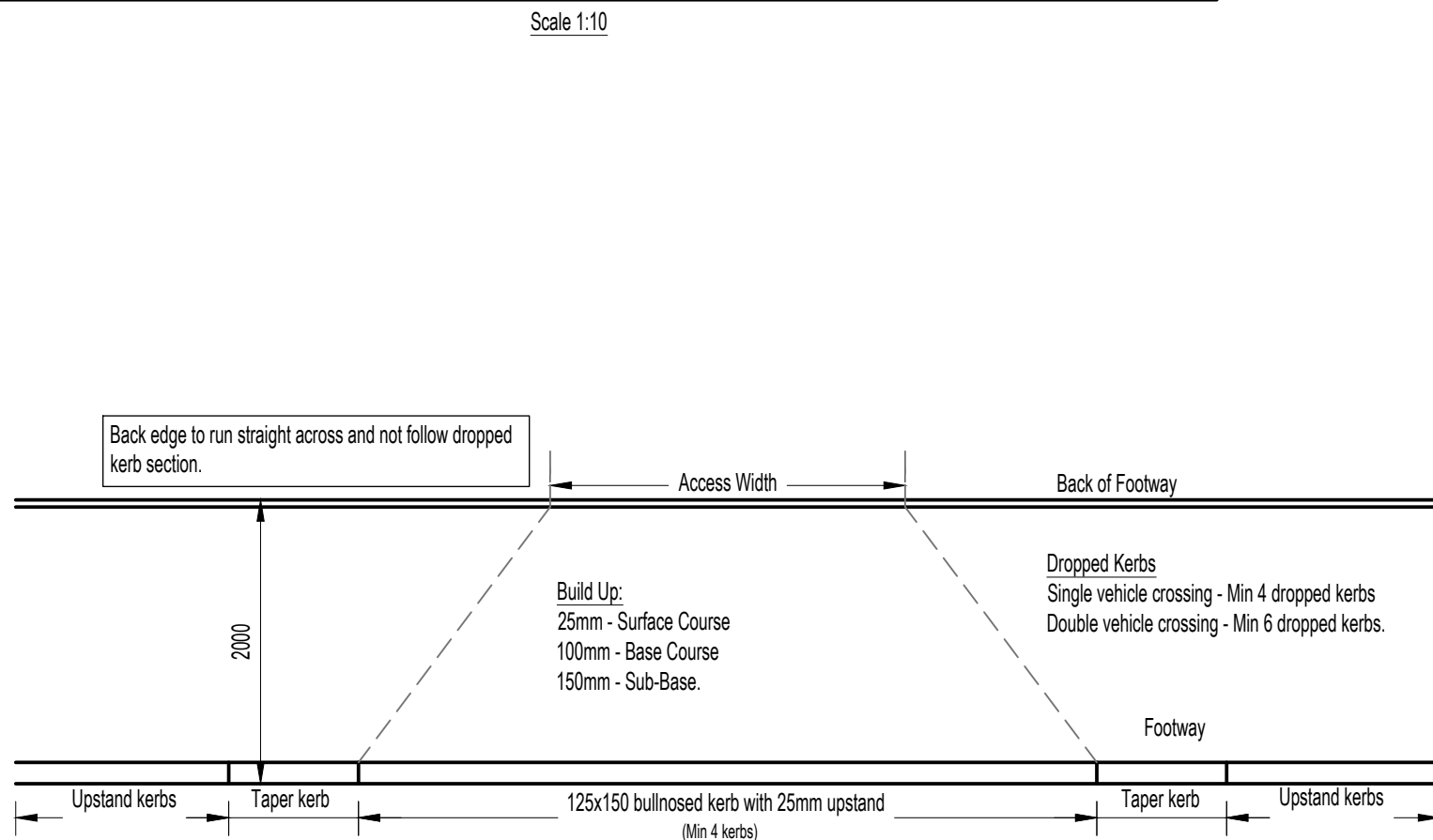

TYPICAL VEHICULAR CROSSING PLAN

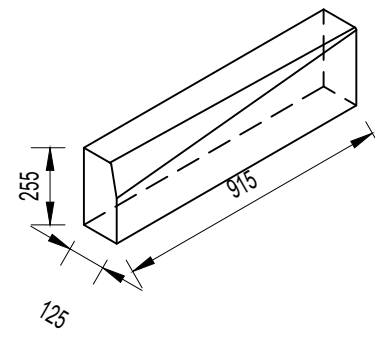

HALF-BATTERED TO BULLNOSE TRANSITION KERB

ROAD SPECIFICATION - TYPE 4

SURFACE COURSE
30mm thk - 10mm size dense bitumen macadam (dbm) 125 Pen surface course to BS 4987-1 Clause 7.5. HStone

BINDER COURSE
50mm thk - 20mm size dbm 125 Pen binder course to BS 4987-1 Clause 6.5. HStone

BASE (ROADBASE)
90mm thk - 32mm size dbm 125 Pen to BS 4987-1 Clause 5.2. LStone

SUB-BASE
440mm thk - type 1 granular sub-base to Highway Works Clause 803. Must be free from extraneous matter. Weeds must be removed and the sub-grade sprayed with total weedkiller.

ROAD SPECIFICATION - TYPE 5B

SURFACE COURSE
60mm thk - Concrete blocks laid on a screeded layer, 35mm compacted thickness of naturally occurring sand, complying with BS 7533 Part3. Method of laying to be in accordance with BS 6717 Part 3. Blocks to be either Marshalls Pencil Edge or Plasmore Plaseline. Unless otherwise approved the blocks shall be 200 x 100mm. Colours of blocks to be agreed with the Client & Highway Engineer

BINDER COURSE
50mm thk - 20mm size dbm 125 Pen binder course to BS 4987-1 Clause 6.5.

SUB-BASE
340mm thk - type 1 granular sub-base to Highway Works Clause 803. Must be free from extraneous matter. Weeds must be removed and the sub-grade sprayed with total weedkiller.

FOOTWAY SPECIFICATION

SURFACE COURSE
25mm thk - 0/6mm size dbm 190 Pen surface course complying with South Yorkshire Lab. Spec. No 34 and BS 4987 H/Stone.

BINDER COURSE
100mm thk - 0/20mm size dbm binder course complying with South Yorkshire Lab. Spec. No 31 and BS 4987. (100mm thick beneath vehicular footway crossing) L/Stone.

SUB-BASE 150mm thk - type 1 granular sub-base to South Yorkshire Lab. Spec. No 19. Must be free from extraneous matter. Weeds must be removed and the sub-grade sprayed with total weedkiller.

GENERAL NOTES

The formation, whether in cut or fill, shall be prepared, profiled and THOROUGHLY COMPACTED as required by clauses 612 and 616 of the DOT Specification for Highway Works.

Over excavation below road formation is to be backfilled with Type 1 granular sub-base material, well compacted in layers not exceeding 225mm. Minimum compacted thickness of any such layer to be 110mm.

Blast furnace slag and limestone aggregate are not allowed in the carriageway binder course unless it is to be covered within 6 weeks.

Channel Blocks to be used where the gradient is between 1:80 and 1:150.

No recycled aggregates to be used in sub base layers.

P01	First issue.	JR	CH	NOT ISSUED
REV	DESCRIPTION	SIG	CHK	DATE

HOOBER HOMES

WEST STREET, WOSBROUGH , BARNLEY

HIGHWAY CONSTRUCTION DETAILS SHEET 1 OF 2



Eastwood
CONSULTING ENGINEERS

St Andrew's House
23 Kingfield Road
Sheffield, S11 9AS

T: 0114 255 4554
E: mail@eastwoodce.com
eastwoodce.com

ECE PROJECT No	SCALE AT A1	STATUS	SUITABLE FOR
48404	As Stated	S0	Initial
DRAWING NUMBER			
48404	- ECE - XX - XX - DR - C -	0036	P01
Project	Originator	Zone	Level
	Type	Role	Number