

GENERAL NOTES
 This drawing shows the provisional design only and is subject to Local Authority approval. This drawing should not be scaled for setting out purposes unless specified.

This drawing is based on a topographical/ordnance survey provided by others.

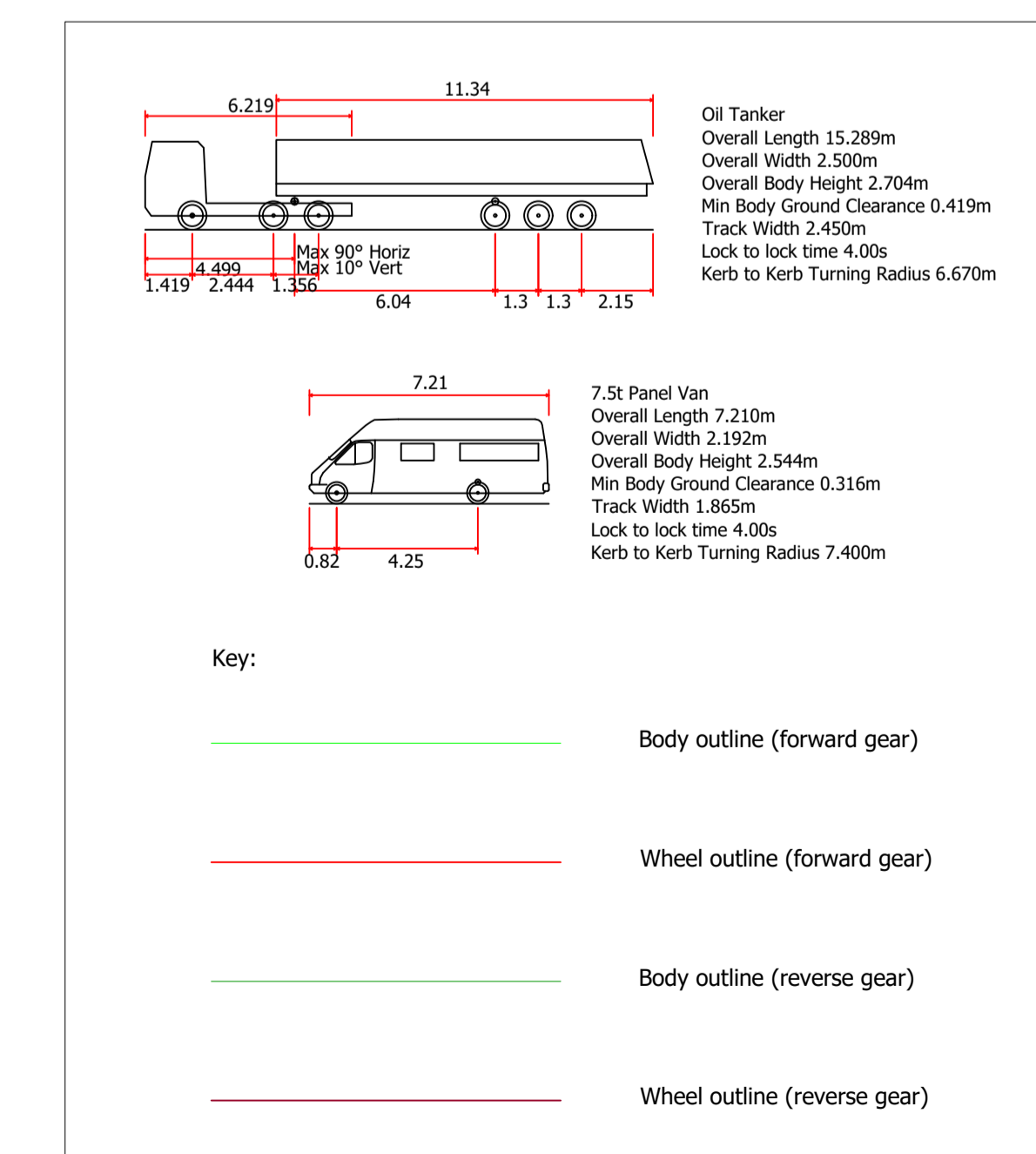
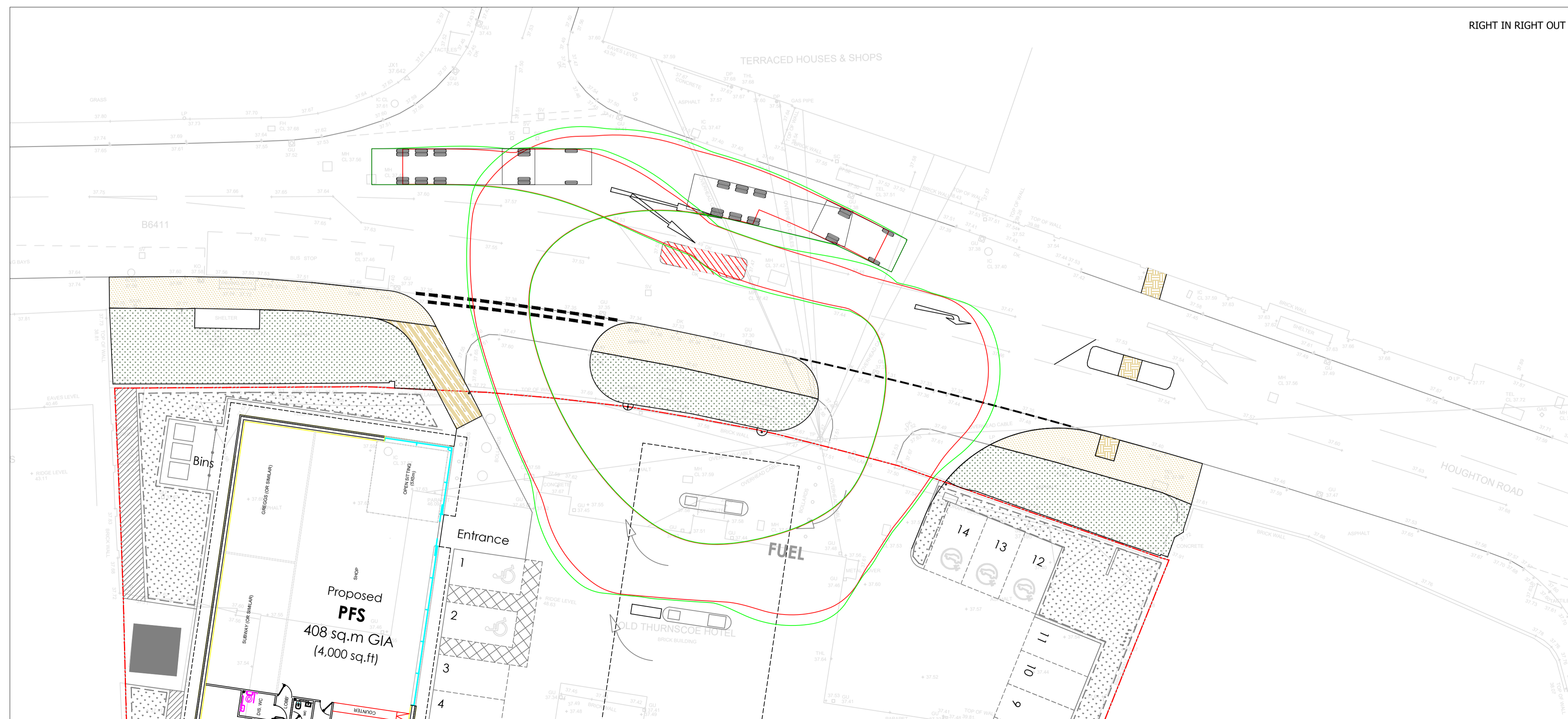
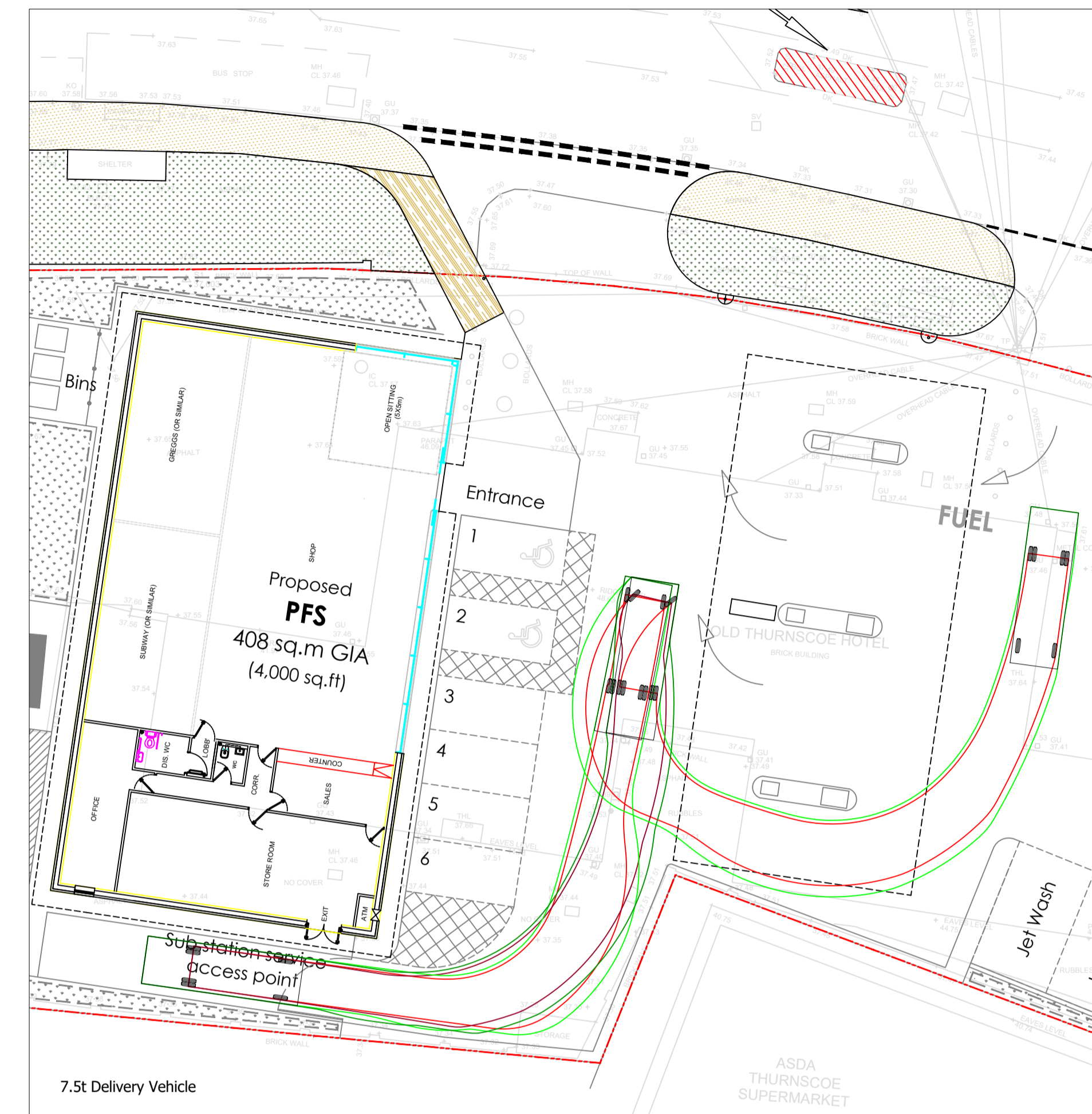
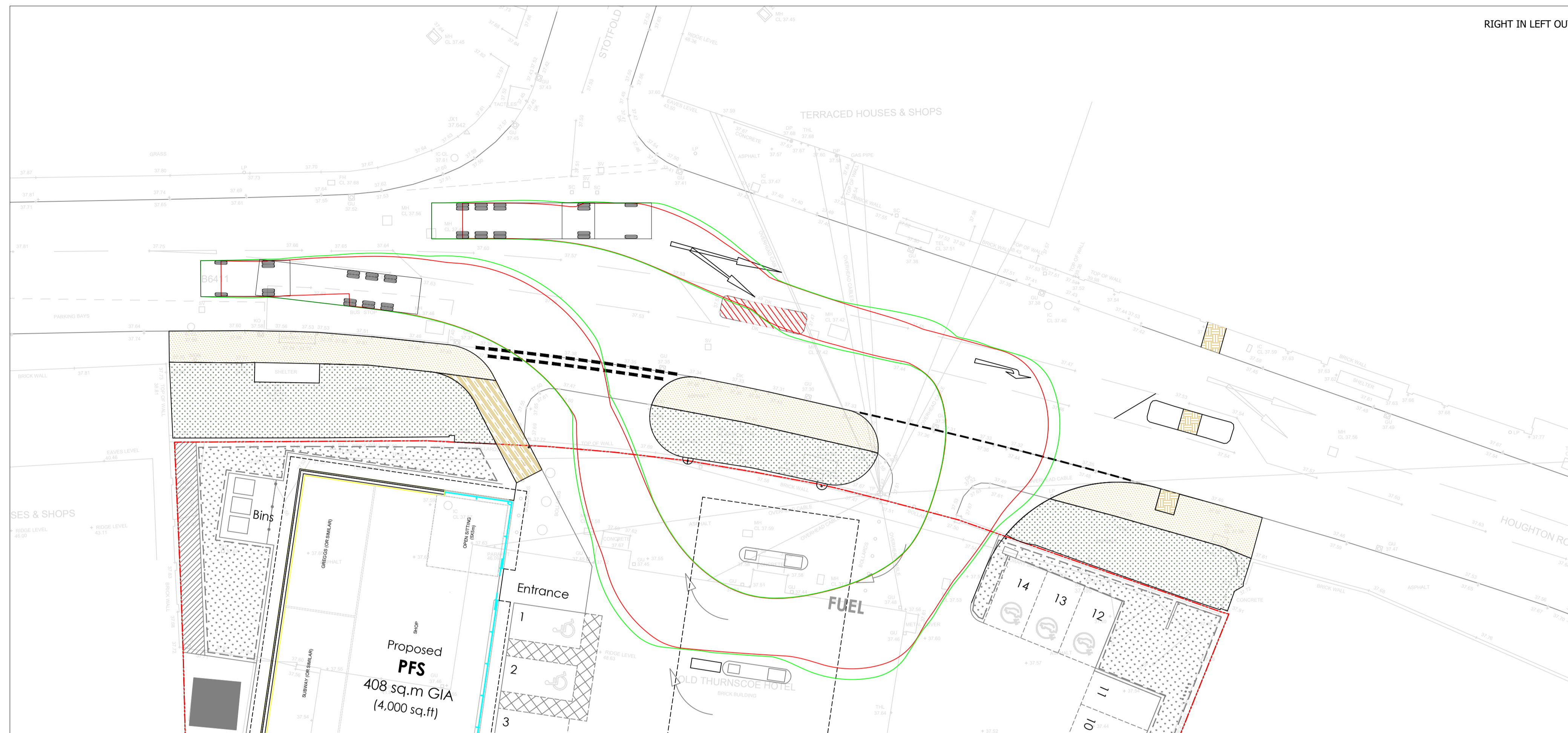
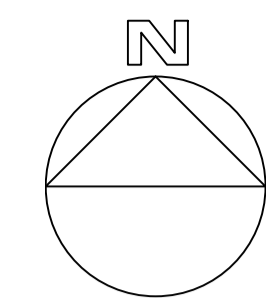

A 12.10.2022 AMENDED FOLLOWING COUNCIL COMMENTS

PROJECT
 THURNSCOE HOTEL, ROTHERHAM

TITLE
 VEHICLE TRACKING #2 OF 2

SCALE
 1:200 @ A1

DRAWING
 2075 -103A

DATE
 12.10.2022