

This drawing is the copyright of Rosetta Landscape Design and cannot be reproduced in any form without the express consent of the company. Written and scaled dimensions to be checked on site, any discrepancies reported prior to work commencing. **If in doubt please ask.**

This drawing has been prepared for the purpose of planning approval.

Planting Notes

Topsoil shall be a minimum of 400mm depth over planting beds and graded to fall. Imported topsoil must be BS3882:2007 compliant and existing topsoil must be cultivated in accordance with BS3882:2007. No cultivation should take place in wet/ waterlogged conditions.

Herbicide and cultivation: Topsoil to be treated with two applications of herbicide prior to planting, where necessary, strictly in accordance with the Control of Pesticides Regulations 1986 (as amended 1997, or, otherwise, updated/superseded legislation) and following manufacturer's instructions by qualified staff. The topsoil shall then be cultivated to 150mm depth.

Planting: All planting and turfing shall conform to BS: 3936: 1992 and BS:4428:1989.

Trees: Standard trees to be planted in pits 800x800x450mm or dimensions of rootball, whichever is greater. Heavy and Extra Heavy Standard trees to be planted in pits 1000x1000x600mm or dimensions of rootball, whichever is greater. Alginate soil improver and 150g Enmag (or, equivalent) to be incorporated into the soil of all new tree pits. Trees to be planted centrally within a tree pit. Tree stakes shall be of hazel, chestnut or other approved timber. They shall be round, rough sawn, straight, free from projections, large or edge knots and other defects and be pointed at the lower end. They shall be strong enough not to split when driven into the ground and when ties are nailed to them (both initially and when adjusted). For Feathered trees use 2Nr stakes (1.4m by 75mm) to be driven into ground 800mm, leaving 600mm above ground. For Selected Standard Trees 2Nr stakes (1.7m by 100mm) and cross bar are required; stakes to be driven 900mm below ground leaving 800mm above ground. For Heavy/ Extra Heavy trees use 2Nr stakes (2.2m x 100mm) with a 400x100x15mm cross bar. Stakes to be driven into ground 1m leaving 1.2m above ground.

Semi-mature/multi-stemmed trees greater than 5m to be underground guyed. Tree ties shall consist of a solid rubber spacer, hollowed on both sides and twice slotted of such a width that the tree is held away from the stake and/or cross bar, and such that it does not rub against the stake and/or cross bar in any location and fixed so that nails do not scar tree and 25mm wide rubber or rubber covered canvas strap of such a length to allow 50mm overlap after securing. The strap shall be flexible, slightly elastic and adjustable. The Fixing Nails shall be galvanised and not less than 38mm long with 10mm diameter heads.

Container grown shrubs, transplants and whips: Shrubs and transplants shall be planted in pits 300x300x400mm depth, and the backfill shall include 3 litres of peat-free tree and shrub compost. Where two or more shrub species are indicated within a single bed each species shall be randomly mixed throughout the bed in groups of 3/5.

Herbicide: Spot treat with herbicide throughout the maintenance period in accordance with the manufacturer's instructions.

Mulch: Planting beds to receive 75mm depth pulverized ornamental bark mulch. Native woodland/edge plants to be planted with 800g flax fibre mulch mat pinned to soil. Native hedgerow to be planted through 800g flax fibre mulch roll, edges tucked. Ensure the top of the mulch layer is a minimum of 15mm below adjacent pavements and other surfaces, to prevent spillage.

Plant position: Final position of trees and shrubs subject to confirmation of service location and approval of statutory undertakers.

Protection to planting: Native hedgerow plants to be protected by spiral shelters. Native trees and shrubs within mixes to be protected by shelter guards as supplied by Acorn Planting Products Ltd (01508 528763), or equivalent.

Ornamental hedging: Hedges to comprise a single row of plants. 400mm wide trench excavated to take plants and topsoil cultivated to 400mm depth prior to application of fertiliser.

Grass: All turf/seeded areas to be cultivated and levelled as required removing any stones, rubble, subsoil, general construction waste.

Wildflower grassland: To be prepared and cultivated in 100mm depth of nutrient poor soil.

Planting Season: Bare-root shrubs to be planted between mid-November and mid-March dependant upon the planting season.

LEGEND

Site boundary

Proposed tree Heavy (Standard)

Proposed tree Selected (Standard)

Proposed shrub bed

Proposed wildflower / grass mix: 50/50 mix of Emorsgate EM2 'Standard General Purpose Meadow Mixture' with EM34 'Mixed Diverse Meadows' @ sown @ 4g/m²

Proposed wildflower / grass mix Emorsgate EM8 'Meadow Mixture For Wetlands' sown @ 4g/m²

Proposed Native Woodland Mix

Proposed Native Shrub Mix

Proposed grass

Proposed Native Hedge Mix

Rev A: Revised to PRA Architects 'Proposed Site Layout', 1225.05 Rev A1 02Apr26

Base: PRA Architects 'Proposed Site Layout', 1225.05 Rev AH received 27Mar26

PROJECT	Wakefield Road, Smithies, Barnsley		
TITLE	Sales Area Detailed Landscape Proposal		
CLIENT	Gleeson Homes and Regeneration		
DATE	31 Mar 26	SCALE 1 : 1000	SHEET A0
DRAWN	RP	DRAWING NO	3836/7
CHECKED	BP	REVISION	A



Swallow's Nest, Main Street
Askham Richard, York, YO23 3PT

Telephone +44 (0)1904 500410

Email design@rosettalandscapedesign.co.uk
Web www.rosettalandscapedesign.co.uk

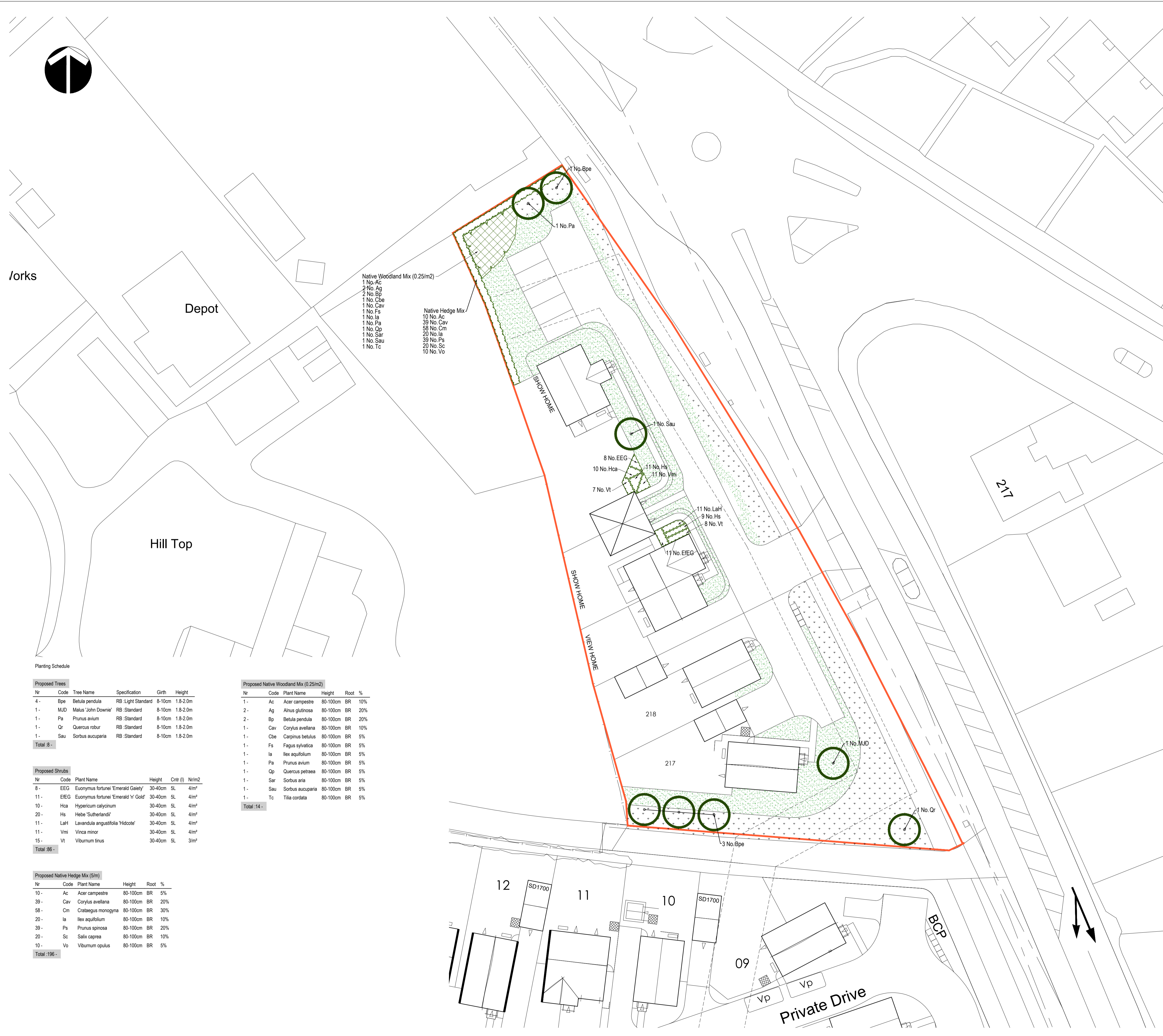

Planting Schedule

Nr	Code	Tree Name	Specification	Girth	Height
4-	Bpe	Betula pendula	RB -Light Standard	8-10cm	1.8-2.0m
1-	MJD	Malus 'John Downie'	RB -Standard	8-10cm	1.8-2.0m
1-	Pa	Prunus avium	RB -Standard	8-10cm	1.8-2.0m
1-	Qr	Quercus robur	RB -Standard	8-10cm	1.8-2.0m
1-	Sau	Sorbus aucuparia	RB -Standard	8-10cm	1.8-2.0m
Total :8-					

Nr	Code	Plant Name	Height	Ctr (l)	Nr/m2
8-	EEG	Euonymus fortunei 'Emerald Gaeley'	30-40cm	SL	4/m ²
11-	EREG	Euonymus fortunei 'Emerald 'n' Gold'	30-40cm	SL	4/m ²
10-	Hca	Hypericum calycinum	30-40cm	SL	4/m ²
20-	His	Hebe 'Sutherlandii'	30-40cm	SL	4/m ²
11-	LaH	Lavandula angustifolia 'Hidcotel'	30-40cm	SL	4/m ²
11-	Vmi	Vinca minor	30-40cm	SL	4/m ²
15-	Vt	Viburnum tinus	30-40cm	SL	3/m ²
Total :86-					

Nr	Code	Plant Name	Height	Root %
10-	Ac	Acer campestre	80-100cm	BR 5%
39-	Cav	Corylus avellana	80-100cm	BR 20%
58-	Cm	Crataegus monogyna	80-100cm	BR 30%
20-	la	Ilex aquifolium	80-100cm	BR 10%
39-	Ps	Prunus spinosa	80-100cm	BR 20%
20-	Sc	Salix caprea	80-100cm	BR 10%
10-	Vo	Viburnum opulus	80-100cm	BR 5%
Total :196-				

Nr	Code	Plant Name	Height	Root %
1-	Ac	Acer campestre	80-100cm	BR 10%
2-	Ag	Alnus glutinosa	80-100cm	BR 20%
2-	Bp	Betula pendula	80-100cm	BR 20%
1-	Cav	Corylus avellana	80-100cm	BR 10%
1-	Cbe	Carpinus betulus	80-100cm	BR 5%
1-	Fs	Fagus sylvatica	80-100cm	BR 5%
1-	la	Ilex aquifolium	80-100cm	BR 5%
1-	Pa	Prunus avium	80-100cm	BR 5%
1-	Op	Quercus petraea	80-100cm	BR 5%
1-	Sar	Sorbus aria	80-100cm	BR 5%
1-	Sau	Sorbus aucuparia	80-100cm	BR 5%
1-	Tc	Tilia cordata	80-100cm	BR 5%
Total :14-				