

Dewsome Avenue, Wombwell

Soft Landscaping Proposal ~ 1:200 at A1 ~ July 2016 ~ RAW - LA1

Shrubs to B53936 to be planted in debris & weed free topsoil 30 cms deep. Topsoil to B53882. Allow for 75mm depth of Contract Ornamental bark mulch to all planting beds. Stakes to be staked and tied at low level using 75mm dia peeled larch stakes & durable rubber ties. Tree pits to be 1.2m x 1.2m x 750mm deep, backfilled in layers & incorporating the recommended quantity of micorhyzal fungal spores.

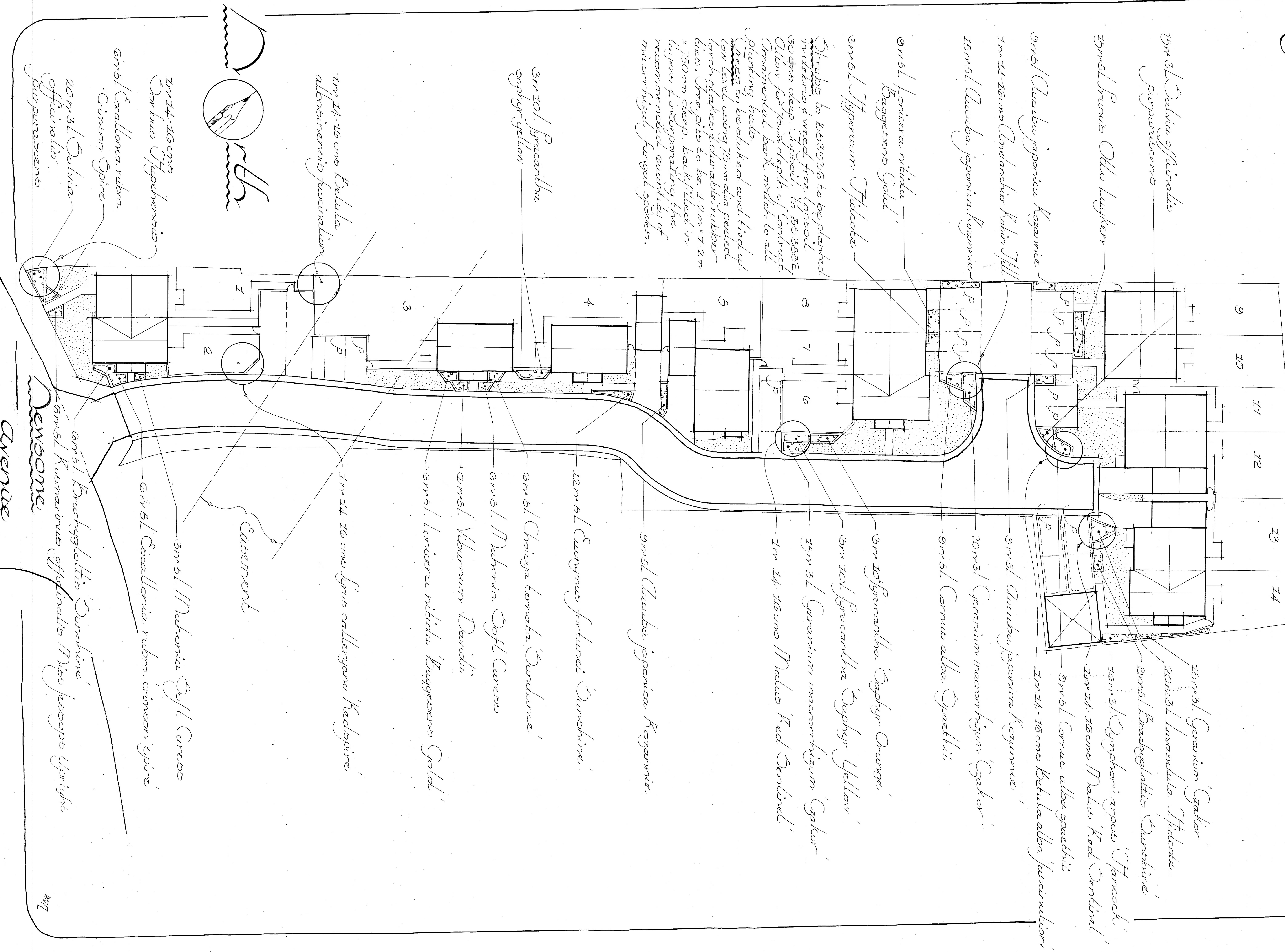

15m 3L *Salvia officinalis* 'Purpurascens'

15m 5L *Prunus* 'Otto Luyken'

9m 5L *Aucuba japonica* 'Koganne'

1m 14-16cm *Amelanchier* 'Robin Hill'

15m 5L *Aucuba japonica* 'Koganne'

9m 5L *Lonicera nitida* 'Baggesens Gold'

3m 5L *Hypericum* 'Stalcoke'

3m 10L *Pracantha* 'Saphyr yellow'

1m 14-16cm *Betula* 'albosinensis fascination'

1m 14-16cm *Barbus* 'Hypochensis'

9m 5L *Coccolonia rubra* 'Ginsoon Spire'

20m 3L *Salvia officinalis* 'Purpurascens'

9 10 11 12 13 14

15m 3L *Geranium* 'Gakor'

20m 3L *Lavandula* 'Stalcoke'

9m 5L *Brachyglottis* 'Sunshine'

16m 3L *Eumphoricarpus* 'Tancock'

1m 14-16cm *Malus* 'Red Sentinel'

9m 5L *Cornus alba* 'Spaethii'

9m 5L *Aucuba japonica* 'Koganne'

20m 3L *Geranium macrorrhizum* 'Gakor'

9m 5L *Cornus alba* 'Spaethii'

3m 10L *Pracantha* 'Saphyr Orange'

3m 10L *Pracantha* 'Saphyr Yellow'

15m 3L *Geranium macrorrhizum* 'Gakor'

1m 14-16cm *Malus* 'Red Sentinel'

9m 5L *Aucuba japonica* 'Koganne'

12m 5L *Euonymus fortunei* 'Sunshine'

9m 5L *Choisya ternata* 'Dundance'

9m 5L *Mahonia* 'Soft Caress'

9m 5L *Viburnum* 'Davidii'

9m 5L *Lonicera nitida* 'Baggesens Gold'

1m 14-16cm *Prunus calleryana* 'Redspire'

Casement

3m 5L *Mahonia* 'Soft Caress'

9m 5L *Coccolonia rubra* 'Ginsoon Spire'

9m 5L *Brachyglottis* 'Sunshine'

9m 5L *Rosmarinus officinalis* 'Miss Jessops Upright'

Dewsome Avenue

