

EXTERNAL RAINWATER PIPE CONNECTION

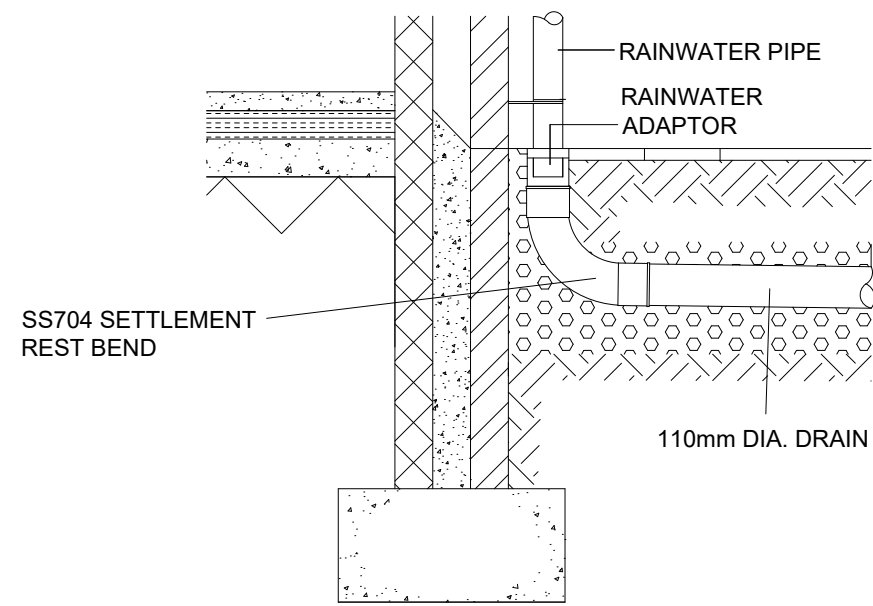

WHERE A COMBINED DRAINAGE SYSTEM IS BEING USED, A TRAPPED GULLY SHOULD BE USED AT THE BASE OF THE RAINWATER PIPE.

SOIL PIPE/WC CONNECTION

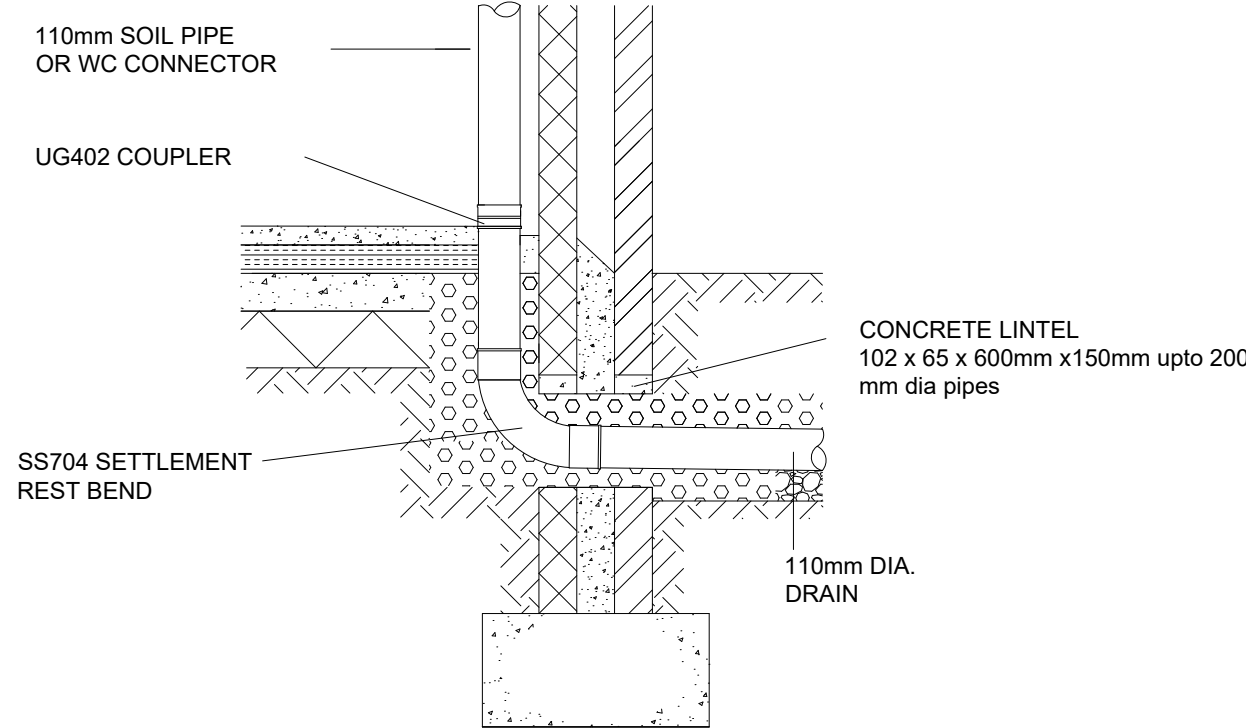

RAINWATER PIPE CONNECTION

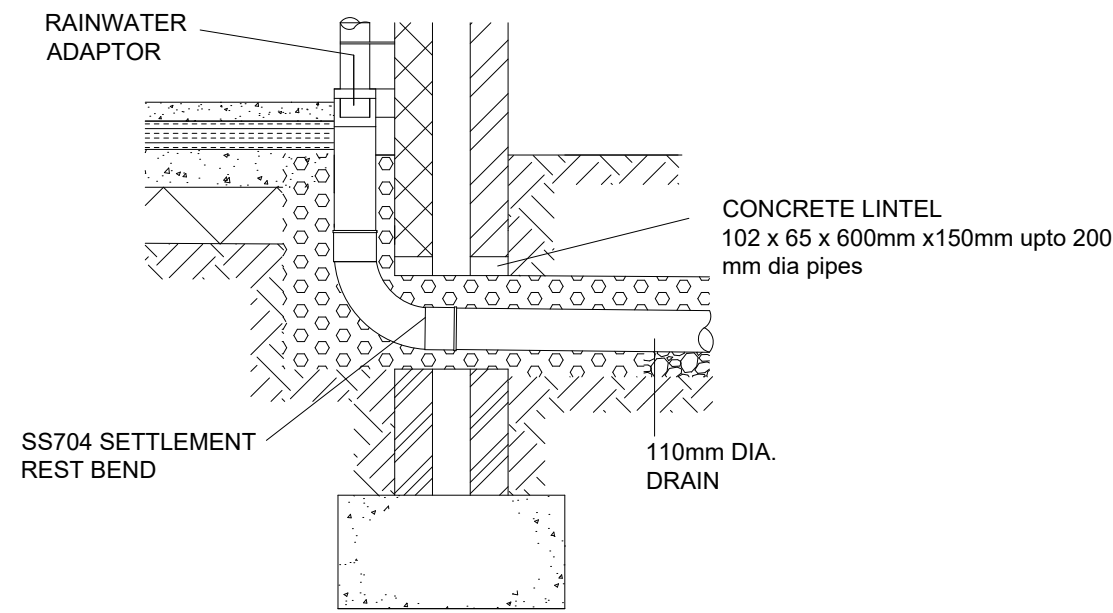

PIPES THROUGH WALLS

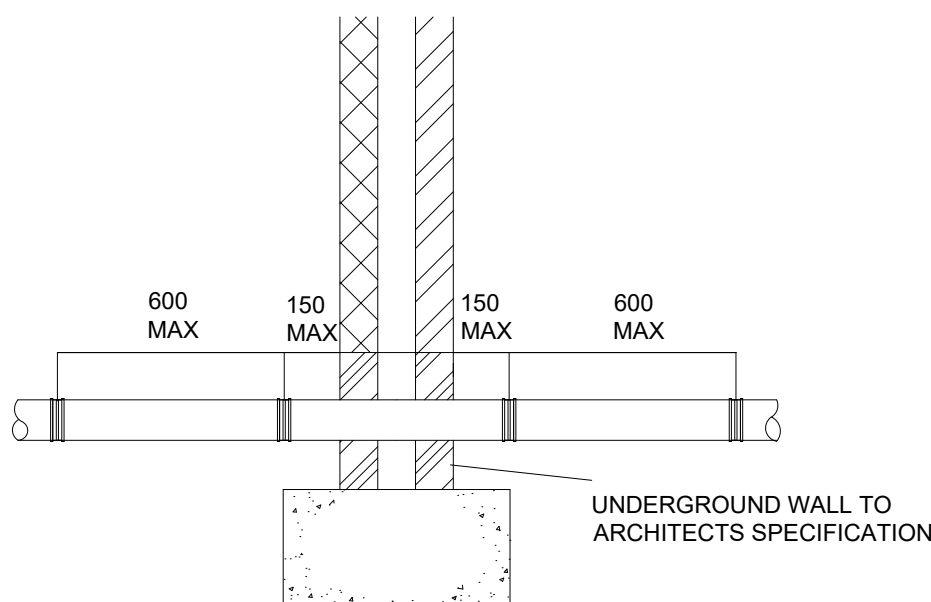

SHORT LENGTH OF PIPE BEDDED IN WALL WITH JOINTS WITHIN 150mm OF EACH WALL FACE.

ADJACENT ROCKER PIPES OF 600mm MAX.LENGTH WITH FLEXIBLE JOINTS.

PIPES NEAR BUILDINGS

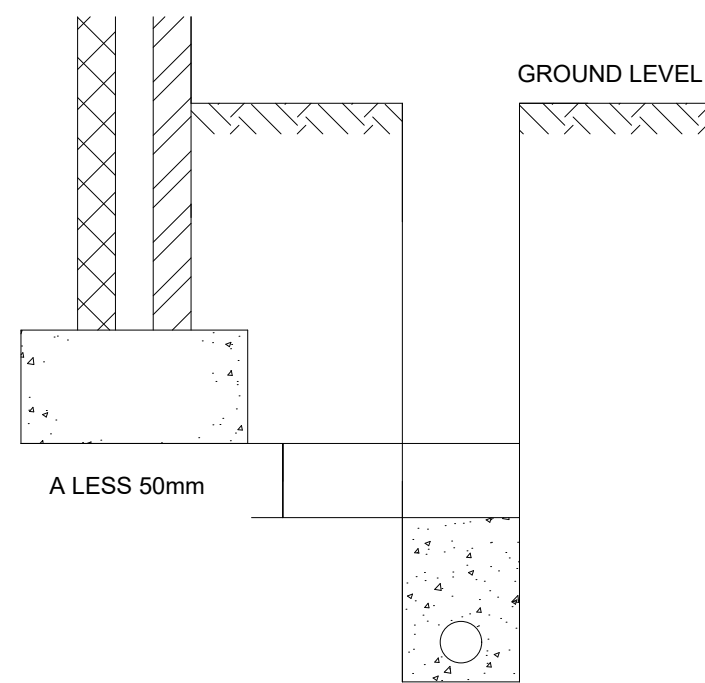

WHERE DIMENSION A IS GREATER THAN 1.0m, CONCRETE FILL TRENCH TO THIS LEVEL.

PIPES NEAR BUILDINGS

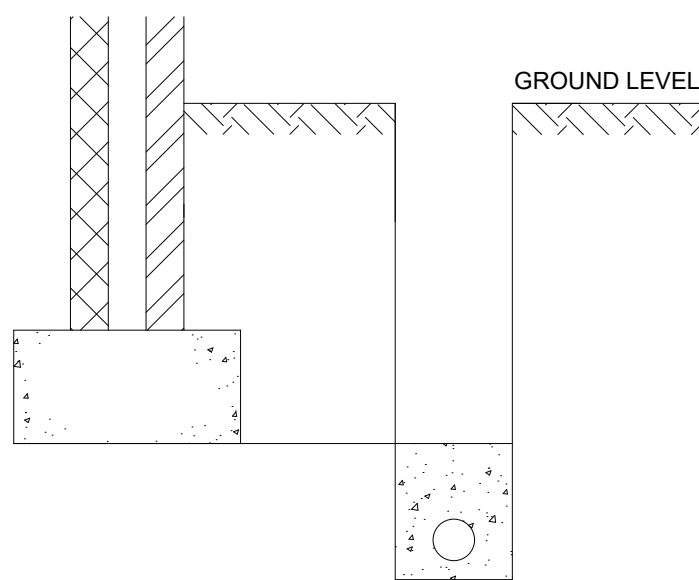

WHERE DIMENSION A IS LESS THAN 1m, CONCRETE FILL TRENCH TO LEVEL OF UNDERSIDE OF FOUNDATIONS.

PROTECTION FOR PIPES

1. PIPES LAID AT SHALLOW DEPTHS IN NON-TRAFFICKED AREAS.

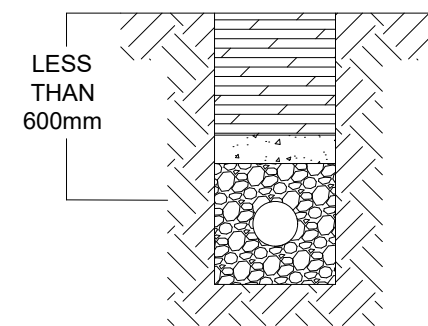

PIPES LAID IN NON TRAFFICKED AREAS, E.G. IN GARDENS WITH LESS THAN 600MM OF COVER, SHOULD BE PROTECTED AGAINST DAMAGE BY PLACING PAVING SLABS OR SIMILAR OVER THEM ACROSS THE WHOLE WIDTH OF THE TRENCH.

A LAYER OF GRANULAR MATERIAL OF 75mm MIN THICKNESS MUST BE LAID BETWEEN PIPES AND PROTECTION

PIPES THROUGH WALLS

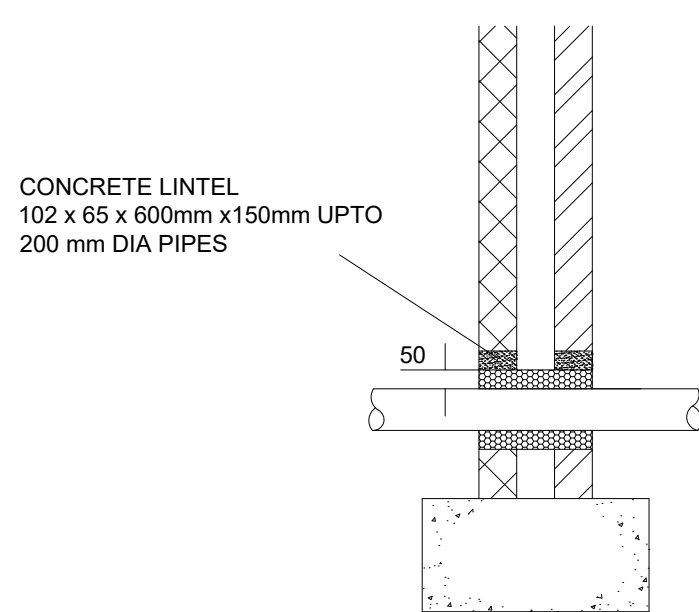

ARCH OR LINTEL OPENING TO GIVE 50mm SPACE ALL AROUND THE PIPE.

MASK OPENING ON BOTH SIDES OF THE WALL WITH RIGID SHEET MATERIAL SUCH AS 15 mm CEMENT BOARD OR EQUIVALENT APPROVED BY BUILDING CONTROL TO PREVENT ENTRY OF FILL OR VERMIN.

IMPORTANT FILL VOID WITH EXPANDING FOAM COMPRESSIBLE MATERIAL TO PREVENT ENTRY OF GAS.

INTERNAL WASTE PIPE CONNECTION

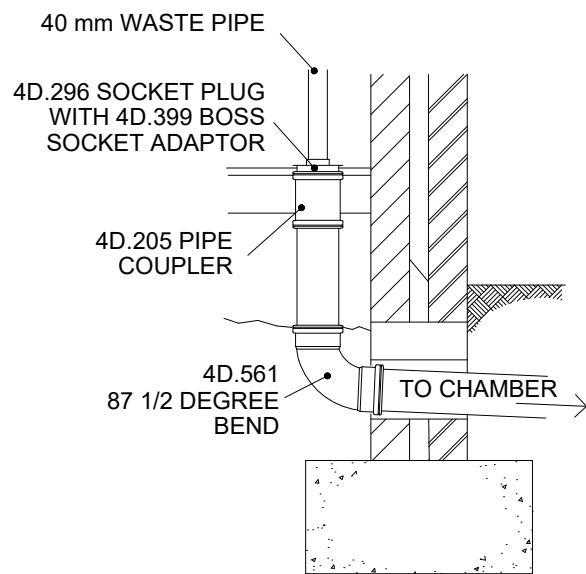

RODDING EYE

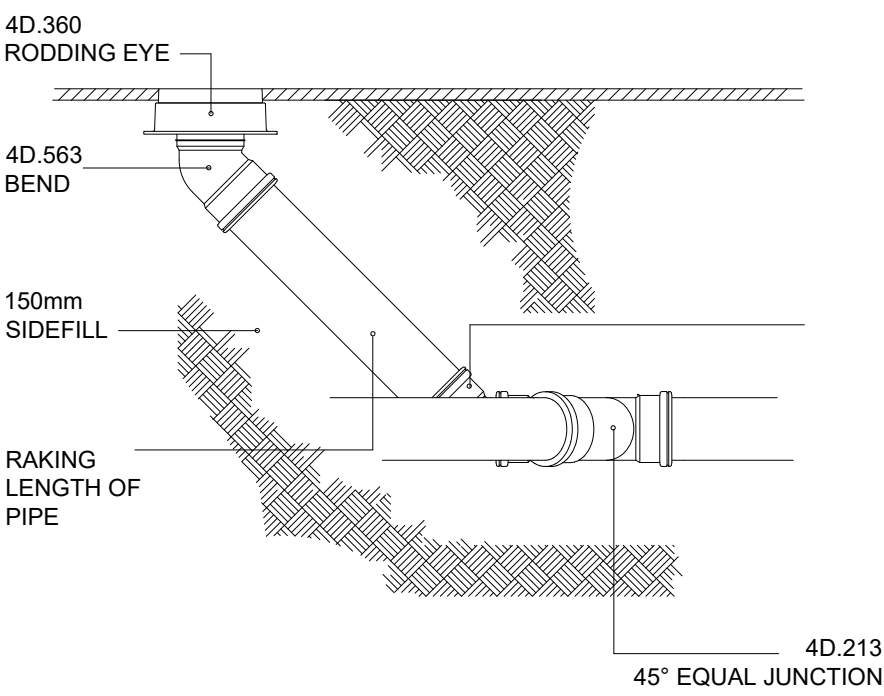

JOINT FOR CONCRETE ENCASED PIPE

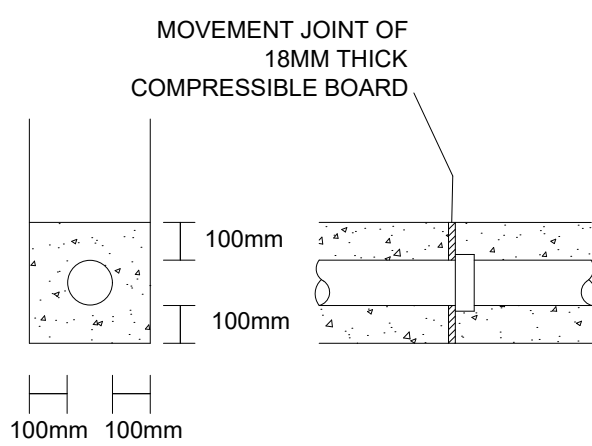

WHERE PIPES ARE SURROUNDED IN CONCRETE TO PROTECT NEARBY FOUNDATIONS, AN 18mm COMPRESSIBLE BOARD, E.G. FIBREBOARD OR POLYSTYRENE SHOULD BE PLACED AROUND THE PIPE AT EACH JOINT.

PIPES LAID AT SHALLOW DEPTHS UNDER BUILDINGS

WHERE THE CROWN OF THE PIPE IS WITHIN 300mm OF THE UNDERSIDE OF THE SLAB, THE PIPEWORK SHOULD BE SURROUNDED WITH 150mm CONCRETE AS AN INTEGRAL PART OF THE FLOOR SLAB.

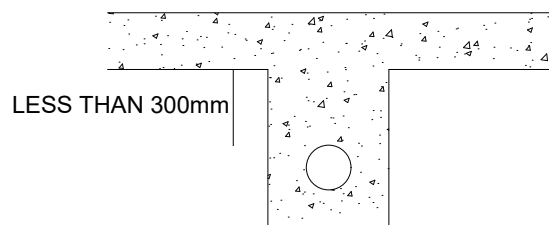

PIPES LAID AT SHALLOW DEPTHS IN ADAPTABLE TRAFFICKED AREAS.

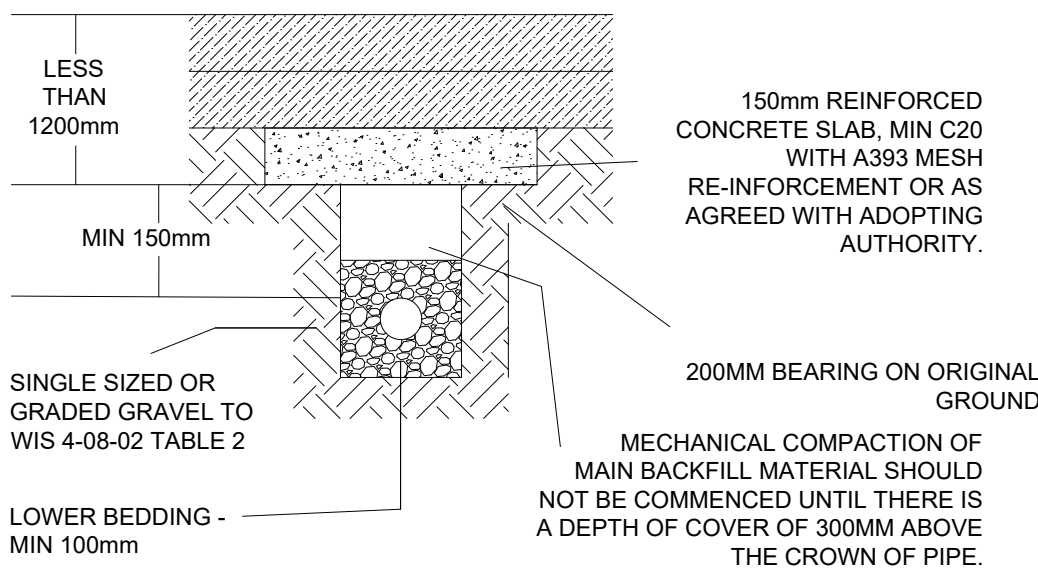

SIDEFILL MATERIAL TO BE PLACED EVENLY ON BOTH SIDES OF PIPE, TAKING CARE TO WORK UNDER THE LOWER QUADRANT OF PIPE, ENSURING THE PIPE IS NOT LIFTED. BOTH SIDES OF THE TRENCH SHOULD BE FILLED SIMULTANEOUSLY TO AVOID HORIZONTAL MOVEMENT OF THE PIPE.

VERTICAL INLET HOPPER, TRAPPED, CONNECTION DETAIL GC4

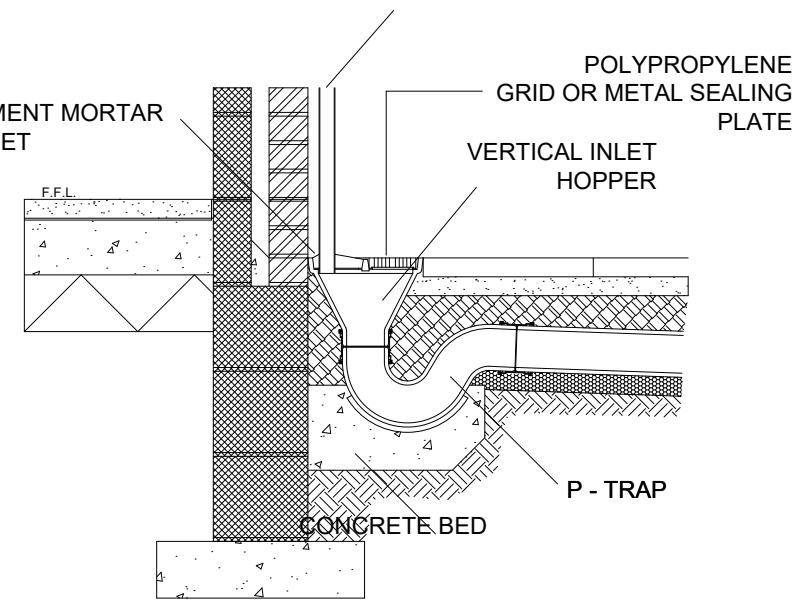

Y JUNCTION DETAIL

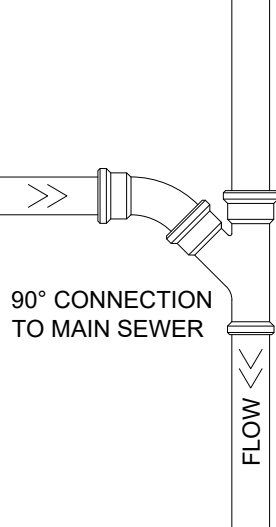

TRAPPED ROAD GULLY: TYPE G5 N.T.S

