

Notes:
Drawings are based on survey data and may not accurately represent what is physically present.
Do not scale from this drawing. All dimensions are to be verified on site before proceeding with the work.
All dimensions are in millimeters unless noted otherwise.
Purcell shall be notified in writing of any discrepancies.

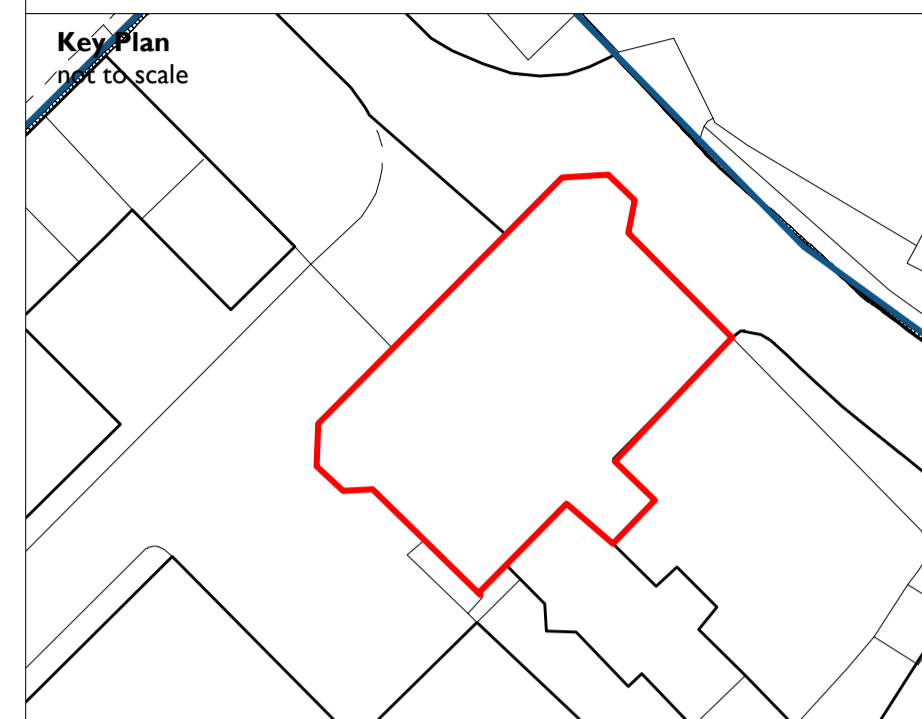

- KEY**
- As existing
 - Carpet tiling as M50/130. Allow for new plywood substrate as M50/560
 - Entrance matting as M50/170
 - Carpet with new nosings to stairs M50/130 & M50/750B
 - Deep clean existing flooring
 - Rubber sheet, Safety flooring M50/150A. Allow for new plywood substrate as M50/560
 - New floor tiles as M40/110B
 - Nursery demise

Note:
For floor finishes to lifts refer to lift specification.
Thresholds to be reviewed.

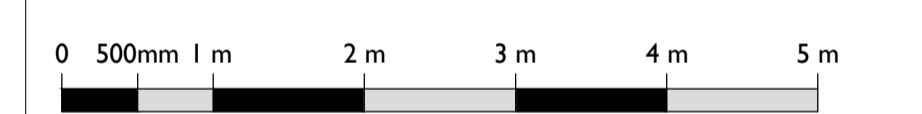

REV	DATE	BY	CHK	DESCRIPTION
P01	05/06/2023	TW	TW	
P02	25/08/2023	TW	TW	
C01	22/09/2023	TW	TW	
C02	17/10/2023	TW	TW	
C03	23/02/2024	YN	TW	

CLIENT
Barnsley MBC

PROJECT
Elsecar - Forging Ahead

JOB NUMBER
241992



PURCELL

TITLE
Building 13
First Floor - Floor Finishes

SIZE	SCALE	LAST REVISED	DRAWN	CHECKED
A1L	1:50	23/02/2024	YN	TW

REV SUITABILITY/REASON FOR ISSUE
C03 A4 - Technical Design Approved

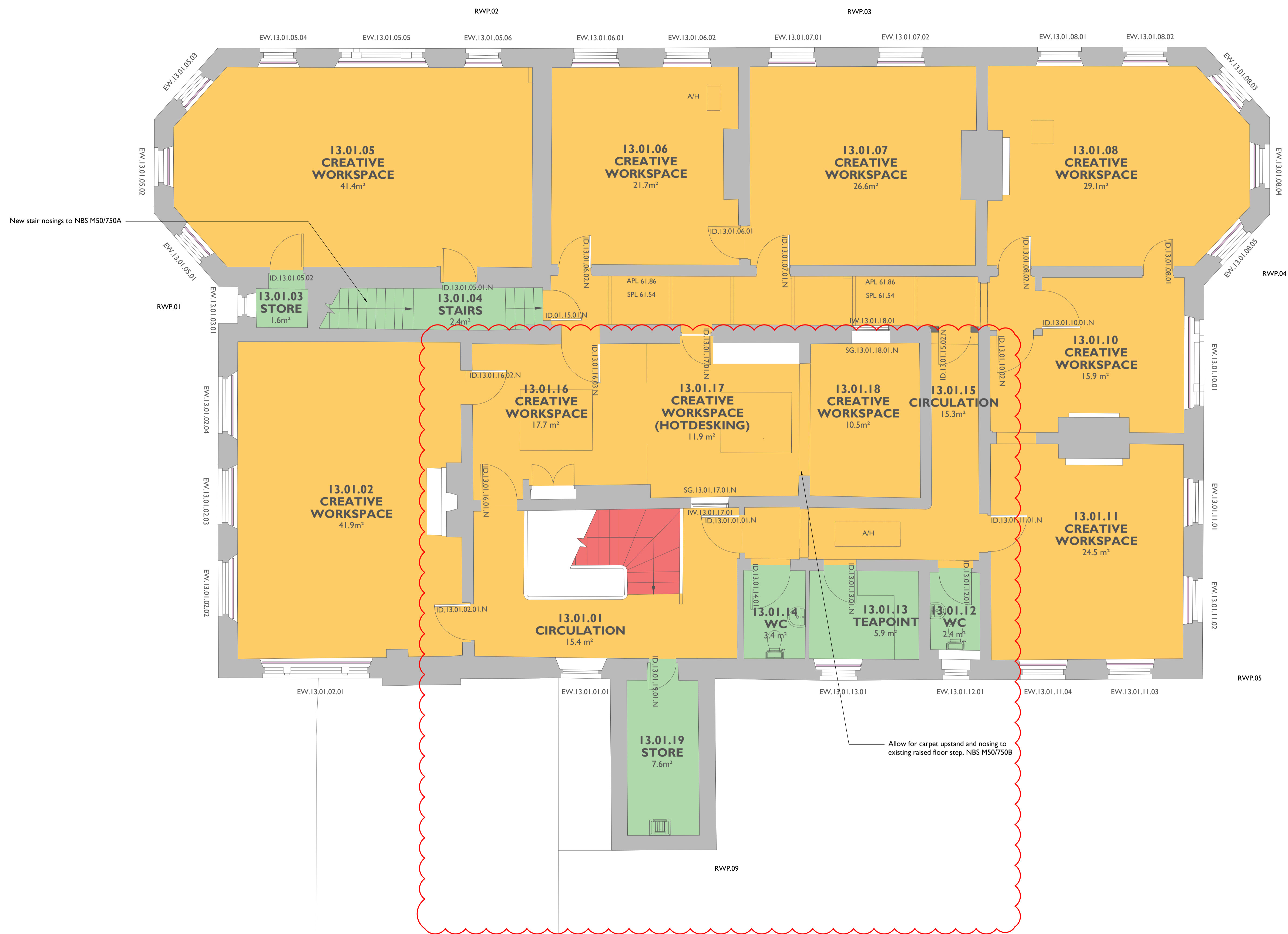
DRAWING NAME
EFAS-PUR-13-01-DR-A-3011



I First Floor - Floor Finishes
3011 1:50 @ A1

