

Symbol Guide

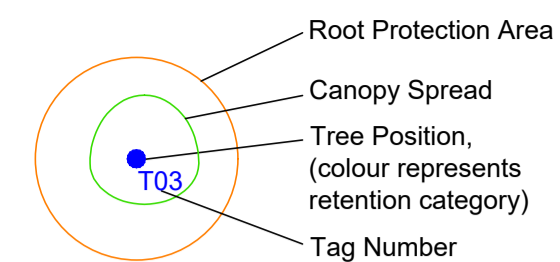

BS5837:2012 - Tree Category

- Category A Trees High Quality
- Category B Trees Moderate Quality
- Category C Trees Low Quality
- Category U Trees Poor Quality

KEY

- Indicative Red Line Boundary
- Proposed Retaining Wall
- Tree Protection Fencing



Project Name:	Capitol Park Barnsley
Drawing Title:	Tree Protection Plan
Drawing Number:	260426-1.5-CPB-TPP-LH
Client:	Marshall Construction (West Yorkshire) Ltd
Date:	May 2026
Scale:	1:500 @ A1

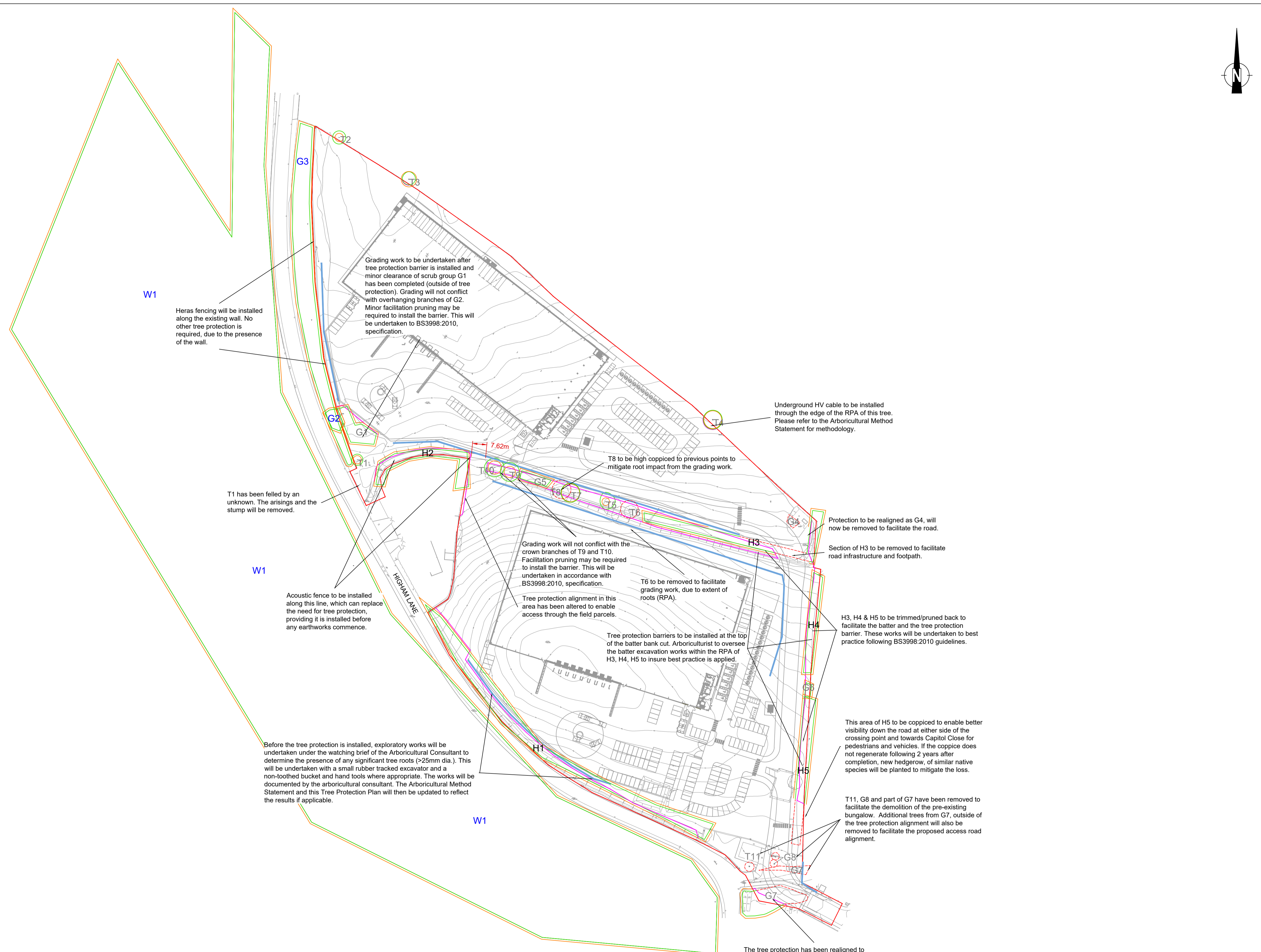

W1  
Heras fencing will be installed along the existing wall. No other tree protection is required, due to the presence of the wall.

Grading work to be undertaken after tree protection barrier is installed and minor clearance of scrub group G1 has been completed (outside of tree protection). Grading will not conflict with overhanging branches of G2. Minor facilitation pruning may be required to install the barrier. This will be undertaken to BS3998:2010, specification.

T1 has been felled by an unknown. The arisings and the stump will be removed.

W1  
Acoustic fence to be installed along this line, which can replace the need for tree protection, providing it is installed before any earthworks commence.

Before the tree protection is installed, exploratory works will be undertaken under the watching brief of the Arboricultural Consultant to determine the presence of any significant tree roots (>25mm dia.). This will be undertaken with a small rubber tracked excavator and a non-toothed bucket and hand tools where appropriate. The works will be documented by the arboricultural consultant. The Arboricultural Method Statement and this Tree Protection Plan will then be updated to reflect the results if applicable.

W1

Grading work will not conflict with the crown branches of T9 and T10. Facilitation pruning may be required to install the barrier. This will be undertaken in accordance with BS3998:2010, specification.

Tree protection alignment in this area has been altered to enable access through the field parcels.

Tree protection barriers to be installed at the top of the batter bank cut. Arboriculturist to oversee the batter excavation works within the RPA of H3, H4, H5 to insure best practice is applied.

T8 to be high copped to previous points to mitigate root impact from the grading work.

T6 to be removed to facilitate grading work, due to extent of roots (RPA).

Underground HV cable to be installed through the edge of the RPA of this tree. Please refer to the Arboricultural Method Statement for methodology.

Protection to be realigned as G4, will now be removed to facilitate the road.

Section of H3 to be removed to facilitate road infrastructure and footpath.

H3, H4 & H5 to be trimmed/pruned back to facilitate the batter and the tree protection barrier. These works will be undertaken to best practice following BS3998:2010 guidelines.

This area of H5 to be copped to enable better visibility down the road at either side of the crossing point and towards Capitol Close for pedestrians and vehicles. If the copping does not regenerate following 2 years after completion, new hedgerow, of similar native species will be planted to mitigate the loss.

T11, G8 and part of G7 have been removed to facilitate the demolition of the pre-existing bungalow. Additional trees from G7, outside of the tree protection alignment will also be removed to facilitate the proposed access road alignment.

The tree protection has been realigned to facilitate the altered footpath alignment, which is slightly further south. This will result in several more small trees being removed and the area to be retained will be reduced.