

SHEFFIELD ROAD, PENISTONE
EXTENDED PHASE 1 HABITAT SURVEY

A Report to The Co-Operative Group

Middlemarch Environmental Ltd
Triumph House
Birmingham Road
Allesley
Coventry
CV5 9AZ

Tel: 01676 525880
Fax: 01676 521400

E-Mail: admin@middlemarch-environmental.com
Web Site: www.middlemarch-environmental.com

Report Number: RT-MME-113193-01

December 2012

SHEFFIELD ROAD, PENISTONE
EXTENDED PHASE 1 HABITAT SURVEY

CONTROLLED COPY

01 OF 02

01 THE CO-OPERATIVE GROUP
02 MIDDLEMARCH ENVIRONMENTAL LTD

This report was compiled by:
Fiona Wallis BSc (Hons) and James Calow MPhil, CEnv, MIEEM, MIEMA, MIEEnvSc

*The contents of this report are the responsibility of Middlemarch Environmental Ltd.
It should be noted that, whilst every effort is made to meet the client's brief,
no site investigation can ensure complete assessment
or prediction of the natural environment.*

Contract Number C113193

December 2012

EXECUTIVE SUMMARY

Middlemarch Environmental Ltd was commissioned by the Co-Operative Group to carry out an initial ecological appraisal at a site at Sheffield Road, Penistone. To fulfill this brief an ecological desk study and Extended Phase I Habitat Survey were undertaken.

The ecological desk study revealed no nature conservation sites within 1 km of the survey area. However, the desk study did provide records for a number of protected and notable species including mammals and birds.

The Extended Phase I Habitat Survey was undertaken on 27th November 2012 by Fiona Wallis, Ecological Consultant. At the time of the survey, the site consisted mainly of poor semi-improved grassland with scattered trees, and scrub and a strip of plantation woodland along the northern boundary. Two walls were located on site; one stone retaining wall located parallel to the northern boundary and the second a brick wall located on the western boundary.

In order to ensure compliance with wildlife legislation and relevant planning policy, the following works are recommended:

- **Bats:** To ensure compliance with relevant legislation, the recommendations made in Middlemarch Environmental Ltd Initial Bat Survey RT-MME-113193-02 should be followed.
- **Nesting Birds:** To ensure compliance with the Wildlife and Countryside Act 1981 (as amended), vegetation clearance should be undertaken outside the nesting bird season. If this is not possible then any vegetation that is to be removed or disturbed should be checked by an experienced ecologist for nesting birds immediately prior to works commencing.
- **Reptiles:** To ensure compliance with the Wildlife and Countryside Act 1981 (as amended), a reptile survey should be undertaken of suitable habitats within the proposed development site.
- **Terrestrial Mammals including Hedgehog:** Any excavations that need to be left overnight should be covered or fitted with mammal ramps to ensure that any animals that enter can safely escape.
- **Japanese Knotweed:** To ensure compliance with the Wildlife and Countryside Act 1981 (as amended) the works must not cause Japanese knotweed to spread. Therefore it is recommended that a Japanese knotweed survey be completed and a Method Statement developed to ensure that the proposed works do not result in the spread of this invasive non-native species.

Recommendations regarding habitat enhancement and the protection of BAP habitats and trees have also been made and can be viewed in Section 6.

CONTENTS

| | |
|---|-----------|
| 1. INTRODUCTION..... | 5 |
| 1.1 PROJECT BACKGROUND..... | 5 |
| 1.2 SITE DESCRIPTION..... | 5 |
| 2. METHODOLOGIES | 6 |
| 2.1 DESK STUDY | 6 |
| 2.2 EXTENDED PHASE 1 HABITAT SURVEY..... | 6 |
| 3. DESK STUDY RESULTS | 7 |
| 3.1 INTRODUCTION | 7 |
| 3.2 NATURE CONSERVATION SITES | 7 |
| 3.3 PROTECTED SPECIES | 7 |
| 3.4 INVASIVE SPECIES..... | 9 |
| 4. EXTENDED PHASE 1 HABITAT SURVEY | 10 |
| 4.1 INTRODUCTION | 10 |
| 4.2 SURVEY CONSTRAINTS | 10 |
| 4.3 HABITATS..... | 10 |
| 4.4 FAUNA | 12 |
| 4.5 INVASIVE PLANT SPECIES..... | 12 |
| 5. DISCUSSIONS AND CONCLUSIONS..... | 13 |
| 5.1 INTRODUCTION / SUMMARY OF PROPOSALS | 13 |
| 5.2 NATURE CONSERVATION SITES | 13 |
| 5.3 HABITATS..... | 13 |
| 5.4 PROTECTED/NOTABLE SPECIES | 14 |
| 5.5 INVASIVE PLANT SPECIES..... | 15 |
| 6. RECOMMENDATIONS | 16 |
| 6.1 NATURE CONSERVATION SITES | 16 |
| 6.2 HABITATS..... | 16 |
| 6.3 PROTECTED / NOTABLE SPECIES..... | 16 |
| 6.4 INVASIVE PLANT SPECIES..... | 17 |
| REFERENCES AND BIBLIOGRAPHY..... | 18 |
| APPENDICES | 19 |
| APPENDIX 1 | 20 |
| APPENDIX 2 | 51 |
| APPENDIX 3 | 54 |

1. INTRODUCTION

1.1 PROJECT BACKGROUND

In November 2012 the Co-Operative Group commissioned Middlemarch Environmental Ltd to undertake an initial ecological appraisal of the site of a proposed development at Sheffield Road, Penistone. It is understood that the proposals include the construction of 44 residential units with associated infrastructure and landscaping.

Middlemarch Environmental Ltd has also carried out a bat survey and an arboricultural survey for The Co-Operative Group at this site. The findings of these surveys are detailed in Middlemarch Environmental Ltd Reports RT-MME-113193-02 and RT-MME-113193-03 respectively.

To fulfil the above brief to assess the existing ecological interest of the site, a desk study and an Extended Phase 1 Habitat Survey were undertaken on 27th November 2012.

1.2 SITE DESCRIPTION

The site is centred at National Grid Reference SE 252 032. The site is located in the eastern outskirts of Penistone off the B6462 in the Metropolitan Borough of Barnsley, South Yorkshire. The surrounding landscape comprised a mixture of built up areas with roads and residential dwellings, small scale industrial buildings and a railway line to the south west. The River Don is located 50 m north of the site. The site consisted mainly of poor semi-improved grassland with scattered trees, and scrub and a strip of plantation woodland along the northern boundary. Two walls were located on site; one stone retaining wall located parallel to the northern boundary and the second a brick wall located on the western boundary.

2. METHODOLOGIES

2.1 DESK STUDY

A desk study was undertaken to determine the presence of any designated nature conservation sites and protected species that have been recorded within a 1 km radius of the site.

This involved contacting appropriate statutory and non-statutory organisations which hold ecological data relating to the survey area. Middlemarch Environmental Ltd then assimilated and reviewed the desk study data provided by these organisations.

The consultees for the Desk Study were:

- Natural England - *MAGIC* website for statutory conservation sites; and,
- Sheffield Biological Records Centre.

The data collected from these consultees is discussed in Section 3. Raw data are provided in Appendix 1.

2.2 EXTENDED PHASE 1 HABITAT SURVEY

An Extended Phase 1 Habitat Survey was conducted following the methodology of the Joint Nature Conservation Committee (JNCC, 2010) and the Institute of Environmental Assessment (IEA, 1995). Phase 1 Habitat Survey is a standard technique for classifying and mapping British habitats. The aim is to provide a record of habitats that are present on site. During the survey, the presence, or potential presence, of protected species was noted. Data recorded during the field survey is discussed in Section 4.

Whilst every effort is made to notify the client of any plant species listed on Schedule 9 of the Wildlife and Countryside Act (1981, as amended) present on site, it should be noted that this is not a specific survey for these species.

3. DESK STUDY RESULTS

3.1 INTRODUCTION

All relevant ecological data provided by the consultees was reviewed and the results from these investigations are summarised below in Sections 3.2 and 3.3. The full data are provided in Appendix 1.

3.2 NATURE CONSERVATION SITES

Reference to the Multi Agency Geographical Information for the Countryside (MAGIC) website and the local biodiversity information indicates that no nature conservation sites with statutory protection and no nature conservation sites with non-statutory protection occur within a 1 km radius of the survey area.

Two areas of ancient woodland occur within a 1 km radius of the site. Shrogg Wood is located approximately 610 m north east of the site and Spring Vale Wood approximately 650 m east of the site. The Scout Dike Grassland Inventory Site is located approximately 850 m west of the site. This site is listed as containing neutral grassland.

3.3 PROTECTED SPECIES

Table 3.1 provides a summary of protected species records within a 1 km radius of the study area. It should be noted that the absence of records should not be taken as confirmation that a species is absent from the search area. Relevant records of UK and local Biodiversity Action Plan species have also been included within this table.

| Species | No. of Records | Most Recent Record | Proximity of Nearest Record to Study Area | UK BAP? | Local BAP? | NERC S.41 List? | Legislation / Conservation Status |
|---|----------------|--------------------|---|---------|------------|-----------------|-----------------------------------|
| Mammals | | | | | | | |
| <i>Bats</i> | | | | | | | |
| Brandt's bat <i>Myotis brandti</i> | 1 | 1990 | 640 m north west | - | ✓ | - | ECH 4, WCA 5, WCA 6 |
| Noctule <i>Nyctalus noctula</i> | 2 | 1991 | 640 m north west | ✓ | ✓ | ✓ | ECH 4, WCA 5, WCA 6 |
| Pipistrelle <i>Pipistrellus pipistrellus</i> | 13 | 1997 | 500 m north west | - | ✓ | - | ECH 4, WCA 5, WCA 6 |
| Soprano pipistrelle <i>Pipistrellus pygmaeus</i> | 1 | 2001 | 1 km west | ✓ | ✓ | ✓ | ECH 4, WCA 5, WCA 6 |
| Unidentified bat <i>Chiroptera</i> sp. | 7 | 2008 | 500 m north west | - | ✓ | - | ECH 4, WCA 5, WCA 6 |
| Whiskered bat <i>Myotis mystacinus</i> | 1 | 1987 | 640 m north west | - | ✓ | - | ECH 2, ECH 4, WCA 5, WCA 6 |
| <i>Other</i> | | | | | | | |
| Brown hare <i>Lepus europaeus</i> | 1 | Historic | 700 m west | ✓ | - | ✓ | - |
| Hedgehog <i>Erinaceus europaeus</i> | 4 | 1983 | 500 m south west | ✓ | ✓ | ✓ | WCA 6 |
| Key: | | | | | | | |
| <p>ECH 2: Annex II of the European Communities Council Directive on the Conservation of Natural Habitats and Wild Fauna and Flora. Animal and plant species of community interest whose conservation requires the designation of Special Areas of Conservation.</p> <p>ECH 4: Annex IV of the European Communities Council Directive on the Conservation of Natural Habitats and Wild Fauna and Flora. Animal and plant species of community interest in need of strict protection.</p> <p>WCA 5: Schedule 5 of Wildlife and Countryside Act 1981 (as amended). Protected animals (other than birds).</p> <p>WCA 6: Schedule 6 of Wildlife and Countryside Act 1981 (as amended). Animals which may not be killed or taken by certain methods.</p> <p>UK BAP: United Kingdom Biodiversity Action Plan.</p> <p>Local BAP: Barnsley Local Biodiversity Action Plan</p> <p>NERC S.41: Natural Environment and Rural Communities Act 2006, Section 41: Habitats and Species of Principal Importance in England.</p> <p>Note. This table does not include reference to the Berne Convention (Convention on the Conservation of European Wildlife and Natural Habitats), the Bonn Convention on the Conservation of Migratory Species of Wild Animals or the Convention on International Trade in Endangered Species of Wild Fauna and Flora (CITES).</p> | | | | | | | |

Table 3.1: Summary of Protected/Notable Species Records Within 1 km Radius of Study Site

In addition to the records provided in Table 3.1, records of numerous notable bird species were provided. Many of these species are listed on the UK BAP and could utilise the habitats on site including house sparrow *Passer domesticus* (RSPB Red List), starling *Sturnus vulgaris* (RSPB Red List) and yellowhammer *Emberiza citrinella* (RSPB Red List). A number of common plant, moss, lichen and invertebrate species were also recorded in the ecological desk study. The details of these are provided in Appendix 1.

3.4 INVASIVE SPECIES

The ecological desk study identified no invasive species records within a 1 km radius of the study area. It should be noted that the absence of records should not be taken as confirmation that a species is absent from the search area.

3.5 PREVIOUS ECOLOGICAL SURVEYS

In April 2009 the Co-Operative Group commissioned Entec UK Ltd to undertake an initial ecological appraisal of the site of a proposed development at Sheffield Road, Penistone. This included undertaking a desk study and an Extended Phase 1 Habitat Survey of the proposed development site.

This survey concluded that the majority of the site comprised semi-improved grassland with areas of scattered and dense scrub. A densely planted broadleaved woodland was located on the northern boundary, which may have been planted as screening. Whilst the site was generally considered to be of negligible nature conservation value, the habitats on site were deemed to have potential to support protected species, such as nesting birds and reptiles.

4. EXTENDED PHASE 1 HABITAT SURVEY

4.1 INTRODUCTION

The results of the Extended Phase 1 Habitat Survey are presented in Section 4.2. An annotated Extended Phase 1 Habitat Survey Drawing (Middlemarch Environmental Ltd Drawing C113193-01-01) is attached in Appendix 2. This drawing illustrates the location and extent of all habitat types recorded on site. Any notable features or features too small to map are detailed using target notes.

The survey was carried out on 27th November 2012 by Fiona Wallis, Ecological Consultant. Table 4.1 details the weather conditions at the time of the survey.

| Parameter | Condition |
|------------------|--------------------|
| Temperature (°C) | 8 |
| Cloud (%) | 100 |
| Wind (Beaufort) | F2 |
| Precipitation | Occasional Drizzle |

Table 4.1: Weather Conditions During Survey Period

4.2 SURVEY CONSTRAINTS

November is not an optimal time for completing botanical assessments however, given the nature of the habitats present, this was not considered to be a significant constraint to a robust initial site assessment.

4.3 HABITATS

The following habitat types were recorded on site during the field survey:

- Amenity Grassland
- Broadleaved Plantation Woodland
- Dense Scrub
- Fence
- Hardstanding
- Poor Semi Improved Grassland
- Scattered Scrub
- Scattered Broadleaf Trees
- Tall Ruderals
- Wall

These habitats are described below. They are ordered alphabetically, not in order of ecological importance.

Amenity Grassland

A small road verge was present within the proposed development boundary and comprised perennial rye grass *Lolium perenne* with Yorkshire fog *Holcus lanatus* and dandelion *Taraxacum officinale* agg. The sward had been cut short to approximately 20 cm at the time of the survey.

Broadleaved Plantation Woodland

The broadleaf plantation woodland block comprised a number of young to early mature trees including silver birch *Betula pendula*, willow *Salix* sp., alder *Alnus glutinosa* and sycamore *Acer pseudoplatanus*. The average height of the trees was approximately 15 m. The field layer comprised bramble *Rubus fruticosus* agg. with hawthorn *Crataegus monogyna*, dogrose *Rosa canina* and fern *Dryopteris* sp.

Dense Scrub

The dense scrub is present in the north western portion of the site and comprised birch *Betula* sp., willow *Salix* sp., alder *Alnus glutinosa*, ash *Fraxinus excelsior* and bramble *Rubus fruticosus* agg. Trees overhanging the site in this corner include early mature sycamore *Acer pseudoplatanus* (Target Note 3).

Fence

A wooden fence is present along the eastern boundary within the poor semi-improved grassland habitat. This fence did not support any notable vegetation.

Hardstanding

Tarmac roads and pavements are present within the site. No notable vegetation was present within this habitat aside from occasional areas of moss.

Poor Semi Improved Grassland

This habitat dominated the proposed development area with patches of locally frequent tall ruderal vegetation. The grassland was tussocky in places (Target Note 1) with some bare areas in a recently disturbed patch near the eastern boundary which had started to re-colonise. The sward ranged from very short (where used as a footpath) to tall and tussocky, with an average height of around 20 cm. Species recorded within this habitat included perennial rye grass *Lolium perenne*, cock's-foot *Dactylis glomerata* (both dominant), ribwort plantain *Plantago lanceolata*, dandelion *Taraxacum officinale* agg., clover *Trifolium* sp., willowherb *Epilobium* sp., thistle *Cirsium* sp., nettle *Urtica dioica*, fescue *Festuca* sp., birds-foot trefoil *Lotus corniculatus*, Yorkshire fog *Holcus lanatus*, false oat grass *Arrhenatherum elatius*, umbellifers, vetch *Vicia* sp., dock *Rumex* sp. and teasel *Dipsacus fullonum*.

Scattered Scrub

Scattered scrub is present throughout the semi-improved grassland habitat. This mainly comprised young tree saplings such as birch *Betula* sp. and willow *Salix* sp. with hawthorn *Crataegus monogyna*, dogrose *Rosa canina* and *Cotoneaster watereri*. The trees were generally young and ranged between 2 and 6 m in height.

Scattered Broadleaved Trees

A number of broadleaved trees were present along the southern boundary of the site including birch *Betula* sp., willow *Salix* sp., and alder *Alnus glutinosa*. The trees were approximately 8 m in height and were young.

Tall Ruderals

This habitat mainly comprised of patches of nettle *Urtica dioica* with coarse grasses and scattered bramble *Rubus fruticosus* agg. scrub.

Wall

The site contained two walls; one stone wall which was located parallel to the northern boundary and one dilapidated brick wall located on the western boundary (Target Note 7). The retaining stone wall on the northern boundary measured approximately 1m in height and contained several areas of missing mortar and gaps (Target Note 4). A low brick wall was also recorded along the south western boundary, which was also in poor condition (Target Note 5).

4.4 FAUNA

During the survey field signs of faunal species were noted and mapped. The time of year at which the survey is undertaken will affect species or field signs directly recorded during the survey. A range of common bird species, including woodpigeon blackbird *Turdus merula*, carrion crow *Corvus corone* and blue tit *Cyanistes caeruleus*, were recorded on site during the field survey.

4.5 INVASIVE PLANT SPECIES

Two stands of the invasive, non native plant species Japanese knotweed *Fallopia japonica* were recorded during the field survey. This species is listed on Schedule 9 of the Wildlife and Countryside Act 1981 (as amended). As such, it is an offence to cause it to grow or spread in the wild.

5. DISCUSSIONS AND CONCLUSIONS

5.1 SUMMARY OF PROPOSALS

It is understood that an outline planning application for 44 units will be submitted for the site, however the precise details of the development have not been finalised at this stage. Information provided by the client show that the woodland on the northern boundary is to be retained where possible or replanted as part of the development.

A precautionary approach has been adopted when discussing which habitats/species are notable considerations. The discussion and recommendations should be reviewed and amended, where appropriate, once the proposals are finalised.

5.2 NATURE CONSERVATION SITES

No nature conservation sites were recorded within a 1 km radius of the site.

5.3 HABITATS

The ecological importance of the habitats present on site is assessed against their presence on the UK and Local BAPs and on Section 41 of the NERC Act. It also takes into account the intrinsic value of the habitat e.g. mature trees which cannot easily be replaced. Those habitats which meet any of these criteria and are considered likely to be impacted by the proposals are highlighted as notable considerations. This is summarised in Table 5.1 and further discussed in the text below.

| Habitat type | UK BAP? | Local BAP? | NERC Act? | Will habitat be impacted? | Is habitat a notable consideration? |
|---------------------------------|---------|------------|-----------|---------------------------|-------------------------------------|
| Amenity Grassland | - | - | - | Potentially | No |
| Broadleaved Plantation Woodland | - | - | - | Potentially | Yes |
| Dense Scrub | - | - | - | Potentially | No |
| Fence | - | - | - | Potentially | No |
| Hardstanding | - | - | - | Potentially | No |
| Poor Semi Improved Grassland | - | - | - | Yes | No |
| Scattered Scrub | - | - | - | Yes | No |
| Scattered Broadleaved Trees | - | - | - | Potentially | Yes |
| Tall Ruderals | - | - | - | Potentially | No |
| Wall | - | - | - | Potentially | No |

Table 5.1: Summary of Ecological Importance of Habitats on Site

The broadleaved plantation woodland and scattered broadleaved trees are notable considerations as the trees would be difficult to replace. The remaining habitats are not notable as they are of low ecological value, are common in the local area, are of a small size or can easily be replaced.

5.4 PROTECTED/NOTABLE SPECIES

Table 5.2 and the discussion below consider any species identified within the desk study or where potentially suitable habitat is present.

| Species/ Species group | Key habitats for these species | Will species be impacted, if present? | Is species a notable consideration? |
|------------------------|--|---------------------------------------|-------------------------------------|
| Badgers | Poor semi-improved grassland | Yes | No |
| Bats | Poor semi-improved grassland, scrub, scattered trees | Yes | Yes |
| Birds | Scrub, scattered trees, plantation woodland | Yes | Yes |
| Great Crested Newts | Poor semi-improved grassland, scrub | Yes | No |
| Other - Hedgehog | Poor semi-improved grassland | Yes | Yes |
| Reptiles | Poor semi-improved grassland | Yes | Yes |

Table 5.2: Summary of Ecological Importance of Species on Site

Badgers

The desk study identified no records of badgers within the 1 km search area. The site contains some suitable badger foraging habitat but no sett building habitat. No evidence of badger activity on site such as setts, latrines, hairs or tracks was recorded during the field survey. Badgers are not a notable consideration with respect to the site's development.

Bats

The desk study identified several records of bats within the 1 km search area including noctules and common pipistrelle. The potential of the site to support roosting bat species has been investigated in an initial bat survey (Middlemarch Environmental Ltd Report No. RT-MME-113193-02) which revealed suitable features within the stone wall on the northern boundary. Furthermore, the scrub and woodland habitats offer foraging/commuting habitat for a variety of bat species. As a result, bats are a notable consideration in relation to the proposed works. A recommendation is made in Section 6.3.

Birds

The desk study identified records of a number of bird species including several that may be found in the proposed development site. During the field survey the scattered trees and introduced shrub vegetation was used by a range of common bird species. These habitats also have the potential to support nesting birds, which are protected under the Wildlife and Countryside Act (as amended). As these habitats will be affected by the proposed works, nesting birds are a notable consideration and a recommendation is made in Section 6.3.

Great Crested Newt

No records of great crested newt were recorded within 1 km of the site. No waterbodies are present on site but terrestrial habitat is present for the species. From reference to Ordnance Survey 1:25,000 maps it appears that there are no water bodies located within a 500 m radius of the proposed development (excluding potential small garden ponds in the neighbouring housing estate). It is therefore considered highly unlikely that any great crested newts would be present within the terrestrial habitats on the site. In addition the roads, railway line and the River Don pose a significant barrier to the species' movement within the local area.

Other - Hedgehog

The desk study identified records of hedgehogs within the 1 km search area which is a UK BAP priority species. There are suitable foraging habitats for this species and as such it is a notable consideration.

Reptiles

The desk study returned no records of reptiles within the search area. The site contains optimal reptile habitat including semi-improved grassland and scrub and is adjacent to a railway line (a known dispersal corridor for reptile species). Reptiles are therefore a notable consideration with respect to the proposed works. Recommendations have been made in Section 6.3.

A summary of legislation relevant to the ecology of the site is included in Appendix 3.

5.5 INVASIVE PLANT SPECIES

Two stands of the invasive, non native plant species Japanese knotweed *Fallopia japonica* were recorded during the field survey. This species is listed on Schedule 9 of the Wildlife and Countryside Act 1981 (as amended). As such, it is an offence to cause it to grow or spread in the wild. As such, a recommendation is made in Section 6.4.

6. RECOMMENDATIONS

All recommendations made below are subject to change once the details of the proposed works are finalised. Once the extent of the proposed development is known all recommendations should be reviewed and amended as appropriate.

6.1 NATURE CONSERVATION SITES

No recommendations are made.

6.2 HABITATS

The following recommendations are made regarding the habitats present on site:

- **Habitat Loss and Enhancement:** In accordance with the provision of Chapter 11 of the National Planning Policy Framework (Conserving and Enhancing the Natural Environment) and Local Planning Policy, a biodiversity enhancement plan should be incorporated into the landscaping scheme of any proposed works to maximise the ecological value of the site. This should include the creation of areas of species rich grassland.
- **Trees:** Any trees on site, or overhanging the site, which are not to be removed as a part of any proposed works should be protected in accordance with British Standard 5837: 2012 "Trees in relation to design, demolition and construction - recommendations". Protection should be installed on site prior to the commencement of any works on site.

6.3 PROTECTED / NOTABLE SPECIES

The following recommendations are made regarding protected species that are potentially present on site:

- **Bats:** To ensure compliance with relevant legislation, the recommendations made in Middlemarch Environmental Ltd Initial Bat Survey RT-MME-113193-02 should be followed.
- **Nesting Birds:** To ensure compliance with the Wildlife and Countryside Act 1981 (as amended), vegetation clearance should be undertaken outside the nesting bird season. The nesting bird season is weather dependent but generally extends between March and September inclusive. If this is not possible then any vegetation that is to be removed or disturbed should be checked by an experienced ecologist for nesting birds immediately prior to works commencing. If birds are found to be nesting any works which may affect them would have to be delayed until the young have fledged and the nest has been abandoned naturally.
- **Reptiles:** To ensure compliance with the Wildlife and Countryside Act 1981 (as amended), a reptile survey should be undertaken of suitable habitats within the proposed development site. Reptile surveys can be completed in suitable weather conditions between April and September (inclusive).
- **Terrestrial Mammals including Hedgehog:** Any excavations that need to be left overnight should be covered or fitted with mammal ramps to ensure that any animals that enter can safely escape.

6.4 INVASIVE PLANT SPECIES

- **Japanese Knotweed:** To ensure compliance with the Wildlife and Countryside Act 1981 (as amended) the works must not cause Japanese knotweed to spread. Japanese knotweed can spread from rhizomes in soil within a 7 m radius of the stand of the plant. Therefore it is recommended that a Japanese knotweed survey be completed and a Method Statement developed to ensure that the proposed works do not result in the spread of this invasive non-native species. The optimal time for survey is between April and September.

REFERENCES AND BIBLIOGRAPHY

Barnsley Biodiversity Trust (2008). 'Barnsley Biodiversity Action Plan 2008-2013', Available:

<http://www.barnsleybiodiversity.org.uk/>

British Standards Institution. (2012). *British Standard 5837:2012, Trees in relation to design, demolition and construction – recommendations*. British Standards Institution, London.

Department for Communities and Local Government (2012). National Planning Policy Framework. Available:

<http://www.communities.gov.uk/planningandbuilding/planningsystem/planningpolicy/planningpolicyframework/>

IEA. (1995). *Guidelines for Baseline Ecological Assessment, Institute of Environmental Assessment*. E&FN Spon, An Imprint of Chapman and Hall. London.

JNCC, (1993). *Handbook for Phase 1 Habitat Survey: A technique for environmental audit (reprint)*. Joint Nature Conservation Committee, Peterborough.

Middlemarch Environmental Ltd (2012). Initial Bat Survey: Sheffield Road, Penistone. Middlemarch Environmental Ltd Report No. RT-MME-113193-02.

Middlemarch Environmental Ltd (2012). Arboricultural Survey: Sheffield Road, Penistone. Middlemarch Environmental Ltd Report No. RT-MME-113193-03.

UK Biodiversity Partnership. (no date). 'UK Biodiversity Action Plan'. Available: <http://www.ukbap.org.uk>

APPENDICES

APPENDIX 1: Desk Study Data

APPENDIX 2: Middlemarch Environmental Ltd Drawing C113193-01-01
Extended Phase 1 Habitat Survey

APPENDIX 3: Overview of Relevant Legislation

APPENDIX 1

Desk Study Data

The data contained in this appendix is confidential and cannot be reproduced.

Site Check Report

Report generated on November 29 2012.

You clicked on the point:

Grid Ref: **SE252032**

Full Grid Ref: **425200 , 403200**

The following features have been found within 1,000 metres of your search point:

Counties, Metropolitan Districts and Unitary Authorities (GB)

| Name | Geographic Level |
|-----------|-----------------------|
| BARNSELEY | METROPOLITAN DISTRICT |

NUTS1 - Government Office Regions (GB)

| Name | Reference | Hotlink |
|--------------------------|-----------|---|
| YORKSHIRE AND THE HUMBER | UKE | http://www.ons.gov.uk/ons/guide-method/geography/beginner-s-guide/european/yorkshire-and-the-humber/index.html |

Ancient Woodland (England)

| Grid Reference | Wood Name | Theme ID | Theme Name |
|----------------|------------------|----------|---------------------------------|
| se261029 | SPRING VALE WOOD | 1103246 | ANCIENT & SEMI-NATURAL WOODLAND |
| se256038 | SHROGG WOOD | 1103243 | ANCIENT & SEMI-NATURAL WOODLAND |

Local Nature Reserves (England)

There are no features within your search area.

National Nature Reserves (England)

There are no features within your search area.

Special Protection Areas (England)

There are no features within your search area.

Special Areas of Conservation (England)

There are no features within your search area.

Sites of Special Scientific Interest (England)

There are no features within your search area.

Important Bird Areas (England)

There are no features within your search area.

Areas of Outstanding Natural Beauty (England)

There are no features within your search area.

National Parks: Lake District and Yorkshire Dales Variation Orders 2012 - subject to confirmation (England)

There are no features within your search area.

National Parks (England)

There are no features within your search area.

Nature Improvement Areas (England)

There are no features within your search area.

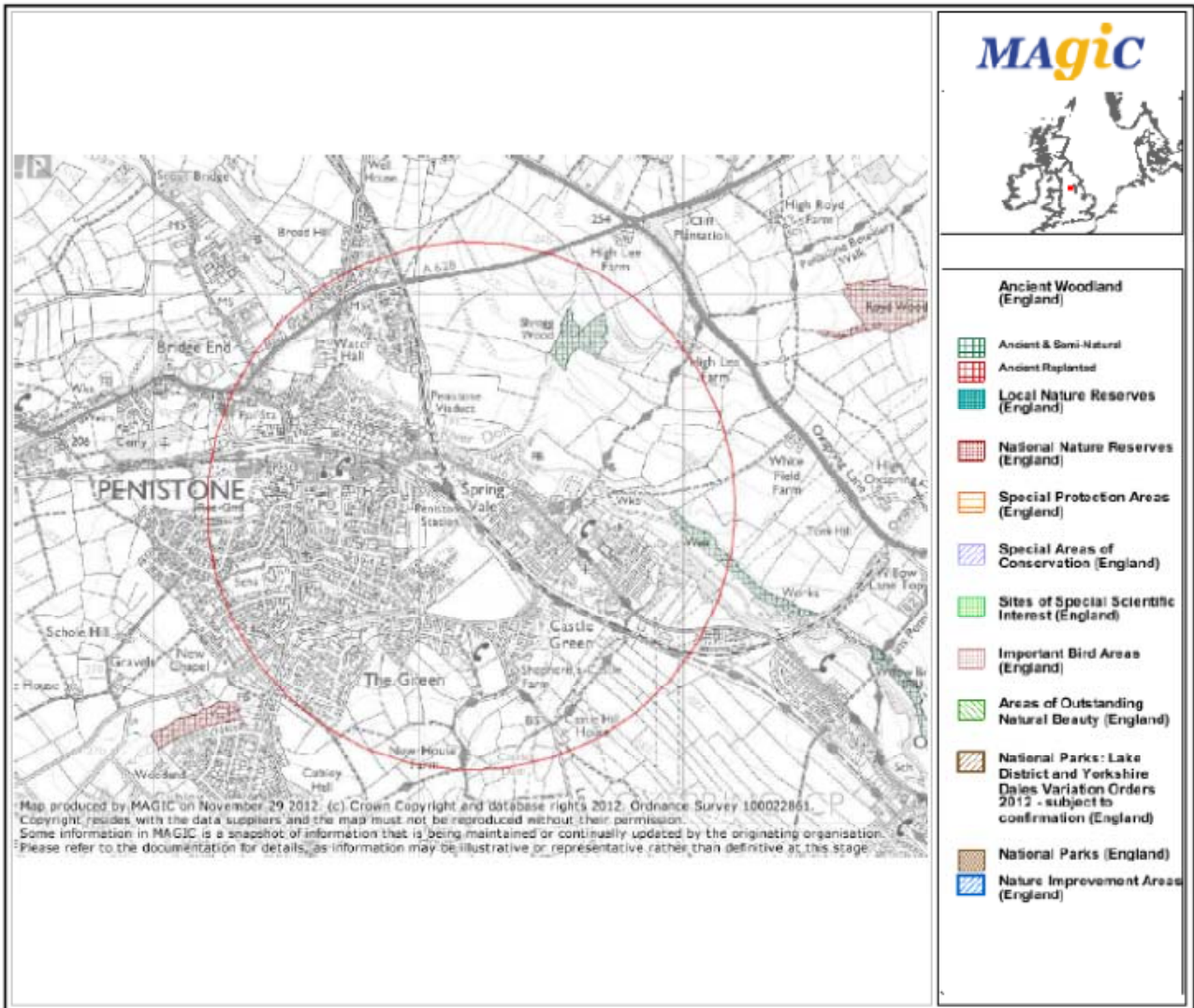

| Grid Ref | Date | Scientific Name | Common Name | BAP Species | Wildlife and Countryside Act | Red and Amber birds |
|----------|------------|------------------|-------------|-------------|------------------------------|---------------------|
| SE247036 | 17/07/1989 | Nyctalus noctula | Noctule | 1 | 1 | 0 |
| SE247036 | 09/07/1991 | Nyctalus noctula | Noctule | 1 | 1 | 0 |
| SE2403 | 01/08/1995 | Alcedo atthis | Kingfisher | 0 | 1 | 1 |
| SE2403 | 30/10/1995 | Alcedo atthis | Kingfisher | 0 | 1 | 1 |
| SE2403 | 19/02/1996 | Alcedo atthis | Kingfisher | 0 | 1 | 1 |
| SE243035 | 20/05/1996 | Alcedo atthis | Kingfisher | 0 | 1 | 1 |
| SE2403 | 08/06/1996 | Alcedo atthis | Kingfisher | 0 | 1 | 1 |
| SE2403 | 12/08/1996 | Alcedo atthis | Kingfisher | 0 | 1 | 1 |
| SE2403 | 28/11/1994 | Alcedo atthis | Kingfisher | 0 | 1 | 1 |
| SE247038 | 01/09/1993 | Alcedo atthis | Kingfisher | 0 | 1 | 1 |
| SE2403 | 19/03/1995 | Alcedo atthis | Kingfisher | 0 | 1 | 1 |
| SE2403 | 01/02/1994 | Alcedo atthis | Kingfisher | 0 | 1 | 1 |
| SE2403 | 01/03/1994 | Alcedo atthis | Kingfisher | 0 | 1 | 1 |
| SE2403 | 22/08/1994 | Alcedo atthis | Kingfisher | 0 | 1 | 1 |
| SE248038 | 20/10/1994 | Alcedo atthis | Kingfisher | 0 | 1 | 1 |
| SE2403 | 01/03/1998 | Alcedo atthis | Kingfisher | 0 | 1 | 1 |
| SE2403 | 06/01/1995 | Alcedo atthis | Kingfisher | 0 | 1 | 1 |
| SE2403 | 01/11/1999 | Alcedo atthis | Kingfisher | 0 | 1 | 1 |
| SE2403 | 01/12/1999 | Alcedo atthis | Kingfisher | 0 | 1 | 1 |
| SE247038 | 01/05/1993 | Alcedo atthis | Kingfisher | 0 | 1 | 1 |
| SE244036 | 01/09/1993 | Alcedo atthis | Kingfisher | 0 | 1 | 1 |
| SE2403 | 21/07/1999 | Alcedo atthis | Kingfisher | 0 | 1 | 1 |
| SE247038 | 31/10/1993 | Alcedo atthis | Kingfisher | 0 | 1 | 1 |
| SE2403 | 22/10/1996 | Alcedo atthis | Kingfisher | 0 | 1 | 1 |
| SE2403 | 29/11/1996 | Alcedo atthis | Kingfisher | 0 | 1 | 1 |
| SE2403 | 10/05/1997 | Alcedo atthis | Kingfisher | 0 | 1 | 1 |
| SE2403 | 12/06/1997 | Alcedo atthis | Kingfisher | 0 | 1 | 1 |
| SE2402 | 02/11/2010 | Turdus pilaris | Fieldfare | 0 | 1 | 1 |

| | | | | | | |
|----------|------------|---------------------------|---------------|---|---|---|
| SE2402 | 02/11/2010 | Turdus pilaris | Fieldfare | 0 | 1 | 1 |
| SE247037 | 12/04/1996 | Turdus iliacus | Redwing | 0 | 1 | 1 |
| SE2403 | 01/12/1993 | Turdus iliacus | Redwing | 0 | 1 | 1 |
| SE2403 | 03/02/1996 | Fringilla montifringilla | Brambling | 0 | 1 | 1 |
| SE2403 | 01/02/1997 | Fringilla montifringilla | Brambling | 0 | 1 | 1 |
| SE2403 | 01/02/1994 | Fringilla montifringilla | Brambling | 0 | 1 | 1 |
| SE244030 | 21/09/2012 | Rana temporaria | Common Frog | 0 | 1 | 0 |
| SE247036 | 18/08/1987 | Myotis mystacinus | Whiskered Bat | 0 | 1 | 0 |
| SE2403 | 31/07/2008 | Pipistrellus pipistrellus | Pipistrelle | 0 | 1 | 0 |
| SE247036 | 09/06/1988 | Pipistrellus pipistrellus | Pipistrelle | 0 | 1 | 0 |
| SE247036 | 07/07/1988 | Pipistrellus pipistrellus | Pipistrelle | 0 | 1 | 0 |
| SE248038 | 13/07/1997 | Pipistrellus pipistrellus | Pipistrelle | 0 | 1 | 0 |
| SE249033 | 08/03/1988 | Pipistrellus pipistrellus | Pipistrelle | 0 | 1 | 0 |
| SE247036 | 15/08/1988 | Pipistrellus pipistrellus | Pipistrelle | 0 | 1 | 0 |
| SE247036 | 27/07/1991 | Pipistrellus pipistrellus | Pipistrelle | 0 | 1 | 0 |
| SE247036 | 27/07/1991 | Pipistrellus pipistrellus | Pipistrelle | 0 | 1 | 0 |
| SE247036 | 28/07/1991 | Pipistrellus pipistrellus | Pipistrelle | 0 | 1 | 0 |

| | | | | | | |
|----------|------------|---------------------------|--------------------|---|---|---|
| SE247036 | 16/07/1993 | Pipistrellus pipistrellus | Pipistrelle | 0 | 1 | 0 |
| SE248035 | 06/07/1991 | Pipistrellus pipistrellus | Pipistrelle | 0 | 1 | 0 |
| SE248035 | 08/08/1991 | Pipistrellus pipistrellus | Pipistrelle | 0 | 1 | 0 |
| SE247036 | 17/07/1989 | Pipistrellus pipistrellus | Pipistrelle | 0 | 1 | 0 |
| SE247036 | 09/07/1991 | Pipistrellus pipistrellus | Pipistrelle | 0 | 1 | 0 |
| SE2502 | 01/10/1995 | Vanellus vanellus | Lapwing | 1 | 0 | 1 |
| SE243030 | 25/10/1995 | Vanellus vanellus | Lapwing | 1 | 0 | 1 |
| SE2403 | 19/12/1995 | Vanellus vanellus | Lapwing | 1 | 0 | 1 |
| SE2502 | 01/10/1999 | Vanellus vanellus | Lapwing | 1 | 0 | 1 |
| SE2402 | 01/03/2001 | Vanellus vanellus | Lapwing | 1 | 0 | 1 |
| SE2402 | 01/03/2002 | Vanellus vanellus | Lapwing | 1 | 0 | 1 |
| SE243035 | 28/05/1996 | Cuculus canorus | Cuckoo | 1 | 0 | 1 |
| SE2403 | 29/05/1997 | Cuculus canorus | Cuckoo | 1 | 0 | 1 |
| SE2403 | 07/05/1999 | Muscicapa striata | Spotted Flycatcher | 1 | 0 | 1 |
| SE2403 | 01/05/1994 | Muscicapa striata | Spotted Flycatcher | 1 | 0 | 1 |
| SE2403 | 01/06/1994 | Muscicapa striata | Spotted Flycatcher | 1 | 0 | 1 |
| SE2403 | 01/01/1997 | Muscicapa striata | Spotted Flycatcher | 1 | 0 | 1 |
| SE2403 | ##### | Muscicapa striata | Spotted Flycatcher | 1 | 0 | 1 |
| SE2403 | 10/08/1995 | Muscicapa striata | Spotted Flycatcher | 1 | 0 | 1 |
| SE243035 | 30/05/1996 | Muscicapa striata | Spotted Flycatcher | 1 | 0 | 1 |
| SE2403 | 02/06/1996 | Muscicapa striata | Spotted Flycatcher | 1 | 0 | 1 |
| SE2403 | 20/01/1996 | Emberiza citrinella | Yellowhammer | 1 | 0 | 1 |
| SE2403 | 01/03/1996 | Emberiza citrinella | Yellowhammer | 1 | 0 | 1 |
| SE243035 | 01/05/1996 | Emberiza citrinella | Yellowhammer | 1 | 0 | 1 |
| SE2403 | 01/12/1995 | Emberiza citrinella | Yellowhammer | 1 | 0 | 1 |

| | | | | | | |
|----------|------------|---------------------|---------------|---|---|---|
| SE2403 | 01/01/1997 | Emberiza citrinella | Yellowhammer | 1 | 0 | 1 |
| SE2403 | 01/02/1997 | Emberiza citrinella | Yellowhammer | 1 | 0 | 1 |
| SE2403 | 01/03/1998 | Emberiza citrinella | Yellowhammer | 1 | 0 | 1 |
| SE2403 | 01/05/1998 | Emberiza citrinella | Yellowhammer | 1 | 0 | 1 |
| SE2403 | 01/02/1994 | Emberiza citrinella | Yellowhammer | 1 | 0 | 1 |
| SE2403 | 27/02/1995 | Emberiza citrinella | Yellowhammer | 1 | 0 | 1 |
| SE2403 | 01/03/1995 | Emberiza citrinella | Yellowhammer | 1 | 0 | 1 |
| SE2502 | 01/03/2001 | Emberiza citrinella | Yellowhammer | 1 | 0 | 1 |
| SE2403 | 01/06/1997 | Emberiza citrinella | Yellowhammer | 1 | 0 | 1 |
| SE253024 | 29/06/1997 | Emberiza citrinella | Yellowhammer | 1 | 0 | 1 |
| SE2403 | 01/08/1996 | Passer domesticus | House Sparrow | 1 | 0 | 1 |
| SE2403 | 01/12/1995 | Passer domesticus | House Sparrow | 1 | 0 | 1 |
| SE253024 | 29/06/1997 | Passer domesticus | House Sparrow | 1 | 0 | 1 |
| SE2403 | 01/11/1997 | Passer domesticus | House Sparrow | 1 | 0 | 1 |
| SE247037 | 01/06/1999 | Passer domesticus | House Sparrow | 1 | 0 | 1 |
| SE20L | 01/04/1989 | Passer montanus | Tree Sparrow | 1 | 0 | 1 |
| SE2502 | 01/03/2000 | Passer montanus | Tree Sparrow | 1 | 0 | 1 |
| SE2502 | 01/03/2001 | Passer montanus | Tree Sparrow | 1 | 0 | 1 |
| SE2503 | 01/01/2011 | Passer domesticus | House Sparrow | 1 | 0 | 1 |
| SE258028 | 30/07/1983 | Erinaceus europaeus | Hedgehog | 1 | 0 | 0 |
| SE246031 | 16/07/1983 | Erinaceus europaeus | Hedgehog | 1 | 0 | 0 |
| SE249028 | 04/08/1983 | Erinaceus europaeus | Hedgehog | 1 | 0 | 0 |
| SE244037 | 13/08/1983 | Erinaceus europaeus | Hedgehog | 1 | 0 | 0 |
| SE2403 | 22/09/2012 | Salmo trutta | Sea Trout | 1 | 0 | 0 |
| SE245032 | 01/01/1964 | Lepus europaeus | Brown Hare | 1 | 0 | 0 |

| | | | | | | |
|----------|------------|---------------------------|--------------------|---|---|---|
| SE242029 | 23/07/2001 | Pipistrellus pipistrellus | 55 Khz Pipistrelle | 1 | 0 | 0 |
| SE2403 | 25/08/1996 | Falco tinnunculus | Kestrel | 0 | 0 | 1 |
| SE2403 | 31/10/1996 | Falco tinnunculus | Kestrel | 0 | 0 | 1 |
| SE253024 | 29/06/1997 | Falco tinnunculus | Kestrel | 0 | 0 | 1 |
| SE2403 | 20/09/1997 | Falco tinnunculus | Kestrel | 0 | 0 | 1 |
| SE20L | 01/11/1997 | Falco tinnunculus | Kestrel | 0 | 0 | 1 |
| SE2403 | 01/01/1998 | Falco tinnunculus | Kestrel | 0 | 0 | 1 |
| SE2403 | 01/11/1999 | Falco tinnunculus | Kestrel | 0 | 0 | 1 |
| SE2403 | 01/03/1996 | Columba oenas | Stock Dove | 0 | 0 | 1 |
| SE247037 | 01/04/1996 | Columba oenas | Stock Dove | 0 | 0 | 1 |
| SE243035 | 01/05/1996 | Columba oenas | Stock Dove | 0 | 0 | 1 |
| SE2403 | 01/01/1997 | Columba oenas | Stock Dove | 0 | 0 | 1 |
| SE2403 | 01/02/1997 | Columba oenas | Stock Dove | 0 | 0 | 1 |
| SE2403 | 26/12/1997 | Columba oenas | Stock Dove | 0 | 0 | 1 |
| SE2403 | 13/07/1996 | Picus viridis | Green Woodpecker | 0 | 0 | 1 |
| SE2403 | 01/01/1997 | Picus viridis | Green Woodpecker | 0 | 0 | 1 |
| SE2403 | 01/02/1997 | Picus viridis | Green Woodpecker | 0 | 0 | 1 |
| SE2403 | 01/07/1997 | Picus viridis | Green Woodpecker | 0 | 0 | 1 |
| SE2403 | 01/08/1997 | Picus viridis | Green Woodpecker | 0 | 0 | 1 |
| SE2403 | 01/03/1998 | Picus viridis | Green Woodpecker | 0 | 0 | 1 |
| SE2403 | 02/02/1995 | Picus viridis | Green Woodpecker | 0 | 0 | 1 |
| SE2403 | 01/03/1995 | Picus viridis | Green Woodpecker | 0 | 0 | 1 |
| SE247037 | 24/06/1999 | Picus viridis | Green Woodpecker | 0 | 0 | 1 |
| SE2403 | 01/07/1999 | Picus viridis | Green Woodpecker | 0 | 0 | 1 |
| SE2403 | 01/11/1999 | Picus viridis | Green Woodpecker | 0 | 0 | 1 |
| SE2403 | 01/09/1993 | Picus viridis | Green Woodpecker | 0 | 0 | 1 |
| SE2403 | 01/09/1993 | Picus viridis | Green Woodpecker | 0 | 0 | 1 |
| SE2403 | 01/12/1993 | Picus viridis | Green Woodpecker | 0 | 0 | 1 |
| SE2403 | 01/01/1994 | Picus viridis | Green Woodpecker | 0 | 0 | 1 |

| | | | | | | |
|----------|------------|-------------------|---------------------------|---|---|---|
| SE2403 | 03/11/1994 | Picus viridis | Green Woodpecker | 0 | 0 | 1 |
| SE2403 | 25/06/1997 | Dendrocopos minor | Lesser Spotted Woodpecker | 0 | 0 | 1 |
| SE243030 | 09/10/1995 | Hirundo rustica | Swallow | 0 | 0 | 1 |
| SE2403 | 01/06/1996 | Hirundo rustica | Swallow | 0 | 0 | 1 |
| SE2403 | 25/04/1998 | Hirundo rustica | Swallow | 0 | 0 | 1 |
| SE243030 | 13/09/1996 | Hirundo rustica | Swallow | 0 | 0 | 1 |
| SE255023 | 29/06/1997 | Hirundo rustica | Swallow | 0 | 0 | 1 |
| SE20L | 01/07/1997 | Hirundo rustica | Swallow | 0 | 0 | 1 |
| SE2403 | 01/08/1997 | Hirundo rustica | Swallow | 0 | 0 | 1 |
| SE2403 | 20/09/1997 | Hirundo rustica | Swallow | 0 | 0 | 1 |
| SE243030 | 01/09/1996 | Delichon urbica | House Martin | 0 | 0 | 1 |
| SE2403 | 10/10/1985 | Delichon urbica | House Martin | 0 | 0 | 1 |
| SE2403 | 21/02/1995 | Parus montanus | Willow Tit | 0 | 0 | 1 |
| SE2403 | 19/12/1995 | Turdus viscivorus | Mistle Thrush | 0 | 0 | 1 |
| SE2403 | 30/01/1996 | Turdus viscivorus | Mistle Thrush | 0 | 0 | 1 |
| SE2403 | 01/03/1996 | Turdus viscivorus | Mistle Thrush | 0 | 0 | 1 |
| SE2403 | 16/01/1997 | Turdus viscivorus | Mistle Thrush | 0 | 0 | 1 |
| SE2403 | 06/04/1998 | Turdus viscivorus | Mistle Thrush | 0 | 0 | 1 |
| SE2403 | 01/01/2000 | Turdus viscivorus | Mistle Thrush | 0 | 0 | 1 |
| SE2403 | 18/02/1996 | Turdus philomelos | Song Thrush | 0 | 0 | 1 |
| SE2403 | 28/04/1998 | Turdus philomelos | Song Thrush | 0 | 0 | 1 |
| SE2403 | 30/04/1998 | Turdus philomelos | Song Thrush | 0 | 0 | 1 |
| SE2403 | 03/05/1998 | Turdus philomelos | Song Thrush | 0 | 0 | 1 |
| SE247037 | 01/06/1999 | Turdus philomelos | Song Thrush | 0 | 0 | 1 |
| SE2403 | 06/07/1999 | Turdus philomelos | Song Thrush | 0 | 0 | 1 |
| SE2403 | 23/11/1994 | Turdus philomelos | Song Thrush | 0 | 0 | 1 |
| SE2403 | 03/02/1995 | Turdus philomelos | Song Thrush | 0 | 0 | 1 |
| SE2403 | 01/05/1999 | Turdus philomelos | Song Thrush | 0 | 0 | 1 |
| SE2403 | 01/08/1996 | Turdus merula | Blackbird | 0 | 0 | 1 |

| | | | | | | |
|----------|------------|------------------------|----------------|---|---|---|
| SE2403 | 01/10/1996 | Turdus merula | Blackbird | 0 | 0 | 1 |
| SE2403 | 01/12/1995 | Turdus merula | Blackbird | 0 | 0 | 1 |
| SE244030 | 21/09/2012 | Turdus merula | Blackbird | 0 | 0 | 1 |
| SE247037 | 20/04/1996 | Phylloscopus trochilus | Willow Warbler | 0 | 0 | 1 |
| SE2403 | 20/04/1997 | Phylloscopus trochilus | Willow Warbler | 0 | 0 | 1 |
| SE2403 | 27/04/1998 | Phylloscopus trochilus | Willow Warbler | 0 | 0 | 1 |
| SE2403 | 23/10/1997 | Regulus regulus | Goldcrest | 0 | 0 | 1 |
| SE248038 | 01/10/1998 | Regulus regulus | Goldcrest | 0 | 0 | 1 |
| SE2403 | 01/12/1998 | Regulus regulus | Goldcrest | 0 | 0 | 1 |
| SE2403 | 01/12/1999 | Regulus regulus | Goldcrest | 0 | 0 | 1 |
| SE248038 | 25/10/1994 | Regulus regulus | Goldcrest | 0 | 0 | 1 |
| SE2403 | 01/01/1996 | Prunella modularis | Dunnock | 0 | 0 | 1 |
| SE2403 | 01/08/1996 | Prunella modularis | Dunnock | 0 | 0 | 1 |
| SE2403 | 01/12/1995 | Prunella modularis | Dunnock | 0 | 0 | 1 |
| SE247037 | 01/06/1999 | Motacilla cinerea | Grey Wagtail | 0 | 0 | 1 |
| SE2403 | 17/07/1999 | Motacilla cinerea | Grey Wagtail | 0 | 0 | 1 |
| SE2403 | 01/07/1994 | Motacilla cinerea | Grey Wagtail | 0 | 0 | 1 |
| SE243030 | 01/09/1996 | Sturnus vulgaris | Starling | 0 | 0 | 1 |
| SE2403 | 18/05/1995 | Carduelis carduelis | Goldfinch | 0 | 0 | 1 |
| SE247037 | 17/04/1996 | Carduelis carduelis | Goldfinch | 0 | 0 | 1 |
| SE243030 | 11/05/1996 | Carduelis carduelis | Goldfinch | 0 | 0 | 1 |
| SE2403 | 30/04/1998 | Carduelis carduelis | Goldfinch | 0 | 0 | 1 |
| SE2403 | 01/03/1994 | Carduelis carduelis | Goldfinch | 0 | 0 | 1 |
| SE2403 | 01/05/1994 | Carduelis carduelis | Goldfinch | 0 | 0 | 1 |
| SE2403 | 25/03/1995 | Carduelis carduelis | Goldfinch | 0 | 0 | 1 |
| SE2502 | 01/03/2001 | Carduelis cannabina | Linnet | 0 | 0 | 1 |

| | | | | | | |
|----------|------------|------------------------|--------------|---|---|---|
| SE20L | 01/04/1989 | Tachybaptus ruficollis | Little Grebe | 0 | 0 | 0 |
| SE20L | 01/04/1989 | Tachybaptus ruficollis | Little Grebe | 0 | 0 | 0 |
| SE20L | 01/04/1989 | Tachybaptus ruficollis | Little Grebe | 0 | 0 | 0 |
| SE20L | 01/04/1989 | Tachybaptus ruficollis | Little Grebe | 0 | 0 | 0 |
| SE20L | 01/04/1989 | Tachybaptus ruficollis | Little Grebe | 0 | 0 | 0 |
| SE20L | 01/04/1989 | Tachybaptus ruficollis | Little Grebe | 0 | 0 | 0 |
| SE20L | 01/04/1989 | Tachybaptus ruficollis | Little Grebe | 0 | 0 | 0 |
| SE20L | 01/04/1989 | Tachybaptus ruficollis | Little Grebe | 0 | 0 | 0 |
| SE20L | 01/04/1989 | Tachybaptus ruficollis | Little Grebe | 0 | 0 | 0 |
| SE20L | 01/04/1989 | Tachybaptus ruficollis | Little Grebe | 0 | 0 | 0 |
| SE20L | 01/04/1989 | Tachybaptus ruficollis | Little Grebe | 0 | 0 | 0 |
| SE20L | 01/04/1989 | Tachybaptus ruficollis | Little Grebe | 0 | 0 | 0 |
| SE20L | 01/04/1989 | Tachybaptus ruficollis | Little Grebe | 0 | 0 | 0 |
| SE2403 | 01/10/1995 | Ardea cinerea | Grey Heron | 0 | 0 | 0 |
| SE2403 | 01/10/1996 | Ardea cinerea | Grey Heron | 0 | 0 | 0 |
| SE2403 | 18/09/1997 | Ardea cinerea | Grey Heron | 0 | 0 | 0 |
| SE2403 | 01/11/1997 | Ardea cinerea | Grey Heron | 0 | 0 | 0 |
| SE2403 | 01/05/1998 | Ardea cinerea | Grey Heron | 0 | 0 | 0 |
| SE247037 | 01/06/1999 | Ardea cinerea | Grey Heron | 0 | 0 | 0 |

| | | | | | | |
|----------|------------|--------------------|--------------|---|---|---|
| SE2403 | 21/07/1999 | Ardea cinerea | Grey Heron | 0 | 0 | 0 |
| SE2403 | 01/08/1999 | Ardea cinerea | Grey Heron | 0 | 0 | 0 |
| SE2403 | 01/09/1993 | Ardea cinerea | Grey Heron | 0 | 0 | 0 |
| SE2403 | 28/10/1994 | Ardea cinerea | Grey Heron | 0 | 0 | 0 |
| SE2403 | 11/02/1995 | Ardea cinerea | Grey Heron | 0 | 0 | 0 |
| SE255023 | 29/06/1997 | Anas platyrhynchos | Mallard | 0 | 0 | 0 |
| SE2403 | 25/05/1999 | Anas platyrhynchos | Mallard | 0 | 0 | 0 |
| SE2403 | 01/01/1994 | Anas platyrhynchos | Mallard | 0 | 0 | 0 |
| SE243030 | 06/09/1995 | Branta canadensis | Canada Goose | 0 | 0 | 0 |
| SE243030 | 07/09/1995 | Branta canadensis | Canada Goose | 0 | 0 | 0 |
| SE243030 | 11/09/1995 | Branta canadensis | Canada Goose | 0 | 0 | 0 |
| SE2403 | 27/12/1995 | Branta canadensis | Canada Goose | 0 | 0 | 0 |
| SE243030 | 25/08/1996 | Branta canadensis | Canada Goose | 0 | 0 | 0 |
| SE243030 | 09/09/1996 | Branta canadensis | Canada Goose | 0 | 0 | 0 |
| SE2403 | 01/01/1997 | Branta canadensis | Canada Goose | 0 | 0 | 0 |
| SE2502 | 01/11/1997 | Branta canadensis | Canada Goose | 0 | 0 | 0 |
| SE2403 | 01/02/1999 | Branta canadensis | Canada Goose | 0 | 0 | 0 |
| SE254023 | 01/09/1994 | Branta canadensis | Canada Goose | 0 | 0 | 0 |
| SE255023 | 01/01/1995 | Branta canadensis | Canada Goose | 0 | 0 | 0 |
| SE243030 | 30/08/1995 | Accipiter nisus | Sparrowhawk | 0 | 0 | 0 |
| SE2403 | 01/12/1995 | Accipiter nisus | Sparrowhawk | 0 | 0 | 0 |
| SE2403 | 30/07/1996 | Accipiter nisus | Sparrowhawk | 0 | 0 | 0 |
| SE2403 | 01/08/1996 | Accipiter nisus | Sparrowhawk | 0 | 0 | 0 |
| SE2403 | 13/08/1996 | Accipiter nisus | Sparrowhawk | 0 | 0 | 0 |
| SE2403 | 21/10/1996 | Accipiter nisus | Sparrowhawk | 0 | 0 | 0 |
| SE2403 | 31/01/1998 | Accipiter nisus | Sparrowhawk | 0 | 0 | 0 |
| SE2403 | 01/05/1998 | Accipiter nisus | Sparrowhawk | 0 | 0 | 0 |
| SE2403 | 01/02/1999 | Accipiter nisus | Sparrowhawk | 0 | 0 | 0 |
| SE2403 | 01/01/1994 | Accipiter nisus | Sparrowhawk | 0 | 0 | 0 |
| SE2403 | 04/02/1995 | Accipiter nisus | Sparrowhawk | 0 | 0 | 0 |

| | | | | | | |
|----------|------------|-----------------------|---------------|---|---|---|
| SE244030 | 21/09/2012 | Accipiter nisus | Sparrowhawk | 0 | 0 | 0 |
| SE243035 | 01/05/1996 | Gallinula chloropus | Moorhen | 0 | 0 | 0 |
| SE2403 | 07/05/1996 | Gallinula chloropus | Moorhen | 0 | 0 | 0 |
| SE2403 | 01/06/1996 | Gallinula chloropus | Moorhen | 0 | 0 | 0 |
| SE2403 | 01/12/1995 | Gallinula chloropus | Moorhen | 0 | 0 | 0 |
| SE2403 | 30/04/1997 | Gallinula chloropus | Moorhen | 0 | 0 | 0 |
| SE255023 | 29/06/1997 | Gallinula chloropus | Moorhen | 0 | 0 | 0 |
| SE2403 | 01/07/1997 | Gallinula chloropus | Moorhen | 0 | 0 | 0 |
| SE2403 | 01/05/1998 | Gallinula chloropus | Moorhen | 0 | 0 | 0 |
| SE2403 | 01/02/1999 | Gallinula chloropus | Moorhen | 0 | 0 | 0 |
| SE255023 | 07/03/1999 | Gallinula chloropus | Moorhen | 0 | 0 | 0 |
| SE2403 | 01/01/1994 | Gallinula chloropus | Moorhen | 0 | 0 | 0 |
| SE2403 | 01/09/1994 | Gallinula chloropus | Moorhen | 0 | 0 | 0 |
| SE255023 | 29/06/1997 | Fulica atra | Coot | 0 | 0 | 0 |
| SE255023 | 07/03/1999 | Fulica atra | Coot | 0 | 0 | 0 |
| SE2403 | 01/08/1996 | Streptopelia decaocto | Collared Dove | 0 | 0 | 0 |
| SE2403 | 01/12/1999 | Streptopelia decaocto | Collared Dove | 0 | 0 | 0 |
| SE2403 | 01/01/2000 | Streptopelia decaocto | Collared Dove | 0 | 0 | 0 |
| SE2403 | 01/08/1996 | Streptopelia decaocto | Collared Dove | 0 | 0 | 0 |
| SE2403 | 21/10/1996 | Streptopelia decaocto | Collared Dove | 0 | 0 | 0 |
| SE20L | 01/04/1989 | Athene noctua | Little Owl | 0 | 0 | 0 |
| SE2403 | 26/10/1996 | Strix aluco | Tawny Owl | 0 | 0 | 0 |
| SE2403 | 29/11/1996 | Strix aluco | Tawny Owl | 0 | 0 | 0 |
| SE247037 | 01/06/1999 | Strix aluco | Tawny Owl | 0 | 0 | 0 |
| SE2403 | 01/10/1999 | Strix aluco | Tawny Owl | 0 | 0 | 0 |

| | | | | | | |
|----------|------------|-------------------|--------------------------|---|---|---|
| SE2403 | 01/11/1999 | Strix aluco | Tawny Owl | 0 | 0 | 0 |
| SE243030 | 25/05/1996 | Apus apus | Swift | 0 | 0 | 0 |
| SE243030 | 10/09/1996 | Apus apus | Swift | 0 | 0 | 0 |
| SE243030 | 01/07/1989 | Apus apus | Swift | 0 | 0 | 0 |
| SE2403 | 03/02/1996 | Dendrocopos major | Great Spotted Woodpecker | 0 | 0 | 0 |
| SE2403 | 17/02/1996 | Dendrocopos major | Great Spotted Woodpecker | 0 | 0 | 0 |
| SE2403 | 01/03/1996 | Dendrocopos major | Great Spotted Woodpecker | 0 | 0 | 0 |
| SE247037 | 01/04/1996 | Dendrocopos major | Great Spotted Woodpecker | 0 | 0 | 0 |
| SE243035 | 01/05/1996 | Dendrocopos major | Great Spotted Woodpecker | 0 | 0 | 0 |
| SE2403 | 13/06/1997 | Dendrocopos major | Great Spotted Woodpecker | 0 | 0 | 0 |
| SE2403 | 01/12/1998 | Dendrocopos major | Great Spotted Woodpecker | 0 | 0 | 0 |
| SE246037 | 28/03/1999 | Dendrocopos major | Great Spotted Woodpecker | 0 | 0 | 0 |
| SE247037 | 01/06/1999 | Dendrocopos major | Great Spotted Woodpecker | 0 | 0 | 0 |
| SE2403 | 01/12/1999 | Dendrocopos major | Great Spotted Woodpecker | 0 | 0 | 0 |
| SE2403 | 01/01/2000 | Dendrocopos major | Great Spotted Woodpecker | 0 | 0 | 0 |
| SE2403 | 01/03/1994 | Dendrocopos major | Great Spotted Woodpecker | 0 | 0 | 0 |
| SE2403 | 01/12/1995 | Pica pica | Magpie | 0 | 0 | 0 |
| SE2403 | 01/05/1999 | Pica pica | Magpie | 0 | 0 | 0 |

| | | | | | | |
|----------|------------|---------------------|-----------------|---|---|---|
| SE248038 | 01/10/1998 | Garrulus glandarius | Jay | 0 | 0 | 0 |
| SE2403 | 01/12/1998 | Garrulus glandarius | Jay | 0 | 0 | 0 |
| SE2403 | 01/02/1999 | Garrulus glandarius | Jay | 0 | 0 | 0 |
| SE246037 | 28/03/1999 | Garrulus glandarius | Jay | 0 | 0 | 0 |
| SE2403 | 01/12/1995 | Parus major | Great Tit | 0 | 0 | 0 |
| SE243035 | 01/05/1996 | Parus caeruleus | Blue Tit | 0 | 0 | 0 |
| SE2403 | 01/08/1996 | Parus caeruleus | Blue Tit | 0 | 0 | 0 |
| SE2403 | 01/12/1995 | Parus caeruleus | Blue Tit | 0 | 0 | 0 |
| SE2403 | 01/07/1997 | Parus caeruleus | Blue Tit | 0 | 0 | 0 |
| SE247037 | 01/06/1999 | Parus caeruleus | Blue Tit | 0 | 0 | 0 |
| SE2403 | 20/09/1997 | Parus ater | Coal Tit | 0 | 0 | 0 |
| SE2403 | 01/12/1998 | Parus ater | Coal Tit | 0 | 0 | 0 |
| SE2403 | 01/02/1999 | Parus ater | Coal Tit | 0 | 0 | 0 |
| SE2403 | 26/12/1995 | Aegithalos caudatus | Long-Tailed Tit | 0 | 0 | 0 |
| SE2403 | 03/02/1996 | Aegithalos caudatus | Long-Tailed Tit | 0 | 0 | 0 |
| SE2403 | 01/03/1996 | Aegithalos caudatus | Long-Tailed Tit | 0 | 0 | 0 |
| SE247037 | 10/04/1996 | Aegithalos caudatus | Long-Tailed Tit | 0 | 0 | 0 |
| SE2403 | 01/05/1998 | Aegithalos caudatus | Long-Tailed Tit | 0 | 0 | 0 |
| SE2403 | 01/02/1999 | Aegithalos caudatus | Long-Tailed Tit | 0 | 0 | 0 |
| SE2403 | 01/11/1999 | Aegithalos caudatus | Long-Tailed Tit | 0 | 0 | 0 |
| SE2403 | 01/03/1994 | Aegithalos caudatus | Long-Tailed Tit | 0 | 0 | 0 |

| | | | | | | |
|----------|------------|---------------------|-----------------|---|---|---|
| SE246038 | 17/09/1994 | Aegithalos caudatus | Long-Tailed Tit | 0 | 0 | 0 |
| SE2403 | 30/11/1994 | Aegithalos caudatus | Long-Tailed Tit | 0 | 0 | 0 |
| SE2403 | 18/02/1995 | Aegithalos caudatus | Long-Tailed Tit | 0 | 0 | 0 |
| SE2403 | 01/03/1995 | Aegithalos caudatus | Long-Tailed Tit | 0 | 0 | 0 |
| SE2403 | 01/06/1995 | Certhia familiaris | Treecreeper | 0 | 0 | 0 |
| SE2403 | 01/08/1995 | Certhia familiaris | Treecreeper | 0 | 0 | 0 |
| SE2403 | 17/10/1995 | Certhia familiaris | Treecreeper | 0 | 0 | 0 |
| SE2403 | 26/12/1995 | Certhia familiaris | Treecreeper | 0 | 0 | 0 |
| SE245035 | 10/05/1996 | Certhia familiaris | Treecreeper | 0 | 0 | 0 |
| SE2403 | 13/06/1996 | Certhia familiaris | Treecreeper | 0 | 0 | 0 |
| SE2403 | 24/02/1995 | Certhia familiaris | Treecreeper | 0 | 0 | 0 |
| SE2403 | 01/03/1995 | Certhia familiaris | Treecreeper | 0 | 0 | 0 |
| SE246037 | 28/03/1999 | Certhia familiaris | Treecreeper | 0 | 0 | 0 |
| SE247037 | 01/06/1999 | Certhia familiaris | Treecreeper | 0 | 0 | 0 |
| SE2403 | 01/11/1993 | Certhia familiaris | Treecreeper | 0 | 0 | 0 |
| SE2403 | 01/03/1994 | Certhia familiaris | Treecreeper | 0 | 0 | 0 |
| SE2403 | 06/07/1996 | Certhia familiaris | Treecreeper | 0 | 0 | 0 |
| SE2403 | 04/02/1997 | Certhia familiaris | Treecreeper | 0 | 0 | 0 |
| SE2403 | 24/08/1994 | Certhia familiaris | Treecreeper | 0 | 0 | 0 |
| SE246038 | 26/09/1994 | Certhia familiaris | Treecreeper | 0 | 0 | 0 |
| SE2403 | 10/05/1997 | Certhia familiaris | Treecreeper | 0 | 0 | 0 |
| SE2403 | 01/07/1997 | Certhia familiaris | Treecreeper | 0 | 0 | 0 |
| SE2403 | 01/03/1998 | Certhia familiaris | Treecreeper | 0 | 0 | 0 |
| SE2403 | 01/02/1999 | Certhia familiaris | Treecreeper | 0 | 0 | 0 |
| SE2403 | 01/01/2000 | Certhia familiaris | Treecreeper | 0 | 0 | 0 |
| SE246036 | 05/11/1992 | Certhia familiaris | Treecreeper | 0 | 0 | 0 |

| | | | | | | |
|----------|------------|-------------------------|----------------|---|---|---|
| SE2403 | 01/06/1994 | Troglodytes troglodytes | Wren | 0 | 0 | 0 |
| SE2403 | 01/07/1994 | Troglodytes troglodytes | Wren | 0 | 0 | 0 |
| SE258028 | 07/03/1999 | Cinclus cinclus | Dipper | 0 | 0 | 0 |
| SE2403 | 01/11/1999 | Cinclus cinclus | Dipper | 0 | 0 | 0 |
| SE2502 | 17/03/1996 | Oenanthe oenanthe | Wheatear | 0 | 0 | 0 |
| SE2403 | 01/08/1996 | Erithacus rubecula | Robin | 0 | 0 | 0 |
| SE2403 | 01/12/1995 | Erithacus rubecula | Robin | 0 | 0 | 0 |
| SE2403 | 21/01/1997 | Erithacus rubecula | Robin | 0 | 0 | 0 |
| SE2403 | 03/03/1996 | Sylvia atricapilla | Blackcap | 0 | 0 | 0 |
| SE2403 | 01/12/1996 | Sylvia atricapilla | Blackcap | 0 | 0 | 0 |
| SE2403 | 20/04/1997 | Sylvia atricapilla | Blackcap | 0 | 0 | 0 |
| SE2403 | 01/05/1997 | Sylvia atricapilla | Blackcap | 0 | 0 | 0 |
| SE2403 | 01/06/1997 | Sylvia atricapilla | Blackcap | 0 | 0 | 0 |
| SE2403 | 10/05/1998 | Sylvia borin | Garden Warbler | 0 | 0 | 0 |
| SE247037 | 01/06/1999 | Phylloscopus collybita | Chiffchaff | 0 | 0 | 0 |
| SE243030 | 25/05/1996 | Carduelis chloris | Greenfinch | 0 | 0 | 0 |
| SE2403 | 01/01/1997 | Carduelis chloris | Greenfinch | 0 | 0 | 0 |
| SE253024 | 29/06/1997 | Carduelis chloris | Greenfinch | 0 | 0 | 0 |
| SE2403 | 01/11/1997 | Carduelis chloris | Greenfinch | 0 | 0 | 0 |
| SE2403 | 26/12/1995 | Carduelis spinus | Siskin | 0 | 0 | 0 |
| SE2403 | 10/02/1996 | Carduelis spinus | Siskin | 0 | 0 | 0 |
| SE2403 | 01/03/1996 | Carduelis spinus | Siskin | 0 | 0 | 0 |
| SE2403 | 01/01/1997 | Carduelis spinus | Siskin | 0 | 0 | 0 |
| SE2403 | 01/02/1997 | Carduelis spinus | Siskin | 0 | 0 | 0 |
| SE2403 | 26/12/1997 | Carduelis spinus | Siskin | 0 | 0 | 0 |
| SE243030 | 11/03/1993 | Carduelis spinus | Siskin | 0 | 0 | 0 |

| | | | | | | |
|----------|------------|--------------------------------|---------------------|---|---|---|
| SE2403 | 01/11/1993 | Carduelis spinus | Siskin | 0 | 0 | 0 |
| SE2403 | 26/03/1995 | Carduelis spinus | Siskin | 0 | 0 | 0 |
| SE2403 | 01/01/1998 | Carduelis spinus | Siskin | 0 | 0 | 0 |
| SE248038 | 01/10/1998 | Carduelis spinus | Siskin | 0 | 0 | 0 |
| SE2403 | 01/02/1999 | Carduelis spinus | Siskin | 0 | 0 | 0 |
| SE2403 | 01/01/2000 | Carduelis spinus | Siskin | 0 | 0 | 0 |
| SE2403 | 01/08/1996 | Fringilla coelebs | Chaffinch | 0 | 0 | 0 |
| SE2403 | 01/11/1996 | Fringilla coelebs | Chaffinch | 0 | 0 | 0 |
| SE2403 | 01/12/1995 | Fringilla coelebs | Chaffinch | 0 | 0 | 0 |
| SE2403 | 01/11/1997 | Fringilla coelebs | Chaffinch | 0 | 0 | 0 |
| SE2403 | 01/05/1999 | Fringilla coelebs | Chaffinch | 0 | 0 | 0 |
| SE2403 | 27/02/1995 | Fringilla coelebs | Chaffinch | 0 | 0 | 0 |
| SE2502 | 30/01/1998 | Mergus merganser | Goosander | 0 | 0 | 0 |
| SE255023 | 07/03/1999 | Aythya fuligula | Tufted Duck | 0 | 0 | 0 |
| SE243030 | 16/02/1991 | Bombycilla garrulus | Waxwing | 0 | 0 | 0 |
| SE2403 | 01/12/1995 | Corvus corone subsp. corone | Carrion Crow | 0 | 0 | 0 |
| SE2502 | 25/02/2006 | Juncus bufonius agg. | Toad Rush agg. | 0 | 0 | 0 |
| SE2502 | 25/02/2006 | Lolium perenne | Perennial Rye-Grass | 0 | 0 | 0 |
| SE2502 | 25/02/2006 | Poa annua | Annual Meadow-Grass | 0 | 0 | 0 |
| SE2502 | 25/02/2006 | Poa pratensis | Smooth Meadow-Grass | 0 | 0 | 0 |
| SE2502 | 25/02/2006 | Poa trivialis | Rough Meadow-Grass | 0 | 0 | 0 |
| SE2502 | 25/02/2006 | Holcus lanatus | Yorkshire-Fog | 0 | 0 | 0 |
| SE2502 | 25/02/2006 | Agrostis capillaris | Common Bent | 0 | 0 | 0 |
| SE2502 | 25/02/2006 | Agrostis stolonifera | Creeping Bent | 0 | 0 | 0 |

| | | | | | | |
|----------|------------|------------------------|-----------------------------|---|---|---|
| SE2502 | 25/02/2006 | Alopecurus geniculatus | Marsh Foxtail | 0 | 0 | 0 |
| SE2502 | 25/02/2006 | Anthoxanthum odoratum | Sweet Vernal Grass | 0 | 0 | 0 |
| SE2502 | 25/02/2006 | Ranunculus repens | Creeping Buttercup | 0 | 0 | 0 |
| SE2502 | 25/02/2006 | Ranunculus omiophyllus | Round-Leaved Crowfoot | 0 | 0 | 0 |
| SE244030 | 21/09/2012 | Nymphaea alba | White Water-Lily | 0 | 0 | 0 |
| SE244030 | 21/09/2012 | Brassica | Cabbage | 0 | 0 | 0 |
| SE2502 | 25/02/2006 | Cardamine flexuosa | Wavy Bitter-Cress | 0 | 0 | 0 |
| SE2502 | 25/02/2006 | Rorippa microphylla | Narrow-Fruited Water-Cress | 0 | 0 | 0 |
| SE244030 | 21/09/2012 | Cerastium fontanum | Common Mouse-Ear | 0 | 0 | 0 |
| SE2502 | 25/02/2006 | Stellaria uliginosa | Bog Stitchwort | 0 | 0 | 0 |
| SE244030 | 21/09/2012 | Acer pseudoplatanus | Sycamore | 0 | 0 | 0 |
| SE2502 | 25/02/2006 | Trifolium repens | White Clover | 0 | 0 | 0 |
| SE244030 | 21/09/2012 | Agrimonia eupatoria | Agrimony | 0 | 0 | 0 |
| SE253024 | 29/06/1997 | Crataegus monogyna | Hawthorn | 0 | 0 | 0 |
| SE2403 | 01/10/1996 | Sorbus aucuparia | Rowan | 0 | 0 | 0 |
| SE2502 | 25/02/2006 | Epilobium ciliatum | American Willowherb | 0 | 0 | 0 |
| SE2502 | 25/02/2006 | Callitriche hamulata | Intermediate Water-starwort | 0 | 0 | 0 |
| SE244030 | 21/09/2012 | Persicaria maculosa | Redshank | 0 | 0 | 0 |
| SE2502 | 25/02/2006 | Rumex acetosa | Common Sorrel | 0 | 0 | 0 |

| | | | | | | |
|----------|------------|------------------------------|----------------------|---|---|---|
| SE244030 | 21/09/2012 | Betula | Birch | 0 | 0 | 0 |
| SE2403 | 01/11/1993 | Alnus glutinosa | Alder | 0 | 0 | 0 |
| SE2403 | 17/10/1995 | Alnus glutinosa | Alder | 0 | 0 | 0 |
| SE2403 | 01/01/1997 | Alnus glutinosa | Alder | 0 | 0 | 0 |
| SE2403 | 26/12/1997 | Alnus glutinosa | Alder | 0 | 0 | 0 |
| SE2403 | 01/01/1998 | Alnus glutinosa | Alder | 0 | 0 | 0 |
| SE244030 | 21/09/2012 | Quercus petraea | Sessile Oak | 0 | 0 | 0 |
| SE244030 | 21/09/2012 | Salix | Sallow | 0 | 0 | 0 |
| SE2403 | 13/06/1997 | Fraxinus excelsior | Ash | 0 | 0 | 0 |
| SE244030 | 21/09/2012 | Pentaglottis sempervirens | Green Alkanet | 0 | 0 | 0 |
| SE244030 | 21/09/2012 | Mentha aquatica | Water Mint | 0 | 0 | 0 |
| SE2502 | 25/02/2006 | Littorella uniflora | Shoreweed | 0 | 0 | 0 |
| SE244030 | 21/09/2012 | Senecio vulgaris | Groundsel | 0 | 0 | 0 |
| SE2502 | 25/02/2006 | Cirsium palustre | Marsh Thistle | 0 | 0 | 0 |
| SE2403 | 22/09/2012 | Thymallus thymallus | Grayling | 0 | 0 | 0 |
| SE244030 | 21/09/2012 | Cyprinus carpio | Carp | 0 | 0 | 0 |
| SE245035 | 24/10/1973 | Phoxinus phoxinus | Minnow | 0 | 0 | 0 |
| SE244030 | 21/09/2012 | Pieris brassicae | Large White | 0 | 0 | 0 |
| SE2403 | 04/07/2011 | Pieris rapae | Small White | 0 | 0 | 0 |
| SE2403 | 09/08/2011 | Pieris rapae | Small White | 0 | 0 | 0 |
| SE2403 | 09/08/2011 | Pieris napi | Green-Veined White | 0 | 0 | 0 |
| SE2403 | 09/08/2011 | Maniola jurtina | Meadow Brown | 0 | 0 | 0 |
| SE248035 | 01/11/1981 | Aegopinella nitidula | Aegopinella nitidula | 0 | 0 | 0 |
| SE246038 | 29/05/1998 | Hydraena gracilis | Hydraena gracilis | 0 | 0 | 0 |
| SE246038 | 29/05/1998 | Elmis aenea | Elmis aenea | 0 | 0 | 0 |
| SE246038 | 14/10/1999 | Elmis aenea | Elmis aenea | 0 | 0 | 0 |
| SE246038 | 14/10/1999 | Elmis aenea | Elmis aenea | 0 | 0 | 0 |

| | | | | | | |
|----------|------------|-------------------------|-------------------------|---|---|---|
| SE247037 | 14/10/1999 | Limnius volckmari | Limnius volckmari | 0 | 0 | 0 |
| SE246038 | 14/10/1999 | Limnius volckmari | Limnius volckmari | 0 | 0 | 0 |
| SE246038 | 14/10/1999 | Limnius volckmari | Limnius volckmari | 0 | 0 | 0 |
| SE246038 | 14/10/1999 | Oulimnius tuberculatus | Oulimnius tuberculatus | 0 | 0 | 0 |
| SE256025 | 20/07/2009 | Rhyacophila dorsalis | Rhyacophila dorsalis | 0 | 0 | 0 |
| SE254022 | 07/09/2009 | Rhyacophila dorsalis | Rhyacophila dorsalis | 0 | 0 | 0 |
| SE2403 | 22/09/2012 | Rhyacophila dorsalis | Rhyacophila dorsalis | 0 | 0 | 0 |
| SE256025 | 20/07/2009 | Hydropsyche instabilis | Hydropsyche instabilis | 0 | 0 | 0 |
| SE254022 | 07/09/2009 | Potamophylax latipennis | Potamophylax latipennis | 0 | 0 | 0 |
| SE2403 | 22/09/2012 | Potamophylax latipennis | Potamophylax latipennis | 0 | 0 | 0 |
| SE256025 | 20/07/2009 | Sericostoma personatum | Sericostoma personatum | 0 | 0 | 0 |
| SE254022 | 02/06/2009 | Molanna angustata | Molanna angustata | 0 | 0 | 0 |
| SE254022 | 07/09/2009 | Molanna angustata | Molanna angustata | 0 | 0 | 0 |
| SE254022 | 02/06/2009 | Mystacides azurea | Mystacides azurea | 0 | 0 | 0 |
| SE254022 | 02/06/2009 | Mystacides longicornis | Mystacides longicornis | 0 | 0 | 0 |
| SE2403 | 11/09/2008 | Palomena prasina | Green Shieldbug | 0 | 0 | 0 |
| SE2403 | 22/09/2012 | Baetis rhodani | Baetis rhodani | 0 | 0 | 0 |
| SE246034 | 06/05/1995 | Acarospora fuscata | Acarospora fuscata | 0 | 0 | 0 |
| SE246034 | 06/05/1995 | Porpidia tuberculosa | Porpidia tuberculosa | 0 | 0 | 0 |

| | | | | | | |
|----------|------------|--------------------------|--------------------------|---|---|---|
| SE246034 | 06/05/1995 | Hypogymnia physodes | Hypogymnia physodes | 0 | 0 | 0 |
| SE246034 | 06/05/1995 | Lecania erysibe | Lecania erysibe | 0 | 0 | 0 |
| SE246034 | 06/05/1995 | Lecanora albescens | Lecanora albescens | 0 | 0 | 0 |
| SE246034 | 06/05/1995 | Lecanora dispersa | Lecanora dispersa | 0 | 0 | 0 |
| SE246034 | 06/05/1995 | Lecanora epanora | Lecanora epanora | 0 | 0 | 0 |
| SE246034 | 06/05/1995 | Lecanora intricata | Lecanora intricata | 0 | 0 | 0 |
| SE246034 | 06/05/1995 | Lecanora muralis | Lecanora muralis | 0 | 0 | 0 |
| SE246034 | 06/05/1995 | Lecanora polytropa | Lecanora polytropa | 0 | 0 | 0 |
| SE246034 | 06/05/1995 | Lecanora soralifera | Lecanora soralifera | 0 | 0 | 0 |
| SE246034 | 06/05/1995 | Lecidella scabra | Lecidella scabra | 0 | 0 | 0 |
| SE246034 | 06/05/1995 | Lepraria incana | Lepraria incana | 0 | 0 | 0 |
| SE246034 | 06/05/1995 | Parmelia sulcata | Parmelia sulcata | 0 | 0 | 0 |
| SE246034 | 06/05/1995 | Phaeophyscia orbicularis | Phaeophyscia orbicularis | 0 | 0 | 0 |
| SE246034 | 06/05/1995 | Rinodina gennarii | Rinodina gennarii | 0 | 0 | 0 |
| SE246034 | 06/05/1995 | Trapelia placodioides | Trapelia placodioides | 0 | 0 | 0 |
| SE246034 | 06/05/1995 | Caloplaca citrina | Caloplaca citrina | 0 | 0 | 0 |
| SE246034 | 06/05/1995 | Caloplaca holocarpa | Caloplaca holocarpa | 0 | 0 | 0 |
| SE2503 | 15/03/2007 | Conocephalum conicum | Great Scented Liverwort | 0 | 0 | 0 |
| SE2503 | 15/03/2007 | Lunularia cruciata | Crescent-cup Liverwort | 0 | 0 | 0 |
| SE2503 | 15/03/2007 | Lophocolea bidentata | Bifid Crestwort | 0 | 0 | 0 |
| SE2503 | 15/03/2007 | Orthotrichum affine | Wood Bristle-moss | 0 | 0 | 0 |

| | | | | | | |
|----------|------------|----------------------------|------------------------|---|---|---|
| SE2403 | 15/03/2007 | Rhytidiadelphus squarrosus | Springy Turf-moss | 0 | 0 | 0 |
| SE244030 | 21/09/2012 | Lumbricus terrestris | Common Earthworm | 0 | 0 | 0 |
| SE2403 | 22/09/2012 | Leuctra geniculata | Leuctra geniculata | 0 | 0 | 0 |
| SE2503 | 15/03/2007 | Calypogeia fissa | Common Pouchwort | 0 | 0 | 0 |
| SE2503 | 15/03/2007 | Diplophyllum albicans | White Earwort | 0 | 0 | 0 |
| SE2503 | 15/03/2007 | Chiloscyphus polyanthos | St Winifrid's Moss | 0 | 0 | 0 |
| SE2503 | 15/03/2007 | Pellia endiviifolia | Endive Pellia | 0 | 0 | 0 |
| SE2503 | 15/03/2007 | Polytrichum piliferum | Bristly Haircap | 0 | 0 | 0 |
| SE2403 | 15/03/2007 | Atrichum undulatum | Common Smoothcap | 0 | 0 | 0 |
| SE2403 | 15/03/2007 | Ceratodon purpureus | Redshank | 0 | 0 | 0 |
| SE2503 | 15/03/2007 | Dicranella heteromalla | Silky Forklet-moss | 0 | 0 | 0 |
| SE2403 | 15/03/2007 | Dicranoweisia cirrata | Common Pincushion | 0 | 0 | 0 |
| SE2503 | 15/03/2007 | Dicranum scoparium | Broom Fork-moss | 0 | 0 | 0 |
| SE2503 | 15/03/2007 | Campylopus introflexus | Heath Star Moss | 0 | 0 | 0 |
| SE2503 | 15/03/2007 | Fissidens bryoides | Lesser Pocket-moss | 0 | 0 | 0 |
| SE2503 | 15/03/2007 | Fissidens taxifolius | Common Pocket-moss | 0 | 0 | 0 |
| SE2503 | 15/03/2007 | Tortula ruralis | Great Hairy Screw-moss | 0 | 0 | 0 |

| | | | | | | |
|--------|------------|-----------------------|-------------------------------|---|---|---|
| SE2403 | 15/03/2007 | Tortula muralis | Wall Screw-moss | 0 | 0 | 0 |
| SE2503 | 15/03/2007 | Barbula convoluta | Lesser Bird's-claw Beard-moss | 0 | 0 | 0 |
| SE2503 | 15/03/2007 | Barbula unguiculata | Bird's-claw Beard-moss | 0 | 0 | 0 |
| SE2503 | 15/03/2007 | Barbula cylindrica | Cylindric Beard-moss | 0 | 0 | 0 |
| SE2503 | 15/03/2007 | Barbula recurvirostra | Red Beard-moss | 0 | 0 | 0 |
| SE2503 | 15/03/2007 | Schistidium apocarpum | Schistidium apocarpum | 0 | 0 | 0 |
| SE2503 | 15/03/2007 | Grimmia pulvinata | Grey-cushioned Grimmia | 0 | 0 | 0 |
| SE2503 | 15/03/2007 | Racomitrium aciculare | Yellow Fringe-moss | 0 | 0 | 0 |
| SE2503 | 15/03/2007 | Funaria hygrometrica | Common Cord-moss | 0 | 0 | 0 |
| SE2503 | 15/03/2007 | Pohlia nutans | Nodding Thread-moss | 0 | 0 | 0 |
| SE2403 | 15/03/2007 | Bryum capillare | Capillary Thread-moss | 0 | 0 | 0 |
| SE2503 | 15/03/2007 | Bryum argenteum | Silver-moss | 0 | 0 | 0 |
| SE2503 | 15/03/2007 | Bryum rubens | Crimson-tuber Thread-moss | 0 | 0 | 0 |
| SE2503 | 15/03/2007 | Mnium hornum | Swan's-neck Thyme-moss | 0 | 0 | 0 |
| SE2503 | 15/03/2007 | Rhizomnium punctatum | Dotted Thyme-moss | 0 | 0 | 0 |
| SE2503 | 15/03/2007 | Plagiomnium undulatum | Hart's-tongue Thyme-moss | 0 | 0 | 0 |

| | | | | | | |
|--------|------------|-----------------------------|--------------------------------|---|---|---|
| SE2403 | 15/03/2007 | Orthotrichum diaphanum | White-tipped Bristle-moss | 0 | 0 | 0 |
| SE2503 | 15/03/2007 | Ulota crispa var. norvegica | Bruch's Pincushion | 0 | 0 | 0 |
| SE2503 | 15/03/2007 | Thamnobryum alopecurum | Fox-tail Feather-moss | 0 | 0 | 0 |
| SE2503 | 15/03/2007 | Amblystegium serpens | Creeping Feather-moss | 0 | 0 | 0 |
| SE2503 | 15/03/2007 | Amblystegium riparium | Kneiff's Feather-moss | 0 | 0 | 0 |
| SE2503 | 15/03/2007 | Calliergon cuspidatum | Pointed Spear-moss | 0 | 0 | 0 |
| SE2503 | 15/03/2007 | Homalothecium sericeum | Silky Wall Feather-moss | 0 | 0 | 0 |
| SE2503 | 15/03/2007 | Brachythecium albicans | Whitish Feather-moss | 0 | 0 | 0 |
| SE2503 | 15/03/2007 | Brachythecium rutabulum | Rough-stalked Feather-moss | 0 | 0 | 0 |
| SE2503 | 15/03/2007 | Brachythecium rivulare | River Feather-moss | 0 | 0 | 0 |
| SE2503 | 15/03/2007 | Rhynchostegium riparioides | Long-beaked Water Feather-moss | 0 | 0 | 0 |
| SE2403 | 15/03/2007 | Rhynchostegium confertum | Clustered Feather-moss | 0 | 0 | 0 |
| SE2503 | 15/03/2007 | Eurhynchium praelongum | Common Feather-moss | 0 | 0 | 0 |
| SE2503 | 15/03/2007 | Plagiothecium succulentum | Juicy Silk-moss | 0 | 0 | 0 |
| SE2503 | 15/03/2007 | Isopterygium elegans | Elegant Silk-moss | 0 | 0 | 0 |

| | | | | | | |
|----------|------------|---------------------------------------|--------------------|---|---|---|
| SE2503 | 15/03/2007 | Hypnum cupressiforme var. lacunosum | Great Plait-moss | 0 | 0 | 0 |
| SE2503 | 15/03/2007 | Hypnum cupressiforme var. resupinatum | Supine Plait-moss | 0 | 0 | 0 |
| SE2503 | 15/03/2007 | Hypnum jutlandicum | Heath Plait-moss | 0 | 0 | 0 |
| SE244030 | 21/09/2012 | Juncus | Rush | 0 | 0 | 0 |
| SE2403 | 09/08/2011 | Pyronia tithonus | Hedge Brown | 0 | 0 | 0 |
| SE2402 | 18/07/2008 | Chiroptera | Bats | 0 | 0 | 0 |
| SE2403 | 08/02/1993 | Chiroptera | Bats | 0 | 0 | 0 |
| SE247036 | 31/07/1987 | Chiroptera | Bats | 0 | 0 | 0 |
| SE247036 | 18/08/1987 | Chiroptera | Bats | 0 | 0 | 0 |
| SE247036 | 27/05/1988 | Chiroptera | Bats | 0 | 0 | 0 |
| SE247036 | 16/07/1990 | Chiroptera | Bats | 0 | 0 | 0 |
| SE247036 | 08/07/1991 | Chiroptera | Bats | 0 | 0 | 0 |
| SE248035 | 30/07/1990 | Chiroptera | Bats | 0 | 0 | 0 |
| SE248036 | 02/08/1990 | Chiroptera | Bats | 0 | 0 | 0 |
| SE249039 | 28/06/2001 | Chiroptera | Bats | 0 | 0 | 0 |
| SE2503 | 01/01/2011 | Streptopelia decaocto | Collared Dove | 0 | 0 | 0 |
| SE2402 | 14/06/2009 | Aegithalos caudatus | Long-Tailed Tit | 0 | 0 | 0 |
| SE2503 | 01/01/2011 | Erithacus rubecula | Robin | 0 | 0 | 0 |
| SE2503 | 01/01/2011 | Corvus frugilegus | Rook | 0 | 0 | 0 |
| SE2502 | 01/10/1999 | Larus | Indet. Gull | 0 | 0 | 0 |
| SE244030 | 21/09/2012 | Harmonia axyridis | Harlequin Ladybird | 0 | 0 | 0 |

| | | | | | | |
|----------|------------|--|--|---|---|---|
| SE246034 | 06/05/1995 | Lecanora conizaeoides forma conizaeoides | Lecanora conizaeoides forma conizaeoides | 0 | 0 | 0 |
| SE246034 | 06/05/1995 | Melanelia subaurifera | Melanelixia subaurifera | 0 | 0 | 0 |
| SE246034 | 06/05/1995 | Physcia tenella subsp. tenella | Physcia tenella subsp. tenella | | | |
| SE247036 | 20/07/1990 | Myotis brandti | Brandt's Bat | | | |
| SE254022 | 07/09/2009 | Agraylea multipunctata | Agraylea multipunctata | | | |
| SE254022 | 21/06/2010 | Agraylea multipunctata | Agraylea multipunctata | | | |
| SE254022 | 02/06/2009 | Hydroptila occulta | Hydroptila occulta | | | |
| SE256025 | 20/07/2009 | Hydroptila vectis | Hydroptila vectis | | | |
| SE254022 | 21/06/2010 | Hydroptila vectis | Hydroptila vectis | | | |
| SE254022 | 02/06/2009 | Tinodes waeneri | Tinodes waeneri | | | |
| SE254022 | 07/09/2009 | Tinodes waeneri | Tinodes waeneri | | | |
| SE254022 | 21/06/2010 | Hydropsyche angustipennis | Hydropsyche angustipennis | | | |
| SE254022 | 02/06/2009 | Hydropsyche pellucidula | Hydropsyche pellucidula | | | |
| SE254022 | 02/06/2009 | Adicella reducta | Adicella reducta | | | |
| SE256025 | 20/07/2009 | Adicella reducta | Adicella reducta | | | |
| SE254022 | 21/06/2010 | Adicella reducta | Adicella reducta | | | |
| SE254022 | 07/09/2009 | Oecetis lacustris | Oecetis lacustris | | | |
| SE254022 | 07/09/2009 | Oecetis ochracea | Oecetis ochracea | | | |
| SE246034 | 06/05/1995 | Lecanora crenulata | Lecanora crenulata | | | |
| SE246034 | 06/05/1995 | Caloplaca dalmatica | Caloplaca dalmatica | | | |
| SE2503 | 15/03/2007 | Bryum bicolor | Bryum bicolor | | | |

| | | | | | | |
|--------|------------|---|--|--|--|--|
| SE2403 | 15/03/2007 | Hypnum cupressiforme var. cupressiforme | Hypnum cupressiforme var. cupressiforme | | | |
|--------|------------|---|--|--|--|--|

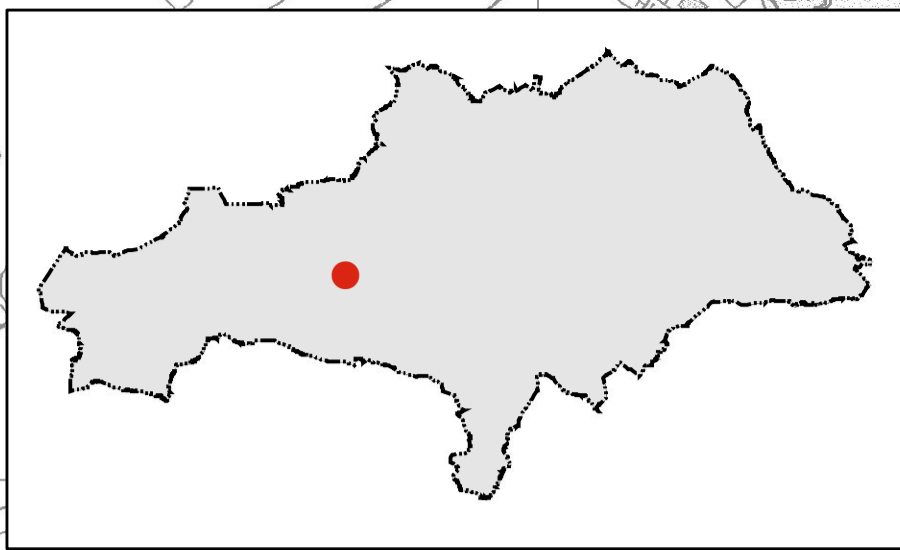

-  Sheffield Road, Penistone SE 252 032
-  1km Buffer Sheffield Road, Penistone SE 252 032
-  Undetermined Grassland (Natural England Inventory)
-  Barnsley District Boundary
-  Deciduous Woodland (Natural England Inventory)

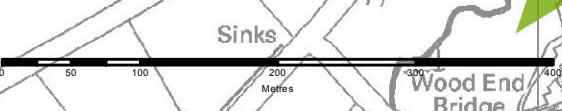

OXSPRING CP
Sheffield Biological Records Centre

APPENDIX 2

Middlemarch Environmental Ltd Drawing C113193-01-01
Extended Phase 1 Habitat Survey

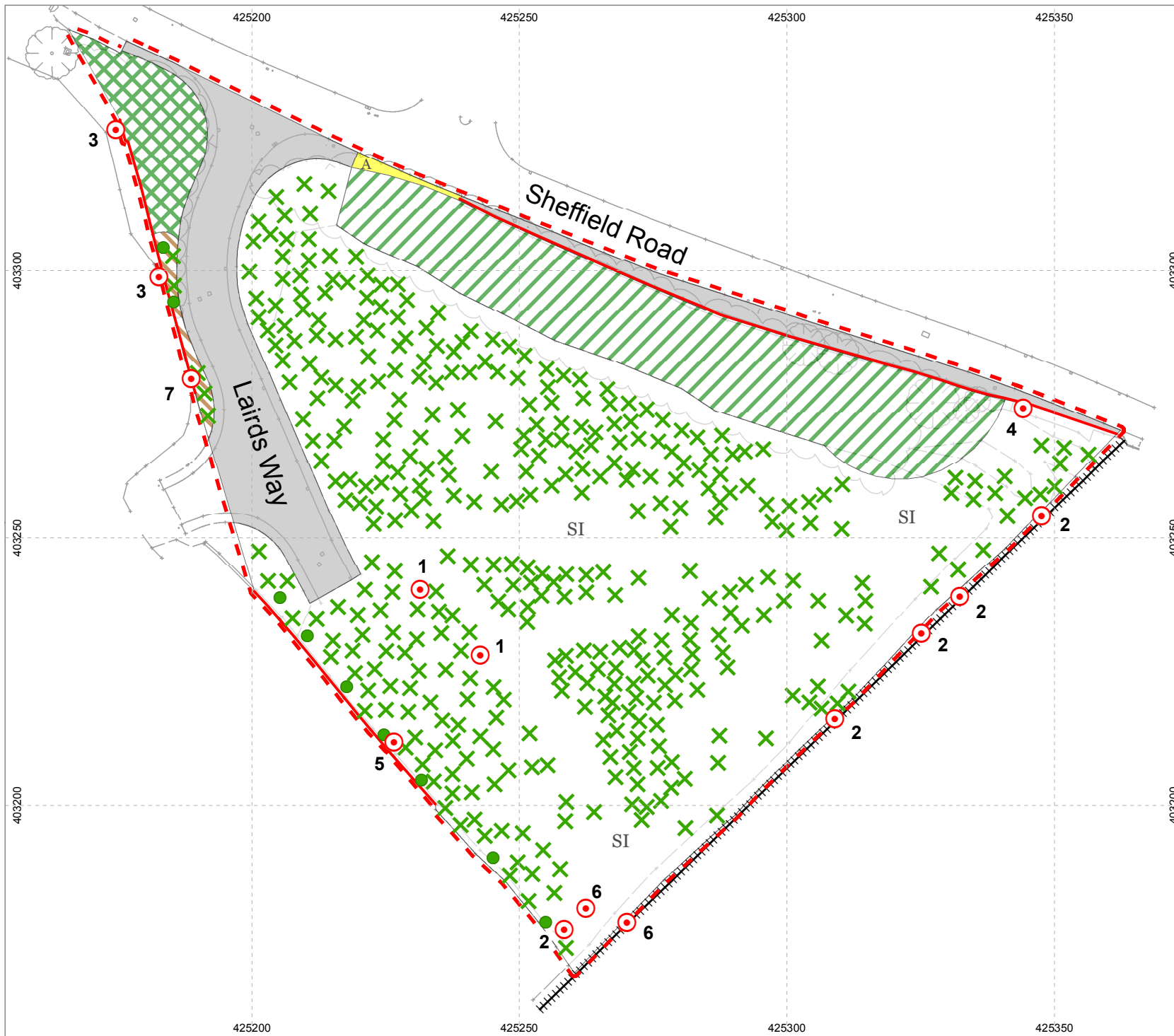

C113193-01-01

Legend

- Scattered scrub
- Scattered tree
- Target note
- Survey boundary
- Fence
- Wall
- Amenity grassland
- Broad-leaved plantation woodland
- Dense scrub
- Hardstanding
- Poor semi-improved grassland
- Tall ruderal

| | | | |
|-------------|---------------------------------|----------------|---------------------------|
| Client | The Co-operative Group | Project | Sheffield Road, Penistone |
| Drawing | Extended Phase 1 Habitat Survey | Drawing Number | C113193-01-01 |
| Revision | 00 | Date | December 2012 |
| Scale at A4 | 1:1,000 | Drawn By | CD |
| Approved By | FW | Notes | - |



Triumph House, Birmingham Road, Allesley, Coventry CV5 9AZ
 T:01676 525880 F:01676 521400
 E:admin@middlemarch-environmental.com

Drawing based on topographical survey "PS-0805-TS", supplied by the client.

TARGET NOTES

1. Wetter area of grassland with standing water that contains moss and lower frequency of grass. The presence of water appears to be ephemeral.
2. Brash pile.
3. Trees overhanging site.
4. Missing mortar and gaps within stone retaining wall.
5. Low brick wall that is damaged in places
6. Japanese knotweed. Dead stems remaining from previous growing season.
7. Section of delapidated brick wall with missing mortar.

APPENDIX 3

Overview of Relevant Legislation

GENERAL LEGISLATION AND POLICY OVERVIEW

This section provides an overview of the framework of legislation and policy which underpins nature conservation and is a material consideration in the planning process in England.

CONSERVATION OF HABITATS AND SPECIES REGULATIONS 2010, AS AMENDED (HABITATS REGULATIONS 2010, AS AMENDED)

The Habitats Regulations 2010 consolidate and update the Conservation (Natural Habitats, &c.) Regulations 1994 and all its various amendments. The Habitats Regulations 2010 are the principal means by which the EEC Council Directive 92/43 (The Habitats Directive) as amended is transposed into English and Welsh law.

The Habitats Regulations 2010 place duty upon the relevant authority of government to identify sites which are of importance to the habitats and species listed in Annexes I and II of the Habitats Directive. Those sites which meet the criteria are, in conjunction with the European Commission, designated as Sites of Community Importance, which are subsequently identified as Special Areas of Conservation (SAC) by the European Union member states. The regulations also place a duty upon the government to maintain a register of European protected sites designated as a result of EC Directive 79/409/EEC on the Conservation of Wild Birds (The Birds Directive). These sites are termed Special Protection Areas (SPA) and, in conjunction with SACs, form a network of sites known as Natura 2000. The Habitats Directive introduces for the first time for protected areas, the precautionary principle; that is that projects can only be permitted having ascertained no adverse effect on the integrity of the site. Projects may still be permitted if there are no alternatives, and there are imperative reasons of overriding public interest.

The Habitats Regulations 2010 also provide for the protection of individual species of fauna and flora of European conservation concern listed in Schedules 2 and 5 respectively. Schedule 2 includes species such as otter and great crested newt for which the UK population represents a significant proportion of the total European population. It is an offence to deliberately kill, injure, disturb or trade these species. Schedule 5 plant species are protected from unlawful destruction, uprooting or trade under the regulations.

The Habitats Regulations 2010 were amended in August 2012 to ensure clearer transposition of the provisions of Articles 2, 3, 4(4) (second sentence) and Article 10 of the Wild Birds Directive, by giving additional and specific duties to relevant bodies. A number of amendments were also made to transpose more clearly certain elements of the Habitats Directive.

THE WILDLIFE AND COUNTRYSIDE ACT (WCA) 1981 (AS AMENDED)

The WCA, as amended, consolidates and amends pre-existing national wildlife legislation in order to implement the Bern Convention and the Birds Directive. It complements the Conservation (Natural Habitats, &c.) Regulations 1994 (as amended), offering protection to a wider range of species. The Act also provides for the designation and protection of national conservation sites of value for their floral, faunal or geological features, termed Sites of Special Scientific Interest (SSSIs).

Schedules of the act provide lists of protected species, both flora and fauna, and detail the possible offences that apply to these species. All relevant species specific legislation is detailed later in this Appendix.

THE COUNTRYSIDE AND RIGHTS OF WAY (CROW) ACT 2000

The CROW Act, introduced in England and Wales in 2000, amends and strengthens existing wildlife legislation detailed in the WCA. It places a duty on government departments and the National Assembly for Wales to have regard for biodiversity, and provides increased powers for the protection and maintenance of SSSIs.

The Act also contains lists of habitats and species (Section 74) for which conservation measures should be promoted, in accordance with the recommendations of the Convention on Biological Diversity (Rio Earth Summit) 1992.

THE NATURAL ENVIRONMENT AND RURAL COMMUNITIES (NERC) ACT 2006

Section 40 of the NERC Act places a duty upon all local authorities and public bodies in England and Wales to promote and enhance biodiversity in all of their functions. Sections 41 (England) and 42 (Wales) list habitats and species of principal importance to the conservation of biodiversity. These lists supersede

Section 74 of the CRoW Act 2000. These species and habitats are a material consideration in the planning process.

THE HEDGEROW REGULATIONS 1997

The Hedgerow Regulations make provision for the identification of important hedgerows which may not be removed without permission from the Local Planning Authority.

UK BIODIVERSITY ACTION PLAN

The United Kingdom Biodiversity Action Plan (UKBAP), first published in 1994 and updated in 2007, is a government initiative designed to implement the requirements of the Convention of Biological Diversity to conserve and enhance species and habitats. The UKBAP contains a list of priority habitats and species of conservation concern in the UK, and outlines biodiversity initiatives designed to enhance their conservation status. Lists and Broad and Local habitats are also included. The priority habitats and species correlate with those listed on Section 41 and 42 of the NERC Act.

The UKBAP requires that conservation of biodiversity is addressed at a County level through the production of Local BAPs. These are complementary to the UKBAP, however are targeted towards species of conservation concern characteristic of each area. In addition, a number of local authorities and large organisations have produced their own BAPs.

UKBAP and Local BAP targets with regard to species and habitats are a material consideration in the planning process.

Planning Policy

National Planning Policy Framework

In early 2012, the National Planning Policy Framework (NPPF) replaced much previous planning policy guidance, including Planning Policy Statement 9: Biological and Geological Conservation. The government circular 06/05: Biodiversity and Geological Conservation - Statutory Obligations and Their Impact within the Planning System, which accompanied PPS9, still remains valid. A presumption towards sustainable development is at the heart of the NPPF. This presumption does not apply however where developments require appropriate assessment under the Birds or Habitats Directives.

Chapter 11, on conserving and enhancing the natural environment, sets out how the planning system should contribute to and enhance the natural and local environment by minimising impacts on biodiversity and, where possible, provide net gains in biodiversity. Opportunities to incorporate biodiversity gains into a development should be encouraged.

If a proposed development would result in significant harm to the natural environment which cannot be avoided (through the use of an alternative site with less harmful impacts), mitigated or compensated for (as a last resort) then planning permission should be refused.

SPECIES SPECIFIC LEGISLATION

This section contains a summary of legislation with relation to the species present or potentially present in the survey area. The reader should refer to the original legislation for definitive interpretation.

Bats

Bats and the places they use for shelter or protection (i.e. roosts) receive European protection under The Conservation of Habitats and Species Regulations 2010, as amended (Habitats Regulations 2010, as amended). They receive further legal protection under the Wildlife and Countryside Act (WCA) 1981, as amended. This protection means that bats, and the places they use for shelter or protection, are capable of being a material consideration in the planning process.

Regulation 41 of the Habitats Regulations 2010 (as amended), states that a person commits an offence if they:

- deliberately capture, injure or kill a bat;
- deliberately disturb bats; or
- damage or destroy a bat roost (breeding site or resting place).

Disturbance of animals includes in particular any disturbance which is likely to impair their ability to survive, to breed or reproduce, or to rear or nurture their young, or in the case of animals of a hibernating or migratory species, to hibernate or migrate; or to affect significantly the local distribution or abundance of the species to which they belong.

It is an offence under the Habitats Regulations 2010 (as amended) for any person to have in his possession or control, to transport, to sell or exchange or to offer for sale, any live or dead bats, part of a bat or anything derived from bats, which has been unlawfully taken from the wild.

Whilst broadly similar to the above legislation, the WCA 1981 (as amended) differs in the following ways:

- Section 9(1) of the WCA makes it an offence to *intentionally* (rather than deliberately) kill, injure or take any protected species.
- Section 9(4)(a) of the WCA makes it an offence to *intentionally or recklessly** damage or destroy, or *obstruct access to*, any structure or place which a protected species uses for shelter or protection.
- Section 9(4)(b) of the WCA makes it an offence to *intentionally or recklessly** disturb any protected species *while it is occupying a structure or place which it uses for shelter or protection*.

*Reckless offences were added by the Countryside and Rights of Way (CRoW) Act 2000.

As bats re-use the same roosts (breeding site or resting place) after periods of vacancy, legal opinion is that roosts are protected whether or not bats are present.

The following bat species are listed on the UK BAP and Section 41 of the NERC Act 2006: Barbastelle Bat *Barbastella barbastellus*, Bechstein's Bat *Myotis bechsteinii*, Noctule Bat *Nyctalus noctula*, Soprano Pipistrelle *Pipistrellus pygmaeus*, Brown Long-eared Bat *Plecotus auritus*, Greater Horseshoe Bat *Rhinolophus ferrumequinum* and Lesser Horseshoe Bat *Rhinolophus hipposideros*.

The reader should refer to the original legislation for the definitive interpretation.

Nesting and Nest Building Birds

Nesting and nest building birds are protected under the Wildlife and Countryside Act WCA 1981 (as amended). Some species (listed in Schedule 1 of the WCA) are protected by special penalties.

Subject to the provisions of the act, if any person intentionally:

- kills, injures or takes any wild bird;
- takes, damages or destroys the nest of any wild bird while that nest is in use or being built; or
- takes or destroys an egg of any wild bird,

he shall be guilty of an offence.

'Reckless' offences with regard to the disturbance of nesting wild birds included in Schedule 1 of the Wildlife and Countryside Act were added by the Countryside and Rights of Way Act 2000.

The Natural Environment and Rural Communities (NERC) Act 2006 places a duty on Government Departments to have regard for the conservation of biodiversity and maintains lists of species and habitats which are of principal importance for the purposes of conserving biodiversity in England and Wales. These lists include a number of bird species.

Reptiles

All of the UK's native reptiles are protected by law. The two rarest species – sand lizard (*Lacerta agilis*) and smooth snake (*Coronella austriaca*) – benefit from the greatest protection, however these two species are not known to occur within South Yorkshire / Both these species have a limited geographical distribution and none of the habitats within the study area fulfill their specific habitat requirements. It is therefore considered that these species are unlikely to be present within the study area. Common lizard (*Lacerta vivipara*), slow-worm (*Anguis fragilis*), adder (*Vipera berus*) and grass snake (*Natrix natrix*) are protected under the Wildlife and Countryside Act 1981 as amended from intentional killing or injuring.

In England and Wales, this Act has been amended by the Countryside and Rights of Way Act 2000 (CRoW), which adds an extra offence, makes species offences arrestable, increases the time limits for some prosecutions and increases penalties. The Natural Environment and Rural Communities (NERC) Act 2006 places a duty on Government Departments to have regard for the conservation of biodiversity and maintains lists of species and habitats which are of principal importance for the purposes of conserving biodiversity in England and Wales. All native reptile species are included on these lists.

This is a simplified description of the legislation. In particular, the offences mentioned here may be absolute, intentional, deliberate or reckless. Note that where it is predictable that reptiles are likely to be killed or injured by activities such as site clearance, this could legally constitute intentional killing or injuring.

English Nature (2004) has stated that:

Reptiles are likely to be threatened, and the law potentially breached, by activities such as the following:

- Archaeological and geotechnical investigations
- Clearing land, installing site offices or digging foundations
- Cutting vegetation to a low height
- Laying pipelines or installing other services
- Driving machinery over sensitive areas
- Storing construction materials in sensitive areas
- Removing rubble, wood piles and other debris.

In general Natural England would expect reasonable avoidance to include measures such as altering development layouts to avoid key areas, as well as capture and exclusion of reptiles.

MIDDLEMARCH ENVIRONMENTAL LTD

QUALITY ASSURANCE

TITLE: SHEFFIELD ROAD, PENISTONE
EXTENDED PHASE 1 HABITAT SURVEY

A Report to The Co-Operative Group

Contract Number: C113193

Report Number: RT-MME-113193-01

Revision Number: 00

Description: Final

Date: December 2012

Checked by:

Dr Katy Read
Associate Director

Approved by:

Dr Philip Fermor
Managing Director