

This drawing is the copyright of Rosetta Landscape Design and cannot be reproduced in any form without the express consent of the company. Written and scaled dimensions to be checked on site, any discrepancies reported prior to work commencing. **If in doubt please ask.**

This drawing has been prepared for the purpose of planning approval.

Proposed Native Hedge Mix 1 (4.00/m)

Nr	Code	Plant Name	Ht(cm)	Root	Cntr(l)	Mix(%)
30	Ac	Acer campestre	80-100	B		5.00
123	Cav	Corylus avellana	80-100	B		20.00
183	Cm	Crataegus monogyna	80-100	B		30.00
60	la	Ilex aquifolium	80-100	C	5	10.00
123	Ps	Prunus spinosa	80-100	B		20.00
60	Sc	Salix caprea	80-100	B		10.00
30	Vo	Viburnum opulus	80-100	B		5.00

Proposed Shrubs

Nr	Code	Plant Name	Ht(cm)	Root	Cntr(l)	Nr/m ²
28	BIA	Berberis thunbergii 'Atropurpurea'	45-60	C	5	3.00
63	BrS	Brachyglottis 'Sunshine'	30-40	C	5	3.00
82	CIS	Choisya ternata 'Sundance'	30-40	C	5	3.00
23	EIEG	Euonymus fortunei 'Emerald 'n' Gold'	15-30	C	5	5.00
100	EIE	Euonymus fortunei 'Emerald Gaiety'	15-30	C	5	5.00
51	HpS	Hebe pinguifolia 'Sutherlandii'	30-40	C	5	4.00
9	Hca	Hypericum calycinum	45-60	C	5	4.00
42	LaH	Lavandula angustifolia 'Hidcote'	30-40	C	5	4.00
48	LnBG	Lonicera nitida 'Baggesen's Gold'	30-40	C	5	4.00
31	LnMG	Lonicera nitida 'May Green'	30-40	C	5	3.00
26	Vd	Viburnum davidii	30-40	C	5	3.00
25	Vt	Viburnum tinus	40-60	C	5	3.00
57	Vmi	Vinca minor	15-20	C	5	4.00



All hedges to be carefully and regularly clipped with line and level being maintained to promote a dense, uniform and tidy appearance, according to the type of hedges and situation

Gaps in existing hedgerow to be in-filled with same species and density of proposed Native Hedge mix 1

Native Hedge Mix 1
5nr Ac
31nr Cm
10nr Ia
21nr Ps
10nr Sc
5nr Vo

All hedges to be carefully and regularly clipped with line and level being maintained to promote a dense, uniform and tidy appearance, according to the type of hedge and situation

Gaps in existing hedgerow to be in-filled with same species and density of proposed Native Hedge mix 1

Native Hedge Mix 1
7nr Ac
28nr Cav
42nr Cm
14nr Ia
28nr Ps
14nr Sc
7nr Vo

Planting Notes

Topsoil shall be a minimum of 400mm depth over planting beds and graded to fall. Imported topsoil must be BS3882:2007 compliant and existing topsoil must be cultivated in accordance with BS3882:2007. No cultivation should take place in wet/waterlogged conditions.

Herbicide and cultivation: Topsoil to be treated with two applications of herbicide prior to planting, where necessary, strictly in accordance with the Control of Pesticides Regulations 1986 (as amended 1997 or, otherwise, updated/superseded legislation) and following manufacturer's instructions by qualified staff. The topsoil shall than be cultivated to 150mm depth.

Planting: All planting and turfing shall conform to BS: 3936: 1992 and BS:4428:1989.

Trees: Standard trees to be planted in pits 800x800x450mm or dimensions of rootball, whichever is greater. Tree to be supported by 1Nr stake (1500mm long, per tree, 600mm above ground, 75mm diameter) and 1Nr bio-degradable tie. AlignKey soil improver and 150g Enmag (or, equivalent) to be incorporated into the soil of all new tree pits. Trees to be planted centrally within a tree pit.

Container grown shrubs, transplants and whips: Shrubs and transplants shall be planted in pits 300x300x400mm depth), and the backfill shall include 3 litres of peat-free tree and shrub compost. Where two or more shrub species are indicated within a single bed each species shall be randomly mixed throughout the bed in groups of 3/5.

Native hedge: To be planted as a double row.

Herbicide: Spot treat with herbicide throughout the maintenance period in accordance with the manufacturer's instructions.

Mulch: Planting beds to receive 75mm depth pulverized ornamental bark mulch. Native woodland/edge plants to be planted with 800g flax fibre mulch mat pinned to soil. Native hedgerow to be planted through 800g flax fibre mulch roll, edges tucked. Ensure the top of the mulch layer is a minimum of 15mm below adjacent pavements and other surfaces, to prevent spillage.

Plant position: Final position of trees and shrubs subject to confirmation of service location and approval of statutory undertakers.

Grass: All turf/seeded areas to be cultivated and levelled as required removing any stones, rubble, subsoil, general construction waste.

Planting Season: Bare-root plants to be planted between mid-November and mid-March dependant upon the planting season.

LEGEND

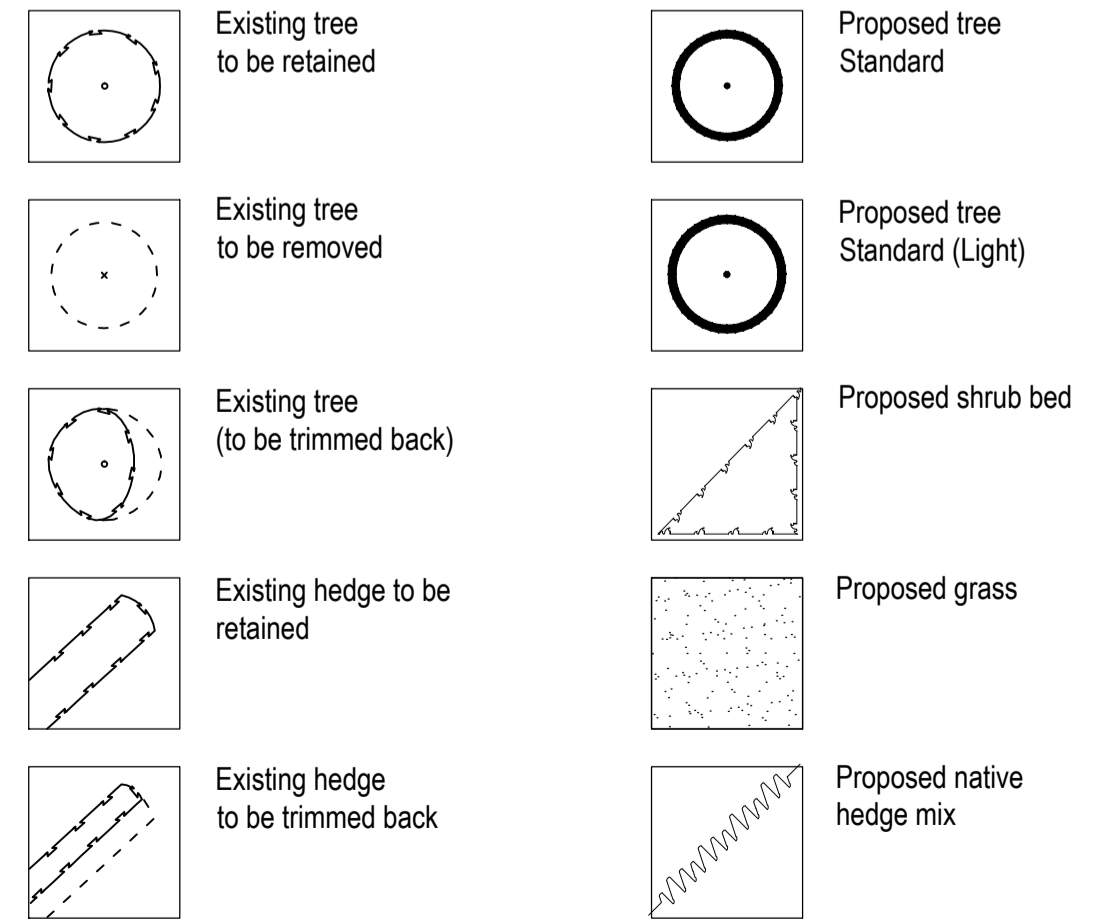

All hedges to be carefully and regularly clipped with line and level being maintained to promote a dense, uniform and tidy appearance, according to the type of hedge and situation

Gaps in existing hedgerow to be in-filled with same species and density of proposed Native Hedge mix 1

Proposed Trees

Nr	Code	Plant Name	Form	Ht(cm)	Girth(cm)	CStm(cm)	Root
4	Ac	Acer campestre	Standard	250-300	8-10	175-200	B
6	Al	Amelanchier lamarckii	Standard (Light)	250-300	6-8	150-175	B
5	Bp	Betula pendula	Standard	250-300	8-10	175-200	B
6	MJD	Malus 'John Downie'	Standard (Light)	250-300	6-8	150-175	B
3	Sar	Sorbus aria	Standard	250-300	8-10	175-200	B
4	Sau	Sorbus aucuparia	Standard	250-300	8-10	175-200	B

Rev C: Hedging note added in line with feedback 08Sep22 (RP)
 Rev B: Revised to 1014/JJ, received 11Apr22 - 21Apr22 (MP/Jr)
 Rev A: Revised to 1014/3C received 14Oct20 - 15Oct20 (MP/Jr)
 Base: Richard Ward Design, 'Planning Layout', 1014/3B

PROJECT Barnburgh View, Goldthorpe Ph 3
 TITLE Detailed Landscape Proposals (1 of 2)
 CLIENT Gleeson Homes and Regeneration
 DATE 05 Oct 20 SCALE 1 : 250 SHEET A1
 DRAWN MP/Jr DRAWING NO 3627/2
 CHECKED MP REVISION C

ROSETTA
 LANDSCAPE DESIGN
 Chartered Landscape Architects
 Swallow's Nest, Main Street
 Askham Richard, York, YO26 5NA
 Telephone +44 (0)1904 500410
 Email design@rosettalandscapedesign.co.uk
 Web www.rosettalandscapedesign.co.uk